

## Digital Voice Tracer

### Product highlights

- Voice-activated recording mode without pressing buttons
- Slot for microSD card for extra memory
- Noise reduction for clear recordings
- Stereo recording

## What's in the box

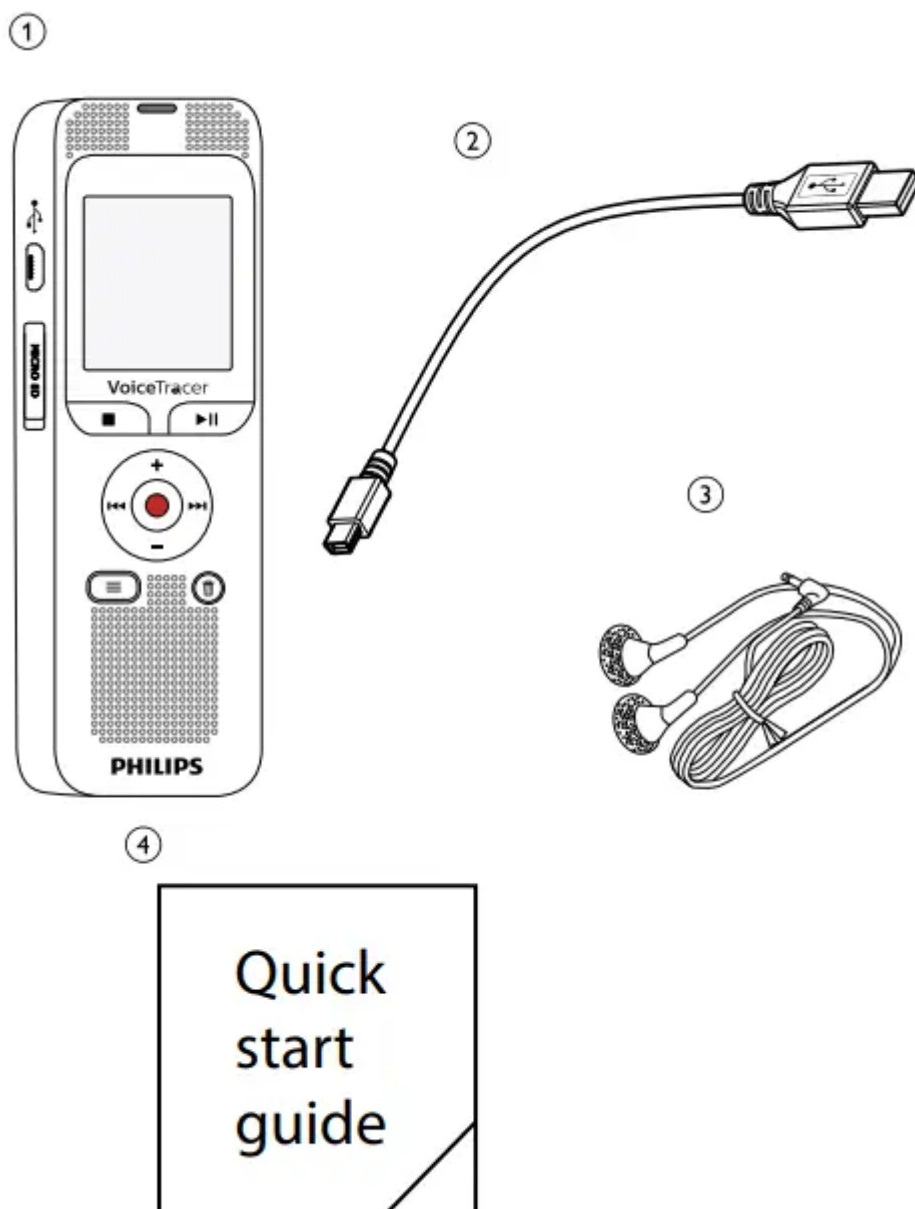

1. Device
2. USB cable to connect to a computer
3. Stereo headphones
4. Quick-start guide

## Product overviews

### Front and rear sides

1. Slot for memory card (microSD card)
2. Micro USB port for computer connection
3. Microphone
4. Status LED: Red – device is recording  
Green – device is playing back  
Yellow – data is being transferred to/from the computer
5. Display
6. Operating panel with keys
7. Speaker
8. Power on/off key keypad lock
9. Headphone socket (stereo jack, 3.5 mm)
10. External microphone socket, line-in socket (stereo jack, 3.5 mm)

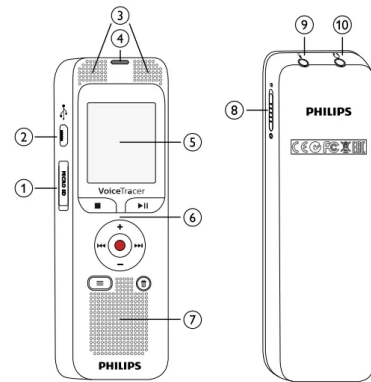

## Keys

1. Call up menu functions (menu key)
2. + Increase volume, menu navigation: Select menu functions

**▶▶** Short press: jump to the next index mark

Menu navigation: display next menu tab

Long press: fast seek forward mode

**-** Volume down, menu navigation: Select menu functions

**◀◀** Short press: jump to the previous recording

Menu navigation: display previous menu tab  
Long press: fast seek rewind mode

3. **■** Stop playback (stop key), close menu
4. **▶||** Play recording (playback key), Pause playback (pause key)
5. **●** Start recording (record key), confirm selection
6. **🗑** Delete recording (delete key)

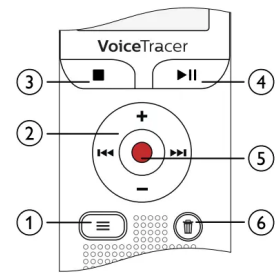

## Start-up screen

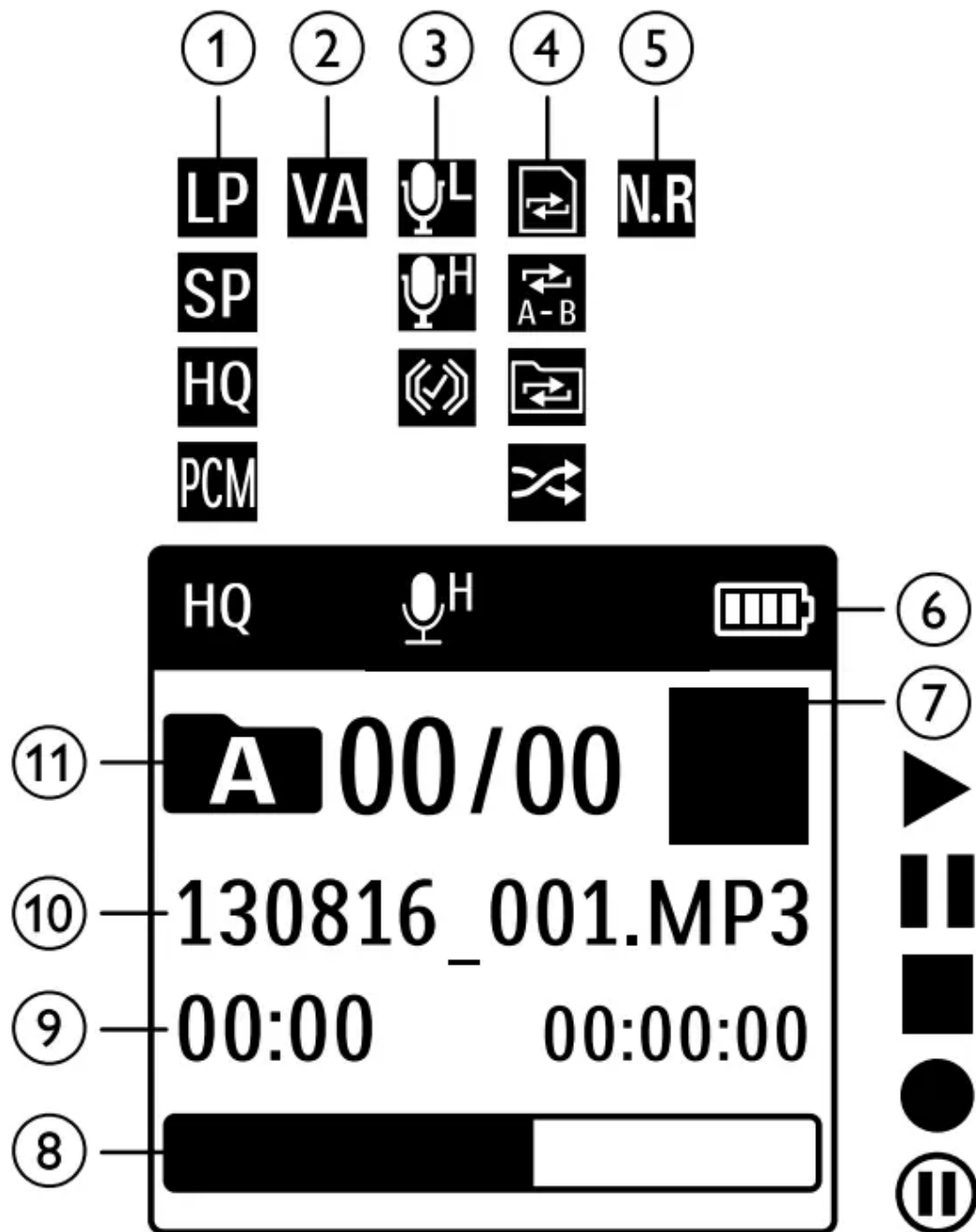



1. **HQ** Set recording quality: **LP** – LP, **SP** – SP, **HQ** – HQ, **PCM** – PCM

2. **VA** – Voice activation switched on

3. **Microphone sensitivity:** **L** – low sensitivity (shorter distance), **H** – high

sensitivity (longer distance), **Line-in source**

4. Set repeat mode / continuous loop:  – Repeat file playback,  – Repeat selection/sequence,  – Repeat folder playback,  – Random repeat mode

5.  – Noise reduction on





6.  Battery charge level

7.  – Playback,  – Pause,  – Stop,  – Record,  – Pause record

8. Position indicator of current playback/recording

9. Playback/recording time / Remaining recording time

10. File name of current playback/recording

11.  Selected folder, depending on the selected storage medium (  – internal memory,  /  – microSD card) / number of the current recording / total number of recordings in the folder

### Menu overview

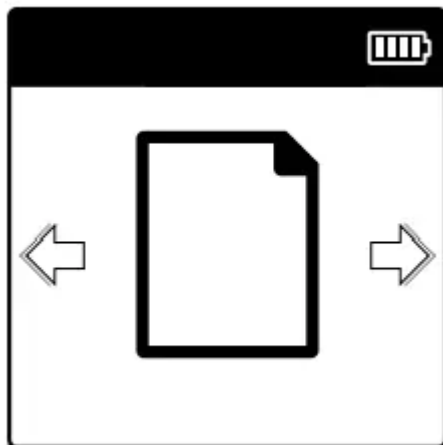

 File menu:

Repeat a file / repeat a sequence

Protecting a recording / lock file

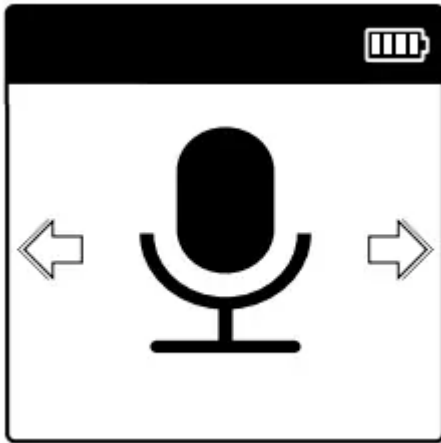

 Recording settings:

- Setting microphone sensitivity
- Setting recording quality
- Setting the timer
- Enabling/disabling voice-activated recording
- Setting auto divide

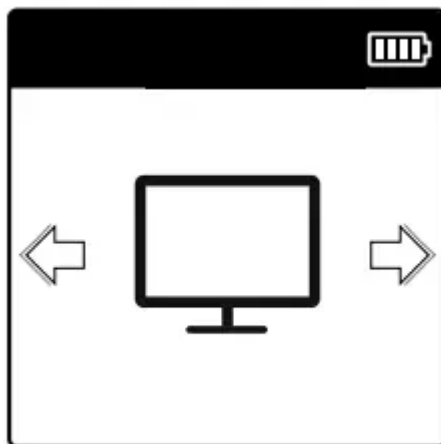

 Display settings:

- Select language
- Adjusting the display contrast
- Enabling/disabling the background light

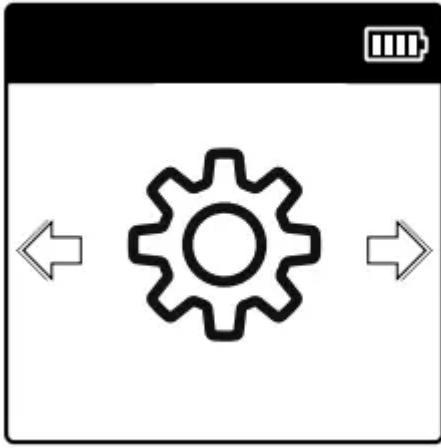

#### Device settings:

Set date & time AUTO-OFF

Memory formatting

Enabling/disabling the record indicator

Enabling/disabling key and signal tones

Set file location

Display device information

Device reset

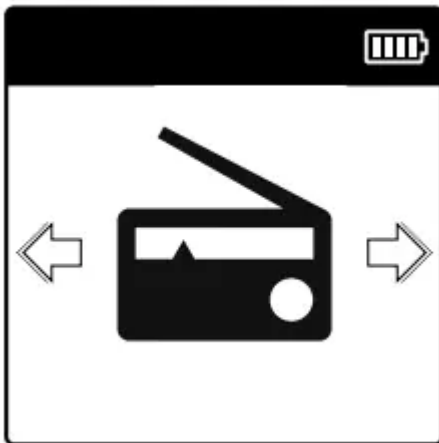

#### Radio settings

Radio mode

Saving a radio station pre-set

## First steps

Use the installation guide on the following pages to start using your device quickly and easily.

### Charging the battery

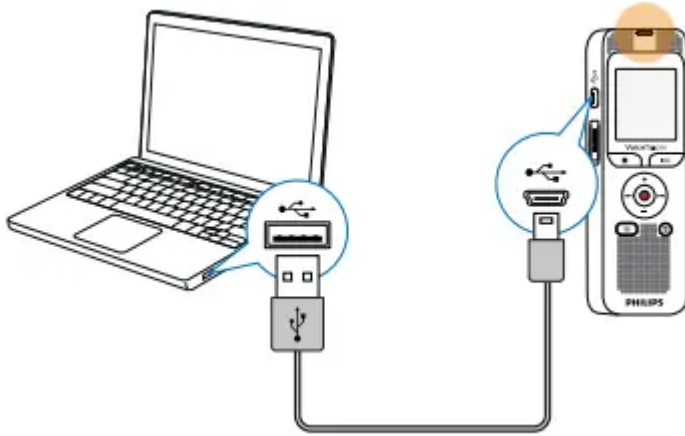

### Power on/off

1. Slide the on/off switch on the side of the device downwards for approximately two seconds. The device turns on and the start-up screen is displayed.

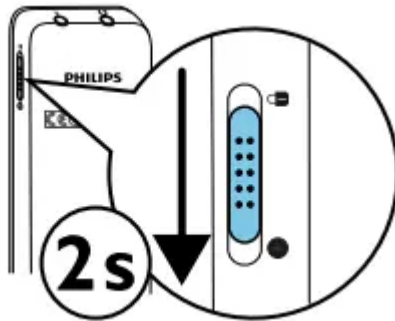

2. To power off, pull down the power switch on the side of the device again and hold for about two seconds.

## Enabling/disabling the keypad lock

The keypad lock deactivates all keys on the device. The timer function of the device continues to function.

1. Slide the on/off switch up into the  position to lock the keypad of the device. The display briefly shows 'Hold'.

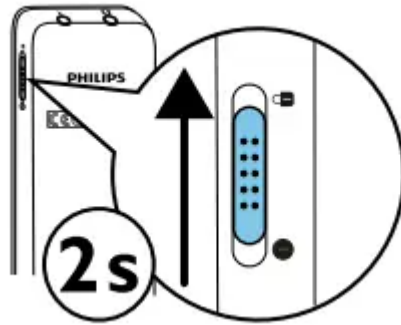

2. Slide the Power on/off switch down to the Off position to disengage the keypad lock.

## Inserting a microSD card

1. Flip the memory card slot cover to the side.
2. Insert the microSD card into the card slot with the contacts facing upwards.

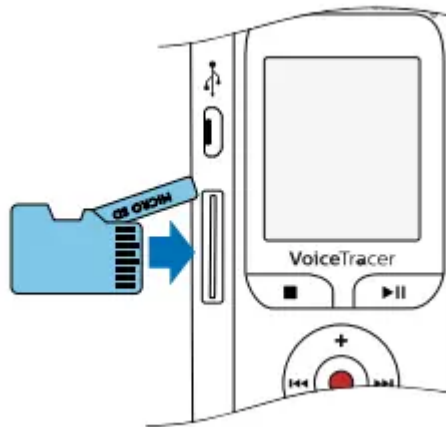

3. Insert the memory card until it snaps into place.
4. To remove the card press the memory card slightly until the snapping mechanism unlocks and the card is ejected.

## Accessories

Depending on the type of the device, the product package may include various accessories. Additional accessories may be obtained directly from your retailer.

## How to connect headphones

1. Turn down the volume of the device before you plug in the headphones.

2. Insert the stereo jack into the headphone connection  on the top of the device.
3. Turn up the volume until you reach a comfortable listening level. The speaker is switched off when headphones are connected.

### Connecting an external microphone

1. Stop the recording currently in progress.
2. Insert the jack into the microphone connection  on the top of the device.

### Connecting to a computer

You can select one of the following options once you have connected the device to a computer

- A USB mass storage device: You can use the File Explorer to access the device data without installing additional software. The device is automatically displayed as a mass storage device. It is a convenient way to store, back up and and move files
1. Plug the USB connector into a USB port on your computer.
  2. Insert the micro USB plug into the USB port on the side of the device. The device is displayed as a mass storage device in File Explorer.

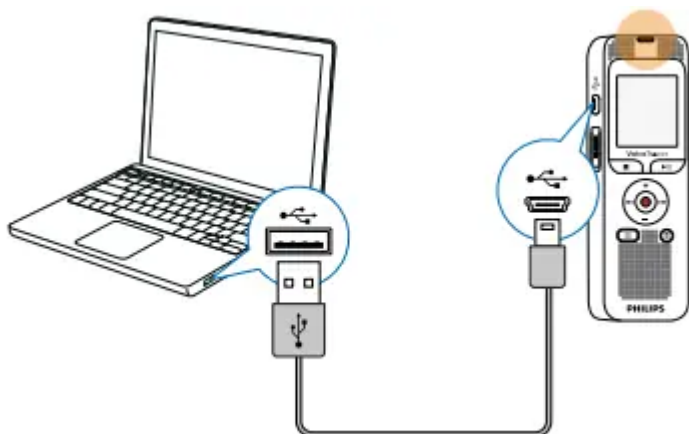

### Transferring files from or to the device

You can use the File Explorer to access the device data without installing additional software. The device is automatically displayed as a mass storage device.

1. Connect the device to the computer as described.
2. Open File Explorer. The device is automatically displayed, similarly to a USB memory stick or card, as a mass storage device. Use the Voice folder for recordings and the Music folder for music files.
3. Copy or move files to your computer or delete files to archive recordings and free up space on the device.





## Disconnecting from a computer

1. Select Eject USB in File Explorer.
2. Disconnect the USB cable from the computer.

## Record

The device offers many features that you can use during recording or to improve the quality of a recording. Use the timer and the voice activation functions to start a recording automatically

### Creating a recording

- Before starting a recording, set the required recording quality and microphone sensitivity.
  - When you record in environments with lots of noise in the background (e.g. while in a crowd or during a train or car journey), you can enable the noise reduction function to reduce the background noise
1. In stop mode (start-up screen), press the  key to select the desired folder for the recording
  2. Point the built-in microphone toward the sound source and press 
  3. Press  to pause recording. The record/play indicator will blink red.
  4. Press the  key to resume recording
  5. Press the  key to stop recording. The device returns to stop mode.

### Recording using an external microphone

- If you connect an external microphone to the device, the recording source will switch automatically and the device's microphone will be turned off.
- If you connect an external microphone, the device will record stereo sound. The integrated microphone only records mono sound.

### Starting recording automatically

- You have two options to start automatic recording: Timer function and voice activation.





#### Use Timer function

You can use this function to start a recording at a specified date and time. The device can record from the device's microphone or an external microphone

- Customize the timer settings in the Settings menu and turn on the feature. The device will start recording at a specified time. The device can be switched off at this time or the keypad can be locked.

#### Use voice activation

When voice-activated recording is enabled, recording will start when you begin speaking. When you stop speaking, the device will automatically pause recording after three seconds of silence, and resume only when you begin speaking again. Use the voice activation level to set the volume at which the device should begin recording

1. Customize the voice-activated recording settings in the Settings menu and turn on the feature. If this feature is on, the  symbol is displayed.
2. Press the  key. The device switches to standby mode. The () symbol will be displayed. Recording will start when you begin speaking. When you stop speaking, the device will automatically pause recording after three seconds of silence.
3. Press the  key to stop recording. The device returns to stop mode.

## Troubleshooting

The device does not turn on

- The built-in battery is empty. Recharge the battery.

The device does not playback recordings

- The keypad lock may be enabled. Slide the on/off switch to the "Off" position.
- No recordings are saved in the device.

The microSD card cannot be selected as a recording location

- There is no memory card in the device. Insert a memory card into the device.
- The memory card is not formatted (file system FAT32). Format the memory card in the device.

I cannot hear anything from the speaker.

- A headset is connected to the device.
- The volume is at the lowest setting

The recording session does not start

- Pre-recording or voice-activated recording mode may be enabled.
- The keypad lock may be enabled. Slide the on/off switch to the "Off" position.
- The maximum number of recordings may have been reached or the available space for recording is full. Delete some recordings or move them to an external device. Select another location folder

I cannot hear anything from the headphones.

- The headphones are incorrectly connected. Check the headphone connection.

- The volume is at the lowest setting.

External microphone records mono sound only

- Switch the external sound source to stereo microphone.

## Appendix

The information in this user manual has been produced to the best of our knowledge. It (particularly the technical data) may be modified or updated at any time without prior notice.

### Technical data

Technical data	
Dimensions (W×H×D)	37 × 108 × 14 mm
Weight	55 g
Batteries	Rechargeable built-in Li-ion battery
USB connection	High-speed 2.0, Micro-USB
USB input	USB 5 V/DC, 500 mA
Microphone connection	Stereo jack, 3.5 mm
Headset connection	Stereo jack, 3.5 mm
Display	23 × 23 mm Resolution: 112 × 112 pixels

## Technical data

Internal memory	NAND-Flash, 8 GB
Memory card	microSD card up to 32 GB SDHC optimized for class 6 or higher
Recording format	PCM – WAV, 1,536 kbits/s HQ – MP3, 128 kbits/s SP – MP3, 64 kbits/s LP – MP3, 8 kbits/s
Music playback	MP3, WMA Bit rate: 8 – 320 kbps no DRM
Speaker	Frequency range: 750 – 18,000 Hz Output: 110 mW
Recording time Internal storage	PCM – 12 h HQ – 148 h SP – 297 h LP – 2370 h
Battery life	>50 h

## Technical data

Sampling rate	PCM – 48 kHz HQ – 32 kHz SP – 16 kHz LP – 8 kHz
---------------	----------------------------------------------------------

Radio	FM stereo Frequency range: 87.5 – 108 MHz Memory capacity: 20 radio stations
-------	------------------------------------------------------------------------------------

System requirements	Operating system: Windows 8, 7, Vista, XP (32-bit, SP2), MacOS X 10.8, Linux
---------------------	------------------------------------------------------------------------------

Temperature	5 °C – 45 °C / 41 °F – 113 °F
-------------	-------------------------------

Humidity	10% – 90%
----------	-----------

### Warning

This content is compiled from multiple sources and is provided for reference purposes only. It may not be complete or fully applicable to all situations. If you are unable to resolve your issue, please contact the product manufacturer or an authorized service provider for official support.