

## COMPONENTS

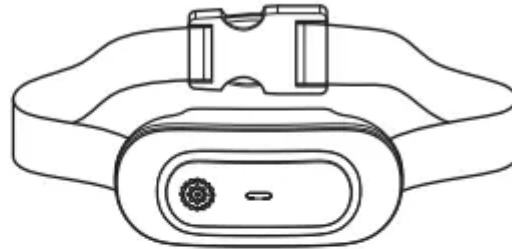

1 Handheld Remote



2 Receiver

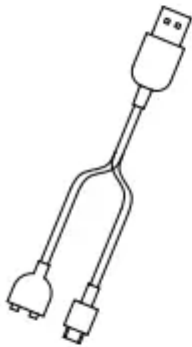

4 Charging Cable



5 Wrist Strap



6 User Manual

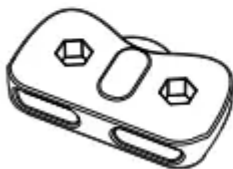

7 Test Light Tool



8 Long Contact Points



9 Silicone Caps

# OVERVIEW

## Handheld Remote

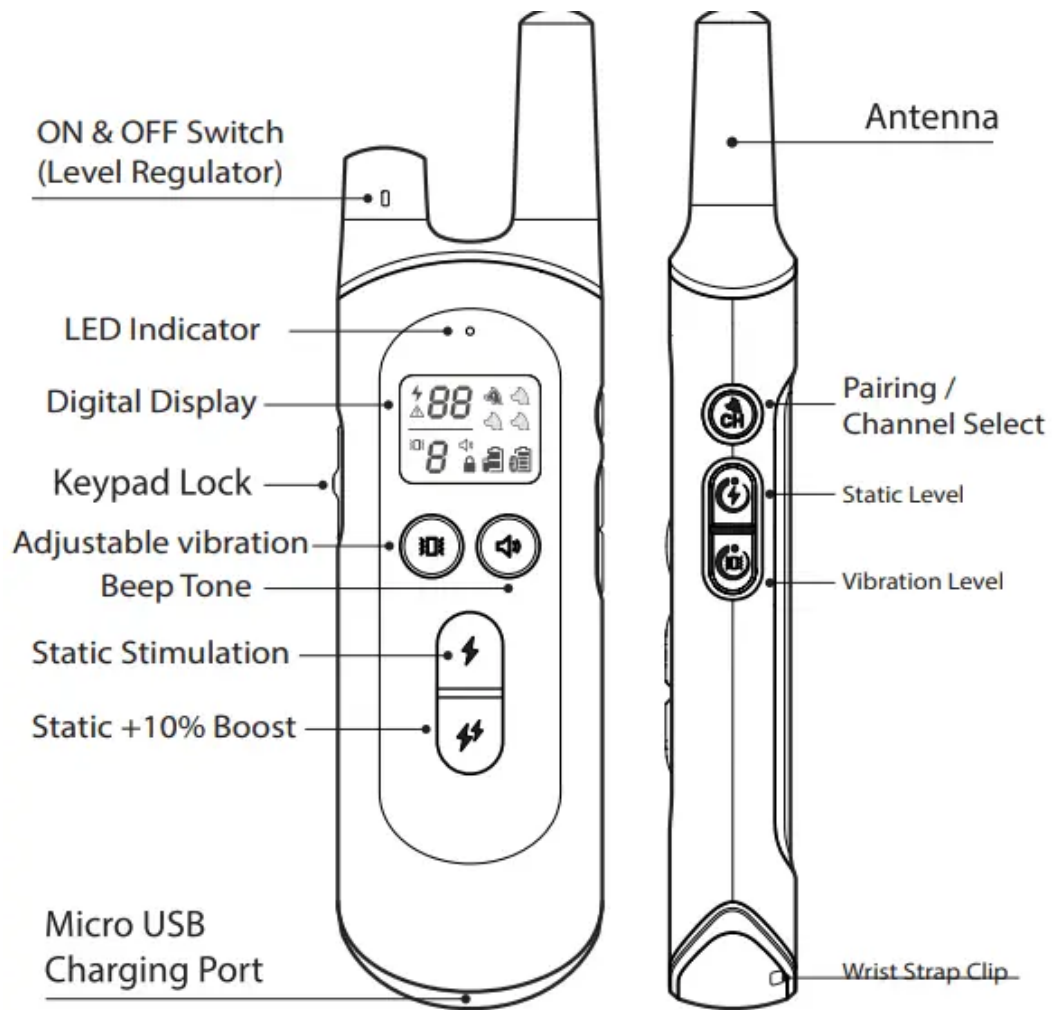

## Screen

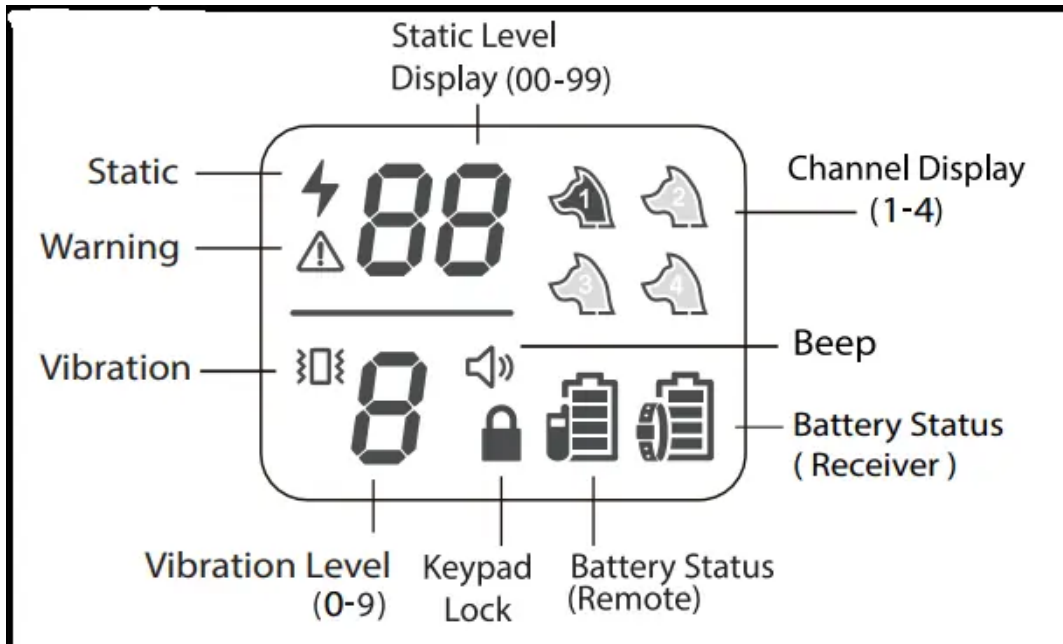

## Receiver

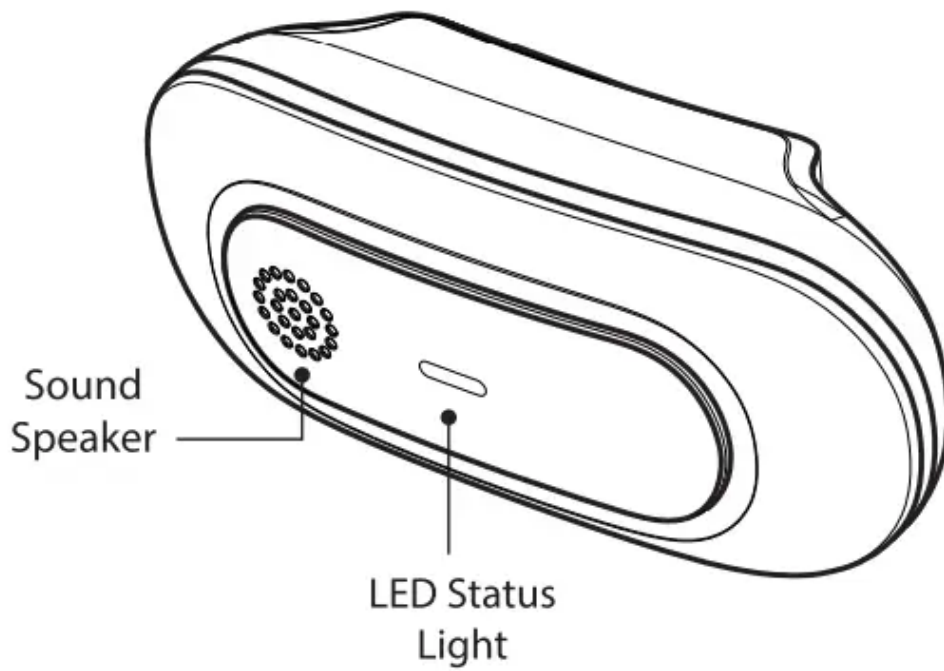

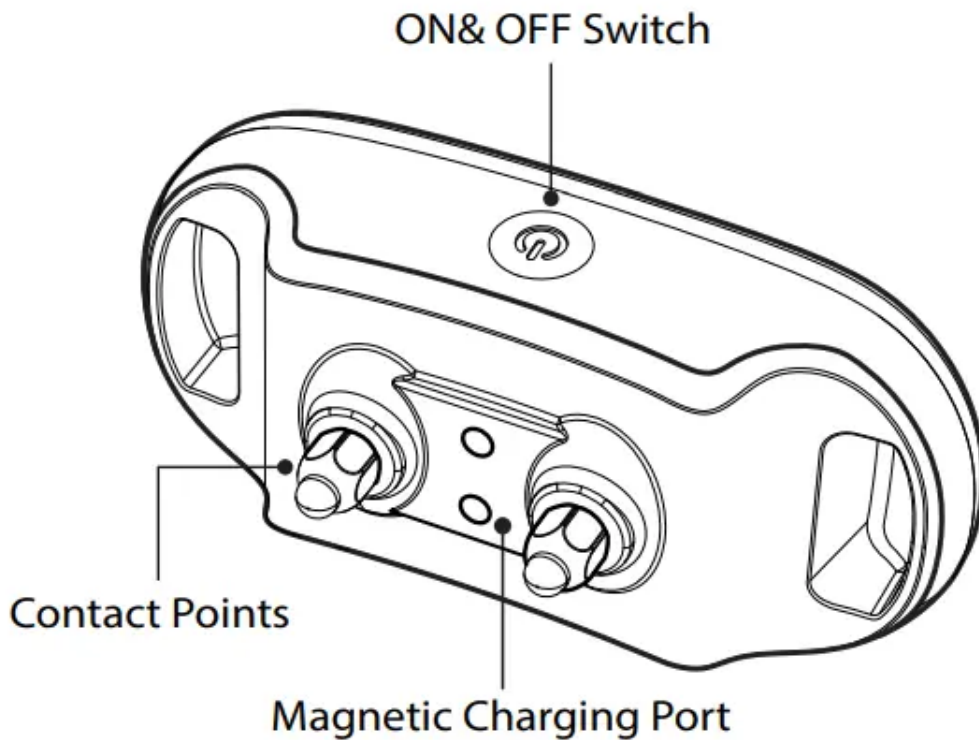

## Important Safety Information

This is the safety alert symbol. It is used to alert you to potential injury hazards. Obey all safety messages that follow this symbol to avoid possible injury.

### WARNING

**WARNING** indicates a hazardous situation which, if not avoided, could result in serious injury.

Not for use with aggressive dogs. Do not use this product if your dog is prone to aggressive behavior. Aggressive dogs can cause severe injury to their owners and others. If you are not sure that this product is right for your dog, please talk to your veterinarian or a certified trainer.

### CAUTION

CAUTION, used with the safety alert symbol, indicates a hazardous situation, which, if not avoided could result in minor or moderate injury.

- Safety during on-leash training. It is vitally important that you and your dog remain safe while learning during on-leash training. Your dog should be on a strong leash, long enough for him to attempt to chase an object, but short enough for him not to reach a road or other unsafe area. You must also be physically strong enough to restrain your dog when he tries to chase.
- This pet training device is not a toy, keep away from children.

## CAUTION

CAUTION, used without the safety alert symbol, indicates a hazardous situation, which, if not avoided, could result in harm to your pet.

Risk of skin damage. Please read and follow the instructions in this manual. Proper fit of the collar is important. A collar worn for too long or made too tight on the pet's neck may cause skin damage. Ranging from redness to pressure ulcers; this condition is commonly known as bed sores.

- Avoid leaving the collar on the dog for more than 12 hours per day. Possible reposition the collar on the pet's neck every 1 to 3 hours.
- Check the fit to prevent excessive pressure; follow the instructions in this manual.
- Never connect a leash to the electronic collar; it will cause excessive pressure on the contact points.
- When using a separate collar for a leash, don't put pressure on the electronic collar.
- Wash the dog's neck area and the contacts of the collar weekly with a damp cloth.
- Check the contact area daily for signs of a rash or a sore.
- If a rash or sore is found, discontinue use of the collar until the skin has healed. If the condition persists beyond 48 hours, see your veterinarian.

## 1. Charge the Collar and Remote

When charging is completed, the green light will appear.

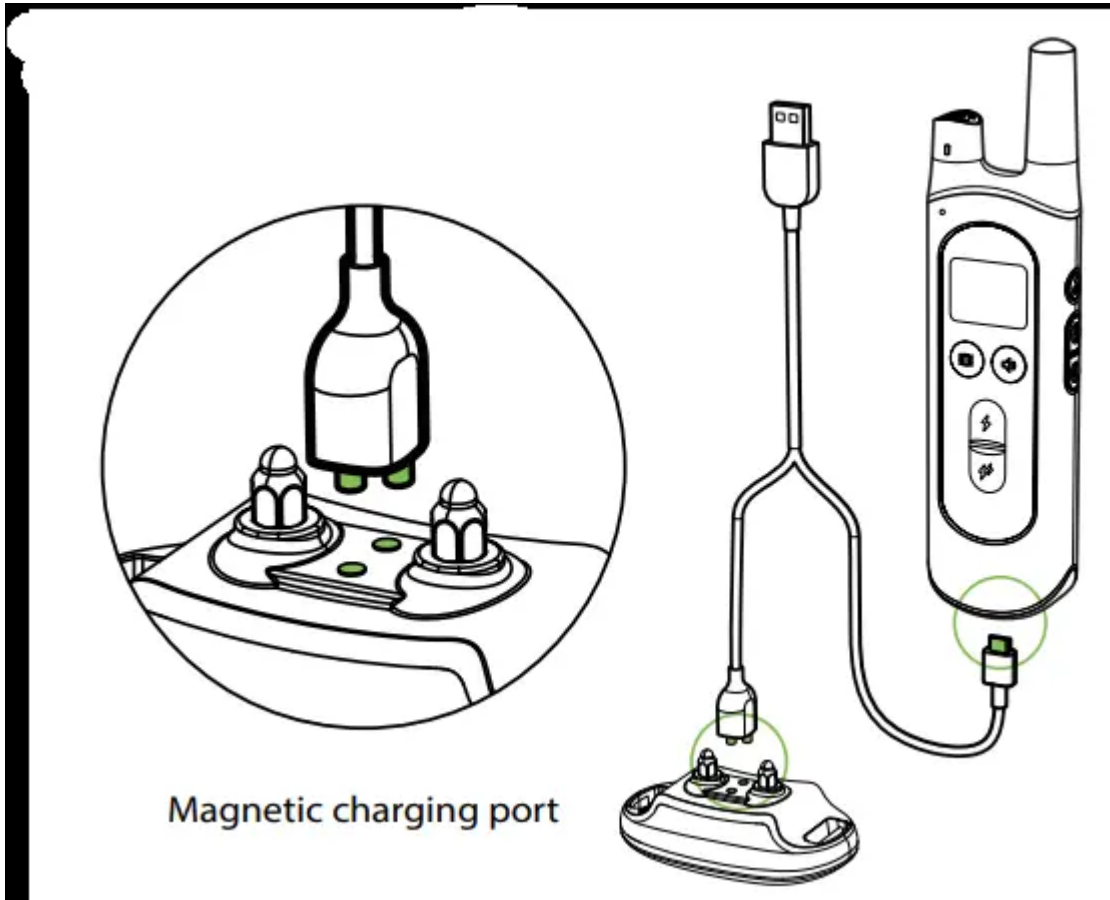

## 2. Fit the Receiver Collar

**Note:** The Contact Points must have direct contact with Dog's skin on the underside of neck. Check the tightness of the Collar by inserting one finger snugly between the collar and neck.

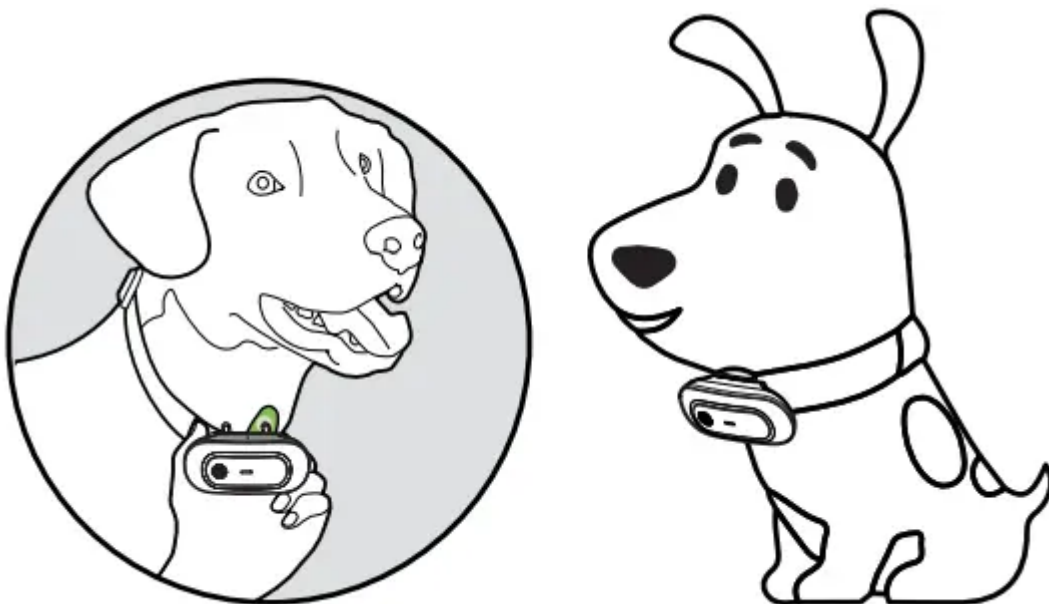

### 3. To turn the Remote and Receiver on

When not using the collar, turn it off to increase the battery life. Long press the button 3 secs to turn off the Receiver.

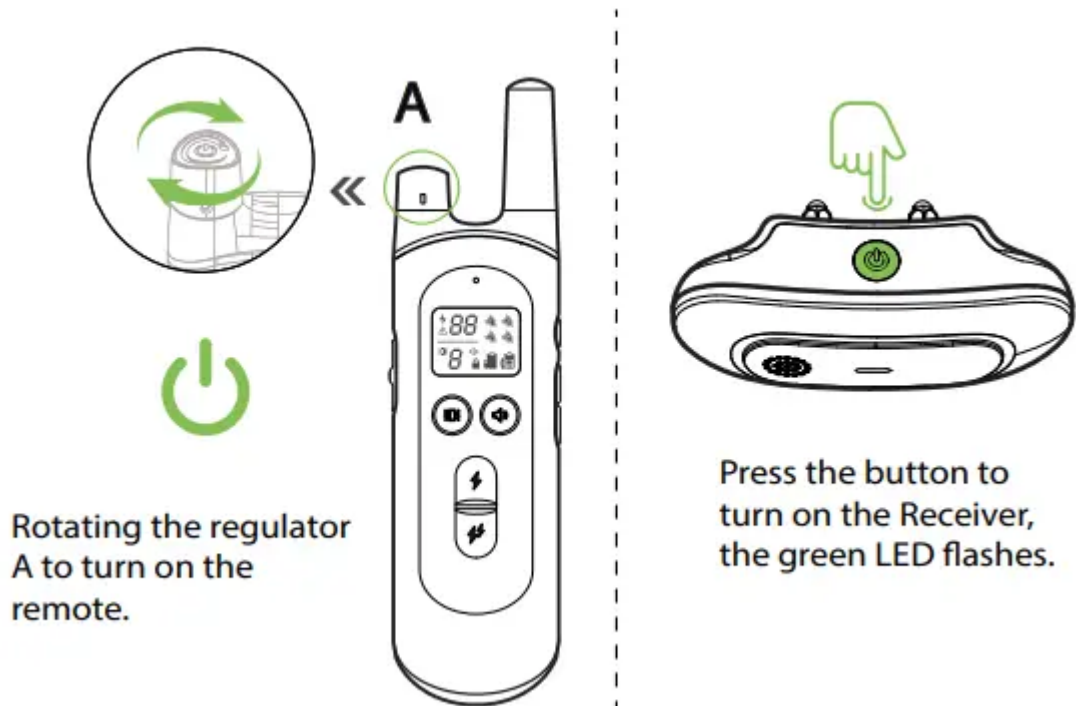

#### 4. Keypad Lock

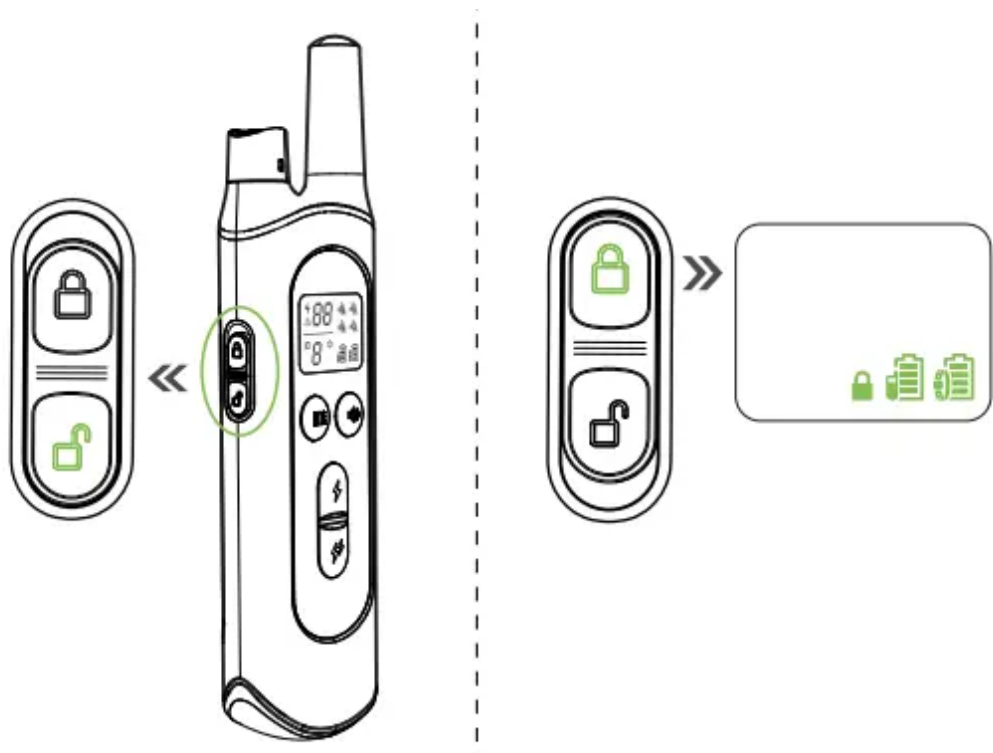

Security Keypad: lock or unlock

#### 5. Beep Tone command

Delivers a beep tone with non-adjustable volume to the collar.

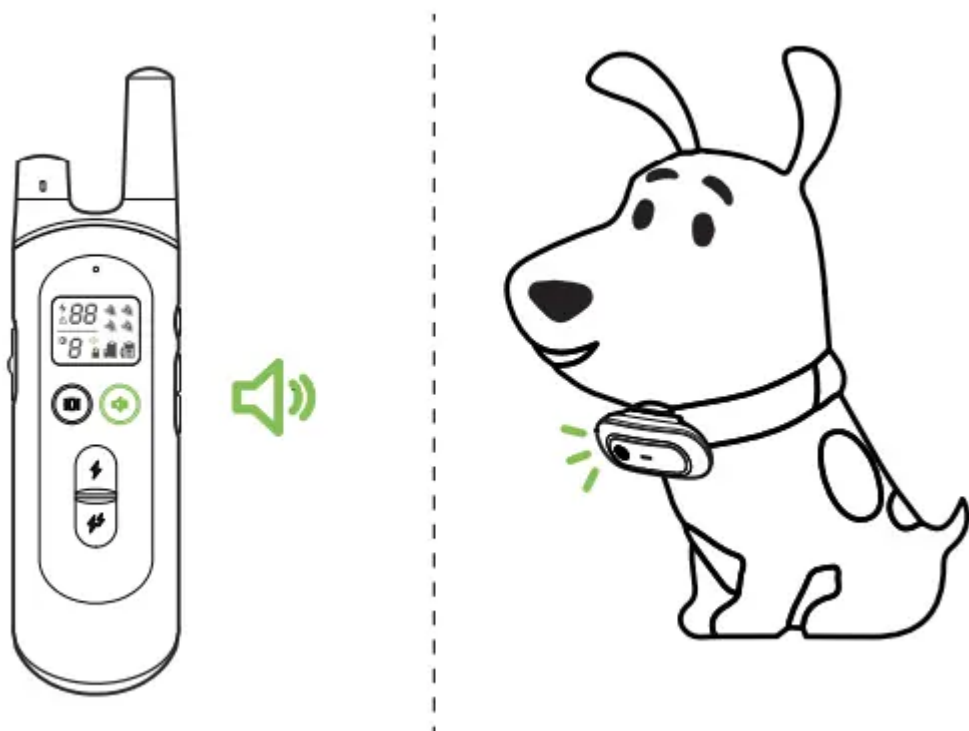

## 6. Vibration command

Delivers vibration to the collar. Vibration Intensity adjustment: Press and hold the vibration Level button B, at the same time, rotating the level regulator A of the remote.

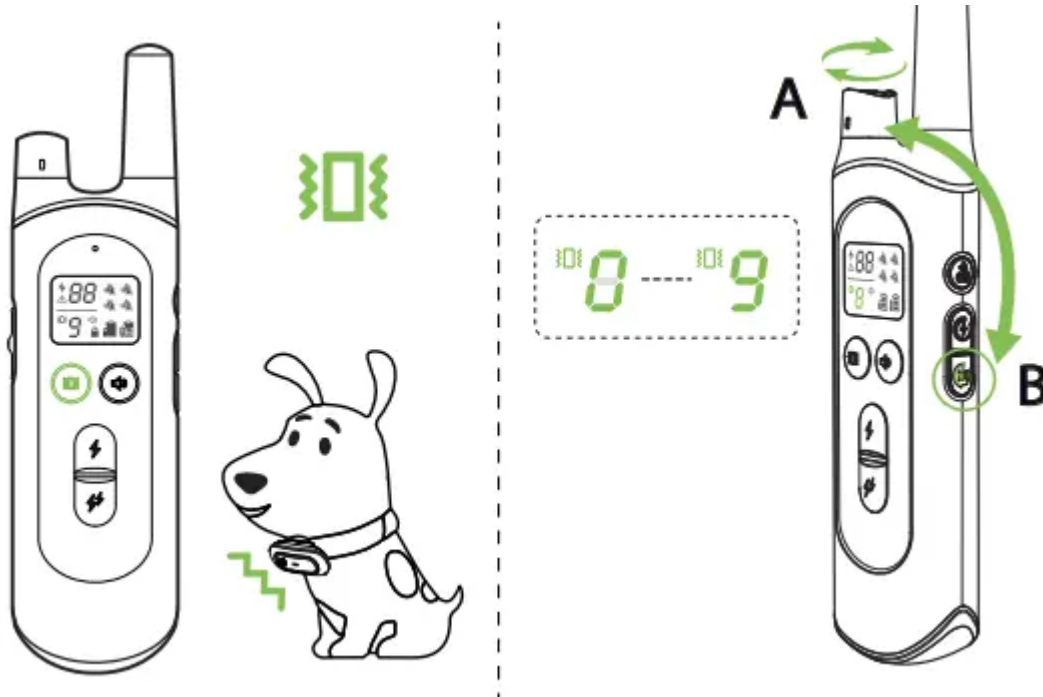

## 7. Static Stimulation command

- Static button: Delivers currently selected level Static stimulation to the collar.
- Static + button: That is 10% higher than the currently selected level. Some consumers would like to instant access to a higher setting where the dog may not respond to lower levels.

- Static Intensity adjustment: Press and hold the static Level button C, at the same time, rotating the level regulator A of the remote.

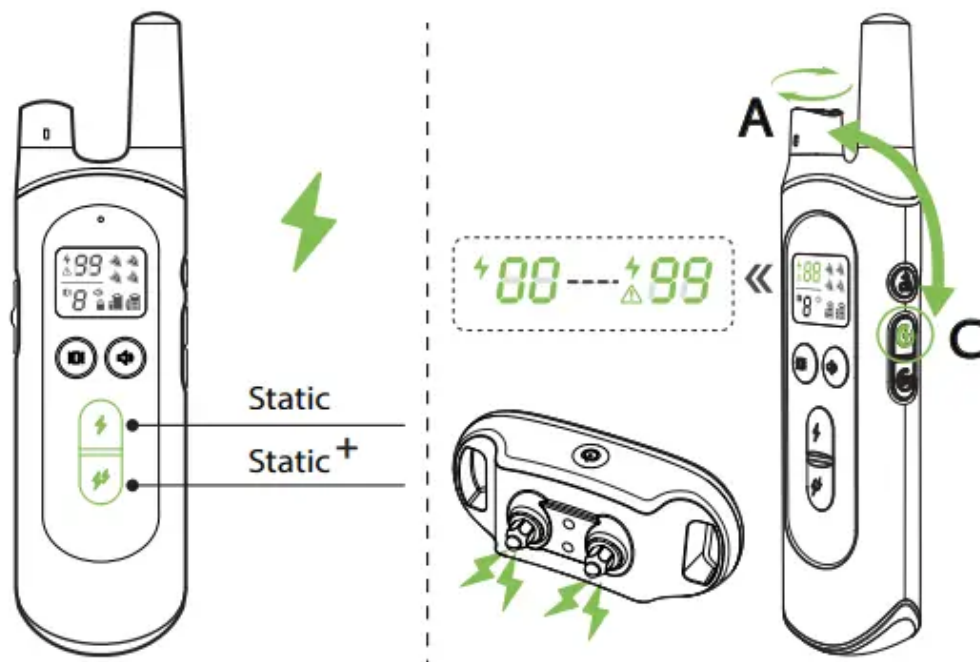

## How to find the Best Static Level for Your Dog ?

Very Important: Always start at the lowest level and choose the level that is best for your dog. Have 1 to 99 different Stimulation Levels. Follow the steps below to find the best Level:

- Step 1: Starting at Level 10 on the Digital Display, press the static button to see dog's reaction.
- Step 2: Move up through the Stimulation levels until your pet reliably responds to the Stimulation.
- Step 3: If your dog continues to show no response at Level 50, check the fit of the Receiver Collar. If your dog has long or thick hair, change to a longer set of Contact Points, or dog's hair will need to be trimmed around the Contact Points.
- If all of these steps have been done and dog continues to show no reaction, see the "How to Use Test Light Tool" section.

## Main Features



Vibration, Tone and Static training model



9 adjustable vibration level and 99 adjustable static level



Dual batteries status display for Remote and Receiver



Receiver collar IPX7 waterproof (Remote non-waterproof)



Remote range 1000-1600 feet



Long life Lithium Polymer battery



Big digital display



Support maximum 4 receiver collars with one remote



Magnetic charging port

## How to Use Test Light Tool

### A: Static function test

1. Make sure the Remote and Receiver Collar on.
2. Hold the Test Light tool contacts to the Contact Points.
3. Press a Static button on the Remote Transmitter. The Test Light will be lighted.

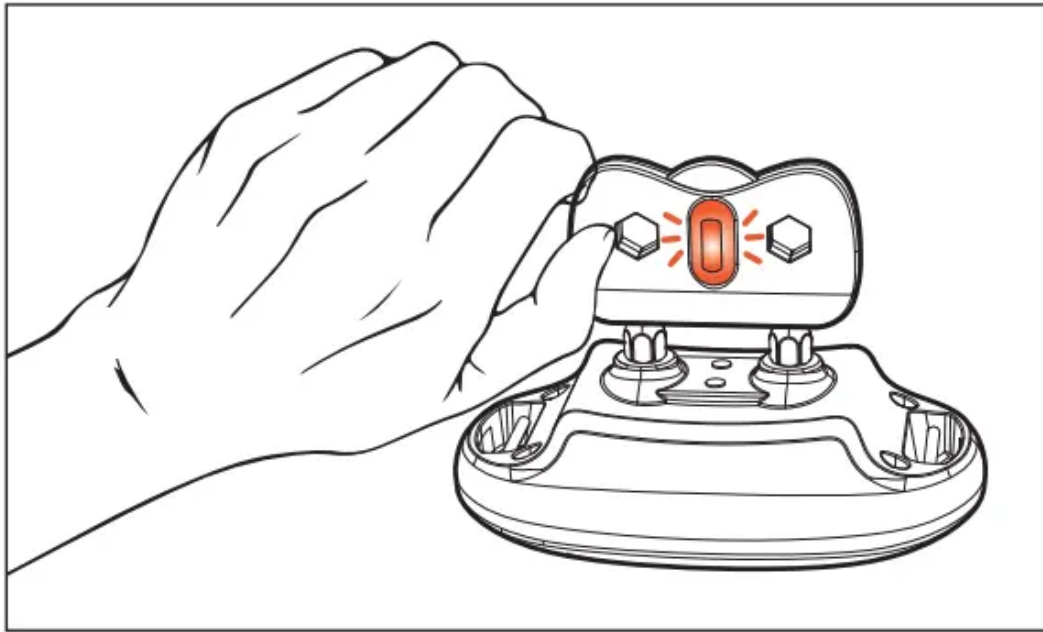

B: As a tool to tighten or loosen the contact points

For dog with shorter coats, use 2pcs shorter contact point. Or install the conductive Silicone onto the contact point to make it softer. It may better to your dog's skin.

For dog with thicker coats, use 2pcs longer contact points. Or install the conductive Silicone.

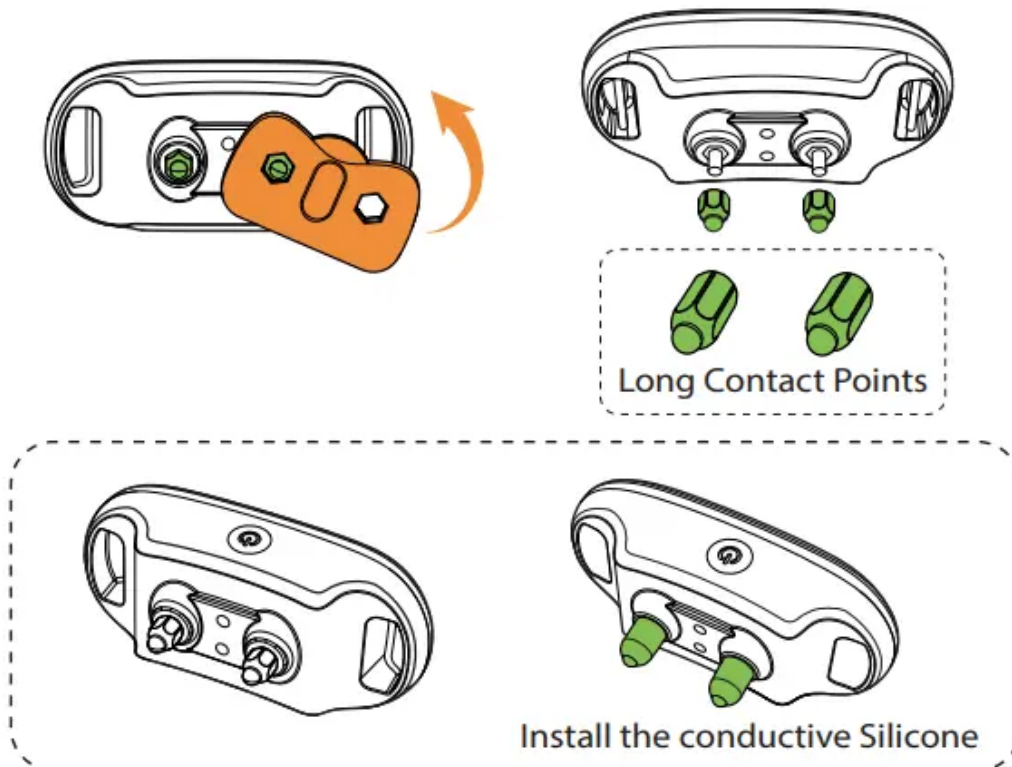

## Training Tips

If you want to eliminate unwanted behavior – For examples barking. Please follow these training steps.

1. Put a separate non-metallic collar on your dog's neck above the Receiver Collar, and attach a 8-10 foot leash. (Note: Be sure the extra collar does not put pressure on the Contact Points.)
2. Hold the leash and the Remote Transmitter
3. Choose your pet's Recognition Level.
4. As soon as your pet is barking, press the Stimulation button and give the command "No" or "No barking."
5. Release the Stimulation button immediately once your dog stop barking, and verbally praise him.
6. If your pet ignores the stimulation, increase the Intensity Level by 3 to 5.
7. Practice this exercise in several different areas.

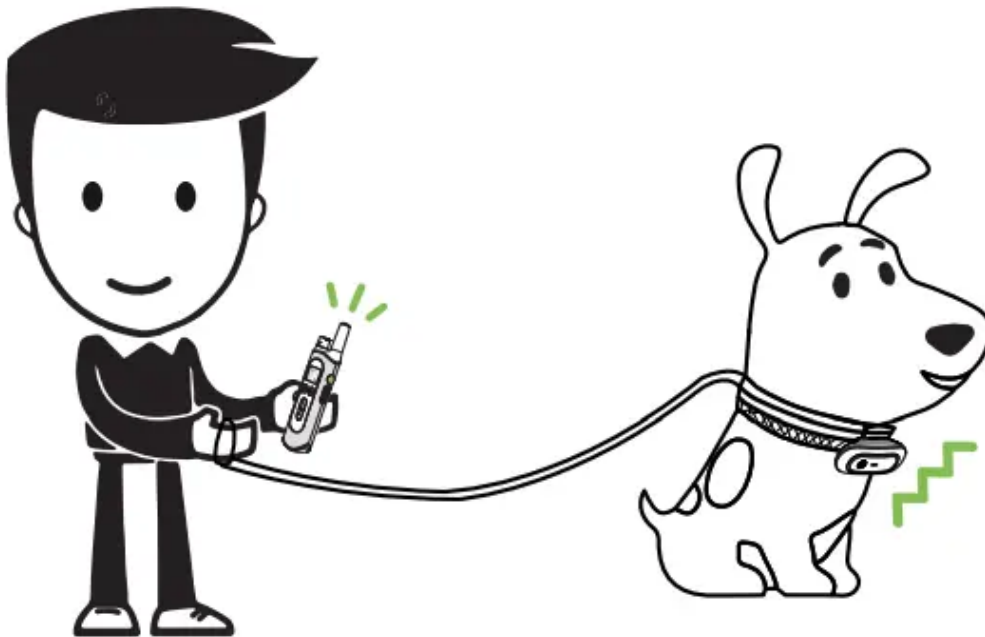

## Pairing

( Notes : You may skip this step because the set is already paired by factory setting. )

1. Make sure the Receiver is turned off.

2. Press and hold Switch for 5 secs until the green light is flashing fast.

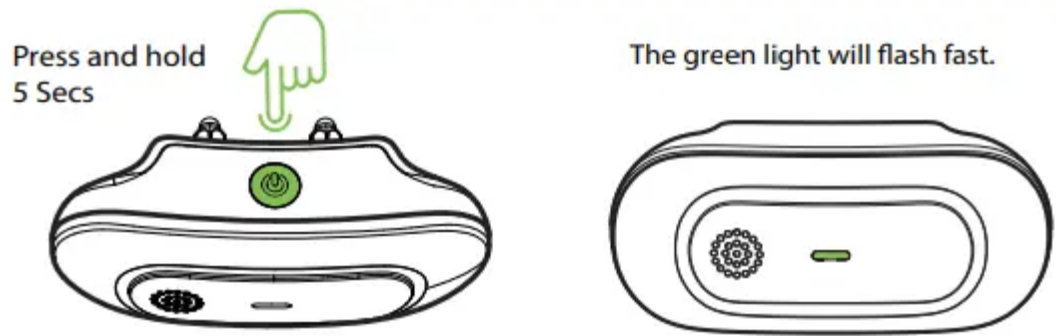

3. Press the remote Pairing/Channel Select button D to pairing the receiver.

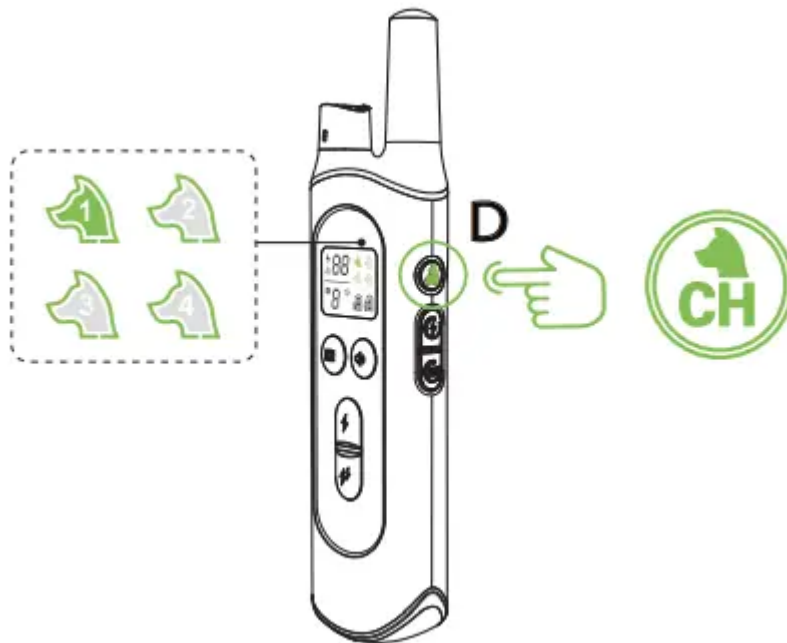

4. Pairing successful: the receiver will beep and the green light flash slowly.



## Two,Three, Four Receiver System

( Note: Please skip this step if you only use one receiver. This setting only for multiple receiver with one remote. )

### Part I : Pairing 2nd , 3rd, or 4th Receiver.

( Note : You should buy an additional receiver collar. )

- Receiver :
  1. Make sure the Receiver is turned off.
  2. Press and hold Switch for 5 secs until the green light flashes fast.
- Remote:
  3. Press and hold channel button D, at the same time, rotating the level regulator A to select the dog icon. (For examples Dog 2, the Dog2 icon will flash.)
  4. Press the remote Pairing/Channel Select button D to paring the receiver

### Part II : Receiver Switching:

- Able to train 4 dogs at the same time.
- Press and hold channel button D, at the same time, rotating the level regulator A to select the dog to train.

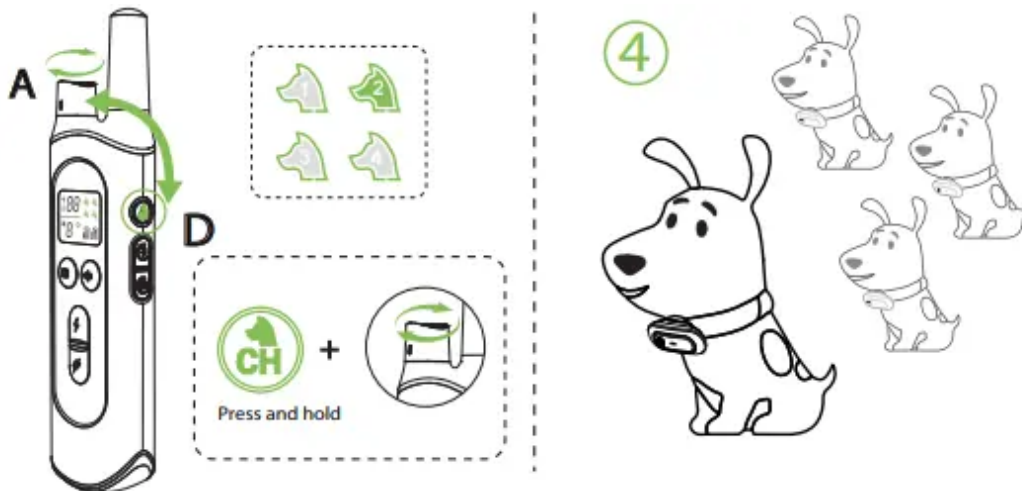

### Part III : Reset all paired receiver collar.

- Make sure the remote is "ON" .
- Press and hold Static level button C and Vibration level button B, at the same time, turning the regulator switch A OFF to ON. All paired receiver will be removed and the dog 1 icon will flash.
- Pairing the receiver again.

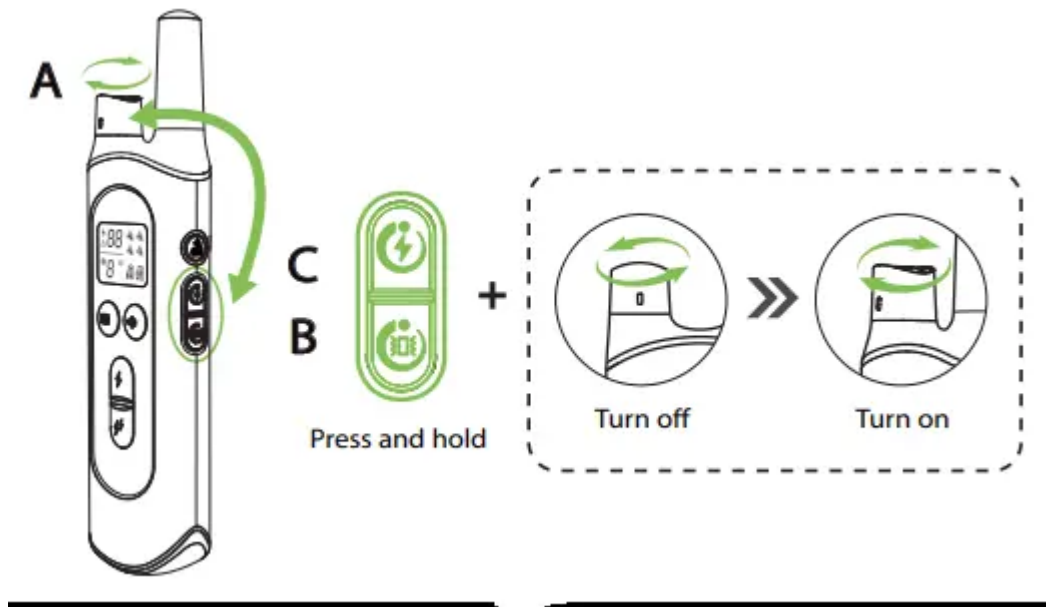

## Question & Answer

How to change the longer prongs for this collar? I don't think they are getting through my Labs thick hair.

Answer: Just part the hair or trim it a bit. I have a dog with very thick neck of hair. I parted it with my hands . Just be sure remote is off then start on low setting and work your way up. If no response repeat steps of working prongs thru hair remember to turn off or lock remote.

## Troubleshooting

### 1. My pet is not responding when I press a beep vibration or static button.

- Check the Receiver Collar if it is On.
- Please check to see if the battery is low in either the Remote Transmitter or Receiver Collar.
- Verify the Receiver Collar is delivering Stimulation to your pet by placing the Test Light, enclosed in your kit, on the Receiver Collar.
- Increase the correction level. Refer to “Find the Best Stimulation Level For Your dog” .
- Make sure the Receiver Collar’s Contact Points are placed snugly against your pet’s skin.

### 2. The Receiver Collar will not turn on.

- Make sure the Receiver Collar has been charged.

### 3. The Receiver Collar is not responding to the Remote Transmitter.

- Verify the Receiver Collar has been turned on.

**Warning**

This content is compiled from multiple sources and is provided for reference purposes only. It may not be complete or fully applicable to all situations. If you are unable to resolve your issue, please contact the product manufacturer or an authorized service provider for official support.

---

Document generated by [ManualsFile](#)