

PACKAGE CONTENTS

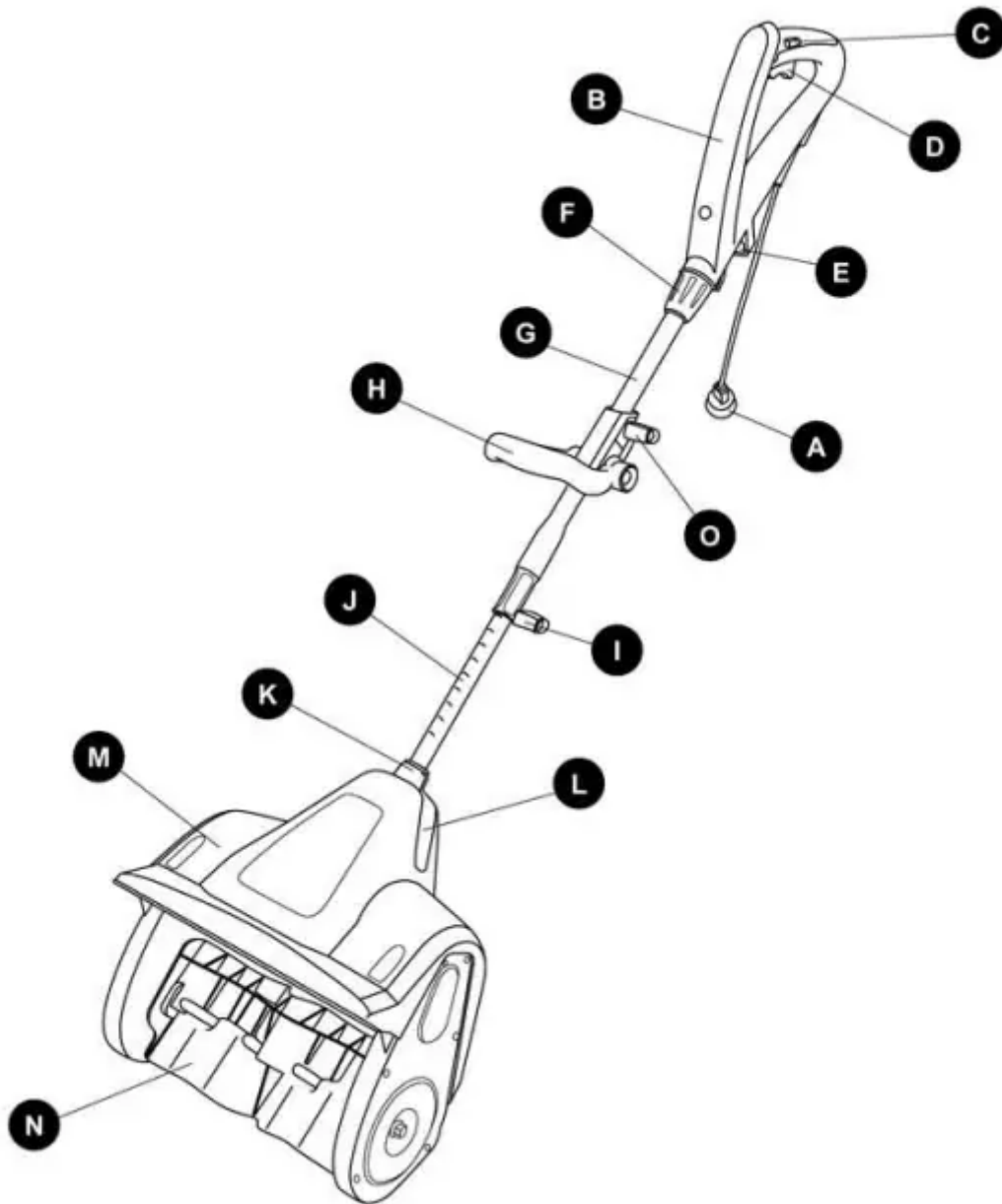

- A. Polarized plug
- B. Main handle
- C. Switch button
- D. Trigger
- E. Cord lock
- F. Handle fastener
- G. Main pole

- H. Auxiliary handle
- I. Joint fixing knob
- J. Telescopic pole
- K. Opening
- L. Groove
- M. Main cover
- N. Auger
- O. Auxiliary handle knob

HARDWARE CONTENTS

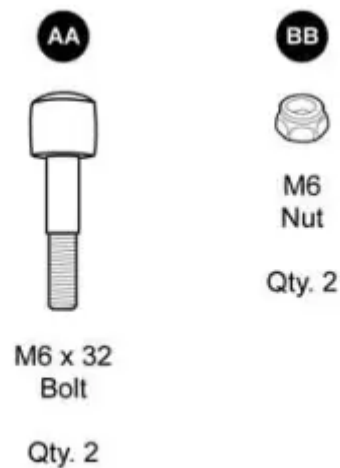

SAFETY

Please read and understand this entire manual before attempting to assemble, operate or install the product.

Work Area

- Keep work area clean and well-lit. Cluttered, dark areas invite accidents.
- Do not operate snow thrower in an explosive atmosphere, such as in the presence of flammable liquids, gases, or dust. Electrical appliances create sparks that may ignite the dust or fumes.
- Keep children, pets, and bystanders away from work area. Be aware that the normal noise of the machine when turned on may make it difficult for you to hear approaching people.

Electrical Safety

- Electrical plugs must match the outlet. Never modify the plug in any way. Do not use any adaptor plugs with grounded appliances. Unmodified plugs and matching outlets will reduce risk of electric shock.
- Avoid body contact with earthed or grounded surfaces such as pipes, radiators, ranges, and refrigerators. There is an increased risk of electric shock if your body is earthed or grounded.
- Do not abuse the cord. Keep cord away from heat, oil, sharp edges or moving parts. Damaged or entangled cords increase the risk of electric shock. Never carry the snow thrower by its cord or yank the cord to disconnect it from the electrical outlet.
- Replace or properly repair damaged cords. If cord is damaged in any manner while plugged in, pull the extension cord from the wall receptacle.
- Contact with water while operating the snow thrower can result in electric shock and serious bodily injury. Do not use the snow thrower in damp or wet locations or expose to rain. Do not handle the plug or the appliance with wet hands or while standing in water.
- Extension Cord - WARNING - Only use a UL-rated extension cord for OUTDOOR, all-weather use (usually orange color). To prevent the extension cord from disconnecting during operation, tie it around the top right side of the middle frame before connecting it to the snow thrower as shown in Figure 2 on page 12.
- Turn off the power switch and disconnect the power cable before inspecting, servicing, repairing, or cleaning the snow thrower. Any such operation should be performed after revolving parts inside the snow thrower stop completely.
- Do not move or transport the snow thrower when the plug is connected to the power socket and the switch is turned on.

Personal Safety

- Stay alert - Watch what you are doing and use common sense when operating the snow thrower. Do not use the machine when tired, ill, or under the influence of drugs, alcohol, or medication. A moment of inattention may result in serious personal injury.
- Wear proper clothing - Wearing rubber boots offers additional protection from electric shock. Do not wear loose clothing or jewelry that may become caught in the machine. Wear protective headgear to keep hair away from revolving parts of the machine. Safety glasses offer better protection than everyday eyeglasses.
- Moving parts present risks - Keep your face, hair, clothing, hands and feet away from moving parts. All guards and safety attachments must be installed properly before using the unit. Shut off and disconnect cord before touching any parts other than the handles and switch.

- Surfaces - This snow thrower is intended for use on paved surfaces. Do not use on gravel, stone, or other unpaved surfaces unless the snow thrower is adjusted for such surfaces according to the instructions given in the operator's manual.
- Avoid accidental starting - Make sure the switch is in the off position before plugging in the unit. Do not carry the snow thrower with your finger on the switch.
- Body position - Maintain proper footing and balance at all times. Place heels firmly on the ground and tightly grasp the handle bar. Watch for uneven surfaces and do not overreach. In case you fall or collide with the snow thrower, inspect the unit for damage. When stepping backwards, be careful to avoid obstacles beneath your feet or behind you to avoid falling.

Snow thrower Use and Care

- Know your snow thrower - Familiarize yourself with the main parts of your snow thrower.

Read the operator's manual carefully. Learn your snow thrower's applications and limitations as well as the specific potential hazards related to this machine. Do not use this machine for any purpose other than the one for which it was designed. Otherwise, it may cause mechanical defaults, serious damage or personal injury.

- Preliminary unit inspection - Thoroughly inspect the unit before use. Make sure all the parts are secure and installed correctly. If you notice any abnormalities, do not use the machine until it has been properly repaired. Always perform a test run the first time you use the snow thrower or after replacing parts to ensure that the unit is functioning properly.
- Preliminary area inspection - Clear the area to be plowed before each use. Remove all objects such as rocks, broken glass, nails, wire, or string, which can be thrown by or become entangled in the snow thrower. Keep the area of operation clear of other people and pets.
- Excessive force - The snow thrower was designed to respond at a certain rate for various snow conditions for optimum safety and performance. Do not force it; keep pressure constant.
- Malfunctioning switch - Do not use the snow thrower if the switch does not turn it on and off. Any electrical appliance that cannot be controlled by the switch is not safe to use and must be repaired.
- Hitting an object - If the snow thrower accidentally strikes an object, stop the snow thrower; inspect for damage; repair or replace any damaged part before restarting and operating the snow thrower.
- Discharge chute safety - Never direct the snow discharge chute at the operator, at bystanders, at vehicles or at windows. Thrown snow and foreign objects accidentally picked up by the snow thrower can cause serious damage and personal injury. Do not use your hands to unclog the discharge chute. Stop the motor before removing debris.

- **Abnormal operation** - If you notice the snow thrower running in an unstable state or hear abnormal sounds from the engine, stop the machine, disconnect the power immediately, and contact your original distributor.
- **Noise control** - When using the snow thrower, you must respect local laws and regulations regarding noise control and environmental protection. To avoid noise disturbance, you should carefully decide upon an appropriate operation time and consider the surrounding conditions.
- **When work is completed** - Disconnect the snow thrower from the power source when not in use, when changing accessories, and before performing any maintenance.
- **Store safely** - Store snow thrower indoors in a dry area between uses. Keep in a locked area where children and unauthorized users cannot gain access. Do not store the machine while it is still connected to the power source. It may cause damage and injury.
- **Maintain for safety and longevity** - Check for misalignment or binding of moving parts, breakage of parts, and any other conditions that may affect the unit's operation. If damaged, repair or replace the damaged part before use. Use only those replacement parts made for your model. When replacing any parts, you must strictly observe the instructions and procedures described in this manual. Special care should be paid to any rubber parts, since these parts may increase the engine load and decrease its mechanical power if damaged.

PRODUCT LABELS

WARNING - Read, understand and follow all safety labels and markings on the unit.



CAUTION

- Inspect wiring, which, if damaged during shipping, may cause serious bodily injury during equipment use. If any damage is seen or suspected, do not assemble. Instead, contact our customer service department at 1-800-791-9458.
- Handle with care during assembly so that electrical wiring does not become damaged.

ASSEMBLY

1. Loosen the knob (I) on the main pole (G).

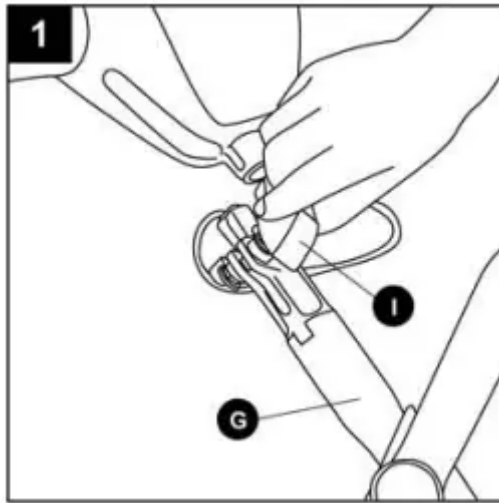

2. Hold the main pole (G) with one hand and pull the telescopic pole (J) out with the other hand until the two holes on the telescopic pole (J) are exposed.

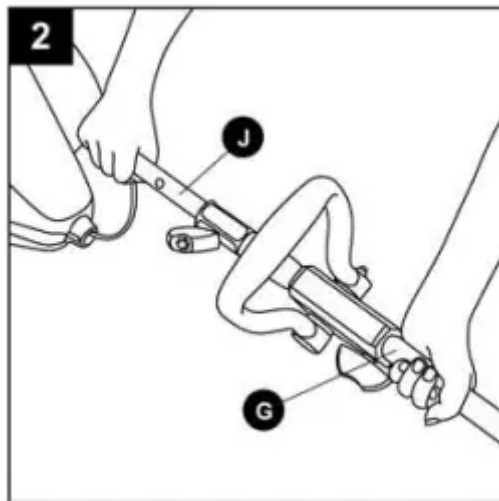

3. Remove the nut (BB) and bolt (AA) on the telescopic pole (J) with a screwdriver.

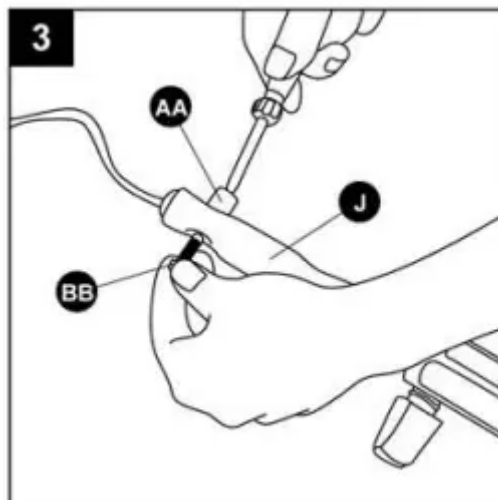

Hardware Used

AA	M6 x 32 Bolt		x 1
BB	M6 Nut		x 1

4. Remove the bolt (AA) and nut (BB) from the plastic bushing with a screwdriver.

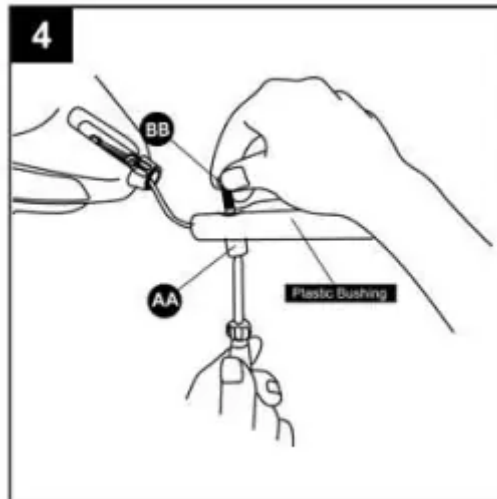

AA	M6 x 32 Bolt		x 1
BB	M6 Nut		x 1

5. Locate the slot on the telescopic pole (J) and align it with the track at the opening (K) of the main cover (M). Insert the pole and plastic bushing into the opening (K), making sure that the tab inside the opening is inserted into the hole on the pole.

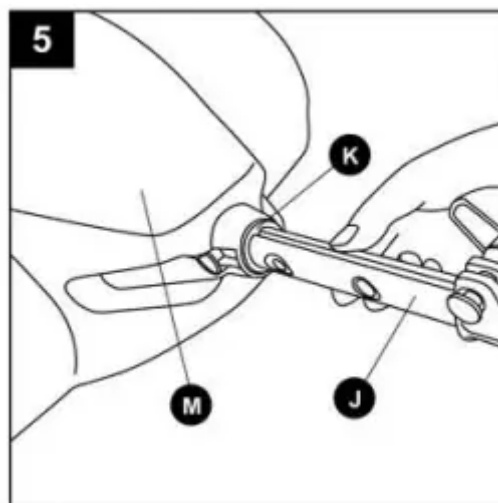

6. Insert the bolt (AA) into the right groove (L) of the main cover (M), then insert the nut (BB) with the right hand from the other sides and tighten the bolt (AA) with a screwdriver.

NOTE: Determine the left and right sides of the snow thrower by standing in the normal operating position.

- AA** M6 x 32 Bolt  x 1
- BB** M6 Nut  x 1

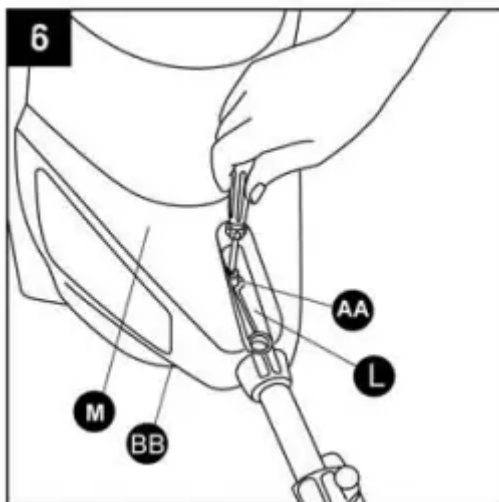

7. Insert the nut (BB) and bolt (AA) into the hole near the opening (K) and tighten the bolt (AA) with a screwdriver

- AA** M6 x 32 Bolt  x 1
- BB** M6 Nut  x 1

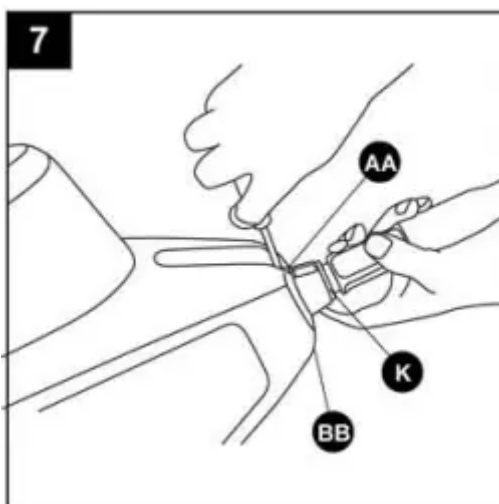

8. Insert the main pole (G) into the main handle (B), making sure that the tab on the main handle (B) is inserted into the hole on the main pole (G).



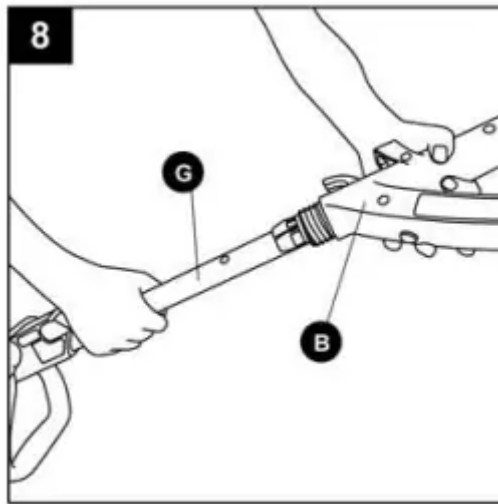

9. Turn the handle fastener (F) clockwise to secure the connection between the main handle (B) and main pole (G).

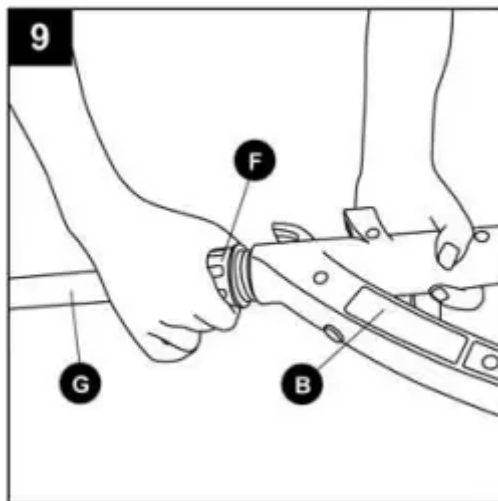

10. Loosen the knob (O) of the auxiliary handle (H). Move the auxiliary handle (H) to a position that is comfortable to you and tighten the knob (O).

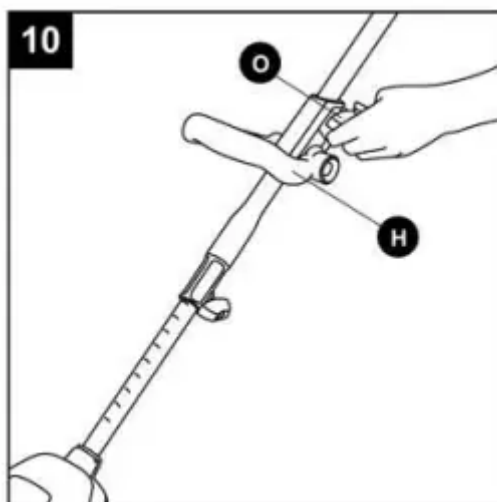

11. Set the pole to a position that is comfortable to you sliding the main handle (B) to the desired height. Tighten the knob (I).

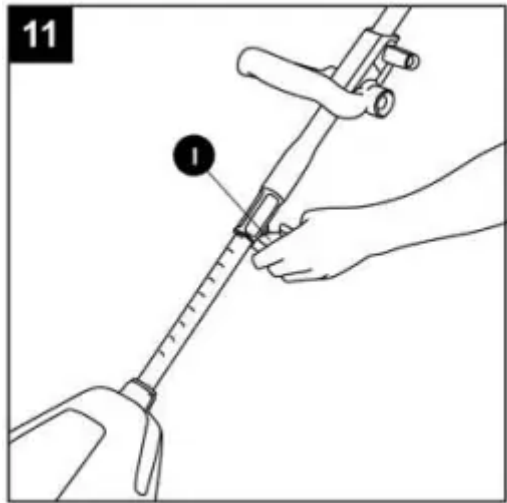

OPERATING

Note: Before using this machine, make sure that the power source you will use complies with the specifications detailed in this manual. Before inserting the plug into the socket, verify that the snow thrower's auger and scraper are firmly attached with screws. Perform a test run to ensure that the rotor turns freely.

SECURING THE EXTENSION CORD

1. For safe and efficient use of your snow thrower, use only a UL-rated extension cord recommended for outdoor use. Refer to the Extension Cord Chart below.

WARNING

Electric shock may cause SEVERE INJURY or DEATH. Heed these warnings:

- Do not allow any part of snow thrower to make contact with water while powered on. If the appliance becomes wet while turned off, wipe dry before starting.
- Use only a UL-rated extension cord for outdoor, all-weather use. Do not use an extension cord more than 150 feet long.
- Don't touch the appliance or its plug with wet hands or while standing in water. Wearing rubber boots offers some protection.

EXTENSION CORD CHART

Cord length is:	Up to 100 ft.	100-150 ft.
Wire gauge is:	16	14

2. To prevent the extension cord from disconnecting during use, tie the female end of the extension cord into a loose knot on the cord lock (E) before connecting to the male plug in the socket of the snow thrower.

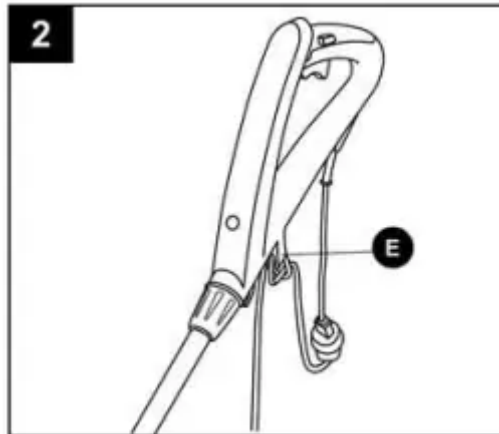

3. Note that the snow thrower has a polarized male plug (A), with one prong in the socket slightly longer and wider than the other. The extension cord female end should be likewise polarized, so that the extension cord fits snugly into the socket.

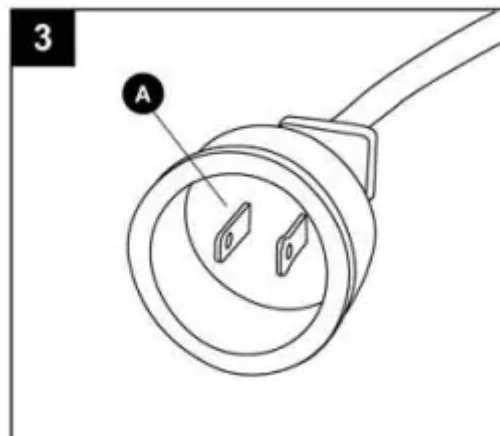

WARNING

Damaged electrical cords present risk of fire, electric shock, and serious bodily injury.

Before operating the snow thrower, carefully examine the electrical cord. If the cord is damaged, do not use the snow thrower. Replace or repair the damaged cord immediately. If you need assistance, contact our customer service department at 1-800-791-9458.

POWERING ON AND OFF

1. To power on, first press the switch button (C) on the side of the hand grip and follow by squeezing the trigger (D). Reverse operation cannot start the machine.
2. To power off, release your grip on the trigger (D).

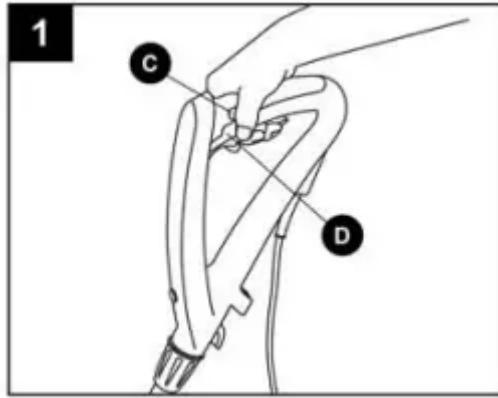

MOVING THE MACHINE AND PLOWING SNOW

WARNING

Foreign objects, such as rocks, broken glass, nails, wire, or string, can be picked up and thrown by the snow thrower, causing serious personal injury.

Remove all foreign objects from the area to be plowed before operating the snow thrower.

- Keep the area of operation free of foreign objects that can become thrown by the rotor blades. Perform a thorough inspection of the area since some objects may be hidden from view by surrounding snow. If the snow thrower hits an obstruction or picks up a foreign object during use, stop the snow thrower, disconnect the extension cord, remove the obstruction, and inspect the unit for damage. Repair or replace any damaged part before restarting and operating the unit.
- Keep children, pets, and bystanders away from the area of operation. Be aware that the normal noise of the machine when turned on may make it difficult for you to hear approaching people.
- Note wind direction. If possible, move in the same direction as the wind so that the snow is not thrown against the wind (and thus back into your face and back onto the path).
- While moving the snow thrower, do not drag the power cable violently or roughly. The snow thrower should move within the range that the cable can reach.
- Do not push the snow thrower with excessive force. You should push the machine gently and evenly in accordance with the unit's throw rate.
- Do not apply additional man-made load to the engine since this may cause engine damage.
- Some parts of the snow thrower may freeze under extreme temperature conditions. Do not attempt to operate the snow thrower with frozen parts. If the parts freeze while the snow thrower is in use, stop the snow thrower, unplug the extension cord, and inspect for frozen

parts. Free all parts before restarting or operating the snow thrower. Never force controls that have frozen.

- Working on pebbles, gravel, or unpaved surfaces - To avoid throwing loose surface material along with the snow, push down on the handle to raise the scraper at the base of the unit above the pebbles or gravel.

CARE AND MAINTENANCE

WARNING

Make sure to turn off the switch and disconnect the extension cord before performing any maintenance task on your snow thrower.

- Run the snow thrower for a few minutes to melt away any snow on the snow thrower. Turn the snow thrower's power off.
- Disconnect the extension cord from the snow thrower.
- Examine the extension cord thoroughly for signs of wear or damage. Replace it if it is worn or damaged.
- Examine the snow thrower thoroughly for worn, loose bolts or damaged parts. For repairing or replacing parts, contact customer service.
- Store the extension cord with the snow thrower.
- Store the unit in a locked and dry or high and dry place to prevent unauthorized use/ damage and keep out of the reach of children. Store the instruction manual along with unit for future use.

WARRANTY

One-Year Full Warranty for Residential Use

Amerisun Inc. warrants this product for one year which begins on the date purchased against defects in material or workmanship when used for normal residential purposes. The manufacturer will, at its option, repair or replace, for the original purchaser, any part or parts which have been found to be defective in material and workmanship. Residential use means use of the product on the same lot as your home.

- If you have questions or problems, or before returning this product, call toll-free 1-800-791-9458 or email.

This warranty covers product defects only. Amerisun is not liable for indirect, incidental, or consequential damages in connection with the use of PowerSmart Products covered by this warranty, including any cost or expense of providing substitute equipment or service during reasonable periods of mal-function or non-use pending completion of repairs under this warranty.

Some states do not allow exclusions of incidental or consequential damages, so the above exclusions may not apply to you. This warranty gives you specific legal rights, and you may also have other rights which vary from state to state.

Warning

This content is compiled from multiple sources and is provided for reference purposes only. It may not be complete or fully applicable to all situations. If you are unable to resolve your issue, please contact the product manufacturer or an authorized service provider for official support.

Document generated by [ManualsFile](#)

