

Installation

This dryer must be installed by a qualified technician. The installer is responsible for connecting the dryer to the main power while observing the relevant safety regulations of your area.

What's included

Make sure all the parts are included in the product package. If you have a problem with the dryer or the parts, contact a local Samsung customer center or the retailer.

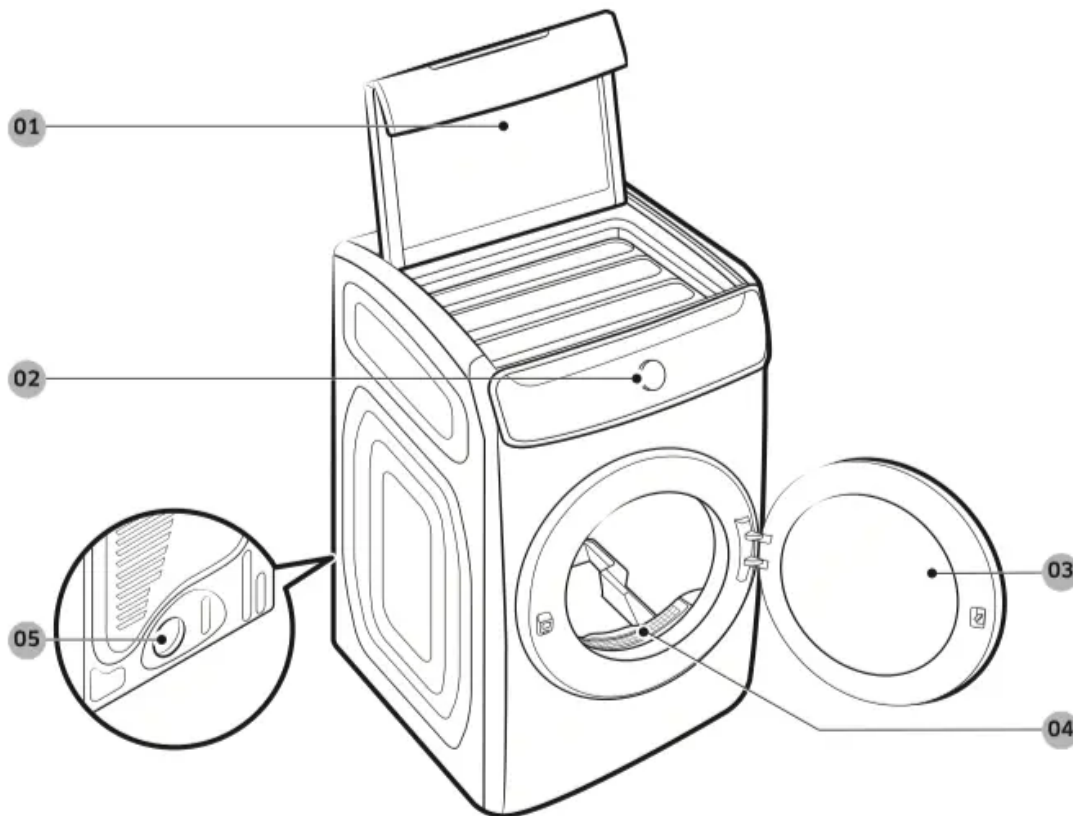

- 01 Top door
- 02 Control panel
- 03 Front door
- 04 Lint filter
- 05 Exhaust duct

Accessories (supplied)



Y-connector



Water hose (Canadian elec. models only)



Short water hose



Flexible rack

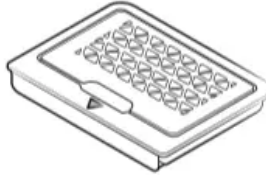

Dryer-sheet case

Accessories (not supplied)

You must purchase these items at a local service center.

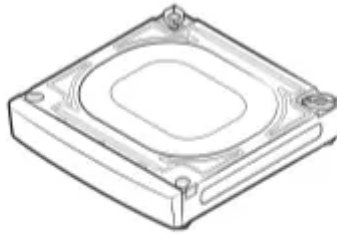

Pedestal

Tools needed for installation



Pliers



Cutting knife



**Pipe wrench
(gas models only)**



Nut screwdriver



Level



**Phillips
screwdriver**



Duct tape



Wrench



**LPG-safe
compound or
Teflon Tape (for
gas installation)**

WARNING

Packing materials can be dangerous to children. Keep all packing materials (plastic bags, polystyrene, etc.) out of children's reach.

Step-by-step installation

Make sure you have a qualified technician install the dryer. Step by step installation instructions start below.

- Do not remove the protective film on the doors before completing the product installation. If you remove the protective film before the installation is complete, the doors may get scratched or damaged during installation.
- Make sure the installation location allows enough space for the dryer doors to be fully open.

STEP 1 Install the exhaust system

1. Select a location and move the dryer to the site. For easy access, we recommend you install the dryer in the same location as your washer.
2. To change the door direction, see "Door reversal" on page 33.
3. Install the exhaust system as instructed in the "Exhaust ducting guide" section.

CAUTION Before installing your dryer, remove the packing in the duct.

NOTE

- To move the dryer easily, lay two of the carton cushions from the packaging on the floor. Tip the dryer on its side so it lies across both cushion-tops. Push the dryer so that it is near its final location, and then set the dryer upright.
- Secure room around the dryer to facilitate ducting and wiring.

STEP 2 Connect the gas line (for gas models)

Before connecting the gas line, make sure you have read the "Gas requirements" section on page 18.

1. Remove the protective cap from the gas pipe.
2. Apply an LPG (Liquefied Petroleum Gas)-safe compound or 1.5 wraps of Teflon tape to all threaded connections.
3. Connect the gas supply to the dryer. An additional fitting is required to connect the 3/4" (1.9 cm) female thread end of a flexible connector to the 3/8" (1 cm) male threaded end on the dryer. Tighten up the fitting over all threads.
4. Turn on the gas supply, and check for any leaks using a soap solution. If a leak is found, tighten the connections and try again. Do not use an open flame to check for gas leaks.

STEP 3 Connect the electrical wiring (for electric models)

Before connecting the electrical wiring, make sure you have read the “Electrical requirements” section on page 19.

3-wire system

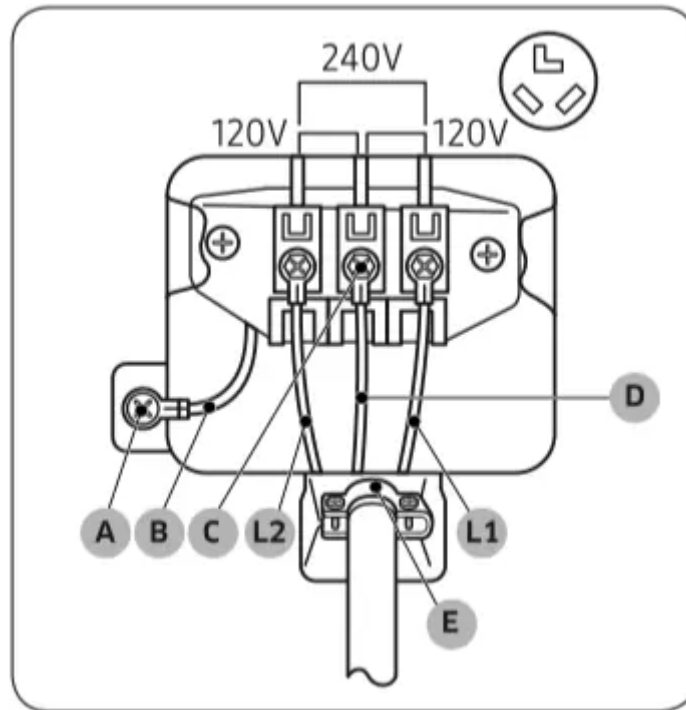

- A. External ground connector
- B. Neutral grounding wire (white)
- C. Center silver-colored terminal block screw
- D. Neutral wire (white or center wire)
- E. 3 / 4 " (1.9 cm) UL-listed strain relief

1. Loosen or remove the screws from the center terminal block.
2. Connect the neutral wire (white or center wire) of the power cable to the center, silver-colored terminal screw of the terminal block. Tighten the screws.
3. Connect the other wires to outer terminal block screws. Tighten the screws.
4. Tighten the strain relief screws.
5. Insert the terminal block cover into the rear panel of the dryer. Then, secure the cover with a hold-down screw.

CAUTION

- To convert from the 4-wire system to 3-wire system, connect the ground strap to the terminal block support to ground the dryer frame to the neutral conductor.

- Ring-type terminals are recommended. If using strap terminals, make sure they are tightened.
- Connect the power cord and check L1/L2/D (N) voltage. If the voltage is low, it may not heat properly. Review the “Electrical requirements” section on page 19 if needed.

4-wire system

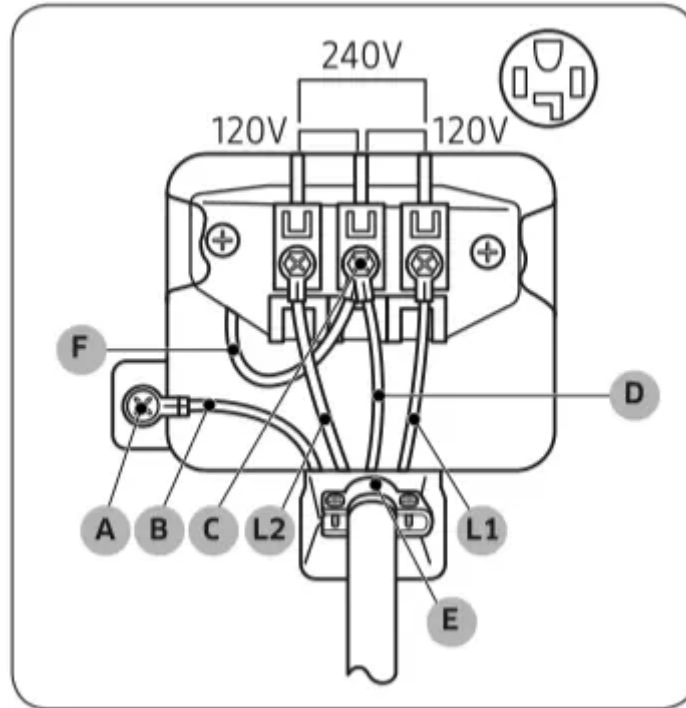

- A. External ground connector
- B. Neutral grounding wire (white)
- C. Center silver-colored terminal block screw
- D. Neutral wire (white or center wire)
- E. 3 / 4 " (1.9 cm) UL-listed strain relief
- F. Neutral wire (white or center wire)

1. Remove the external ground connector’s screw and connect the ground wire (green or unwrapped) of the power cable to the screw.

CAUTION

- To connect the ground wire to the neutral position without through contact A (cabinet ground), contact a technician. This is not user serviceable.
 - Ring-type terminals are recommended. If using strap terminals, make sure they are tightened.
2. Loosen or remove the screws from the center terminal block.

3. Connect the neutral wire (white or center wire) and ground wire (white) to the center screw of the terminal block. Tighten the screw.
4. Connect the other wires to the outer terminal block screws. Tighten the screws.
5. Tighten the strain relief screws.
6. Insert the tab of the terminal block cover into the rear slot of the dryer. Secure the cover with a hold-down screw.

CAUTION Connect the power cord and check L1/L2/D (N) voltage. If the voltage is low, it may not heat properly. Review the “Electrical requirements” section on page 19 if needed.

WARNING

- All U.S. models are designed for a 3-wire system connection. The dryer frame is grounded to the neutral conductor at the terminal block. A 4-wire system connection is required for new or remodeled construction, mobile homes, or if local codes do not permit grounding through neutral. If you use the 4-wire system, you cannot ground the dryer frame to the neutral conductor at the terminal block.
- Remove the terminal block cover plate. Insert the power cord with a UL-listed strain relief through the hole provided in the cabinet near the terminal block.
- A strain relief must be used. Do not loosen the nuts already installed on the terminal block. Be sure they are tight. Use a 3/8" (1 cm) deep well socket.
- Since January 1, 1996, the national electric code requires that new wiring (not existing) utilize a 4-wire connection to this dryer.

STEP 4 Connect the water hose (applicable models only)

The dryer must be connected to a cold water tap using the provided water hoses.



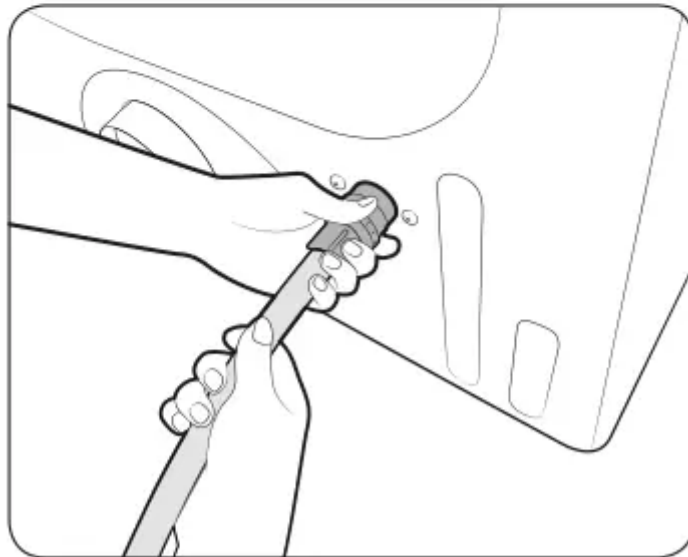
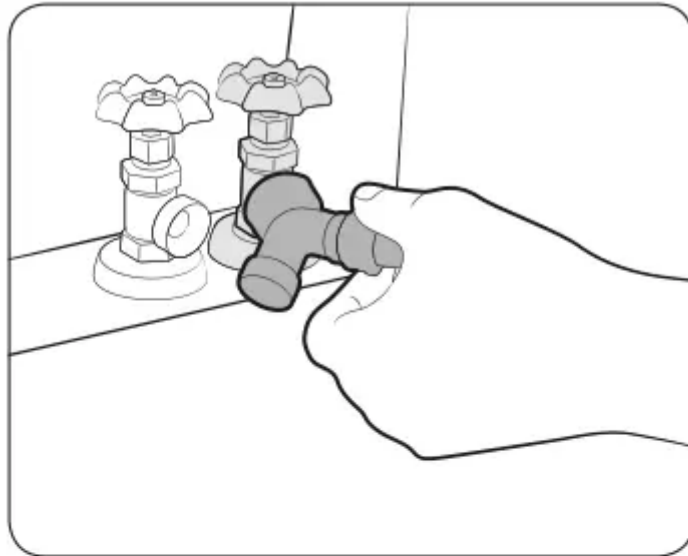

1. Close the cold water tap. If you have a washer's cold water hose attached to the cold water tap, unscrew and remove the hose. Then, connect the female end of the Y-connector to the cold water tap.
2. Connect the straight end of the water hose to the Y-connector. Tighten the hose coupling by hand.
3. Using pliers, tighten the coupling an additional twothirds turn. Do not overtighten. You can damage the coupling.
4. Connect the angled end of the water hose to the filling valve at the bottom rear of the dryer. Turn the coupling by hand until it is tight.
5. Using pliers, tighten the coupling an additional twothirds turn. Do not overtighten. You can damage the coupling.

6. If you detached the cold water hose from your washer, attach the hose to the open end of the Y-connector, tighten the coupling by hand until it is tight, and then, using a pliers, tighten an additional two-thirds turn.

7. Open the cold water tap, and then check for any leaks.

If the Y-connector cannot be directly connected to the cold water tap, use the short hose. See the “Using the short hose as an extension” section on page 28.

Using the short hose as an extension

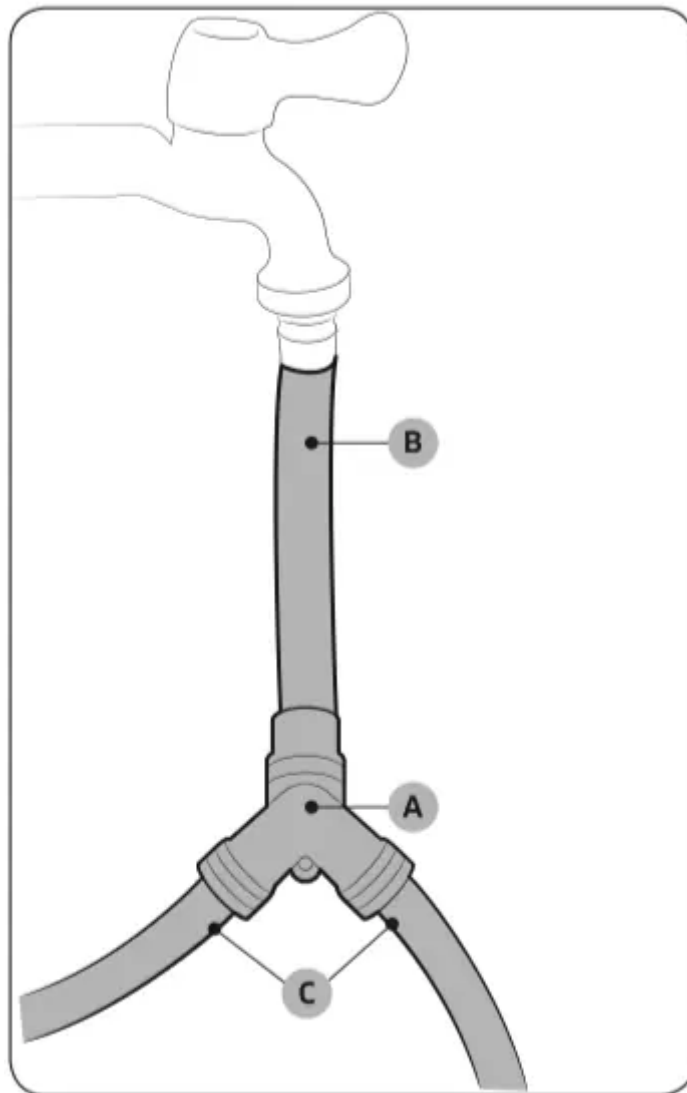

1. Close the cold water tap. If you have a washer’s cold water hose attached to the cold water tap, unscrew and remove the hose. Then, connect the short hose (B) to the cold water tap. Turn the coupling by hand until it is tight.

2. Using pliers, tighten the coupling an additional two-thirds turn. Do not overtighten. You can damage the coupling.

3. Connect the Y-connector (A) to the brass male end of the short hose. Turn the coupling by hand until it is tight.

4. Using pliers, tighten the coupling an additional two-thirds turn. Do not overtighten. You can damage the coupling.
5. Connect the angled end of the water hoses (C) to the filling valve at the bottom rear of the dryer. Turn the coupling by hand until it is tight.
6. Using pliers, tighten the coupling an additional two-thirds turn. Do not overtighten. You can damage the coupling.
7. If you detached the cold water hose from your washer, attach the hose to the free end of the Y-connector, tighten the coupling by hand until it is tight, and then, using a pliers, tighten an additional two-thirds turn.
8. Open the cold water tap, and then check for any leaks.

STEP 5 Level the dryer

To ensure optimal performance, the dryer must be level.

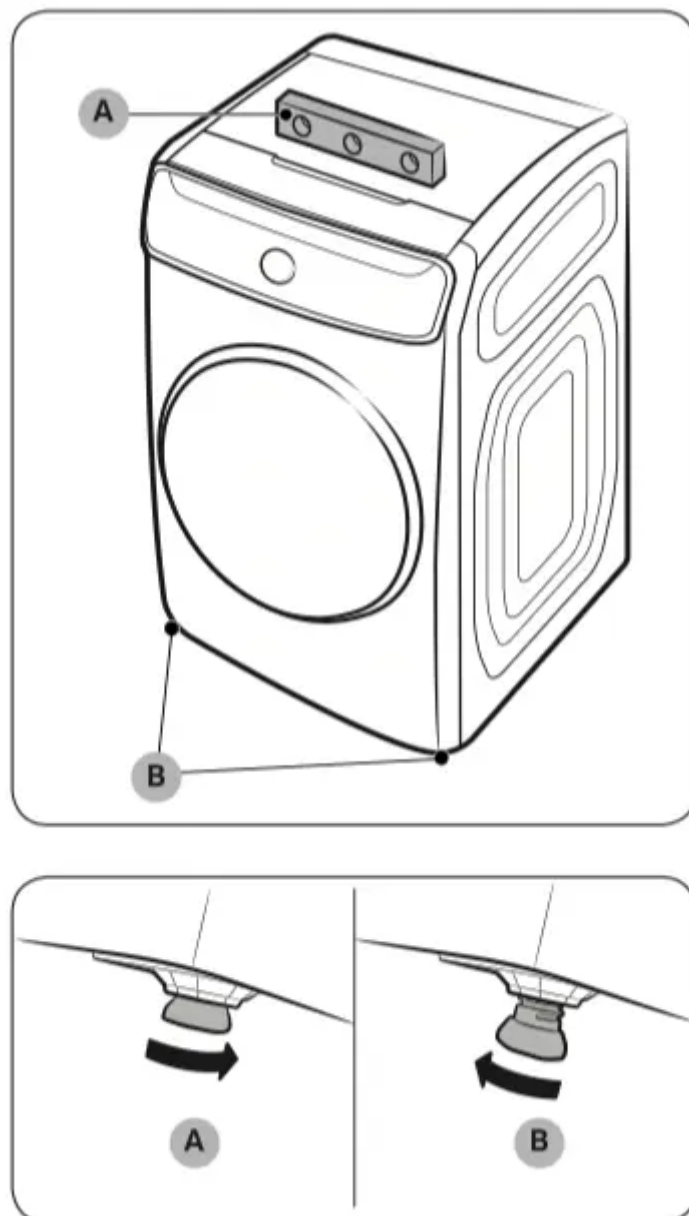

Using a level (A), check if the dryer is level side to side and then front to back. If the dryer is not level, turn the leveling legs (B) clockwise to lower the dryer or counterclockwise to raise the dryer.

NOTE

- To set the dryer to the same height as your washer, fully retract (A) the leveling legs by turning them counterclockwise, then loosen (B) the feet by turning them clockwise. Once the dryer is the same height as the washer, follow the directions above to level the dryer.
- Adjust the leveling legs only as much as necessary to level the dryer. Extending the leveling feet more than necessary can cause the dryer to vibrate.

STEP 6 Power on (for gas models)

Make sure all gas connections, the exhaust line, and all wiring is connected correctly. Then, plug the power cord into a power source and check the dryer's installation and operation using the final checklist in Step 7.

STEP 7 Final Check

When installation is complete, confirm that:

- The dryer is plugged into an electrical outlet and grounded properly.
- The exhaust ductwork is connected, and the joints are taped.
- You have used rigid or stiff-walled flexible metal duct material, not plastic flexible duct.
- The dryer is level and is sitting firmly on the floor.
- The dryer starts, runs, heats, and shuts off properly.
- The gas is supplied properly with no leaks (For gas models only).

CAUTION

The burner may not ignite initially due to air in the gas line. Allowing your dryer to operate on a heat setting will purge the line. If the gas does not ignite within 5 minutes, turn your dryer off and wait 5 minutes. Be sure the gas supply to your dryer has been turned on. To confirm gas ignition, check the exhaust for heat.

Vent blockage test

After the dryer is installed, run the Vent Blockage Test function to check if the duct system is properly installed. Vent Blockage Test automatically detects the status of the ducts and reports any blockage or problems. Proper ducting can reduce drying time and save energy.

NOTE The Vent Blockage Test function must run when the dryer is cool. If the dryer warms up after the installation check, run the Air Fluff cycle for several minutes to reduce its internal temperature.

Running the vent blockage test

1. Make sure the drum is empty, and then close the door. (If there are any clothes or other items in the drum, the test will not give accurate results.)
2. Tap  to turn the dryer on, then simultaneously tap and hold Options for 3 seconds.
3. Turn the Navigation dial to select Vent Blockage Test, and then tap OK. Vent Blockage Test starts immediately.



- The test takes about 2 minutes and "Testing..." is displayed during the test.

CAUTION Do not open the door during the test.

NOTE If you have started other procedures before running Vent Blockage Test, the dryer will not enter the Vent Blockage Test mode.

4. After 2 minutes, when the test is complete, the results are displayed and the dryer sounds a tone. If status of the duct system is normal, an alarm triggers with the "No problems detected" message. If the duct system cannot exhaust properly, the check code appears, and the dryer sounds an alarm tone. For description about the code, see the "Installation check codes" section on page 32.

If there are any other problems, an information code appears in the display. For description about the code, see the "Information codes" section on page 64.

- To stop or cancel Vent Blockage Test, tap  to turn off your dryer.
- The results remain on the display for about 5 minutes and then automatically turn off. You can turn the results off immediately by tapping .

NOTE

- During or after the test, the internal drum is hot. Use caution to prevent burns. The Vent Blockage Test function is used to check for problems in the current duct system when the dryer is installed for the first time.
- If the test result displays check code (the duct system is blocked), refer to the "Ducting requirements" section on page 16 and the "Exhaust ducting guide" section below, and then take proper measures to correct any problems. If the test is suspended, it could result in incorrect results. Follow the proper procedures when testing the dryer.
- Even if the test result is normal ("No problems detected"), the duct system could be blocked slightly. Properly install all duct work according to the installation instructions in this manual.

Installation check codes

Check code	Meaning	Solution
No problems detected	Vent condition is good.	
Vent is nearly clogged	Over 80 % of the vent is clogged. (This may lead to poor drying performance or cause malfunction)	<ol style="list-style-type: none"> 1. Clean the lint filter. 2. Check your vent condition. (Refer to the “Ducting requirements” section) <p>* You must take measures (such as cleaning) through expert personnel.</p>
Leave the dryer at room temperature	The internal temperature of the dryer is too low (below 32 °F (0 °C)) or too high (over 104 °F (40 °C)) and therefore vent blockage cannot be detected.	Leave the dryer at room temperature (41~95 °F (5~35 °C)) for an hour and check again.
Items detected in the drum	Unit is detecting items inside the drum or there is an error on the dry sensor.	<p>Remove items from the drum and check again.</p> <p>If the problem continues, contact a service center.</p>

NOTE

For other information codes, see the “Troubleshooting” section on page 64.

Exhaust ducting guide

Ducting

1. Make sure the dryer is installed properly so the air exhausts freely.
2. Use 4-inch rigid metal ducts. Tape all joints including the dryer connection. Never use lint-trapping screws.
3. To facilitate the exhaust, keep the ducts as straight as possible.

Cleaning

Clean all old ducts before installing the dryer, and make sure the vent flap opens and closes freely. We recommend that you clean the exhaust system annually or on a regular basis.

WARNING

- To prevent fire, do not use plastic, thin-foil, or non-metal flexible ducts of any kind.

- Do not use a poor exhaust system because it slows down the dryer's performance.
- Do not use excessively long ducts that have multiple elbows.
- Do not use crushed or clogged venting or ducts.

Door reversal

Type 1

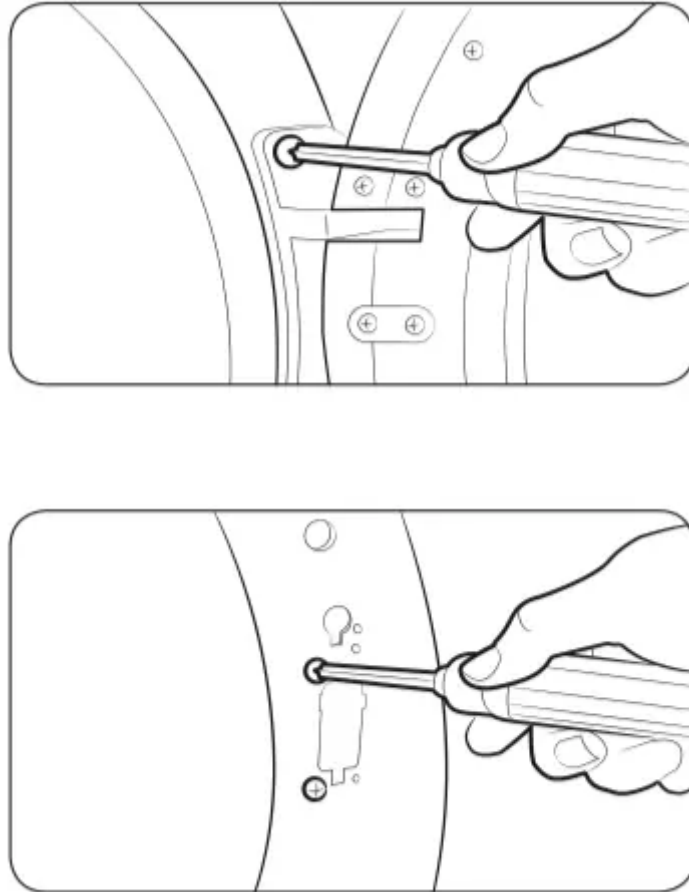

1. Put a soft rug on the floor to rest the door on after you have removed it. This will prevent the door from being scratched.
2. Unplug the power cord.
3. Remove two door hinge screws.
4. Lift the door and remove it.

NOTE There is a screw on the back side of the hinge that will support the door as you unscrew the hinge screws.

5. Remove the two screws that are above and below the cut-out in the frame front.

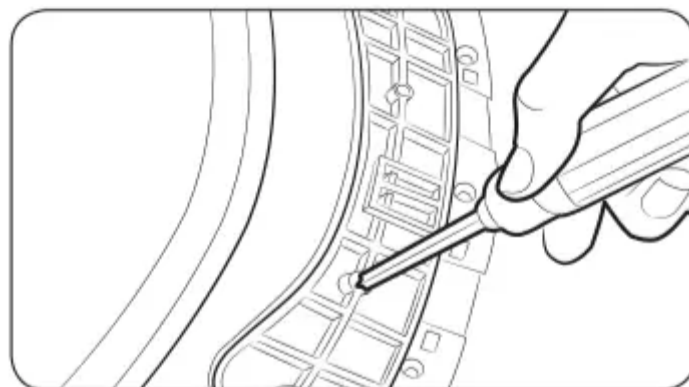
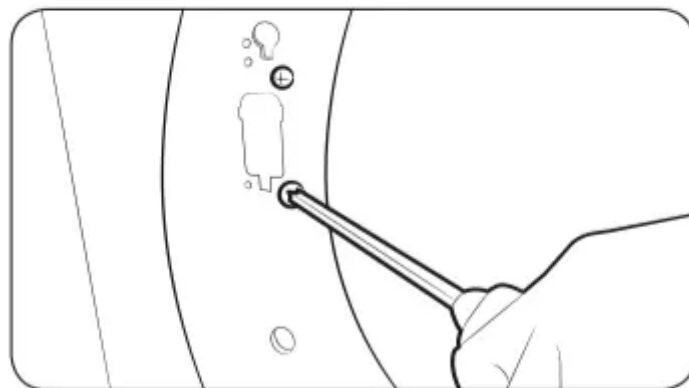
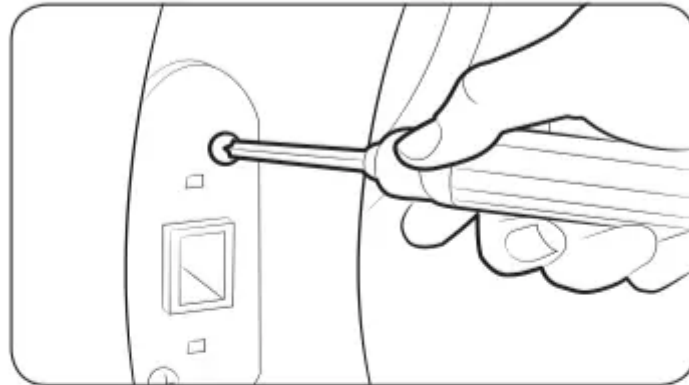
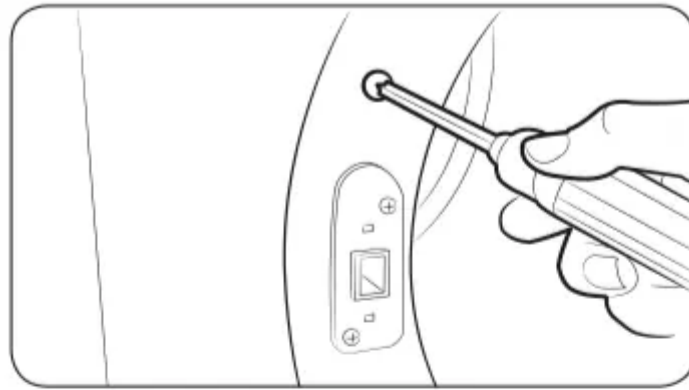

6. Remove the two screws above and below the lever holder on the opposite side of the door opening.

7. Remove the two screws that hold the lever holder in place, and then remove the lever holder.

8. Re-insert the two screws that held the lever holder into the same screw holes, and then tighten.

9. Remove the single screw from the back of the door hinge.

NOTE

This is the screw that supports the door against the frame so you can unscrew or screw in the hinge without needing to support the door yourself.



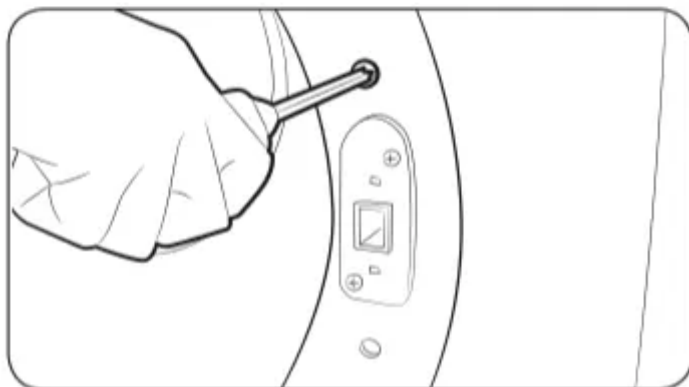
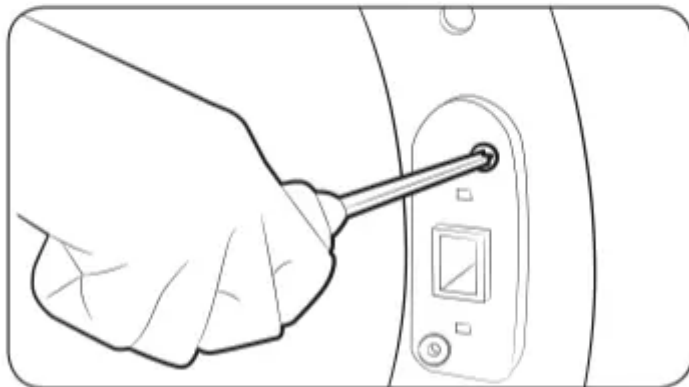
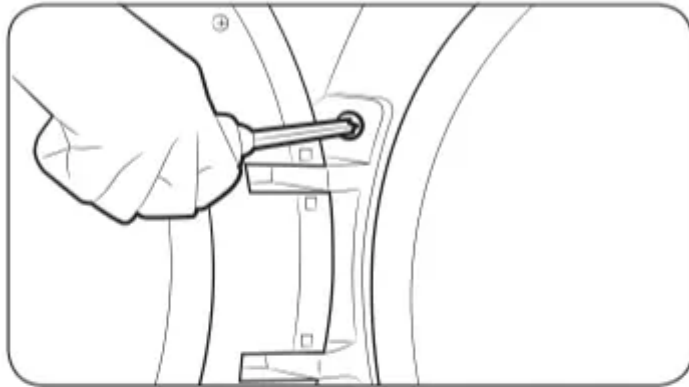
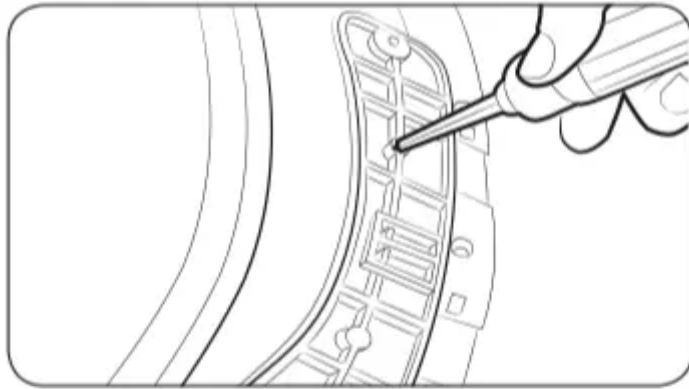

10. Insert the screw you just removed into the other screw hole on the back of the door hinge, and then tighten.

11. Place the door on the other side, and then reattach it to the dryer.

NOTE

Insert the head of the screw on the back of the hinge into the hole above the cut out in the frame, and then slide the door hinge down until it stops. Make sure the protrusion on the back of the hinge is pressed into the cut out before you tighten the hinge screws.

12. Push the lever holder into the cut out on the other side of the door opening. Insert screws, and then tighten as shown.

13. Re-attach the remaining screws to the remaining holes above and below the lever holder, and then tighten.

Before you start

Here are a few things you should know before starting your dryer.

Initial setup

- When you turn on your dryer for the first time, the screen shows the initial setup process. Follow the on-screen instructions to complete it.
- If you complete the initial setup and operate a cycle for more than a minute, the initial setup will not appear again.
- The initial setup includes language selection and a brief tutorial.
- When tapping a button, tap exactly over the text.
- Operating the washing machine and dryer at the same time may result in a loss of power depending on where they are installed and your electrical power status.

01 Language selection

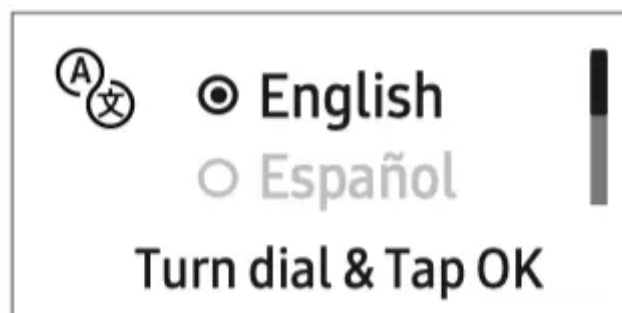

02 Welcome screen

Welcome!

03 Tutorial

**Let's explore
your new dryer!**

[Tap OK to skip]

**A dryer that knows you!
All Done!**

Sort and load

- Put one wash load in the dryer at a time.
- Do not mix heavy and lightweight items together.
- To improve drying efficiency for one or two items, add a dry towel to the load.
- For best results, untangle items before inserting them into the dryer. Tangled items may degrade the drying efficiency or cause the door to open.
- Overloading reduces the tumbling action, resulting in uneven drying and wrinkling.
- Unless recommended on the care label, do not dry woolens or fiberglass items.
- Avoid drying unwashed items.
- Do not dry items soiled with oil, alcohol, gasoline, etc.

Lint filter

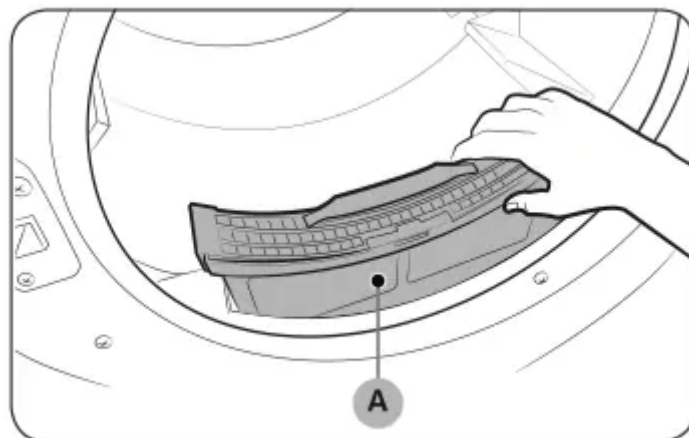

To prevent a risk of fire, make sure to clean the lint filter before or after every load.

1. Turn off the dryer.
2. Open the door and pull out the lint filter (A) from inside the drum.
3. Open the lint filter by separating it at the top. Remove the lint, and then clean the lint filter.
4. Close the lint filter, reinsert the lint filter into the dryer, and then close the dryer door.

CAUTION

- Do not operate the dryer without the lint filter in place.
- Do not use a damaged or broken lint filter. This may reduce performance and/or cause fire.

Rack guidelines

Flexible rack

The flexible rack is designed to dry delicate items that are not suitable for or cannot be dried in the lower dryer.

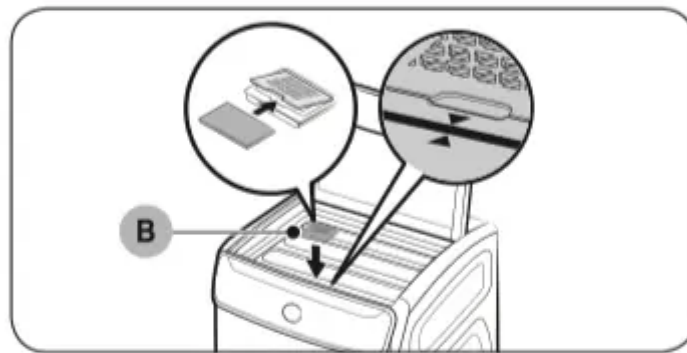
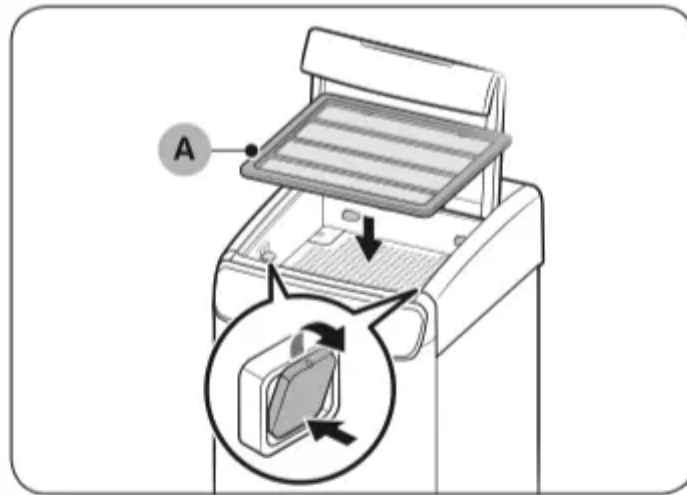

To use the flexible rack

1. Locate the rack supports (x4) in each corner of the upper dryer. Push down the lower area of the front 2 supports to unfold. The rear 2 supports are fixed.
2. Insert the flexible rack (A) inside the upper dryer. Make sure all 4 corners of the rack sit on the rack supports properly.

NOTE You don't have to use the drying rack. Put bulky items below the rack and put any additional items on the rack.

3. Insert a folded dryer sheet in dryer-sheet case (B), and then put the case at the top center of the rack. Make sure the dryer-sheet case faces against the triangle mark on the upper dryer because only the arrow area has the built-in magnet to secure the filter.

NOTE If using a large-sized dryer sheet, the dryer-sheet case may not close normally. However, this does not affect the drying performance.

Bulky items are easily wrinkled in the upper dryer. Do not dry bulky items in the upper dryer. Please see the Upper dryer section on page 43 for reference.

WARNING Do not dry animals, plants, food items, or anything else but clothing.

Rack Dry (applicable models only)

Some models come with a drying rack which is inserted into the drum at the factory. If your model came with a drying rack, remove the rack from the drum before you use the dryer for the first time. To remove the rack, pull the rack straight up, and then take it out of the drum. Remove the drying rack from its packaging and store the rack for later use.

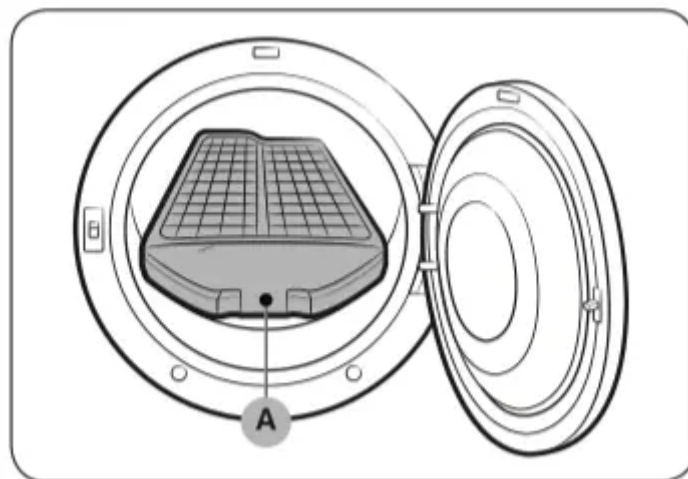

If a drying rack is not provided, you can purchase it at a local Samsung service center. (Part Code : DC9300374G) To use the drying rack, follow these steps:

1. Insert the drying rack (A) inside the tumbler with the filter handle to the front.
2. Insert the rear legs of the drying rack into the recessed areas of the rear wall, and then press down the middle of the drying rack to secure it in place.
3. Put items to dry on the rack. Make sure to leave space between the items for air flow.
4. Press Rack Dry or other Cycle Setting according to rack drying suggestions below, then select the drying time.
5. When the items are dry, remove the them from the dryer, and then remove the drying rack.

Drying rack drying suggestions

Item	Cycle settings
Washable sweaters (fold sweater into same shape as rack and lay it flat on the rack)	Time Dry with the Low temperature setting
Stuffed toys (cotton or polyester fiber-filled)	
Stuffed toys (foam or rubber-filled)	Air Fluff
Foam rubber pillows	
Sneakers	

WARNING

- Make sure to unpack the drying rack before using it. Otherwise, the dryer can be damaged or its performance diminished.
- Drying foam rubber, plastic, or rubber on a heat setting may damage the items and create a fire hazard.

Operations

This FlexDry™ dryer features the upper dryer and the lower dryer for your convenience. The upper dryer is a top load dryer that is designed to dry relatively small loads while the lower dryer is a drum loader you can use to dry normal or relatively heavy loads.

WARNING

To reduce the risk of fire, electric shock, or injury, read the “Safety information” before operating this appliance.





CAUTION

Do not spray water onto the control panel. This may cause a system failure.

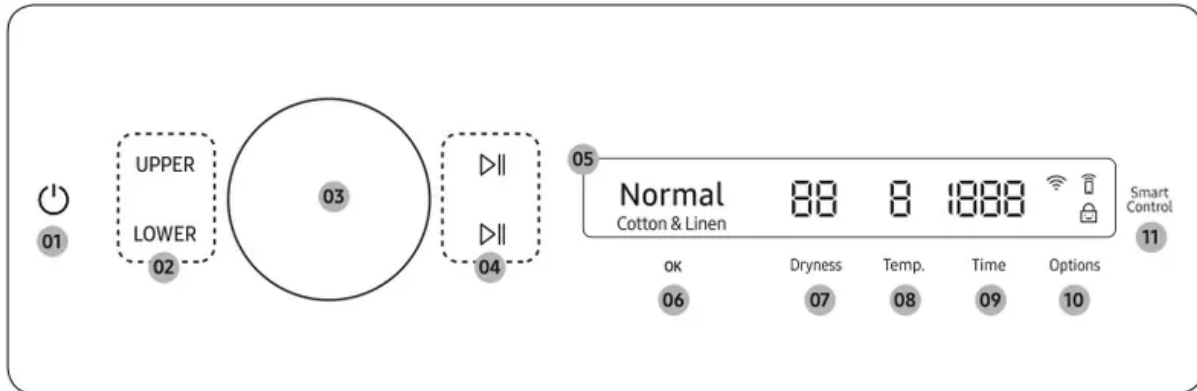

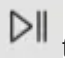

Control panel



<p>01 Power </p>	<p>Tap to turn the dryer on or off.</p> <ul style="list-style-type: none"> • If you do not manipulate the control panel for 10 minutes after the dryer is turned on, the dryer automatically turns off. • The dryer automatically turns off when the drying completes. <p>CAUTION</p> <p>Do not tap  to turn the dryer off while the drying is in progress. Tap and hold  to pause the cycle first, and then tap  to turn the dryer off.</p>
<p>02 UPPER / LOWER</p>	<p>Tap UPPER to select the upper dryer and use its features.</p> <ul style="list-style-type: none"> • You can tap and hold UPPER for 3 seconds to cancel the upper dryer operation. Tap LOWER to select the lower dryer and use its features. • You can tap and hold LOWER for 3 seconds to cancel the lower dryer operation.
<p>03 Navigation dial</p>	<p>Turn the Navigation dial left or right to navigate through cycles and functions. When you turn the Navigation dial, the display shows your selection (such as cycle, additional features, and system functions).</p>
<p>04 Start/Pause </p>	<p>You can start or pause the operation.</p> <ul style="list-style-type: none"> • The upper button controls the upper dryer, and the lower button controls the lower dryer. • Tap and hold the button to start the operation. • During the operation, tap the button to pause.
<p>05 Display</p>	<p>The display shows the current cycle, estimated time remaining, cycle options, and other useful or alert messages.</p>
<p>06 OK</p>	<p>Tap to confirm your selection of function or setting.</p>
<p>07 Dryness</p>	<p>Tap to change the dry level for the selected cycle. You can select from level 1 to 5, but available level depends on the selected cycle.</p> <ul style="list-style-type: none"> • 4 or 5: Suitable for large and thick items. • 3: Standard drying level.



	<ul style="list-style-type: none"> • 2: The Damp dry level is designed to partially dry items. Use for items that lay flat or hang to dry. • 1: Gently dries items to protect fabric. Suitable for delicate items or items you want to naturally dry (by hanging or laying flat on drying rack) while they are damp.
08 Temp.	Temperature can only be adjusted in Time Dry cycle. Tap to change the temperature of the current cycle.
09 Time	<p>Tap to select the cycle time for the following cycles. You can set the drying time between 10 to 160 minutes, and available drying time depend on the selected cycle.</p> <ul style="list-style-type: none"> • Upper Dryer: Blouses, Sweaters, Undergarments, Accessories. • Lower Dryer: Small Load, Time Dry, Air Fluff, Wrinkle Away.
10 Options	<ul style="list-style-type: none"> • Tap to enter the Options menu. • Tap and hold for 3 seconds to enter the System Functions menu.
11 Smart Control (Electric models only) / Smart Monitor (Gas models only)	After connecting the dryer to your home network using the SmartThings app, you can control or monitor the dryer remotely. When started, the Smart Control (Smart Monitor) indicator turns on. The dryer enters waiting mode and waits for remote commands.

Icon description

	Wi-Fi	This icon indicates that the dryer is connected to Wi-Fi.
	Smart Control	This icon indicates that Smart Control is on. For more information on "Smart Control", see page 51.
	Child Lock	This icon indicates that Child Lock is on. For more information on "Child Lock", see page 48.

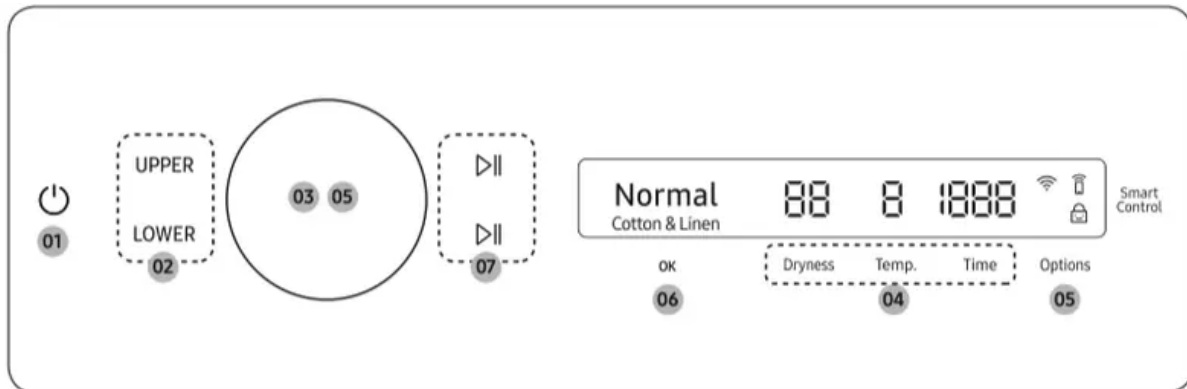
Operating a cycle



1. Tap  to turn on the dryer.
2. Tap UPPER or LOWER.
 - Tap UPPER to select the upper dryer and use its features.
 - Tap LOWER to select the lower dryer and use its features.
3. Turn the Navigation dial to select the cycle you want. For more information on “Cycle overview”, see page 43.
4. Tap Dryness, Temp., or Time to change the default cycle settings.
5. Tap Options, and then turn the Navigation dial to select additional function. For more information on “Options”, see page 45.
6. Tap OK to change the settings for selected additional function. Not all cycles have additional features available.
7. Tap and hold  to start operation. Once you set the cycle you want, the screen displays a brief cycle description, and cycle time. You can also check the cycle progress, remaining cycle time, and information codes.

Cycle overview

NOTE

Other cycles can be used after adding them to your cycle list using the My Cycles function. For more information, see the “My Cycles” section on page 47.

Upper dryer

Cycle	Description
Blouses	For synthetic blouses and blouses with accessories (ornaments)
Sweaters	For washable wool or wool-blended sweaters, cotton or cotton-blended sweaters, and knitted cardigans
Undergarments	For synthetic reshaping innerwear, innerwear with laces, spandex fabrics for Pilates or Yoga, and leggings
Accessories	For scarfs, mufflers, gloves, and stockings

Lower dryer



Cycle	Description
Normal	For most fabrics including cottons and linens.
Time Dry	You can specify a cycle time by a 10-minute unit.
Heavy Duty	For drying items made out of heavy fabrics, such as jeans, corduroys, or work clothes, with high temperature heat.
SuperSpeed	Fast & effective for synthetic fabrics.
Small Load	Timed cycle for small load items. The default cycle time is 30 minutes. However, you may manually change the cycle time if necessary.
Delicates	For heat-sensitive items at a low drying temperature.
Steam Sanitize+ (Sensor Dry)	Use to sanitize items by applying steam and high-temperature heat to the fabric. This cycle can make items soft and reduce smells. Confirm that the laundry load is wet or partially wet before starting this cycle.
Wrinkle Away (Manual Dry)	For best results, load 2-3 items at once. You can extend the drying time by a 10-minute unit (starting from a minimum of 10 minutes), depending on the item type or load. Confirm that the laundry load is dry.
Steam Refresh (Manual Dry)	Use to smooth out wrinkles and reduce odors in loads of one to four items. With this cycle selected, a small amount of water is sprayed into the dryer drum after several minutes of tumbling with heat. Confirm that the laundry load is dry.
Towels	Use to dry loads such as bath towels.



Bedding	For bulky items such as blankets, sheets, comforters, and light duvets.
Activewear.	For exercise wear and outdoor wear such as sports jerseys, training pants, water-repellent jackets, and other performance clothing. Thick fabrics like a zipper or velcro closure of a jacket, or training socks may not be completely dried.
Denim	Use a stepped drying temperature for removing moisture of Jeans and denims.
Shirts	Use to quickly dry a few items such as a shirt.
Wool	For machine washable and tumble dryable wool only. For best results, turn laundry inside out before drying.
Perm Press	Dry wrinkle-free cottons, synthetic fabrics, knits, and permanent press fabrics automatically.
Eco Normal	For reducing energy usage. This cycle adjusts the cycle time and temperature for increased efficiency.
Air Fluff	Tumbles the load in room temperature air.

Options

Using Options

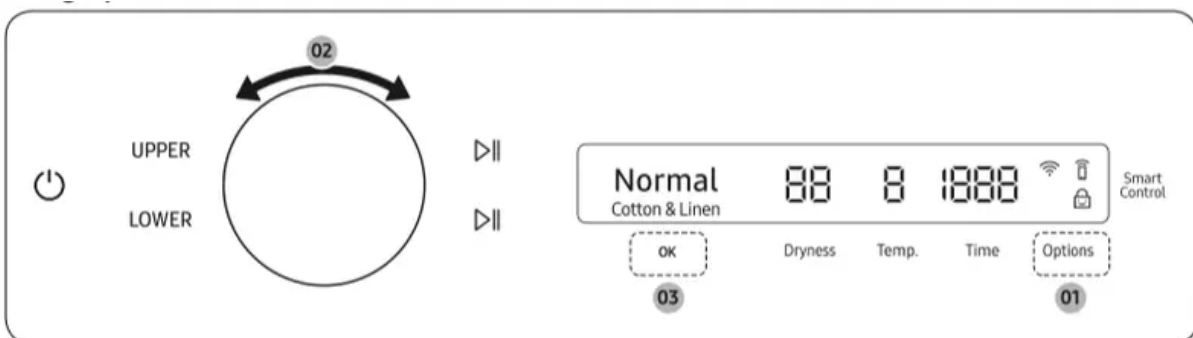

1. Tap UPPER or LOWER to select the upper or lower dryer.
2. Tap Options.
3. Turn the Navigation dial to select the desired additional function.
4. Tap OK to change the selected function's settings or start the function.

NOTE

- To return to the main screen, tap Options again or turn the Navigation dial to select Back, and then tap OK.
- If the selected function is not supported, the "Currently not supported" message is displayed, and the OK button is not activated.
- When you select an additional function, a brief help message appears for the first ten times of use.
- If you do not manipulate the control panel for 7 seconds after entering the Options menu, the display returns to the main screen.

Air Fluff

You can dry heat-sensitive clothing without heat, in room temperature air. Enabling this function may require more time to dry. This option is available for the Blouses, Undergarments and Accessories cycles.

1. Tap UPPER.
 - This function is not available for the lower dryer.
2. Tap Options.
3. Turn the Navigation dial to select Air Fluff, and then tap OK.
4. Tap OK to select On or Off.

Super Speed

Super Speed increases the fan speed to shorten the drying time. This option is available for the Blouses, Undergarments and Accessories cycles.

1. Tap UPPER.
 - This function is not available for the lower dryer.
2. Tap Options.
3. Turn the Navigation dial to select Super Speed, and then tap OK.
4. Tap OK to select On or Off.

Wrinkle Prevent

Reduces wrinkles by rotating the drum intermittently after completing the dry cycle. Wrinkle Prevent provides approximately 180 minutes. The load is dry and can be removed at any time during the Wrinkle Prevent cycle.

1. Tap LOWER.
 - This function is not available for the upper dryer.
2. Tap Options.

3. Turn the Navigation dial to select Wrinkle Prevent, and then tap OK.
4. Tap OK to select On or Off.

Damp Alert

This function alerts you when shirts and other items that require ironing are dry enough to be suitable for ironing.

1. Tap LOWER.
 - This function is not available for the upper dryer.
2. Select a cycle and change the cycle settings as necessary.
 - This function is available for Normal, Heavy Duty, Bedding, Delicates, Perm Press, Towels and Denim with Dryness set to 2-5.
3. Tap Options.
4. Turn the Navigation dial to select Damp Alert, and then tap OK.
5. Tap OK to select On or Off.

AntiStatic

Reduces static electricity that occurs from clothing friction. This is done by spraying steam in a later stage of the drying cycle. The AntiStatic function is only available with Normal, Heavy Duty, Perm Press, Delicates, and Time Dry. In the Normal, Heavy Duty, Delicates, and Perm Press cycles, you can use this function if the dryness setting is 3 or higher.

1. Tap LOWER.
 - This function is not available for the upper dryer.
2. Tap Options.
3. Turn the Navigation dial to select AntiStatic, and then tap OK.
4. Tap OK to select On or Off.

Eco Dry

With the Eco Dry activated, drying takes a longer time but power consumption is reduced. This function is available with Normal and Time Dry.

1. Tap LOWER.
 - This function is not available for the upper dryer.
2. Tap Options.
3. Turn the Navigation dial to select Eco Dry, and then tap OK.
4. Tap OK to select On or Off.

NOTE The drying time can be extended by up to 3 times normal depending on the temperature and load. The Eco Dry function is enabled by default.

My Cycles

Add or remove cycles to create a personal cycle list.

1. Tap UPPER or LOWER to select the upper or lower dryer.
2. Tap Options.
3. Turn the Navigation dial to select My Cycles, and then tap OK.
 - You can only edit a cycle to create a personal cycle when the dryer is not operating.
4. Turn the Navigation dial to select a desired cycle.
5. Tap OK to add or remove the selected cycle.
 - Addition and removal of a cycle is saved automatically.
6. Tap Options or select Back to finish My Cycles setting.

NOTE The Normal (lower) and Blouses (upper) cycles cannot be removed from the cycles list.

Drum Light

You can turn the drum light on or off.

1. Tap LOWER.
 - This function is not available for the upper dryer.
2. Tap Options.
3. Turn the Navigation dial to select Drum Light, and then tap OK.
4. Tap OK to select On or Off.
 - The drum light turns on even when the dryer is off. (If the dryer is plugged into a power outlet.)
 - When the dryer door opens, the drum light automatically turns on and automatically turns off after 2 minutes.

Child Lock

To prevent children or infants from accidentally starting or setting the dryer, Child Lock locks all buttons except for  and Options.

1. Close the door.
2. Tap UPPER or LOWER to select the upper or lower dryer.
3. Tap Options.
4. Turn the Navigation dial to select Child Lock, and then tap OK.

5. Tap OK to select On or Off.

- The Child Lock  icon turns on when the function is on.
- You cannot turn on Child Lock with the door open. If you get the "Door is open" message on the display while you try to turn on Child Lock, close the door and try again.

NOTE

- When Child Lock is on, all buttons are disabled except for  and Options.
- If you tap a button with Child Lock on, an alarm triggers with the "Child Lock on" message.
- If you open and close the door with Child Lock on, an alarm triggers with the "Open door & check inside" and "Child Lock on" message.
- To dismiss a notification message, turn off Child Lock or the power.

System functions

Using System Functions

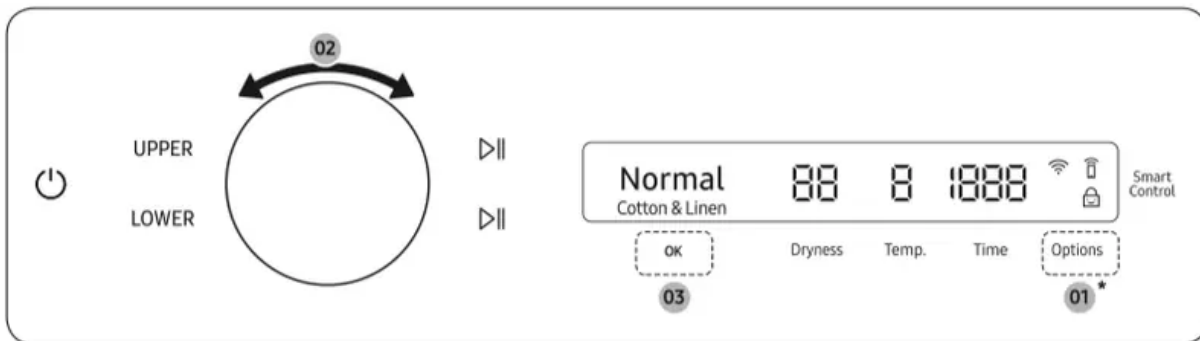

* Tap and hold 3 seconds.

1. Tap and hold Options for 3 seconds.
2. Turn the Navigation dial and select the desired system function, and then tap OK.
3. Tap OK to change the selected function's settings or start the function.

NOTE

- To return to the main screen, tap Options again or turn the Navigation dial to select Back, and then tap OK.
- If you do not manipulate the control panel for 7 seconds after entering the System Functions menu, the display returns to the main screen.

AI Pattern

This function saves your frequently used cycles and settings.

1. Tap and hold Options for 3 seconds.
2. Turn the Navigation dial to select AI Pattern, and then tap OK.
3. Tap OK to select On or Off.
 - The default setting is On. Set it to Off if you do not want to use this function.
 - When you turn the function on, the dryer remembers frequently used cycles and their settings (Dry Level Dryness, Time Time) and save them in frequently used order.
 - When you turn off the function, all the saved data resets.

Alarm

You can enable/disable alarm sounds.

1. Tap and hold Options for 3 seconds.
2. Turn the Navigation dial to select Alarm, and then tap OK.
3. Tap OK to select On or Off.
 - The default setting is On.

NOTE The setting remains unchanged even if you restart the dryer.

Wi-Fi

You can turn the dryer's Wi-Fi on or off.

1. Tap and hold Options for 3 seconds.
2. Turn the Navigation dial to select Wi-Fi, and then tap OK.
3. Tap OK to select On or Off.
 - The dryer's Wi-Fi is off as a factory default setting. However, the dryer's Wi-Fi turns on automatically when you turn on the dryer for the first time. Then, the final Wi-Fi setting maintains regardless of the dryer power status.
 - Once you turn on the dryer's Wi-Fi and connect to a network, the dryer remains connected to the network even when you turn off the power.
 - The Wi-Fi  indicates that the dryer is connected to the router through the Wi-Fi connection.

Language

You can change the system language.

1. Tap and hold Options for 3 seconds.
2. Turn the Navigation dial to select Language, and then tap OK.
3. Turn the Navigation dial to select the desired language, and then tap OK.

Vent Blockage Test

Detects the status of the ducts and reports any blockage or problems.

1. Tap and hold Options for 3 seconds.
2. Turn the Navigation dial to select Vent Blockage Test, and then tap OK.
 - Vent Blockage Test starts immediately.

Factory Reset

You can reset your dryer.

1. Tap and hold Options for 3 seconds.
2. Turn the Navigation dial to select Factory Reset, and then tap OK.
 - Your dryer resets to the factory setting.

Special features

Smart Control

You can connect to the SmartThings app and control your dryer remotely. (Smart Control for electric model, Smart Monitor for gas model)

Connecting your dryer

- Download and open the SmartThings app on your mobile device
- Tap  to turn on the dryer.
- Tap and hold Smart Control / Smart Monitor on the dryer.
 - a. The dryer enters AP mode and connects to your mobile device.
 - b. Tap Smart Control / Smart Monitor to authenticate your dryer on your mobile device.
 - c. Once the authentication process is complete, your dryer is successfully connected to the app. Use various features available in the SmartThings app.

NOTE

- If your dryer fails to connect with the SmartThings app, try again.
- Check your router if you experience any Internet connection problem after connecting your dryer with the SmartThings app.
- If the Wi-Fi is off, tap and hold Options for 3 seconds to navigate to System Functions, select Wi-Fi and tap OK to turn it on.
- Turning the dryer's Wi-Fi on allows you connect to the dryer via SmartThings app on your smartphone regardless of the power status of the dryer. However, the dryer appears offline on the SmartThings app if the dryer's Wi-Fi is off.



- Close the door before starting the Smart Control function.
- If you use the dryer 20 times without being connected to SmartThings, the next time you turn the dryer on, a pop-up about Smart Control connection will appear for 3 seconds.
- If the dryer's Wi-Fi is not connected to an AP (access point), the Wi-Fi will turn off when you turn of the power.

Stay Connect

Set up the Stay Connect function in your SmartThings app. Your dryer stays connected to the app so you can use the dryer when you are away from home.

1. If you turn on the Stay Connect function on the SmartThings app, the dryer will stay in standby power saving mode after completing a cycle.

- The Stay Connect function will remain active for up to 24 hour if the door remains closed.

2. When the Stay Connect function is active, the Smart Control  and Wi-Fi  turn on your dryer display.



3. Conveniently control your dryer using the SmartThings app

NOTE The dryer switches to standby power saving mode when operation is paused even if the machine is not connected to the SmartThings app.

Cycle chart

Upper dryer

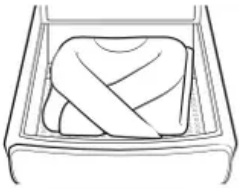
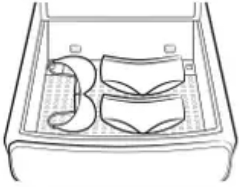
- The drying time depends on the load and the item type. To shorten the drying time, use Super Speed.
- For manual-wash items, use a towel to remove moisture from the items before drying.
- To reduce the drying time of the items that are machine-washable, set the spinning option on your washer to high to remove as much moisture as possible.
- Arrange items as even and straight as possible. Overlapped items may not be dried well. Available or recommended items for a specific cycle are as below:

Cycle	Picture	Load	Item
Blouses		1 EA (max. 2 EA)	Synthetic blouses, blouses with accessories (ornaments)
Sweaters		1 EA (max. 2 EA)	Wool or wool-blended sweaters, cotton or cotton-blended sweaters, knitted cardigans
Undergarments		3 EA (max. 6 EA)	Synthetic reshaping innerwear, innerwear with laces, spandex fabrics for Pilates or Yoga, leggings
Accessories		2 EA (max. 4 EA)	Scarfs, mufflers, gloves, stockings

The max load is calculated on the condition of using the drying rack.

NOTE

● : factory setting, ○ : can be selected

Cycle	Time	Options	
		Air Fluff	Super Speed
Blouses	○	○	○
Sweaters	○		
Undergarments	○	○	○
Accessories	○	○	○



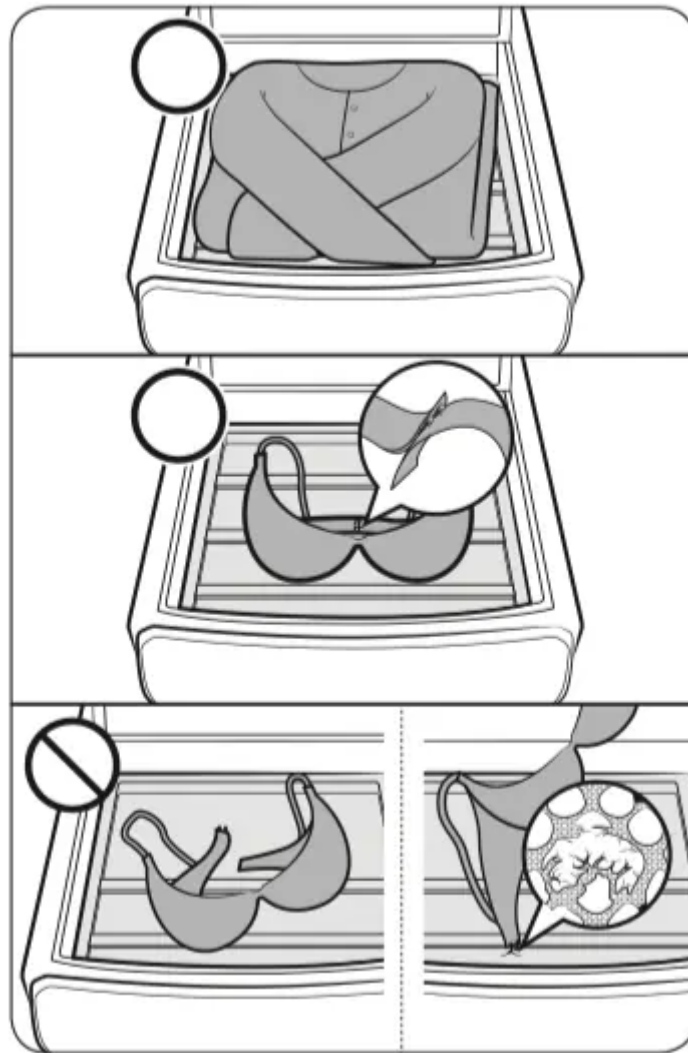

CAUTION

Clothing with accessories or hooks may get stuck in the mesh of the rack.

- Clothing with accessories must face upwards.
- Clothing with hooks must be hooked up before being placed.

Not Recommended for the upper dryer

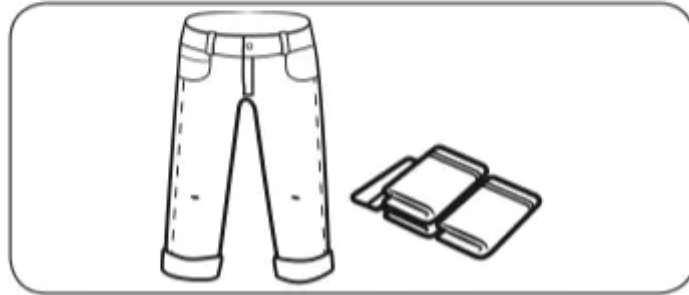



Do not dry shoes, bags, down/fur products, rugs, carpets, or bulky items in the upper dryer.

Do not dry shoes, bags, down/fur products, rugs, carpets, or bulky items in the upper dryer.

Lower dryer



NOTE

For best results, follow the load size recommendations for each dry cycle.

-  Large load: Fill the drum to about 3 /4 full. Do not add items over this level as they need to tumble freely.
-  Medium load : Fill the drum to about 1 /2 full.
-  Small load : Fill the drum with 3-5 items, not more than 1 /4 full.

Cycle	Recommended items	Load size	Dry level
Normal	Cottons, work clothes, linens, mixed loads		Normal dry, level 3 (Adjustable)
Time Dry	Any load		-
Heavy Duty	Heavy fabrics such as jeans, corduroys, heavy work clothes		Normal dry, level 3 (Adjustable)
SuperSpeed	Synthetic fabrics (Maximum amount : 8 lbs)		Normal dry, level 3 (Not Adjustable)
Small Load	Small loads		-
Delicates	Underwear, blouses, lingerie		Normal dry, level 3 (Adjustable)
Steam Sanitize+ (Sensor Dry)	Bedding, curtains, children's clothing		Very dry, level 5 (Not Adjustable)
Wrinkle Away (Manual Dry)	Shirts, Trouser, Blouses		-
Steam Refresh (Manual Dry)	Shirts, trousers, comforters, pillows		-
Towels	Bath towels and similar items		Normal dry, level 3 (Adjustable)
Bedding	Bulky items such as blankets, sheets, comforters, pillows		Normal dry, level 3 (Adjustable)
Activewear	Water-repellent wear, performance clothes, sports wear (Maximum : 4 lbs)		Normal dry, level 3 (Not Adjustable)
Denim	Jeans, Denims		Normal dry, level 3 (Adjustable)
Shirts	Shirt, Blouses		Normal dry, level 3 (Not Adjustable)
Wool	For machine washable and tumble dryable wool only (Maximum amount : 3 lbs)		Normal dry, level 3 (Not Adjustable)
Perm Press	Shirts, synthetic fabrics, knits, wrinkle-free cottons, permanent press		Normal dry, level 3 (Adjustable)
Eco Normal	Cottons, work clothes, linens		Normal dry, level 3 (Not Adjustable)
Air Fluff	Foam, rubber, plastic		-

NOTE

 : factory setting,  : can be selected

Cycle	Functions (Temp. Control)	Time	Options			
			AntiStatic	Damp Alert	Wrinkle Prevent	Eco Dry
Normal	Medium, level 4		<input type="radio"/>	<input type="radio"/>	<input type="radio"/>	<input checked="" type="radio"/>
Time Dry	High, level 5 (Adjustable)	<input type="radio"/>	<input type="radio"/>		<input type="radio"/>	<input checked="" type="radio"/>
Heavy Duty	High, level 5		<input type="radio"/>	<input type="radio"/>	<input type="radio"/>	
SuperSpeed	High, level 5				<input type="radio"/>	
Small Load	High, level 5	<input type="radio"/>			<input type="radio"/>	
Delicates	Extra low, level 1		<input type="radio"/>	<input type="radio"/>	<input type="radio"/>	
Steam Sanitize+	High, level 5				<input type="radio"/>	
Wrinkle Away	High, level 5	<input type="radio"/>			<input type="radio"/>	
Steam Refresh	High, level 5				<input type="radio"/>	
Towels	High, level 5			<input type="radio"/>	<input type="radio"/>	
Bedding	High, level 5			<input type="radio"/>	<input type="radio"/>	
Activewear	Medium, level 4				<input type="radio"/>	
Denim	Medium, level 4			<input type="radio"/>	<input type="radio"/>	
Shirts	Medium, level 4				<input type="radio"/>	
Wool	Low, level 2				<input type="radio"/>	
Perm Press	Medium Low, level 3		<input type="radio"/>	<input type="radio"/>	<input type="radio"/>	
Eco Normal	Extra low, level 1				<input type="radio"/>	
Air Fluff	-	<input type="radio"/>			<input type="radio"/>	

Drying guide

The best way to dry items is to follow the instructions on the care label. If no drying instructions are provided, see the following table for reference.

Lower dryer

Items	Description
Bedspreads & Comforters	<p>Follow the care label instructions or dry using Bedding.</p> <ul style="list-style-type: none"> • Make sure the item is thoroughly dry before using or storing. • May require repositioning in the drum to ensure even drying.
Blankets	<p>Use Normal and dry only one blanket at a time for best tumbling action.</p> <ul style="list-style-type: none"> • Make sure blankets are thoroughly dry before using or storing.
Curtains & Draperies	<p>Use PERM PRESS and the medium low temperature setting to help minimize wrinkling.</p> <ul style="list-style-type: none"> • Dry curtains and draperies in small loads for best results and remove as soon as possible after the cycle is complete.
Cloth Diapers	<p>Use Normal and the Medium temperature setting for soft, fluffy diapers.</p>
Down-filled Items (jackets, sleeping bags, comforters, etc.)	<p>Use Normal and the Medium temperature setting.</p> <ul style="list-style-type: none"> • Add a couple of dry towels to absorb moisture and shorten drying time.
Foam Rubber (rug backs, stuffed toys, shoulder pads, etc.)	<p>Do not dry on a heat setting.</p> <p>WARNING</p> <p>Drying a rubber item with heat may damage it or cause a fire.</p>
Pillows	<p>Use Normal.</p> <ul style="list-style-type: none"> • Add a couple of dry towels and a pair of clean sneakers to help the tumbling action and to fluff the pillows. • Do not dry kapok or foam pillows using a heated drying cycle.



Plastics (shower curtains, outdoor furniture covers, etc.)	Use Time Dry and the Low temperature settings depending on the care label instructions.
---	---

WARNING

Do not dry:

- Fiberglass items (curtains, draperies, etc.)
- Woolens, unless recommended on the label
- Items spotted or soaked with vegetable or cooking oils

Maintenance

Keep your FlexDry™ dryer clean to prevent decreased performance and to lengthen its life.

WARNING

Certain internal parts are intentionally not grounded and may present a risk of electric shock only during servicing.

Service Personnel - Do not contact the following parts while the appliance is energized: Control board and inlet valve.

General cleaning and maintenance instructions

Control panel

- Clean with a soft, damp cloth. Do not use abrasive substances.
- Do not spray liquid cleaning agents directly on the display of the dryer.
- Some laundry pre-treatment soil and stain removers may damage the control panel.
- When using liquid cleaning agents, apply them to the cleaning cloth. Do not apply them directly to the dryer. Wipe up any spills or overspray immediately.

Exterior

- Clean with a soft, damp cloth. Do not use abrasive substances.
- Protect the surface from sharp objects.
- Do not place heavy or sharp objects or a detergent container on the dryer. They can scratch or damage the top cover of the dryer.
- The dryer has a high-gloss finish on its entire surface. Be careful not to scratch or damage the surface.

Exhaust system

- Check and clean the exhaust system on a yearly or regular basis to maintain optimum performance.
- The external exhaust hood must be cleaned more frequently to ensure proper air flow.

Vent sensor

The dryer features a vent sensor that detects and notifies you when it is time to clean the ductwork. Check the following if you get the “Check the lint filter or vent condition” message when you turn on the dryer.

NOTE

- For duct installation, see Exhaust ducting guide on page 33 and Ducting requirements on page 16.
- The dryer may keep running even if the duct is clogged, but the drying time will be extended.
- When you get the message check the lint filter and the ducts, and clean them if necessary.
- If the message keep appears, it is because the duct is installed or connected with some restrictions (it's too long or has too many bends). This is not a system failure. However, drying time may be extended or the drying performance may be degraded.

Upper dryer

Flexible rack

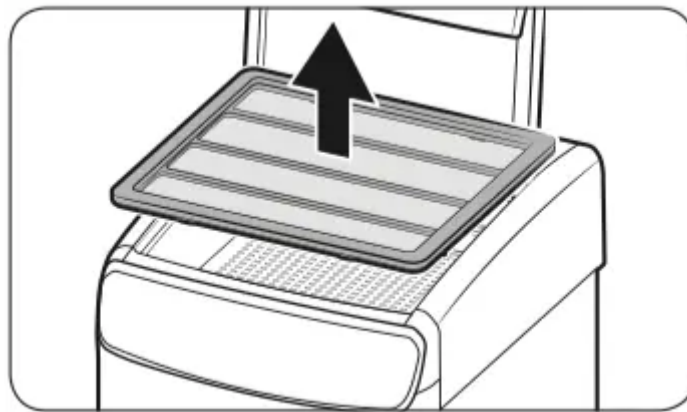

- If you use the flexible rack, make sure to clean the rack after every use so that it is readily available for future use.
- Clean the rack with neutral cleaning agents and running water.

Upper recesses

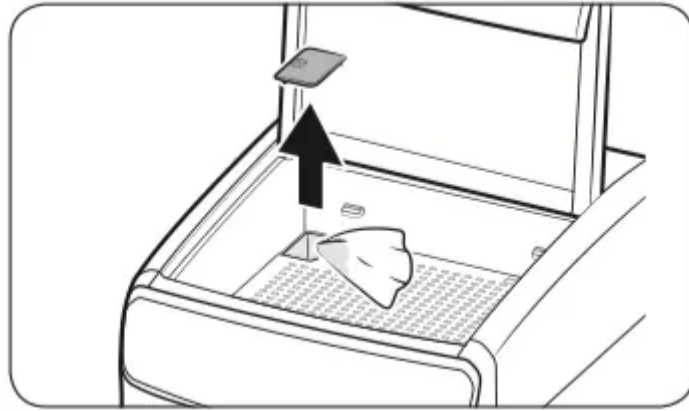

- Clean the left and right rear recesses of the upper dryer after every use.
- Locate the recesses in the rear corners of the upper dryer, and then remove the recess covers on both sides.
- The upper dryer may have collected water while it is operating. After every use or while the upper dryer is operating, remove the covers of the rear recesses, and then clean the recesses using a soft dry cloth.
- By design, the surface of the upper dryer is slanted to facilitate collection of water.

Dryer-sheet case

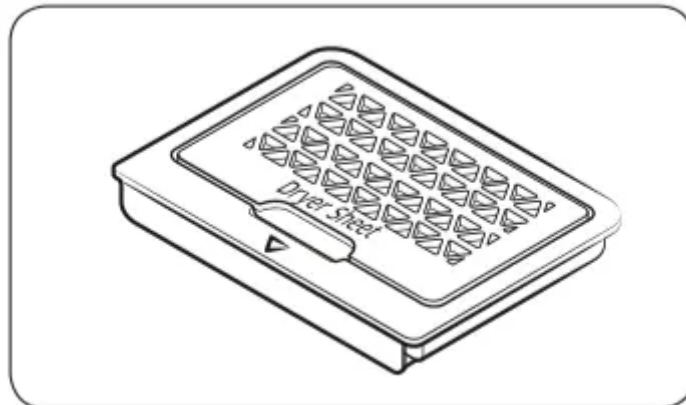

- Clean the Dryer-sheet case with neutral cleaning agents and running water.

Lower dryer

Stainless steel drum

- Clean the drum after every use.
- To clean the stainless steel drum, use a damp cloth with a mild, non-abrasive cleaner suitable for easily marred surfaces. Remove cleaner residue and dry with a clean cloth.

Drying rack

- If you used the lower drying rack, make sure to clean the rack after every use so that it is readily available for future use.
- Clean the drying rack with neutral cleaning agents and running water.

Troubleshooting

Checkpoints

If you encounter a problem with the dryer, first check the table below and try the suggestions.

Problem	Action
<p>Dryer does not start.</p>	<ul style="list-style-type: none"> • Make sure the dryer is plugged in. • Make sure the door is properly closed. • Check the fuse or reset the circuit breaker. • If you opened the door during a cycle, tap and hold  again. • Clean the filter. • Make sure Child Lock is not activated. • If you are using the upper dryer but it does not operate properly, you can turn the lower dryer on and see if an information code appears.
<p>The dryer does not warm up.</p>	<ul style="list-style-type: none"> • Check your home's circuit breakers or fuses. • Some cycles do not require heat. Check the selected cycle again. • For a gas dryer, make sure the gas supply is on. • Clean the lint filter and exhaust duct. • The dryer may have moved into the cool-down phase of the cycle. • Turn off the Eco Dry option for the Normal or Time Dry cycles. When the Eco Dry option is on, the dryer performs an air dry process in the beginning of the cycle to reduce energy consumption. The air dry process does not use heated air, so you may feel that the dryer is not being heated, but this is normal.
<p>Items are not dried.</p>	<p>Check all of the above. Additionally:</p> <ul style="list-style-type: none"> • Make sure the exhaust hood outside your home can open and close freely. • Check the exhaust system for lint buildup. Ducting should be inspected and cleaned annually. • Use a 4" rigid metal exhaust duct. • Do not overload. 1 wash load = 1 dryer load. • Dry heavy items and light weight items separately. • Large, bulky items, such as blankets or comforters, may require repositioning to ensure even drying. • Make sure that your washer is draining properly and extracting adequate water from the load.

- The load may be too small to tumble properly. Add a few towels and restart the dryer.
- The load may be too large to tumble properly. Remove some items and restart the dryer.
- Clean the lint filter.

<p>The dryer is too loud.</p>	<ul style="list-style-type: none"> • Look for coins, loose buttons, nails, and other objects and remove them immediately. • Check the lint filter. Remove any items stuck inside the lint filter. • Make sure the dryer is level and standing firmly on the floor. • The dryer may hum due to air moving through the drum and fan. This is normal. • It is normal to hear the dryer gas valve or heating element cycle on and off during the drying cycle.
<p>Items are not dried evenly.</p>	<ul style="list-style-type: none"> • Seams, pockets, and other parts of clothing are harder to dry than others. This is normal. • Sort heavy and light items separately.
<p>There is a smell coming from the dryer.</p>	<ul style="list-style-type: none"> • The smell of paint, varnish, cleaning agents, and other household items could have circulated in the air and entered the dryer. If you notice such a smell, ventilate completely before using the dryer. • If drying in an enclosed area, the dryer could cause the ambient temperature to rise. Accordingly, make sure to open a window and ventilate the area. • Do not attempt to dry wet items after leaving them in the washing machine or dryer for a long time.
<p>The dryer turns off before the items are dry.</p>	<ul style="list-style-type: none"> • The load is too small. Throw in few additional items like towels and try drying again.
<p>The clothes have lint on them.</p>	<ul style="list-style-type: none"> • Always make sure the lint filter is clean before putting items into the dryer. When drying items that generate a large amount of lint, you may need to clean the lint filter in the middle of a cycle. • Some fabrics (such as white towels) causes more lint and should be dried separately from fabrics that lint attaches easily (such as black linen pants). • Check the inside of the pockets to make sure they are empty before drying.
	<ul style="list-style-type: none"> • Small loads of 1 to 4 items work best.



<p>Items still wrinkled after Wrinkle Prevent (Wrinkle Away, Wrinkle Release).</p>	<ul style="list-style-type: none"> • Load fewer items. Load similar-type items. • Take out the items immediately after drying is complete.
<p>Water drips from the nozzle when the Steam cycles starts.</p>	<ul style="list-style-type: none"> • This is steam condensation. The dripping water will stop after a short time.
<p>Sprayed water is not visible during Steam cycles.</p>	<ul style="list-style-type: none"> • Sprayed water is difficult to see when the door is closed.

<p>Extended time.</p>	<ul style="list-style-type: none"> • Some cycles automatically sense the moisture in the load and shut the dryer off when the selected dryness level is reached. <p>The drying time can change according to the type and amount of laundry. See the cycle chart for reference.</p>
------------------------------	---

If a problem persists, contact a local Samsung service center.

Information codes

If the dryer fails to operate, you may see an information code on the display panel. To determine what you should do, check the list of codes in the table below, and then try the suggested actions.

Information code	Meaning	Action
Door is open	Operating the dryer with the door open.	<ul style="list-style-type: none"> • Make sure the door is properly closed. • Make sure laundry is not caught in the door
FC	Invalid power source frequency.	<ul style="list-style-type: none"> • Try restarting the cycle. • If this information code remains, contact a Samsung service center.
AC	Electronic control problem (Invalid Communication).	Contact a Samsung service center.
HC	High temperature heating check.	<ul style="list-style-type: none"> • Clean the lint filter. • If this information code remains, contact a Samsung service center.
9C1	The electronic control needs to be checked.	<ul style="list-style-type: none"> • Check if power cord is connected properly. • Check if the electrical outlet is working properly. • If the information code remains, contact a Samsung service center.
tC	The Thermistor1 resistance is very low or high.	<ul style="list-style-type: none"> • Check for a clogged lint screen. • Check if the vent system is restricted. • If this information code remains, contact a Samsung service center.
tC5	The Thermistor2 resistance is very low or high.	<ul style="list-style-type: none"> • Check for a clogged lint screen. • Check if the vent system is restricted. • If this information code remains, contact a Samsung service center.

dF	Incorrect door switch.	Contact a Samsung service center.
-----------	------------------------	-----------------------------------

If any information code keeps appearing on the display, contact a Samsung service center.

Warning

This content is compiled from multiple sources and is provided for reference purposes only. It may not be complete or fully applicable to all situations. If you are unable to resolve your issue, please contact the product manufacturer or an authorized service provider for official support.

Document generated by [ManualsFile](#)

