

Installation* for Electrolux Front Load Washer

*Please refer to the Use & Care Guide provided with this washer for further details.

TO INSTALLER: Leave these instructions with the customer.

WARNING RISK OF FIRE

Read all the following instructions before installing and using this appliance.

- Dispose of the carton and plastic bags after the washer is unpacked. Children might use them for play. Cartons covered with rugs, bedspreads, or plastic sheets can become airtight chambers causing suffocation. Place all materials in a garbage container or make these materials inaccessible to children.
- For your safety the information in this manual must be followed to minimize the risk of fire or explosion or to prevent property damage, personal injury or loss of life. Do not store or use gasoline or other flammable vapors and liquids in the vicinity of this or any other appliance.
- Install the washer according to the manufacturer's instructions and local codes.
- The electrical service to the washer must conform with local codes and ordinances and the latest edition of the National Electrical Code, ANSI/NFPA 70, or in Canada, the Canadian Electrical Code CSA C22.1 part 1.
- To avoid back or other injury, have more than one person move or lift the washer.
- Do not stack a dryer on top of washer already installed on pedestal. Do not stack washer on top of dryer. Do not stack washer on top of another washer.

The instructions in this manual and all other literature included with this washer are not meant to cover every possible condition and situation that may occur. Good safe practice and caution **MUST** be applied when installing, operating and maintaining any appliance.

1 Remove Foam Packaging and Shipping Hardware.

Remove Foam Packaging

1. Temporarily remove door tape.
2. Open washer door and remove everything from the drum.
3. Close door and reapply door tape.
4. Using a rug, blanket or piece of cardboard to protect the floor, carefully lay the washer on its back.

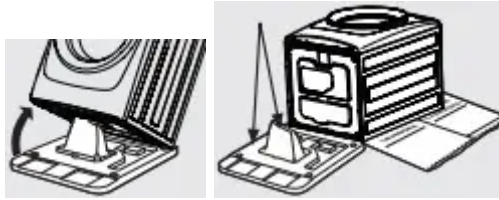

5. Remove styrofoam base and shipping plug and set them aside.
6. Carefully return the washer to an upright position.
7. Carefully move the washer to within 4 feet (1 m) of its final location.

WARNING

ELECTRIC SHOCK HAZARD

Certain internal parts are intentionally not grounded and may present a risk of electrical shock if contacted during installation.

Do not contact the following parts while the appliance is energized

- Pump
- Drive motor
- Electrical control boards
- Water valves

CAUTION

EXCESSIVE WEIGHT HAZARD

To avoid back or other injury, have more than one person move or lift the washer.

IMPORTANT

DO NOT tip washer upside down onto its top or onto its right side for any reason.

Remove Shipping Bolts and Install Plugs

1. Remove shipping bolts from rear of unit.

NOTE: Spacers may need time to relax before they can be easily pulled through shipping hole.

2. Situer les bouchons dans le petit sac fourni avec les guides d'instructions de la laveuse.
3. Les insérer dans les trous dans le panneau arrière de la laveuse où la quincaillerie de transport avait été retirée

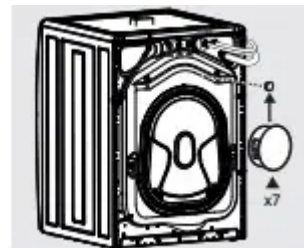
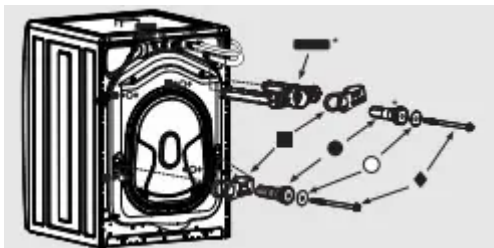

For detailed information, refer to "Unpacking the washer" in the Installation sections of the Use & Care Guide provided with this washer.

2 Electrical Requirements

CIRCUIT - Individual, properly polarized and grounded 15 amp. branch circuit fused with 15 amp. time delay fuse or circuit breaker.

POWER SUPPLY - 2 wire, with ground, 120 volt single phase, 60 Hz, Alternating Current.

OUTLET RECEPTACLE - Properly grounded 3-prong receptacle to be located so the power supply cord is accessible when the washer is in an installed position.

WARNING

ELECTRICAL SHOCK HAZARD

Improper connection of the equipment grounding conductor can cause an electrical shock that may result in serious injury or death. Check with a licensed electrician if you are in doubt as to whether the appliance is properly grounded.

1. The washer **MUST** be grounded. In the event of malfunction or breakdown, grounding will reduce the risk of electrical shock by a path of least resistance for electrical current.
2. Since your washer is equipped with a power supply cord having an equipment-grounding conductor and a grounding plug, the plug **MUST** be plugged into an appropriate, copper wired receptacle that is properly installed and grounded in accordance with all local codes and ordinances or in the absence of local codes, with the National Electrical Codes, ANSI/NFPA 70 (latest edition), or in Canada, the Canadian electrical code C22.1 part 1. If in doubt, call a licensed electrician. **DO NOT** cut off or alter the grounding prong on the power supply cord. In situations where a two-slot receptacle is present, it is the owner's responsibility to have a licensed electrician replace it with a properly grounded three prong grounding type receptacle.

For detailed information, refer to "Electrical system requirements" in the Installation sections of the Use & Care Guide provided with this washer.

3 Leveling the Washer

Excessive noise and vibration can be prevented by properly leveling the washer.

1. Place a level on top of the washer.
2. Use an adjustable wrench to adjust the leveling legs so the washer is level front-to-rear and side-to-side, and stable corner-to-corner.
3. Press down on alternate corners and sides and feel for the slightest movement. Adjust the eg(s) so the washer sits solidly on the floor on **ALL** four legs. Keep the leveling leg extension at a minimum for best performance of the washer.



4 Connect Water Line

1. Run some water from the hot and cold faucets to flush the water lines and remove particles that might clog the water valve screens and to determine which faucet is hot and which is cold supply.
2. Check to ensure that the inlet hoses have the rubber washer firmly in place.
3. Connect the HOT inlet hose to the HOT inlet connection on the washer and the COLD inlet hose to the COLD inlet connection on the washer. Tighten by hand until snug. Then tighten each supply connection another $\frac{2}{3}$ turn with pliers. Do not cross thread or over-tighten these connections.
4. Connect the HOT inlet hose to the HOT water supply and the COLD inlet hose to the COLD water supply.

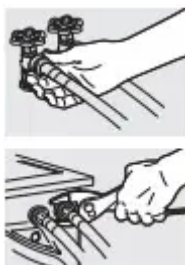

5. Tighten by hand until snug. Then tighten each supply connection another $\frac{2}{3}$ turn with pliers. **Do not bend, kink or pinch water inlet hoses.**
6. Turn on the water and check for leaks.

For detailed information, refer to "Connecting inlet water" in the Installation sections of the Use & Care Guide provided with this washer.

5 Connect Drain and Electric

1. Verify the anti-siphon disc is in place.



2. Form a "U" shape on the end of the drain hose with the hose pointed toward the drain. Place the formed end in a laundry tub or a standpipe and secure the drain hose with the cable tie (provided in the enclosure package) to the standpipe, inlet hose, laundry tub, etc. so the hose does not pull out from the force of the water.
3. Plug the power cord into a grounded outlet.

4. Turn on the power at a circuit breaker/fuse box.
5. Carefully slide the washer to its final position. Recheck leveling and rock corners for stability. See "Leveling the washer". Remove and discard door tape.

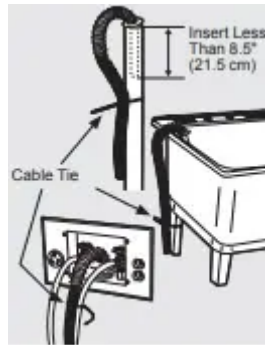

NOTE

The standpipe inside diameter must be 1-1/4" (3.2 cm) minimum. There must be an air gap around the drain hose in the standpipe. A snug hose fit can cause a siphoning action.

IMPORTANT

Check to ensure the power is off at a circuit breaker/ fuse box before plugging the power cord into an outlet.

6. Run the washer through a complete cycle, checking for water leaks and proper operation.
7. If you have any questions during initial operation, please review the "Troubleshooting" section in the Use & Care Guide before calling for service

For detailed information, refer to "Connecting drain and electrical" in the Installation sections of the Use & Care Guide provided with this washer.

6 Installation Checklist

Shipping Hardware

- Foam shipping support (under wash tub) removed and stored
- Shipping bolts and spacers removed from rear of appliance and stored
- Hole plugs (shipped in bag in drum) installed in holes in backsheet

Leveling

- Washer is level, side-to-side and front-to-back
- Cabinet is sitting solid on all corners

Water Supply

- Use only new hoses and verify rubber sealing washers are installed

HOT supply is connected to HOT inlet and COLD supply is connected to COLD inlet

HOT and COLD water supply turned on

No leaks present at water supply connections or appliance inlet connections - recheck in 24 hours

Drain

Stand pipe or wall drain height minimum 24"

Verify anti-siphon disc is attached toward end of drain hose

Drain hose secured in place with cable tie (shipped in drum)

Door Reversal

Follow detailed instructions in this guide

Test hinge and latch for function

Electrical Power

House power turned on

Washer plugged in

Final Checks

Installation instructions and Use & Care Guide read thoroughly

Door locks and water enters drum when cycle starts

Registration card sent in

Warning

This content is compiled from multiple sources and is provided for reference purposes only. It may not be complete or fully applicable to all situations. If you are unable to resolve your issue, please contact the product manufacturer or an authorized service provider for official support.

