

OPERATING

PARTS

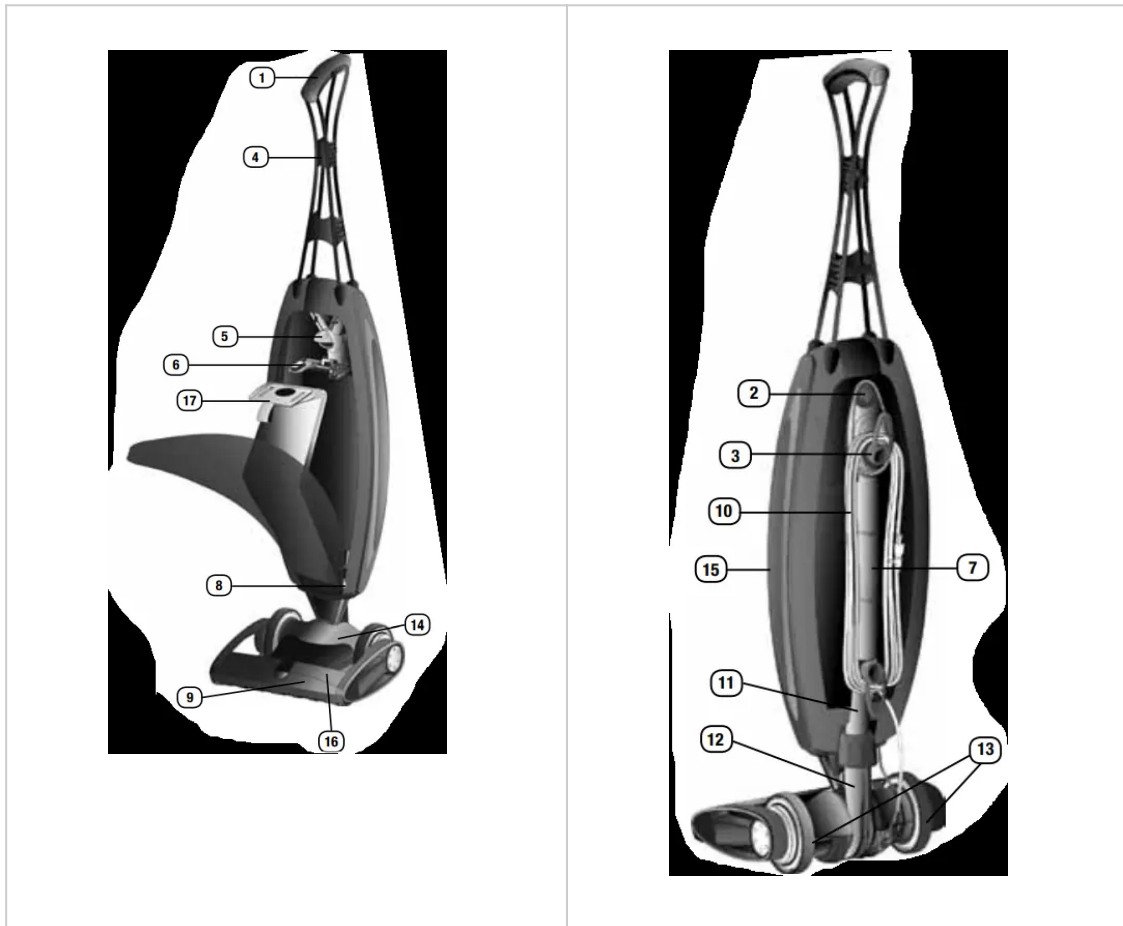

1. Handle with soft comfort grip
2. On/Off Switch
3. Cord Dump
4. Magnesium Handle
5. Deflector
6. Bag Dock
7. Carry Handle
8. Zipper
9. Main Bumper
10. Power Cord
11. Lower Tube

12. Fan Housing
13. Rear Wheels
14. Cover
15. Outer Bag
16. Power Head
17. HEPA Odor Fighting Inner Bag

ASSEMBLING THE HANDLE

<p>1. Align the four connector tabs at the bottom of the magnesium handle with the four receiving ports at the top of the outer bag and insert until a “snap” is heard.</p>	
<p>2. Snap cord assembly into the cord clip located on the back of the magnesium handle. Leave excess cord at the power head to allow movement.</p>	

Operating the Oreck Magnesium™

Make sure the disposable inner bag is in place. Do not operate the vacuum without a disposable inner bag. Plug the power cord into an electrical outlet and press the ON/OFF switch on the back of the vacuum when ready to operate. Press the button once to turn the unit on high, press a second time for low speed, and a third time to turn the unit off.

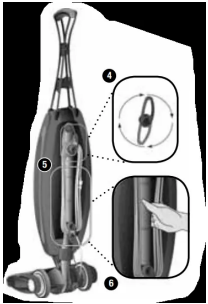
<p>3. Up-Position Lock - Place foot on power head and lean handle back gently to release lock for vacuum use. Return handle to the full upright position to engage lock.</p> <p>Note: Do not operate the vacuum while in the upright and locked position. Do not let the vacuum run while in any one stationary position for any period of time. Keep the vacuum moving while in operation.</p>	
<p>4. Cord Dump - To release cord, twist cord dump 1/2 turn. Slide cord off cord dump.</p> <p>5. Easy Power Cord Storage - Turn Cord Dump to the up position, wrap power cord around Cord Dump and lower cord bracket located below the Carry handle.</p> <p>6. Carry Handle - Carry handle located on back of the vacuum for easy lifting, carrying, and vacuuming stairs.</p>	

INNER BAG REMOVAL:

1. Unzip outer bag completely.
2. Pull tab on bag to release bag dock from connector. Bag dock door will hinge downward.
3. Gently pull bag cardboard collar outward from bag dock. Saniseal® dust seal will close automatically.

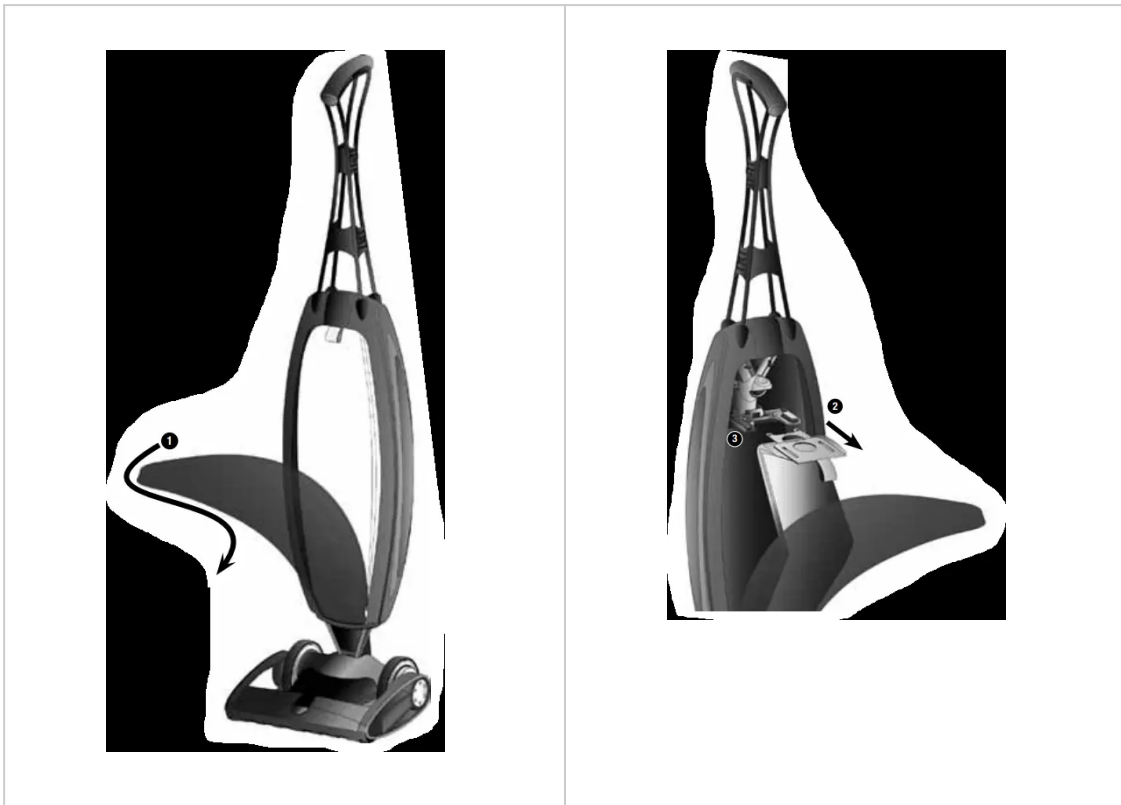

INNER BAG INSTALLATION:

4. Slide the cardboard collar completely onto bag dock door.
5. Firmly push bag dock door with both thumbs on indication point until it snaps.

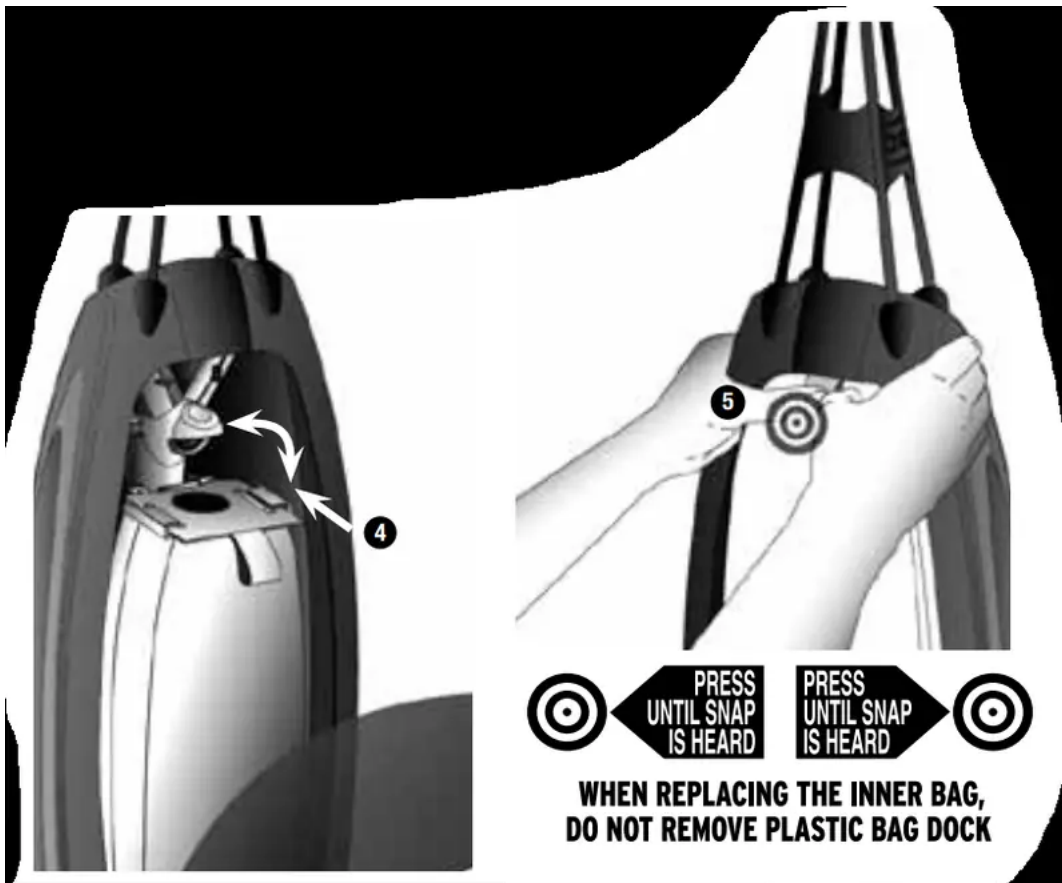

The performance of your new vacuum greatly depends upon care and maintenance. The instructions in this manual will guide you in performing basic care and maintenance. To obtain the most satisfying years of service read the instructions and keep them handy for future reference.

HEPA Odor Fighting Inner Bag

Your Oreck includes an HEPA Odor Fighting Inner Bag. The disposable inner bag plays a very important role in the efficiency of your ORECK vacuum. The purpose of the disposable inner bag is to trap dirt, but at the same time it must be porous enough to allow air to pass through. If the disposable inner bag becomes clogged, no air can pass through the vacuum and cleaning cannot take place, regardless of the vacuum's power.

To keep your upright vacuum operating at maximum efficiency, change the disposable inner bag frequently. **DO NOT FILL ABOVE THE LINE INDICATED ON THE DISPOSABLE INNER BAG.**

Be sure the disposable inner bag is installed properly. Note: All disposable inner bags are not the same. Oreck offers HEPA and nonHEPA inner bags. Your Oreck HEPA or non-HEPA inner bags have been designed to be used with the ORECK Upright vacuum. Using bags other than genuine Oreck HEPA or non-HEPA disposable inner bags will affect the cleaning ability of your vacuum and could cause damage to it.





GENERAL USE & MAINTENANCE

Simple Operating Tips:

You'll love the way your Oreck cleans under things, and is SO lightweight and easy to use.

The following are a few simple suggestions regarding its operation:

- When inserting a new disposable inner bag, first puff out and OPEN the bag.
- When the disposable inner bag is full, replace it.
- Check the disposable inner bag at least once a month.
- Do not run the vacuum over the cord. The revolving brushroll could damage the cord.
- Use caution when vacuuming over area rug edges and fringe.

- If at any time the machine does not pick up properly or makes an unusual noise, stop operation and service.
- Although your upright will pick up pins, paper clips, and other small objects, it is recommended that these be removed from the floor before you vacuum. Failure to do so may result in permanent damage to the motor suction fan and its housing.

The Belt

The Oreck Magnesium™ is equipped with the EnduroLife™ Belt, which is designed for long life and doesn't need changing.

Motor Protection/Vacuum Shutdown

If the vacuum becomes overloaded, which could occur by sucking up a large obstruction or on extremely thick carpet, the electronics are designed to shut down the vacuum. If this happens, the vacuum will be turned off and the headlights will flash. To reset the vacuum turn the unit off, wait 5 seconds, and then turn it back on. If it shuts down again there may be a large obstruction in the vacuum. See steps on clearing a blockage.

WARNING: Unplug cord from electrical outlet before servicing.

1. Clear any large obstruction or blockage from the vacuum.
2. Once the blockage is cleared, plug the vacuum back in and it will reset.

NOTE: If the vacuum continues to shut down, contact an Oreck Authorized Service Center.

Lubrication

The vacuum motor bearings are factory lubricated and sealed. Further lubrication is not required.

Brushroll Maintenance

At least once a month, check for and remove excessive lint, string or hair from the revolving brushroll. Patented cleaning grooves on the brushroll will allow easier cleaning. Wipe the outside of the vacuum with a damp cloth. Also clean the connector deflector assembly area, base of vacuum and fan housing area. If there is dust in the outer bag, vacuum it or shake it out.

A little preventative maintenance will keep your Upright vacuum looking new and will ensure continued cleaning effectiveness.

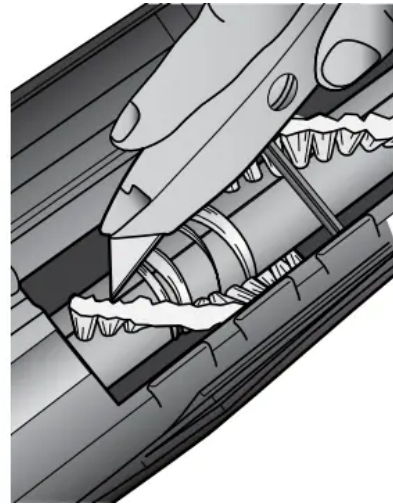

Replacing the Brushroll

The brush roll is designed for long life. Should it ever become worn or frayed, it can be replaced by an Oreck Authorized Service Center.

Stuffing or Blockage

IMPORTANT: On plush and new carpets, stuffing may occur inside the intake tube and the lower tube assembly. This is due to excessive fuzz and loose cuttings in the carpet. Stuffing could occur for the first few cleanings until all the loose material is removed. Due to the high efficiency of the vacuum, many older carpets will cause stuffing when the vacuum is first used on them. If your vacuum does not pick up properly, or makes unusual noise and the outer bag does not fluff up or balloon open, follow these steps:

WARNING: Unplug cord from electrical outlet before servicing.

1. Check for blockage at the mouth of the intake opening. If there is blockage, remove it with long-nose pliers, a screwdriver or coat hanger.
2. Twist lower collar counterclockwise to slide up. Pull tube out of base. Check for blockage. If blockage is in the tube, remove with a coat hanger.
3. If tube is not blocked, look into fan housing. Remove debris with long-nose pliers, a screwdriver or coat hanger.



4. Insert tube and push down until the tube is seated. Make sure O-ring is in place against fan housing opening.

5. To finish reassembly, replace and tighten collar clockwise until collar locking tabs are locked in place.

Note: Many times blockage occurs due to a full disposable inner bag causing dirt to back down the air flow system. When that happens, the blockage will be at the top of the system, starting in the area where the disposable inner bag connects to the connector assembly. If the above actions do not correct the problem, contact an Oreck authorized service center or call the customer service center.

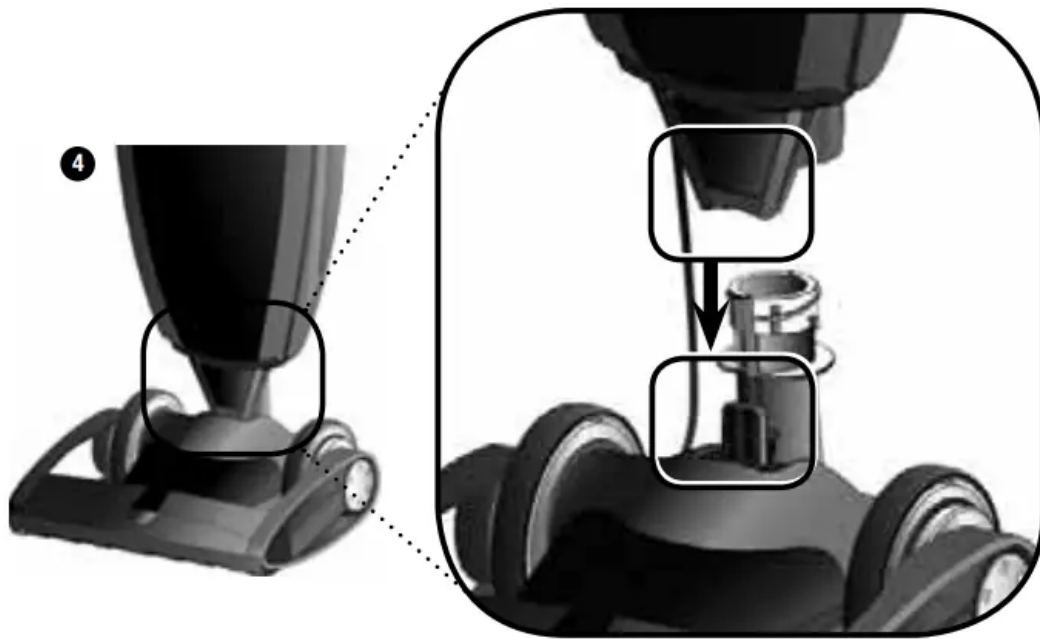

TROUBLESHOOTING

Problem	Check	What to do
Vacuum will not run	<ul style="list-style-type: none"> • Not plugged in properly. • No electricity in wall outlet. • The Brushroll is blocked. 	<ul style="list-style-type: none"> • Be sure power cord is firmly plugged into wall outlet. • Check electrical source – fuse or circuit breaker. • Clear blockage. Unit will reset
Vacuum does not pick up.	<ul style="list-style-type: none"> • Did the vacuum shutdown on very dense material or large obstruction, and did the lights flash? • Disposable Inner Bag is full. • Nozzle or intake pivot clogged. • Brush is worn. • Bag tube clogged. • Bag pores are clogged with fine dust. • Impeller fan is broken. • Brushroll is not even at both ends. 	<ul style="list-style-type: none"> • See steps on clearing an obstruction. Turn the unit off and wait 5 seconds and vacuum will reset. • You can also unplug unit and vacuum will reset. • Replace Disposable Inner Bag • Clear blockage • Contact Oreck Authorized Service Center. • Clear blockage • Change Disposable Inner Bag reek Authorized Service Center.
Vacuum still does not operate properly	<ul style="list-style-type: none"> • Check all the above points. 	<ul style="list-style-type: none"> • Contact Oreck Authorized Service Center.



IMPORTANT SAFETY INSTRUCTIONS!

WARNING!: To reduce the risk of fire, electric shock, or injury: • Do not leave appliance unattended when plugged in. Unplug from outlet when not in use and before servicing.

- Do not use outdoors or on wet surfaces.
- Do not operate the unit while in the upright and locked position.
- Do not let the unit run while in any one stationary position for any period of time. Keep the unit moving while in operation.
- Do not allow to be used as a toy. Close attention is necessary when used near children.
- Use only as described in this manual. Use only manufacturer's recommended attachments.
- Do not use with damaged cord or plug. If appliance is not working as it should, has been dropped, damaged, left outdoors, or dropped into water, return it to a service center or call customer service at: US: 1-800-989-3535 Canada: 1-888-676-7325
- Do not pull or carry by cord, use cord as a handle, close door on cord, or pull cord around sharp edges or corners.
- Keep cord away from heated surfaces.
- Do not run appliance over cord.
- Do not unplug by pulling on cord. To unplug, grasp the plug, not the cord.
- Do not handle plug or appliance with wet hands.
- Do not put any object into openings. Do not use with any opening blocked; keep free of dust, lint, hair and anything that may reduce air flow.
- Keep hair, loose clothing, fingers and all parts of body away from openings and moving parts.
- Do not use to pick up anything that is burning or smoking, such as cigarettes, matches, or hot ashes.
- Do not use without disposable inner bag assembly in place.
- Turn off all controls before unplugging.
- Use extra care when cleaning on stairs.
- Do not use to pick up flammable or combustible liquids, such as gasoline or lighter fluid, or use in areas where they may be present.
- Do not use appliance in an enclosed space where flammable, explosive or toxic vapors are given off by oil base paint, paint thinner, some mothproofing substances, or in an area where flammable dust is present.
- Do not pick up toxic material such as chlorine bleach, drain cleaner, gasoline, etc. with this appliance.

- Use caution when vacuuming over area rug edges and fringe.
- Product contains chemicals known to the State of California to cause cancer and birth defects or other reproductive harm.

CAUTION! Wood Floors, Soft (Vinyl, Asphalt Tile, etc.) Floor Surfaces and Polished Floor Finishes

Use floor and floor finish manufacturer's recommended methods of cleaning. The brushroll may also scuff very soft finishes. Do not operate the vacuum while in the upright and locked position.

Do not let the vacuum run while in any one stationary position for any period of time. Keep the vacuum moving while in operation.

Warning

This content is compiled from multiple sources and is provided for reference purposes only. It may not be complete or fully applicable to all situations. If you are unable to resolve your issue, please contact the product manufacturer or an authorized service provider for official support.