

Use Manual Earbuds

Parts and features

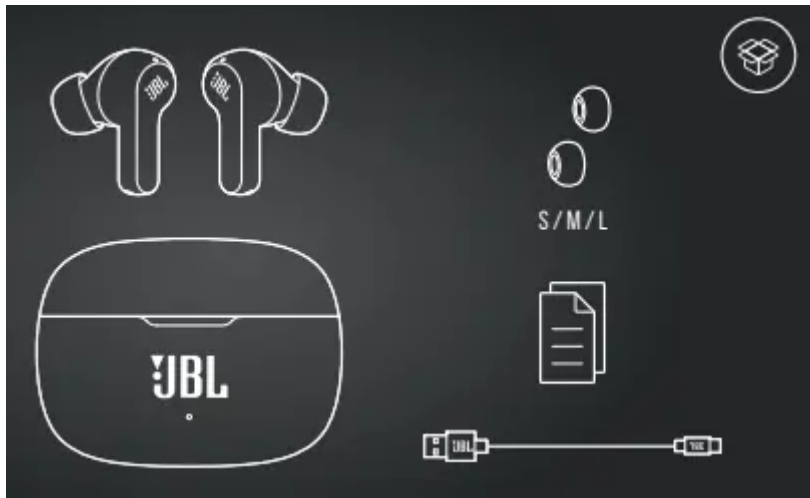

How to wear

1. Try different sizes of eartips for best fit and seal.



- 2.

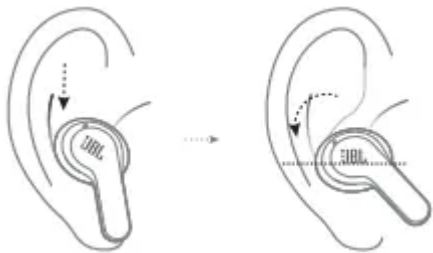

Pay attention to the first use:

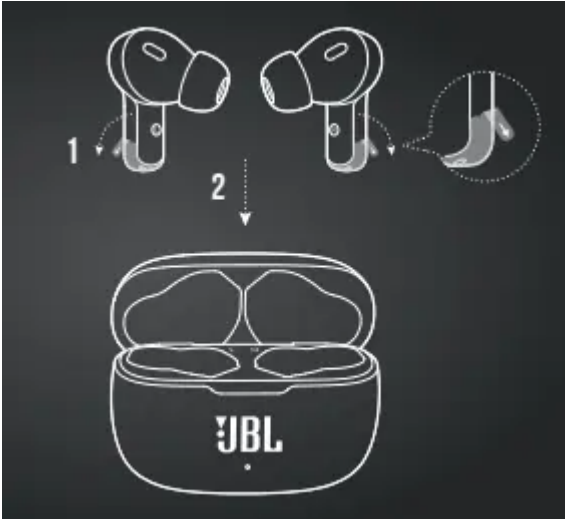

Power on and connect

1.

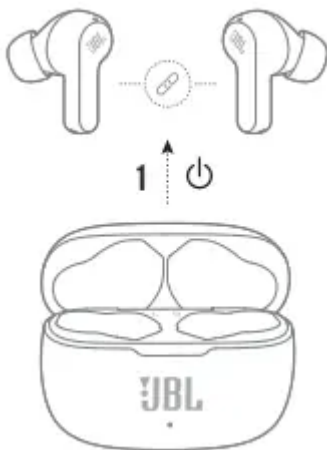

2. Choose JBL VIBE200TWS to connect.

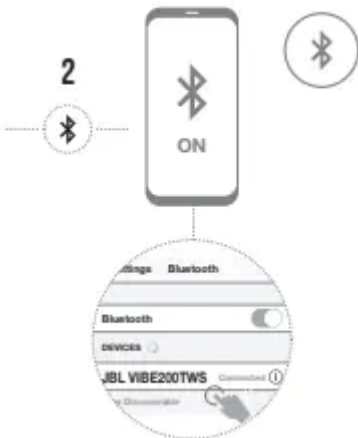

Dual connect

Stereo mode

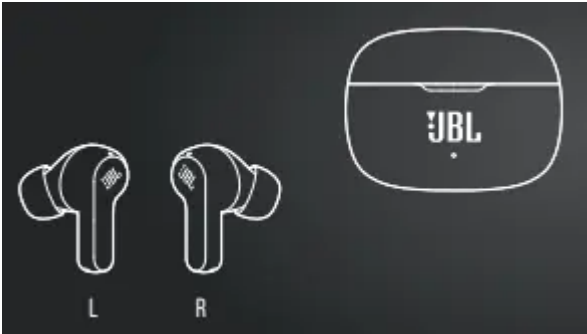

Mono mode

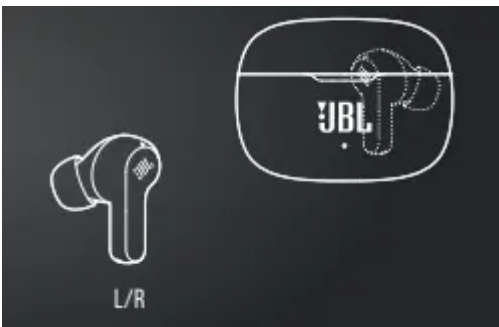

Button command

1. Stereo mode

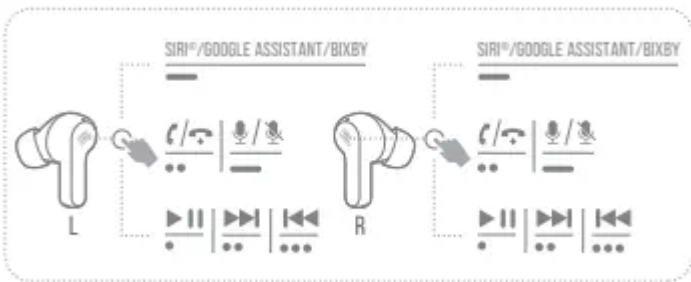

2. Mono mode

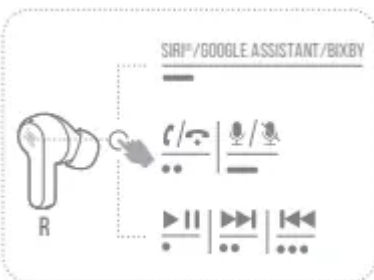

Power off

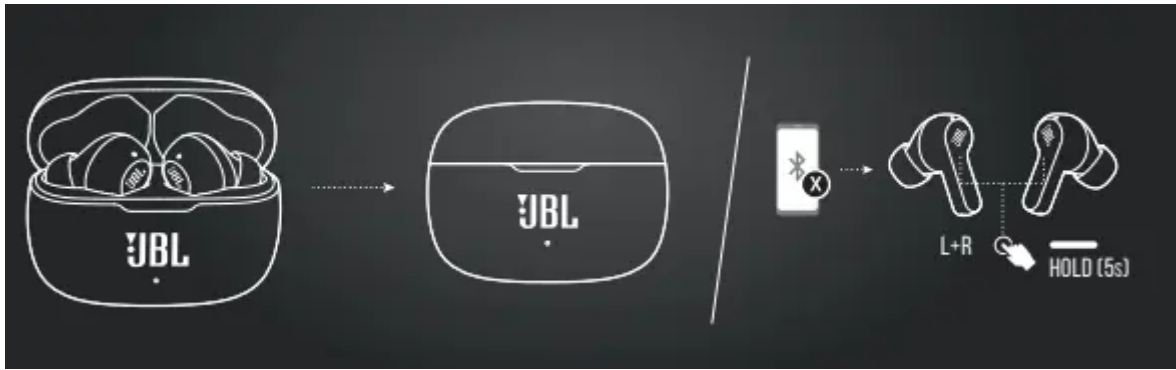

Manual controls

1. Connect to a new bluetooth device

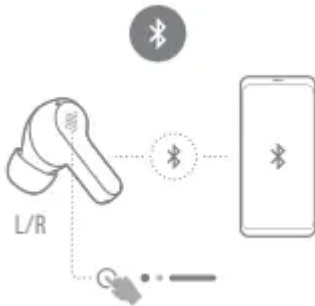

2. Reconnect left and right

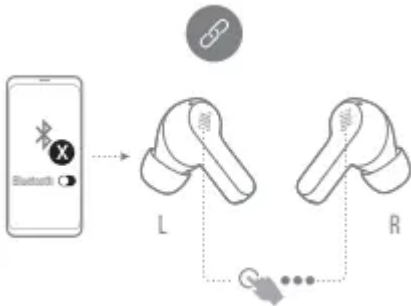

3. Factory reset

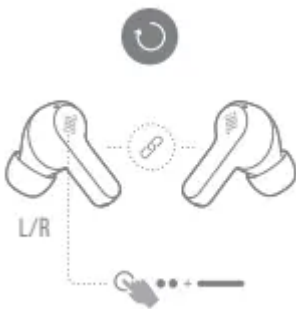

Note:

- TAP × 1
- TAP × 2
- TAP × 3
- HOLD (5s)

Charging

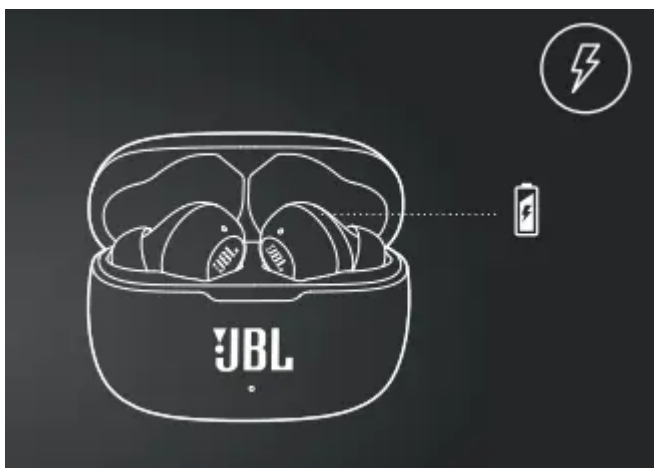
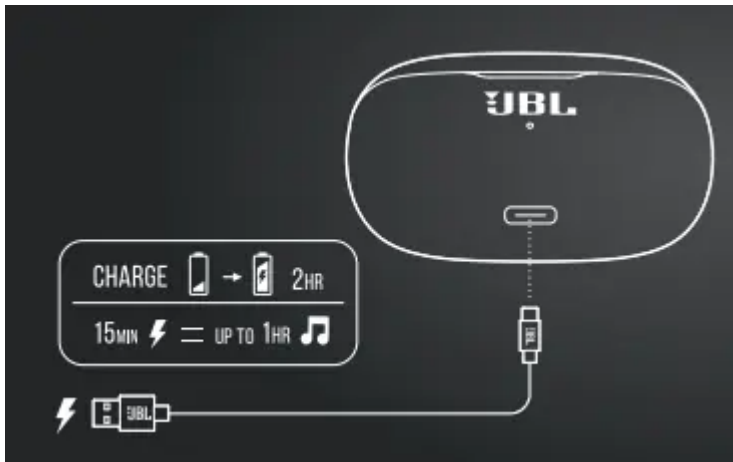

Led behaviors

LED BEHAVIORS

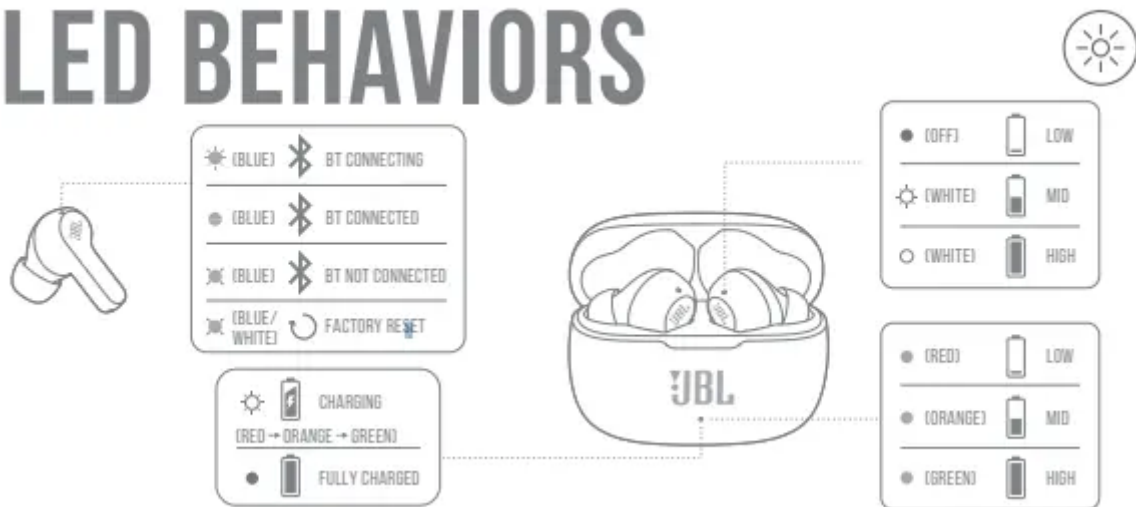

Specifications

- Model: VIBE200TWS
- Driver size: 8 mm/ 0.315" Dynamic Driver
- Power supply: 5 V 1 A
- Weight: 47.5 g/ 0.105 lbs
- Headset battery type: Lithium-ion Battery (48 mAh/ 3.7 V)
- Charging case battery type: Lithium-ion Battery(500 mAh/ 3.7 V)
- Charging time: 2 hrs from empty
- Music playtime with BT on: up to 5 hrs
- Frequency response: 20 Hz – 20 kHz
- Impedance: 16 ohm
- Sensitivity: 108dB SPL@1 kHz
- Maximum SPL: 93 dB
- Microphone sensitivity: -38 dBV/Pa @1 kHz
- Bluetooth version: 5.0
- Bluetooth profile version: A2DP V1.3, AVRCP V1.6, HFP V1.7 B
- Bluetooth transmitter frequency range: 2.400 GHz - 2.4835 GHz
- Bluetooth transmitter power: 12 dBm
- Bluetooth transmitter modulation: GFSK, $\pi/4$ QPSK, 8DPSK
- Maximum operation temperature: 45°C

Warning

This content is compiled from multiple sources and is provided for reference purposes only. It may not be complete or fully applicable to all situations. If you are unable to resolve your issue, please contact the product manufacturer or an authorized service provider for official support.

Document generated by [ManualsFile](#)