

## BEFORE USING FOR THE FIRST TIME

Fill the reservoir to the max mark, and run the appliance without coffee

## PARTS

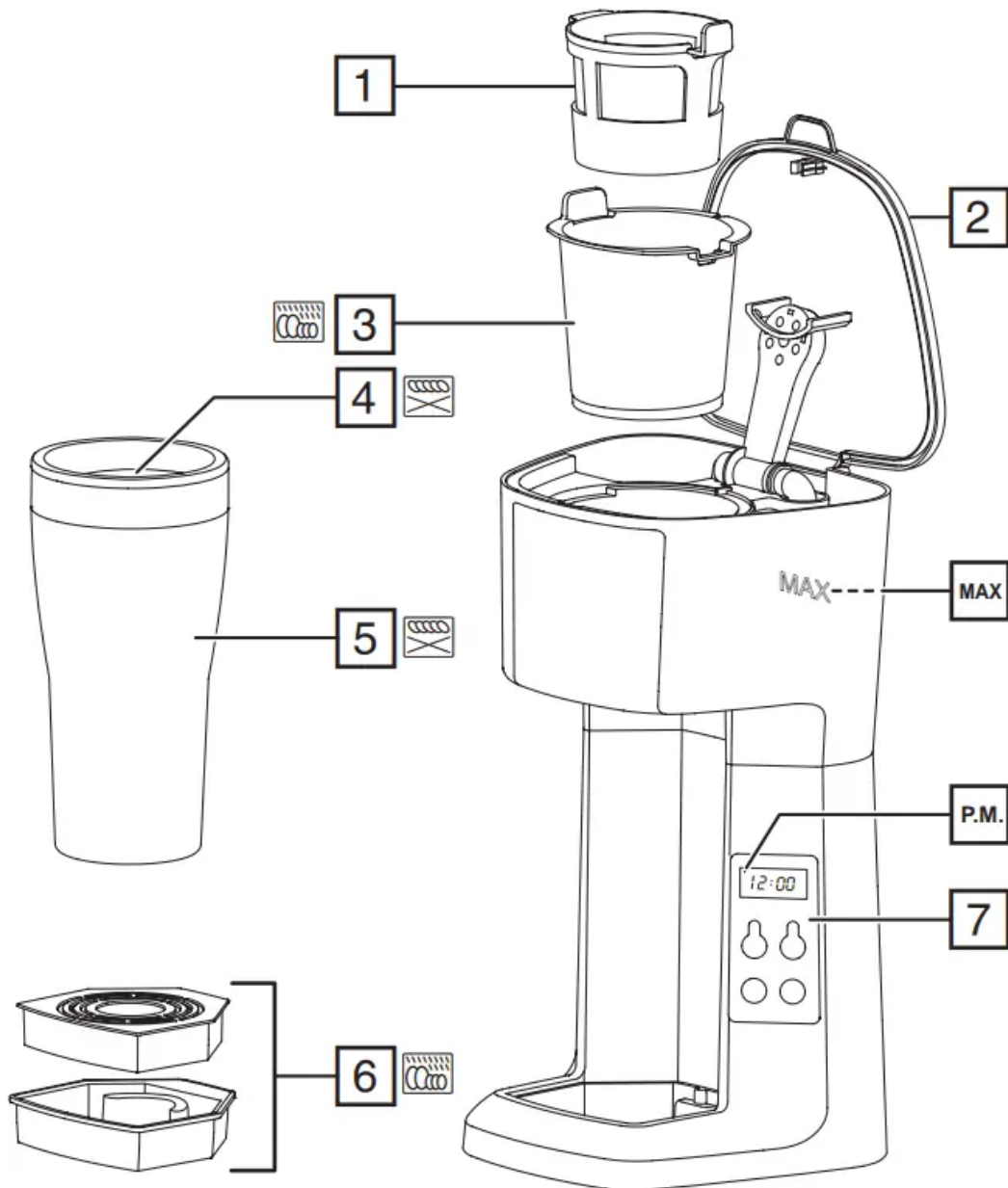

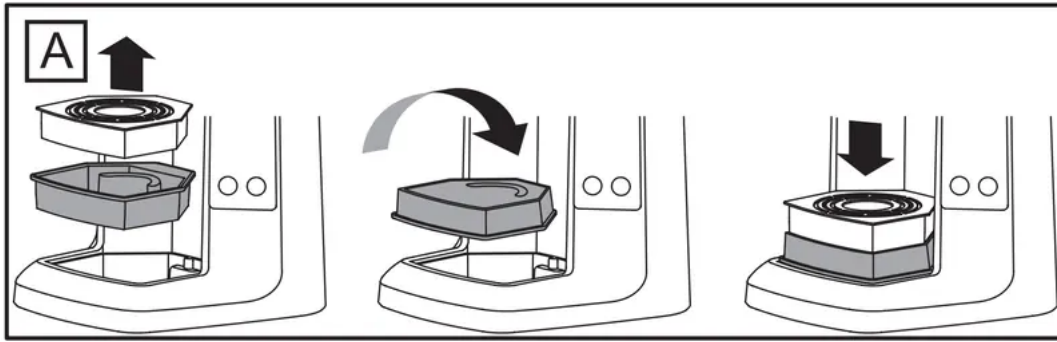

1. Permanent filter
2. Lid
3. Filter holder
4. Lid with sliding cover
5. Travel mug
6. Drip tray
7. Control panel

## SET THE CLOCK

1. Put the plug into the power socket.
2. 12:00 will blink on the display.
3. Set the clock to the correct time.
  - Use the h and min buttons to set the correct hour and minute.

A small dot in the display indicates **PM**.

The clock will retain its settings until the coffee maker is unplugged.

## MAKING COFFEE



1. Open the lid.
2. Pour fresh cold water into the reservoir up to MAX mark using the travel mug. If you are using a regular coffee mug or cup, use the cup itself to fill the reservoir. Never fill the reservoir past the MAX mark.
3. Close the lid
4. Add sweetener, cream or milk to the travel mug or cup as desired.
5. Fit the permanent filter into the filter holder.
6. For the travel mug, put approximately 20-25g of ground filter coffee into the filter. For a regular mug or cup (235 ml), use approximately 10-12g of coffee.
7. Place the travel mug or cup under the coffee maker. If using the travel mug, ensure that the sliding cover in the lid is in the open position. The tray can be adjusted in height if

you are using a regular cup (FIG A). Ensure the drip tray is securely in place before brewing.

8. Put the plug into the power socket (switch the socket on, if it's switchable).

9.



Press the  switch. The light will come on. The coffeemaker and  light turn off automatically when brewing is finished. Allow coffee to finish dripping from the unit before removing the travel mug or cup. Do not remove your mug while coffee is brewing.

10.





To cancel brewing, press the  button

## USING THE TIMER

1. Set the timer to the time you want to start brewing.

◦



Press and hold the  /AUTO button for 3 seconds. The  AUTO light will start flashing.

◦ Use the h and min buttons to set the correct hour and minute.

◦



Once the desired time is displayed press the  /AUTO button again.



The  /AUTO light will stop flashing and stay on. This indicates the time is set.

2. At the time you set, your coffee maker will start up.

3.



To cancel the timer before brewing has started, press the  /AUTO button again.

## NOTES

- Don't be tempted to reheat coffee in the appliance. You'll damage the appliance and the coffee will be undrinkable.

- Clean the filter holder after each use. Residue from a previous brew will spoil your coffee.
- The time will need to be reset if the unit is unplugged or power is interrupted.
- Be careful when opening the cover after brewing as this area is hot and steamy.

Use the lift tab located on the front of the lid.

## CARE AND MAINTENANCE

1. Unplug the appliance and let it cool.
2. Tip the contents of the filter holder into the bin.
3. Clean the outside surfaces of the appliance with a damp cloth.
4. You may clean the travel mug, permanent filter and filter holder in warm soapy water. Rinse thoroughly afterwards, to remove all traces of soap.



You may wash these parts in a dishwasher.



You may wash these parts in the top rack of a dishwasher.

### DESCALE REGULARLY

Descale the appliance at least monthly with a proprietary descaler. Follow the instructions on the package of descaler.

Products returned under guarantee with faults due to scale will be subject to a repair charge.

### IMPORTANT SAFEGUARDS

Follow basic safety precautions, including:

- This appliance can be used by children aged from 8 years and above and persons with reduced physical, sensory or mental capabilities or lack of experience and knowledge if they have been supervised/instructed and understand the hazards involved.
- Children shall not play with the appliance.
- Cleaning and user maintenance shall not be done by children unless they are older than 8 and supervised.
- Keep the appliance and cable out of reach of children under 8 years.
- Misuse of the appliance may cause injury.

**The surfaces of the appliance will get hot. Residual heat will keep the surfaces hot after use.**

- If the cable is damaged, it must be replaced by the manufacturer, its service agent, or someone similarly qualified, to avoid hazard.
- The surface of the heating element is subject to residual heat after use.
- Use the appliance according to these instructions. Any misuse may cause potential injury, electric shock or other hazards.
- This appliance can be used by persons with reduced physical, sensory or mental capabilities or lack of experience and knowledge if they have been given supervision or instruction concerning use of the appliance in a safe way and understand the hazards involved.
- This appliance is intended to be used in household and similar applications such as:
  - staff kitchen areas in shops, offices and other working environments;
  - by clients in hotels, motels and other residential type environments;
  - bed and breakfast type environments;
  - farm houses.
- Do not use this appliance near bathtubs, showers, basins or other vessels containing water.
  - Sit the appliance on a stable, level, heat-resistant surface.
  - Keep the appliance and cable away from the edges of worktops.
  - Don't use accessories or attachments other than those we supply.
  - Don't use the appliance for any purpose other than those described in these instructions.
  - Don't use the appliance if it's damaged or malfunctions.

**Warning**

This content is compiled from multiple sources and is provided for reference purposes only. It may not be complete or fully applicable to all situations. If you are unable to resolve your issue, please contact the product manufacturer or an authorized service provider for official support.