

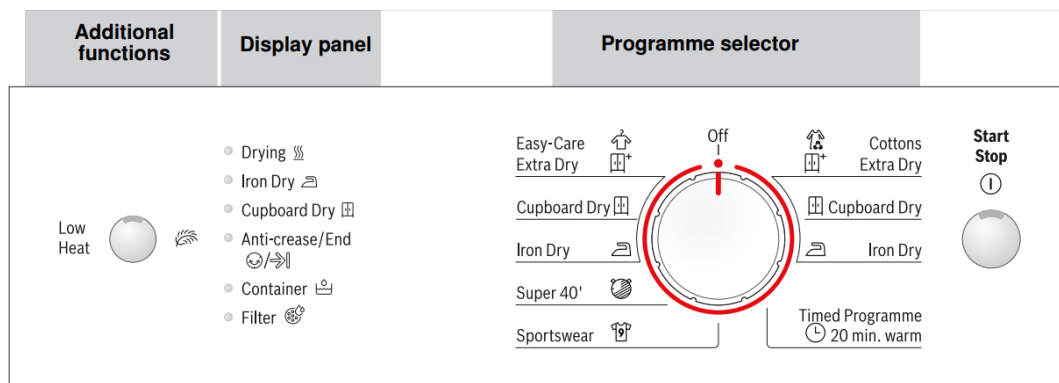







Selecting and adjusting the programme



1. Select the drying programme
2. and adapt to individual requirements

3. Press the  Start/Stop button

 Low Heat	Service indicators  Container  Filter	Empty the condensate container. Clean the fluff filter and/or air cooler under running water
	Fine adjustment of the drying result	The drying result (e.g. Cupboard Dry) can be adjusted over three levels (1 - max. 3) 0, 1, 2, 3 for the   Cottons,  Easy-Care and  Super 40' programmes apresetting = 0. After one of these programmes has been finely adjusted, the setting is retained for the others. Further information

Setting the programmes



Emptying condensation

After each drying cycle, empty the condensate container; otherwise the next drying programme may be cancelled as a result of the condensate container being full.

1. Pull out condensate container keeping it horizontal.
2. Pour out condensation.

3. Always push container in fully until it clicks into place. If  Container flashes in the display panel aWhat to do if..

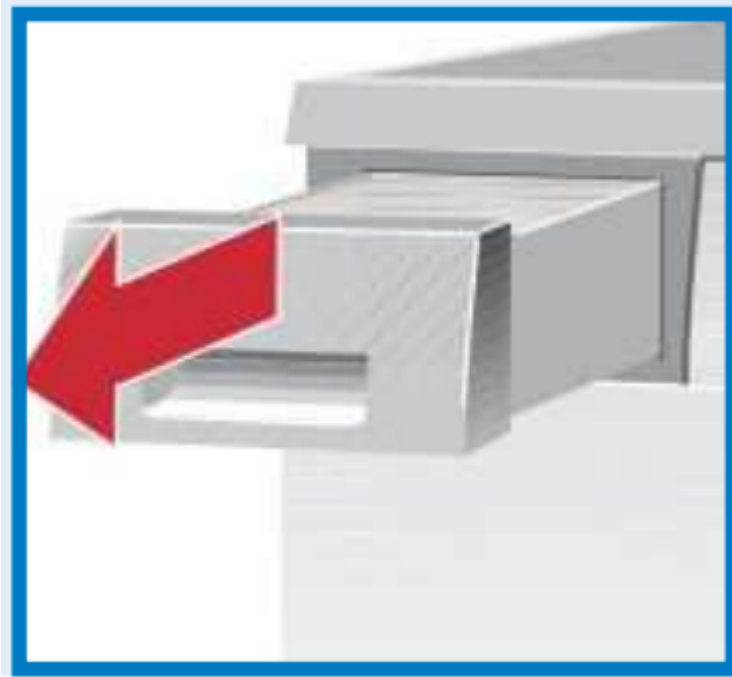

Cleaning the fluff filter

Clean the fluff filter after each drying operation.

1. Open the door, remove fluff from door/door area.
2. Pull out and fold open the fluff filter.
3. Remove the fluff (by wiping the filter with your hand). If the fluff filter is very dirty or blocked, rinse with warm water and dry thoroughly.
4. Close and reinsert the fluff filter.

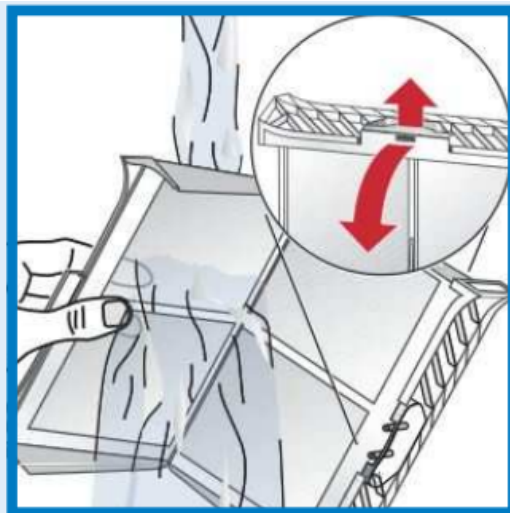



Switching off the dryer

Turn the programme selector to Off. Do not leave laundry in the dryer.

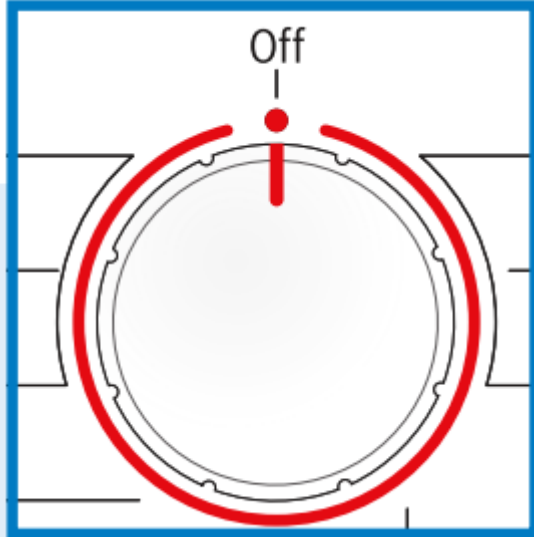

Removing the laundry

The automatic anti-crease function causes the drum to move at specific intervals, the

washing remains loose and fluffy for an hour (two hours if the additional

Reduced Ironing function is also selected depending on model).

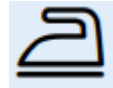

Drying

Programme end (once lights up in the display).



1. Open door, the drying process is interrupted.
2. Load or remove laundry and close door.

3. If required, select a new programme and additional functions. 4. Press the Start/Stop button.



Information on laundry



Labelling of fabrics

Follow the manufacturer's care information.



Drying at normal temperature.



Drying at low temperature → also select



Low Heat.



Do not machine dry.

Drying tips

– To ensure a consistent result, sort the laundry by fabric type and drying programme.

- Always dry very small items (e.g. baby socks) together with large items of laundry (e.g. hand towel).
- Close zips, hooks and eyelets, and button-up covers. Tie fabric belts, apron strings, etc. together.
- Do not over-dry easy-care laundry → risk of creasing! Allow laundry to finish drying in the air.
- Do not dry woolens in the dryer, only use to freshen them up , → Woollens finish Programme (depending on model).
- Do not iron laundry immediately after drying, fold items up and leave for a while → the remaining moisture will then be distributed evenly.
- The drying result depends on the type of water used during washing → Fine adjustment of the drying result
- Machine-knitted fabrics (e.g. T-shirts or jerseys) often shrink the first time they are



dried → do not use the Extra Dry programme.

- Starched laundry is not always suitable for dryers → starch leaves behind a coating that adversely affects the drying operation.
- Use the correct dosage of fabric softener as per the manufacturer's instructions when washing the laundry to be dried.
- Use the timer programme for small loads → this improves the drying result.

Environmental protection / Energy-saving tips

- Before drying, spin the laundry thoroughly in the washing machine → the higher the spin speed the shorter the drying time will be (consumes less energy), also spin easy-care laundry.
- Put in, but do not exceed, the maximum recommended quantity of laundry → programme overview
- Make sure the room is well-ventilated during drying. – Do not obstruct or seal up the air inlet.
- Keep the air cooler clean → “Care and cleaning”.

Fine adjustment of the drying result

Adjustment of the levels of dryness

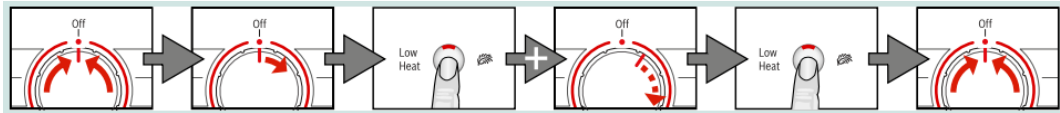

1. Turn to Off

2. 1 x to the right

3.



Press and hold Low Heat and turn 5 x to the right

4.



Press Low Heat until the required level is reached

5. Turn to Off

Drying, Iron Dry, Cupboard Dry, Anti-Crease/End are displayed in sequence. Short signal when changing from level 3 to 0, otherwise long signal

0	1	2	3

Care and cleaning

Dryer housing, control panel, air cooler, moisture sensors

- Wipe with a soft, damp cloth.
- Do not use harsh cleaning agents and solvents.
- Remove detergent and cleaning agent residue immediately.



Clean the protective filter 5 - 6 times a year or if Filter flashes after cleaning the fluff filter.

Air cooler / Protective filter

When cleaning, only remove the protective filter. Clean the air cooler behind the protective filter once a year.

– Allow the dryer to cool.

– Residual water may leak out, so place an absorbent towel underneath the maintenance door

1. Unlock the maintenance door.
2. Open the maintenance door fully.
3. Turn both locking levers towards each another.
4. Pull out the protective filter/air cooler.
5. Clean the protective filter/air cooler thoroughly, Allow to drip dry.
6. Clean the seals.
7. Re-insert the protective filter/air cooler, with the handle facing down.
8. Turn back both locking levers.
9. Close the maintenance door until the lock clicks into place.

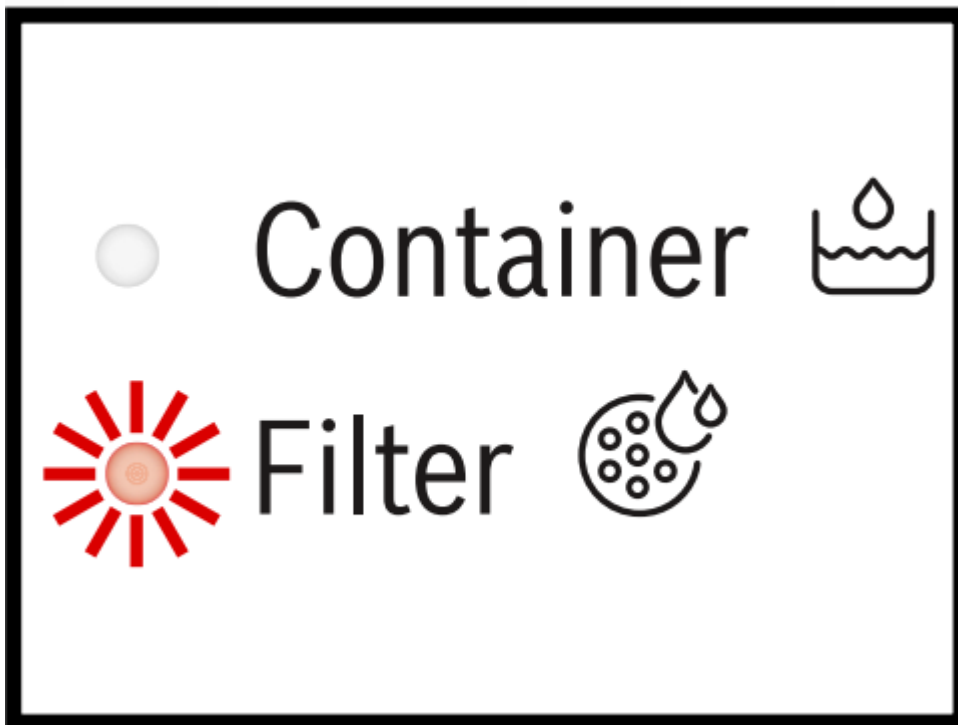

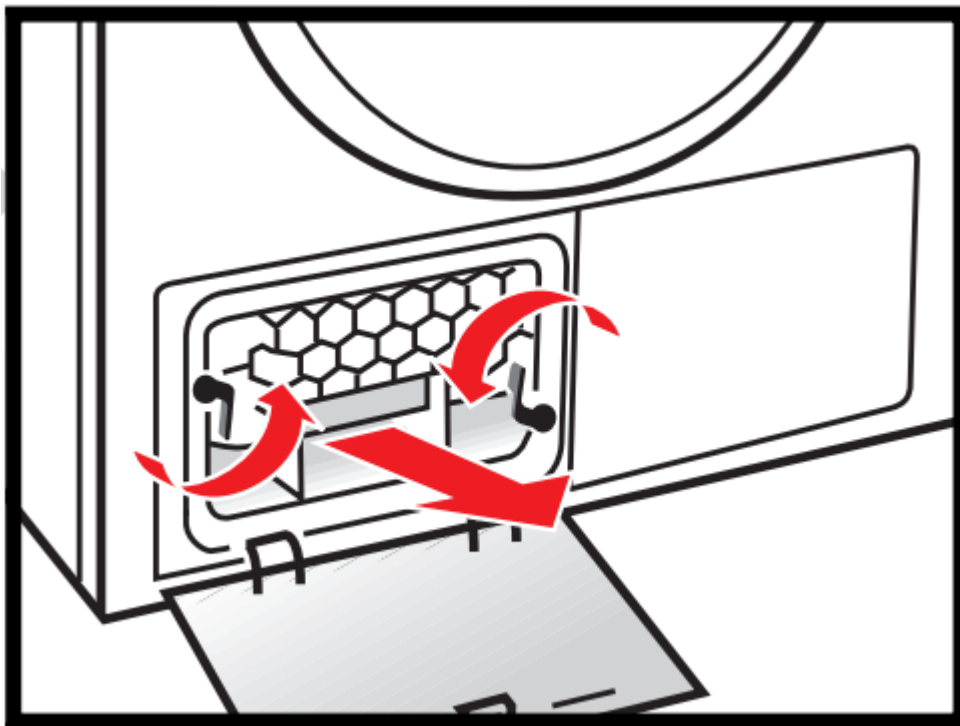
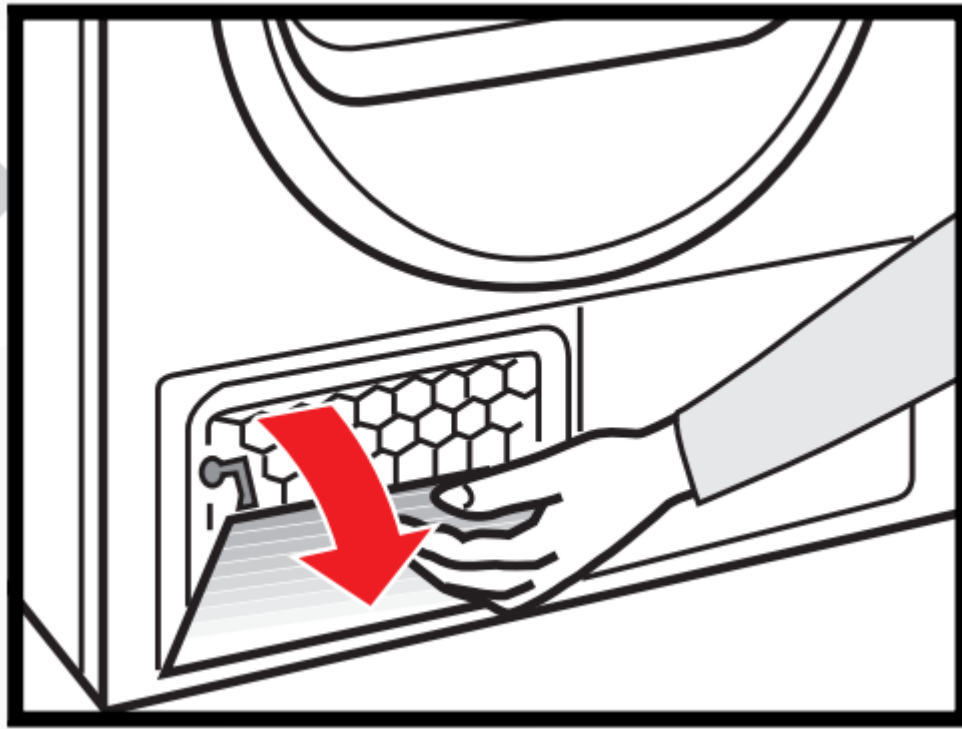

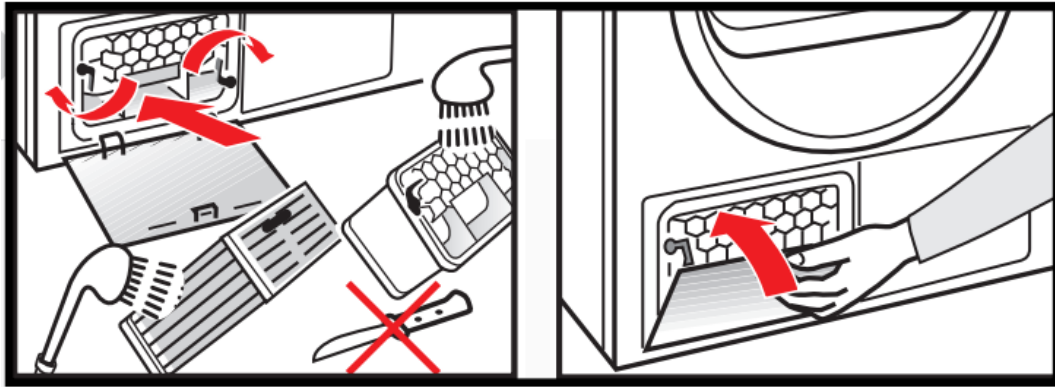

Moisture sensors

The dryer is fitted with stainless steel moisture sensors. The sensors measure the level of moisture in the laundry. After a long period of operation, a fine layer of limescale may form on the sensors.

1. Open the door and clean the moisture sensors with a damp sponge which has a rough surface.



Programme overview

After drying...	iron laundry	lightly iron laundry	do not iron laundry	mangle laundry
PROGRAMMES	TEXTILE TYPE AND INFORMATION			
* Cottons	max. 7 kg	Hard-wearing fabrics, boil-resistant fabrics made of cotton or linen.		
* Easy-Care	max. 3.5 kg	Non-iron laundry made of synthetic fibres and blended fabric, easy-care cotton.		
Iron Dry		Fabrics suitable for ironing (iron fabrics in order to avoid creasing).		
Cupboard Dry		Single-layer fabrics.		
Extra Dry		Fabrics made of thick, multilayered items of clothing.		
Timed Programme 20 min. warm	max. 3 kg	Pre-dried, multi-layered, sensitive fabrics made of acrylic fibres, or separate small items of laundry. Also for subsequent drying.		
Super 40'	max. 2 kg	Laundry made of synthetic fibres, cotton or blended fabrics (for example) that needs to be dried quickly. The values may differ from the those specified depending on the type of fabric, mixture of laundry to be dried, residual moisture in the fabric and loading capacity.		
Sportswear	max. 1.5 kg	Fabrics with membrane coating, water-repellent fabrics, functional clothing, fleece fabrics (dry jackets/trousers with removable internal lining separately).		

*Dryness levels can be selected individually → Extra Dry, Cupboard Dry and Iron Dry (depending on the model). Degree of dryness can be finely adjusted; multi-layered textiles require a longer drying time than single-layered items of clothing. Recommendation: Dry separately.

Installation

- Delivery specification: dryer, instructions for installation and use, woollens basket (depending on model).
- Check dryer for transport damage.
- The dryer is very heavy. Do not attempt to lift it on your own.
- Be careful to avoid sharp edges.
- Do not lift the dryer by any of the protruding parts (e.g. the door) as they may break off.
- Do not set up in a room that is susceptible to frost. Freezing water may cause damage.
- If in doubt, have the appliance connected by an expert.

1. Setting up the dryer

- The appliance plug must always be accessible.
- Ensure that the appliance is installed on a clean, level and solid surface.
- Keep the cooling grille at the front of the dryer unobstructed.
- Keep the area around the dryer clean.
- Make the dryer level using the threaded feet and a spirit level. Do not remove the threaded feet under any circumstances.

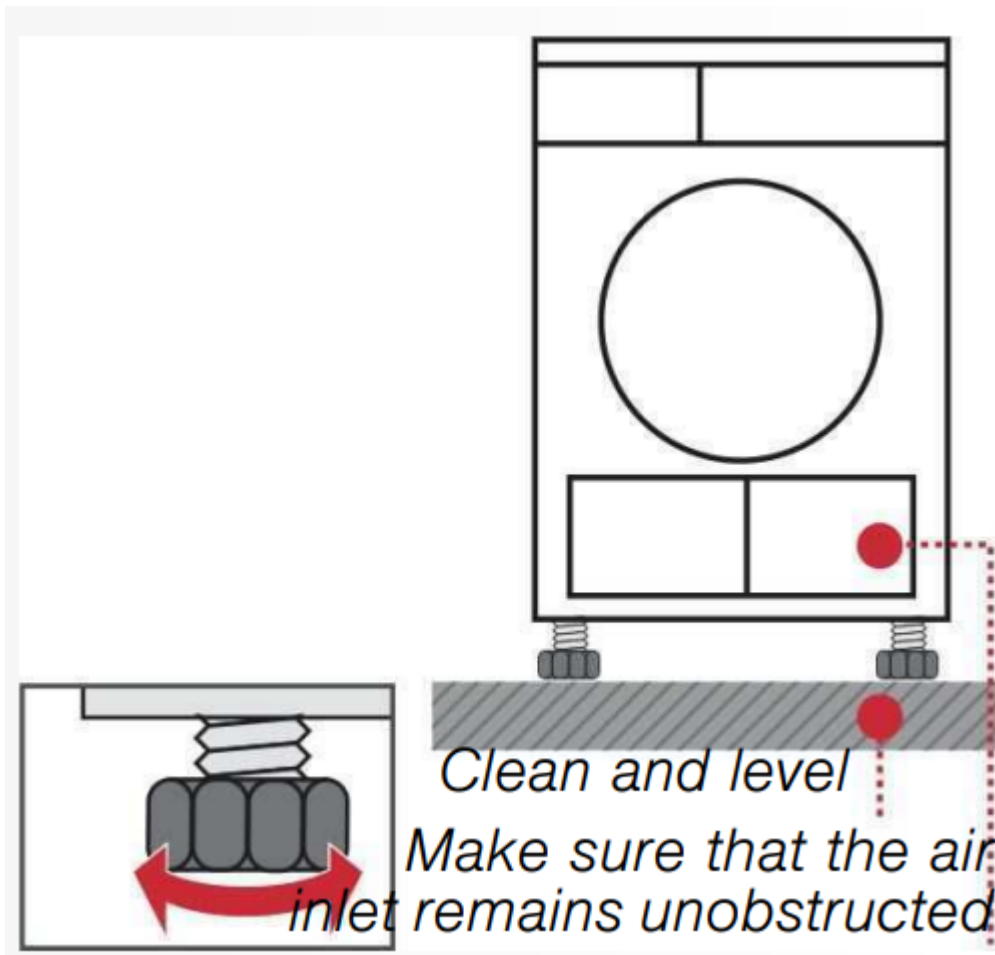

2. Mains connection see safety instructions

- Connect to an AC earthed socket. If in doubt have the socket checked by an expert.
- The mains voltage and the voltage shown on the rating plate must correspond.
- The connected load and necessary fuse protection are specified on the rating plate.

3. Converting the installed load (Note the fuse protection of the socket.)

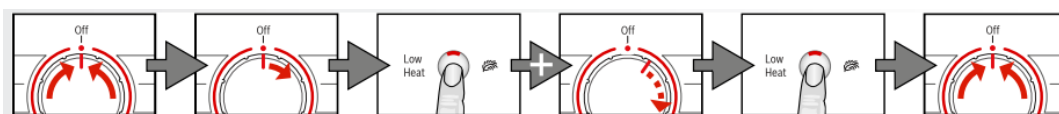

The values for the energy label are determined using a circuit breaker/fuse rating of 16 A. If the circuit breaker/fuse rating is changed to 10 A, the drying time and energy consumption will be higher. You can find details on this in the consumption values table.



- turn to Off
- 1 x to the right

- Press and hold selection then turn 3 x to the right
- set amperage
- turn to Off

Feedback (depending on model):

10 A	Lo		<input type="radio"/> off
16 A	h ₁		 flashes

Frost protection / Transport



Preparation

1. Empty the condensate container
2. Select any programme using the programme selector.
3. Press the  Start/Stop button → condensation is pumped into the container.
4. Wait 5 min. and then empty the condensate container again. 5. Turn the programme selector to Off.

Technical data

Dimensions (DxWxH) : 60 x 60 x 85 cm (height adjustable)

Weight approximately : 45 kg

Max. capacity : 7 kg

Condensate container : 4.2 l

Connection voltage

Connected load



Fuse protection : see appliance rating plate

Ambient temperature

Product number/

Production number

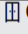
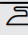
Consumption values table

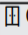
Fabrics/ programmes	Residual moisture in the fabrics after spinning		Drying time**		Energy consumption**	
			10 A	16 A	10 A	16 A
 Cottons 7 kg						
 Cupboard Dry*	1400 U/min	(50%)	122 min	95 min	3.73 kWh	3.60 kWh
	1000 U/min	(60%)	142 min	111 min	4.35 kWh	4.20 kWh
	800 U/min	(70%)	164 min	128 min	4.98 kWh	4.80 kWh
 Iron Dry*	1400 U/min	(50%)	102 min	74 min	2.69 kWh	2.59 kWh
	1000 U/min	(60%)	121 min	88 min	3.40 kWh	3.28 kWh
	800 U/min	(70%)	142 min	100 min	4.11 kWh	3.96 kWh
 Easy-Care 3.5 kg						
 Cupboard Dry*	800 U/min	(40%)	48 min	42 min	1.39 kWh	1.35 kWh
	600 U/min	(50%)	60 min	51 min	1.70 kWh	1.65 kWh

* Programme setting for testing in accordance with applicable EN61121 standard.

** The values may differ from those specified, depending on the type of fabric, composition of laundry to be dried, residual moisture in the laundry, the degree of dryness that has been set, the amount of laundry being loaded, the environmental conditions, and any additional functions that have been activated.







Optional accessories

Connection fittings for condensation outlet

The condensation is conveyed directly via a hose.

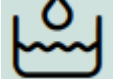
What to do if



<p>The  Start/Stop indicator lamp does not light up.</p>	<p>Mains plug plugged in? Programme selected? Check the socket fuse.</p>
<p>The display panel light and indicator lights (depending on model) go out and the  Start/Stop indicator light flashes.</p>	<p>Energy-saving mode is activated → a see the separate Energy saving mode instructions.</p>
<p>The  Container and  Start/Stop indicator lights are flashing.</p>	<p>Empty the condensate container. If featured, check hose for condensation outlet.</p>
<p>The  Filter and  Start/Stop indicator lights are flashing.</p>	<p>Clean the fluff filter and/or air cooler under running water</p>
<p>Dryer does not start.</p>	<p> Start/Stop button selected? Door closed? Ambient temperature greater than 5°C? The optimum ambient temperature for drying is between 5 °C and 35 °C.</p>
<p>Water is running out.</p>	<p>Align dryer horizontally. Clean air cooler seal.</p>
<p>The door opens by itself.</p>	<p>Push the door closed until you hear it engage.</p>
<p>Creasing.</p>	<p>Laundry load exceeded? Remove articles of clothing immediately after the end of the programme, hang up and pull into shape. Unsuitable programme selected</p>
<p>Laundry is not dried correctly or is still too damp Laundry is not dried correctly or is still too damp.</p>	<p>After the end of the programme, warm laundry feels damper than it actually is. Spread the laundry out and allow the heat to disperse.</p>

	<p>Finely adjust the dryness level – this extends the drying time but does not increase the temperature. Your laundry will become drier.</p> <p>Select a programme with a longer drying time or increase the drying level. This does not increase the temperature. Select a time programme for extended drying of laundry that is still damp.</p> <p>If you have exceeded the maximum load for the programme, the laundry may not be dried correctly.</p> <p>Clean the moisture sensor in the drum. A fine layer of limescale may adversely affect the performance of the sensors and your washing will not dry properly.</p> <p>Drying has been interrupted as a result of a power cut, because the condensate container is full or because the maximum drying time has been exceeded.</p>
Drying time too long.	<p>Rinse the fluff filters under running water</p> <p>Insufficient supply of air → ensure that air can circulate.</p> <p>Air inlet possibly blocked → Clear inlet .</p> <p>Ambient temperature higher than 35 °C → ventilate the room. The optimum ambient temperature for drying is between 5 °C and 35 °C. Outside of this range, the drying time may increase.</p>
The humidity in the room increases significantly.	Make sure the room is sufficiently ventilated.
Power failure.	Remove laundry from the dryer immediately and spread out. This allows the heat to dissipate. Be careful as the door, the drum and the laundry may be hot.
One or more indicator lights for programme status are flashing.	<p>Clean filter and air cooler</p> <p>Check installation conditions</p>

Switch off, leave to cool down, switch on again,
restart programme.

Warning

This content is compiled from multiple sources and is provided for reference purposes only. It may not be complete or fully applicable to all situations. If you are unable to resolve your issue, please contact the product manufacturer or an authorized service provider for official support.

Document generated by [ManualsFile](#)