

## Safety information

### CRITICAL USAGE WARNINGS

- Do not insert the power plug into a wall socket with wet hands.
- Do not store articles on the top of the appliance.
- When you open or close the door, the articles may fall and cause personal injury and/or material damage.
- Do not insert hands, feet or metal objects such as knives, etc.) into the bottom or the back of the refrigerator.
- This may result in an electric shock or injury.
- Any sharp edges may cause a personal injury
- Do not put a container filled with water on the refrigerator.
- If spilled, there is a risk of fire or electric shock.
- Children should be supervised to ensure that they do not play with the appliance.
- Keep fingers out of “pinch point” areas.
- Clearances between the doors and cabinet are necessarily small. Be careful when you open the doors when children are in the area.
- Do not let children hang on the door. A serious injury may occur.
- Do not let children go inside the refrigerator.
- Children could become trapped.
- Do not insert your hands into the bottom area under the appliance.
- Any sharp edges may cause personal injury.
- Do not let children step on a drawer cover.
- The drawer may break and cause them to slip.
- Do not overfill the refrigerator with food

### USAGE CAUTIONS

1. Use only the ice maker provided with the refrigerator.
2. Have the refrigerator's water supply connected only to a potable water supply. To operate the ice maker properly, water pressure of 20 ~ psi (138 ~ 862 kPa) is required. If you will be away from home for a long period of time on vacation, for example) and won't be using the water or ice dispensers, close the water valve.
3. Otherwise, water leakage may occur.

4. If you won't be using the refrigerator for a very long period of time, (3 weeks or more) empty the refrigerator including ice bucket, unplug it, close the water valve, wipe excess moisture from the inside walls, and leave the doors open to prevent odors and mold.

## **CLEANING CAUTIONS**

1. Do not directly spray water on the inside or outside the refrigerator.
2. There is a risk of fire or electric shock.
3. Do not use a hair dryer to dry the inside of the refrigerator. Do not place a lighted candle in the refrigerator to remove bad odors.
4. This may result in an electric shock or fire.
5. Remove any foreign matter or dust from the power plug pins. Do not use a wet or damp cloth when cleaning the plug.
6. Otherwise, there is a risk of fire or electric shock.
7. Before cleaning or performing maintenance, unplug the appliance from the wall socket.
8. Failing to do so may result in an electric shock or fire.
9. Use a clean sponge or soft cloth and a mild detergent in warm water to clean the refrigerator.
10. Do not use abrasive or harsh cleansers such as window sprays, scouring cleansers, flammable fluids, muriatic acid, cleaning waxes, concentrated detergents, bleaches, or cleansers containing petroleum products on exterior surfaces (doors and cabinet), plastic parts, door and interior liners, and gaskets.
11. These can scratch or damage the material.
12. Do not clean glass shelves or covers with warm water when they are cold. Glass shelves and covers may break if exposed to sudden temperature changes or impacts such as bumping or dropping.

## **ADDITIONAL TIPS FOR PROPER USAGE**

- In the event of a power failure, call the local office of your Electricity Company and ask how long it is going to last.
- Most power failures that are corrected in an hour or two will not affect your refrigerator temperatures. However, you should minimize the number of door openings while the power is off.
- But Should the power failure last more than hours, remove and discard all frozen food.
- The appliance might not operate consistently frozen contents can thaw or temperatures can become too warm in the frozen food compartment) when sited for an extended

### Setting up your French Door Refrigerator

- Selecting the best location for the refrigerator

**Choose :**

- A location with easy access to a water supply.
- A location without direct exposure to sunlight.
- A location with a level floor.
- A location with enough space for the refrigerator doors to open easily.
- A location that allows sufficient space to the right, left, back and top for air circulation.
- A location that allows you to move the refrigerator easily if it needs maintenance or service.
- Do not install the refrigerator in locations where the temperature is over 110 °F (43 °C) or below 50 °F (10 °C).
- Do not locate the refrigerator where it may become wet.
- If the refrigerator does not have enough space, it can cause the bad influence to refrigeration efficiency and power consumption.
- If your refrigerator has an ice maker, allow extra space at the back for the water line connections.
- When you install the refrigerator next to a fixed wall, you need a minimum clearance of 3 ¾" (mm) between the refrigerator and wall to allow the door to swing open.

**Important :**

- Make sure that you can easily move your refrigerator to its final location by measuring doorways (both width and height), thresholds, ceilings, stairways, etc.
- The following chart details the exact height and depth of this Samsung French Door Refrigerator.

## Setting up

**Getting ready to install the refrigerator**

- Congratulations on your purchase of this Samsung French Door Refrigerator.
- We hope you enjoy the state-of-art features and efficiencies that this new appliance offers.
- Selecting the best location for the refrigerator

**Choose :**

- A location with easy access to a water supply.
- A location without direct exposure to sunlight.
- A location with level (or nearly level) flooring.
- A location with enough space for the refrigerator doors to open easily.

- A location that allows sufficient space to the right, left, back, and top for air circulation.
- If the refrigerator does not have enough space, it can cause the bad influence to refrigeration efficiency and power consumption.
- A location that allows you to move the refrigerator easily if it needs maintenance or service.
- Do not install the refrigerator in locations where the temperature is over 110 °F (43 °C) or below 50 °F (10 °C).
- If your refrigerator is not level, the internal cooling system may not work correctly.
- Refer to drawing and dimensions below for overall space required for use.

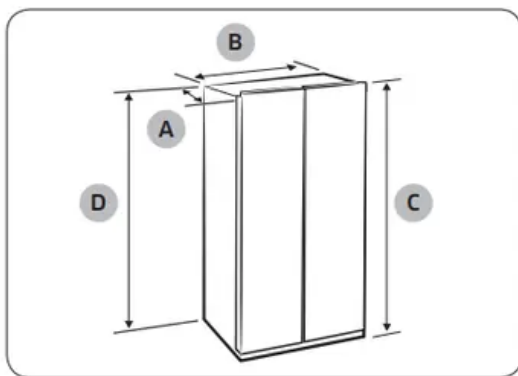

<b>Depth "A"</b>	34" (864 mm)
<b>Width "B"</b>	35 3/4" (908 mm)
<b>Height "C"</b>	68 1/2" (1740 mm)
<b>Overall Height "D"</b>	70" (1776 mm)

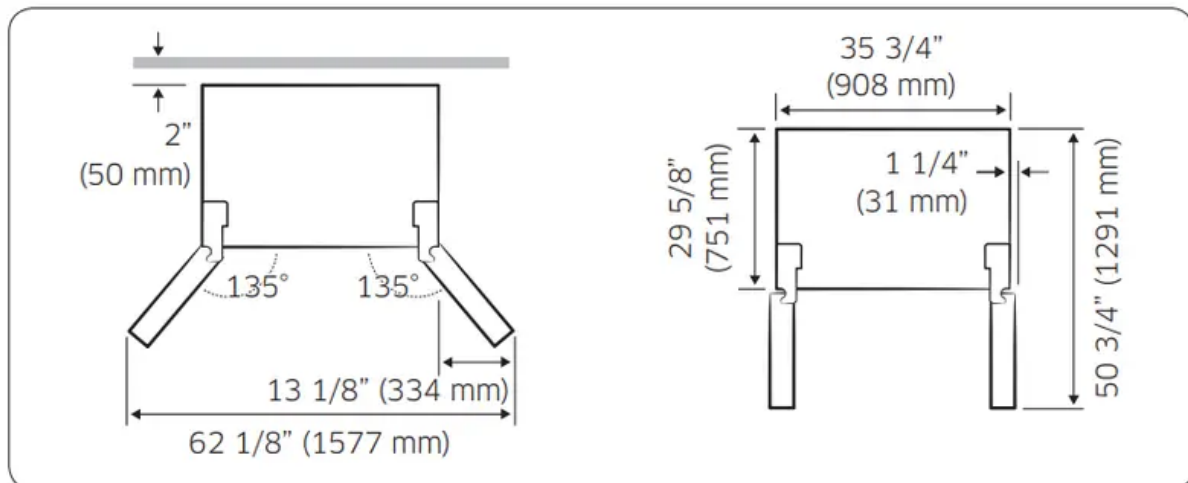

## Flooring

1. For proper installation, you must place this refrigerator on a level, hard surface that is the same height as the rest of the floor.
2. This surface should be strong enough to support a fully loaded refrigerator.
3. To protect the finish of the flooring during installation, cut a large section of the cardboard carton and place it under the refrigerator where you are working.
4. When moving the refrigerator, you need to pull and push it straight forwards or back.

5. Do not wiggle it from side to side.

### CAUTION

1. When installing, servicing or cleaning behind the refrigerator, be sure to pull the unit straight out and push back in straight after finishing.
2. Important: Make sure that you can easily move your refrigerator to its final location by measuring doorways (both width and height), thresholds, ceilings, stairways, etc.
3. The following chart details the exact height and depth of this Samsung Side by Side

Refrigerator.



### Installing the handles

- Important: If you need to remove the refrigerator's doors to move it into place, install the handles after you put the doors back on.
- Take the handles out of the right side door.

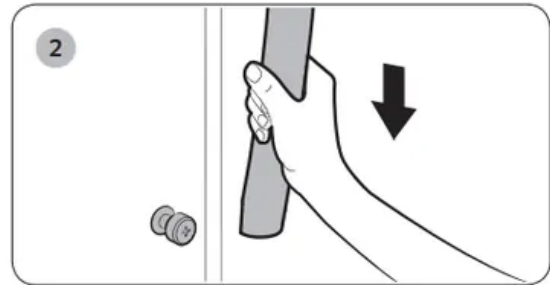
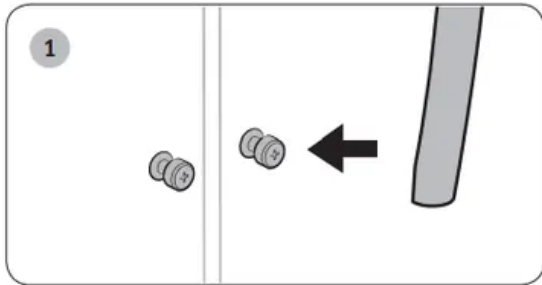
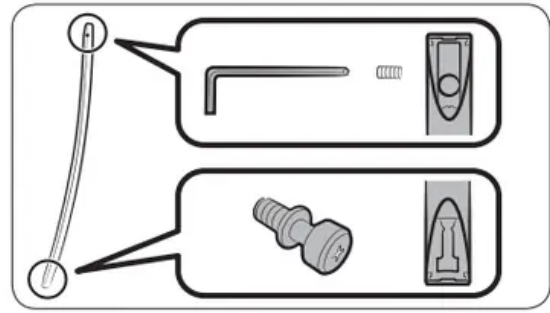
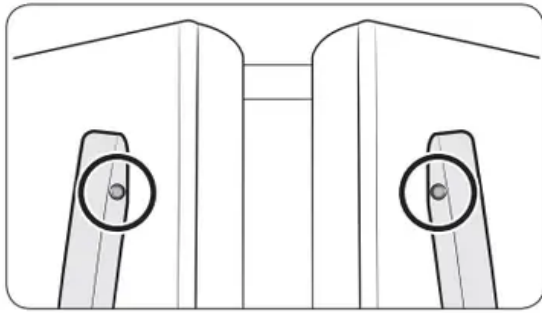

### How to install the handles

1. Orient each handle so that the end with the sticker attached is at the top and the holes with the tightening screws are facing each other.
2. Then, follow the directions below to install each handle.

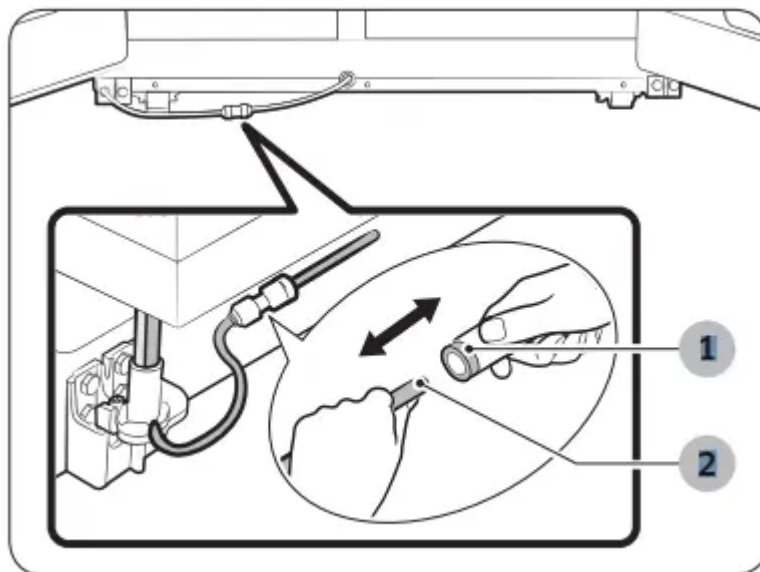

### Removing the refrigerator doors

1. If your entrance won't allow the refrigerator to pass easily through it, you can remove the refrigerator doors.
2. To remove the doors, follow the steps below.
3. If you do not need to remove the doors, go to "Leveling the refrigerator" on page 31.
4. Separate the water supply line from the refrigerator

5. Remove one or two water lines, depending on the model, by pressing each coupler (1) and pulling the water lines (2) away.

#### NOTE

- Your refrigerator may have one or two water lines, depending on the model.
- If it has two, the lines are different colors. Make sure you match the colors when you re-attach them.

#### CAUTION

1. Do not cut the water line.
2. Gently separate it from the coupler.

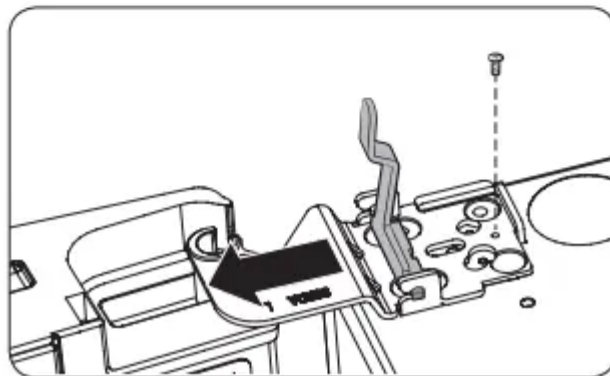
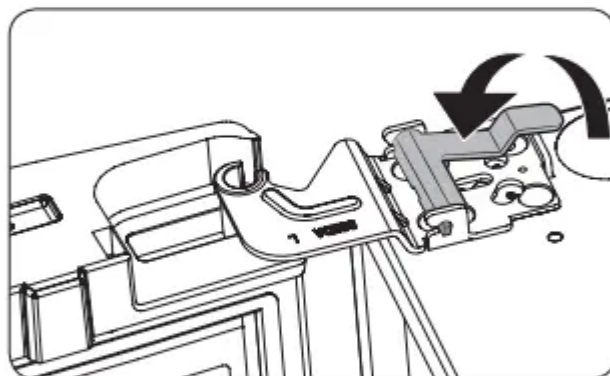
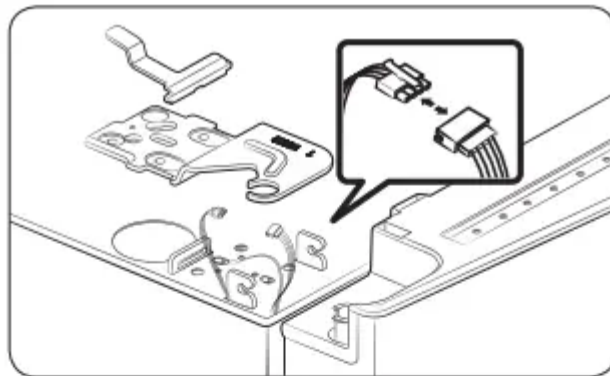

1. A few things to mention first.
2. Make sure that you lift the door straight up so the hinges are not bent or broken.

3. Be careful not to pinch the water tubing and wire harness on the door.
4. Place doors on a protected surface to prevent scratching or damage.
5. Is necessary, have two people disassemble the doors.
6. With the Freezer door closed, remove the upper hinge cover (1) using a screwdriver, and then disconnect the wires by gently pulling them apart (2).

**NOTE**

- Be careful not to damage the sensor harness with the hinge cover.2. Disconnect the electrical harness.
- Gently lift the clamp.

**NOTE**

- To prevent damage to the clamp or injuries, do not lift the clamp forcefully.
- Pull the clamp to remove.
- Remove the ground screw by turning it counter-clockwise.
- Open the door by 90 degrees. While holding the door, remove the hinge.

**CAUTION**

If you remove the hinge without holding the door, the door may fall and cause injury



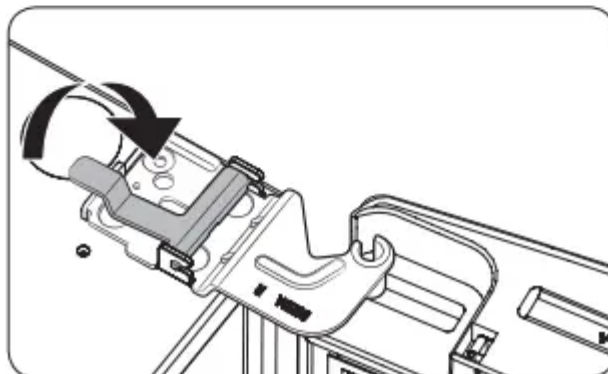
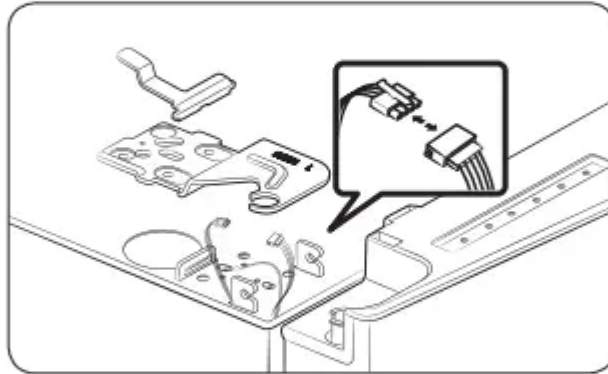
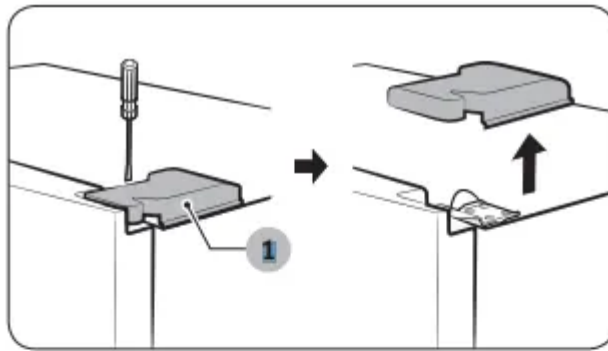

### Remove the fridge door

- With the door closed, remove the upper hinge cover (1) using a screwdriver.
- Disconnect the electrical harness.
- Gently lift the clamp.

### NOTE

- To prevent damage to the clamp or injuries, do not lift the clamp forcefully

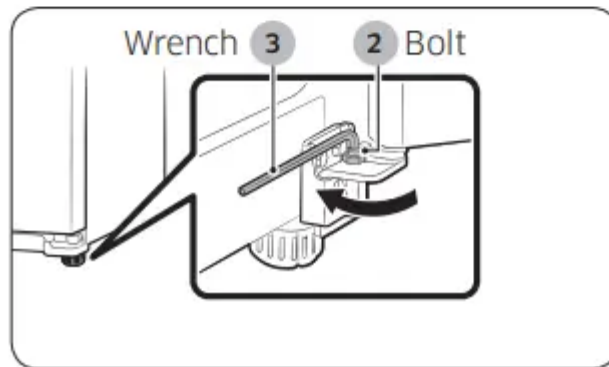
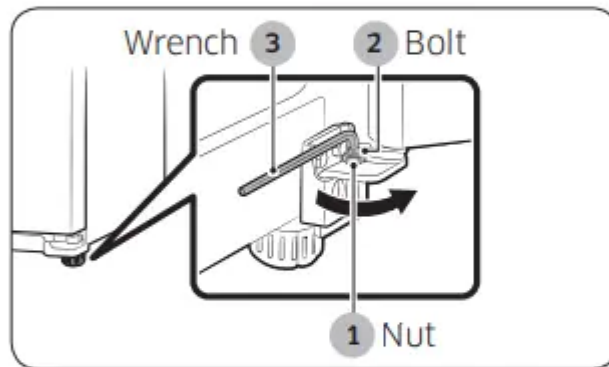
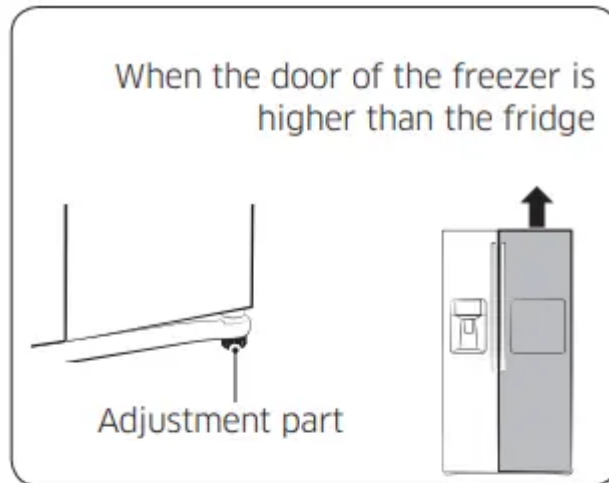

### Re-attaching the Water Supply Lines

#### Center of transparent coupler clip A (1/4" mm)

- The Water Lines must be fully Inserted into the center of the transparent coupler to prevent water leakage from the dispenser.
- Insert the 2 clips in the install pack as shown below, and then confirm that each clip holds the line firmly
- Before levelling the refrigerator, remove the front leg cover.

- Open both the freezer and refrigerator doors.
- Unscrew the three screws holding the front leg cover in place by turning them counterclockwise.
- When the screws are loose, remove the front leg cover.
- When the Freezer part is lower than the Fridge part.
- Insert a flat-blade screwdriver into a slot on the Freezer Leg, then turn it clockwise.
- When the Fridge part is lower than the Freezer part.

### **Leg Screw Driver**

- Insert a flat-blade screwdriver into a slot on the Fridge Leg, then turn it clockwise.

### **NOTE**

1. Refer to the next section for the best way to make very minor adjustments to the doors.
2. Making minor adjustments between doors
3. A level refrigerator is necessary for getting the doors perfectly even.
4. Make sure your refrigerator is level before you begin.
5. If you need help leveling, review the previous section on leveling the refrigerator.
6. When the door of the freezer is higher than the fridge

### **Adjustment part**

- The process for adjusting each door is the same.
- Open the doors and adjust them, one at a time, as follows:
- Bolt 1. Unscrew the nut (1) from the lower hinge until it reaches the upper end of the bolt (2).

### **NOTE**

1. When you release the nut (1), make sure that you use the hex wrench provided to loosen the bolt (2) in a counterclockwise ( ) direction.
2. You should then be able to unscrew the nut (1) with your fingers.
3. Wrench 3 2 Bolt 2. Adjust the height difference between the doors by turning the bolt (2) clockwise ( ) or counter clockwise

### **NOTE**

- When you turn clockwise ( ), the door will move up.

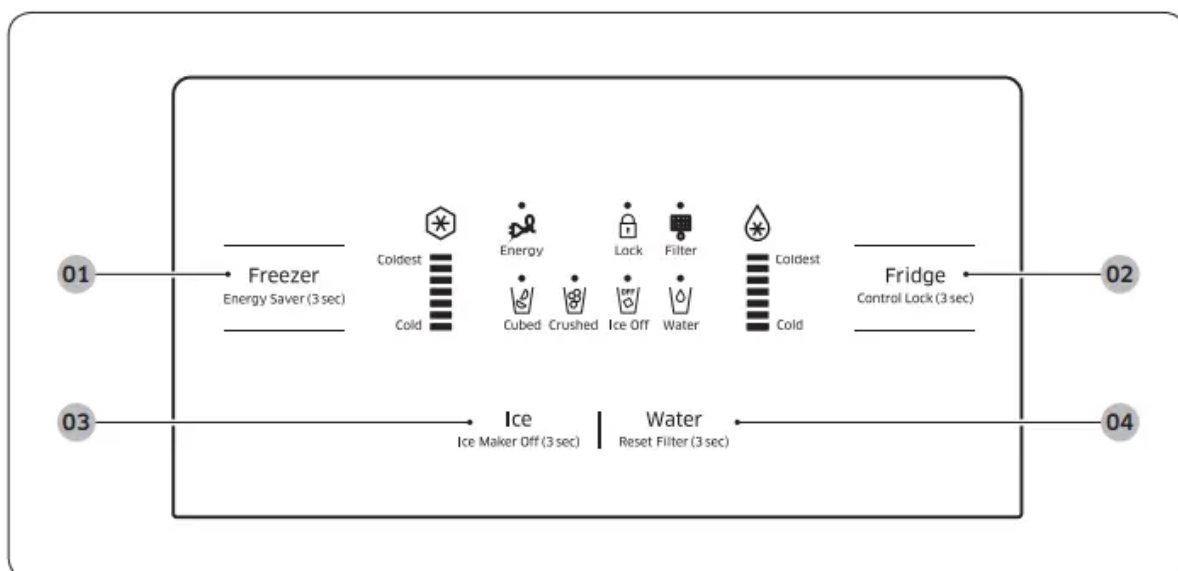

### Installing the water dispenser line

1. A water dispenser is one of the helpful features on your new Samsung Refrigerator.
2. To help promote better health, the Samsung water filter removes unwanted particles from your water.
3. However, it does not sterilize or destroy microorganisms.
4. You may need to purchase a water purifying system to do that.
5. The water line also connects to the ice maker.
6. For the ice maker to operate properly, water pressure of 20 ~ 125 psi (138 ~ 862 kPa) is required.
7. If the refrigerator is installed in an area with low water pressure (below 20 psi), you can install a booster pump to compensate for the low pressure.
8. After you have connected the water line, make sure the water storage tank inside the refrigerator is properly filled.
9. To do this, press the water dispenser lever until water runs from the water dispenser.

### Connecting to the water supply line

1. Cold water line
2. Pipe clamp
3. Shut off valve
4. Water line installation kit
5. First, shut off the main water supply line and turn the ice-maker off.

### NOTE

- The refrigerator should NOT be plugged in at this point.

- Locate the nearest cold water drinking water line.
- Install the pipe clamp and shut off valve.
- Connect the water line installation kit to the shut off valve.

### Completing the set up

- Now that you have your new refrigerator installed in place, you are ready to set up and enjoy the features and functions of the appliance.
- By completing the following steps, your refrigerator should be fully operational.
- Make sure your refrigerator is in an appropriate location with reasonable clearance between it and the wall. Refer to installation instructions in this manual.
- Once the refrigerator is plugged in, make sure the interior light comes on when you open the doors.
- Set the Temperature control to the coldest temperature and wait for an hour.
- The freezer will get slightly chilled and the motor will run smoothly.
- Reset the refrigerator and freezer to the temperatures you want.
- After you plug the refrigerator in, it will take a few hours to reach the appropriate temperature.
- You can store food and drinks in the refrigerator after the temperature is sufficiently cool.

## Operating

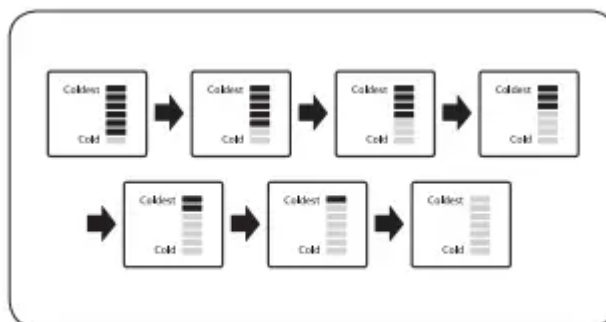

### Freezer /Energy Saver sec

- Press the Freezer button to set the freezer temperature between cold and coldest.
- Press Freezer button for several times to activate the Power Freeze icon which speeds up the freezing process in the freezer.
- This can be helpful if you need to quickly freeze items that spoil easily or if the temperature in the freezer has warmed dramatically
- For example, if the door was left open).

- If you need to freeze a large amount of food, activate the Power
- Freeze function at least 20 hours before you put the food into the freezer.
- Press and hold the Freezer button for 3 seconds to activate the
- Energy Saver function for better energy efficiency.
- If condensation occurs on the doors, turn the Energy Saver function off.

### **Fridge Control Lock**

1. Press the Fridge button to set the Fridge temperature between cold and coldest.
2. Press and hold the Fridge button for several times to activate the
3. Power Cool function which speeds up the cooling process in the refrigerator.
4. If you press and hold the Fridge button for 3 seconds, all buttons will be locked and the dispenser pad will not work.

### **Ice Maker Off**

1. Press the Ice button to select cubed ice or crushed ice.
2. Press and hold the Ice button for 3 seconds to turn the ice making function off. Press and hold the Ice button again for 3 seconds to turn the ice making function back on.
3. Note that Ice Maker Off mode will be deactivated if you press and hold the ice lever (marked "ICE" on the lever) for more than 5 seconds.

### **Water / Reset Filter (3 sec)**

- Press the Water button to turn the water dispenser on.
- Press and hold the Water button for 3 seconds after changing the filter to reset the water filter indicator.

### **Using the control panel Freezer / Fridge (Temperature adjustment)**

- Press the Freezer or Fridge button until the desired temperature is set. For a lower temperature, press the Freezer or Fridge button until more LEDs light (colder).
- For a higher temperature, press the Freezer or Fridge button until fewer LEDs light (less cold). Each time you press the Freezer or Fridge button, the temperature indicator changes in the order shown below.

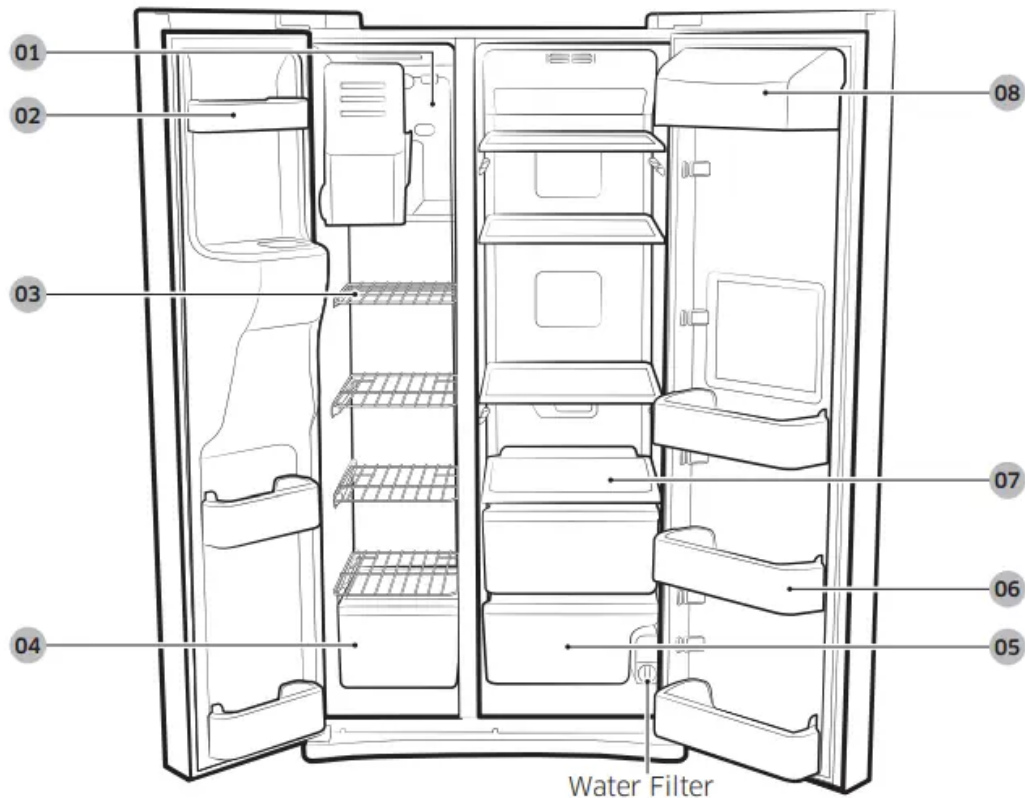

### Power Freeze

1. This icon lights when you activate the Power Freeze function. Power Freeze function generates cool air for 50 hours continuously, chilling the freezer more quickly.
2. This function is useful when you need to decrease the temperature in the freezer quickly or to make more ice rapidly.
3. When the freezer is cold enough or you have enough ice, just press the Freezer button again to cancel the Power Freeze function.

### NOTE

- When you use this function, the energy consumption of the refrigerator may increase. Remember to turn it off when you do not need it and return the freezer to your original temperature setting

### Control Lock

- This icon lights when you activate the Lock function. When the Lock icon is lit, all the panel buttons, including the Ice button and the dispensers, are locked and de-activated.
- Press and hold the Fridge button for 3 seconds to turn Lock off and re-activate the panel buttons.

## Display Off

- To conserve energy, the Panel Display turns off automatically under the following conditions: When no button has been pressed, when no doors have been opened, or when no Dispenser Lever has been pushed for a period of time.
- However, the icon indicating your Water or Cubed / Crushed selection, stays on. When you press a button, open a door, or push a Dispenser Lever, the Panel Display turns on again.
- Except for the Water and Ice buttons, all function buttons will become operational after you remove your finger from the button you are currently pressing.

## Cooling Off Mode Demo Mode/Shop Mode

1. Cooling Off mode (also called Shop mode or Demo mode) is designed for use by retailers when they display refrigerators on the shop floor.
2. In Cooling Off mode, the refrigerator's fan motor and lights work normally, but the compressors do not run, and the refrigerator and freezer do not get cold.
3. To start Cooling Off mode, Press and hold the Freezer button, the Ice button and the Fridge button for 5 seconds during normal operation.
4. The refrigerator chime sounds and
5. Animation(Freezer/Fridge Temperature
6. Indicator moveing) appears on the display

## Using the water dispenser

- Press the Water button on the control panel.
- Place your glass under the water outlet, and then push against the dispenser pad until you hear a click.
- Make sure the glass is in line with the dispenser to prevent the water from splashing out.

## To get colder water

- The dispensed water is cool, not icy cold.
- When you want colder water, dispense ice into your glass first before filling it with water to prevent water from splashing out.

## Using the ice dispenser

1. Press the Ice button to select the type of ice you want.
2. Place your glass under the ice outlet, and then push gently against the dispenser pad.
3. Make sure the glass is in line with the dispenser to prevent the ice from bouncing out.
4. When cubed ice is selected after you have dispensed crushed ice, a small amount of residual crushed ice might be produced.

## Storing food

- The Samsung Side-By-Side Refrigerator has been designed to provide you with maximum space saving features and functions.
- Here are some of the customized compartments we have created to keep your food fresher, longer.

Important : To prevent odors from penetrating the ice in the ice maker, store all food securely in wraps or containers that are as airtight as possible.

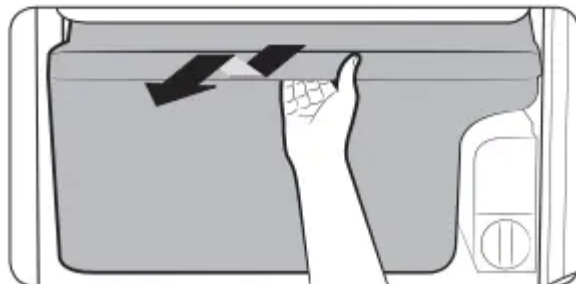
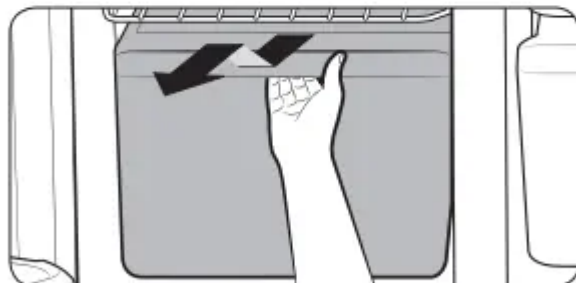
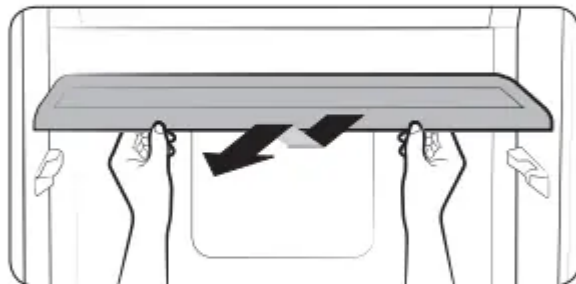
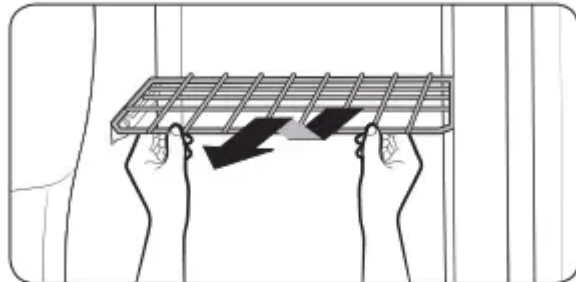
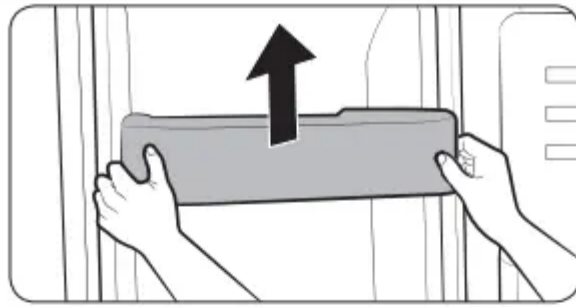

- Removing the freezer/fridge accessories

### Door Bins

- To remove, firmly grab the door bin with both hands and lift it up gently.

### Shelves

1. Pull the shelf out as far as it goes.

2. Then lift it up and remove it.
3. Wire Shelf/Glass Shelf)

### Drawer

1. To remove, pull the drawers out as far as they go, and then lift up slightly and pull.
2. Drawer/Fruit & Vegetable Drawer)

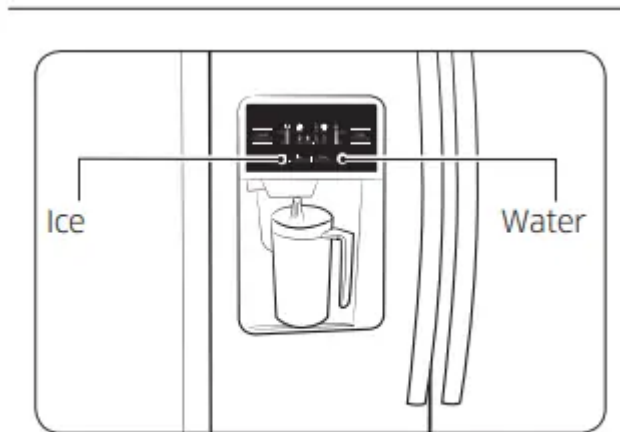

### Cleaning the refrigerator

- Caring for your Samsung Side-By-Side Refrigerator prolongs the life of your appliance and helps keep it odor and germ-free.

### Cleaning the Interior

1. Clean the inside walls and accessories with a mild detergent, and then wipe dry with a soft cloth.
2. You can remove the drawers and shelves for a more thorough cleaning.
3. Just make sure to dry them before putting them back into place.

### Cleaning the Exterior

1. Wipe the digital panel and display panel with a clean, soft cloth.
2. Spray water onto the cleaning cloth instead of spraying directly on the surface of the refrigerator. This helps ensure an even distribution of moisture on the surface.
3. The doors, handles, and cabinet surfaces should be cleaned with a mild detergent, and then wiped dry with a soft cloth.
4. To keep your appliance looking its best, the exterior should be polished once or twice a year.

### WARNING

- Do not use Benzene, Thinner, or Clorox bleach)™ for cleaning.
- They may damage the surface of the appliance and can create a risk of fire.

### **Cleaning the rubber door seals**

1. If the rubber door seals are dirty, the doors may not close properly, and the refrigerator will not operate efficiently.
2. Keep the door seals free of grit or grime by cleaning the doors with a mild detergent and damp cloth.
3. Wipe dry with a clean, soft cloth.

### **CAUTION**

1. Do not spray the refrigerator with water while it is plugged in, as it may cause an electric shock.
2. Do not clean the refrigerator with benzene, thinner, or car detergent as there is a risk of fire.
3. Changing the LED type lighting

### **CAUTION**

1. Do not disassemble or replace the LED type lighting.
2. To change the LED type lighting, contact a Samsung service center
3. Changing the water filter

### **NOTE**

- Replace the water filter when the water filter indicator turns red.
- The water filter is located on the bottom right side of the refrigerator.
- To make changing the water filter easier, you may want to shut off the water supply, and then drain any water remaining in the water line by pressing the Water button and then pressing a glass against the water dispenser pad.
- Turn the water filter 90° counterclockwise.
- Pull the water filter out of the filter housing.
- Insert a new water filter into the filter housing.

### **Removing residual matter from inside the water supply line after installing a new filter**

- Ice Water
- Turn ON the main water supply.
- Press the Water button on the control panel. Place a cup or glass under the water outlet, and then push the cup or glass against the dispenser pad until you hear a “click”.
- Flush 3 gallons of water through the filter.
- Flush approximately 6 minutes.
- This will clean the water supply system and remove air from the lines.
- Additional flushing may be required in some households.

- Open the refrigerator door and make sure there are no water leaks coming from the water filter.

Foods	Refrigerator	Freezer	Storage Tips
<b>Dairy products</b>			
Butter	2-3 Weeks	6-9 Months	Wrap or cover tightly.
Milk	1-2 Weeks	Not recommended	Check date code. Most milk and similar products are sold in date-coded cartons that indicate a product's peak freshness. Re-seal with cap or wrap tightly. Do not return unused portions to original container.
Cream Cheese, cheese food, and cheese spread	2-4 Weeks	Not recommended	Check date code. Keep all cheese tightly packed in moisture proof wrap
Hard Cheese (unopened)	3-4 Months	6 Months	
Hard Cheese (opened)	2 Months	Not recommended	
Cottage Cheese	10-15 Days	Not recommended	
Cream	7-10 Days	2 Months	Check date code. Most yogurt, creams, and similar products are sold in date-coded cartons that indicate a product's peak freshness. Re-seal or cover tightly. Do not return unused portions to original container.
Sour Cream	2 Weeks	Not recommended	
Cream Dips (opened)	1 Week	Not recommended	
Yogurt	10-14 Days	Not recommended	Check date code. Keep covered.
Frozen Yogurt	na	2 Months	
<b>Eggs</b>			
Eggs (uncooked)	3-4 Weeks	Not recommended	Check date code. Store eggs in coldest part of refrigerator and in their original container.
Eggs (cooked)	1 Week	Not recommended	Store in covered container
Leftover egg dishes	3-4 Days	Not recommended	Store in covered container

### Food storage tips

[IMAGE]

## Troubleshooting

### The refrigerator does not work at all or it does not chill sufficiently

- Confirm that the power plug is properly connected.
- Is the temperature control on the display panel set to the correct temperature?
- Try setting it to a lower temperature.
- Is the refrigerator in direct sunlight or located too near a heat source?
- Is the back of the refrigerator too close to the wall and therefore keeping air from circulating?
- Check if the Cooling Off Mode is on. If the Freezer/Fridge temperature indicator is moving, refer to page 42 to cancel the Cooling Off Mode.

### The food in the fridge is frozen.

1. Is the temperature control on the display panel set to the correct temperature?
2. Try setting it to a warmer temperature.
3. Is the temperature in the room very low?
4. Did you store the food with a high water content in the coldest part of the fridge?

### You hear unusual noise or sounds.

- Confirm that the refrigerator is level and stable.
- If the refrigerator's water supply line is not connected and water is not being supplied to the refrigerator, the refrigerator will make unusual noises if the ice maker is on or if you push the water dispenser lever. To stop the noises, press the
- Ice button for at least 3 seconds until the Ice Off icon lights indicating that the ice maker is off.

### You hear a ticking sound from inside the refrigerator.

- This is normal and occurs because various parts in the refrigerator's interior contract or expand in response to temperature changes.
- The front corners of the appliance are hot and condensation is occurring.
- Some heat is normal as anti-condensators are installed in the front corners of the refrigerator to prevent condensation.
- Is the refrigerator door ajar?
- Condensation can occur when you leave the door open for a long time

### Ice is not dispensing.

- Did you wait for 12 hours after installation of the water supply line before making ice?
- Is the water line connected and the shut-off valve open?

- Did you manually stop the ice making function?
- Make sure Ice Type is set to Cubed or Crushed.
- Is there any ice clumped in the ice maker bucket?
- Is the freezer temperature too warm? Try setting the freezer temperature lower.
- You can hear water bubbling in the refrigerator.

**This is normal.**

- The bubbling comes from the refrigerant coolant liquid circulating through the refrigerator.
- There is a bad smell in the refrigerator.
- Has a food item spoiled?
- Make sure that strong smelling food (for example, fish) is wrapped so that it is airtight.
- Clean out your freezer periodically and throw away any spoiled or suspect food.

**Frost forms on the walls of the freezer.**

1. Is the air vent blocked?
2. Remove any obstructions so air can circulate freely.
3. Allow sufficient space between the foods stored for efficient air circulation.
4. Is the freezer door closed properly?

**Water dispenser is not functioning.**

- Is the water line connected and the shut-off valve open?
- Has the water supply line tubing been crushed or kinked?
- Make sure the tubing is free and clear of any obstruction.
- Is the water tank frozen because the refrigerator temperature is too low?
- Try selecting a warmer setting on the main display panel.

**Warning**

This content is compiled from multiple sources and is provided for reference purposes only. It may not be complete or fully applicable to all situations. If you are unable to resolve your issue, please contact the product manufacturer or an authorized service provider for official support.

