

Overview

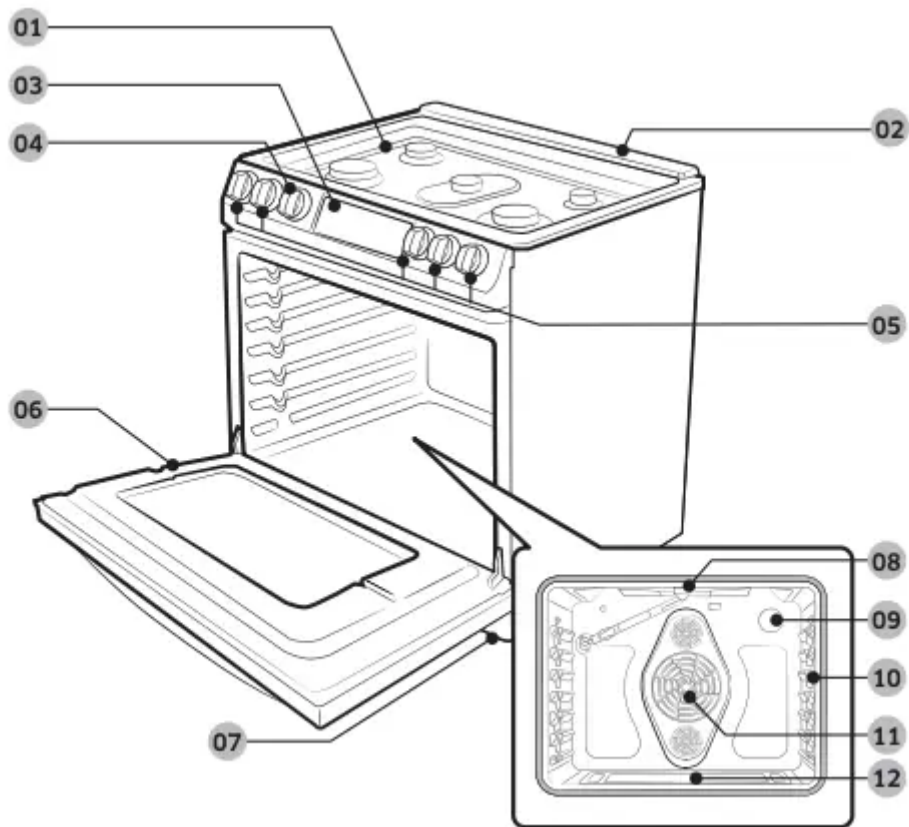

01 Surface burners

02 Oven vents

03 Touch display

04 Oven lights knob (1 pc)

05 Surface burner knobs (5 pcs)

06 Removable oven door

07 Storage drawer

08 Broil oven burner

09 Oven light

10 Oven rack system

11 Convection fan

12 Bake oven burner

What's included

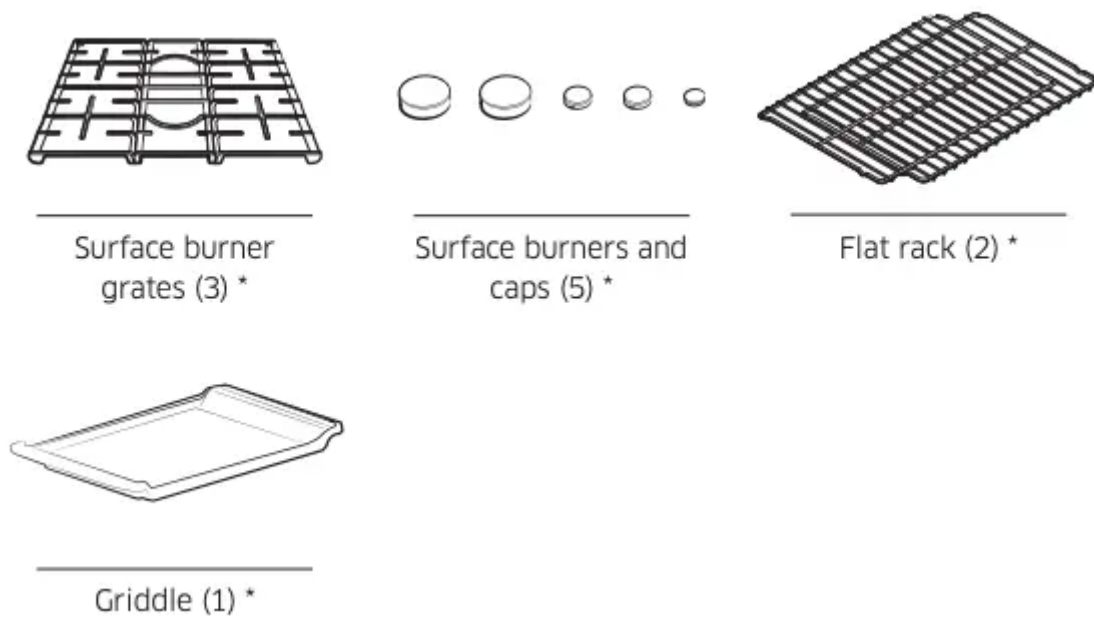

NOTE If you need an accessory marked with an asterisk (*), you can buy it from the Samsung Contact Center (1-800-726-7864).

Control panel

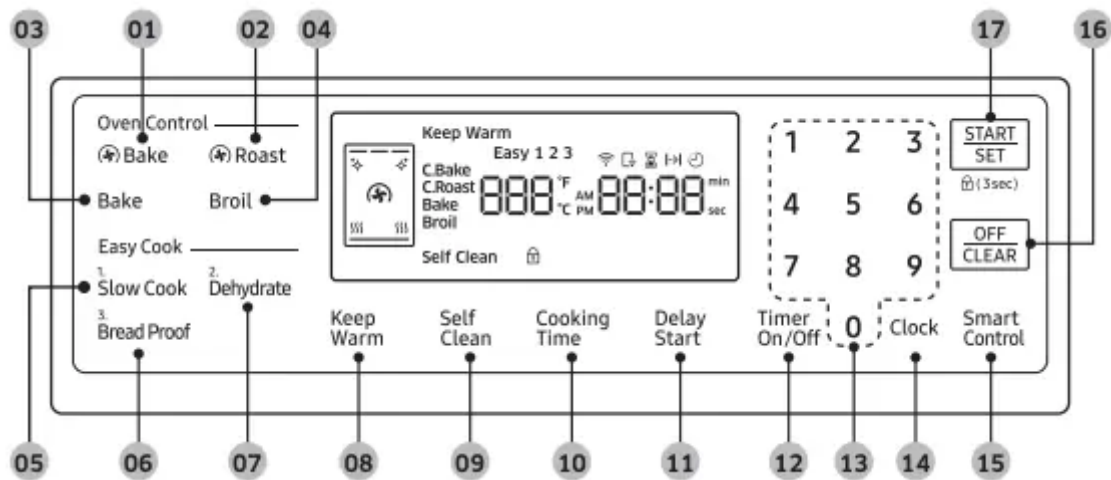

01 Convection Bake: Activate convection baking for large amounts of food on multiple racks.

02 Convection Roast: Activate convection roasting for large cuts of meat.

03 Bake: Bake food evenly using the lower oven burner.

04 Broil: Broil food using the upper oven burner only.

05 Slow Cook: Activates Slow Cook which cooks food slowly at lower temperatures.

06 Bread Proof: Activates the Bread proof function.

07 Dehydrate: Activates the Dehydrate function.

08 Keep Warm: Keep cooked food warm at lower temperatures between 150 °F and 200 °F (66 °C and 93 °C).

09 Self Clean: Burn off food residues in the oven at very high temperatures.

10 Cooking Time: Set the cooking time.

11 Delay Start: Set the oven to start at a certain time.

12 Timer On/Off: Activate or deactivate the timer.

13 Numbers: Use to set the time, temperature, or preset.

14 Clock: Set the clock time.

15 Smart Control: Activates the Easyconnection.

16 OFF/CLEAR: Cancel the current operation but not the timer.

17 START/SET: Start a function or set the time.

Before you start

You should know about the following features and components before you use your range for the first time.

Display mode

Sleep

After 2 minutes of inactivity (or 1 minute when the oven is in standby mode), the control panel enters Sleep mode. In Sleep mode, the control panel is inactive, displaying only the time, until it is reactivated by the user.

Clock

You must set the clock correctly to ensure the automatic features work properly. This product supports two time formats: 12-hour (default) and 24-hour.

To set the clock time



1. Press the Clock pad.

2. To select AM/PM, press the Clock pad again.
3. Enter the current time using the number pad.
4. Press the START/SET pad to confirm the settings.

To change the time format (12hr/24hr)



1. Press the Broil pad and 4 on the number pad simultaneously.
2. Press 0 for the 24-hour format.
3. Press 0 again for the 12-hour format.
4. Press the START/SET pad.

NOTE You can set/change the clock or the kitchen timer before you start a cooking mode or while most cooking modes are operating. However, you cannot set or change the time if a time based function is operating (Time Bake, for example) or the Sabbath option is enabled.

Kitchen timer

The kitchen timer gives you an extra timer you can use to time cooking tasks such as boiling eggs. It does not, however, start or stop any cooking operation. You can set the timer from 1 minute to 9 hours and 59 minutes.

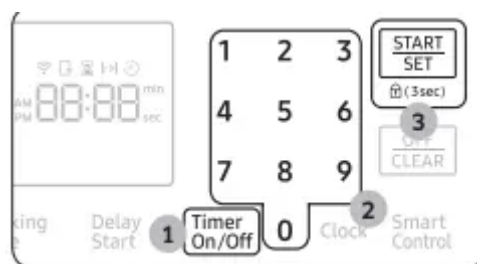

1. Press the Timer On/Off pad.
2. Enter a desired time using the number pad.
3. When done, press the START/SET or Timer On/Off pad.
4. To cancel the Timer settings, press the Timer On/Off pad again.

5. When the set time elapses, the oven beeps and displays the “End” message. Press the Timer On/Off pad to delete the message.

Oven vent/cooling vent

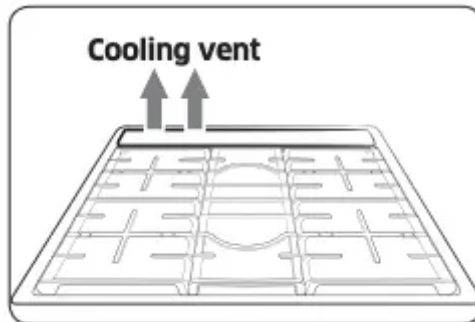

The cooling vents are located at the back of the oven range. Proper air circulation prevents combustion problems and ensures good performance.

- Do not block the vent or its surroundings.
- Use caution when placing items near the vent. Hot steam can cause them to overheat or melt.

Gas oven



STEP 1 Put all ingredients in a heat-safe container.

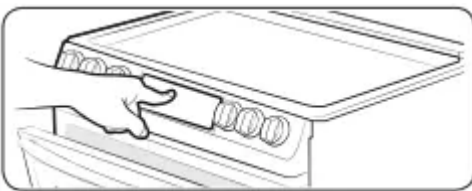

STEP 2 Select a cooking mode, and then start preheating.



STEP 3 Place the container on a rack.



STEP 4 Close the door and start cooking.

NOTES

- The cooling fan automatically runs for a certain amount of time after cooking is complete.
- There can be slight popping sound during oven cooking. This sound may occur during normal oven burner cycling, when the oven burner flame is extinguished.

Cooking mode

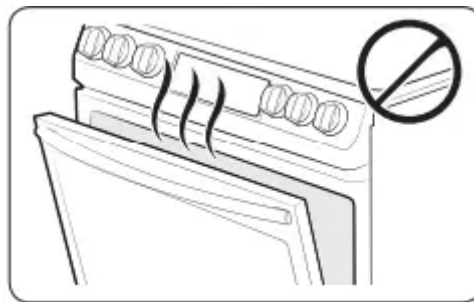

- Make sure to close the door before you start cooking.
- If you leave the door open for 20-30 seconds while the oven is in convection baking/ roasting, baking, or broiling modes, the oven burner shuts off. To restart the burner, close the door.

Baking and roasting



1. Press the Bake, Roast, or Bake pad.
2. If necessary, use the number pad to change the default temperature (350 °F). You can set the oven to any temperature from 175 °F to 550 °F.

3. Press the START/SET pad.

- The oven preheats until it reaches the temperature you set.
- It beeps six times when the temperature reaches you set.
- When preheating is complete, place the food in the oven, and then close the door.

4. When cooking is complete, press the OFF/CLEAR pad, and then take out the food.

NOTE To change the temperature during cooking, repeat steps 1 through 3 above

Convection cooking

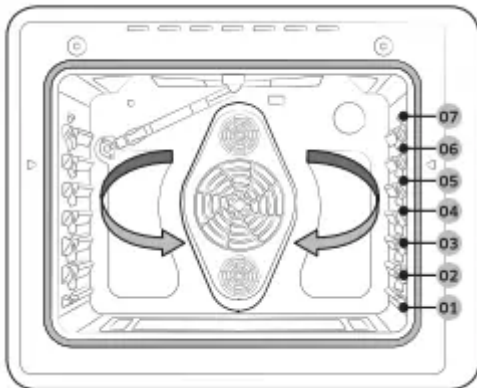

The convection fan at the back of the oven circulates hot air evenly throughout the oven cavity so that food is evenly cooked and browned in less time than with regular heat.

NOTE When using convection cooking, always pre-heat the oven for the best results.

Convection baking

- Ideal for foods being cooked using multiple racks.
- Good for large quantities of food.
- Provides the best performance for cookies, biscuits, brownies, cupcakes, cream puffs, sweet rolls, angel food cake, and bread.
- Cookies bake best when cooked on flat cookie sheets.
- When convection baking using a single rack, place the rack in rack position 3 or 4.
- When convection baking using two racks, place the racks in positions 2 and 5 (Cakes, Cookies).
- The oven automatically adjusts the temperature for convection baking.

Convection roasting

- Good for larger, tender cuts of meat, uncovered.
- For best performance, place a broiler pan and grid under the meat or poultry. The pan catches grease spills and the grid prevents grease spatters.

- Heated air circulates over, under, and around the food. Meat and poultry are browned on all sides as if they were cooked on a rotisserie.

Broiling

Broiling uses the oven broil burner at the top of the oven to cook and brown food. Meat or fish must be put on a broiling grid in a broiling pan. Preheating for 5 minutes before broiling is recommended.

Broiling



1. Put food on a broiling grid in a broiling pan.
2. Press the Broil pad once for Hi temperature broiling or twice for Lo.
3. Press the START/SET pad to start the broiler.
4. Let the oven pre-heat for 5 minutes.
5. Place the pan on the desired rack, and then close the oven door.
6. When one side of the food is browned, turn it over, close the oven door, and start cooking the other side.
7. When cooking is complete, press the OFF/CLEAR pad.

NOTES

- Make sure to close the door before you start cooking.
- Use the low temperature setting for poultry or thick cuts of meat to prevent overbroiling.
- In general, to prevent overbroiling, press the Broil pad to switch from Hi to Lo.
- Use caution when you open the oven door to turn over the food. The air escaping from the oven will be very hot.
- For information about broiler temperatures, rack settings, and cooking times for different foods, see "Broiling guide" on page 23.

Recipe guide

Broiling guide

For detailed broiling instructions, see page 22.

NOTES

- This is for reference only.
- Preheating for 5 minutes before broiling is recommended.
- The size, weight, thickness, starting temperature, and your doneness preference will affect broiling times.
- This guide is based on meats at refrigerator temperature.
- If you have covered the meat with aluminum foil and you let it stand covered for 10 minutes after cooking is complete, the internal temperature increases by 5-10 °F degrees.

Food	Doneness	Size	Thickness	Broil setting	Rack position	Cooking time	
						1st side	2nd side
Hamburgers	Medium	9 patties	1"	HI	6	5:00	4:00
Beef steak	Medium	-	1"	HI	5	7:00-8:00	4:00-6:00
	Medium	-	1½"	HI	5	12:00-16:00	11:00-14:00
Chicken pieces	Well done	2-2½ lbs.	¾"-1"	HI	3	18:00-20:00	12:00-15:00
Chicken breasts	Well done	2-3 pcs	-	HI	4	15:00-20:00	7:00-12:00
Pork chops	Well done	1 lb.	½"	HI	5	9:00-11:00	6:00-9:00
Lamb chops	Medium	10 oz.	1½"	HI	4	8:00-12:00	5:00-8:00
	Well done	10 oz.	1½"	HI	4	10:00-16:00	7:00-11:00

CAUTION Make sure to close the door after turning over the food.

Minimum and maximum settings

All the features listed in the table below have minimum and maximum time or temperature settings. A beep will sound each time a pad on the control panel is pressed and the entry is accepted. An error tone will sound in the form of a long beep if the entered temperature or time is below the minimum or above the maximum setting for the feature



Feature	Temperature (°F)	
	Min	Max
Convection Bake	175	550
Convection Roast	175	550
Bake	175	550
Broil	LO	HI
Dehydrate	100	175

Using the oven racks

The rack positions

Your oven range comes with 2 racks and 7 rack positions. The rack positions are delineated by rack guides which support the racks. Each rack guide has a stop that prevents the rack from loosening during the oven's operation. Each rack has stoppers that need to be placed correctly on the rack guides. The stoppers prevent the racks from accidentally coming out of the oven completely when you pull the racks out.

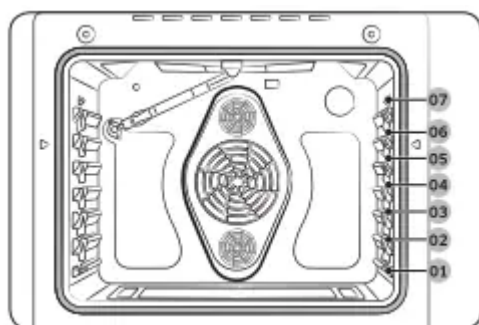

Type of food	Rack position
Broiling hamburgers	6
Broiling meats or small cuts of poultry, fish	5-4
Bundt cakes, Pound cakes, Frozen pies, casseroles	4 or 3
Fresh Pizza, Angel food cakes, Small roasts	2
Turkey, Large roasts, Hams	1

CAUTION

- Do not cover an oven rack with aluminum foil. This will hamper heat circulation, resulting in poor baking.
- Do not place aluminum foil on the oven bottom. The aluminum can melt and damage the oven.
- Arrange the oven racks only when the oven is cool.
- When placing an oven rack in the top-most rack position (position 7), make sure the rack is situated stably on the embossed stop.

NOTES

- The Oven Rack Settings table is for reference only.
- We recommend cooking pizza and pies using the 2nd rack position for crispy bottoms.

Inserting and removing an oven rack

To insert an oven rack



1. Place the rear end of the rack on a rack guide.
2. Slide the rack into the rack guide while holding the front end of the rack.

To remove an oven rack

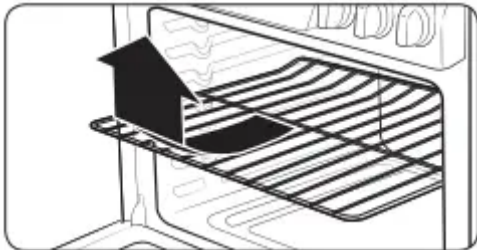

1. Pull out the rack until it stops.
2. Pull up the front end of the rack and remove it from the rack guide.

Rack and Pan placement

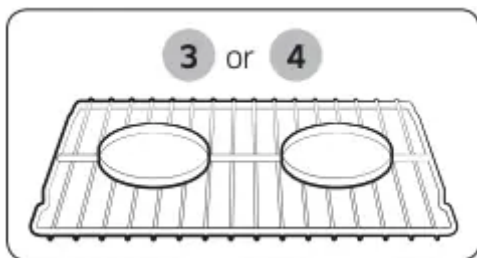

Single Oven Rack

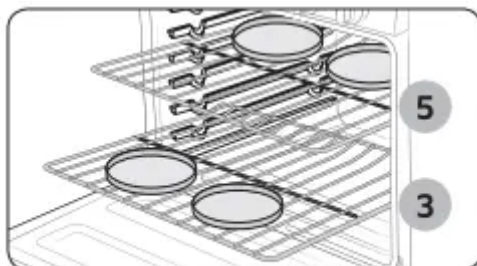

Cake pan positions

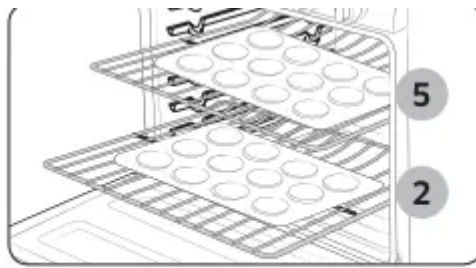

Cookie sheet positions

Centering the baking pans in the oven as much as possible will produce better results. If baking with more than one pan, place the pans so each has at least 1" to 1½" of air space around it.

When baking on a single oven rack, place the oven rack in position 3 or 4. See the figure on the left.

When baking cakes and cookies on multiple racks, place the oven racks in positions 3 and 5. See the figure on the left.

Using Multiple Oven Racks

Type of Baking	Rack Positions
Cakes	3 and 5
Cookies	2 and 5

Cooking options

CAUTION Food that can easily spoil, such as milk, eggs, fish, poultry, and meat, should be chilled in a refrigerator before they are placed in the oven. Even when chilled, they should not stand for more than 1 hour before cooking begins and should be removed promptly when cooking is completed.

Timed Cook

Timed cooking sets the oven to cook foods at a set temperature for a set length of time. The oven automatically turns off when it finishes.

Mode: Bake / Bake / Roast / Slow Cook / Dehydrate



1. Press the pad corresponding to a desired cooking mode such as Bake.

2. If necessary, change the temperature using the number pad.
3. Press the Cooking Time pad.
4. Set the cooking time between 1 minute and 9 hours and 59 minutes (9:59) using the number pad.
5. Press the START/SET pad. The oven will automatically turn on and start preheating. The temperature will increase until it reaches the temperature you set.
6. When preheating is complete, put the container with the food on a rack, and then close the door. The oven starts cooking for the amount of time you set.
7. When the cooking time has elapsed, the oven will automatically shut off and then beep.

NOTE To change the programmed cooking time, press the Cooking Time pad, enter a different time, and then press the START/SET pad.

Delay Start

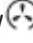
The Delay Start function lets you use the kitchen timer to automatically start and stop another cooking program. You can set Delay Start so that it delays the automatic start of a cooking operation you select by up to 12 hours. **Mode:** Bake /  Bake /  Roast / Self-clean

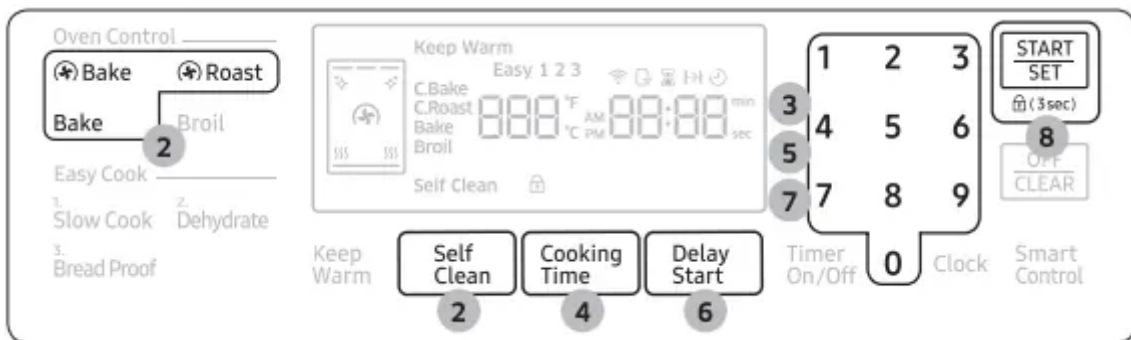

1. Place the container with the food on a rack, and then close the door.
2. Press the pad corresponding to a desired cooking mode such as  Bake.
3. If necessary, change the temperature using the number pad.
4. Press the Cooking Time pad.
5. Set the cooking time between 1 minute and 9 hours and 59 minutes (9:59) using the number pad.
6. Press the Delay Start pad to change the time elements (AM/PM).
7. Set the starting time using the number pad.
8. Press the START/SET pad.
9. The oven starts cooking at the set time, and turns off automatically when it completes cooking.

NOTE To change the starting time, press the Delay Start pad, and enter a new starting time, and then press the START/SET pad.

The Sabbath Option

- The oven temperature can be set higher or lower after you have set this option.
- The display doesn't change and no beep sounds when you change the temperature.
- Once the oven is properly set for baking with the Sabbath option active, the oven will remain continuously on until the Sabbath feature is cancelled. This will override the factory preset 12 hour energy saving feature.
- If the oven light is needed during the Sabbath, press OVEN LIGHT before activating the Sabbath feature. Once the oven light is turned on and the Sabbath option is active, the oven light will remain on until the Sabbath option is turned off.
- If you want the oven light off, be sure to turn it off before activating the Sabbath feature.
- Do not use the surface cooktop when the Sabbath option is on.

To enable the Sabbath option



1. Press the Bake pad.
2. Enter a desired temperature using the number pad. The default temperature is 350 °F.
3. Press the START/SET pad. The display temperature changes after the oven temperature reaches 175 °F.
4. Press the Bake and Number 1 pads simultaneously for 3 seconds to display "SAb". Once "SAb" appears, the oven control no longer beeps or displays any further changes.

NOTES

- You can change the oven temperature once baking starts, but the display will not change or beep. After changing the temperature, it takes 15 seconds before the oven recognizes the change.
- You can turn off the oven at any time by pressing OFF/CLEAR. However, this doesn't deactivate the Sabbath option.

- To deactivate the Sabbath option, hold down Bake and the Number 1 simultaneously for 3 seconds.
- You can set the cooking time before activating the Sabbath option.
- After a power failure, the oven will not resume operation automatically. "SAB" will appear in the control panel, but the oven will not go back on. Food can be safely removed from the oven, but you should not turn off the Sabbath option and turn the oven back on until after the Sabbath/Holidays.
- After the Sabbath observance, turn off the Sabbath option by pressing and holding Bake and the Number 1 simultaneously for at least 3 seconds.

CAUTION

- Do not attempt to activate any other functions except for Bake when the Sabbath option is on. Only the following pads will function properly: Number pads, Bake, Oven Start/Set, and Oven Off.
- Do not open the oven door or change the oven temperature for about 30 minutes after you have started the Sabbath option. Let the oven reach the set temperature. The oven fan operates only when the oven temperature increases.

Slow cook, dehydrate, proofing

Slow cook

The Slow cook feature cooks food slowly at lower oven temperatures. The extended cooking times allow better distribution of flavors in many recipes. This feature is ideal for roasting beef, pork, and poultry. Slow cooking meats may result on the exterior of meats becoming dark but not burnt. This is normal.



1. Press Slow Cook once for HI or twice for LO.
2. Press START/SET.

NOTES Use only 1 rack and place the rack in position 1 or 2 for the best results. Preheating the oven is not necessary.

Dehydrate

Dehydrate dries food or removes moisture from food via heat circulation. After drying the food, keep it in a cool and dry place. For fruit, adding lemon or pineapple juice or sprinkling sugar on the fruit helps the fruit retain sweetness.



1. Press Dehydrate. The default temperature is 150 °F.
2. Enter the temperature you want on number pad. (100 °F-175 °F)
3. Press START/SET.

Recommended Dehydration Temperatures

Category	Rack position	Temperature (°F)
Vegetables or Fruit	3 or 4	100-150
Meat	3 or 4	145-175

NOTE

- Drying time depends on the amount of moisture inside of the food, the size of the food, and the humidity in the air.
- Preheating the oven is not necessary

Bread Proof

The Bread Proof function automatically provides the optimum temperature for the bread proof process, and therefore does not have a temperature adjustment. If you press Bread Proof when the oven temperature is above 100 °F, Hot will appear in the display. Because this function produces the best results when started while the oven is cool, we recommend that you wait until the oven has cooled down and Hot disappears from the display.



1. Press Bread Proof.
2. Press START/SET.
3. Press OFF/CLEAR at any time to turn off the Bread Proof function.

NOTES Use rack position 3 for bread proofing.

CAUTION

- Do not use Bread Proof when the oven temperature is above 125 °F. If the temperature is above 125 °F, this mode will not heat the oven to the optimal temperature. Wait until the oven cools down.
- Do not use Bread Proof for warming food. The proofing temperature is not hot enough to keep food warm.
- Place the dough in a heat-safe container on rack position 3 or 4 and cover it with a cloth or with plastic wrap. You may need to anchor the plastic wrap underneath the container so that the oven does not blow it off the dough.
- To avoid lowering the temperature and extending proofing time, do not open the oven door.

Special features

Keep Warm

Keep cooked food warm at a low temperature up to 3 hours



1. Place the container with the food on a rack, and then close the door.
2. Press the Keep Warm pad.
3. Press the START/SET pad. The oven heats up to 170 °F (77 °C).

NOTES

- You can cancel warming at any time by pressing the OFF/CLEAR pad.
- To set the warming function during a timed cooking, press the Keep Warm pad in timed cooking mode. When the timed cooking is complete, the oven will lower the temperature to the warming default, and keep that temperature until the warming finishes or is canceled.

Changing option settings

Press the Options pad to change various settings of the range to your preference. The Options menu is available only when the oven is off.

Setting		Description
0	Demo mode	Used by retailers for display purposes only.
1	Temperature	Recalibrate the oven temperature.
2	Temp. Unit (°F / °C)	Set the oven control to display temperatures in Fahrenheit or Centigrade.
3	Auto Conversion	Converts regular baking temperatures to convection baking temperatures.
4	Time/date (12hr / 24hr)	Set the clock to display the time in the 12-hour or 24-hour format.
5	Energy saving	Automatically turns off the oven 12 hours after baking starts or 3 hours after broiling starts.
6	Language	Select a preferred language from English, French, or Spanish.
7	Sound	Turn the oven's sound (beeps) on or off.
8	WI-FI On/Off	Set the WI-FI mode to ON/Off

Non-Cooking functions

Demo mode

This is used by retailers for display purposes only. In this mode, the heating element does not operate.



1. Press the Broil pad and 7 on the number pad simultaneously for 3 seconds.
2. Press 0 on the number pad to select Off or On.
3. Press the START/SET pad to save the changes.

Temperature adjust

The oven temperature has been calibrated at the factory. When first using the oven, follow the recommended recipe times and temperatures. If it appears that the oven is too hot or too cool, you can recalibrate the oven temperature. Before recalibrating, test a recipe by using a temperature setting that is higher or lower than recommended. The baking results should help you decide how much of an adjustment is needed. The oven temperature can be adjusted by $\pm 35^{\circ}\text{F}$ ($\pm 19^{\circ}\text{C}$).



1. Press the Broil pad and 1 on the number pad simultaneously for 3 seconds.
2. Press the Broil pad to select a higher(+) or lower(-) temperature.
3. Enter an adjusting temperature value (0-35) using the number pad.
4. Press the START/SET pad to save the changes.

NOTE This adjustment does not affect the broiling or the self-cleaning temperature, and is retained in memory after a power failure.

Temp. Unit ($^{\circ}\text{F}$ / $^{\circ}\text{C}$)

Change the temperature format of the oven to Fahrenheit or Centigrade. The default is Fahrenheit.



1. Press the Broil pad and 2 on the number pad simultaneously for 3 seconds.
2. Press 0 on the number pad to select Fahrenheit or Centigrade.
3. Press the START/SET pad to save the changes.

Auto Conversion

Auto Conversion automatically converts regular baking temperatures to convection baking temperatures. For example, if you enter a regular recipe temperature of 350°F and press START/SET, the oven displays the converted temperature of 325°F .



1. Press the Broil pad and 3 on the number pad simultaneously for 3 seconds.
2. Press 0 on the number pad to select Off or On. (Default setting is *OFF.)
3. Press the START/SET pad to save the changes.

Energy saving

This will automatically turn off the oven 12 hours after baking starts or 3 hours after broiling starts.



1. Press the Broil pad and 5 on the number pad simultaneously for 3 seconds.
2. Press 0 on the number pad to select Off or On.
3. Press the START/SET pad to save the changes.

Sound

Mute/unmute the range.



1. Press the Broil pad and 6 on the number pad simultaneously for 3 seconds.
2. Press 0 on the number pad to select unmute or mute.

3. Press the START/SET pad to save the changes.

Oven lock

Lock the control panel and the door to prevent accidental operations and/or product tipping.



Press and hold the START/SET pad for 3 seconds to lock or unlock both the control panel and the door. When the Oven Lock is on, the oven panel does not operate and the oven door is locked and cannot be opened.

Smart control

How to connect the oven

1. Download and open the SmartThings app on your smart device.
2. Follow the app's on-screen instructions to connect your range.
3. Once the process is complete, the connected  icon located on your range displays and the app will confirm you are connected.
4. If the connection icon does not turn on, follow the instruction on the app to reconnect.



To control the oven remotely

1. Press Smart Control.  appears in the display. The oven can now be controlled remotely with a connected remote device.
2. Select the oven icon on the SmartThings app to open the Oven Control app. When the app is connected to the oven, you can perform the following functions through the application:

Oven remote control using the SmartThings app	
Oven/ Cooktop Monitoring	<ul style="list-style-type: none"> • Check the status of the oven • Monitor the on/off status of each cooktop burner.
Oven Remote Control	<ul style="list-style-type: none"> • Set or adjust oven settings remotely.
My Cooking	<ul style="list-style-type: none"> • Turn the oven off remotely. • Once cooking starts, change the set cooking time and temperature remotely.

Oven remote control using the SmartThings app	
Error Check	<ul style="list-style-type: none"> • Automatically recognize errors.
Temp Probe	<ul style="list-style-type: none"> • Monitor the current temperature and reset the probe setting.
<ul style="list-style-type: none"> • If  is not shown in the display, you are still able to monitor the oven and cooktop status and turn the oven off. 	



WI-FI On/Off

If you set the WI-FI mode to Off, mobile devices cannot connect to the range.



1. Press the Broil pad and 9 on the number pad simultaneously.
2. Press 0 on the number pad to select on or off.
3. Press the START/SET pad to save the changes.

NOTES

- Opening the oven door or pressing Smart Control will delete  from the display and prevent most of the remote functions from operating.
- When oven cooking is finished or cancelled,  is removed from the display.
- For safety reasons, you cannot turn on the gas oven remotely.
- For safety reasons, you must specify the cooking time to enable remote control.
- The oven continues operating even if the Wi-Fi connection is lost.

- Smart Control will not work properly if the Wi-Fi Connection is unstable.
- See the SmartThings app manual for detailed information.

Maintenance

Cleaning

Control panel

First, lock the control panel and the door to prevent accidental operations and/or product tipping.

1. Press and hold the START/SET pad for 3 seconds to lock both the control panel and the door.
2. Clean the control panel using a soft cloth dampened with plain water, warm soapy water, or glass cleaner. Do not spray cleansers directly onto the control panel.
3. When done, press and hold the START/SET pad again for 3 seconds.

WARNING

- Make sure the control panel turns off and all surfaces of the range are cool before cleaning. Otherwise, you can get burned.
- If the range has been moved away from the wall, make sure the anti-tip device is reinstalled properly when the range has been put into place again. Otherwise, the range may tip over, causing physical injuries.
- Do not use steel-wool or abrasive cleansers of any kind. These can scratch or damage the surface.

Stainless steel surface

1. Remove any spills, spots, and grease stains using a soft, wet cloth.
2. Apply an approved stainless steel cleanser to a cloth or paper towel.
3. Clean one small area at a time, rubbing with the grain of the stainless steel if applicable.
4. When done, dry the surface using a soft, dry cloth.
5. Repeat steps 2 through 4 as many times as necessary.

CAUTION

- Do not use a steel-wool pad or abrasive cleanser on stainless steel surfaces. It will scratch the surface.
- Do not spray any type of cleanser into the manifold holes. The ignition system is located in those holes and must be kept free of moisture.

Racks

To keep the racks clean, remove them from the cavity, and soak them in lukewarm soapy water. Then, scour soil off of the racks using a plastic scouring pad. If the racks do not slide in and out smoothly after you have cleaned them, rub the side rail guides with wax paper or a cloth containing a few drops of cooking oil. This will help the racks glide more easily on their tracks.

NOTES

- Do not put the racks in a dishwasher.
- If a rack does not slide in and out smoothly, apply a few drops of cooking oil to the oven rack guides.
- If a rack becomes too difficult to slide in or out, lubricate the rack with graphite lubricant.
- To purchase the graphite lubricant, contact us at 1-800-SAMSUNG (726-7864).

CAUTION

- Do not leave the racks in the oven during the self-cleaning cycle. The extreme heat generated in this cycle can permanently peel off the rack coating and make it difficult to slide the racks on the guide rails.
- Do not spray cooking oil or lubricant directly onto the racks.

Door

Do not remove the inner gasket of the oven door for cleaning.

Door inner side

- Inner surface: Clean the inner side of the door manually using a soapy plastic scouring pad, and then wipe with a dry cloth. Take care not to get the gasket wet or allow moisture into the door.
- Inner glass: The inner glass is cleaned automatically during the self-cleaning cycle.

Door outer side

- Outer surface: Follow the cleaning instructions for the stainless steel surface in the previous section.
- Outer glass: Clean the outer glass using a glass cleanser or soapy water. Rinse and dry thoroughly. Take care not to get the gasket wet or allow moisture into the door.

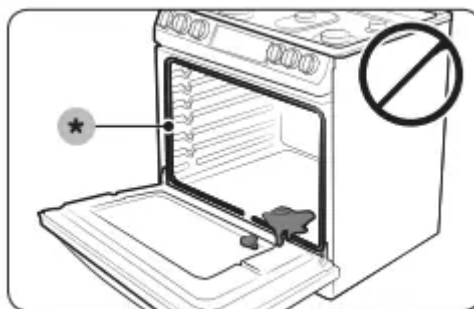

CAUTION Do not let moisture enter the door or contact the door gasket. Moisture may reduce the gasket's performance.

Burner controls

Make sure all surface burner knobs are in the OFF position.

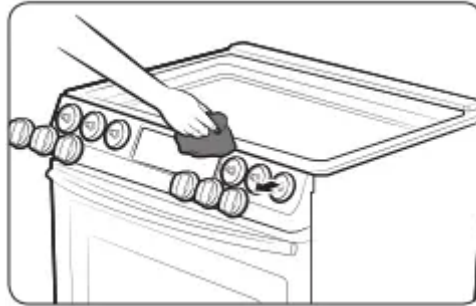

1. Pull knobs off the control valve stems.
2. Clean the knobs in warm, soapy water. Then, rinse and dry them thoroughly.
3. Clean the stainless steel surfaces using stainless steel cleaner.
4. Re-attach the knobs to the control valve stems.

CAUTION

- Do not clean the control knobs in a dish washer.
- Do not spray cleansers directly onto the control panel. Moisture entering the electric circuits may cause electric shock or product damage.

Cooktop surface

The porcelain-enameled cooktop surface needs to be kept clean. We recommend that you remove food spills immediately after they take place.

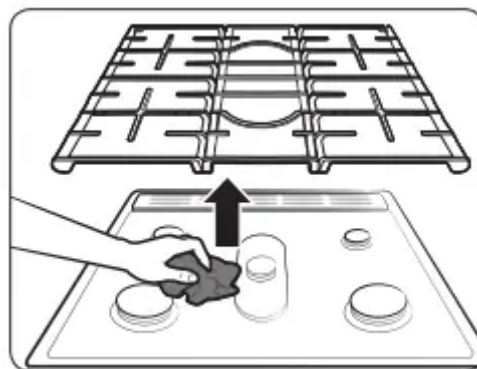

1. Turn off all surface burners.
2. Wait until all burner grates cool down, and then remove them.
3. Clean the cooktop surface using a soft cloth. If food spills run into gaps of the burner components, remove the burner cap and the head, and wipe up the spills.

4. When cleaning is finished, reinsert the burner components, and then put the burner grates back into position.

CAUTION

- Do not use a steel-wool pad or abrasive cleaner, which can scratch or damage the enamel surface.
- Do not remove the cooktop surface to clean it. The gas lines leading to the burner manifolds can be damaged, resulting in a fire or system failure.
- Do not pour water into the cooktop well while cleaning the cooktop. This could leak down into the range gas and electrical systems creating a risk of electrical shock or high levels of carbon monoxide due to corrosion of the gas valves or ports.
- Keep oven vent ducts unobstructed. Clean vents frequently to avoid grease buildup.

Burner grates and components

Turn off all surface burners and make sure they have all cooled down

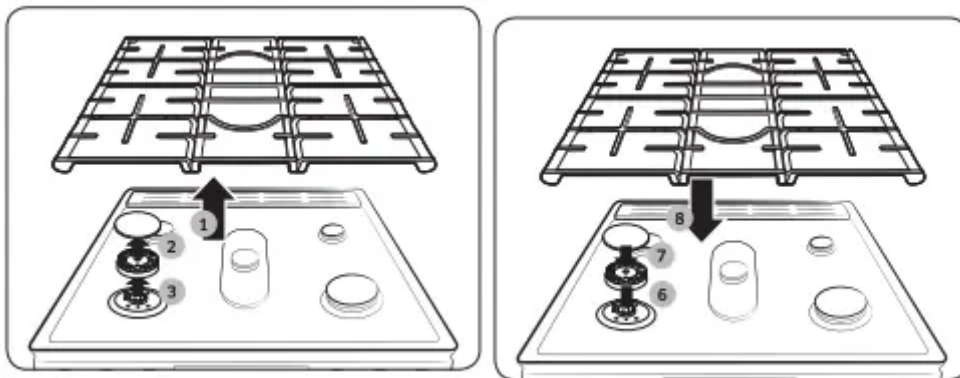

1. Remove the burner grates.
2. Remove the burner caps from the burner heads.
3. Remove the burner heads from the valve manifolds to reveal the starter electrodes.
4. Clean all removable grates and burner components in warm, soapy water. Do not use steel-wool pads or abrasive cleaners.
5. Rinse and dry grates and burner components thoroughly.
6. Return the burner heads to their positions on top of the manifold valves. Make sure a starter electrode is inserted through the hole in each burner head.

NOTE See the next page for detailed burner component re-assembly instructions.

7. Return the burner caps to their positions on top of the burner heads. To ensure proper and safe operation, make sure the burner caps lie flat on top of the burner heads.
8. Re-install the burner grates in their respective positions.

9. Turn on each burner and check if it operates properly. After verifying that a burner operates normally, turn it off.

NOTES

- After cleaning, confirm that the burner port openings aren't plugged.
- Do not wash any burner components in a dish washer.

CAUTION

- The starter electrodes are not removable. Do not attempt to remove them by force.
- To avoid chipping, do not bang grates and caps against each other or against hard surfaces such as cast iron cookware.
- The burner spreader can be blocked by food or dust. Clean the spreader if it appears blocked. If you clean the spreader with water, assemble it only after it is completely dry. If the spreader is wet, it might prevent the burners from igniting.

Burner reinstall guide

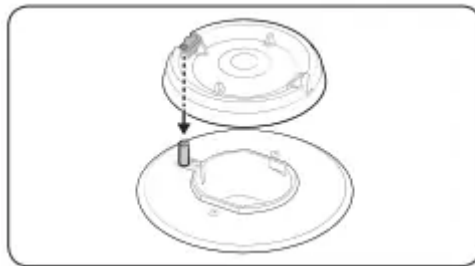

Round Burner head

1. Orient the burner head so that the opening for the electrode lines up with the electrode.



2. Install the burner head so that the electrode passes through the opening for the electrode. Make sure the burner head lies flat on the stove top.

Burner Cap

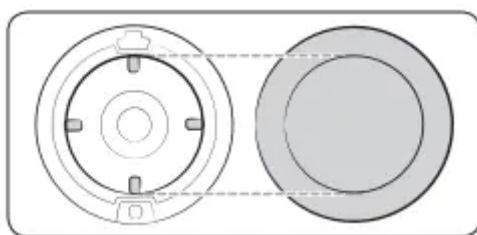

1. Match the burner caps to the burners by size, and then re-install the caps on the burner heads.

CAUTION Make sure each cap is re-installed on the correct burner head, is centered on the burner head, and lies flat.

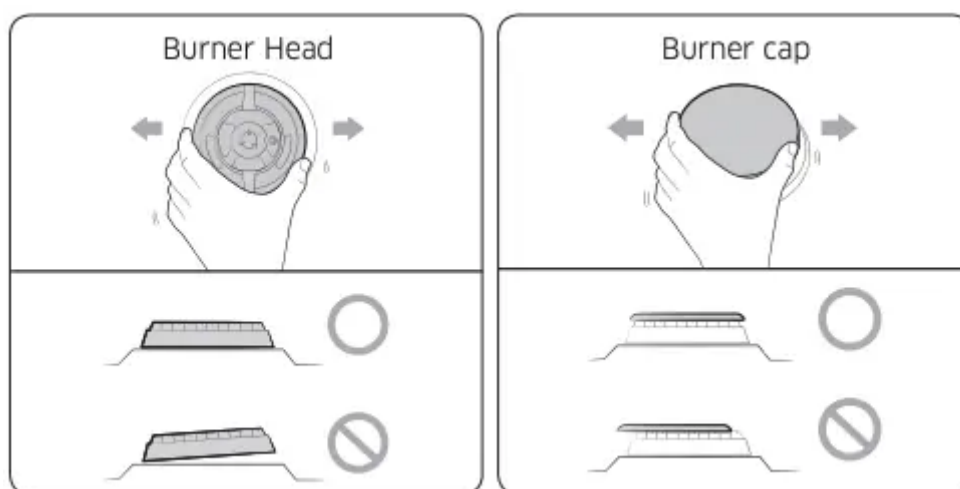

CAUTION Make sure all burner components (heads and caps) are reinstalled properly. They will be stable and rest flat when correctly installed.

Self-cleaning

This self-cleaning oven uses high temperatures (well above cooking temperatures) to burn off leftover grease and residue completely or reduce them to a finely powdered ash that you can wipe away with a damp cloth.

CAUTION

- Do not leave small children unattended near the range during the self-cleaning cycle. The outside surfaces of the range can get extremely hot.
- Some birds are extremely sensitive to fumes from a self-cleaning oven. Relocate birds to a well-ventilated room away from the range.
- Do not line the oven, oven racks, or oven bottom with aluminum foil. Doing so will result in poor heat distribution, produce poor baking results, and cause permanent damage to the oven interior. The aluminum foil will melt onto and adhere to the interior oven surfaces.
- Do not force the oven door open during the self-cleaning cycle. This will damage the automatic door-locking system. The door automatically locks when the self-cleaning cycle is

started and stays locked until the cycle is cancelled and the oven temperature is below 400 °F.

- Use caution when opening the oven door after the self-cleaning cycle. The gas oven will still be VERY HOT and hot air and steam might escape when the door is open.
- Wipe off any excess spillage before using the self-cleaning operation.
- Do not use oven cleaners. Commercial oven cleaners or oven liners should NEVER be used in or around any part of the oven. Residue from oven cleaners will damage the inside of the oven during a self-cleaning operation.

To perform the self-cleaning cycle

Make sure the door lock is released. Remove all racks from the oven cavity.



1. Make sure the oven door is closed completely and unlocked.
2. Press the Self Clean pad once. Then, select the cleaning time by pressing the Self Clean pad one or more times in accordance with the table below.

Once	Twice	Three times
3-hour cycle	5-hour cycle	2-hour cycle

3. Press the START/SET pad. The oven door is locked and the oven begins to heat up.
4. When the self-cleaning cycle is complete, the oven beeps 10 times. The door will remain locked and the Lock icon will blink until the oven temperature falls below 400 °F (204 °C).
5. When the Lock icon changes to an open lock, you can open the oven door. The Lock icon changes to an open lock when the oven temperature drops below 400 °F (204 °C).
6. Press the OFF/CLEAR pad to display the time of the day

CAUTION Do not use the surface burners while the gas oven is performing a self-cleaning cycle.

WARNING Be sure all controls are OFF and all surfaces are COOL before cleaning any part of the range.





NOTE Make sure all surface burners are off while the oven is performing a self cleaning cycle. Self-clean will not operate if a surface burner is on.

To delay starting a self-cleaning cycle



1. Repeat steps 1 and 2 from the column on the left.
2. Press the Delay Start pad. The oven door locks.
3. Set the time you want the oven to start self-cleaning using the number pad.
4. Press the START/SET pad. The oven will start self-cleaning at your specified time.

To cancel the self-cleaning cycle

You may find it necessary to stop or interrupt a self-cleaning cycle due to smoke in the oven. To turn off the self-cleaning cycle, press the OFF/CLEAR pad. The cycle turns off, but the door remains locked and the Lock icon blinks until the oven temperature falls below 400 °F (204 °C)

After self-cleaning

- The door stays locked until the internal oven temperature falls below 400 °F.
- When the oven has cooled down, wipe the oven surfaces with a cloth to remove ash residue.
- Stubborn stains can be removed using a steel-wool pad. Lime deposits can be removed using a vinegar-soaking cloth.
- If you are not satisfied with the cleaning results, repeat the cycle. “HOT” appears on the display until the oven cools down. Wait until the message disappears, and then start a new cycle.
- The cooling fan automatically runs for certain amount of time after self-cleaning.

- Self-cleaning does not operate within 2 hours after running the self-cleaning cycle.

CAUTION Do not attempt to open the oven door immediately after the self-cleaning cycle is complete. The oven is still very hot when the door unlocks. Escaping hot air and/or steam could burn you.

Troubleshooting

If you encounter a problem with the range, check the tables starting below, and then try the suggested actions.

Checkpoints

Gas safety

You smell gas.

The surface burner knob is not in the OFF position and the burner is not lit.

- Turn the burner knob to OFF

There is a gas leak.

- Clear the room, building, or area of all occupants. Immediately call your gas supplier from a neighbor's phone. Do not call from your phone. It is electrical and could cause a spark that could ignite the gas. Follow the gas supplier's instructions. If you cannot reach your gas supplier, call the fire department.

Surface burner

All burners do not light.

The power cord is not plugged into the electrical outlet.

- Make sure the electrical plug is plugged into a live, properly grounded outlet.

A fuse in your home may be blown or the circuit breaker may have tripped.

- Replace the fuse or reset the circuit breaker.

The gas supply is not properly connected or turned on.

- See the Installation Instructions that came with your range.

Surface burners do not light.

The control knob is not set properly.

- Push in the control knob and turn it to the Lite position.

The burner caps are not in place. The burner base is misaligned.

- Clean the electrodes. Put the burner cap on the burner head. Align the burner base.

Surface burner clicks during operation.

The control knob has been left in the Lite position.

- After the burner lights, turn the control knob to a desired setting. If the burner still clicks, contact a service technician.

The burners do not burn evenly

Surface burner components and caps are not assembled correctly and level.

- See page 35.

The surface burners are dirty.

- Clean the surface burner components. (See page 34.)

Very large or yellow surface burner flames.

The wrong burner orifice is installed.

- Check the burner orifice size. Contact your installer if you have the wrong orifice (LP gas instead of natural gas or natural gas instead of LP gas).

Surface burners light but oven burners do not light.

The oven door lock is turned on.

- The display will show the Lock icon. Hold the oven door open and press the START/SET pad for 3 seconds. The oven will beep and the Lock icon will turn off.

The Gas Pressure Regulator shut off switch is in the off position.

- Call a qualified service technician.

Oven

The oven control beeps and displays an information code.

There may be an issue with your oven. See the “Information codes” chart on page .

- Press the OFF/CLEAR pad, and then restart the oven. If the problem persists, disconnect all power to the range for at least 30 seconds and then reconnect the power. If this does not solve the problem, call for service.

The oven will not turn on.

The oven is not completely plugged into the electrical outlet.

- Make sure the electrical plug is fully inserted into a live, properly grounded outlet.

A fuse in your home may be blown or the circuit breaker may have tripped.

- Replace the fuse or reset the circuit breaker

The oven temperature is too hot or cold.

The oven temperature needs to be adjusted and recalibrated.

- See page 30.

The oven burner will not shut off.

The oven door lock is turned on.

- The display will show the Lock icon. Hold the oven door open and press the START/SET pad for 3 seconds. The oven will beep and the Lock icon will turn off.

The Sabbath function has been activated.

- SAb and the time of day will show in the display. All other controls and signals will be deactivated. To turn off the oven only, press the OFF/ CLEAR pad. To cancel the Sabbath function and reactivate the controls and signals, press and hold the Bake and NUM 1 pads simultaneously for 3 seconds.

The oven light (lamp) will not turn on.

The oven door lock is turned on.

- The display will show the Lock icon. Hold the oven door open, and then press the START/SET pad for 3 seconds. The oven will beep and the Lock icon will turn off.

The Sabbath function has been activated.

- SAb and the time of day will show in the display. All other controls and signals will be deactivated. To cancel the Sabbath function and reactivate the light switch and other controls, press and hold the Bake and NUM 1 pads simultaneously for 3 seconds.

A loose or burned-out bulb.

- See page 38.

The switch operating the oven light needs to be replaced.

- Call for a qualified service technician.

The oven smokes excessively during broiling.

Meat or food was not properly prepared before broiling.

- Cut away excess fat and/or fatty edges that may curl.

Improperly positioned top oven rack.

- See the broiling guide on page 23

The controls are not being set properly.

- See page 22.

Greasy buildup on oven surfaces.

- Regular cleaning is necessary when broiling frequently

Cooking is finished, but the cooling fan is still running.



The fan automatically runs for a certain amount of time to ventilate the inside of the oven.

- This is not a product malfunction. The fan is designed to run automatically for a period of time to cool down the oven.

The oven will not self-clean.

The oven door lock is turned on.

- The display will show the Lock icon. Hold the oven door open, and then press the START/SET pad for 3 seconds. The oven will beep and the Lock icon will turn off.

The oven is too hot.

- Let the oven cool down, and then reset the controls. The self-clean cycle will not lock the oven door if the oven temperature is too hot. The door must lock before the selfclean cycle can start.

The self-cleaning oven controls are not properly set.

- Reset the self-cleaning oven controls. (See page 36.)

A surface burner is on. Turn off the surface burner.

- Self-clean will not operate if a surface burner is on.

A crackling or popping sound.

This is normal.

- This is the sound of the metal heating and cooling during any cooking or cleaning function.

Excessive smoking during a selfcleaning cycle.

This is the first time the oven has been cleaned.

- This is normal. The oven will always smoke more the first time it is cleaned. Wipe up all excessive soil before starting the selfcleaning cycle. If smoke persists, press the OFF/CLEAR pad. Open the windows to clear the smoke from the room. After the oven has cooled and unlocked, wipe up excessive soil, and then reset the oven for selfcleaning.

The oven door will not open after a self-cleaning cycle.

This is normal.

- The oven door will stay locked until the oven temperature drops below 400 °F.

The oven is not clean after a selfcleaning cycle.

A fine dust or ash is normal.

- This can be wiped clean with a damp cloth. Set the self-cleaning cycle for a longer cleaning time. The cycle was not long enough to burn off the dirt buildup. Extremely dirty ovens require hand-cleaning of excessive spillovers and food buildup before you start a

self-cleaning cycle. Multiple self-cleaning cycles may be necessary to completely clean the oven.

There is steam or smoke coming from under the control panel.

This is normal.

- The oven vent is located there. More steam is visible when you are using the convection functions or when baking or roasting multiple items at the same time.

A burning or oily odor coming from the vent.

This is normal for a new oven and will disappear within 1/2 hour of the first bake cycle.

- To speed the process, set a self-cleaning cycle for a minimum of 3 hours. (See page 37)

Strong odor.

This is temporary.

- The insulation around the inside of the oven emits an odor the first few times the oven is used.

The oven racks are difficult to slide.

This is normal.

- Apply a small amount of vegetable oil to a paper towel, and then wipe the edges of the oven racks with the paper towel. Racks become dull and hard to slide if they are left in the oven during a self-clean cycle.

Fan noise.

This is normal.

- The convection fan runs until the function is over or the door is opened.

The convection fan is not working.

This is normal.

- The fan starts automatically when the oven reaches the preheat temperature.

Others

The product is not level.

The appliance has been installed improperly. The leveling leg(s) is (are) damaged or uneven.

- Make sure the floor is level, strong, and stable. If the floor sags or slopes, contact a carpenter. Check and level the range. (See the Installation Instructions.)

The kitchen cabinets are not properly aligned and make the range appear to be not level.

- Ensure that cabinets are square and provide sufficient room for installation.

The display goes blank.

The electrical outlet Ground Fault Interrupter (GFI or GFCI) has been tripped and needs to be reset. Your digital control has been damaged.

- Replace the fuse or reset the circuit breaker.

Food does not bake or roast properly in the oven.

The wrong cooking mode was selected.

- See page 21.

The oven racks have not been positioned properly for the foods being cooked.

- See page 24.

Incorrect cookware or cookware of improper size is being used.

- See page 17.

The oven temperature needs to be adjusted and recalibrated.

- See page 30.

There is aluminum foil on racks and/or oven bottom.

- Remove foil.

The clock or timers are not set correctly.

- See pages 15 and 16.

Food does not broil properly in the oven.

The oven controls are not set properly.

- See page 22.

The oven door was not closed during broiling.

- See page 21.

The rack has not been properly positioned.

- See the broiling guide on page 23

Information codes

C-20 Oven sensor malfunction.

C-21 The oven is overheating.

C-30 Check the PBA NTC Sensor

C-31 Check the PBA NTC Sensor

C-d0 Control pad malfunction.

C-d1 Door lock malfunction.



C-F0 PCB signal malfunction.

C-F2 Touch IC and PCB signal malfunction

- 1. Press the OFF/CLEAR pad, and then restart the oven.
- 2. If the problem persists, disconnect all power to the oven range for at least 30 seconds and then reconnect the power.

**** If these solutions do not solve the problem, contact a local Samsung service center or call 1-800-SAMSUNG (1-800-726-7864).**

Warning

This content is compiled from multiple sources and is provided for reference purposes only. It may not be complete or fully applicable to all situations. If you are unable to resolve your issue, please contact the product manufacturer or an authorized service provider for official support.