

User Manual Dryer

PREPARING THE LOAD

Before using the tumble dryer for the first time:

- Please read this instruction book thoroughly.
- Remove all items packed inside drum.
- Wipe the inside of the drum and door with a damp cloth to remove any dust which may have settled in transit.

Clothes Preparation

Make sure that the laundry you are going to dry is suitable for drying in a tumble dryer, as shown by the care symbols on each item. Check that all fastenings are closed and that pockets are empty. Turn the articles inside out. Place clothes loosely in the drum to make sure that they don't get tangled.

Do Not Tumble Dry:

Silk, nylon stockings, delicate embroidery, fabrics with metallic decorations, and garments with PVC or leather trimmings.

During the last 15 minutes, the load is always tumbled in cool air.

Energy Saving

Only put into the tumble dryer laundry which has been thoroughly wrung or spin-dried. The drier the laundry the shorter the drying time thus saving electricity.

ALWAYS

- Check that the filter is clean before every drying cycle.

NEVER

- Put dripping wet items into the tumble dryer, this may damage the appliance.

Sort the Load as Follows

- **By care symbols**

These can be found on the collar or inside seam:



Suitable for tumble drying.



Tumble drying at high temperature.



Tumble drying at low temperature only



Do not tumbles dry

If the item does not have a care label it must be assumed that it is not suitable for tumble drying.

- **By amount and thickness**

Whenever the load is bigger than the dryer capacity, separate clothes according to thickness (e.g. towels from thin underwear).

- **By type of fabric**

Cottons/linen: Towels, cotton jersey, bed and table linen.

Synthetics: Blouses, shirts, overalls, etc. made of polyester or polyamide, as well as for cotton/synthetic mixes.

CLEANING AND ROUTINE MAINTENANCE

Cleaning the Dryer

- Clean the filter and empty the water container after every drying cycle.
- Regularly clean the bottom filter.
- After each period of use, wipe the inside of the drum and leave the door open for a while to allow the circulation of air to dry it.
- Wipe the outside of the machine and the door with a soft cloth.
- DO NOT use abrasive pads or cleaning agents.
- To prevent the door sticking or the build-up of fluff clean the inner door and gasket with a damp cloth after every drying cycle

WATER CONTAINER

The water removed from the laundry during the drying cycle is collected in a container inside



the door of the dryer. When the container is full the indicator on the control panel will light, and the container **MUST** be emptied. However, we recommend that the container is emptied after each drying cycle

To remove the container tank indoor drawer

1. Gently pull out the water container holding the handle. (A)
When it is full the water container will weigh about 6 kg.

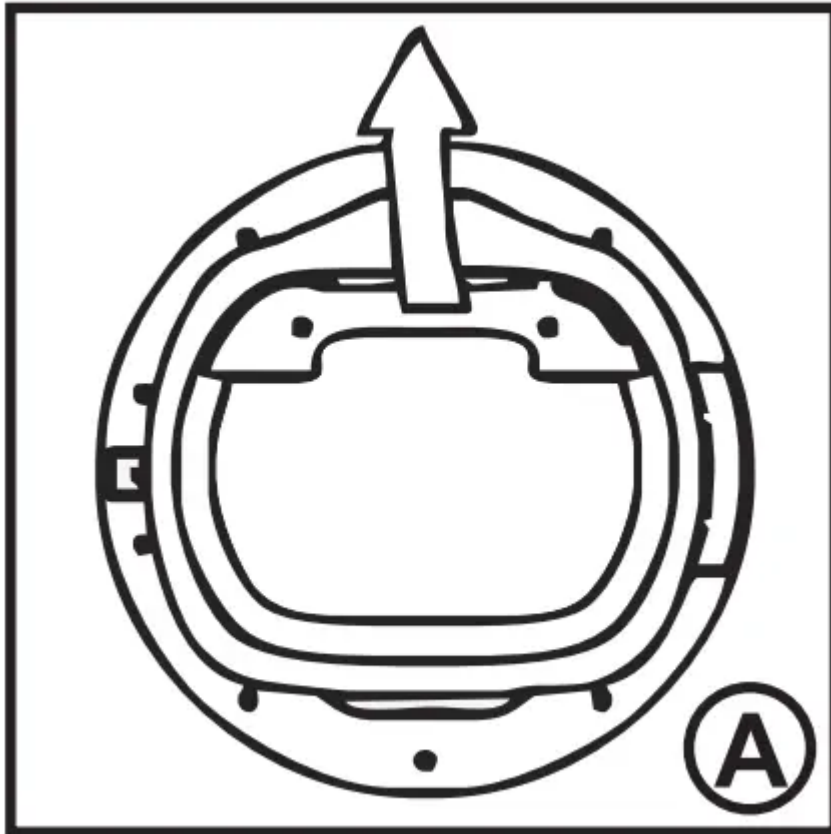

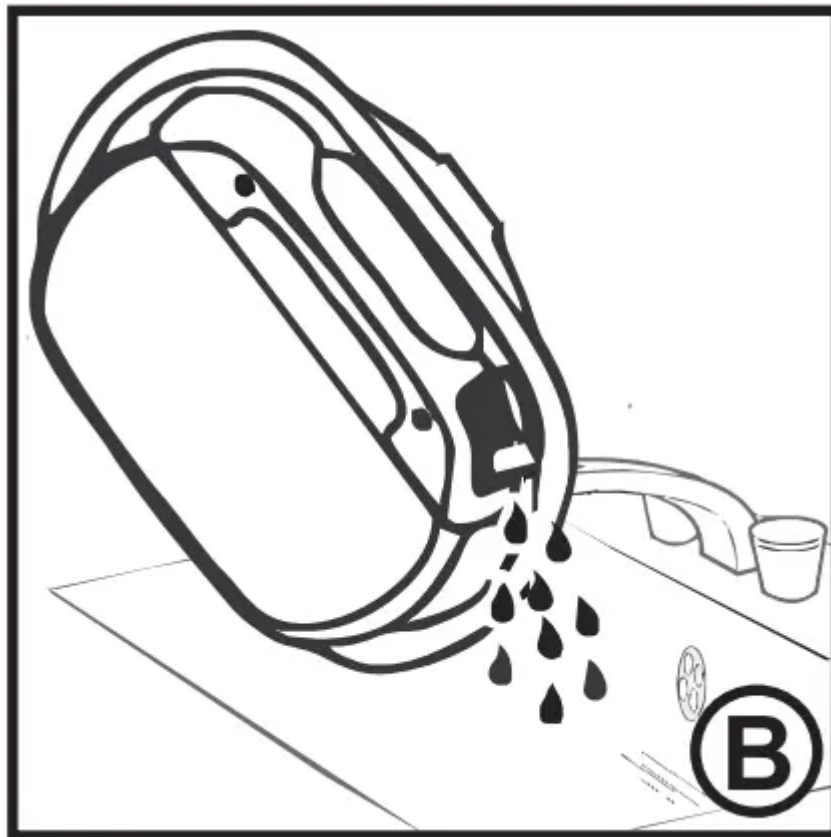

2. Tilt the water container to empty the water out through the spout. (B)



When empty, replace the water container back as shown; (C) First insert the base of the container into position as shown (1) then gently push the top into position (2).

3. Press  Button to restart the cycle.

OPERATION

1. Open the door and load the drum with laundry. Ensure that garments do not hinder closure of the door.
2. Gently close the door pushing it slowly until you hear the door 'click' shut.
3. Turn the Programme Selector dial to select the required drying programme (see Programme Guide).
4. Press the  button. The dryer will start automatically and the indicator above the button will be continuously lit.
5. If the door is opened during the programme to check the laundry, it is necessary to press  to recommence drying after the door has been closed.
6. When the cycle is nearing completion the machine will enter the cool-down phase, the clothes will be tumbled in cool air allowing the load to cool down.
7. Following the completion of the cycle the drum will rotate intermittently to minimize creasing. This will continue until the machine is switched OFF or the door is opened.
8. When the programme is complete the END indicator will light.

DOOR and FILTER

Pull on handle to open the door. To restart the dryer, close the door and press Start / Pause

button. 

Filter

1. Pull the filter upwards
2. Open filter as shown.
3. Gently remove lint using a soft brush or your fingertips.
4. Snap the filter together and push back into place.

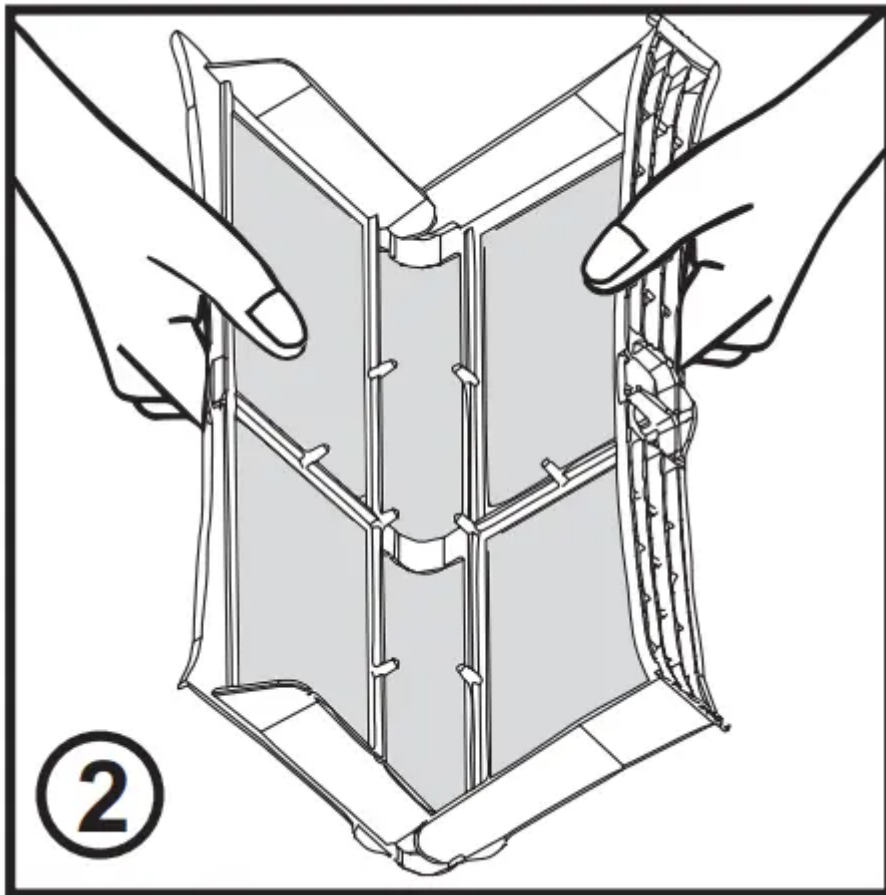
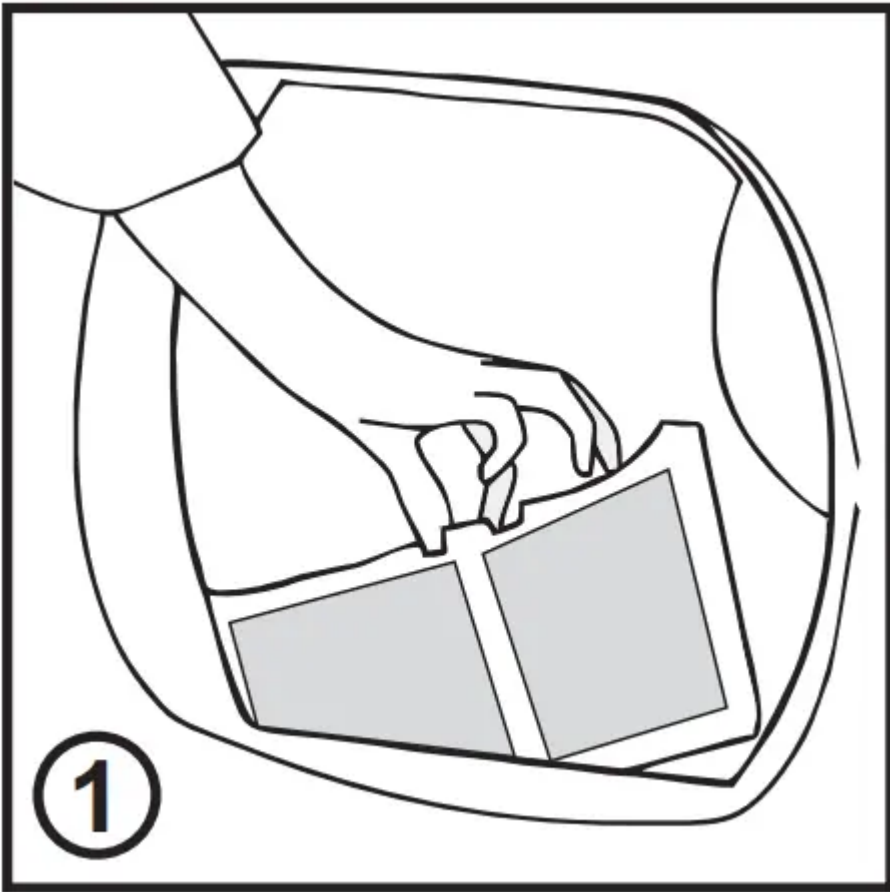

Filter CareIndicator



Lights when the filter needs cleaning. If the laundry is not drying check that the filter is not clogged.

To Clean the Condenser Filter

1. Remove the kickplate
2. Turn the two locking levers anti-clockwise and pull out the front cover.
3. Gently remove the filter frame and clean any dust or fluff with a cloth from the filter. Do not use water to clean the filter.
4. Remove the sponge gently from its place and then wash the sponge by holding it under a running tap turning it so to remove any dust or fluff.
5. Refit the front cover ensuring it is in the correct way (as indicated by the arrow) and pushed firmly into place. Lock the two levers by turning them clockwise
6. Refit the kickplate





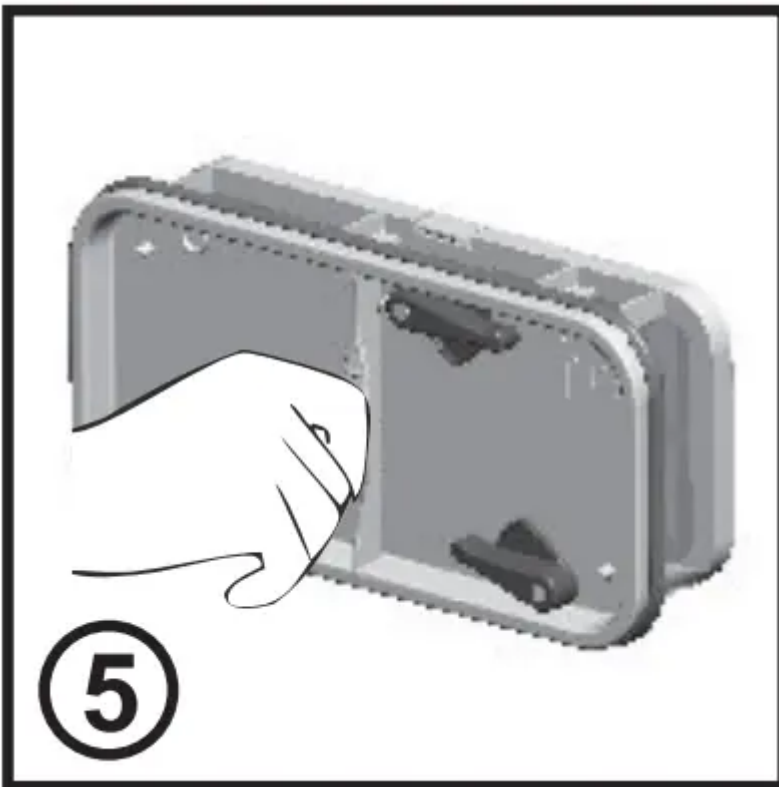
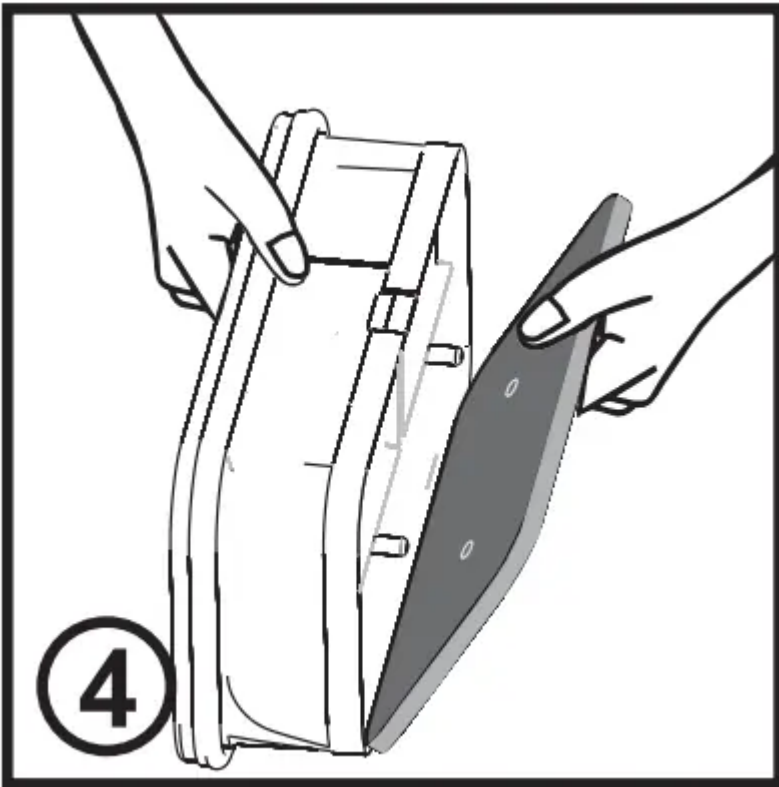

CONTROLS AND INDICATORS

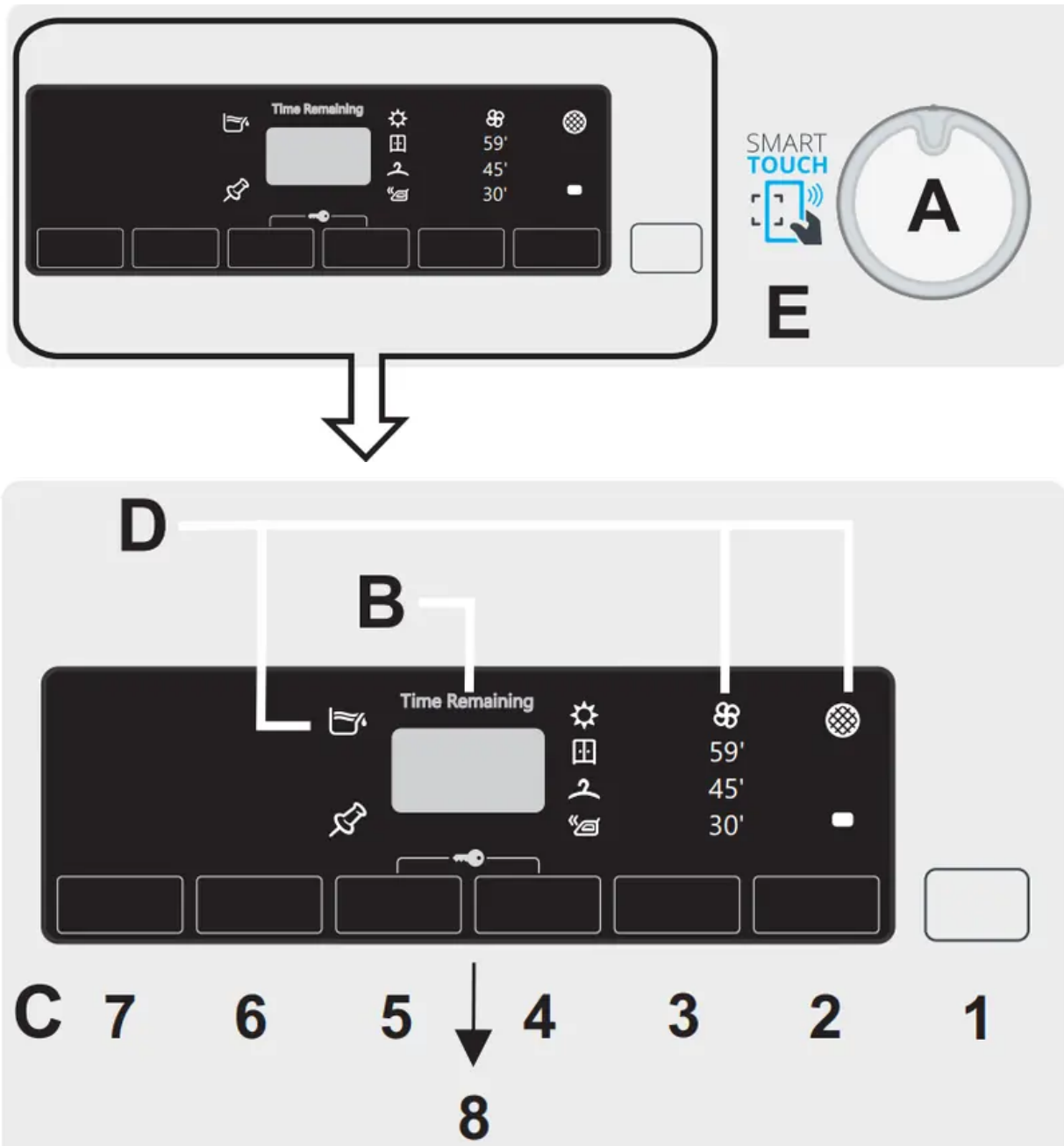

A-Programme Selector - Rotating the knob in both directions it's possible to select the desired drying program. To cancel the selections or switch off the dryer rotate the knob to OFF.

B- Display Digit - The display shows the remaining time for drying, the time until a drying cycle will start (if delayed start has been activated) and other notifications setting.

C-Buttons-

1.Start/Pause Button

To start the selected program and/or suspend it.

2.Super Easy Iron - This option reduces folds and tangles, thanks to alternating movements of the drum during and after drying and automatically setting the iron drying level (the drying level setting can be modified after the option selection).

The option can be set up to five minutes after the start of the cycle and is activated only on automatic cycles.

3.Rapids Button - It's possible switch an automatic program to RAPID program, up to 3 minutes after the start of the cycle. The progressive pressure increases the time (30-45-59 minutes). After this selection to reset the automatic drying functioning it is necessary to switch off the dryer. In case of incompatibility, all LEDs flash quickly 3 times.

4. Drying Selection Button

This allows you to select the required dryness level, it is possible to choose for up to five minutes after the start of a drying cycle:



- **Ready to Iron** : It leaves the garments slightly wet to facilitate ironing.



- **Hanger Dry**: To make garment ready to be hung on a coat hanger.



- **Wardrobe Dry**: For laundry that can be directly stored.



- **Extra-dry** : To get completely dry garments, ideal for full load.

This appliance is equipped with a Drying Manager Function. On automatic cycles, each level of intermediate drying, prior to reaching the selected one, is indicated by a flashing neon that indicates the degree of dryness that the garments have reached.

In case of incompatibility, all LEDs flash quickly for 3 times

5. Delay Start Button - It allows delaying the start of the program from 1 to 24 hours in 1-hour intervals. The delay selected is shown on the display. After pressing the START button the time showed decreases hour by hour. If you open the porthole door with a delayed start set, after re-closing the porthole, press starts again to resume the counting.



6. Memo - This option allows you to store the options set on a cycle. STORAGE > When the cycle is running push the button "memory" for three seconds. The control light "memory" flashes for three times and stores the set options connected to the cycle currently in progress.

Recall: After the selection of the cycle push the button "memory" for recall the stored options (not the cycle)

7. Time cycle selection - It's possible to transform a cycle from automatic to programmed, up to 3 minutes after the start of the cycle. The progressive pressure increases the time in 10-minute intervals.

After this selection to reset the automatic drying functioning it is necessary to switch off the dryer. In case of incompatibility, all LEDs flash quickly for 3 times.



8. Keylock blocking

This function allows the blocking of unwanted changes of the set options on the bezel, during the drying phase.

Activation/ Inactivation: Push 4 and 5 buttons simultaneously for two seconds. The sign "LOC" appears on the display. Unlocking the option, on the display appears the sign "Uni", only once. In case of opening of a 'porthole' with an activated key lock, the cycle stops but the lock is kept: to restart the cycle, you must remove the lock and restore start. When the dryer is off, the option is automatically inactivated.

Key lock can be modified at any time of the cycle.

Automatic Anti crease

This option automatically activates an anti-creased movement of the drum, pre-cycle in case of activation of the delay and at the end of drying cycle for 6 hours. It is activated every 10 minutes. To stop the movements set the knob to OFF

Useful when it's not possible to remove immediately the laundry.

D-Led



Water tank
tank.

- It lights up when it's necessary to empty the water



Filter cleaning - It lights up when the cleaning of the filters is requested (the door and the lower filter.)



Cooling - It lights up when the cycle is in the final cooling phase.

E-SMART TOUCH area - pressing the START/PAUSE button allows a previously downloaded cycle to start whilst the Touch position is selected on the programme knob (for downloading cycles from the App see the relevant section of this user manual).

Maximum Drying Weight

Cottons	Max.capacity declared
Synthetics or Delicates	Max.4 Kg

Drying Guide

The standard cycle COTTON DRY () is the most energy-efficient and best suited for drying normal wet cotton laundry.

The table in last page shows the approximate time and energy consumption of these main drying programmes.



Technical Specifications

Drum capacity	78,5
Maximum load	See energy label
Height	85 cm
Width	60 cm
Depth	48,7 cm
Energy class	See energy label

Power consumption of off-mode	0,40 W
Power consumption of on-mode	0,75 W

SELECTING THE PROGRAMME AND SET THE FUNCTION

PROGRAM	PROGRAM DESCRIPTION	CAPACITY (kg)	DRYING TIME (min)
Whites	The right cycle to dry cottons, sponges and towels.	Full	*
 Cotton	Program Eco normative (hang dry) drying. The most efficient program in energy consumption. Suitable for cottons and linens.	Full	*
Mix & Dry	To dry all together different kind of fabrics as cotton ,linen, mix, synthetics.	4	*
Coloured	A delicate and specific cycle to dry dark or colour cotton or synthetics garments.	4	*
Synthetics	To dry delicate and synthetic fabrics that need an accurate and specific treatment.	4	*
Shirts	This specific cycle has been conceived to dry shirts minimizing tangles and folds thanks specific movements of the drum. It's recommended to take out the linens immediately after drying cycle.	2.5	*
Bed & Bath	Specific cycle dedicated to dry oversized linen like curtains, sheets and tablecloths. Thanks to a specific movement of the drum the linens will be dry minimising tangles and folds.	5	220'
Jeans	Dedicated to dry uniform fabrics like jeans or denim. It's recommended flip over the garments before drying.	4	*
Down Jackets	Perfect cycle to dry duvets and revitalizing the smoothness of the feathers.	4	*
Sport	Dedicated to technical garments for sport and fitness, drying gently with special care to avoid shrinking and deterioration of elastic fibers.	4	*

Wool 	Woolen clothes: the program can be used to dry up to 1 kg of laundry (around 3 jumpers). It is recommended to reverse all clothes before drying. Timing can change due to dimensions and thickness of load and to spinning chosen during washing. At the end of the cycle, clothes are ready to be worn, but if they are heavier, edges can be a bit wet: it is suggested to dry them naturally. It is recommended to unload clothes at the very end of the cycle. Attention: felting process of wool is irreversible; please dry exclusively clothes with symbol (symbol "ok tumble"); this program is not indicated for acrylic clothes.	1	70'
Antiallergy	One specific cycle that dries and in the same time helps to reduce the main allergens such as dustmites, pet hair, pollens and residual of powder detergents	4	220'
Relax Creases	This is a warm cycle that in only 12 minutes helps to relax folds and creases	2.5	*
Refresh	The perfect cycle to remove bad smells from the linens smoothing creases.	2.5	*
Smart Touch 	Customizable setting that interacts with the App on your android smartphone and to download the cycles (see the dedicated section). The factory sets the default programme Auto-Hygiene, which will sanitize the machine.		

* The real duration of drying cycle depends by the starting humidity level of the laundry due to spin speed, type and amount of load, cleanliness of filters and ambient temperature.

PROGRAMMES AND OPTIONS COMPATIBILITY

PROGRAMMES	SELECTABLE OPTIONS						AUTOMATIC OPTIONS	
	Rapids cycle	Time selection	Drying selection	Super Easy	Delay Start	Memo	Automatic Anti crease	Drying Manager
Whites	✓	✓	✓	✓	✓	✓	✓	✓
Cotton	-	-	-	-	✓	-	-	-
Mix & Dry	✓	✓	✓	✓	✓	✓	✓	✓
Coloured	-	-	✓	✓	✓	✓	✓	✓
Synthetics	✓	✓	✓	✓	✓	✓	✓	✓
Shirts	✓	-	✓	✓	✓	✓	✓	✓

Bed & Bath	-	✓	✓	✓	✓	✓	✓	✓
Jeans	-	-	-	✓	✓	✓	✓	✓
Down Jackets	-	-	-	-	✓	-	✓	✓
Sport	-	-	✓	-	✓	✓	✓	✓
Wool	-	-	-	-	✓	-	-	-
Antiallergy	-	✓	-	-	✓	✓	✓	-
Relax Creases	-	-	-	-	✓	-	✓	✓
Refresh	-	-	-	-	✓	-	✓	-

SMART TOUCH

This appliance is equipped with Smart Touch technology that allows you to interact. via the App, with smartphones based on Android operating system and equipped with NFC (Near Field Communication) function.

- Download on your smartphone the Candy Simply-Fi App.

FUNCTIONS

The main functions available using the App are:

- **Voice Assistant** - A guide to help you choose the ideal cycle with only three voice inputs (clothes/fabrics, color, drying level).
- **Cycles** — To download and launch new drying programmes.
- **Smart Care** — Smart Check-up and a troubleshooting guide.
- My Statistics — Drying statistics and tips for a more efficient use of your machine.

HOW TO USE SMART TOUCH

FIRST TIME - Machine registration

Enter the "Settings" menu of your Android smartphone and activate the NFC function inside the "Wireless & Networks" menu.

- Turn the knob to the Smart Touch position to enable the sensor on the dashboard.

- Open the App. create the user profile and register the appliance following the instructions on the phone display or the "Quick Guide" attached to the machine.

NEXT TIME—Regular usage

- Every time you want to manage the machine through the App, first you have to enable the Smart Touch mode by turning the knob to the Smart Touch indicator.
- Make sure you have unlocked your phone (from stand-by mode) and you have activated the NFC function; then. follow the steps mentioned earlier.
- If you want to start a dry cycle. load the laundry and close the door.
- Select the desired function in the App (e.g Starting a programme, the Smart Check upcycle. update statics. etc)
- Follow the instructions on the phone display. KEEPING IT ON the Smart Touch logo on the machine dashboard. when requested to do so by the App.

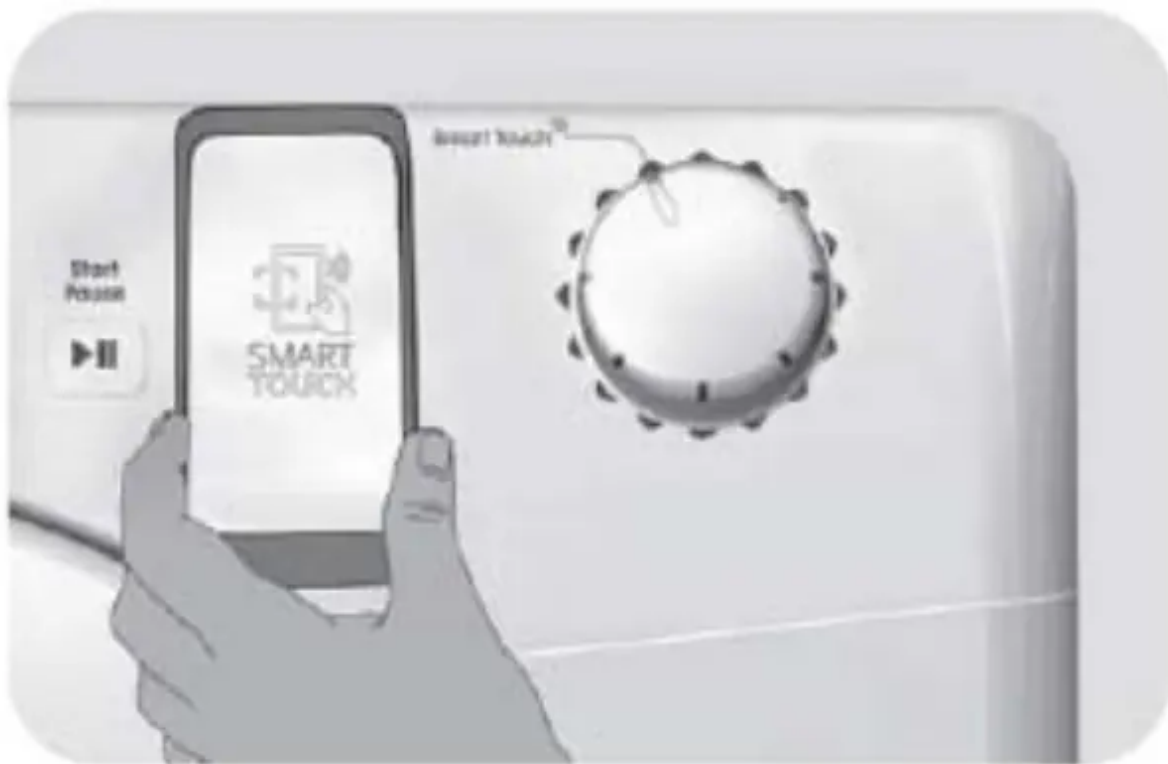

TROUBLESHOOTING

Drying time is too long/clothes are not dry enough

- Have you selected the correct drying time programme?
- Were the clothes too wet? Were the clothes thoroughly wrung or spin-dried?
- Does the filter need cleaning?
- Is the dryer overloaded?

The dryer does not operate

- Is there a working electricity supply to the dryer? Check using another appliance such as a table lamp.
- Is the plug properly connected to the main supply?
- Is there a power failure?
- Has the fuse blown?
- Is the door fully closed?
- Is the dryer switched on? both at the main supply and at the machine?
- Has the drying time or the programme been selected?
- Has the machine been switched on again after opening the door?

The dryer is noisy

- Switch off the dryer and contact GIAS Service for advice.



The **Indicator is on**

- Does the filter need cleaning?



The **Indicator is on**

- Does the water container need emptying?

Warning

This content is compiled from multiple sources and is provided for reference purposes only. It may not be complete or fully applicable to all situations. If you are unable to resolve your issue, please contact the product manufacturer or an authorized service provider for official support.