

TRUE WIRELESS EARBUDS

Earbuds X08

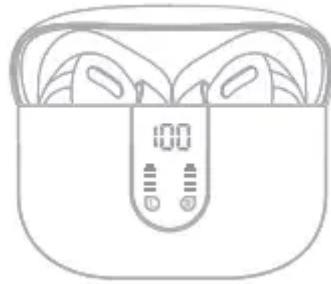

Packing List

- Couple Eartips
- User Manual
- USB-C Charging Cable
- Charging case
- User Manual



Earbuds X2



Charging case X1



Couple Eartips X 3

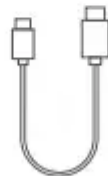

USB-C Charging Cable X1



User Manual X 1

Product Overview

1. Charging Case
2. LED Power Display
3. USB C Charging Port
4. Touch Control Area
5. Earbud LED Light
6. Microphones
7. Charging Point

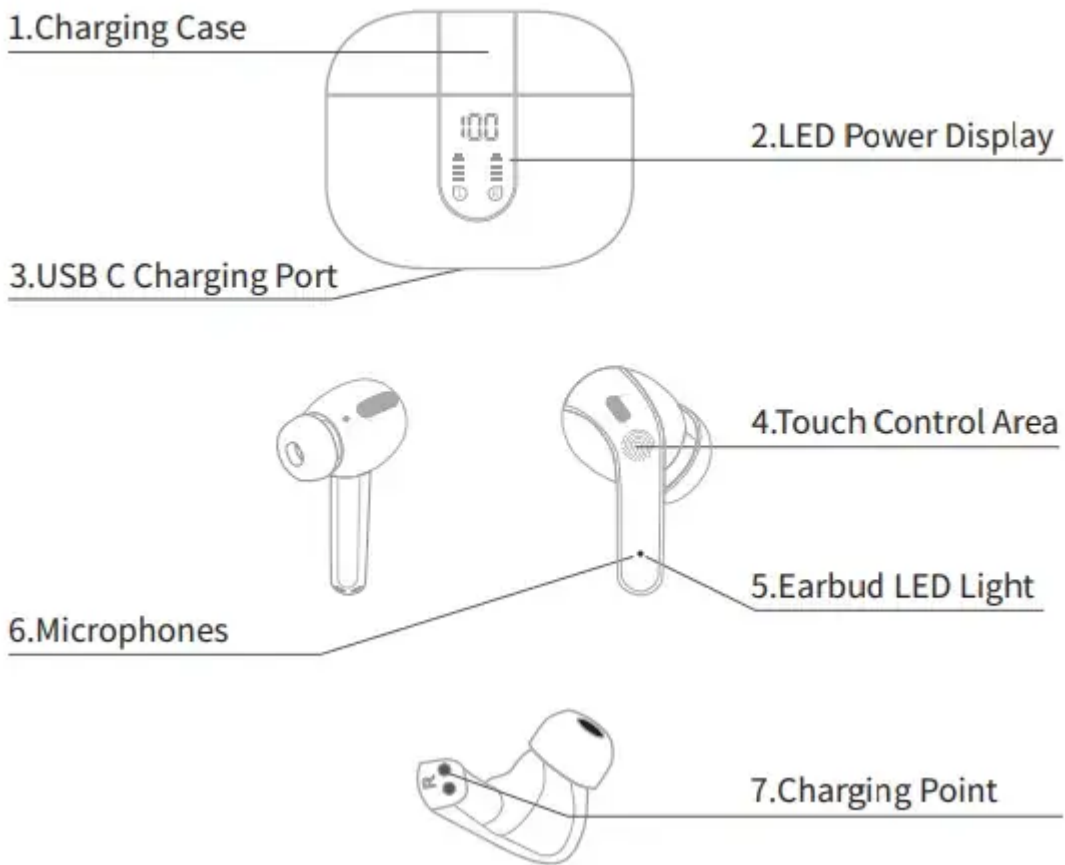

Wear

Step 1: Choose the comfortable eartips

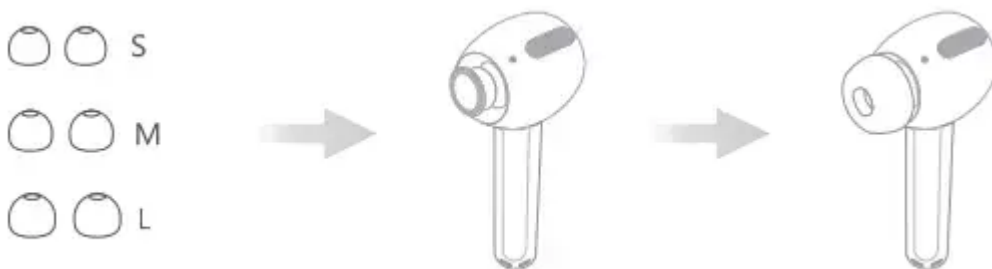

Step 2: Wear it in ear and adjust to a comfortable position (Please put the right and left headphones on the correct ear)



Power On

Auto Power On: Open the charging case, earbuds will power on automatically.

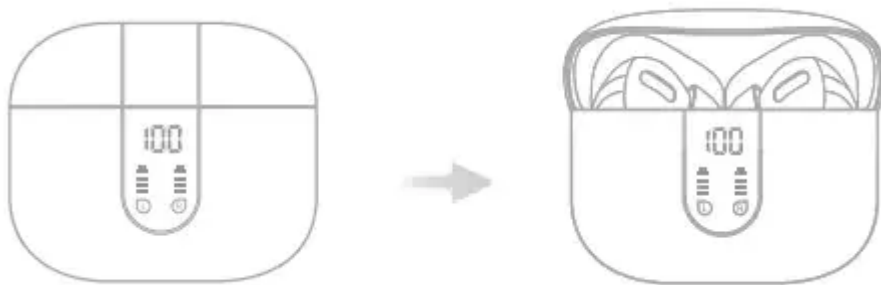

Manual Power On: Long tap on touch control area of one earbud for 2s, earbud will power on and earbud light will become blue.



Power Off

Method 1: Put both earbuds into the charging case, and close the case earbuds will power off automatically.

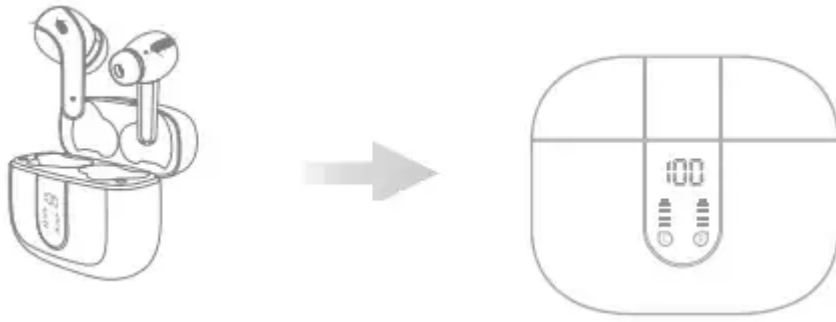

Method 2: Long tap on either earbud for 5s, light on earbud will flash red, then earbud power off.



Pairing

Stereo Mode

1. Open the charging case, earbuds will power on automatically, and then they will connect with each other, and waiting to pair with your phone.



Note: The earbuds can be used individually or simultaneously.

Single Earbud Mode

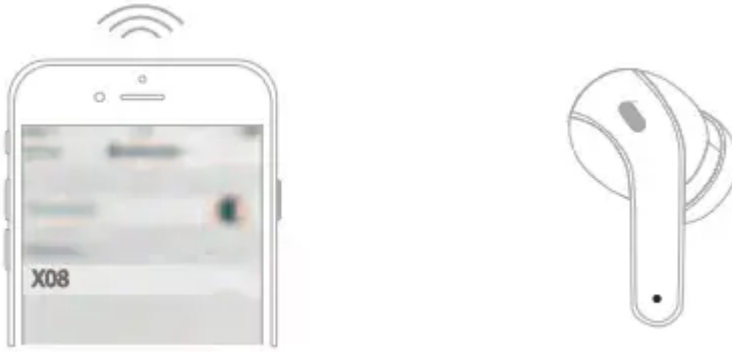

1. Take one earbud (Left/Right) out from the charging case and close the case.
2. Turn on bluetooth of your phone and choose "X08", earbud will pair with your phone successful.

Phone Calls Control

Answer / End Calls: Double tap on either earbud

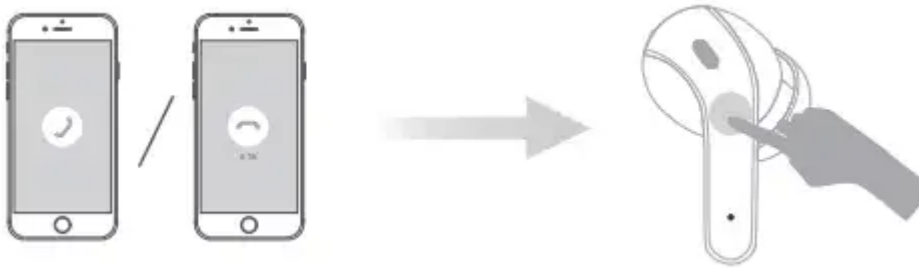

Reject Calls: Long tap on either earbud for 2s

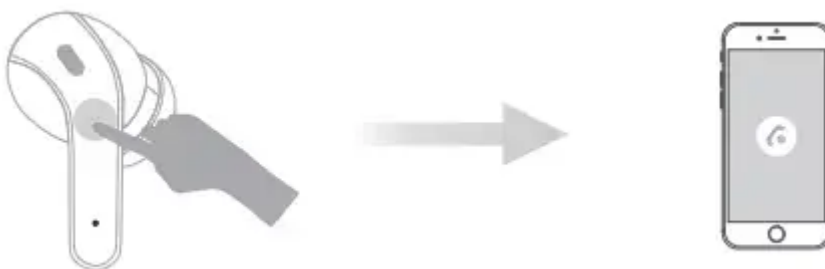

Note: The earbuds can be use individually or simuitaneously.

Music Control

Pause / Play: Tap once on either earbud

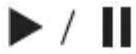

Volume and Voice Assistant:

- Previous Track: Double tap on left earbud



- Next Track: Double tap on right earbud



- Volume +: Long tap on right earbud
- Volume - : Long tap on left earbud
- Voice Assistant: Quick triple tap on right or left earbud



Earbuds Charging

Put both earbuds into charging case and close case, earbuds are being charged and led power display on case will move.

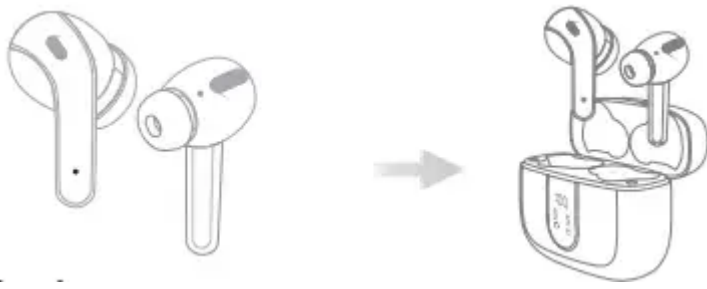

Charging for the case

Method 1: Use USB C charging cable (provided) to connect an adapter (not provided) your charging case.

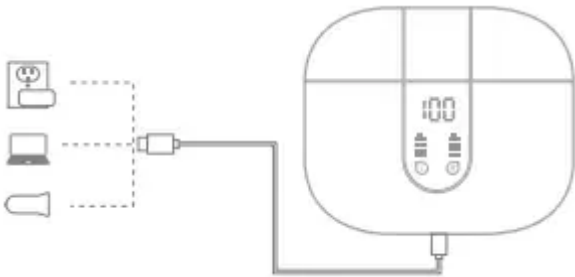

Method 2: Put the charging case on wireless charger (not provided). Please keep Led power display facing up, case can be charged automatically.



Note: for method 2, please place the charging case on the wireless charger until the LED power display flashes, which indicates case is being charged.

Safety Instruction

1. Using earphone at high to moderate volumes for extended periods of time will result in permanent hearing damage. It is advised you keep volume levels moderate to low at times for your safety.
2. Do not use while driving a car, cycling, operating machinery, or performing other activities that require hearing surrounding sounds.
3. Do not use earphone in thunderstorm weather, the earphone may not work properly in the condition, and increase the risk of being hit by lightning.
4. Earphone may not work properly under high temperature or high humidity conditions. Do not use

any corrosive cleaner/oil to clean the earphone.

5. If the earphone comes in contact with liquids, quickly wipe away.

6. If submersed in water, do not turn the earphone on until completely dried. (Tips: liquid submersion voids the warranty.)

7. Keep the earphone and packaging out of reach of children.

8. Please use the original charging cable provided by the earphone manufacturer for charging and choose the right adapter.

FAQ

Q: Why these earbuds can not pair with my mobile phones?

A:

1. Please make sure the earbuds are full charged and power on.
2. Please make sure the bluetooth of your phone is turn on.
3. If above 2 points have no problem, please put earbuds into the case again and close the case, hold on for 1min, then open the charging case and reconnect earbuds with your phone.

Q: Why does the music cut in or cut out?

A: First, please do not let the distance between these earbuds and your phone more than 33 feet (without obstacle). If the distance less than 33 feet, Please note 2 tips as below:

1. Please make sure there is no obstacle between the earbuds and your device.
2. Please make sure there is no Microwave oven/Wifi transmitter around you, which are more likely to produce electromagnetic interference and result in signal interruption.

Q: Why does the earbuds can not be charged and not disconnected with my phone even earbuds are put into case and I have closed the case?

A: Please make sure the charging case are not in low battery, if the charging case are in low battery, earbuds can not be charged and not disconnected even though they are in case. So, please use the type-c cable to charge the case fully.

Q: How to contact Our Customer service?

A: We offers one year replacement warranty, if there is any issue with your earbuds, please don't hesitate to contact us, we will reply within 24 hours and resolve it 100%.

Troubleshooting

Issue 1: Earbuds or charging case couldn't be charged.

Cause: The charging contacts of earbuds or case are dirty.

Troubleshooting: Please clean them as below:

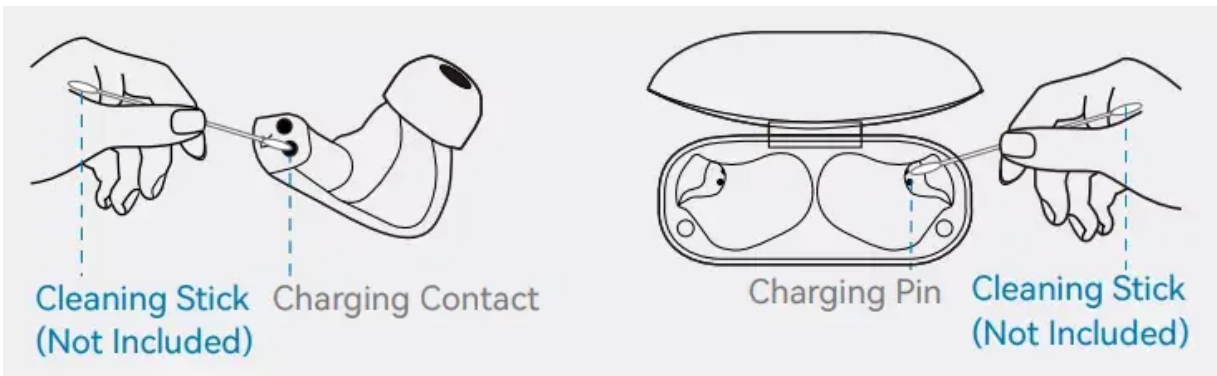

Cause: Incorrect charging cable.

Troubleshooting: Use usb-c cable to charge these earbuds.

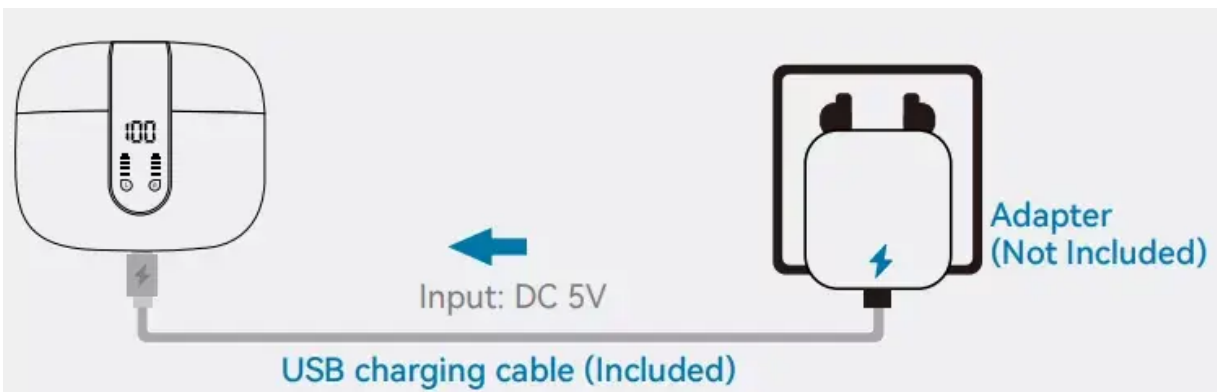

Input: DC 5V

Adapter (Not Included)

USB charging cable (Included)

Issue 2: Sound Cut in/out or connected/disconnected.

Cause ①: There is electromagnetic interference around earbuds.

Troubleshooting: Please keep away from these interference.

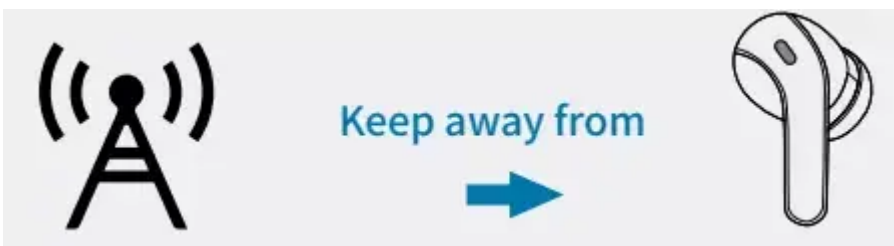

Cause ②: The distance between earbuds and phone is over 33 feet.

Troubleshooting: Please keep the distance less than 33 feet (without obstacle).



Cause ③: The Earbuds in low battery or high temperature.

Troubleshooting: Please use USB-C cable to charge for earbuds.



After eliminating the above causes, please re-pair these earbuds with phone.

Issue 3: The sound for calls are poor or small.

Cause ①: Only wear the sub earbud.

Troubleshooting: Please wear two earbuds for calls and keep L earbud's mic close to your mouth. If only wear one earbud, please keep the other one into charging case and close the lid of case.

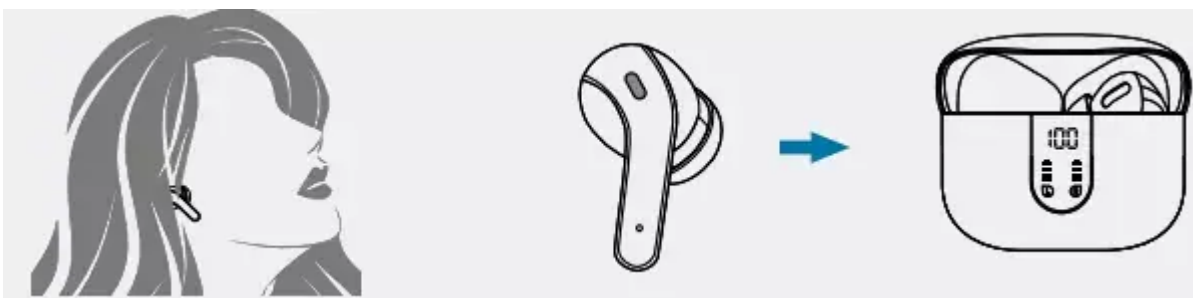

Cause ②: The microphone hole was blocked.

Troubleshooting: Please clean the microphone hole.

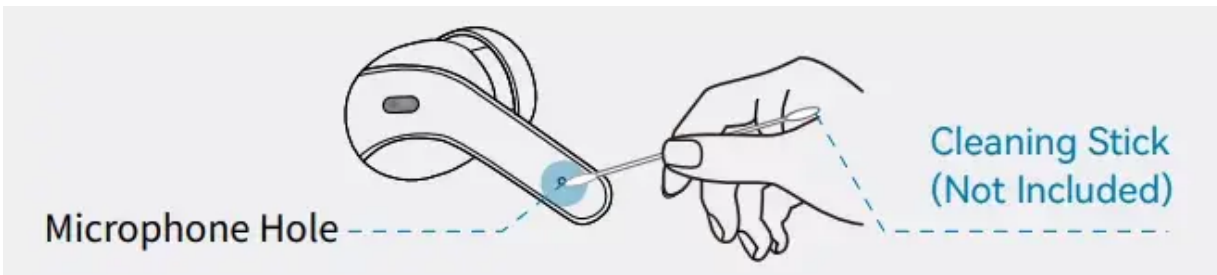

Cleaning Stick (Not Included)

Cause ③: The grilles or the ear tips are dirty.

Troubleshooting: Please clean as below:

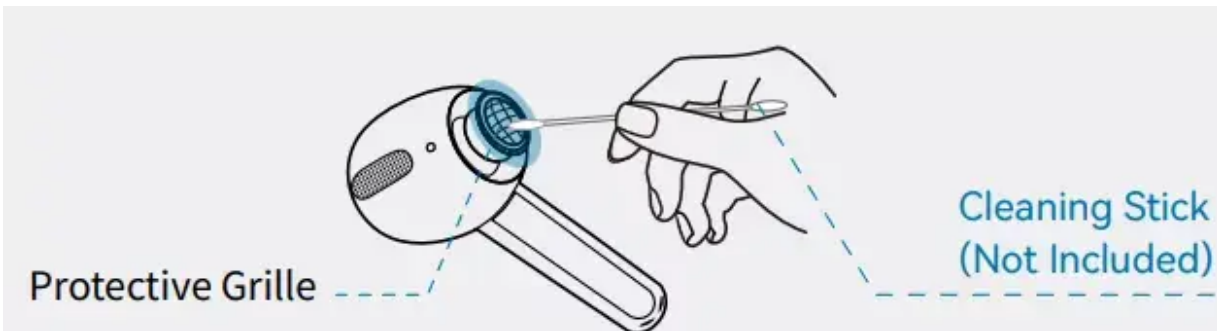

Cleaning Stick (Not Included)

Issue 4 Earbuds can pair with phone , but couldn't pair with PC/Pad.

Cause ①: These earbuds connected with previous device automatically.

Troubleshooting: Turn off previous device bluetooth before you pair with new device

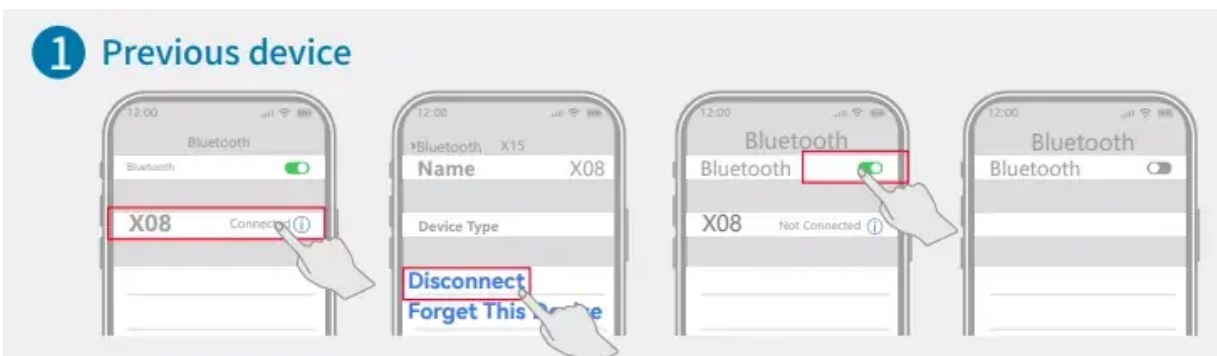

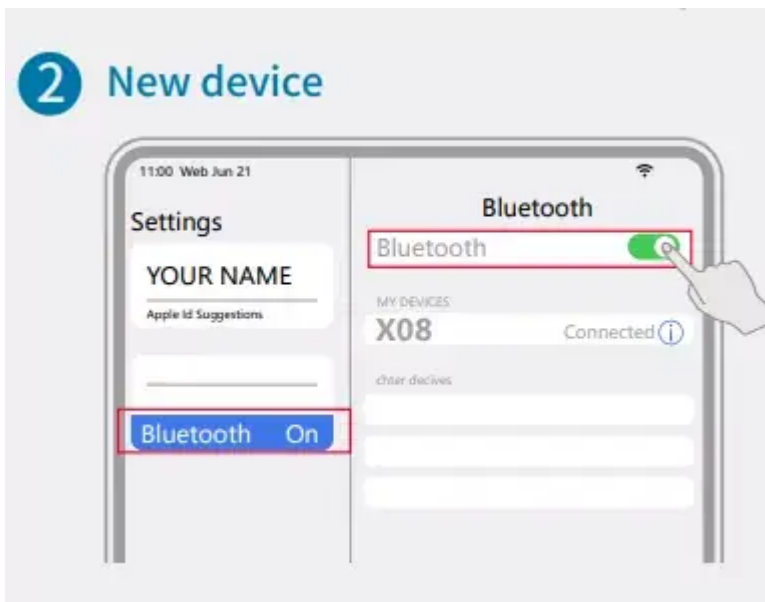

Cause ②: The bluetooth version is too old.

Troubleshooting: Please connect with device which bluetooth version is 4.0 or over 4.0.

Issue 5: These earbuds have static noise or a constant buzzing sound.

Cause ①: The signal and connection between the earbuds and your device are affected by electronic interference emitted by devices like microwave ovens, WiFi routers, signal lights, or devices in airports/metro stations, etc.

Troubleshooting:

- 1) Please clean the grilles.
- 2) Try to use the earbuds in different locations and see whether the static noise is less or gone.
- 3) Keep a distance from electromagnetic interference sources.
- 4) Turn off the devices nearby that may cause interference.
- 5) If the problem persists, please contact us for further assistance or replacement.



Issue 6: Wear Issue

Cause ①: Don't wear correctly or use the suitable eartips

Troubleshooting:

Step 1: Choose the comfortable eartips

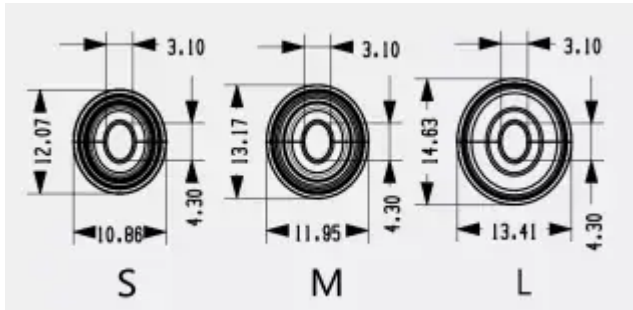

Step 2: Wear it in ear and adjust to a comfortable position (Please put the right and left headphones on the correct ear)



Issue 7: The music sound is poor or bad

Cause 1: Don't use the suitable eartips

Troubleshooting: Choose the suitable eartips after received the product.



Cause 2: The grilles or the ear tips are dirty

Troubleshooting: Please clean as below:



Cause 3: The earbuds inside are wet

Troubleshooting: Please shake the earphones to let the water come out

Protective Grille

Cleaning Stick (Not Included)

Video Support & Customer Service

To get more information, please scan the QR code on the left bottom side. There, you can watch Youtube videos about tutorials and troubleshooting to all kinds of issues.

If you have any issue during using time, please feel free to contact us.

Contact Steps:

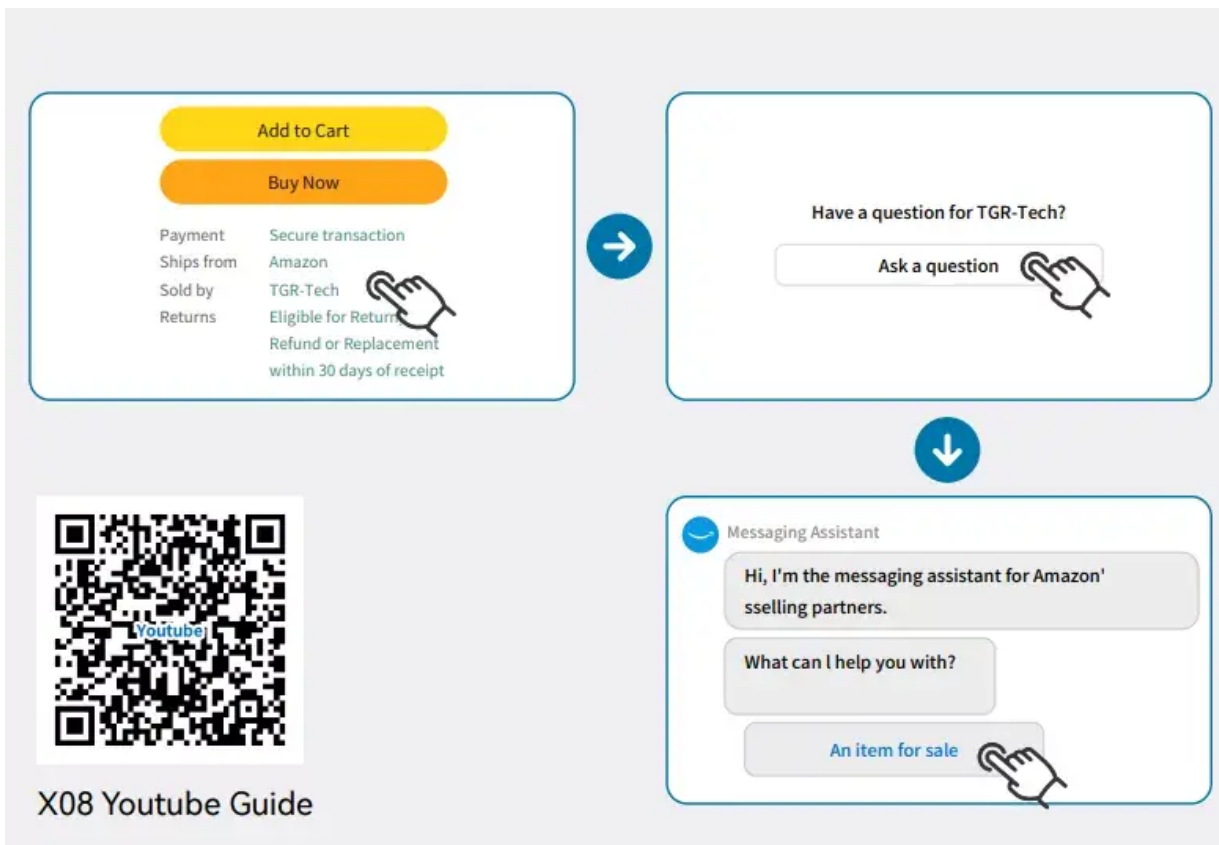

Warning

This content is compiled from multiple sources and is provided for reference purposes only. It may not be complete or fully applicable to all situations. If you are unable to resolve your issue, please contact the product manufacturer or an authorized service provider for official support.