

# User Manual True Wireless Earbuds



## Overview

### Choose Eartips

Please try middle eartips first as they fit most people.

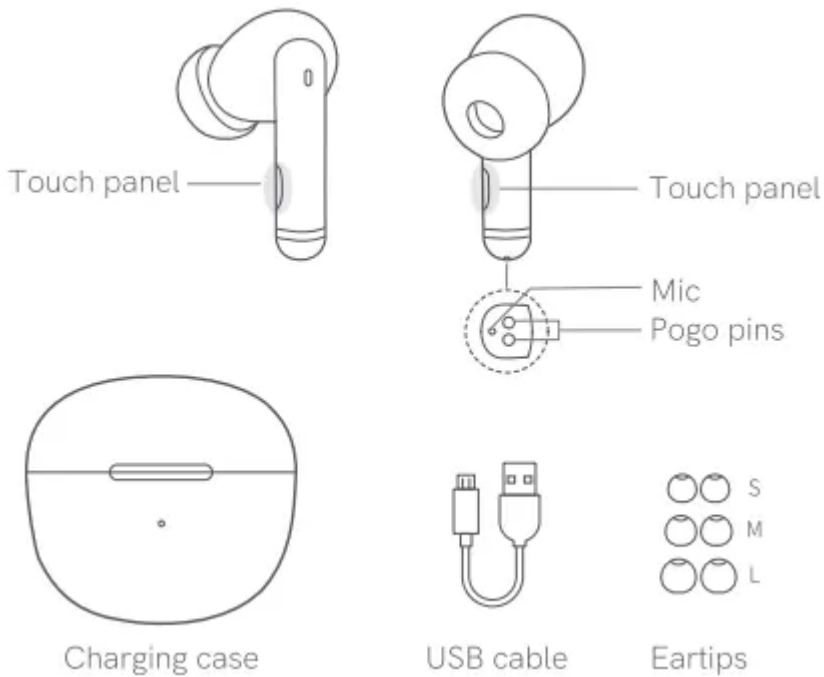

Above pictures are for reference only and practical items may vary.



## How To Use

Open lid and pick up earbuds to power them on. On phone, search for QCY-T13 and tap to connect. Power on earbuds and they will auto reconnect to the last phone in connectivity records, if any.

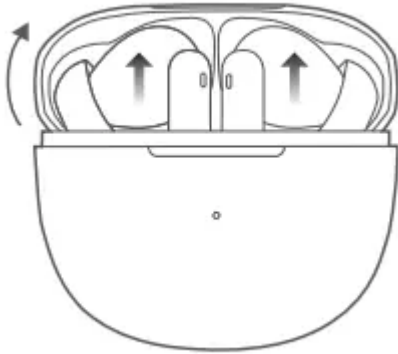

### One Press to Turn Connectable

1. Earbuds have been connected to phone.
2. Push earbuds into case. open case and keep pressing button on case for 3s or until LED blinks green 3 times. Pick up earbuds again to turn them connectable.

## Factory Setting

Push earbuds into case, open lid and keep pressing button on case for 10s or until LED blinks red and blue 3 times to reset and power on earbuds.

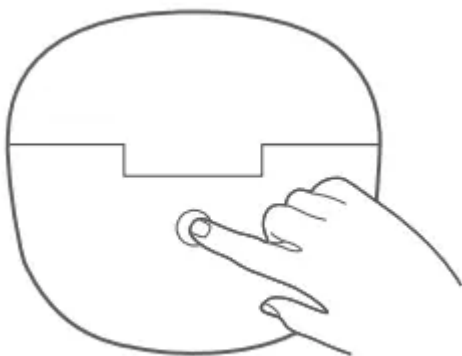

### LED for Battery Level (Press the Button)

- Battery level >90%: green
- Battery level between 90% and 50%: blue
- Battery level <50%: red

## LED

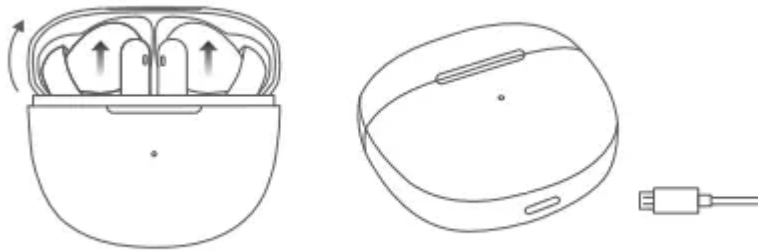

### LED on Case

LED will turn solid red when case is charging and turn solid green once it is topped up.

## Instructions

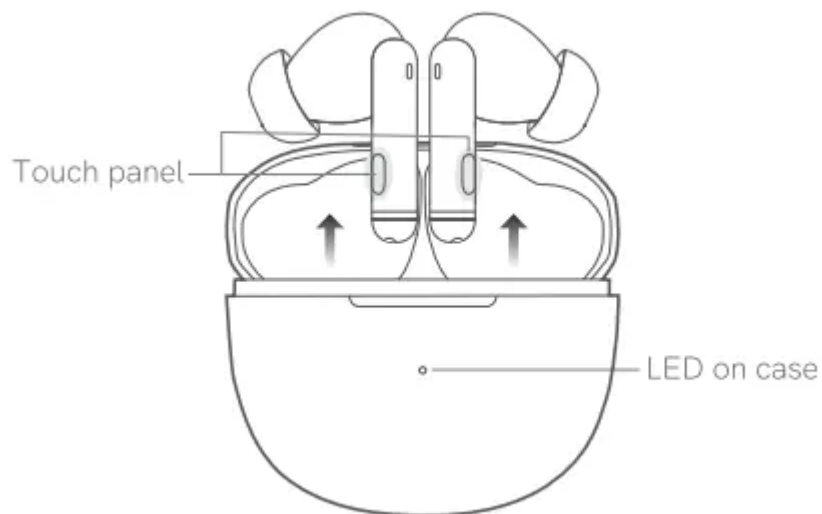

Power-on: keep touching panel for 1.5s



Power-off: Push earbuds into case and close lid( HALL SWITCH) "Answer/end call: double touch panel



Ignore call: keep touching panel for 1.5s



Skip track backward: triple touch left panel



Skip track forward: triple touch right panel



Voice assistant: touch left/right panel 4 times



Playback /pause: double touch left/right panel to play/pause



Gaming mode: keep touching right panel for 3s



Mode switch: keep touching left panel for 3s to switch among ANC, normal and transparent modes.

## Tips

1. Before using the earbuds, please read the manual carefully and keep it for future references.
2. The earbuds need to be fully charged prior to first-time use.
3. If the earbuds are left unused for over two weeks, please recharge.
4. Please use the chargers made by qualified manufacturer.
5. If the earbuds cannot be found by your phone. please check whether they are in pairing mode; if left unconnected for a long while, the earbuds will exit pairing mode. please re-enter the mode; if a procedure error of your phone occurs, reboot it; if a procedure error of the earbuds occurs. reboot or reset it

## Caveats

1. Never disassemble or modify your earbuds for any reasons to avoid any damages and danger.
2. Do not store the earbuds in extreme temperatures (under 0°C or over 45°C).
3. Avoid using the indicator close to the eyes of children or animals.
4. Do not use the earbuds during a thunderstorm to avoid dysfunction and increasing risk of electric shock.
5. Do not use harsh chemicals or strong detergents to clean the earbuds

**Note:** please do not use earbuds for a long time as may damage your hearing.

## FAQ - Troubleshooting

### Why can I only listen to one?

- Put the two earphones back into the charging compartment, and take them out again to see if the binaural mode is restored. If the earphones are not reset, it can be solved.

### **What can I do if the mobile phone prompts that it cannot be connected?**

- Delete the pairing record on the mobile phone, and then search for signal connection again after deleting.

### **How to listen to music/call without sound?**

- Android has a setting icon on the right side of the mobile phone connection record, click to enter, uncheck the two audio options and re-select, Apple is setting the general auxiliary function to enter the audio call mode, select automatic, if it is automatic, change to other Options, then select Automatic, if not restored, delete the pairing record and try again.

### **Why is there a delay in the video/game?**

- Affected by the usage environment, network, and mobile phone codec speed, it will cause different degrees of delay when the mobile phone transmits audio data to the headset

### **Why is it stuck/interrupted?**

- Dear, if there are a large number of Wi-Fi connections, 4G signals, high-power electrical appliances, etc. that interfere during use, there may be stuck and intermittent situations, which can be solved by changing the environment or re-pairing and connecting

## **Battery & Charging**

Case Charge Capacity: 380mAh / Input: 5v 400mA

Full Charge Time: 2 hours / Charging port: Type-C

Quick Charge: No / Wireless Charging: No

Single Use Playtime: Up to 6 hours (ANC off), 5 hours (ANC on)

Playtime with Charge Case: Up to 24 hours (ANC off), 27 hours (ANC on)

App Support: Yes (Android only)

## **Bluetooth**

Bluetooth Range: 10m advertised / Bluetooth: Bluetooth® 5.1

Bluetooth Protocols: HSP/ HFP/ A2DP/ AVRCP tifications

## **Specification**

Driver: 10mm Dynamic Drivers / Chipset: REALTEK

Mic: 4 / ANC: Yes, up to 40dB / Volume Control: Yes

Codecs: SBC

Earbud Weight: 4.87g / Earbud Dimensions: 30mm stem length

Gross Case & Buds Weight: 41.21g

Case Dimensions: 57mm (width) x 53mm (height) x 19mm (depth)

## Product Parameter

Product name: HT03

Certified model: BH21HT03A

Pairing name: QCY-HT03

Bluetooth version: 5.1

Available system: iOS/ Android

Operation range: 10m

Talk time: approx. 3.5hr

Music time: Shr/6hr(ANC ON/OFF)

Bluetooth profiles: HFP/HSP/A2DP/AVRCP.

Battery capacity(case): 380mAh

Top-ups by case: 3(for both earbuds)

Charging port: Type-C

## Warranty Card

### Warranty Period

12 months after you purchase this item (or you may inquire your local shopper for more details)

### Free Service:

Supposing any defects caused by quality issues occur within the warranty period. please take this warranty card and purchase receipts to your distributor for free exchange service.

Image 09

Free exchange service will not be accessed under following circumstances

1. Damages caused unauthorized disassembly.
2. Defects or physical damages caused by leaking or dropping off
3. Damages by act of God. Supposing your item is within any damages or defects except the above circumstances. please return to us or your distributor for free repairing.

## FCC Statement

This equipment has been tested and found to comply with the limits for a Class B digital device, pursuant to Part 15 of the FCC Rules. These limits are designed to provide reasonable protection against harmful interference in a residential installation.

This equipment generates uses and can radiate radio frequency energy and, if not installed and used in accordance with the instructions, may cause harmful interference to radio communications. However, there is no guarantee that interference will not occur in a particular installation. If this equipment does cause harmful interference to radio or television reception, which can be determined by turning the equipment off and on, the user is encouraged to try to correct the interference by one or more of the following measures:

- Reorient or relocate the receiving antenna.
- Increase the separation between the equipment and receiver.
- Connect the equipment into an outlet on a circuit different from that to which the receiver is connected.
- Consult the dealer or an experienced radio/TV technician for help.

This device complies with part 15 of the FCC Rules. Operation is subject to the following two conditions:

1. This device may not cause harmful interference, and (2) this device must accept any interference received, including interference that may cause undesired operation.

Changes or modifications not expressly approved by the party responsible for compliance could void the user's authority to operate the equipment.

### Warning

This content is compiled from multiple sources and is provided for reference purposes only. It may not be complete or fully applicable to all situations. If you are unable to resolve your issue, please contact the product manufacturer or an authorized service provider for official support.