

Check Your Vent System for Good Airflow



Good airflow

Along with heat, dryers require good airflow to efficiently dry laundry. Proper venting will reduce your drying times and improve your energy savings. See Installation Instructions.

The venting system attached to the dryer plays a big role in good airflow.

Service calls caused by improper venting are not covered by the warranty and will be paid by the customer, regardless of who installed the dryer.

Maintain good airflow:

- Clean your lint screen before each load.
- Replace plastic or foil vent material with 4" (102 mm) diameter heavy, rigid vent material.

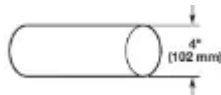

- Use the shortest length of vent possible.
- Use no more than four 90° elbows in a vent system; each bend and curve reduces airflow.

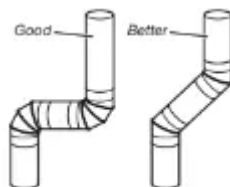

- Remove lint and debris from the exhaust hood.
- Remove lint from the entire length of the vent system at least every 2 years. When cleaning is complete, be sure to follow the Installation Instructions supplied with your dryer for final product check.
- Clear away items from the front of the dryer.

On models with a selectable temperature knob, you may choose a setting based on the fabrics in your load. Drying time and temperature will depend on your dryer model.

ACCUDRY™/AUTOMATIC DRY

Senses moisture in the load or air temperature and shuts off when the load reaches the selected dryness level.

Gives the best drying in the shortest time. Drying time will vary based on fabric type, load size, and dryness setting.

3. TEMPERATURE

Select a drying temperature based on the fabrics in your load. If you are unsure of the temperature to select for a load, select the lower setting rather than the higher setting.

NOTE: The No Heat temperature setting (on some models) is not available on ACCUDRY™ cycles.

4. CYCLE SIGNAL/PUSH TO START

The Cycle Signal produces an audible sound when the drying cycle is finished. Promptly removing clothes at the end of the cycle reduces wrinkling.

Turn the Cycle Signal knob to select the desired setting (On or Off). Press the PUSH to START knob to start the dryer.

NOTE: When the Wrinkle Shield™ setting is selected and the Cycle Signal is on, the tone will sound every minutes until the clothes are removed or the Wrinkle Shield™ setting ends.

Cycle Guide – ACCUDRY™/Automatic Dry Cycles

Not all cycles and settings are available on all models.

ACCUDRY™ – Senses moisture in the load or air temperature and shuts off when the load reaches the selected dryness level. Choose ENERGY PREFERRED cycle for optimal energy savings.

Items to dry:	Cycle:	Temperature:	Available Options:	Cycle Details:
Jeans, heavy work clothes, towels	Jeans, More, or Very Dry	High	Wrinkle Shield™ Temperature Cycle Signal	Automatic cycles give the best drying in the shortest time. Drying time varies based on fabric type, load size, and dryness setting. Select a drying temperature based on the fabrics in your load. If you are unsure of the temperature to select for a load, select the lower setting rather than the higher setting.
Work clothes, medium weight fabrics, sheets	Energy Preferred	Medium	Wrinkle Shield™ Temperature Cycle Signal	
Casual, shirts, pants, lightweight items, synthetics, delicates, athletic wear	Delicate or Less Dry	Low	Wrinkle Shield™ Temperature Cycle Signal	

NOTE: If loads do not seem as dry as you would like, select More or Very Dry the next time you dry a similar load. If loads seem drier than you like, select Less Dry the next time you dry a similar load.



Cycle Guide – Timed Dry Cycles

Not all cycles and settings are available on all models.

TIMED DRY – Will run the dryer for the specified time on the control.

Items to dry:	Cycle:	Temperature:	Available Options:	Cycle Details:
Large or heavy items such as thick towels or robes	Heavy Dry or Heavy Duty	Any	Temperature	Choose High to dry large or heavy loads.
Any load	Damp Dry	Any	Temperature	Dries items to a damp level or for items that do not require an entire drying cycle.
Rubber, plastic, heat sensitive fabrics	Fluff Air	No Heat	Temperature	No heat drying.

Setting the Drying Temperature

If your dryer has multiple heat settings:

A High temperature setting may be used for drying

A Low to Medium temperature setting may be used for drying medium-weight items such as sheets, blouses, dresses, underwear, permanent press fabrics, and some knits. Use the No Heat setting for foam, rubber, plastic, or heat-sensitive fabrics. Line dry bonded or laminated fabrics.

NOTE: If you have questions about drying temperatures for various loads, refer to the care label directions.

Using Your Dryer

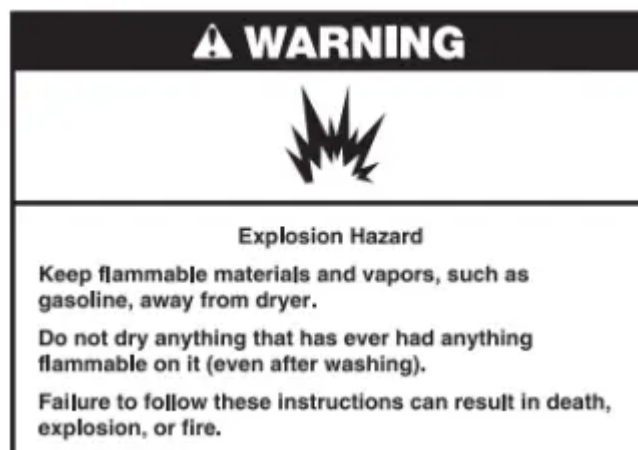

WARNING: To reduce the risk of fire, electric shock, or injury to persons, read the IMPORTANT SAFETY INSTRUCTIONS before operating this dryer.

Before using your dryer, wipe the dryer drum with a damp cloth to remove dust from storing and shipping.

1. Clean the lint screen

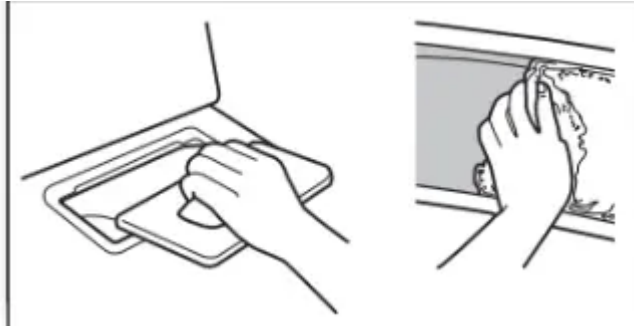

Clean the lint screen before each load. Pull the lint screen out of its holder. Roll lint off the screen with your fingers. Do not rinse or wash screen to remove lint. Push the lint screen firmly back into place.

For additional cleaning information, see “Dryer Care”.

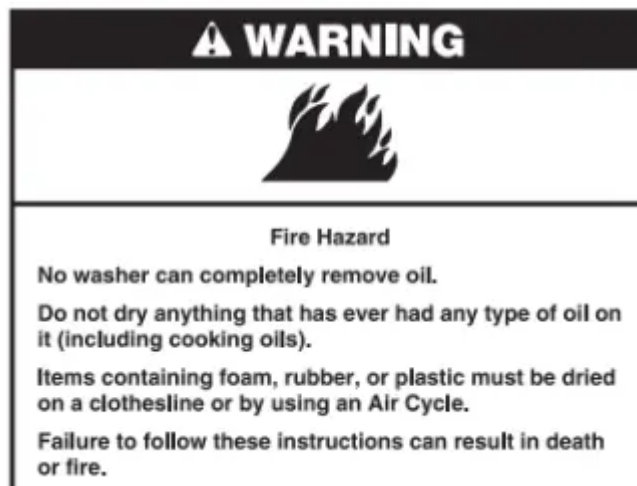

2. Load the dryer

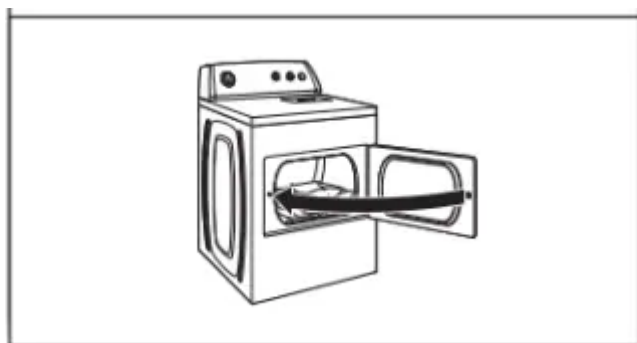

Place laundry in the dryer. Close the door.

NOTE: Your model may have a different door than the one shown. Some models have drop down doors.

Do not tightly pack the dryer; clothes should be able to tumble freely. Control panel and cycles may vary, depending on model.

3. Select the desired cycle



Select the desired cycle for your load. See the “Cycle Guide” for more information about each cycle.

ACCUDRY™/Automatic Dry Cycles

You can select a different dryness level, depending on your load, by turning the knob to dryness level.

Selecting More or Very Dry, ENERGY PREFERRED, or Less Dry automatically adjusts the dryness level at which the dryer will shut off. Once a dry level is set, it cannot be changed without stopping the cycle.

ACCUDRY™/AUTOMATIC DRY cycles give the best drying in the shortest time. Drying time varies based on fabric type, load size, and dryness setting.

NOTE: More or Very Dry removes more load moisture. ENERGY PREFERRED is used for a starting point for ACCUDRY™ cycles. Choose ENERGY PREFERRED for optimal energy savings. Less Dry removes less moisture and is used for loads you may want to put on a hanger to complete drying. heavyweight items such as towels and work clothes.

4. Set cycle settings and options



Select cycle settings and options by turning the knob to the desired position.

NOTE: Not all options and settings are available with all cycles.

Temperature

Turn the Temperature knob to change the drying temperature setting. See “Setting the Drying Temperature”.

Wrinkle Shield™ feature (on some models)

- Get 90 minutes of heat-free, periodic tumbling at the end of a cycle. Turn the Wrinkle Shield™ knob to select on or off at any time before the cycle has ended.
- Some models with a Wrinkle Shield™ cycle will automatically get 40 minutes of heat-free, periodic tumbling at the end of a cycle. For various loads, refer to the care label directions.

9. Select Cycle Signal (if desired)



Turn the Cycle Signal knob to select the desired setting (On or Off). The Cycle Signal produces an audible sound when the drying cycle is finished. Promptly removing clothes at the end of the cycle reduces wrinkling.

NOTE: When the Wrinkle Shield™ setting is selected and the Cycle Signal is On, the tone will sound every 5 minutes until the clothes are removed, or the Wrinkle Shield™ setting ends.

6. Press PUSH to START to begin cycle



Push and hold the PUSH to START knob to begin the cycle.

Promptly remove garments after cycle has completed to reduce wrinkling. Use the Wrinkle Shield™ feature to avoid wrinkling when you are unable to remove a load from the dryer as soon as it stops.

Dryer Care

Cleaning the dryer location

Keep dryer area clear and free from items that would block the air flow for proper dryer operation. This includes clearing piles of laundry in front of the dryer.

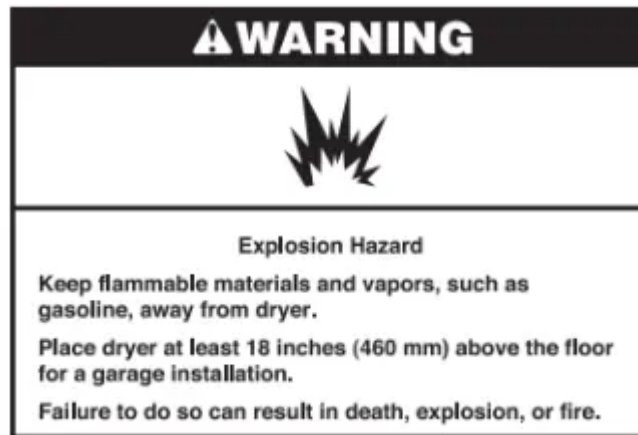

Cleaning the dryer interior

To clean dryer drum

1. Apply a liquid, nonflammable household cleaner to the stained area of the drum and rub with a soft cloth until stain is removed.
2. Wipe drum thoroughly with a damp cloth.
3. Tumble a load of clean cloths or towels to dry the drum.

NOTE: Garments that contain loose dyes, such as denim blue jeans or brightly colored cotton items, may discolor the dryer interior. These stains are not harmful to your dryer and will not stain future loads of clothes. Dry these items inside out to avoid drum staining.

Removing accumulated lint

From Inside the Dryer Cabinet

Lint should be removed every 2 years, or more often, depending on dryer usage. Cleaning should be done by a qualified servicer.

From the Exhaust Vent

Lint should be removed every 2 years, or more often, depending on dryer usage.

Cleaning the lint screen

Every load cleaning

The lint screen is located in the dryer. A screen blocked by lint can increase drying time.

To clean:

1. Pull the lint screen out of its holder. Roll lint off the screen with your fingers. Do not rinse or wash screen to remove lint. Wet lint is hard to remove.

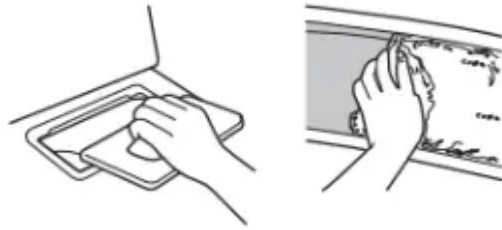

2. Push the lint screen firmly back into place.

IMPORTANT:

- Do not run the dryer with the lint screen loose, damaged, blocked, or missing. Doing so can cause overheating and damage to both the dryer and fabrics.
- If lint falls off the screen into the dryer during removal, check the exhaust hood and remove the lint. See "Venting Requirements."

As needed cleaning

Laundry detergent and fabric softener residue can build up on the lint screen. This buildup can cause longer drying times for your clothes, or cause the dryer to stop before your load is completely dry. The screen is probably clogged if lint falls off while the screen is in the dryer.

Clean the lint screen with a nylon brush every 6 months, or more frequently, if it becomes clogged due to a residue buildup.

To wash:

1. Roll lint off the screen with your fingers.
2. Wet both sides of lint screen with hot water.
3. Wet a nylon brush with hot water and liquid detergent. Scrub lint screen with the brush to remove residue buildup.

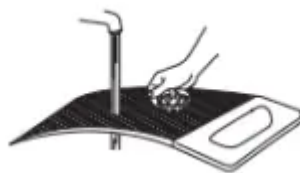

4. Rinse screen with hot water.
5. Thoroughly dry lint screen with a clean towel. Reinstall screen in dryer.

Vacation, storage, and moving care

Non-Use or Storage Care

Operate your dryer only when you are at home. If you will be on vacation or not using your dryer for an extended period of time, you should:

1. Unplug dryer or disconnect power.
2. For gas dryers only): Close shut-off valve to gas supply line.
3. Clean lint screen. See “Cleaning the Lint Screen.”

Moving Care

For power supply cord-connected dryers:

1. Unplug the power supply cord.
2. Make sure leveling legs are secure in dryer base.
3. Use tape to secure dryer door.

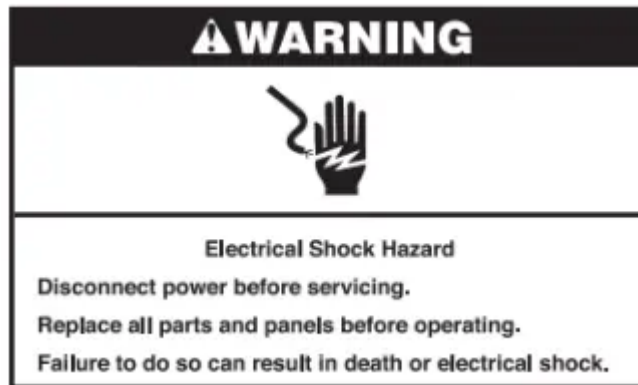

For direct-wired dryers:

1. Turn off power at fuse or breaker box.
2. Disconnect wiring.
3. Make sure leveling legs are secure in dryer base.
4. Use tape to secure dryer door.

For gas dryers:

1. Unplug or disconnect power to dryer.
2. Close shut-off valve in gas supply line.
3. Disconnect gas supply line pipe and remove fittings attached to dryer pipe.
4. Cap the open fuel supply line.
5. Make sure leveling legs are secure in dryer base.
6. Use tape to secure dryer door.

Reinstalling the Dryer

Follow the “Installation Instructions” to locate, level, and connect the dryer.

Changing the drum light on some models)

1. Unplug dryer or disconnect power.
2. Open the dryer door. Locate the light bulb cover on the back wall of the dryer. Using a Phillips-head screwdriver, remove the screw located in the lower right-hand corner of the cover. Remove the cover.

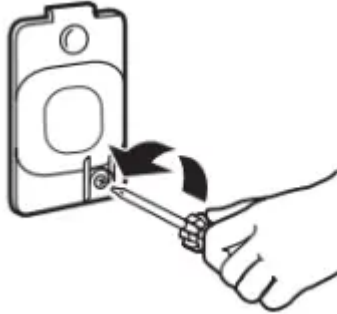

3. Turn bulb counterclockwise. Replace the bulb with a 10-watt appliance bulb only. Replace the cover and secure with the screw.
4. Plug into a grounded outlet or reconnect power.

Troubleshooting

Clothes are not drying satisfactorily; drying times are too long

- Lint screen clogged with lint.

Lint screen should be cleaned before each load.

- Fluff Air cycle or No Heat temperature setting has been selected.

Select the right cycle for the types of garments being dried. See “Cycle Guide.”

- Load too large and heavy to dry quickly.

Separate the load to tumble freely.

- Exhaust vent or outside exhaust hood clogged with lint, restricting air movement.

Run the dryer for 5-10 minutes. Hold your hand under the outside exhaust hood to check air movement. If you do not feel air movement, clean exhaust system of lint or replace exhaust vent with heavy metal or fl exible metal vent. Make sure vent is not crushed or kinked. See Installation Instructions.

- Fabric softener sheets blocking the grille.

Use only one fabric softener sheet, and use it only once.

- Exhaust vent not the correct length.

Check that the exhaust vent is not too long or has too many turns. Long venting will increase drying times. Make sure vent is not crushed or kinked. See Installation Instructions.

- Exhaust vent diameter not the correct size.

Use 4" (102 mm) diameter vent material.

- Dryer located in a room with temperature below 45oF (7oC).

Proper operation of dryer cycles requires temperatures above oF (7oC).

- Dryer located in a closet without adequate opening.

Closet doors must have ventilation openings at the top and bottom of the door. The front of the dryer requires a minimum of 1" (25 mm) of airspace and, for most installations, the rear of the dryer requires 5" (127 mm). See Installation Instructions.

Dryer will not run

- Door not closed completely.

Make sure the dryer door is closed completely.

- PUSH to START knob not pressed firmly or held long enough.

Press and hold the PUSH to START knob until you hear the dryer drum moving.

- Household fuse is blown or circuit breaker has tripped.

Electric dryers use 2 household fuses or circuit breakers. The drum may be turning, but you may not have heat. Replace both fuses or reset the circuit breaker. If the problem continues, call an electrician.

- Incorrect power supply.

Electric dryers require 240-volt power supply. Check with a qualified electrician.

- Wrong type of fuse.

Use a time-delay fuse.

Unusual sounds

- Dryer had a period of non-use.

If the dryer hasn't been used for awhile, there may be a thumping sound during the first few minutes of operation.

- A coin, button, or paper clip is caught between the drum and front or rear of the dryer.

Check the front and rear edges of the drum for small objects. Clean out pockets before laundering.

- It is a gas dryer.

The gas valve clicking is a normal operating sound.

- The four legs are not installed, or the dryer is not level front to back and side to side.

The dryer may vibrate if not properly installed. See Installation Instructions.

- Clothing knotted or balled up.

When balled up, the load will bounce, causing the dryer to vibrate. Separate the load items and restart the dryer.

No heat

- Household fuse is blown or circuit breaker has tripped.

The drum may be turning, but you may not have heat. Electric dryers use 2 household fuses or circuit breakers. Replace both fuses or reset the circuit breaker. If the problem continues, call an electrician.

- Supply line valve not open.

For gas dryers, make sure the supply line valve is open.

- Incorrect power supply.

Electric dryers require 240-volt power supply. Check with a qualified electrician.

Cycle time too short

- Automatic cycle ending early.

The load may not be contacting the sensor strips. Level the dryer.

Use Timed Dry for very small loads. Change the Dry Level setting on ACCUDRY™/ Automatic Dry cycles.

Increasing or decreasing the Dry Level setting will change the amount of drying time in a cycle.

Lint on load

- Lint screen clogged.

Lint screen should be cleaned before each load.

Stains on load or drum

- Dryer fabric softener not properly used.

Add dryer fabric softener sheets at the beginning of the cycle.

Fabric softener sheets added to a partially dried load can stain your garments.

- Drum stains are caused by dyes in clothing (usually blue jeans).

These will not transfer to other clothing.

Loads are wrinkled

- Load not removed from dryer at the end of the cycle.

Select Wrinkle Shield™ feature to tumble the load without heat to avoid wrinkling.

- Dryer tightly packed.

Dry smaller loads that can tumble freely reduce wrinkles from forming.

Odors

- You have recently been painting, staining, or varnishing in the area where your dryer is located.

If so, ventilate the area. When the odors or fumes are gone from the area, rewash and dry the clothing.

- The electric dryer is being used for the first time.

The new electric heating element may have an odor. The odor will be gone after the first cycle.

Load is too hot

- Laundry items removed from the dryer before the end of the cycle.

Allow Cool Down cycle to finish before removing laundry from dryer. All cycles are cooled slowly to reduced wrinkling and make it easier to handle. Items removed before Cool Down may feel very warm.

- A high temperature cycle was used, or a separate temperature control was set on High.

Select a lower temperature and use an automatic drying cycle. These cycles sense the temperature or the moisture level in the load and shut off when the load reaches the selected dryness. This reduces overdrying.

WHIRLPOOL® LAUNDRY LIMITED WARRANTY

IF YOU NEED SERVICE:

1. Before contacting us to arrange service, please determine whether your product requires repair. Some questions can be addressed without service. Please take a few minutes to review the
2. All warranty service is provided exclusively by our authorized Whirlpool Service Providers.

In the U.S. and Canada, direct all requests for warranty service to:

Whirlpool Customer eXperience Center

In the U.S.A. call 1-800-253-1301. In Canada call 1-800-807-6777.

If outside the 50 United States and Canada, contact your authorized Whirlpool dealer to determine if another warranty applies.

ONE YEAR LIMITED WARRANTY

WHAT IS COVERED

For one year from the date of purchase, when this major appliance is installed, operated, and maintained according to instructions attached to or furnished with the product, Whirlpool Corporation or Whirlpool Canada LP (hereafter "Whirlpool") will pay for Factory

Specified Replacement Parts and repair labor to correct defects in materials or workmanship that existed when this major appliance was purchased, or at its sole discretion replace the product. In the event of product replacement, your appliance will be warranted by the remaining term of the original unit's warranty period.

YOUR SOLE AND EXCLUSIVE REMEDY UNDER THIS LIMITED WARRANTY SHALL BE PRODUCT REPAIR AS PROVIDED HEREIN. Service must be provided by a Whirlpool designated service company. This limited warranty is valid only in the United States or Canada and applies only when the major appliance is used in the country in which it was purchased. This limited warranty is effective from the date of original consumer purchase. Proof of original purchase date is required to obtain service under this limited warranty.

WHAT IS NOT COVERED

1. Commercial, non-residential, multiple-family use, or use inconsistent with published user, operator, or installation instructions.
2. In-home instruction on how to use your product.
3. Service to correct improper product maintenance or installation, installation not in accordance with electrical or plumbing codes, or correction of household electrical or plumbing (i.e. house wiring, fuses, or water inlet hoses).
4. Consumable parts (i.e. light bulbs, batteries, air or water filters, preservation solutions, etc.).
5. Defects or damage caused by the use of non-genuine Whirlpool parts or accessories.
6. Conversion of your product from natural gas or L.P. gas or reversal of appliance doors.
7. Damage from accident, misuse, abuse, fire, floods, acts of God, or use with products not approved by Whirlpool.
8. Repairs to parts or systems to correct product damage or defects caused by unauthorized service, alteration, or modification of the appliance.
9. Cosmetic damage including scratches, dents, chips, and other damage to appliance finishes unless such damage results from defects in materials and workmanship and is reported to Whirlpool within 30 days.

10. Discoloration, rust, or oxidation of surfaces resulting from caustic or corrosive environments, including but not limited to, high salt concentrations, high moisture or humidity, or exposure to chemicals.
11. Pick-up or delivery. This product is intended for in-home repair.
12. Travel or transportation expenses for service in remote locations where an authorized Whirlpool servicer is not available.
13. Removal or reinstallation of inaccessible appliances or built-in fixtures (i.e. trim, decorative panels, flooring, cabinetry, islands, countertops, drywall, etc.) that interfere with servicing, removal, or replacement of the product.
14. Service or parts for appliances with original model/serial numbers removed, altered, or not easily determined.

The cost of repair or replacement under these excluded circumstances shall be borne by the customer.

DISCLAIMER OF IMPLIED WARRANTIES

IMPLIED WARRANTIES, INCLUDING ANY IMPLIED WARRANTY OF MERCHANTABILITY OR IMPLIED WARRANTY OF FITNESS FOR A PARTICULAR PURPOSE, ARE LIMITED TO ONE YEAR OR THE SHORTEST PERIOD ALLOWED BY LAW. Some states and provinces do not allow limitations on the duration of implied warranties of merchantability or fitness, so this limitation may not apply to you. This warranty gives you specific legal rights, and you also may have other rights that vary from state to state or province to province.

DISCLAIMER OF REPRESENTATIONS OUTSIDE OF WARRANTY

Whirlpool makes no representations about the quality, durability, or need for service or repair of this major appliance other than the representations contained in this Warranty. If you want a longer or more comprehensive warranty than the limited warranty that comes with this major appliance, you should ask Whirlpool or your retailer about buying an extended warranty.

LIMITATION OF REMEDIES; EXCLUSION OF INCIDENTAL AND CONSEQUENTIAL DAMAGES

YOUR SOLE AND EXCLUSIVE REMEDY UNDER THIS LIMITED WARRANTY SHALL BE PRODUCT REPAIR AS PROVIDED HEREIN. WHIRLPOOL SHALL NOT BE LIABLE FOR INCIDENTAL OR CONSEQUENTIAL DAMAGES. Some states and provinces do not allow the exclusion or limitation of incidental or consequential damages, so these limitations and exclusions may not apply to you. This warranty gives you specific legal rights, and you also may have other rights that vary from state to state or province to province.

Warning

This content is compiled from multiple sources and is provided for reference purposes only. It may not be complete or fully applicable to all situations. If you are unable to resolve your issue, please contact the product manufacturer or an authorized service provider for official support.

Document generated by [ManualsFile](#)

