

IMPORTANT SAFETY INSTRUCTIONS

1. It is hazardous for anyone other than a competent person to carry out any service or repair operation that involves the removal of a cover which gives protection against exposure to electrical parts.
2. If the supply cord is damaged, it must be replaced by the manufacturer, its service agent or similarly qualified persons in order to avoid a hazard. Do not use with damaged cord or plug. Do not run the vacuum cleaner over any cables, or its own power cable. As this will result in damaging the cable.
3. This product is intended for household use only. Do not use outdoors.
4. This appliance can be used by children aged from 8 years and above and persons with reduced physical, sensory or mental capabilities or lack of experience and knowledge if they have been given supervision or instruction concerning use of the appliance in a safe way and understand the hazards involved. Children should not play with the appliance. Cleaning and user maintenance should not be made by children without supervision.
5. Do not direct at people, animals, electrical outlets, or equipment containing electrical components.
6. Do not use this appliance to pick up water or any other liquids, combustible substances or hot/burning objects.
7. Unplug from outlet when not in use, and before putting on and taking off parts, and before cleaning. Do not leave unattended whilst plugged in.
8. Do not use appliance if it has been dropped, damaged, left outdoors or dropped into water. Do not operate this appliance for anything other than its intended use.
9. Keep the appliance and adapter away from water; do not allow it to get wet.
10. If unit is wet, do not plug unit into wall socket or turn unit on. Do not immerse in water or other liquids for cleaning. Do not handle the appliance with wet hands.
11. Do not pull or carry by cord, use cord as a handle, close door on cord, pull cord around sharp corners or edges, or expose cord to heated surfaces.
12. The use of accessory attachments not recommended by the manufacturer may cause fire, electric shock or injury. Only use the accessories supplied by the manufacturer.
13. Only use the appliance when fully assembled.
14. Never place your fingers or other objects into any part of the appliance. Be aware that loose clothing or hair may become trapped in the cleaner if improperly used.

Caution:

- Exhaust air discharged from the sides of the appliance may extinguish a gas fire, pilot light, or disturb ashes in an open fire. Always avoid directing the appliance toward naked flames. Before use, ensure that all of the air vents are clear and there is no restriction of air flow.

OPERATION

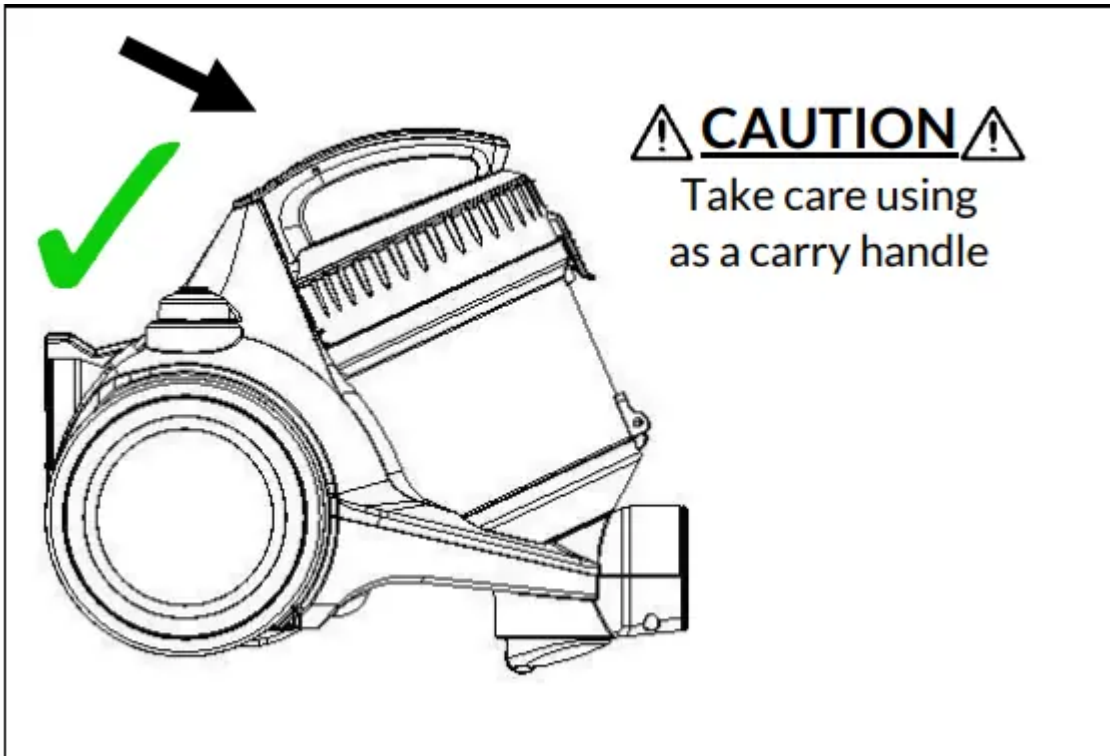

CARRYING THE APPLIANCE

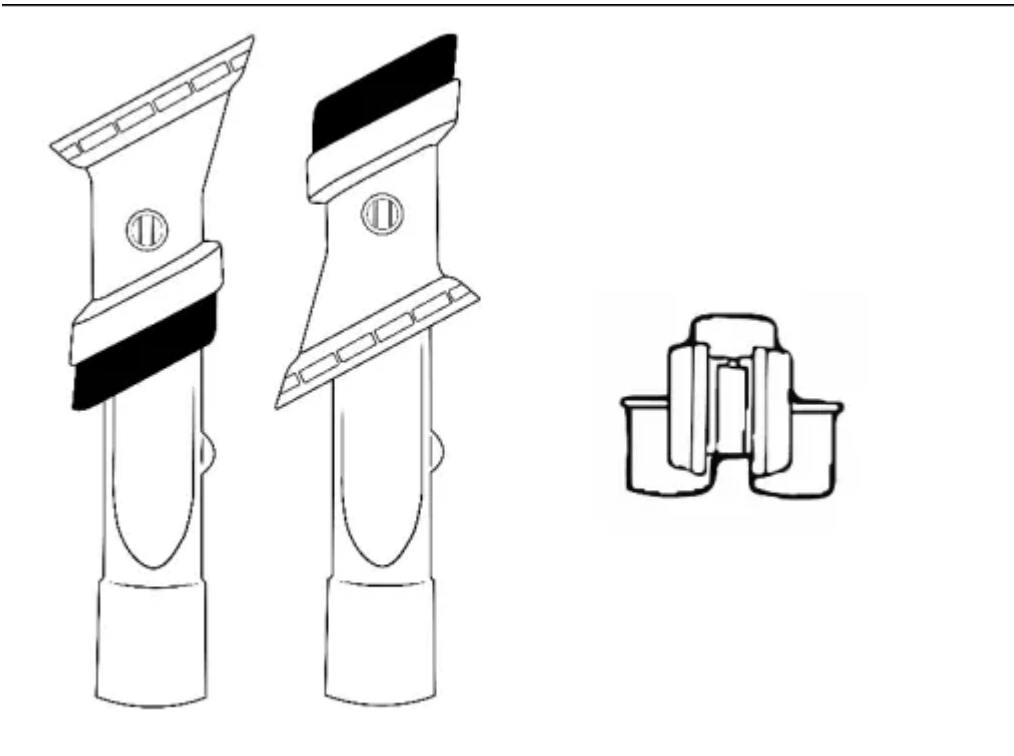

TOOL ATTACHMENTS

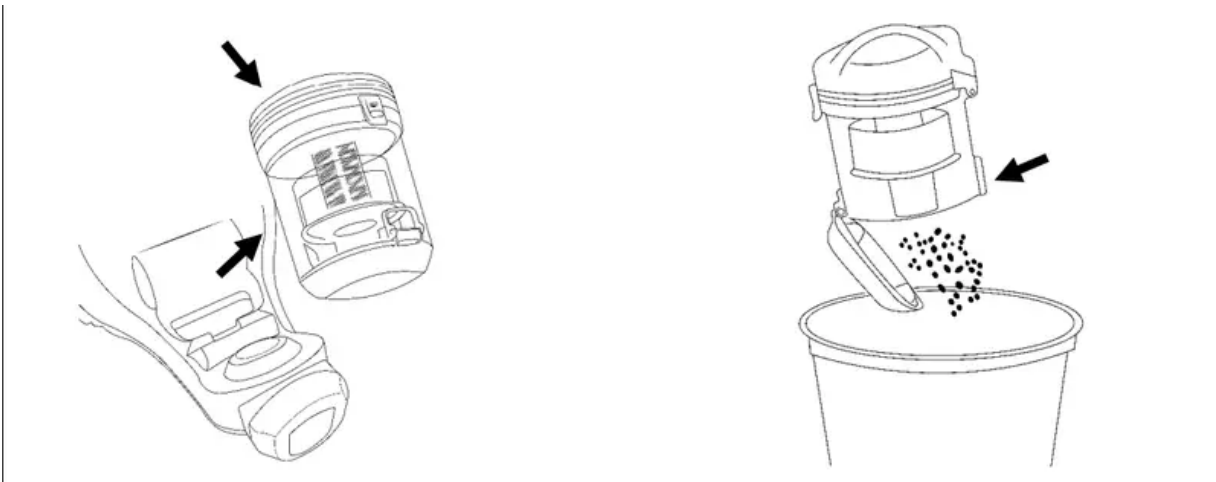

EMPTYING THE BIN

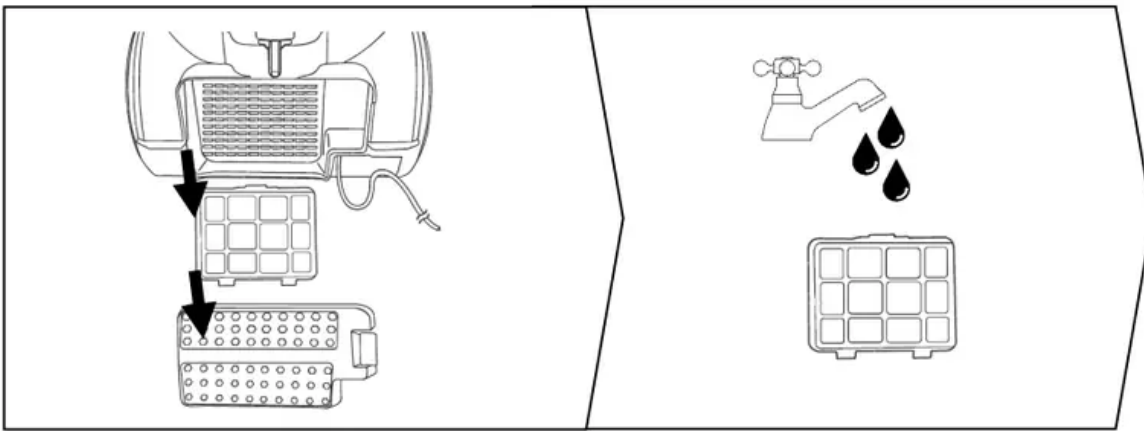
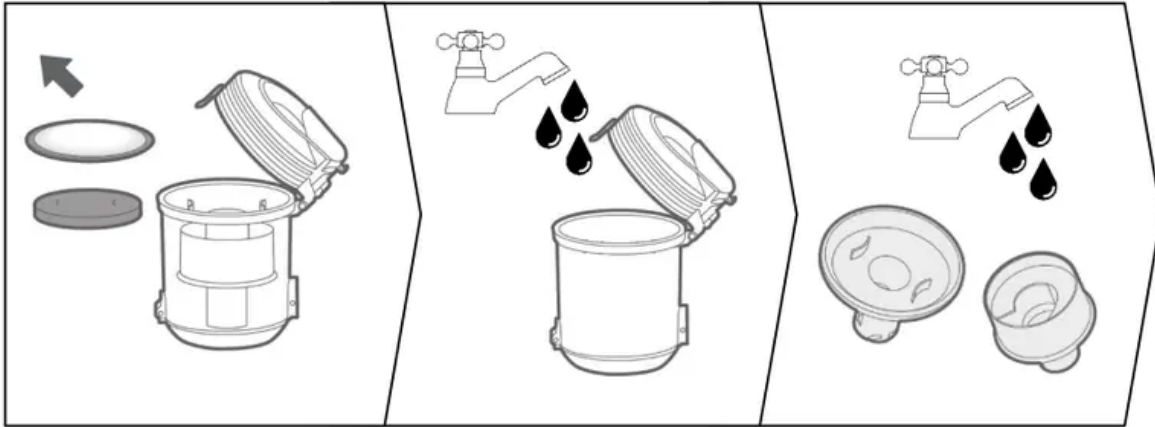

IMPORTANT! WASH THE FILTERS

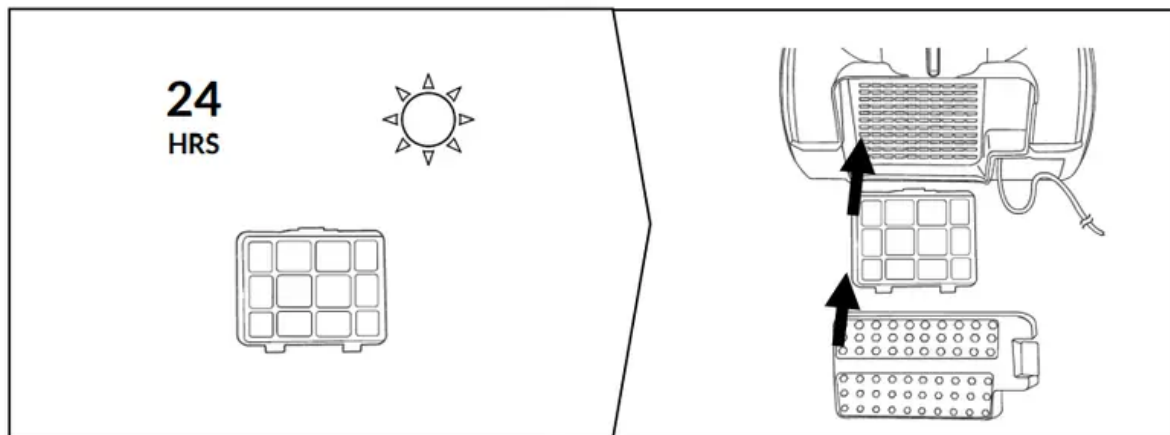
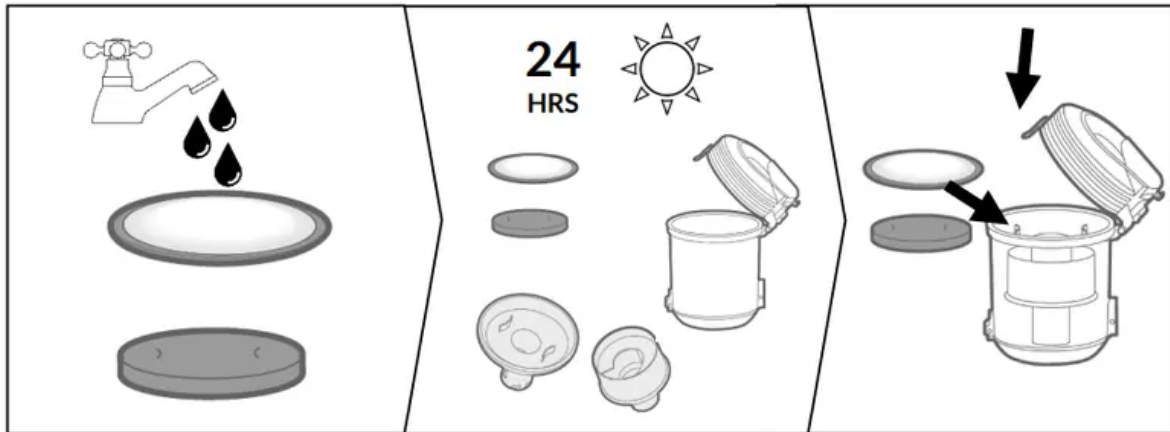

IMPORTANT! WASH THE FILTERS

[IMAGE]

PROBLEM SOLVING

The vacuum cleaner doesn't switch on

- Check the vacuum is plugged in
- Check the socket is switched on
- Check another appliance in the socket
- Check for any obvious signs of damage to cord or plug
- If recently used, allow to cool for 1 hour then try again

The suction is decreasing and dirt is not adequately being picked up

- Check if the dust canister is full; if so, empty it
- Clean the filters following the instructions in this manual
- Check there are no blockages in the hose, and clear any obstructions

Vacuum cleaner is over heating

1. Check the filters are clean
2. Dust is coming out of the vacuum
3. The dust canister has not been fitted correctly. Refit the canister following the instructions in this manual.

The air exhausted from the vacuum smells

- Clean the filters, hose, and dust container following the instructions in this manual

The vacuum cleaner has cut out

- Allow the vacuum to cool for 1 hour. Clean all filters and dust containers before trying to use again

Warning

This content is compiled from multiple sources and is provided for reference purposes only. It may not be complete or fully applicable to all situations. If you are unable to resolve your issue, please contact the product manufacturer or an authorized service provider for official support.