

# User Manual for Everlasting Comfort HUMIDIFIER

## Table of Contents

### COMPONENTS

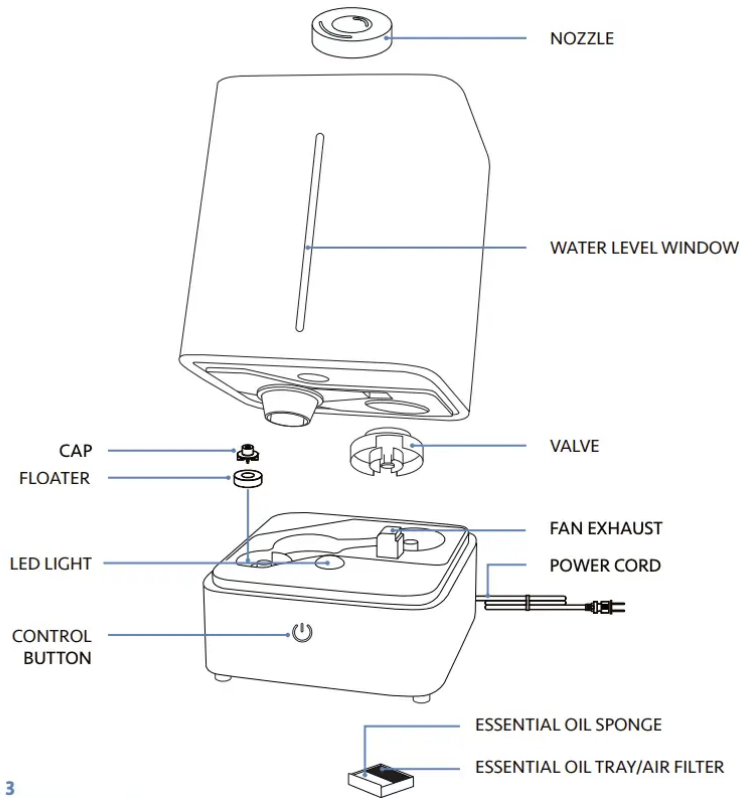

Fig. 3

### EXPLODED DIAGRAM

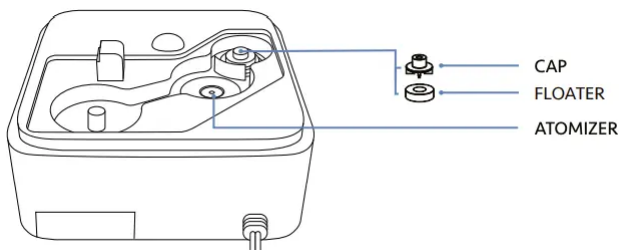

Fig. 4

### TOP VIEW OF BASE



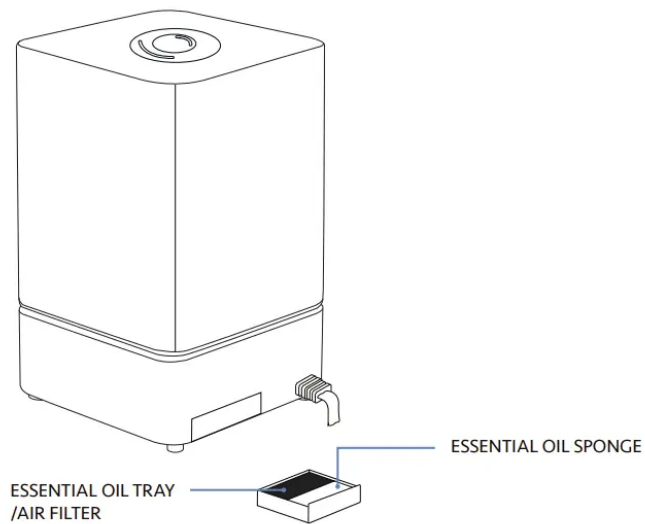

Fig. 5

## BACK VIEW

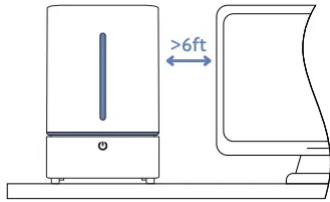

Fig. 6

## CONTROLS

## OPERATING ENVIRONMENT

1. This humidifier is intended for indoor use only.
2. Ideal operating environment: Temperature: 41-104°F, Humidity: <65% RH.
3. Place the unit on a firm, flat and dry surface.
4. Keep humidifier away from children and infants.
5. DO NOT use this appliance in any kind of inflammable environment.
6. Keep unit away from any heat source, i.e. heaters, furnaces, and avoid direct sunlight.
7. Keep the unit in normal room temperatures. Do not operate the unit in freezing temperatures.
8. Direct nozzle to spray mist away from furniture and electric appliances, as they may become damp or be left with a white powder-like residue.
9. Please follow the recommendations in the illustrations on the next page to properly operate your humidifier in your home.



1. Place the unit 6ft away from TVs, audio equipment, and any other electronic appliances.

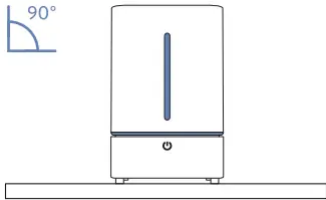

2. Place the unit on a firm, steady, flat and dry surface. Avoid any inclination.

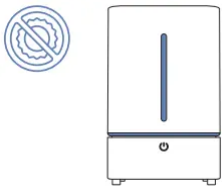

3. Place the unit away from any heat sources, such as furnaces and avoid direct sunlight.

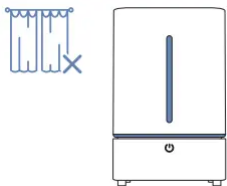

4. Do not place the unit near curtains.

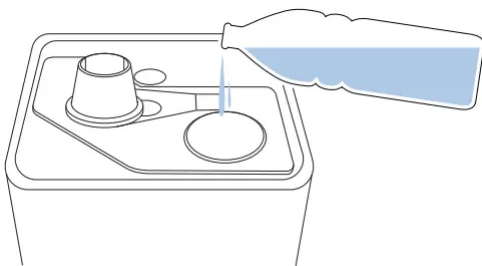

5. **IMPORTANT:** Using tap water with a high mineral content aka "hard water" with any humidifier can cause a fine white dust to be emitted. To avoid this, use distilled or demineralized water.

## OPERATION



1 Set the unit to the OFF position by pushing the control button until the indicator light goes off.

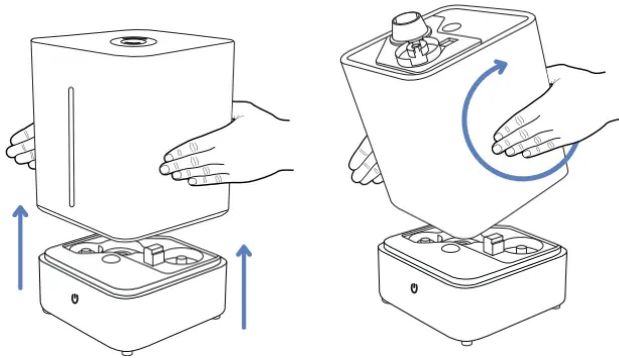

2 With both hands, lift the water tank off the base and flip it over to avoid water from dripping from the bottom of the tank. If the mist nozzle is removed or falls off, make sure to reattach it to the water tank prior to use.

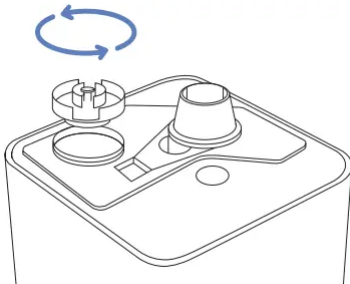

3 Twist open the valve.

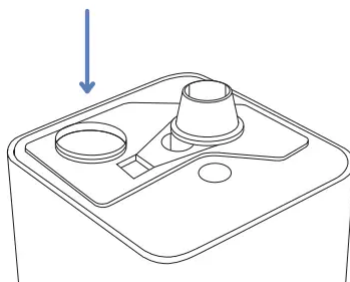

4 Fill with water. DO NOT add any other substance other than tap or filtered water.

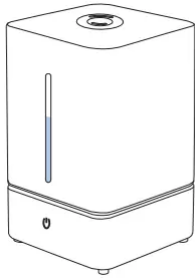

5 Reattach the valve to the water tank and reposition the water tank onto the base with the water level window on the front side of the water tank. **NOTE:** Allow about 10 seconds for the water to flow from the water tank into the base before you turn the unit on.

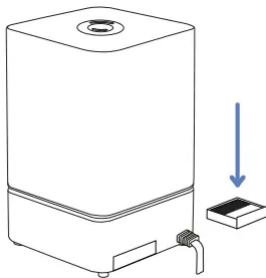

6 OPTIONAL: Add essential oil to the white sponge in the essential oil tray located on the backside of the base

7 A. Press the control button to set your desired mist output level. Refer to the illustration below.

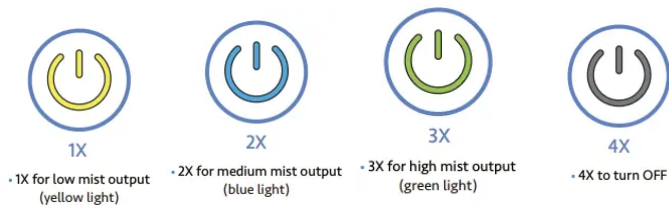

B. NIGHT LIGHT OPERATION: Press and hold the control button at any time for three seconds to turn on or turn off the LED night light located inside the water tank. The water level window on the front side of the unit and underneath the water tank should light up blue.

C. The unit features an “Auto Shut Off” safety feature. When the unit is low on water, it will cut off the atomizer to stop the mist and the indicator light will turn red. To refill the water tank, turn the unit OFF and repeat steps 1-6.



D. **IMPORTANT TIP:** DO NOT leave the humidifier plugged in for prolonged periods (i.e. several days or more) without use. This causes premature failure of the circuitry. When the humidifier is not in use, press the control button until the light goes off, then UNPLUG it.

8 If storing the humidifier, make sure to drain out all of the water from the unit and dry thoroughly

## TROUBLESHOOTING

**IMPORTANT TIP:** DO NOT leave the humidifier plugged in for prolonged periods (i.e. several days or more) without use. This causes premature failure of the circuitry. When the humidifier is not in use, press the control button until the light goes off, then UNPLUG it.

PROBLEM	PRIMARY CAUSE	SOLUTION
Indicator light not illuminated with no mist.	Power supply is not properly plugged into a wall socket. Power switch is not turned on.	Plug the power supply cord into a wall socket. Press the control button to power on.
Indicator light is red with no mist.	<p><b>A.</b> There is no water in the tank.</p> <p><b>B.</b> Atomizer is dirty or floater is missing or stuck to the bottom.</p> <p><b>C.</b> Unit was turned on too quickly when tank was attached to the base.</p> <p><b>D.</b> Unit reset needed.</p> <p><b>E.</b> Too much moisture/humidity in circuit board.</p>	<p><b>A.</b> Add water to tank.</p> <p><b>B.</b> Clean base, atomizer, and floater according to section 6 Maintenance. Check to make sure floater is not stuck to the bottom. With the unit UNPLUGGED, add enough water directly to the base and make sure the floater floats.</p> <p><b>C.</b> Press the control button to the OFF position and wait 10 seconds before turning back on.</p> <p><b>D.</b> Press control button to OFF position. Unplug the unit from the wall and wait 2 mins. Plug the unit back into the wall, fill the water tank with water, and press the control button to the ON position.</p> <p><b>E.</b> Unplug unit from the wall. Empty base of all water, dry with a towel, turn upside down, remove essential oil tray and let dry for 24 hours.</p>
Indicator light is working (yellow, blue, or green lights) with little or no mist.	Atomizer is dirty.	Clean the base and atomizer according to section 6 Maintenance.
Mist has a bad odor.	The water, tank, or base is not clean.	Clean base and atomizer according to section 6 Maintenance.
Humidifier is emitting a white dust/residue.	Use of tap water with a high mineral content, aka "hard water."	Clean tank and base and use only demineralized or distilled water.

## MAINTENANCE

**IMPORTANT TIP:** DO NOT leave the humidifier plugged in for prolonged periods (i.e. several days or more) without use. This causes premature failure of the circuitry. When the humidifier is not in use, press the control button until the light goes off, then UNPLUG it.

**WARNING:** Before performing any type of maintenance and cleaning, be sure to unplug the unit from its power source.

### CLEAN THE WATER TANK (ONCE EVERY 2-3 WEEKS)

Turn unit OFF and unplug from the wall socket.

**WARNING:** Use both hands to lift entire base and tilt to one side to pour water out as shown in (Fig. 7). Use mild dish soap and water to clean the base and clean away any residue near the floater and the atomizer with a brush or cotton swab as shown in (Fig. 7). Only pour water into the base using a cup, never directly from a faucet. Never place the base under running water as this could cause water flow to reach the motor located at the bottom of the base.

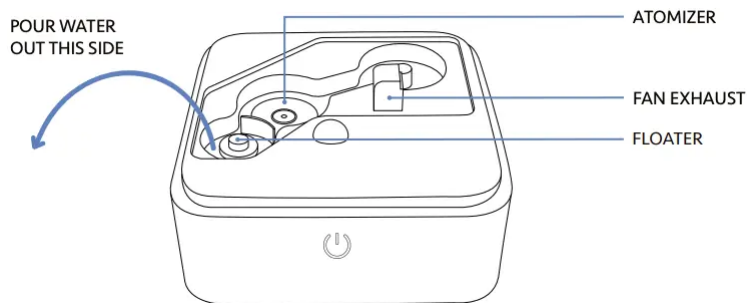

**Fig. 7**

### TOP VIEW OF BASE

**EXTERNAL CLEANING OF HUMIDIFIER** Rinse soft cloth in warm water below 104°F, add a small amount of mild dish soap to soft cloth, and wipe off any surface stains.

#### **Warning**

This content is compiled from multiple sources and is provided for reference purposes only. It may not be complete or fully applicable to all situations. If you are unable to resolve your issue, please contact the product manufacturer or an authorized service provider for official support.