

# Use & Care Manual for Frigidaire FEC300WH00

## Table of Contents

- Register Your Product Online
- Safety Information & Warnings
- Parts List
- Operating Instructions
- Control Panel
- Use Of Remote Control
- Cleaning And Maintenance
- Limited Manufacturer's Warranty

## OPERATING INSTRUCTIONS

Instructions for adding water to the water tank.

### NOTE

- Please clear any remaining water collected at the bottom of the water tank when the machine is not in use.
- When adding water to the tank or cleaning it, the power plug should be removed from the outlet.
- Before you turn on the fan, make sure the pump module is fixed into place.
- There are two ways to add water to the water tank:
  1. Add water directly into the water tank. Make sure that the water pump is properly placed inside.
  2. Add water to the small chamber located above the cooling pad. The water will filter down into the water tank.

### Instructions for cleaning the water tank once disassembled.

1. The water tank buckle should be unlocked to the horizontal state.
2. Pumped out any remaining water until the tank is empty. Proceed by pulling out the water tank from the fan.
3. Separate the water tank from the pump module (including water tube) by turning the knob 90 degrees counterclockwise.
4. Clean the water tank and replace the water tank to its location at the bottom of the fan.
5. Once the water tank is returned to its location, the water pump module should be reattached, and then the water tank buckle should be relocked.

## USE OF ICE CRYSTAL BOX

## NOTE

- 1. The ice crystal box can be repeatedly frozen and recycled; It also not have to be used if you are satisfied with the fan temperature.
- 2. The ice crystal box cover must not be opened to prevent damage.
- 3. The ice crystal box material is environmentally friendly, nontoxic and harmless; it can be safely placed in the refrigerator for freezing.
- 4. The frozen ice crystal box should be placed in the water tank during use, and after the humidification is turned on, the air outlet temperature will be lowered.
- 5. The ice crystal box can be replaced by ice, which also has a cooling effect.
- 6. When adding water, the water level of the water tank should not exceed the "MAX" (maximum) indicating scale. If the water level is lower than the "MIN" (minimum) indicating scale, please add water.

1. Pull out the water tank from the bottom of the fan to check the water level.

2. Remove the ice crystal box from the package and put it in the refrigerator for 3 hours or more. Place the frozen ice crystal box in the water tank and add water. Do not exceeding the "MAX" indicating scale.

## USE OF REMOTE CONTROL

1. The remote controller can be used normally within the scope of 15 feet and 30 degrees of the deviation angle in front of the product.

2. The battery contains many heavy metals, acid-base and other materials, making it threat to human health if consumed or in contact with skin; Old batteries and battery waste should be disposed of safely.

Use manganese or alkaline batteries of type "AAA".DO not use rechargeable batteries.

## CLEANING AND MAINTENANCE

1. Be sure to unplug the fan from the electrical supply source before cleaning.

2. Plastic parts should be cleaned with mild soap and a damp cloth or sponge. Make sure any remaining soap residue is washed away with clean water before plastic parts are replaced back into the fan.

3. Make sure the plastic parts are completely dry and no water enters the internal structure of the fan.

## CONTROL PANEL

### *Function description*

- On and Off button.
- Touch the oscillation key to start or stop air rotation.

- Press the humidification button once the fan is on. In the dry or hot weather, start the humidification function to have a better cooling experience.
- There are two fan speeds: Normal (level 3, normal indicator light is lit up), natural (level 2, natural indicator light is lit up).
- When adjusting the fan speed, press the minus or plus buttons to either decrease or increase the fan speed. Use these buttons to also adjust the fan timer. Increase or decrease the timer by .5-hour increments when you set the fan to run between 0-3 hours. If you set the fan to run longer, between 4-10 hours, then you will only be able to increase or decrease the timer by 1-hour increments.
- To set the timer, press the timer button once the device has been turned on. Once the timer icon begins to flash on the display you can use the increase and decrease buttons to set the length of the timer. The icon will flash a total of 6 times to indicate the timer has been set. To cancel timer mode: 11 Press the timer button (the icon will start to flash). Press the button one more time to cancel the time

### **RULES FOR SAFE OPERATION**

- 1. Never insert fingers, pencils, or any other object through the grille when fan is running.
- 2. Disconnect the fan from the power outlet when moving from it one location to another.
- 3. Be sure the fan is on a stable surface when operating to avoid overturning.
- 4. DO NOT use fan near a window, rain may create electrical hazard.
- 5. Do not use the fan outdoors. Household use only.

## OPERATING INTRUCTIONS

Instructions for adding water to the water tank.

### NOTE

- Please clear any remaining water collected at the bottom of the water tank when the machine is not in use.
- When adding water to the tank or cleaning it, the power plug should be removed from the outlet.
- Before you turn on the fan, make sure the pump module is fixed into place.
- There are two ways to add water to the water tank:
  1. Add water directly into the water tank. Make sure that the water pump is properly placed inside.
  2. Add water to the small chamber located above the cooling pad. The water will filter down into the water tank.

Instructions for cleaning the water tank once disassembled.

1. The water tank buckle should be unlocked to the horizontal state.
2. Pumped out any remaining water until the tank is empty. Proceed by pulling out the water tank from the fan.

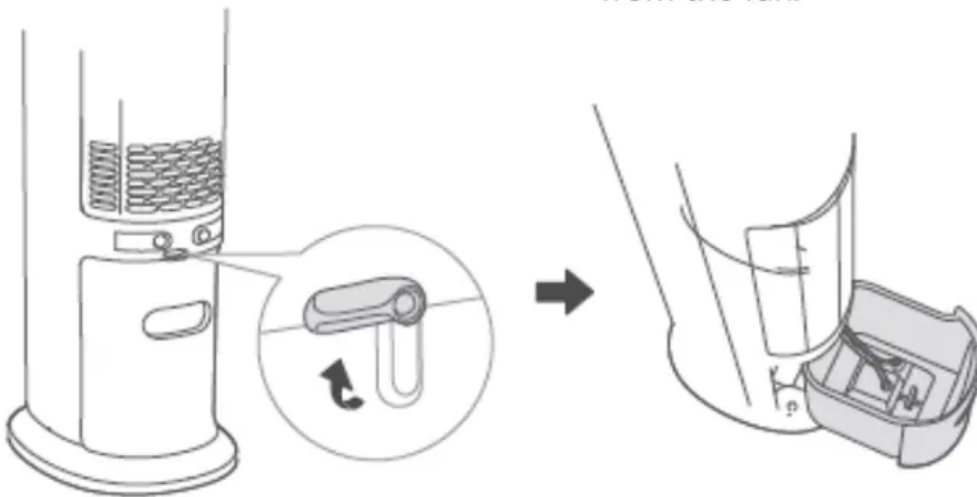

3. Separate the water tank from the pump module (including water tube) by turning the knob 90 degrees counterclockwise.
4. Clean the water tank and replace the water tank to its location at the bottom of the fan.

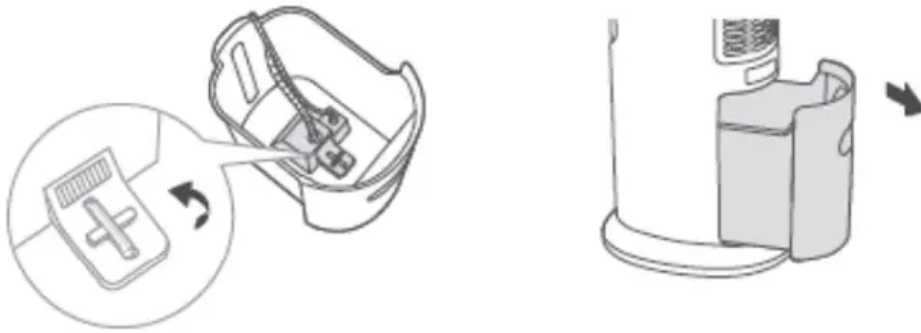

5. Once the water tank is returned to its location, the water pump module should be reattached, and then the water tank buckle should be relocked.

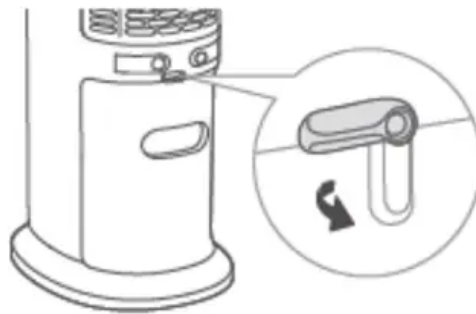

## USE OF ICE CRYSTAL BOX

### NOTE

1. The ice crystal box can be repeatedly frozen and recycled; It also not have to be used if you are satisfied with the fan temperature.
2. The ice crystal box cover must not be opened to prevent damage.
3. The ice crystal box material is environmentally friendly, non-toxic and harmless; it can be safely placed in the refrigerator for freezing.
4. The frozen ice crystal box should be placed in the water tank during use, and after the humidification is turned on, the air outlet temperature will be lowered.
5. The ice crystal box can be replaced by ice, which also has a cooling effect.
6. When adding water, the water level of the water tank should not exceed the "MAX" (maximum) indicating scale. If the water level is lower than the "MIN" (minimum) indicating scale, please add water.

1. Pull out the water tank from the bottom of the fan to check the water level.
2. Remove the ice crystal box from the package and put it in the refrigerator for 3 hours or more. Place the frozen ice crystal box in the water tank and add water. Do not exceeding the "MAX" indicating scale.

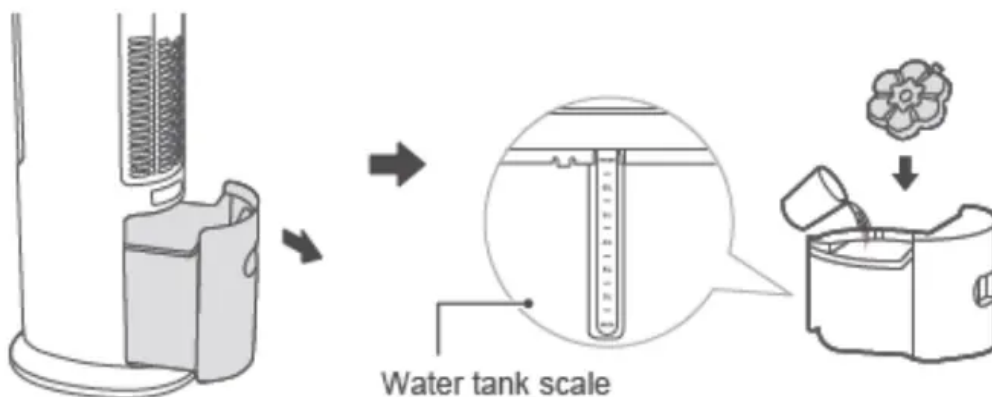

**Warning**

This content is compiled from multiple sources and is provided for reference purposes only. It may not be complete or fully applicable to all situations. If you are unable to resolve your issue, please contact the product manufacturer or an authorized service provider for official support.

---

Document generated by [ManualsFile](#)

