

Description of Appliance

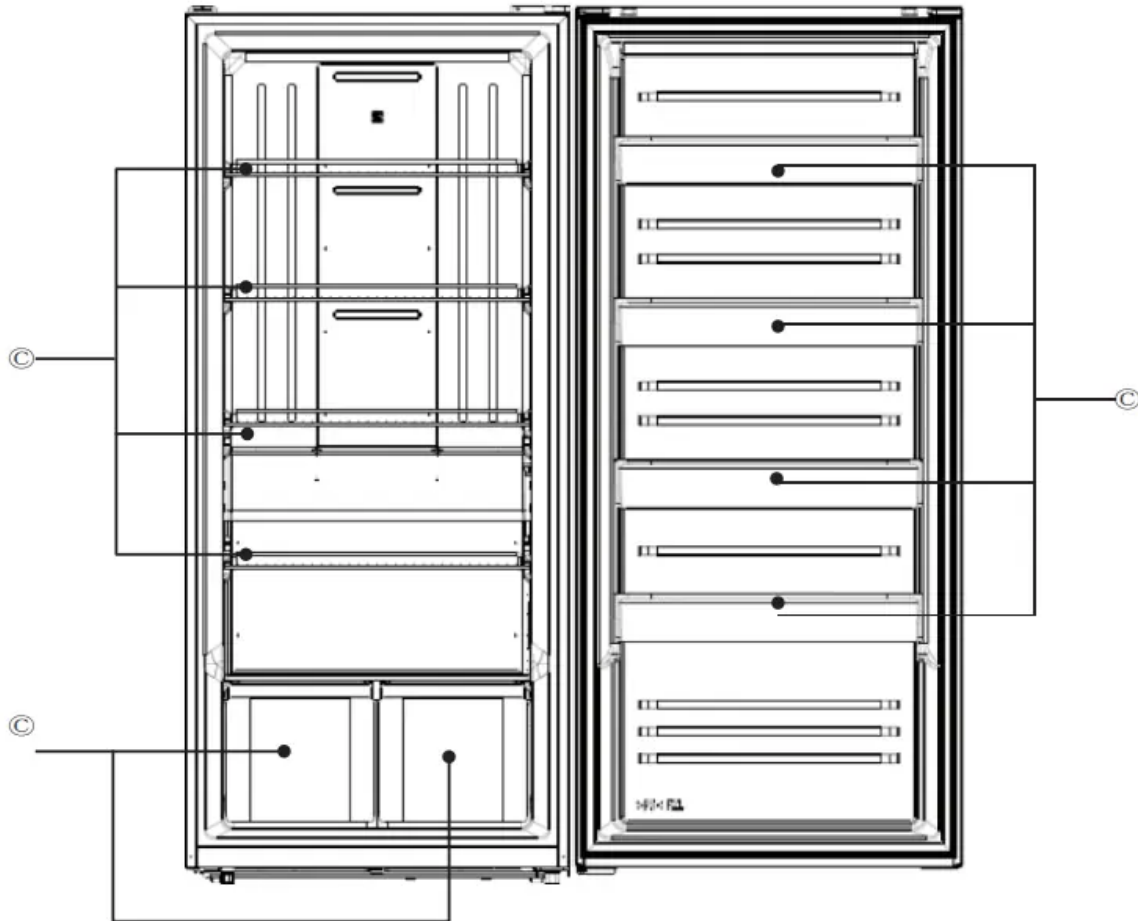

© Freezer Compartment Shelves

- For storage of frozen food, meat, fish, ice cream

© Freezer Compartment Pockets

- For storage of frozen food.

© Freezer Compartment Cases

- For storage of frozen food.

Control Panel

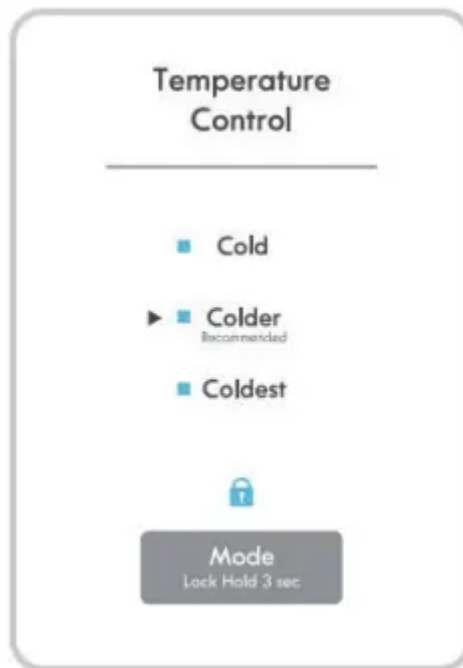

© Freezer Temperature

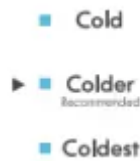

Press the "Mode" button and the temperature setting changes in the sequence as shown below:
Colder → Coldest → Cold

Setting	Cold	Colder	Coldest
Temperature (°C)	-15	-18	-21
Temperature (°F)	6	0	-6

© Lock Function

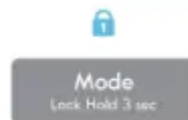

1) Lock function: When "Lock" button is pressed for 3 seconds, the "Lock" button will blink 3 times and activate the lock function Or it locks itself after 20 seconds without pressing any button.

2) Unlock function: When it is locked, press "Lock" button for 3 seconds. "Lock "LED light will blink 3 times and it will be unlocked

Temperature Control

Note: After making an adjustment, allow at least 24 hours for the internal temperature to stabilize at the new setting. The controls are set correctly when food is as cold as you would like and when ice cream is firm. If the temperature in either compartment is too cold or too warm, change the setting one increment at a time.

- The freezer control is preset to 0 deg F (-18 deg C).
- Freezer

Under unlock state, Press the "Mode" button and the temperature setting changes in the sequence as shown below: Colder → Coldest → Cold

>>> Sequential Temperature Change <<<

Setting	Cold	Colder	Coldest
Temperature (°C)	-15	-18	-21
Temperature (°F)	6	0	-6

Note The interior temperature can depend on number of door opening, room temperature, and other user conditions

Handle Installation(Optional)

Included Parts :

Two Standoff Screws(A) , Hex Wrench(B),

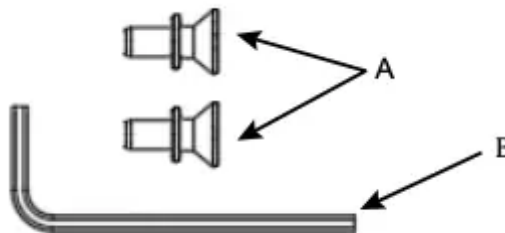

1. Install the standoff screw(B)

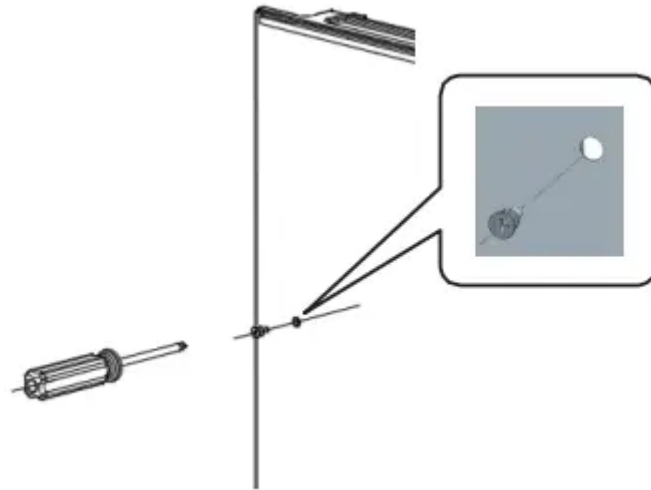

2. Put the Fig1 side up and assemble in the order indicated by the arrow

3. Tighten with a wrench

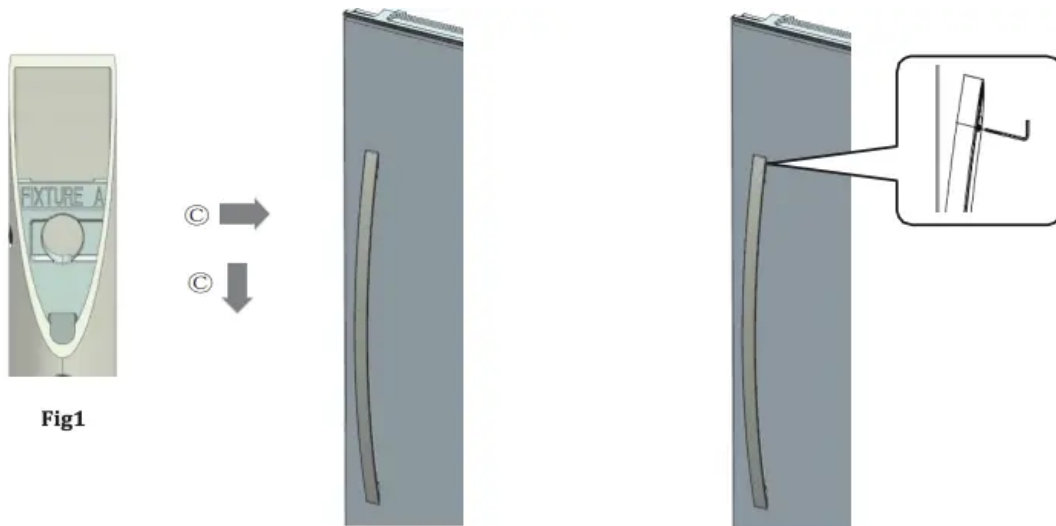

Reversing Door (Option)

Tools Required :

- 5/16"end wrench, Screwdriver

Note

- Before reverse door, do not forget to unplug the freezer

1. Disassemble using a wrench and screwdriver.

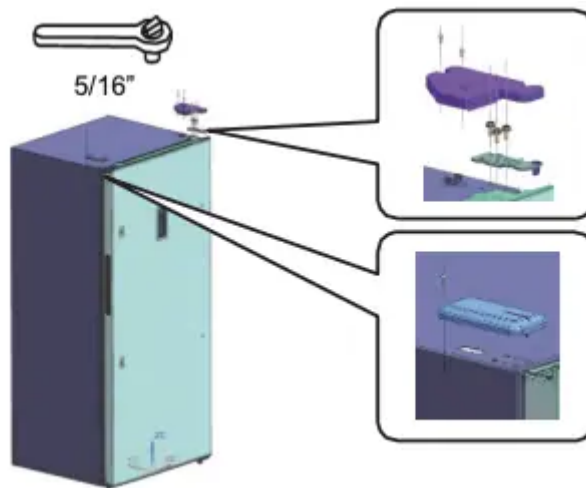

2. Open door and lift. Place door on a non-scratching surface.

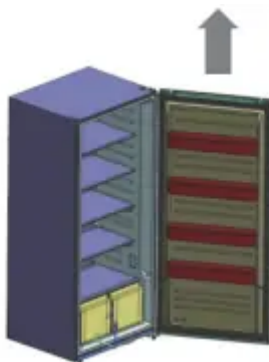

3. Remove the bottom hinge plate and assemble it on the opposite side. Note the location of washer

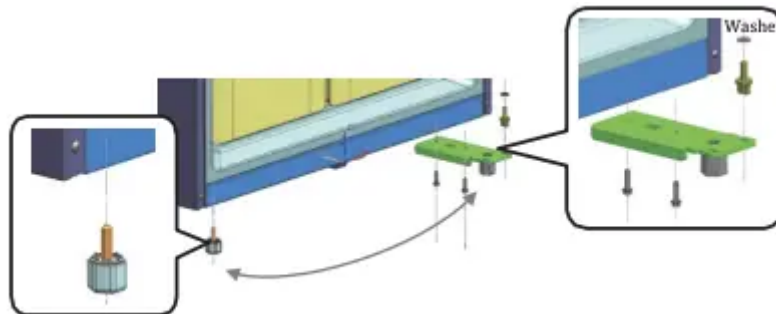

4. Remove the door switch and assemble it to the enclosed COVER HINGE L.

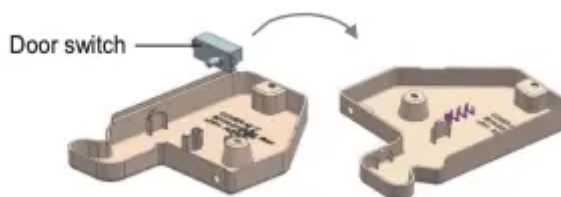

5. Separate the bushing and door stopper and assemble on the opposite side.

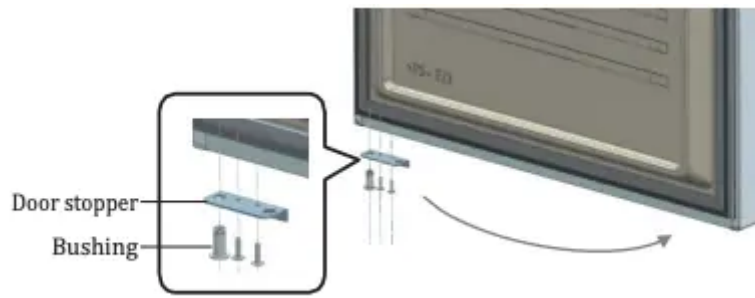

6. Remove the sealing gasket from freezer door, noting orientation during removal. Rotate 180 degrees and reinstall by aligning to groove and firmly pressing around the perimeter, from bottom to top. Make sure gasket is fully seated into door groove.



7. Assemble using a wrench and screwdriver

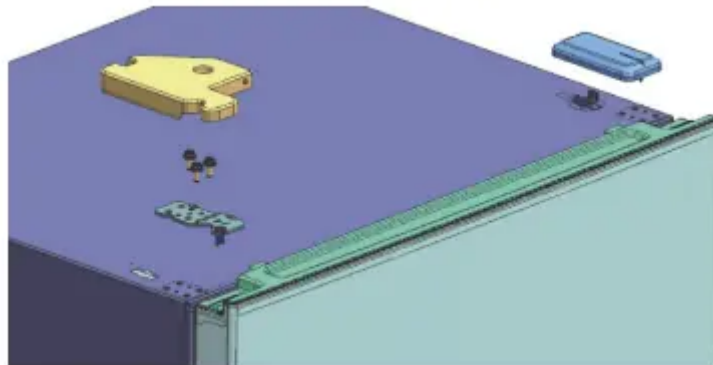

Reversing Handle (Option)

1. Loosen it with a wrench.

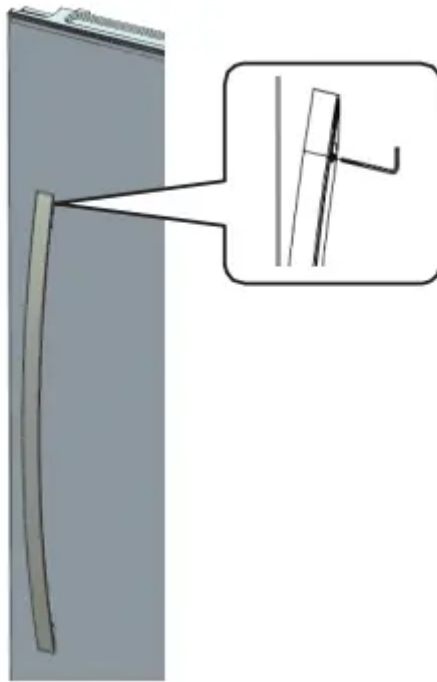

2. Remove by lifting the handle in the direction of the arrow

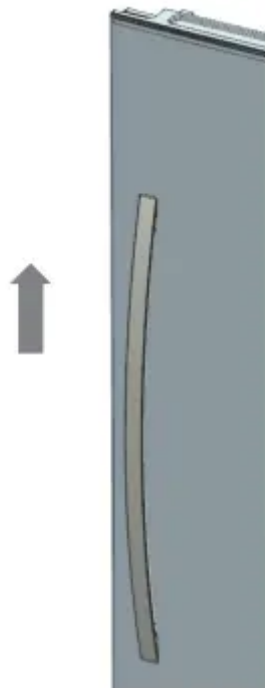

3. Assembling removed handle on the opposite side is same as the handle installation above.

Automatic Defrost

The appliance is equipped with automatic defrost capability so that you do not have to manually defrost. The cooling element of the unit is regularly heated to melt the frost that forms on it. The resulting water drains through a duct at the back of the unit and into a concealed pan at the base of the unit where it evaporates. Should any frost form on the unit interior walls, remove food and

store it elsewhere. Then unplug the unit, wait long enough for the frost to melt, and wipe up the moisture with a dry towel.

Rear Wheels

The appliance is equipped with rear wheels to help you roll it into or out of a location.

CAUTION: Obtain the aid of an assistant if the appliance feels too heavy for you to safely move it.

Interior LED Lighting

The appliance features interior LED lighting, which is more effective and longer lasting than incandescent bulbs. However, in the unlikely event that the LED fails to light, call 1-844-553-6667 to schedule repair service to replace it.

Care & Cleaning

CAUTION Damp objects stick to cold metal surfaces. Do not touch interior metal surfaces with wet or damp hands.

Cleaning the Inside

Wash inside surfaces of the appliance with a solution of two tablespoons of baking soda in one quart (1.1 liters) warm water. Rinse and dry. Wring excess water out of the sponge or cloth when cleaning in the area of the controls, or any electrical parts.

Wash the removable parts and baskets with the baking soda solution mentioned above, or mild detergent and warm water.

Never use metallic scouring pads, brushes, abrasive cleaners, or alkaline solutions on any interior surface. Do not wash removable parts in a dishwasher.

Cleaning Door Bins

To remove the door bins for cleaning, use both hands to squeeze the tray in from both ends and push upward.

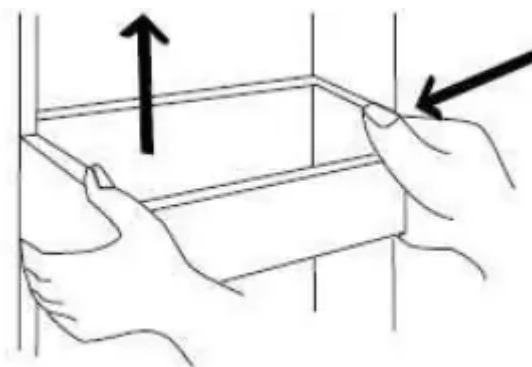

Cleaning the Outside

Wash the cabinet with warm water and mild liquid detergent. Rinse well and wipe dry with a clean soft cloth. Never use metallic scouring pads, brushes, abrasive cleaners, or alkaline solutions on any exterior surface.

Vacation and Moving Tips

WARNING If leaving the appliance door open while on vacation, make certain that children cannot get into the appliance and become entrapped.

Short Vacations: Leave the appliance operating during vacations of less than three weeks.

Long Vacations: If the appliance will not be used for several months:

- Remove all food and unplug the power cord.
- Clean and dry the interior thoroughly.
- Leave the appliance door open slightly, blocking it open if necessary, to prevent odor and mold growth.

Moving: When moving the appliance, follow these guidelines to prevent damage:

- Disconnect the power cord plug from the wall outlet.
- Remove foods and clean the appliance interior.
- Secure all loose items such as bins and shelves by taping them securely in place to prevent damage.
- In a moving vehicle, secure appliance in an upright position to prevent movement. Also protect outside of appliance with a blanket, or similar item.

NOTE If unit is turned off or unplugged for several hours, do not open appliance door unnecessarily. This will maintain the coldest temperature inside and reduce the recovery time to desired temperature once the unit is turned back on.

Power or Appliance Failure

If a power failure occurs, frozen foods will stay frozen for at least 24 hours if the appliance door is kept closed. If the power failure continues, pack seven or eight pounds of dry ice into the appliance every hours. Look in the Yellow Pages under Dry Ice, Dairies, or Ice Cream manufacturers for local dry ice suppliers. Always wear gloves and use caution when handling dry ice.

If the appliance has stopped operating, see Appliance does not run in the Troubleshooting Guide. If you cannot solve the problem, call an authorized servicer immediately. If the appliance remains off for several hours, follow the directions above for the use of dry ice during a power failure. If necessary, take the food to a local locker plant until the appliance is ready to operate. Look in the Yellow Pages under Frozen Food Locker Plants.

Before You Call

TROUBLESHOOTING GUIDE	Before calling for service, review this list. It may save you time and expense. This list includes common occurrences that are not the result of defective workmanship or materials in this appliance.	
CONCERN	POTENTIAL CAUSE	COMMON SOLUTION
Appliance does not run.	<ol style="list-style-type: none"> 1. Unit is plugged into a circuit that has a ground fault interrupt. 2. Temperature control is in the OFF position. 3. Unit may not be plugged in or plug may be loose. 4. House fuse blown or tripped circuit breaker. 5. Power outage 	<ol style="list-style-type: none"> 1. Use another circuit. If you are unsure about the outlet, have it checked by a certified electrician. 2. See Temperature Control Section. 3. Ensure plug is tightly pushed into outlet. 4. Check house fuse or circuit breaker. 5. Check house lights. Call local Electric Company



<p>Appliance runs too much or too long.</p>	<ol style="list-style-type: none"> 1. Room or outside weather is hot. 2. Unit has recently been disconnected for a period of time. 3. Large amounts of warm or hot food have been stored recently. 4. Door is opened too frequently or long. 5. Door may be slightly open. 6. Temperature Control is set too low. 7. Door gasket is dirty, worn, cracked, or poorly fitted. 	<ol style="list-style-type: none"> 1. It is normal for the appliance to work harder under these conditions. 2. It takes 4 hours for the unit interior to cool down completely. 3. Warm food will cause unit to run more until the desired temperature is reached. 4. Warm air entering the interior causes it to run more. Open door less often. 5. See Door Will Not Close in this Before You Call Section. 6. Set control to a warmer setting. Allow several hours for the temperature to stabilize. 7. Clean or change gasket. Leaks in the lid seal will cause unit to run longer in order to maintain desired temperature.
<p>Interior temperature is too cold.</p>	<p>Temperature Control is set too cold.</p>	<p>Adjust the control to a warmer setting. Allow several hours for the temperature to stabilize.</p>
<p>Interior temperature is too warm.</p>	<ol style="list-style-type: none"> 1. Temperature Control is set too warm. 2. Door is kept open too long or is opened too frequently. 3. Door may not be seating properly. 4. Large amounts of warm or hot food may have been stored recently. 5. Appliance has recently been disconnected for a period of time. 	<ol style="list-style-type: none"> 1. Adjust control to a colder setting. Allow several hours for the temperature to stabilize. 2. Warm air enters the appliance every time the door is opened. Open the lid less often. 3. See Door Will Not Close in this Before You Call section. 4. Wait until the appliance has had a chance to reach its selected temperature.



		5. Freezer mode requires 4 hours to cool down completely after appliance is first plugged in.
Appliance exterior surface temperature is warm.	<p>1. Appliance exterior walls can be as much as 30°F warmer than room temperature.</p> <p>2. Appliance too close to adjacent surfaces.</p>	<p>1. This is normal while compressor works to transfer heat from inside appliance cabinet.</p> <p>2. See clearance requirements in the Installation section of this Use & Care Guide.</p>
Louder sound levels whenever appliance is on.	Modern cooling appliances have increased storage capacity and more stable temperatures. They require a high efficiency compressor.	This is normal. When the surrounding noise level is low, you might hear the compressor running while it cools the interior.
Longer sound periods when compressor comes on.	Appliance operates at higher pressures during the start of the ON cycle.	This is normal. Sound will level off or disappear as appliance continues to run.
Popping or cracking sound when compressor comes on.	Metal parts undergo expansion and contraction, as in hot water pipes.	This is normal. Sound will level off or disappear as appliance continues to run.
Bubbling or gurgling sound, like water boiling.	Refrigerant (used for cooling) is circulating throughout the system.	This is normal.
Vibrating or rattling noise.	<p>1. Appliance is not level. It rocks on the floor when it is moved slightly.</p> <p>2. Floor is uneven or weak. Appliance rocks on floor when it is moved slightly. 3. Appliance is touching the wall.</p>	<p>1. Level the unit. Refer to Leveling in Appliance Setup section of this Use & Care Guide.</p> <p>2. Ensure floor can adequately support appliance.</p> <p>3. Move appliance slightly. Refer to Leveling in the Appliance Setup section after moving if necessary.</p>
Moisture forms on inside appliance walls.	1. Weather is hot and humid.	1. This is normal.

	<p>2. Door may not be seating properly.</p> <p>3. Door is kept open too long, or is opened too frequently</p>	<p>2. See Door Will Not Close in this Before You Call section.</p> <p>3. Open the door less often.</p>
Moisture forms on outside of appliance.	<p>Door may not be seat- ing properly, causing the cold air from inside the appliance to meet warm moist air from outside.</p>	<p>See Door Will Not Close in this Before You Call section.</p>
Odors in appliance.	<p>1. Interior needs to be cleaned.</p> <p>2. Foods with strong odors are in the appliance.</p>	<p>1. Clean interior with sponge, warm water, and baking soda.</p> <p>2. Cover the food tightly</p>
Door will not close.	<p>1. Unit is not level or floor is uneven or weak. Unit rocks on the floor when it is moved slightly.</p> <p>2. Food package is pressing against inner door panel</p>	<p>1. Unlevel unit can misalign door and door seal. Floor must be solid and strong enough to support a fully loaded appliance. Refer to Leveling in Appliance Setup section of this Use & Care Guide.</p> <p>2. Reposition or remove excess package.</p>

Warning

This content is compiled from multiple sources and is provided for reference purposes only. It may not be complete or fully applicable to all situations. If you are unable to resolve your issue, please contact the product manufacturer or an authorized service provider for official support.