

User Manual

Features

- Enjoy small, chewable ice pellets like those served in restaurants
- Produces up to 44 lbs. (19.9 kg) of ice per day, letting you stock up for your next get-together
- Fast-working system produces your first ice in about 12 minutes
- 3.3 lb. (1.5 kg) storage capacity gives you plenty of ice for any occasion
- Stainless steel body is easy to keep clean and looks great in any kitchen
- Digital touch controls make using this ice maker simple and easy
- Included ice scoop makes it easy to pour ice into individual glasses
- Auto-cleaning mode makes it easy to keep the ice maker in good working condition
- Four rubber feet keep the ice maker stable on your table or countertop

Product overview

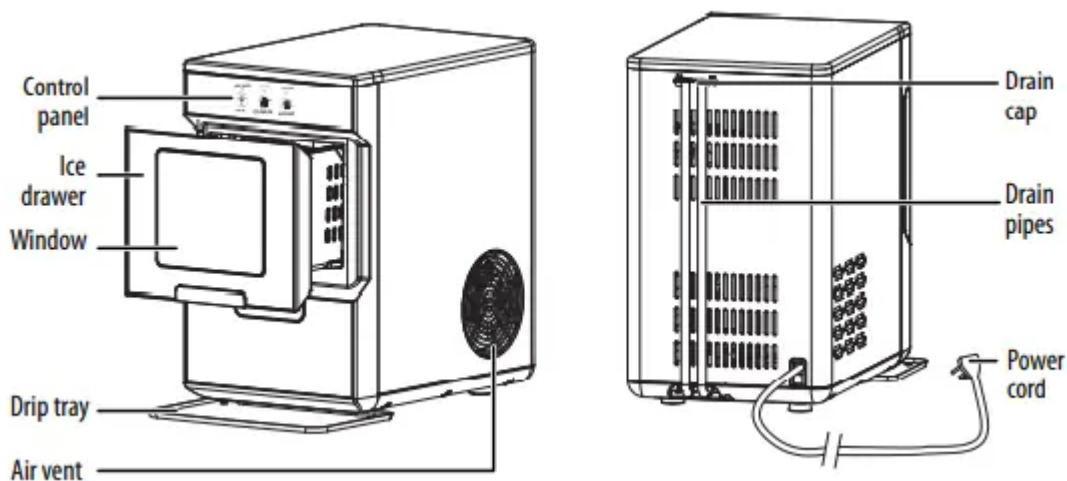

Control panel display

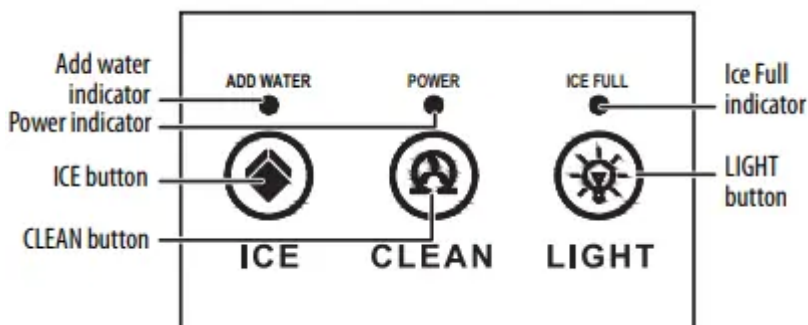

Using your ice maker

Getting ready to make ice

1 Remove the ice drawer from your ice maker.

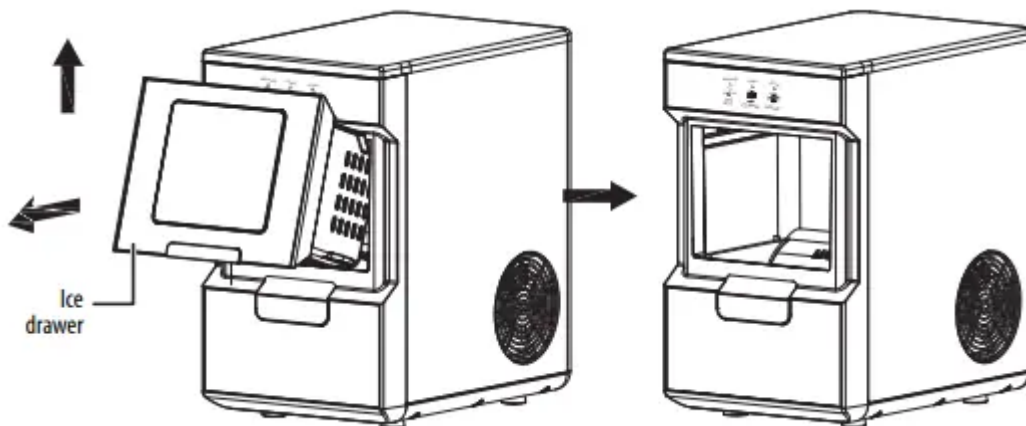

2 Fill the water reservoir with tap (drinking) water to the MAX line. It holds 74.4 oz. (2.2 l) of water.

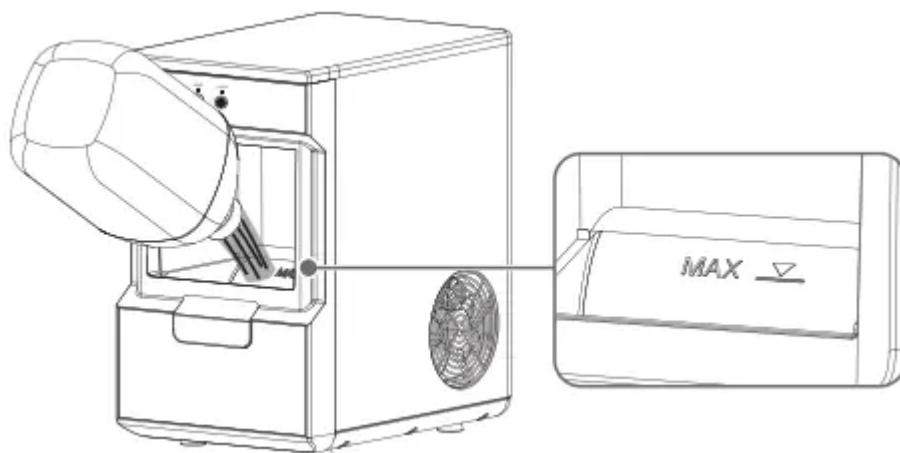

3 Place the ice drawer into the ice maker.

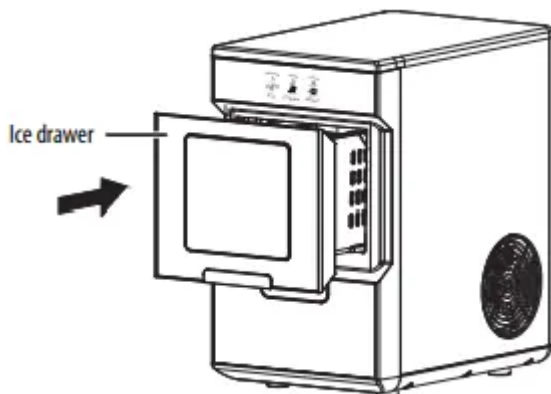

4 Put the drip tray into position.

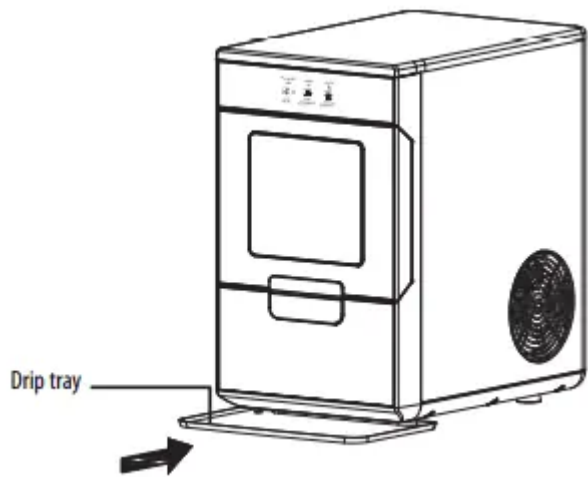

5 Plug in your ice maker. The power indicator turns on.

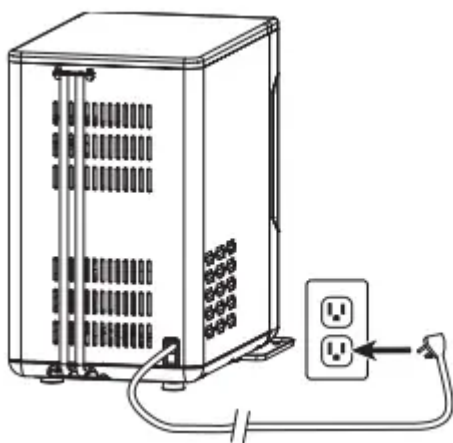

Making ice

1 Make sure the drain cap has been inserted into the drain pipe. Otherwise the ice maker will not work properly.

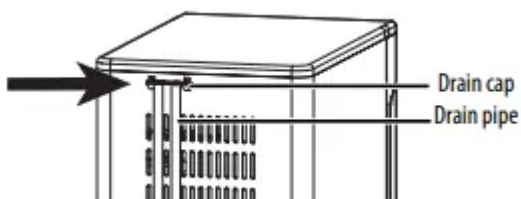

2 Make sure that the water reservoir is full of water and that the ice drawer and drip tray are in place.

3 Press the  (ICE) button. The ice indicator turns on and the ice maker begins making ice.

While ice is being made, you can see in the ice drawer by pressing the  (LIGHT) button and looking through the drawer window.

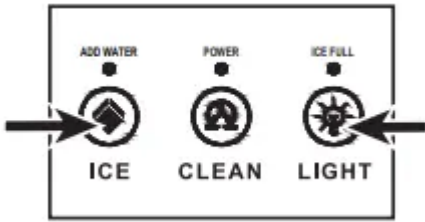

4 To stop making ice, press the  (ICE) button again and the ice maker stops making ice. If you don't stop the ice maker, it will automatically stop when the ice drawer is full and the "ice full" indicator turns on.

Removing ice

1 Open the ice drawer and use the ice scoop to remove the ice. You can also remove the ice by hand.

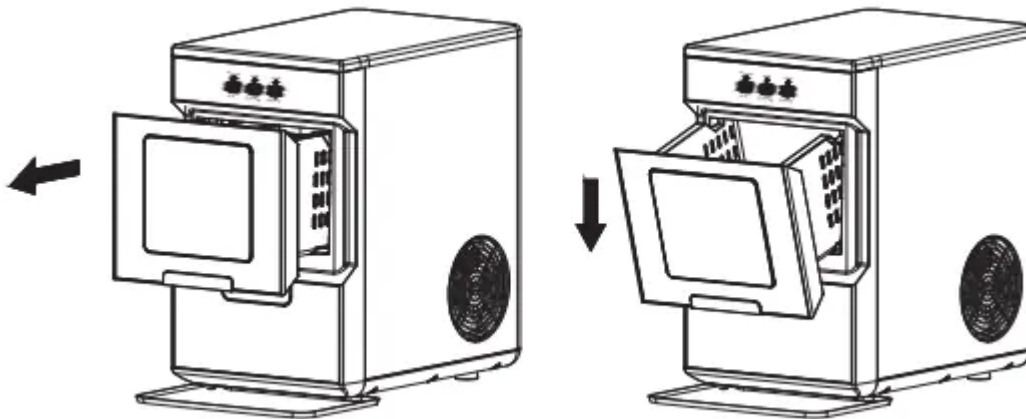

2 If the ice drawer is full, you can remove it to dump the ice into a container and store it in your freezer. To remove the ice drawer, pull it out, then tip up the front of the drawer to remove it.

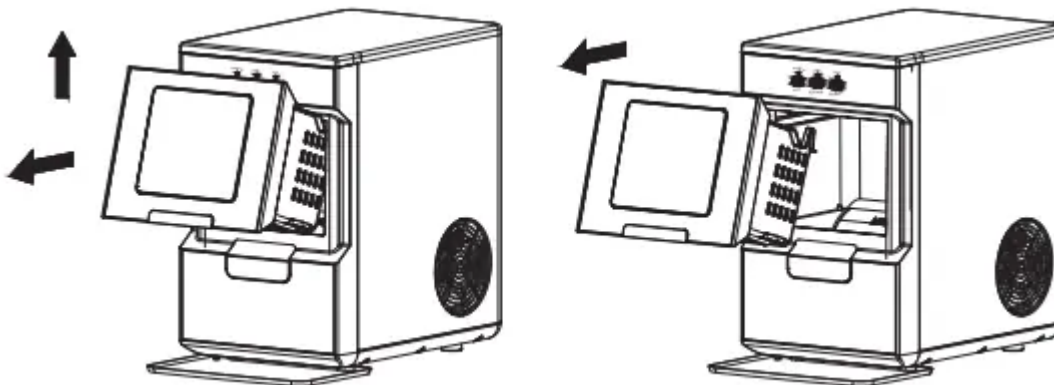

Cleaning your ice maker

Your ice maker is designed for year-round use with only minimal cleaning and maintenance.

CAUTION:



- To prevent damage to the finish, do not use gasoline, benzine, thinner, or other similar solvents, or abrasive cleaners to clean the exterior.
- Do not use bleach or vinegar to clean the internal components of your ice maker.

Cleaning the parts

- Wash the inside with a damp, warm cloth and a baking soda solution (two tablespoons in a quart of water), then wipe dry with a dry cloth. Do this periodically to keep your ice maker looking new.
- Remove the ice drawer and clean it, then replace it in the ice maker.

Running a cleaning cycle

Run a cleaning cycle before using your ice maker for the first time. After that we suggest running a cleaning cycle at least every three days.

1. Before cleaning your ice maker, make sure that the drain cap has been inserted into the drain pipes on the back of the ice maker. Otherwise the ice maker will not work properly.
2. Press the  (CLEAN) button. The cleaning indicator lights turns on. The cleaning cycle runs for at least 20 minutes, then the indicator light turns off and the ice maker stops cleaning.
3. Press the  (CLEAN) button again to turn off the auto clean cycle midway through.
4. After running a cleaning cycle, move your ice maker to the edge of the countertop, turn it around, then place a large bowl under it.
5. Pull the drain pipes from the back of the ice maker and remove the drain plug from the drain pipes.
6. Run the drain pipes into a large bowl and let the water drain from the tank.

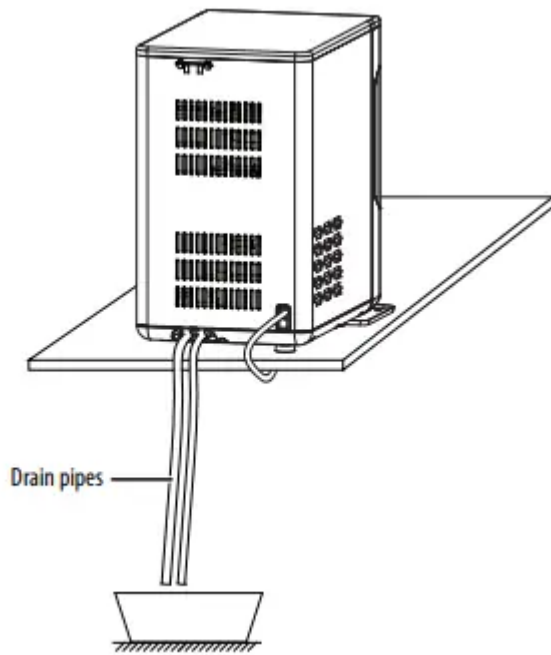

7 Reinsert the drain cap into the drain pipes and replace the drain pipes on the back of your ice maker. Your ice maker is ready to use.

Troubleshooting

The “Add Water” indicator lights

- No water in the reservoir.
 - Turn off your ice maker, remove the ice drawer, add water to the reservoir, replace the drawer, then press the  ICE button to begin making ice.

The ice has a bad taste or there is an odor

- Various
 - Make a few loads of ice after unpacking and discard the ice
 - Clean the ice maker
 - Use filtered water



The “Ice Full” indicator lights or flashes

- Too much ice in the drawer.
 - Remove some ice from the drawer.
- With no ice in the drawer.
 - Something is blocking the infrared light in the ice drawer. Remove the obstacle from the ice drawer or clean the inside of the drawer.
 - Press the  (ICE) button for five seconds (to override). Makes ice for 80 minutes.

The ice making cycle is normal, but no ice is made

- The room temperature or water temperature may be too high.
 - The room temperature should be 50° F ~ 105° F (10° C ~ 40° C). The water temperature should be 45° F ~ 90° F (7° C ~ 32° C).
- The refrigerant liquid may have leaked.
 - Contact a qualified service technician for repair.
- A pipe in the cooling system may be blocked.
 - Contact a qualified service technician for repair.

The LIGHT and ICE icons blink

- The ambient temperature or the water temperature in the inner tank is too high.
 - The ice maker should be operated below 90° F (32° C) ambient temperature.
- Pour colder water into the tank.
- Refrigerant liquid leakage.
 - Press the  (ICE) button twice to restart the ice making process, then wait for 50 minutes. If the problem does not resolve itself, have your ice maker serviced by a qualified technician.
- The motor cover is broken.
 - Press the  (ICE) button twice to restart the ice making process, then wait for 50 minutes. If the problem does not resolve itself, have your ice maker serviced by a qualified technician.
- A pipe in the cooling system is broken.
 - Press the  (ICE) button twice to restart the ice making process, then wait for 50 minutes. If the problem does not resolve itself, have your ice maker serviced by a qualified technician.

Makes ice too slowly

- The hot air outlet is blocked.
 - Check the hot air outlet and remove any blockage.
- The water temperature in the inner tank is too high.
 - The water temperature must be between 45° and 90° F (7° and 32° C)
- The refrigeration system has a malfunction.
 - Have your ice maker serviced by a qualified technician.

Your ice maker is leaking water

- The drain plug is loose or missing.
 - Replace the drain plug into the drain line.
- A pipe joint in the ice maker may be loose.
 - Have your ice maker serviced by a qualified technician.
- The seal has reached the end of its service life.
 - Have your ice maker serviced by a qualified technician.

Specifications

Dimensions (HxWxD)	16.5 x 9.8 x 15 in. (42 x 25 x 38.2 cm)
Weight	34.4 lbs. (15.6 kg)
Power requirements	115 V~ 60 Hz
Current	2.7 A
Refrigerant	R600a / 30 g
Vesicant	C ₅ H ₁₀
Protection type	I

Warning

This content is compiled from multiple sources and is provided for reference purposes only. It may not be complete or fully applicable to all situations. If you are unable to resolve your issue, please contact the product manufacturer or an authorized service provider for official support.