

Basic Operation Flow

Pre-ride Inspection ➔ P.64
Carefully inspect your vehicle to make sure that it is safe to ride.

Acceleration
Apply throttle gradually.
Obey the speed limit.

Shift Change ➔ P.51

Starting the Engine ➔ P.49
Start and warm the engine.
Avoid revving the engine.

Starting the Vehicle
Before pulling away, indicate your direction with the turn signal switch, and check for oncoming traffic.

How to use basic features.

- Instruments ➔ P.20
- Indicators ➔ P.24
- Switches ➔ P.26
- Steering Lock ➔ P.28
- Honda SMART Key System ➔ P.29
- Anti-theft Alarm System ➔ P.37
- Answer Back System ➔ P.43

Braking
STOP!
Close the throttle and apply the front and rear brakes together.
▶ The brake light will indicate that you have applied the brakes.

Stopping
If pulling off the road, signal early enough to show traffic that you are pulling over, and pull over smoothly.

Turning Corners
Do your braking before entering corners.
Gradually reapply throttle when exiting a turn.

Parking ➔ P.11
Park on a firm, level surface. Use the stand, and lock the steering.

Refueling ➔ P.52



Parts Location

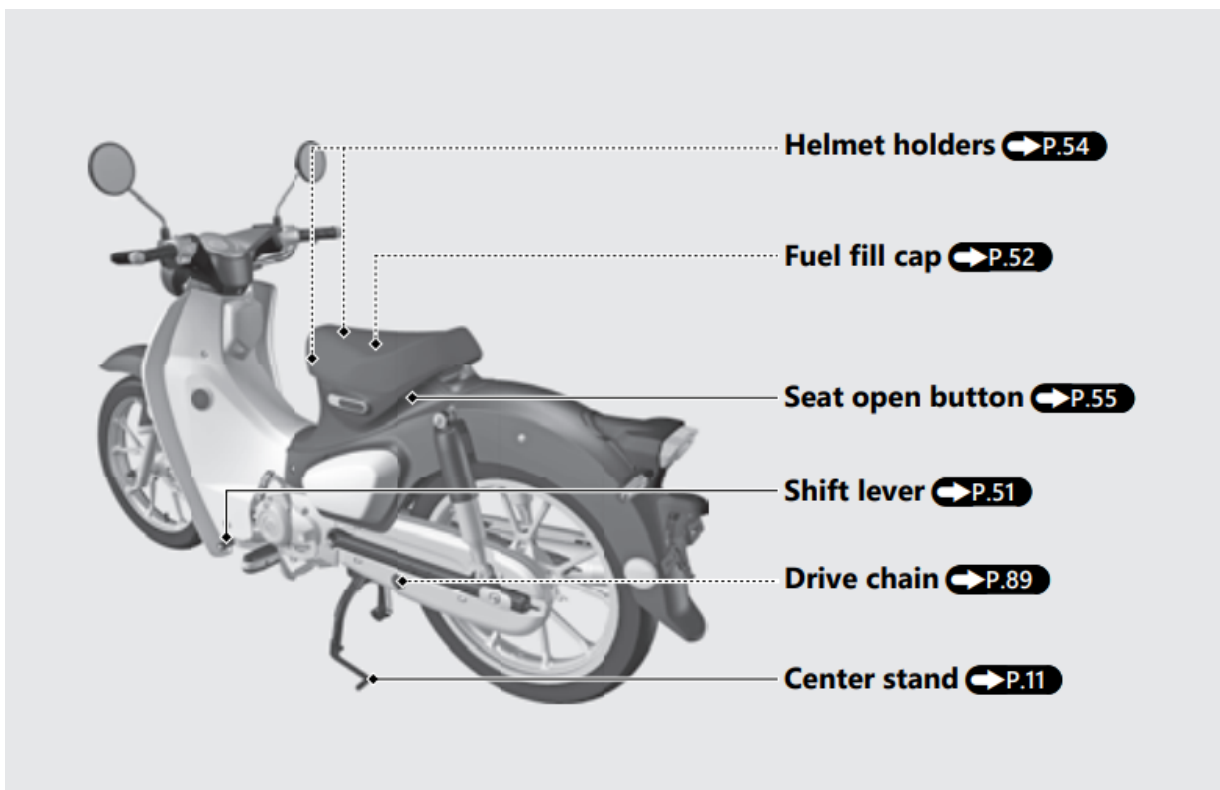
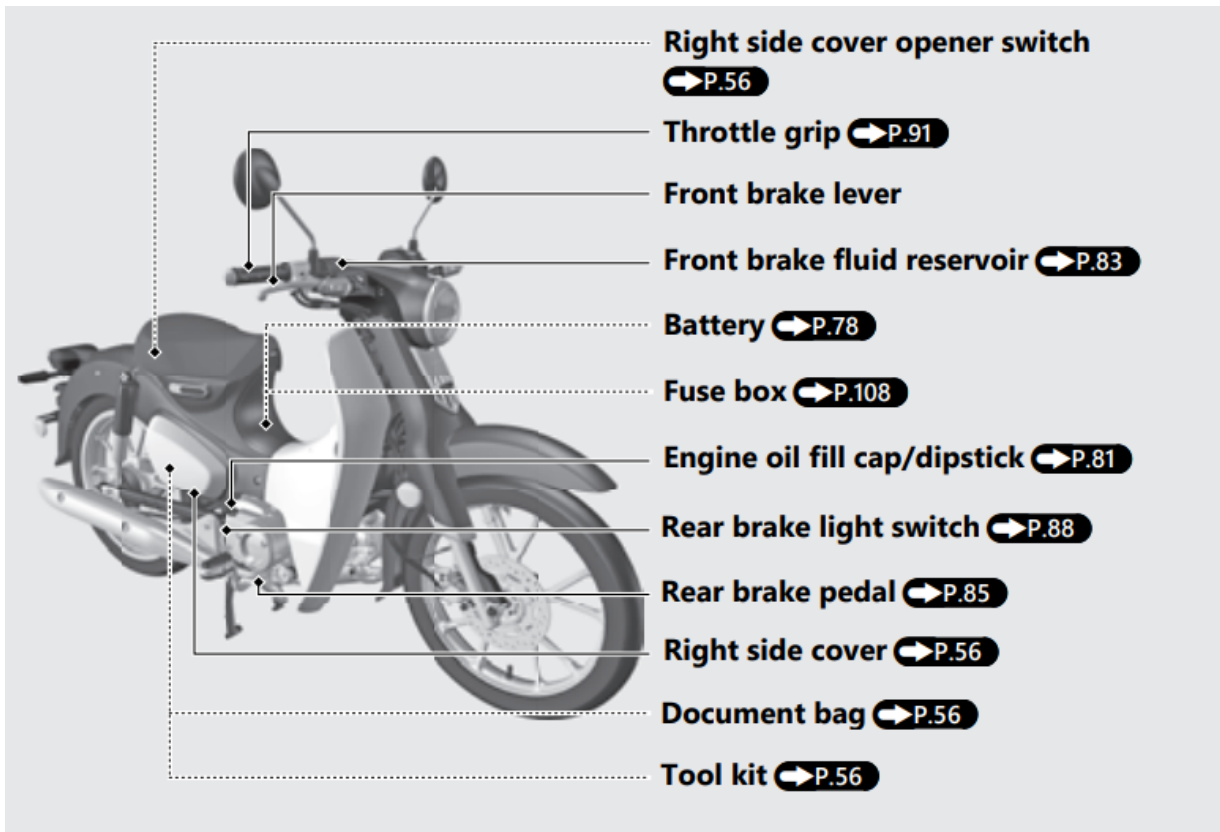

Instruments

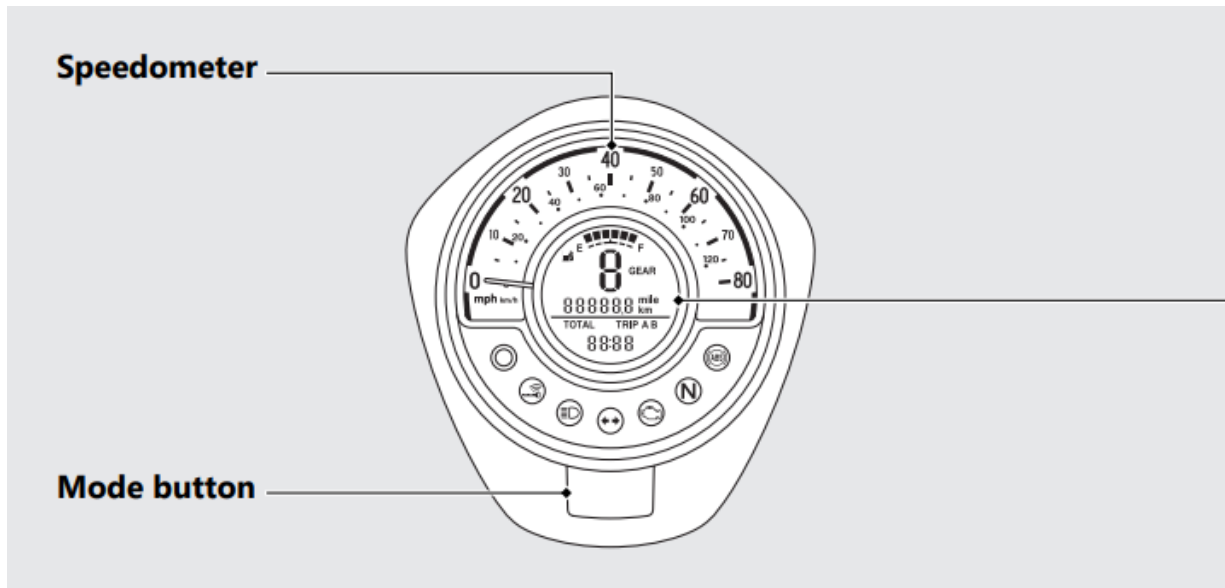

Remaining fuel when only 1st (E) segment starts flashing approximately: 0.26 US gal (1.0 L)

If the fuel gauge indicator flashes in a repeat pattern or turns off

Display Check

When the ignition switch is turned to the ON position, the speedometer needle swings to the maximum scale on the dial once, all the mode and digital segments will show. If any part of the display does not come on when it should, have your dealer check for problems.

Gear position indicator
The gear position is shown on the gear position indicator.

- ▶ "-" appears when the transmission was not shifted properly.

Fuel gauge
Remaining fuel when only the 1st (E) segment starts flashing approximately: 0.26 US gal (1.0 L)



If the fuel gauge indicator flashes in a repeat pattern or turns off: ➔ **P.100**

Odometer [TOTAL]/Tripmeter [TRIP A/B]
The mode button switches between the odometer and the tripmeter.

- Odometer: Total distance ridden.
- Tripmeter: Distance ridden since tripmeter was reset.

▶ Press and hold the mode button while the tripmeter A or B is displayed to reset the tripmeter to 0.0 km/mile.

Clock (12-hour display)
To set the clock: ➔ **P.23**

Display Setting



You can adjust the two settings.

- Clock setting
- Changing of mileage unit

The established setting can also be set by turning the ignition switch to the OFF position.

The control is automatically switched from the setting mode to the ordinary display if the button is not pressed for about 30 seconds. Even in this case, the established setting is maintained.

1 Clock setting:

1. Turn the ignition switch to the ON position.
2. With odometer displayed, press and hold the mode button, the hour digits start flashing.
3. Press the mode button until the desired hour is displayed.

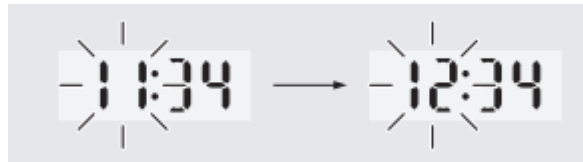

4. Press and hold the mode button, the minute digits start flashing



5. Press the mode button until the desired minute is displayed.



6. Press and hold the mode button. The clock is set, and then the display moves to the changing of mileage unit.

2 Changing of mileage unit:

1. Press the mode button to select either "km" or "mile".

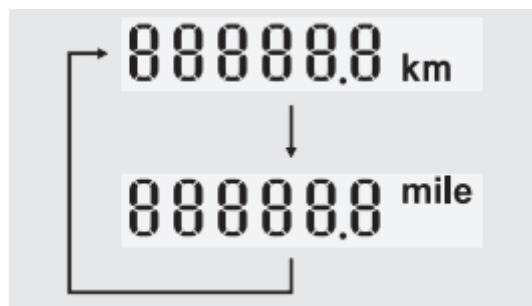

2. Press and hold the mode button. The mileage unit is set, and then the display returns to the ordinary display.

Indicators

If one of these indicators does not come on when it should, have your dealer check for problems.

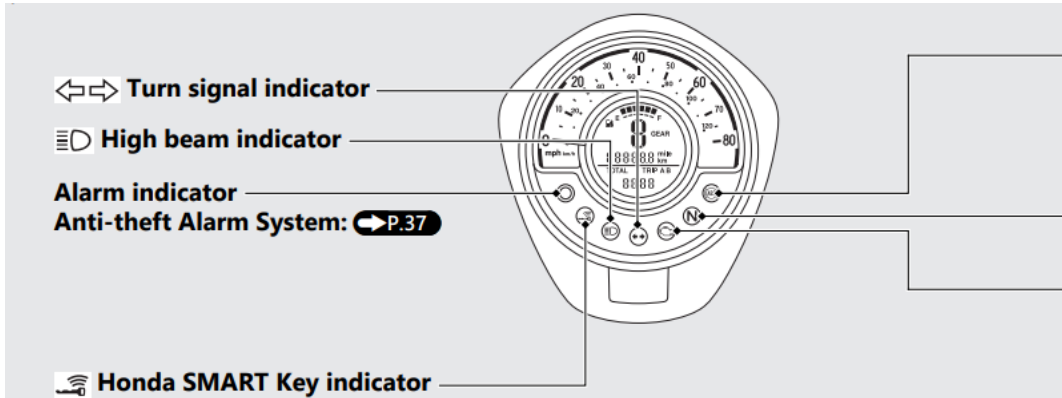

Comes on when vehicle and Honda SMART Key verification is complete, and the ignition switch can be operated. Goes off when the ignition switch is turned to the ON position.

When the Honda SMART Key Indicator Flashes: (P.98)

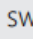
- ABS (Anti-lock Brake System) indicator**
Comes on when the ignition switch is turned to the ON position.
Goes off when your speed reaches approximately 6 mph (10 km/h).
If it comes on while riding: ➔ **P.97**
- Neutral indicator**
Comes on when the transmission is in Neutral.
- PGM-FI (Programmed Fuel Injection) malfunction indicator lamp (MIL)**
Comes on briefly when the ignition switch is turned to the ON position with the engine stop switch in the  (Run) position.
If it comes on while engine is running: ➔ **P.96**

Switches

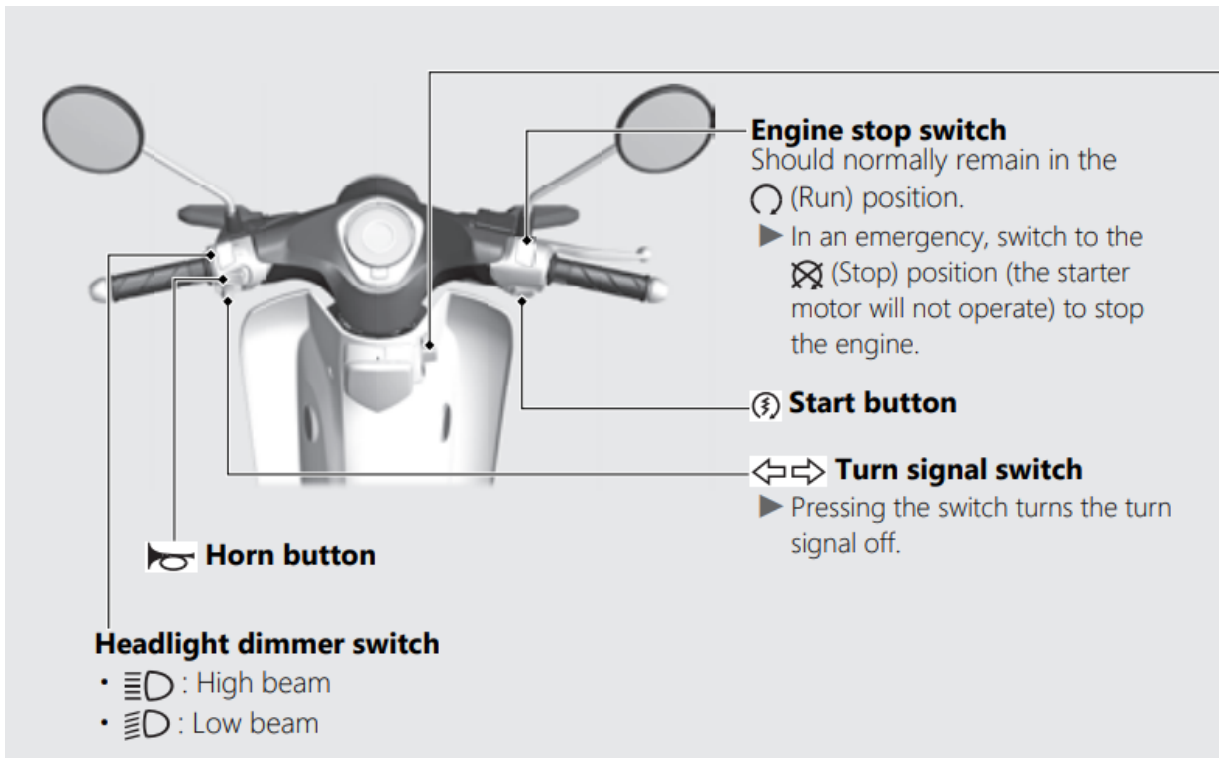

Ignition switch

Switches the electrical system on/off and locks the steering.

To unlock the ignition switch:

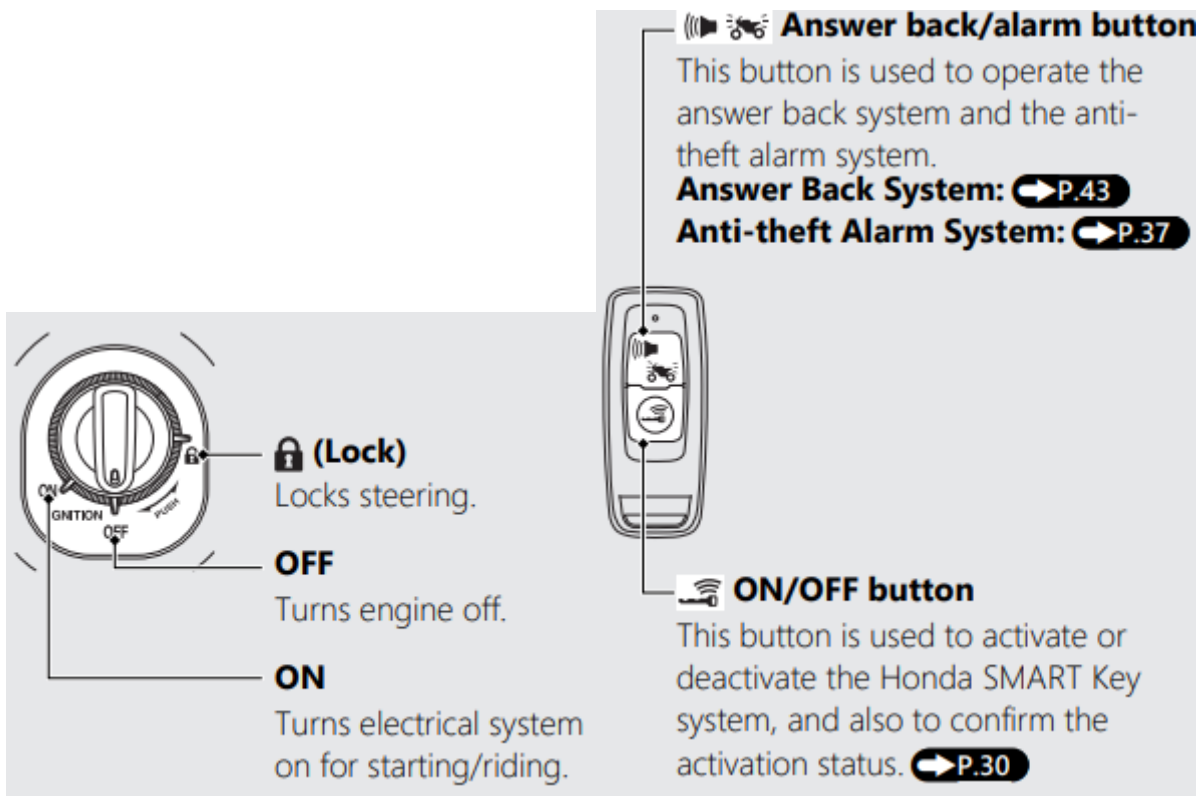

Steering Lock

Lock the steering when parking to help prevent theft. A U-shaped wheel lock or similar device is also recommended.

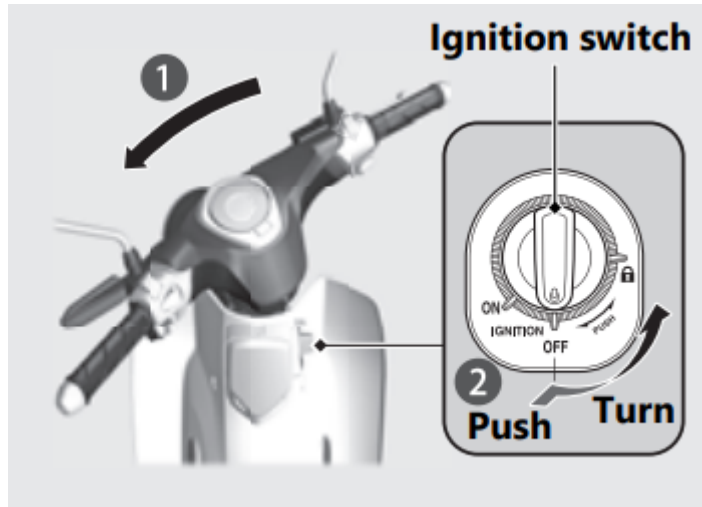

Locking

1. Turn the handlebar all the way to the left.
2. Push the ignition switch down, and turn it to the (Lock) position.
 - To unlock the ignition switch.
 - Jiggle the handlebar if the lock is difficult to engage.
3. Lock the ignition switch.

Unlocking

Push the ignition switch in, and turn it to the OFF position.

- To unlock the ignition switch.

Honda SMART Key System

The Honda SMART Key system allows you to operate the main switch without inserting a key into a keyhole.

The system runs a two-way authentication between the vehicle and the Honda SMART Key to verify if it is the registered Honda SMART Key.

The Honda SMART Key system uses low-intensity radio waves. It may affect medical equipment such as a cardiac pacemaker.

Switching the Honda SMART Key System

To switch the Honda SMART Key system to activation or deactivation

Press the ON/OFF button until the Honda SMART Key LED changes color.

To check the Honda SMART Key system status

Lightly press the ON/OFF button. The Honda SMART Key LED will show the status. When the Honda SMART Key LED is:

Green: (active) Honda SMART Key system authentication can be performed.

Red: (inactive) Honda SMART Key system authentication cannot be performed.

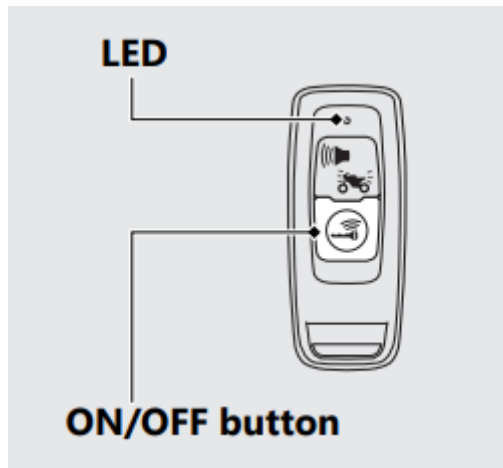

Operating Range

The operating range varies when the ignition switch is locked or unlocked.

The Honda SMART Key system uses low intensity radio waves. Therefore, the operating range may be wider or narrower, or the Honda SMART Key system may not work properly in the following situations:

- When the Honda SMART Key battery is depleted.
- When there are facilities nearby that generate strong radio waves or noise, such as TV towers, power stations, radio stations, or airports.
- When you carry the Honda SMART Key with a laptop or wireless communication device such as a radio or mobile phone.
- When the Honda SMART Key comes into contact with or is covered by metal objects.

When the ignition switch is unlocked:

The system can be operated within the shaded area shown in the illustration.

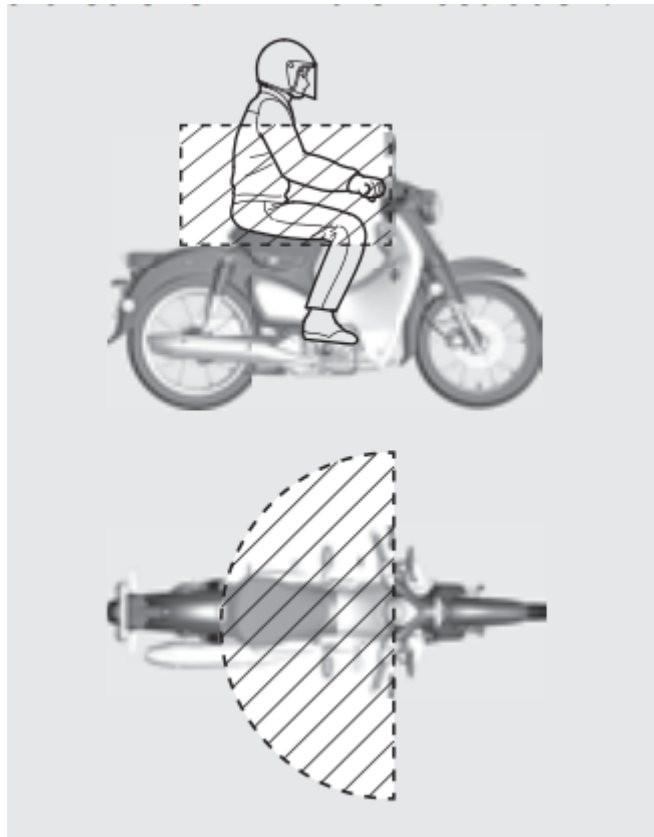

When the ignition switch is locked:

The system can be operated within the shaded area shown in the illustration.

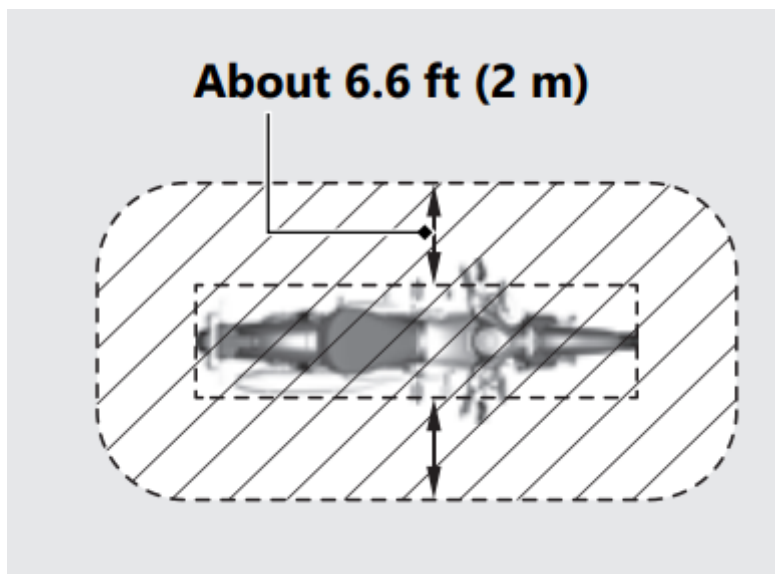

Anyone can unlock the ignition switch and start the engine if your Honda SMART Key is within operating range of your vehicle, even if you are on the other side of a wall or window. If you are away from your vehicle but your Honda SMART Key is still within operating range, deactivate the Honda SMART Key system.

To switching the Honda SMART Key system

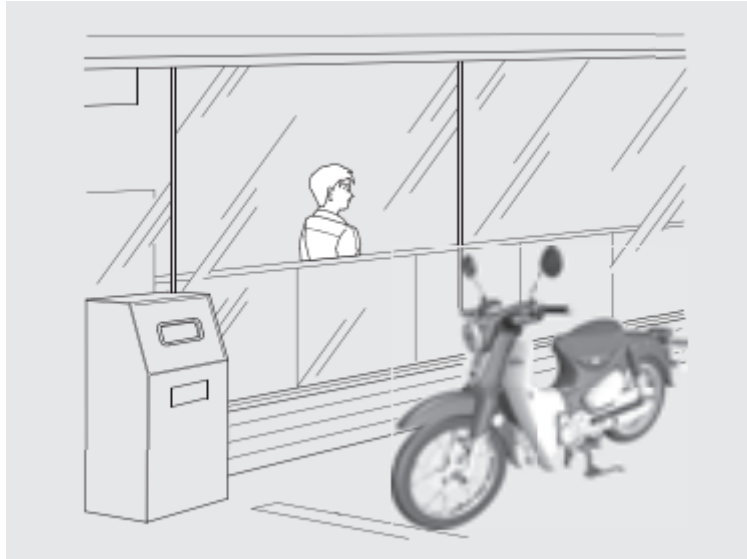

Anyone in possession of the Honda SMART Key can perform the following operations if the Honda SMART Key is within operating range:

- Starting the engine
- Unlocking the ignition switch
- Unlocking the seat lock
- Unlocking the steering lock

You should always keep the Honda SMART Key on your person after you get on and off the vehicle or while riding.

Do not place the Honda SMART Key in any compartment.

If the ignition switch is in the ON position, the vehicle can be operated even by a person who does not have a verified Honda SMART Key.

Whenever you leave your vehicle, lock the steering and lock the ignition switch. (P.35)

Make sure the ignition switch ring goes off and all turn signals flash once at this time.

Switching the ignition switch

To Unlock the Ignition Switch

1. Make sure that the Honda SMART Key is activated. (P.30)
2. To authenticate the Honda SMART Key system, push the ignition switch.
 - When properly authenticated and the ignition switch is unlocked, the buzzer rings times, the Honda SMART Key indicator and ignition switch ring come on.
 - The buzzer sound can be cancelled. (P.36)

3. Turn the ignition switch to the ON position while the Honda SMART Key indicator comes on.
 - If you do not turn the ignition switch to the ON position within 20 seconds after pushing in the ignition switch in, the Honda SMART Key indicator and ignition switch ring will go off, the turn signals flash 1 time, and then the ignition switch will be locked.

When the Honda SMART Key system does not work properly (P.97)

If someone without the Honda SMART Key tries to turn the ignition switch, the ignition switch rotates freely. If you notice the ignition switch is in a different position, turn the ignition switch to the original (OFF or Lock)) position.

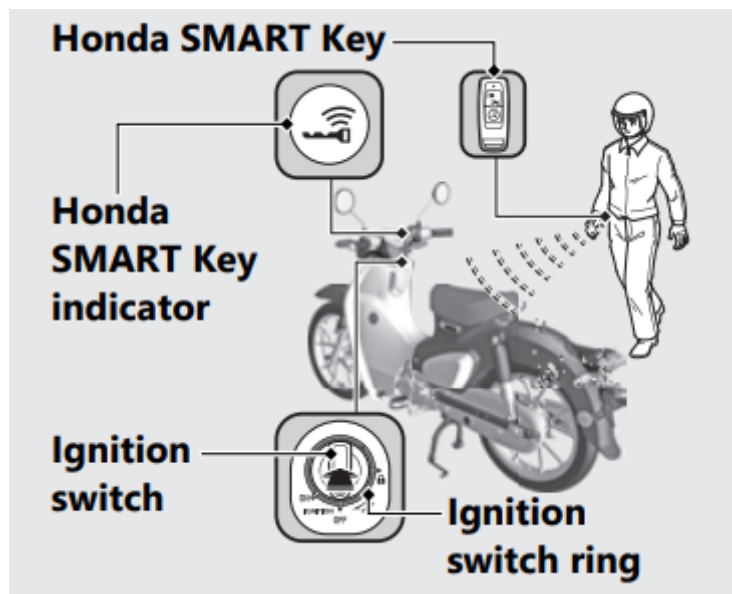

To Lock the Ignition Switch

1 Turn the ignition switch to the OFF or (Lock) position.

2 Lock the ignition switch by doing one of the following:

- Leave the operating range with the Honda SMART Key. (P.31)
- Push the ignition switch.
- Wait for approximately 20 seconds after turning the ignition switch from ON to OFF or (Lock) position.
- Switch the Honda SMART Key system to inactive. (P.30)
- Press the answer back/alarm button on the Honda SMART Key.
 - At the same time, the anti-theft alarm system is set. (P.38)

Make sure that the Honda SMART Key indicator and ignition switch ring go off, the turn signals flash once, and the buzzer rings 1 time. This indicates that the ignition switch is locked.

- The buzzer sound can be cancelled.

When the Honda SMART Key system does not work properly

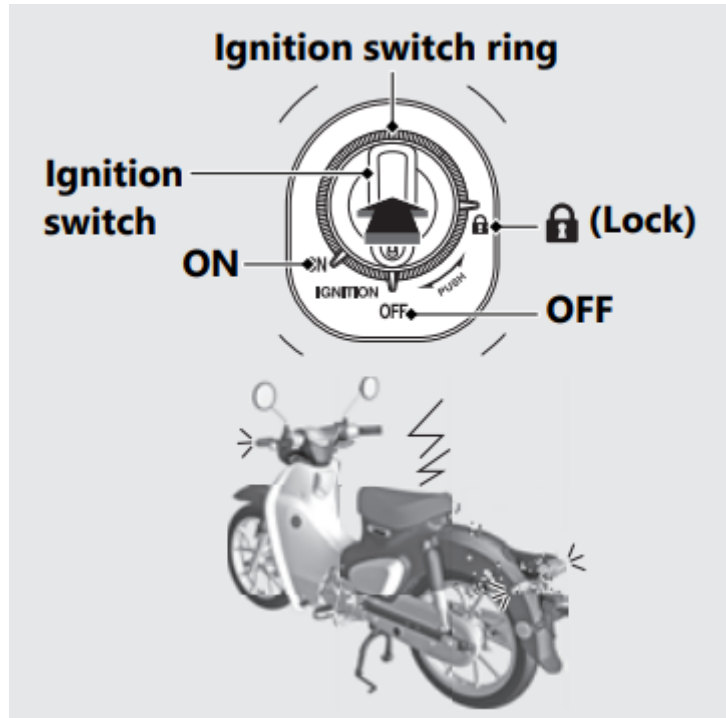

Always make sure the ignition switch position is in the OFF or (Lock) position when you leave your vehicle.

When the ignition switch is locked in the OFF position, the steering cannot be locked. To lock the steering, unlock the ignition switch.

Switch the Buzzer Sound When the Ignition Switch is Locked/Unlocked

Enable

- 1 Deactivate the Honda SMART Key system. (P.30)
- 2 Lightly press the ON/OFF button. The red Honda SMART Key LED comes on.
- 3 While the red LED is on, press the answer back button.
 - The red LED starts blinking when the buzzer sound is properly enabled.

Disable

1. Deactivate the Honda SMART Key system. (P.30)
2. Lightly press the ON/OFF button. The red Honda SMART Key LED blinks.
3. While the red LED is blinking, press the answer back button.
 - The red LED stops blinking but stays on when the buzzer sound is properly disabled.

Anti-theft Alarm System

The anti-theft alarm system is a device to reduce the likelihood of theft. When the sensor detects vibration or movement with the ignition switch in the OFF or (Lock) position and the system is set, the alarm is activated.

The buzzer rings and the turn signals blink for about 10 seconds when the anti-theft alarm system detects vibration caused by contact or movement.

The buzzer rings and the turn signals blink for about 60 seconds when the anti-theft alarm system detects a substantial change in the vehicle posture. After the buzzer rings for seconds, the anti-theft alarm system will be reset in that posture.

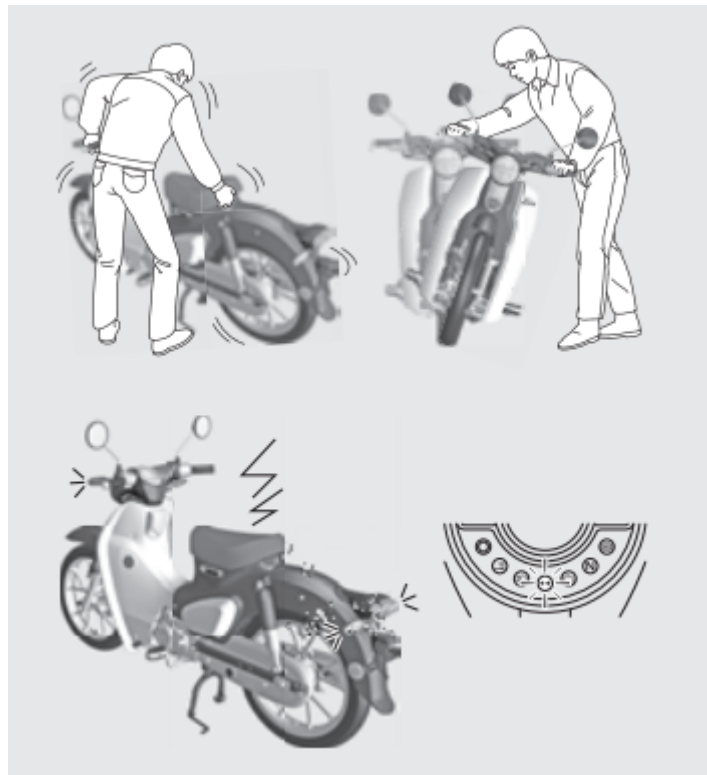

If the ignition switch is left in the OFF or (Lock) position for more than 10 days, the anti-theft alarm system will no longer operate.

When the system is active and the vehicle receives a signal from pressing the answer back or alarm button, system activation will be extended for 10 days.

To reset the system, unlock the ignition switch and turn the ignition switch to the ON position once.

- To unlock the ignition switch. (P.34)

The anti-theft alarm system uses lowintensity radio waves. It may affect medical equipment such as a cardiac pacemaker.

When the battery in the vehicle is weak, the anti-theft alarm system may not function.

Setting the Anti-theft Alarm System

1. Turn the ignition switch to OFF or (Lock) position.
2. Press the alarm button. Within a second, the turn signal light blinks and the buzzer rings 1 time. After 2 seconds, the buzzer rings 1 time. The anti-theft alarm system is activated. The alarm indicator flashes while the anti-theft alarm system is activated.

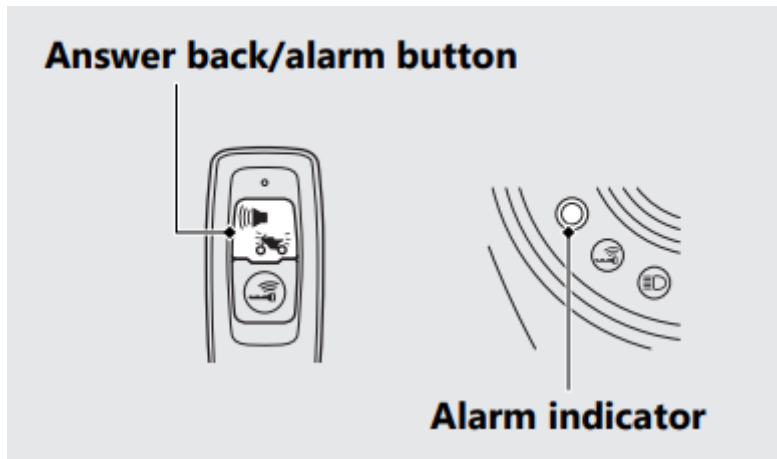

Cancelling the Anti-theft Alarm System

To cancel the anti-theft alarm system, do one of the following:

- Press the alarm button on the Honda SMART Key.
- Unlock the ignition switch. (P.34)
- Press the seat open button while the Honda SMART Key is in the operating range

When the anti-theft alarm system is cancelled, the alarm indicator goes off.

Stopping the Anti-theft Alarm Activation

To stop the anti-theft alarm activation, do one of the following:

- Press the answer back/alarm button on the Honda SMART Key
 - After stopping the anti-theft alarm activation, the anti-theft alarm system will be reset
- Unlock the ignition switch. (P.34)
- Open the seat. (P.55)
 - After stopping the anti-theft alarm activation, the anti-theft alarm system will be cancelled.

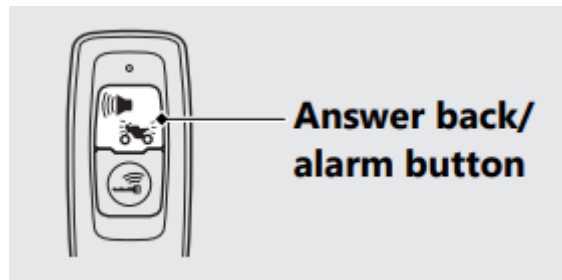

Adjusting the Sensitivity of Anti-theft Alarm System

You can select from 3 sensitivity levels for the anti-theft alarm system.

1. Make sure that the Honda SMART Key system is active. (P.30)
2. Push the ignition switch to authenticate the Honda SMART Key system. (P.34)
3. Press and hold the ignition switch for more than 4 seconds.
 - The Honda SMART Key indicator and ignition switch ring go off.

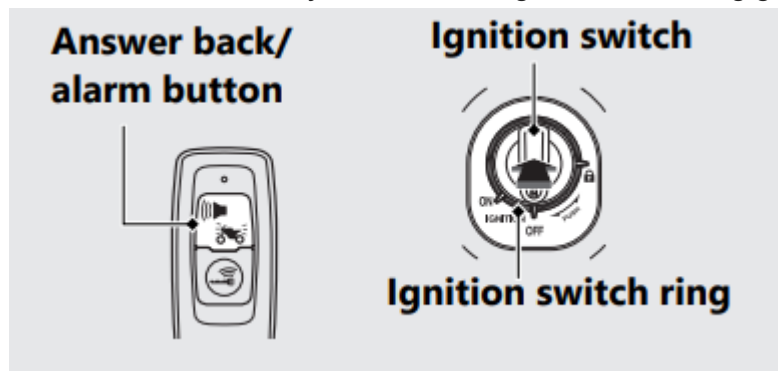

4. Press the ignition switch 1 time while the Honda SMART Key indicator and ignition switch ring are flashing.
 - The Honda SMART Key indicator and ignition switch ring come on, and a buzzer sounds
5. Repeat the following 3 times: Press the answer back/alarm button on the Honda SMART Key 4 times and the ignition switch 1 time.
 - When the ignition switch is pressed, the Honda SMART Key indicator and ignition switch ring go off, and the buzzer sounds. When they light again, do the next input
 - When the answer back/alarm button is pressed, the Honda SMART Key LED comes on. Make sure the LED goes off before pressing the button again.
 - When the answer back/alarm button or ignition switch is not pressed for 1 minute, the Honda SMART Key indicator and ignition switch ring flash 3 times, and then the buzzer sounds and the mode is cancelled. Return to a and do the procedure again.

- If you press the answer back/alarm button the wrong number of times before you repeat the procedure 3 times, then repeat the procedure 3 times again
6. Press the answer back/alarm button to select from 3 sensitivity levels.
 - 3 alarm rings: high sensitivity
 - 2 alarm rings: medium sensitivity
 - 1 alarm ring: low sensitivityThe Honda SMART Key indicator and ignition switch ring come on while setting
 7. Press and hold the ignition switch for more than 2 seconds. The sensitivity level is set.
 - The Honda SMART Key indicator and ignition switch ring turn off, and a buzzer sounds once.
 - When the answer back/alarm button is not pressed for 10 seconds, the Honda SMART Key indicator and ignition switch ring flash 3 times, and then the buzzer sounds, and the sensitivity level is set.

If the Anti-Theft Alarm System Does Not Operate Properly

If any of the following situations arise, battery (2 P. 78) in the vehicle is discharged or there is a system problem. Remove the battery and see your dealer.

The alarm does not ring.

The alarm rings but fades out.

The alarm system does not stop.

Answer Back System

The answer back system is a device to find the location of your vehicle. When the immobilizer is active and you press the answer back button on the Honda SMART Key with the ignition switch in the OFF or (Lock) position, the turn signals light, the ignition switch ring lights, and the buzzer rings, informing you of your vehicle's location. The ignition switch ring will light for about 1 minute.

The answer back system uses low-intensity radio waves. It may affect medical equipment such as a cardiac pacemaker.

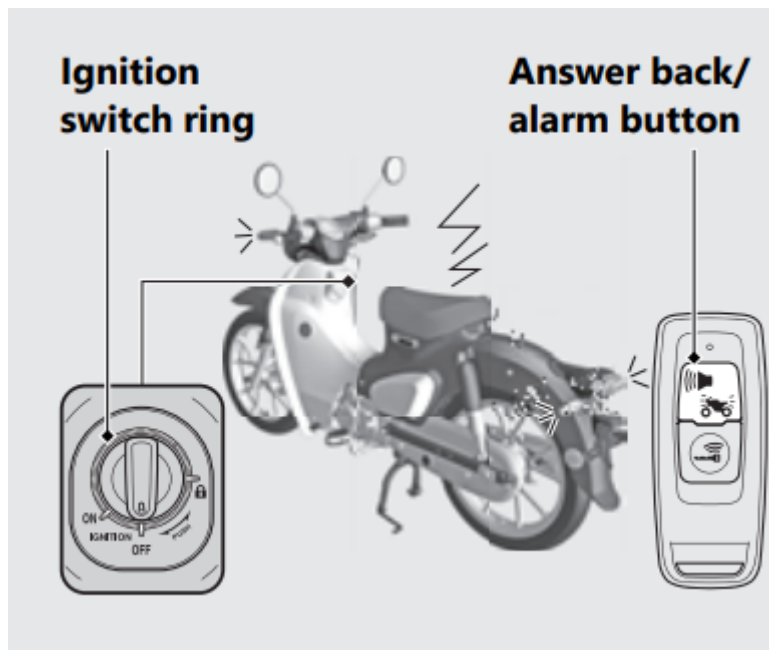

Operation

Press the answer back button on the Honda SMART Key.

- The answer back system will not function when the ignition switch is in the ON position.
When the battery in the vehicle is weak, the answer back system may not function.

If the ignition switch is left in the OFF or (Lock) position for more than 10 days, the answer back system will no longer operate. When the system is active and the vehicle receives a signal from pressing the answer back or alarm button, system activation will be extended for 10 days. To reset the system, unlock the ignition switch and turn the ignition switch to the ON position once.

- To unlock the ignition switch. (P.34)

Adjusting the Answer Back Buzzer Sound Volume Level

You can select the buzzer sound volume from 3 levels.

1. Make sure that the Honda SMART Key system is activated. (P.30)
2. Push the ignition switch to authenticate the Honda SMART Key system. (P.34)
3. Press and hold the ignition switch for more than 4 seconds
 - The Honda SMART Key indicator and ignition switch ring go off.

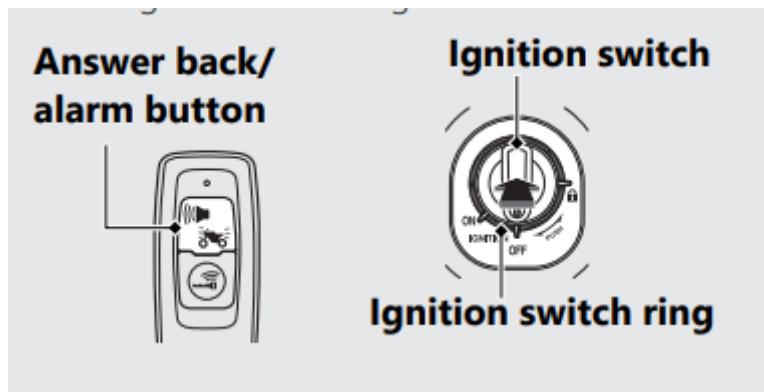

4. Press the ignition switch 1 time while the Honda SMART Key indicator and ignition switch ring are flashing

- The Honda SMART Key indicator and ignition switch ring come on, and a buzzer sounds

6. Repeat the following 3 times: Press the answer back/alarm button on the Honda SMART Key 2 times and the ignition switch 1 time.

- When the ignition switch is pressed, the Honda SMART Key indicator and ignition switch ring go off, and the buzzer sounds. When they light again, do the next input.
- When the ignition switch is pressed, the Honda SMART Key indicator and ignition switch ring go off, and the buzzer sounds. When they light again, do the next input.
- When the answer back/alarm button or ignition switch is not pressed for 1 minute, the Honda SMART Key indicator and ignition switch ring flash 3 times, and then the buzzer sounds and the mode is cancelled. Return to 1 and do the procedure again.
- If you press the answer back/alarm button the wrong number of times before you repeat the procedure 3 times, then repeat the procedure 3 times again.

6. Press the answer back/alarm button to select from 3 levels for the sound volume. The Honda SMART Key indicator and ignition switch ring come on while setting.

7. Press and hold the ignition switch for more than 2 seconds. The sound volume level is set.

- The Honda SMART Key indicator and ignition switch ring turn off, and a buzzer sounds once.
- When the answer back/alarm button is not pressed for 10 seconds, the Honda SMART Key indicator and ignition switch ring flash 3 times, and then the buzzer sounds, and the sound volume level is set

Changing the Answer Back Buzzer Sound Pattern

You can select 3 buzzer sound patterns.

1. Make sure that the Honda SMART Key is active. (P.30)
2. Push the ignition switch to authenticate the Honda SMART Key system. (P.34)

3. Press and hold the ignition switch for more than 4 seconds

- The Honda SMART Key indicator and ignition switch ring flash.



4. Press the ignition switch 1 time while the Honda SMART Key indicator and ignition switch ring are flashing

- The Honda SMART Key indicator and ignition switch ring come on, and a buzzer sounds

5. Repeat the following 3 times: Press the answer back button on the Honda SMART Key 3 times and the ignition switch 1 time.

- When the ignition switch is pressed, the Honda SMART Key indicator and ignition switch ring go off, and the buzzer sounds. When they light again, do the next input
- When the ignition switch is pressed, the Honda SMART Key indicator and ignition switch ring go off, and the buzzer sounds. When they light again, do the next input
- When the answer back/alarm button or ignition switch is not pressed for 1 minute, the Honda SMART Key indicator and ignition switch ring flash 3 times, and then the buzzer sounds and the mode is cancelled. Return to 1 and do the procedure again
- If you press the answer back/alarm button the wrong number of times before you repeat the procedure 3 times, then repeat the procedure 3 times again.

6. Press the answer back/alarm button to select from 3 buzzer sound patterns. The Honda SMART Key indicator and ignition switch ring come on while setting.

7. Press and hold the ignition switch for more than 2 seconds. The sound pattern is set.

- The Honda SMART Key indicator and ignition switch ring turn off, and a buzzer sounds once.
- When the answer back/alarm button is not pressed for 10 seconds, the Honda SMART Key indicator and ignition switch ring flash 3 times, and then the buzzer sounds, and the sound pattern is set.

Temporary Silence Mode

Temporary silence mode is the immediate way to turn off the answer back system buzzer sound.

Enable:

Press and hold the answer back button for about 2 seconds, the Honda SMART Key LED changes to red.

Disable:

Re-press and hold the answer back button for about 2 seconds, the Honda SMART Key LED changes to green.

Starting the Engine

Start your engine using the following procedure, regardless of whether the engine is cold or warm. This vehicle is equipped with a Honda SMART Key system. Always keep Honda SMART Key on you when you ride the vehicle. (P.31)

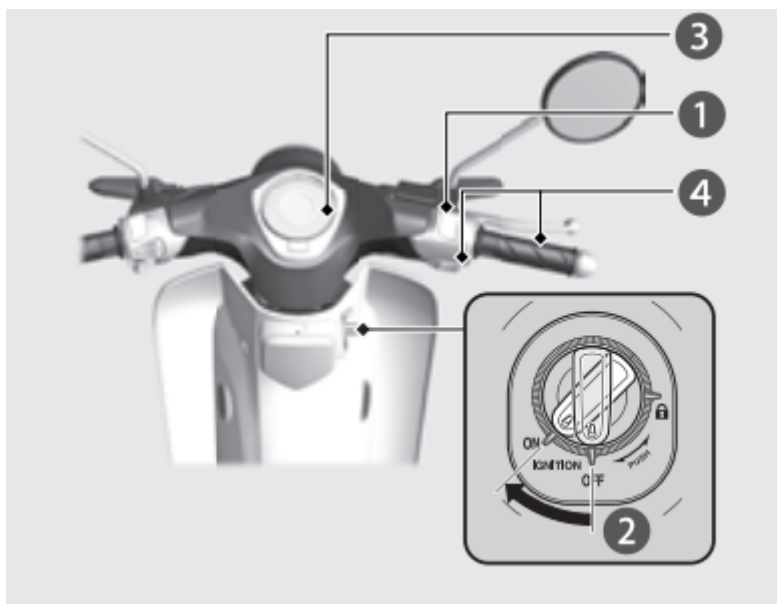

NOTICE

- If the engine does not start within 5 seconds, turn the ignition switch to the OFF position and wait 10 seconds before trying to start the engine again to recover battery voltage.
- Extended fast idling and revving the engine can damage the engine, and the exhaust system.
- Snapping the throttle or fast idling for more than about 5 minutes may cause exhaust pipe discoloration.

1. Make sure the engine stop switch is in the (Run) position.
2. Turn the ignition switch to the ON position.
3. Shift the transmission to Neutral (indicator to come on).
4. Press the start button with the throttle completely closed.

If you cannot start the engine:

Open the throttle slightly (about 0.1 in (3 mm), without freeplay).

About 0.1 in (3 mm), without freeplay

If the engine does not start:

1. Open the throttle fully and press the start button for 5 seconds.
2. Repeat the normal starting procedure.
3. If the engine starts, open the throttle slightly if idling is unstable.
4. If the engine does not start, wait 10 seconds before trying step 1 & 2 again.

Shifting Gears

Your vehicle transmission has 4 forward gears, four-up shift pattern when you shift with your toe. With a heel and toe shifter, you can also shift to a higher gear by pressing the shift lever down with your heel. You can shift to a lower gear by depressing the shift lever down with your toe.

Recommended Shift Points

NOTICE Improper shifting can damage the engine, transmission, and drive train. Also, coasting or towing the vehicle for long distances with the engine off can damage the transmission.

Refueling

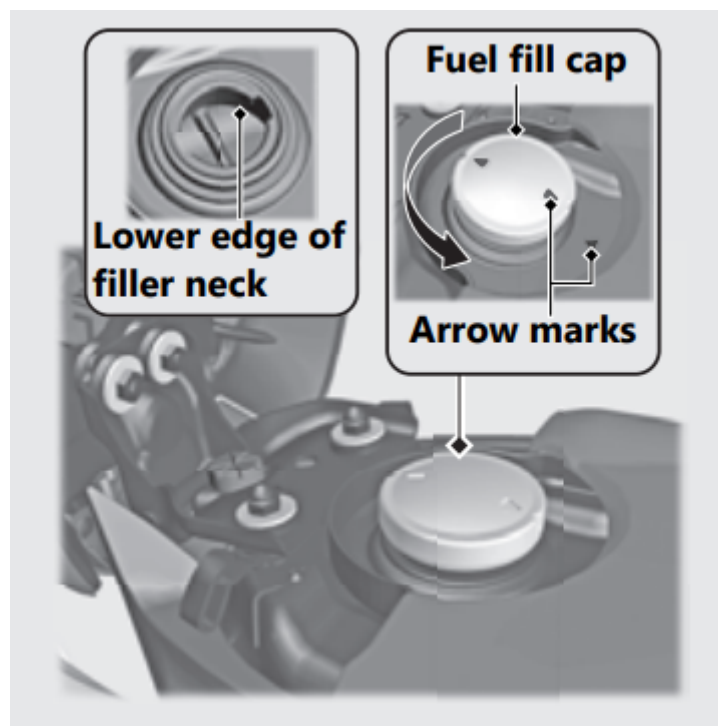

Do not fill with fuel above the lower edge of the filler neck.

Fuel type: Unleaded gasoline only

Recommended fuel octane number: Pump Octane Number (PON) 86 or higher.

Tank capacity: 0.98 US gal (3.7 L)

Refueling and Fuel Guidelines (P.12)

Opening the Fuel Fill Cap

1. Open the seat.
2. Turn the fuel fill cap counterclockwise until it stops and remove the cap.

Closing the Fuel Fill Cap

1. Install and tighten the fuel fill cap firmly by turning it clockwise
 - Make sure that the arrow marks on the cap and fuel tank are aligned.
2. Close the seat.

WARNING Gasoline is highly flammable and explosive. You can be burned or seriously injured when handling fuel.

- Stop the engine, and keep heat, sparks, and flame away.
- Handle fuel only outdoors.
- Wipe up spills immediately.

Storage Equipment

Helmet holder

The helmet holders are located under the seat.

- Use the helmet holders only when parked.

Seat Open

The seat open button can be operated when the Honda SMART Key is in the operating range (P.31) , the Honda SMART Key system is active ((P.30)) and the ignition switch is in the OFF or (Lock) position.

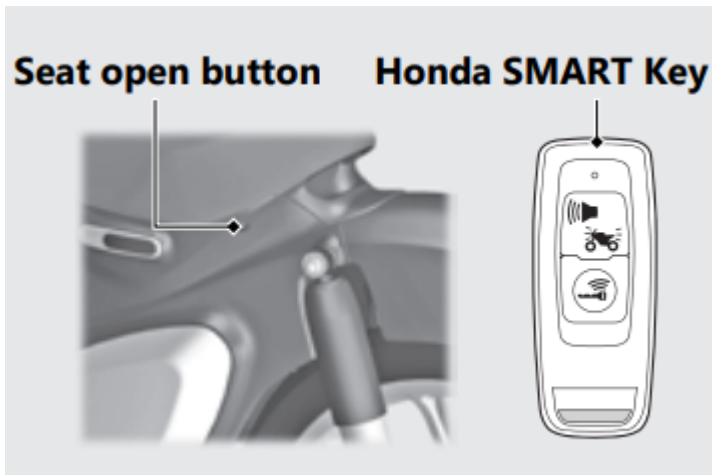

Press the seat open button and open the seat.

- If the battery does not have enough voltage to start the engine, the seat may not open.

Close

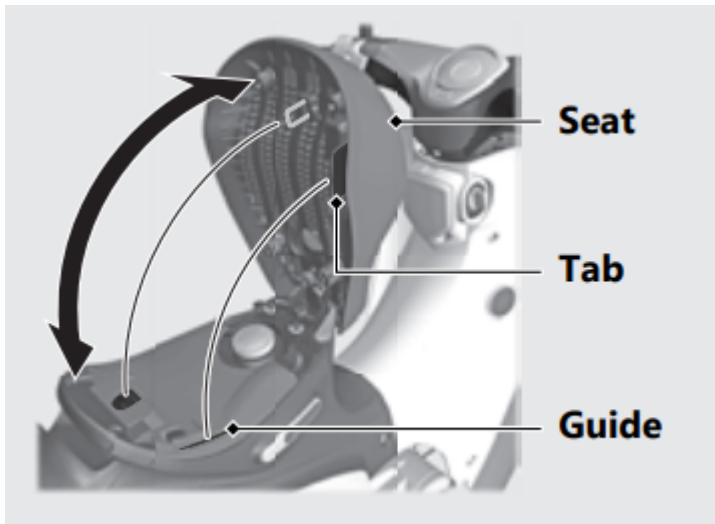

Close the seat and push down on the rear of the seat until it locks. Make sure that the seat is locked securely to pull it up lightly

- Make sure the tab of the seat aligns with the guide

Maintenance

Maintenance Schedule

The maintenance schedule specifies the maintenance requirements necessary to ensure safe, dependable performance, and proper emission control.

Maintenance work should be performed in accordance with Honda's standards and specifications by properly trained and equipped technicians. Your dealer meets all of these requirements. All scheduled maintenance is considered a normal owner operating cost and will be charged to you by

your dealer. Keeping an accurate maintenance record will help ensure your vehicle is properly maintained. P. 63

Make sure whoever performs the scheduled maintenance completes the maintenance record. Retain all service documents. If you sell your vehicle, these service documents should be transferred with the vehicle to the new owner.

Items	Frequency *1									Regular Replace	Refer to page
	× 1,000 mi	0.6	4	8	12	16	20	24			
	× 1,000 km	1.0	6.4	12.8	19.2	25.6	32.0	38.4			
Fuel Line			I	I	I	I	I	I			-
Throttle Operation			I	I	I	I	I	I			91
Air Cleaner *2					R			R			-
Crankcase Breather *3			C	C	C	C	C	C			-
Spark Plug			I	R	I	R	I	R			-
Valve Clearance			I	I	I	I	I	I			-
Engine Oil		R	R	R	R	R	R	R	1 Year		-
Engine Oil Strainer Screen				C		C		C			-
Engine Oil Centrifugal Filter				C		C		C			-
Engine Oil Filter				R		R		R			-
Engine Idle Speed			I	I	I	I	I	I			-
Evaporative Emission Control System *4					I			I			-

Maintenance Level

: Intermediate. We recommend service by your dealer, unless you have the necessary tools and are mechanically skilled. Procedures are provided in an official Honda Service Manual (P. 128).

: Technical. In the interest of safety, have your vehicle serviced by your dealer.

Maintenance Legend

: Inspect (clean, adjust, lubricate, or replace, if necessary)

: Lubricate

: Replace

: Clean

Items	Frequency *1									Regular Replace	Refer to page
	× 1,000 mi	0.6	4	8	12	16	20	24			
	× 1,000 km	1.0	6.4	12.8	19.2	25.6	32.0	38.4			
Drive Chain	Every 300 mi (500 km): I L										89
Brake Fluid *5			I	I	I	I	I	I	2 Years		83
Brake Shoes/Pads Wear			I	I	I	I	I	I			84, 87
Brake System			I	I	I	I	I	I			83
Brake Light Switch			I	I	I	I	I	I			88
Headlight Aim			I	I	I	I	I	I			-
Clutch System		I	I	I	I	I	I	I			-
Suspension			I	I	I	I	I	I			-
Nuts, Bolts, Fasteners				I		I		I			-
Wheels/Tires			I	I	I	I	I	I			-
Steering Head Bearings				I		I		I			-

Notes:

*1 : At higher odometer reading, repeat at the frequency interval established here.



*2 : Service more frequently when riding in unusually wet or dusty areas.

*3 : Service more frequently when riding in rain or at full throttle.

*4 : 50 STATE (meets California)

*5: Replacement requires mechanical skill.

Replacing Parts

Always use Honda Genuine Parts or their equivalents to ensure reliability and safety. When ordering colored components, specify the model name, color, and code mentioned on the color label. The color label is attached to the frame near the rear brake light switch.

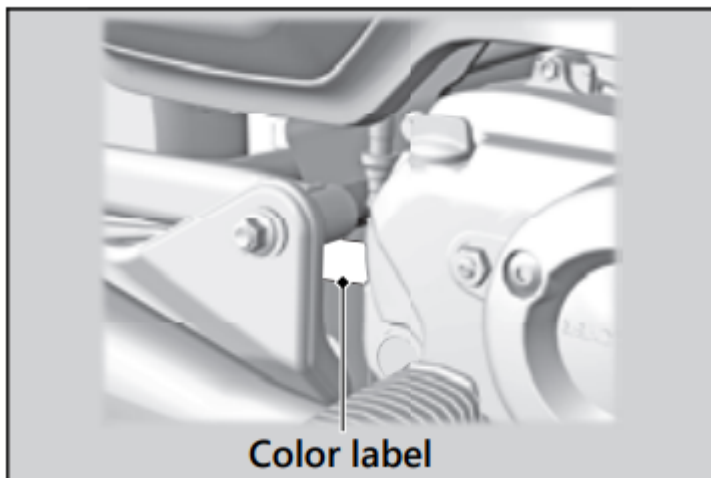

Battery

Your vehicle has a maintenance-free type battery. You do not have to check the battery electrolyte level or add distilled water. Clean the battery terminals if they become dirty or corroded. Do not remove the battery cap seals. There is no need to remove the cap when charging.

NOTICE An improperly disposed of battery can be harmful to the environment and human health. Always confirm local regulations for proper battery disposal instruction.

What to do in an emergency

If any of the following occur, immediately see your doctor.

Electrolyte splashes into your eyes:

- Wash your eyes repeatedly with cool water for at least 15 minutes. Using water under pressure can damage your eyes.

Electrolyte splashes onto your skin:

- Remove affected clothing and wash your skin thoroughly using water.

Electrolyte splashes into your mouth:

- Rinse mouth thoroughly with water, and do not swallow.

WARNING The battery gives off explosive hydrogen gas during normal operation. A spark or flame can cause the battery to explode with enough force to kill or seriously hurt you. Wear protective clothing and a face shield, or have a skilled mechanic do the battery servicing.

WARNING: Battery posts, terminals, and related accessories contain lead and lead compounds.

Wash your hands after handling.

Cleaning the Battery Terminals

1. Remove the battery. P. 78
2. If the terminals are starting to corrode and are coated with a white substance, wash with warm water and wipe clean.
3. If the terminals are heavily corroded, clean and polish the terminals with a wire brush or sandpaper. Wear safety glasses.
4. After cleaning, reinstall the battery.

The battery has a limited life span. Consult your dealer about when you should replace the battery. Always replace the battery with another maintenance-free battery of the same type.

Charging

If you use electrical accessories that drain the battery or you do not ride frequently, we recommend that you charge the battery every 30 days using a charger designed specifically for your Honda, which can be purchased from your dealer. Read the information that came with your battery charger and follow the instructions on the battery. Avoid using an automobile-type battery charger, as these can overheat a motorcycle battery and cause permanent damage. Make sure the ignition switch is in the OFF position before charging the battery.

NOTICE Improper charging can damage the battery. If you can't charge the battery or it appears unable to hold a charge, contact your dealer.

NOTICE Jump starting using an automobile battery can damage your vehicle's electrical system and is not recommended. Bump starting is also not recommended.

NOTICE Installing non-Honda electrical accessories can overload the electrical system, discharging the battery and possibly damaging the system.

Fuses

Fuses protect the electrical circuits on your vehicle. If something electrical on your vehicle stops working, check for and replace any blown fuses. P. 108

Inspecting and Replacing Fuses

Turn the ignition switch to the OFF position to remove and inspect fuses. If a fuse is blown, replace with a fuse of the same rating. For fuse ratings, see “Specifications.” P. 137

NOTICE Replacing a fuse with one that has a higher rating greatly increases the chance of damage to the electrical system.

If a fuse fails repeatedly, you likely have an electrical fault. Have your vehicle inspected by your dealer.

Engine Oil

Engine oil consumption varies and oil quality deteriorates according to riding conditions and time elapsed. Check the engine oil level regularly, and add the recommended engine oil if necessary. Dirty oil or old oil should be changed as soon as possible.

Selecting the Engine Oil

For recommended engine oil, see “Specifications.” P. 136

If you use non-Honda engine oil, check the label to make sure that the oil satisfies all of the following standards:

- JASO T 903 standard*1: MA
- SAE standard*2: 10W-30
- API classification*3: SG or higher

*1. The JASO T 903 standard is an index for engine oils for 4-stroke motorcycle engines. There are two classes: MA and MB. For example, the following label shows the MA classification.

*2. The SAE standard grades oils by their viscosity.

*3. The API classification specifies the quality and performance rating of engine oils. Use SG or higher oils, excluding oils marked as “Energy Conserving” or “Resource Conserving” on the circular API service symbol.

Cleaning and Lubricating

After inspecting the slack, clean the chain and sprockets while rotating the rear wheel. Use a dry cloth with high flash-point solvent. Use a soft brush if the chain is dirty. After cleaning, wipe dry and lubricate with the recommended lubricant

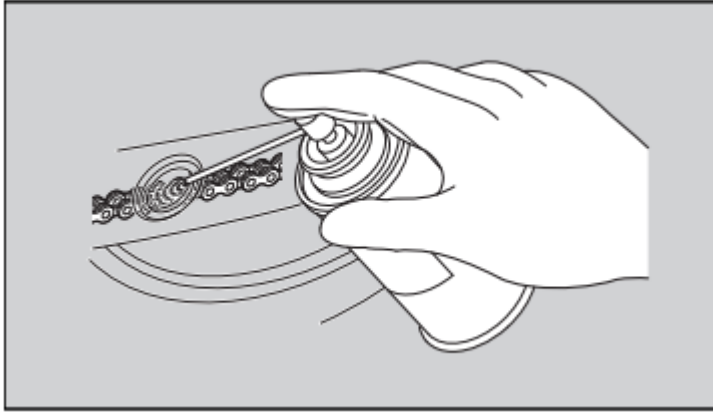

Never use gasoline or low flash point solvents for cleaning the drive chain.

A fire or explosion could result.

Avoid getting lubricant on the brakes or tires.

Avoid applying excess chain lubricant to prevent spray onto your clothes and the vehicle.

Crankcase Breather

Service more frequently when riding in rain, at full throttle, or after the vehicle is washed or overturned. Service if the deposit level can be seen in the transparent section of the drain tube.

If the drain tube overflows, the air filter may become contaminated with engine oil causing poor engine performance.

Removing & Installing Body Components

Battery

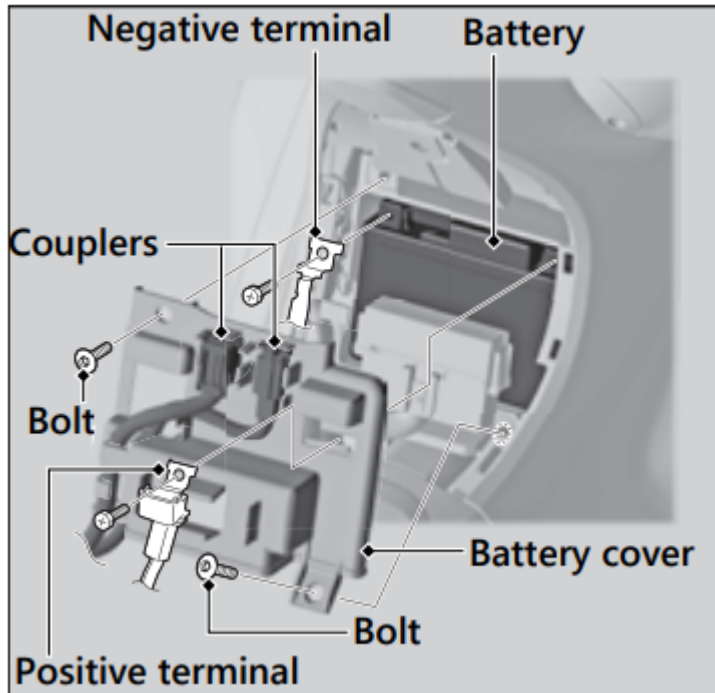

Removal

Make sure the ignition switch is in the OFF position.

1. Remove the center cover. P. 80
2. Remove the couplers from the battery cover.
3. Move the battery cover upward by removing the bolts.
4. Disconnect the negative - terminal from the battery.
5. Disconnect the positive + terminal from the battery.
6. Remove the battery cover.
7. Remove the battery, taking care not to drop the terminal nuts.

Installation

Install the parts in the reverse order of removal. Always connect the positive + terminal first. Make sure that bolts and nuts are tight.

Make sure the clock information is correct after the battery is reconnected. P. 23

The anti-theft alarm system will be deactivated if the battery is disconnected.

The system will remain off when the battery is reconnected.

To activate the system, see "Setting the Antitheft Alarm System." P. 38

For proper handling of the battery, see

"Maintenance Fundamentals." P. 67

"Battery Goes Dead." P. 107

Engine Oil

Checking the Engine Oil

1. If the engine is cold, idle the engine for 3 to 5 minutes.
2. Turn the ignition switch to the OFF position and wait for 2 to 3 minutes.
3. Place your vehicle on its center stand on a firm, level surface.
4. Remove the oil fill cap/dipstick and wipe it clean.
5. Insert the oil fill cap/dipstick until it seats, but don't screw it in.
6. Check that the oil level is between the upper level and lower level marks on the oil fill cap/dipstick.
7. Securely install the oil fill cap/dipstick.

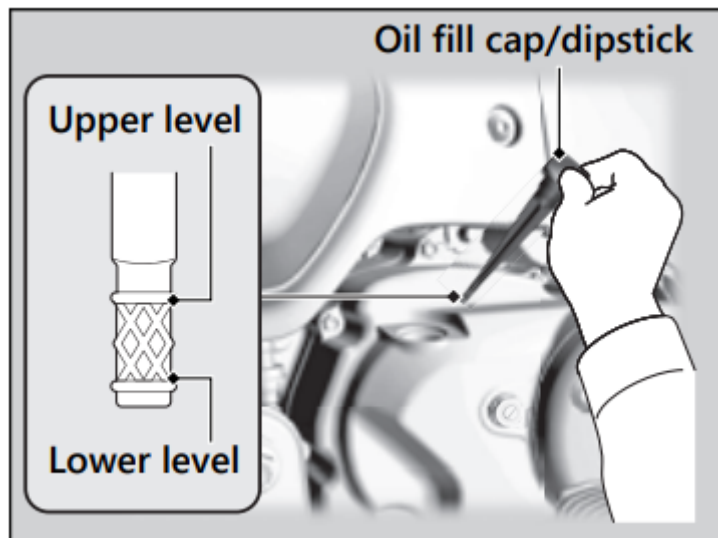

Adding Engine Oil

If the engine oil is below or near the lower level mark, add the recommended engine oil.

1. Remove the oil fill cap. Add the recommended oil until it reaches the upper level mark.
 - Place your vehicle on its center stand on a firm, level surface when checking the oil level.
 - Do not overfill above the upper level mark.
 - Make sure no foreign objects enter the oil filler opening.
 - Wipe up any spills immediately
2. Securely reinstall the oil fill cap.

NOTICE Overfilling with oil or operating with insufficient oil can cause damage to your engine. Do not mix different brands and grades of oil. They may affect lubrication and clutch operation.

For the recommended oil and oil selection guidelines, see “Maintenance Fundamentals.”

Brakes

Checking the Front Brake Fluid

1. Place your vehicle in an upright position on a firm, level surface.
2. Check that the brake fluid reservoir is horizontal and that the fluid level is above the LWR mark.

If the brake fluid level in the reservoir is below the LWR mark or the brake lever freeplay becomes excessive, inspect the brake pads for wear. If the brake pads are not worn, you most likely have a leak. Have your vehicle inspected by your dealer.

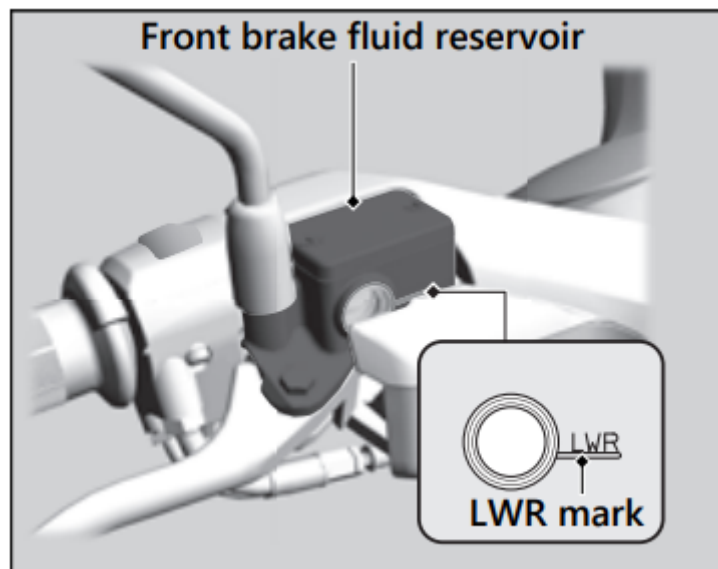

Inspecting the Front Brake Pads

Check the condition of the brake pad wear indicators. The pads need to be replaced if a brake pad is worn to the indicator. Inspect the brake pads from below the brake caliper.

If necessary have the pads replaced by your dealer. Always replace both left and right brake pads at the same time.

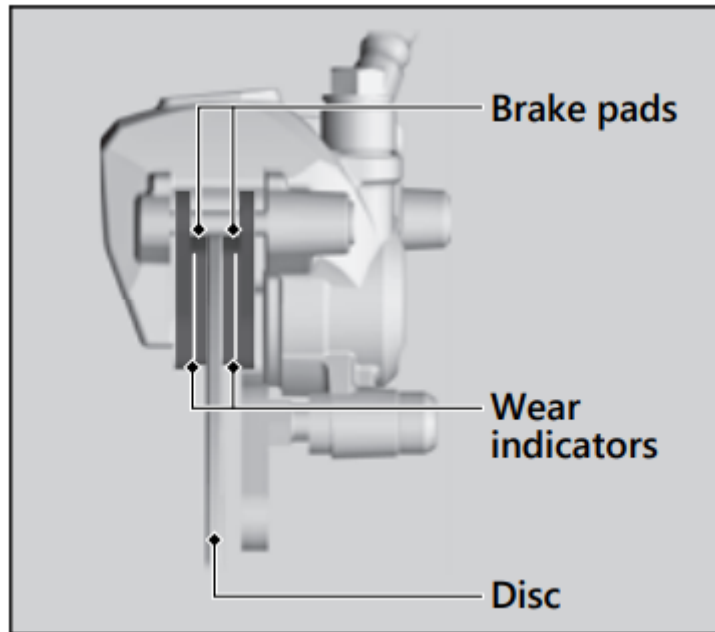

Drive Chain

Inspecting the Drive Chain Slack

Check the drive chain slack at several points along the chain. If the slack is not constant at all points, some links may be kinked and binding. Have the chain inspected by your dealer.

1. Shift the transmission to Neutral. Stop the engine.
2. Place your vehicle on its center stand on a firm, level surface.

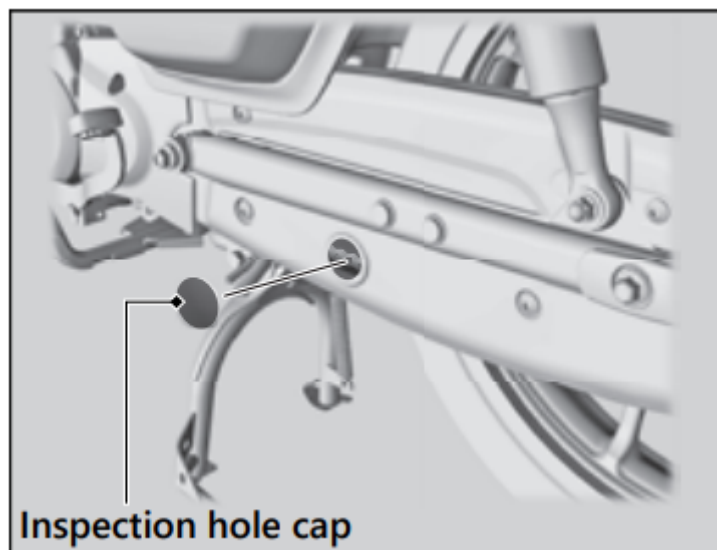

3. Remove the inspection hole cap.
4. Move the drive chain up and down with your finger.

Drive chain slack: 1.0 - 1.4 in (25 - 35 mm)

- Do not ride your vehicle if the slack exceeds $1 \frac{15}{16}$ in (50 mm).
5. Rotate the rear wheel and check that the chain moves smoothly.
 6. Remove the chain covers by removing the bolts.

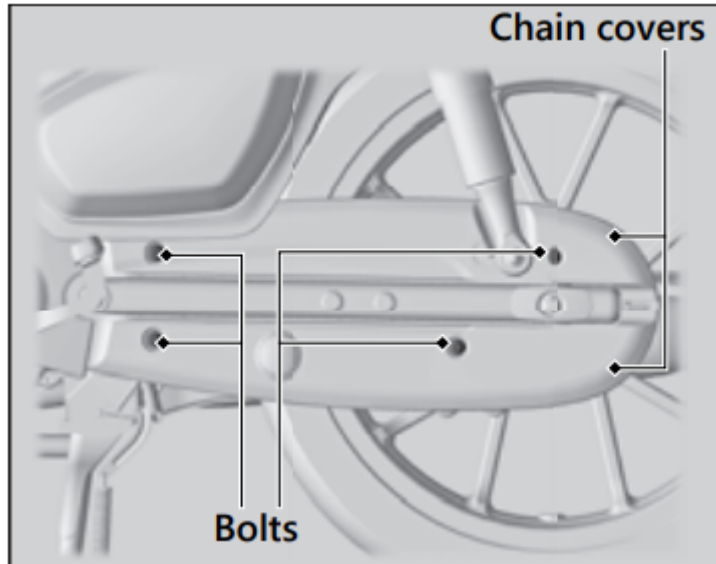

7. Inspect the sprockets
8. Clean and lubricate the drive chain.
9. Install the parts in the reverse order of removal.
10. Tighten the bolts.

Throttle

Checking the Throttle

With the engine off, check that the throttle rotates smoothly from fully closed to fully open in all steering positions and throttle freeplay is correct. If the throttle does not move smoothly, close automatically, or if the cable is damaged, have the vehicle inspected by your dealer.

Freeplay at the throttle grip flange: $\frac{1}{16}$ - $\frac{1}{4}$ in (2 - 6 mm)

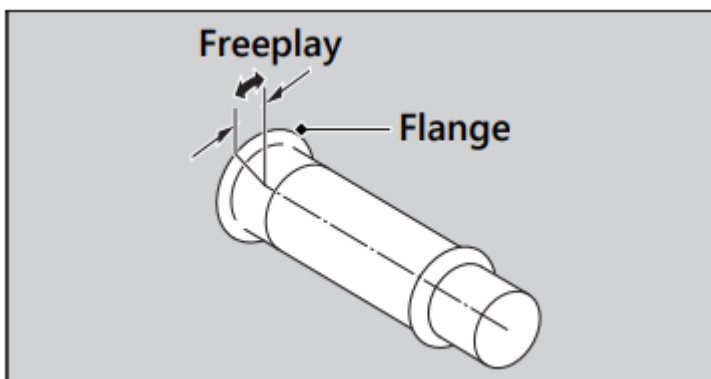

Troubleshooting

Engine Will Not Start

Starter Motor Operates But Engine Does Not Start

Check the following items:

- Check the correct engine starting sequence. P. 49
- Check that there is gasoline in the fuel tank.
- Check if the PGM-FI malfunction indicator lamp (MIL) is on.
- If the indicator lamp is on, contact your dealer as soon as possible.

Starter Motor Does Not Operate

Check the following items:

- Check the correct engine starting sequence.
- Make sure engine stop switch is in the (Run) position.
- Check for a blown fuse
- Check for a loose battery connection or battery terminal corrosion
- Check the condition of the battery.

If the problem continues, have your vehicle inspected by your dealer.

Warning Indicators On or Flashing

PGM-FI (Programmed Fuel Injection) Malfunction Indicator Lamp (MIL)

If the indicator comes on while riding, you may have a serious problem with the PGM-FI system. Reduce speed and have your vehicle inspected by your dealer as soon as possible.

ABS (Anti-lock Brake System) Indicator

If the indicator operates in one of the following ways, you may have a serious problem with the ABS. Reduce your speed and have your vehicle inspected by your dealer as soon as possible.

- Indicator comes on or starts flashing while riding.
- Indicator does not come on when the ignition switch is in the ON position.
- Indicator does not go off at speeds above 6 mph (10 km/h).

If the ABS indicator stays on, your brakes will continue to work as a conventional system, but without the anti-locking function.

The ABS indicator may flash if you turn the rear wheel while the rear wheel is lifted off the ground. In this case, turn the ignition switch to the OFF position, and then to the ON position again. The ABS indicator will go off after your speed reaches 19 mph (30 km/h).

Honda SMART Key Indicator

When the Honda SMART Key indicator flashes 5 times

- Replacing the Honda SMART Key Battery P. 92

If the Honda SMART Key indicator is flashing rapidly while the ignition switch is in the ON position

Start the engine by the normal procedure after pressing the ignition switch again. P. 49

When the Honda SMART Key indicator is flashing while the ignition switch is in the ON position

The Honda SMART Key indicator flashes when communication between your vehicle and Honda SMART Key stops after turning the ignition switch to the ON position. It is probably caused by the following:

- Strong radio waves or noise are affecting the system
- You lose the Honda SMART Key while riding

However, this does not affect the operation of your vehicle until the ignition switch is locked.

If you turn the ignition switch to the OFF or (Lock) position while the Honda SMART Key indicator is flashing, the ignition switch ring, Honda SMART Key indicator will flash faster, and the buzzer will ring for about 20 seconds, automatically go off, and then the ignition switch will lock.

- Turn signals blink at the beginning and end of this function.

Also, to stop this flashing and ringing, press and hold the ignition switch for more than 2 seconds. After the flashing and ringing stop, the ignition switch is locked. If you do not have the Honda SMART Key, the ignition switch can be unlocked in another way. P. 103

Other Warning Indications

Fuel Gauge Failure Indication

If the fuel system has an error, the fuel gauge indicators will be displayed as shown in the illustration. If this occurs, see your dealer as soon as possible.

When the Honda SMART Key System Does Not Operate Properly

When the Honda SMART Key system does not work properly, perform the following.

- Check that the Honda SMART Key system is activated. Lightly push the ON/OFF button on the Honda SMART Key. If the Honda SMART Key LED is red, activate the Honda SMART Key system. P. 30

If the Honda SMART Key LED does not respond, replace the battery

- Check that there is no communication failure in the Honda SMART Key system. The Honda SMART Key system uses lowintensity radio waves. The Honda SMART Key system may not work properly in the following conditions:
 - When there are facilities nearby that generate strong radio waves or noise such as TV towers, power stations, radio stations, or airports
 - When you carry the Honda SMART Key with a laptop or wireless communication device such as a radio or mobile phone.
 - When the Honda SMART Key comes into contact with or is covered by metal objects.
- Check that a registered Honda SMART Key is used. Use a registered Honda SMART Key. The Honda SMART Key system cannot be activated without a registered Honda SMART Key.
- Make sure that you do not use a broken Honda SMART Key. If you use a broken Honda SMART Key, the Honda SMART Key system cannot be activated. Bring the ID tag to your dealer.
- Check the battery condition and battery lead in your vehicle. Check the battery and battery terminals. If the battery is weak, contact your dealer.

If the Honda SMART Key system cannot be activated due to other causes, contact your dealer.

Unlock the Ignition Switch in an Emergency

Set up to ID number input mode

1. Press and hold the ignition switch for more than 4 seconds.
 1. The ignition switch ring and the Honda SMART Key indicator flash for 5 seconds.
2. Check the ID number on the ID tag.
3. Press the ignition switch within 5 seconds when the ignition switch ring and the Honda SMART Key indicator are flashing.
 - The ignition switch ring and the Honda SMART Key indicator stay lit, and the buzzer rings. And then the ID number input mode turns on.



ID number input

You can input your ID number by pressing the ignition switch when the ignition switch is OFF or (Lock) position. Input the ID number on the ID tag in order from the left in turn by pressing the ignition switch. The ID number is authenticated according to the number of times the ignition switch is pushed.

Push the ignition switch the desired number of times within 5 seconds when the ignition switch ring and the Honda SMART Key indicator come on. After 5 seconds, the buzzer rings once, the ignition switch ring and the Honda SMART Key indicator go off and come on again. This means that the inputted number is fixed, and you can input the next number.

- If the ignition switch ring does not come on in blue, the battery may be low. Contact your dealer.

Example:

- To input “0”, wait for 5 seconds without pushing the ignition switch when the ignition switch ring comes on.
- To input “1”, push the ignition switch once within 5 seconds when the ignition switch ring comes on.

ID number input success

After the last ID number is input, the ignition switch ring and the Honda SMART Key indicator come on, the buzzer rings twice.

- Turn the ignition switch to the ON position within 6 minutes. You can start the engine.
- You can also open the seat by pressing the seat open button.

To lock the ignition switch, turn the ignition switch to the OFF, or  (Lock) position, and press and hold the ignition switch for more than 2 seconds.

The ignition switch also locks automatically when the ignition switch has been in the OFF, or  (Lock) position for about 6 minutes.

When the ignition switch is locked, the ignition switch ring and the Honda SMART Key indicator go off, the buzzer rings once, and the turn signals flash once.

To unlock the ignition switch again, redo the “Unlock the Ignition Switch in an Emergency” procedure using the ignition switch.

ID number input failure

After the last ID number is input, the ignition switch ring and the Honda SMART Key indicator flash 3 times, the buzzer rings once, and then goes off.

The ignition switch does not unlock. Redo the “Unlock the Ignition Switch in an Emergency” procedure. P. 103

ID number input cancel

If you make a mistake while inputting your ID, do one of the following:

- Press and hold the ignition switch until the buzzer rings once, the ignition switch ring and the Honda SMART Key indicator turn off.
- Do not press the ignition switch, just wait for the ignition switch ring and the Honda SMART Key indicator to turn off.

Redo the “Unlock the Ignition Switch in an Emergency” procedure

Tire Puncture

Repairing a puncture or removing a wheel requires special tools and technical expertise. We recommend you have this type of service performed by your dealer. After an emergency repair, always have the tire inspected/replaced by your dealer.

Emergency Repair Using a Tire Repair Kit

If your tire has a minor puncture, you can make an emergency repair using a tubeless tire repair kit. Follow the instructions provided with the emergency tire repair kit. Riding your vehicle with a temporary tire repair is very risky. Do not exceed 30 mph (50 km/h). Have the tire replaced by your dealer as soon as possible.

WARNING Riding your vehicle with a temporary tire repair can be risky. If the temporary repair fails, you can crash and be seriously injured or killed. If you must ride with a temporary tire repair, ride slowly and carefully and do not exceed 30 mph (50 km/h) until the tire is replaced.

Electrical Trouble

Battery Goes Dead

Charge the battery using a motorcycle battery charger. Remove the battery from the vehicle before charging. Do not use an automobile-type battery charger, as these can overheat a motorcycle battery and cause permanent damage. If the battery does not recover after recharging, contact your dealer.

NOTICE Jump starting using an automobile battery can damage your vehicle's electrical system and is not recommended. Bump starting is also not recommended.

Burned-out Light Bulb

All light bulbs on the vehicle are LEDs. If there is an LED which is not turned on, see your dealer for servicing.

Blown Fuse

Before handling fuses, see “Inspecting and Replacing Fuses.” P. 66

Fuse Box Fuses

1. Remove the center cover.
2. Remove the battery cover.
3. Remove the fuse box cover.
4. Pull the fuses out one by one with the fuse puller in the tool kit and check for a blown fuse. Always replace a blown fuse with a spare fuse of the same rating.
 - Fuse puller and spare fuses are provided on the back side of the fuse box cover
5. Reinstall the fuse box cover.
6. Reinstall the battery cover.
7. Reinstall the center cover.

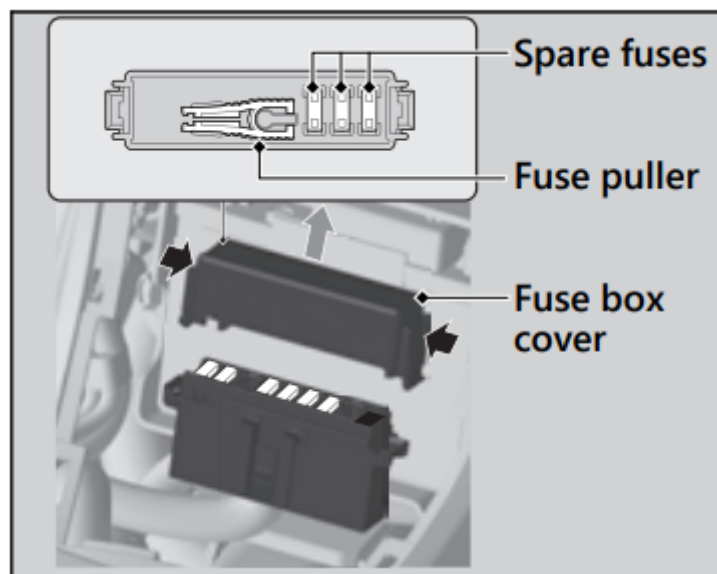

NOTICE If a fuse fails repeatedly, you likely have an electrical problem. Have your vehicle inspected by your dealer.

Unstable Engine Operation Occurs Intermittently

If the fuel pump filter is clogged, unstable engine operation will occur intermittently while riding.

Even if this symptom occurs, you can continue to ride your vehicle.

If unstable engine operation occurs even if sufficient fuel is available, have your vehicle inspected by your dealer as soon as possible.

Information

Keys

Honda SMART Key

Carrying the Honda SMART Key allows you to perform the following operations:

- Locking or unlocking the ignition switch
- Releasing the seat lock
- Locking or unlocking the steering

The ID number of the Honda SMART Key is on the ID tag. You can also unlock the ignition switch by inputting the ID number.

Always carry the ID tag, but separate from the Honda SMART Key, to avoid losing both of them at the same time.

Also store a copy of your ID number in a safe place other than your vehicle.

The Honda SMART Key contains electronic circuits. If the circuits are damaged, the Honda SMART Key will not allow you to perform any operations.

- Do not drop the Honda SMART Key or set heavy objects on it.
- Protect the Honda SMART Key from direct sunlight, high temperature, and high humidity.
- Do not scratch or puncture.
- Do not store near any magnetized products such as a magnetized key chain.
- Always keep the Honda SMART Key away from electric appliances such as a TV, radio, PC or low-frequency massage device.
- Keep the Honda SMART Key away from liquids. If it gets wet, dry it immediately with a soft cloth.
- Keep the Honda SMART Key away from the vehicle while washing the vehicle.
- Do not burn.
- Do not wash in an ultrasonic cleaner.
- If fuel, wax, or grease adhere to the Honda SMART Key, wipe it off immediately to avoid cracking or warping.
- Do not disassemble the Honda SMART Key other than when changing a battery. Only the cover of the Honda SMART Key can be disassembled. Do not disassemble other parts.
- Do not lose your Honda SMART Key. If you lose it, you will need to register a new

Honda SMART Key. See your dealer with your ID tag for registration.

The battery in the Honda SMART Key system normally lasts about 2 years.

Do not keep mobile phones or other radio transmitting devices in any compartment. The radio frequency from the devices will interrupt the Honda SMART Key system.

To get an additional Honda SMART Key, take the Honda SMART Key and the vehicle to your dealer.

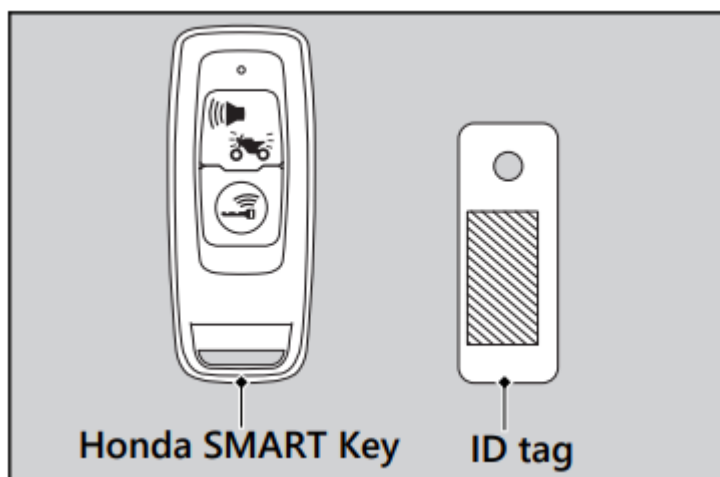

As required by the FCC: This device complies with Part 15 of the FCC Rules. Operation is subject to the following two conditions: (1) this device may not cause harmful interference, and (2) this device must accept any interference received, including interference that may cause undesired operation.

Changes or modifications not expressly approved by the party responsible for compliance could void the user's authority to operate the equipment.

Instruments, Controls, & Other Features

Ignition Switch

Leaving the ignition switch in the ON position with the engine stopped will drain the battery.

Do not turn the ignition switch while riding.

Engine Stop Switch

Do not use the engine stop switch except in an emergency. Doing so when riding will cause the engine to suddenly turn off, making riding unsafe.

If you stop the engine using the engine stop switch, turn the ignition switch to the OFF position. Failing to do so will drain the battery.

Odometer

The display locks at 999,999 when the read-out exceeds 999,999.

Tripmeter

The tripmeters return to 0.0 when each readout exceeds 9,999.9.

Document Bag

The owner's manual, registration, and insurance information can be stored in the plastic document bag behind the right side cover.

High Beam Indicator

If the engine is stopped with the high beam on, and the ignition switch is then turned to the ON position immediately afterwards, the high beam indicator will come on briefly due to the capacitor being discharged.

Headlight

If the engine is stopped with the high beam on, and the dimmer switch is operated immediately afterwards, the headlight will come on briefly due to the capacitor being discharged.

Caring for Your Vehicle

Frequent cleaning and polishing is important to ensure the life of your Honda. A clean vehicle makes it easier to spot potential problems.

In particular, seawater and salts used to prevent ice on roads promote the formation of corrosion. Always wash your vehicle thoroughly after riding on coastal or treated roads.

Washing

Allow the engine, muffler, brakes, and other high-temperature parts to cool before washing.

1. Rinse your vehicle thoroughly using a low pressure garden hose to remove loose dirt.
2. If necessary, use a sponge or a soft towel with mild cleaner to remove road grime.
 - Clean the headlight lens, panels, and other plastic components with extra care to avoid scratching them. Avoid directing water into the air cleaner, muffler, and electrical parts.
3. Thoroughly rinse your vehicle with plenty of clean water and dry with a soft, clean cloth.
4. After the vehicle dries, lubricate any moving parts.
 - Make sure that no lubricant spills onto the brakes or tires. Brake discs, pads, drum or shoes contaminated with oil will suffer greatly reduced braking effectiveness and can lead to a crash.
5. Lubricate the drive chain immediately after washing and drying the vehicle.
6. Apply a coat of wax to prevent corrosion.
 - Avoid products that contain harsh detergents or chemical solvents. These can damage the metal, paint, and plastic on your vehicle. Keep the wax clear of the tires and brakes.
 - If your vehicle has any matte painted parts, do not apply a coat of wax to the matte painted surface.

Washing Precautions

Follow these guidelines when washing:

- Do not use high-pressure washers:
 - High-pressure water cleaners can damage moving parts and electrical parts, rendering them inoperable.
 - Water in the air intake can be drawn into the throttle body and/or enter the air cleaner.
 - Do not direct water at the muffler:
- Water in the muffler can prevent starting and causes rust in the muffler.
- Dry the brakes:
 - Water adversely affects braking effectiveness. After washing, apply the brakes intermittently at low speed to help dry them.
- Do not direct water in the right side cover:
 - Water in the right side cover can damage your documents and other belongings.
- Do not direct water at the air cleaner:
 - Water in the air cleaner can prevent the engine from starting.
- Do not direct water near the headlight:
 - The headlight's inside lens may fog temporarily after washing or while riding in the rain. This does not impact the headlight function.

However, if you see a large amount of water or ice accumulated inside the lens(es), have your vehicle inspected by your dealer.

- Do not use wax or polishing compounds on matte painted surfaces:
 - Use a soft cloth or sponge, plenty of water, and a mild detergent to clean matte painted surfaces. Dry with a soft clean cloth.

Aluminum Components

Aluminum will corrode from contact with dirt, mud, or road salt. Clean aluminum parts regularly and follow these guidelines to avoid scratches:

- Do not use stiff brushes, steel wool, or cleaners containing abrasives.
- Avoid riding over or scraping against curbs.

Panels

Follow these guidelines to prevent scratches and blemishes:

- Wash gently using a soft sponge and plenty of water.

- To remove stubborn stains, use diluted detergent and rinse thoroughly with plenty of water.
- Avoid getting gasoline, brake fluid, or detergents on the instruments, panels, or headlight.

Exhaust Pipe and Muffler

The exhaust pipe and muffler are stainless steel but may become stained by mud or dust.

To remove mud or dust, use a wet sponge and a liquid kitchen abrasive, then rinse well with clean water. Dry with chamois or a soft towel.

If necessary, remove heat stains by using a commercially available fine texture compound.

Then, rinse by the same manner as removing mud or dust.

NOTICE Even though the exhaust is made of stainless steel, it can become stained. Remove all marks and blemishes as soon as they are noticed.

Storing Your Vehicle

If you store your vehicle outdoors, you should consider using a full-body cover.

If you won't be riding for an extended period, follow these guidelines:

- Wash your vehicle and wax all painted surfaces (except matte painted surfaces). Coat chrome pieces with rust-inhibiting oil.
- Lubricate the drive chain.
- Place your vehicle on its center stand and position a block so that both tires are off the ground.
- After rain, remove the body cover and allow the vehicle to dry.
- Remove the battery to prevent discharge. Fully charge the battery and then place it in a shaded, well-ventilated area.
 - If you leave the battery in place, disconnect the negative - terminal to prevent discharge.

After removing your vehicle from storage, inspect all maintenance items required by the Maintenance Schedule.

For more information about storage, refer to the Honda Winter Storage Guide, available from your dealer.

Transporting Your Vehicle

If your vehicle needs to be transported, it should be carried on a motorcycle trailer or a flatbed truck or trailer that has a loading ramp or lifting platform, and motorcycle tie-down straps. Never try to tow your vehicle with a wheel or wheels on the ground.

NOTICE Towing your vehicle with a wheel or wheels on the ground can cause serious damage to the transmission.

Warning

This content is compiled from multiple sources and is provided for reference purposes only. It may not be complete or fully applicable to all situations. If you are unable to resolve your issue, please contact the product manufacturer or an authorized service provider for official support.

Document generated by [ManualsFile](#)

