

# User Manual Digital Kitchen Scale

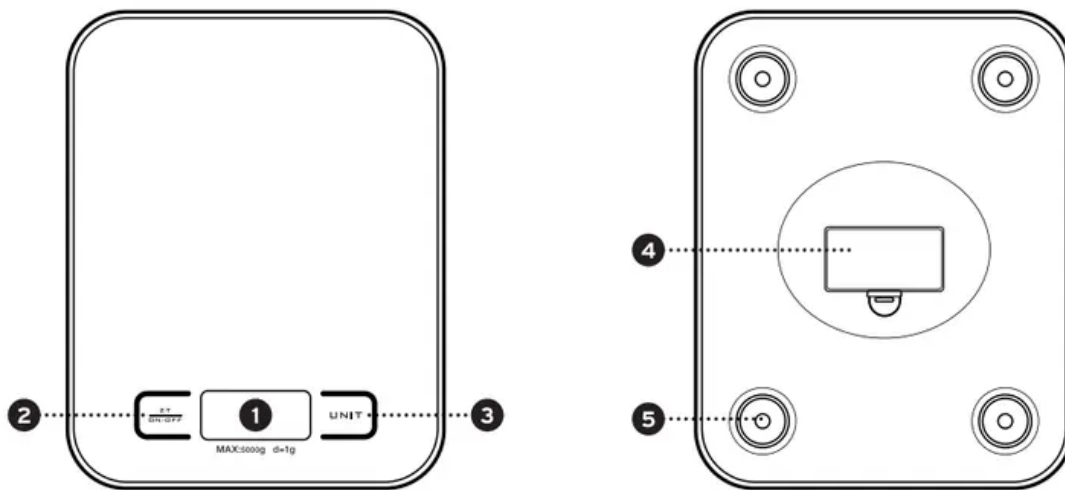

# Main Functions

## Function Diagram



1. LCD Display
2. Power / Auto-Tare
3. Unit Selection
4. Battery Compartment
5. Anti-Skid Padding

## Set-Up

- The included AAA batteries are preinstalled in the scale. Open the battery compartment cover located on the backside of the scale.

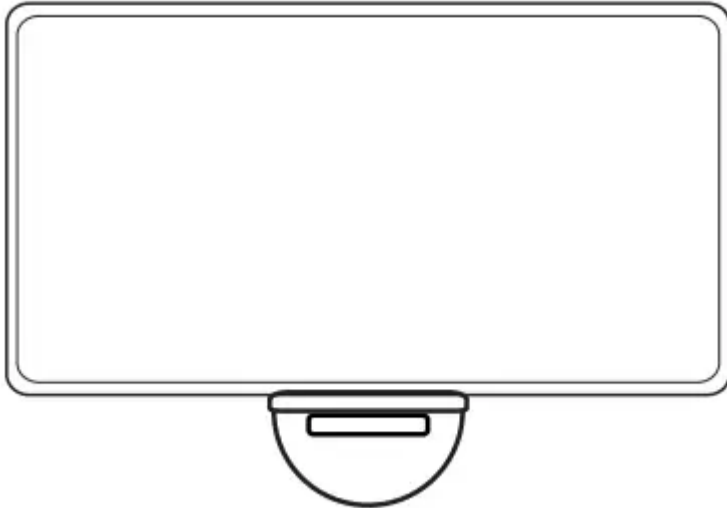

- Remove the plastic strip from the battery compartment to allow the batteries to power the device. Reapply the battery compartment cover.

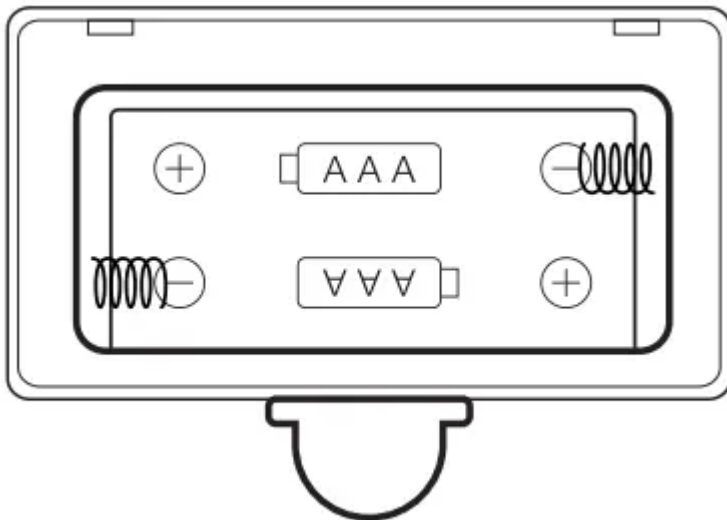

## Operation

### Normal Weighing Mode

1. Place the scale on a flat and level hard surface for measurement.
2. Press the "ON/OFF" button to turn on the scale. Wait until the screen displays zero before measuring.
3. Place the object of measurement on the center of the weighing platform.
4. Allow the scale to adjust to the weight of the object for a few seconds before it displays the final measured reading on the LCD screen.

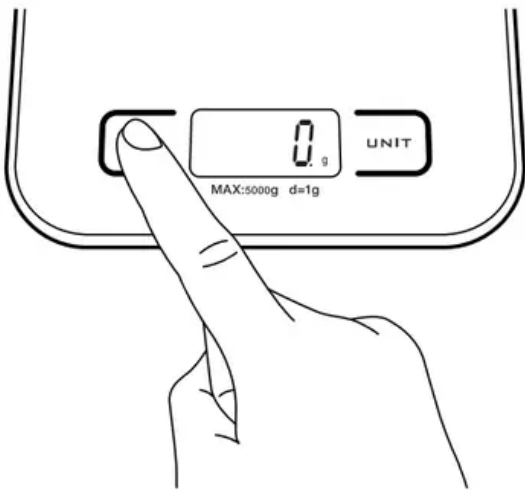

### Zero/Tare Function

The tare function allows the user to deduct the weight of a container from the total weight in order to determine the net weight of the contents excluding the weight of the container which holds them.

1. Turn on the scale and wait for the screen to display zero. If the screen does not display zero automatically, press the 'Z/T' button to auto-adjust to zero.
2. Place the desired object which is to be excluded, on the center of the measuring platform.
3. Press the 'Z/T' button to tare the current weight of the object. The screen should now display zero.
4. Place the desired item(s) to be weighed on the center of the measuring platform (or within the tared container to calculate the net weight of the desired item(s)).

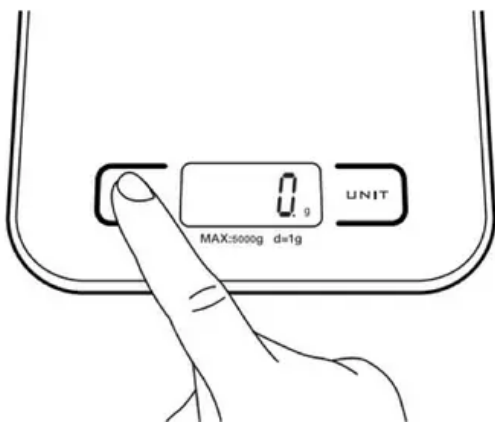

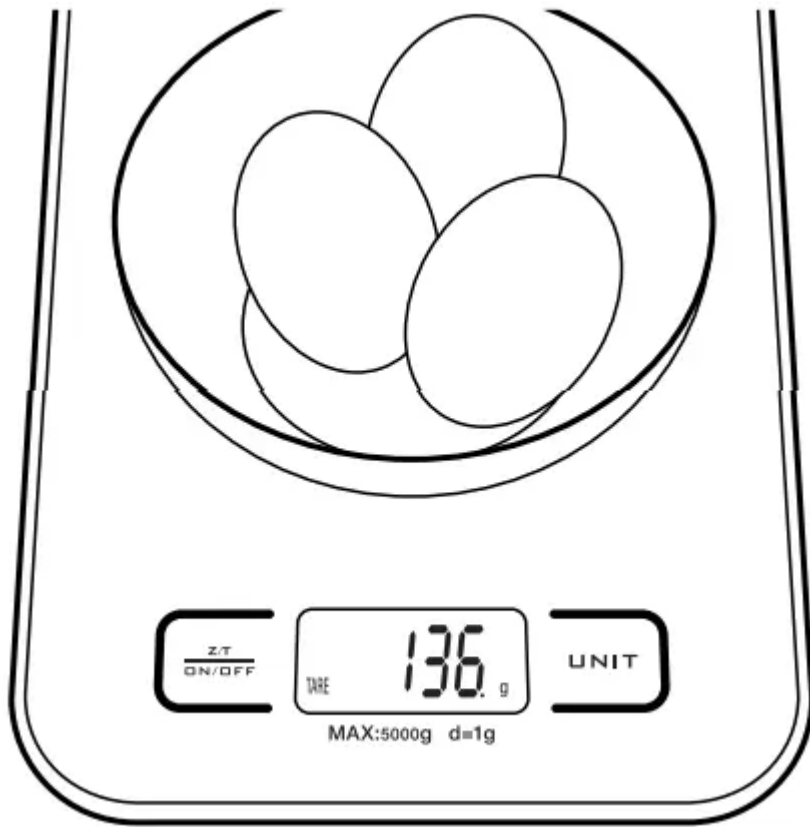

### Unit Conversion

To change the unit of measurement, press the UNIT' button until the LCD display indicates the desired unit of measurement.

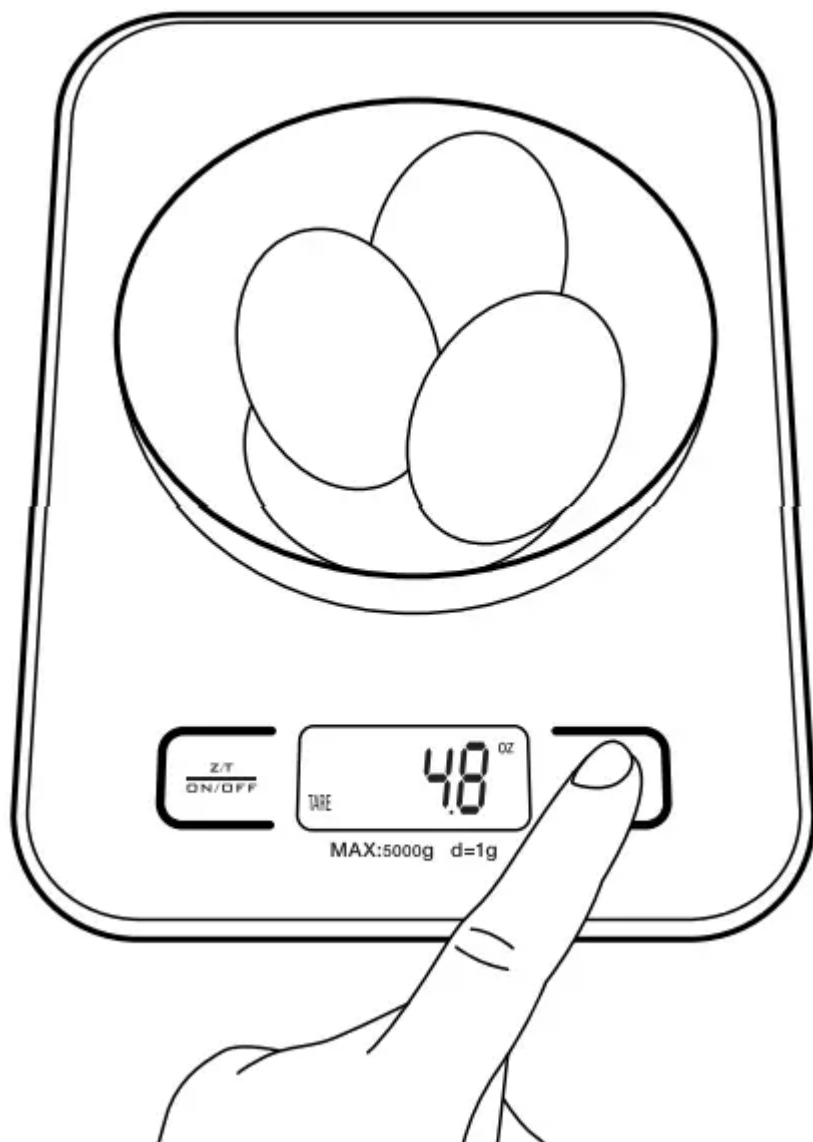

### **Automatic Power Off**

- For batterypower conservation, the display backlight will automatically power off after 20 seconds of inactivity.
- Additionally, the scale itself will automatically power off after 2 minutes of inactivity.

### **Manual Power Off**

Press and hold the 'ON/OFF' button for 2 seconds to manually turn off the digital scale at any time.

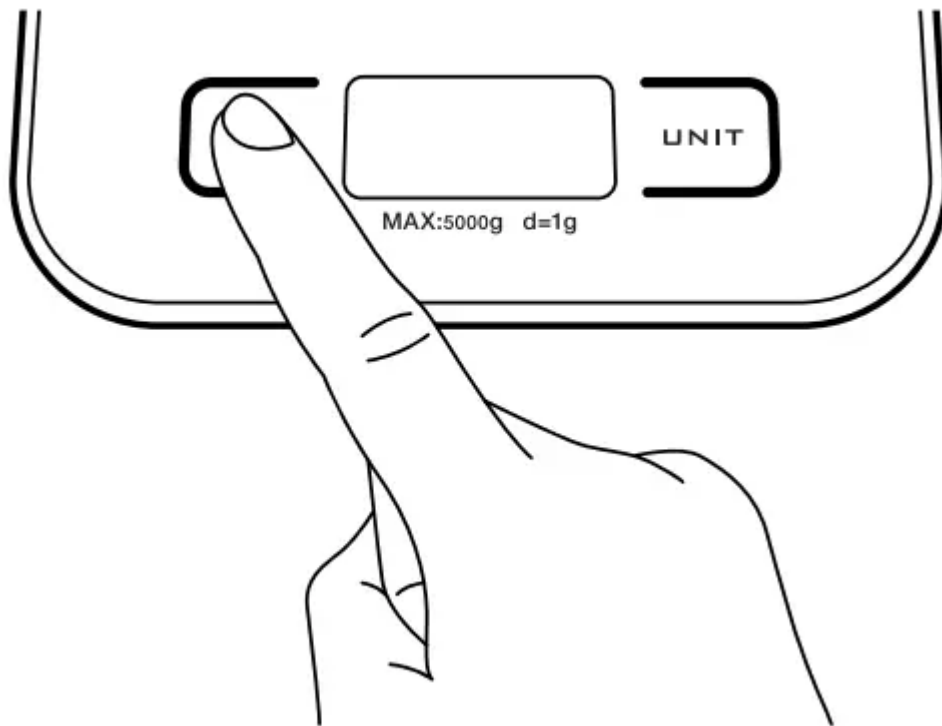

### **Battery Replacement**

1. Open the battery compartment cover on the backside of the scale.
2. Take out the used batteries and dispose them properly.
3. Install new AAA 15 V batteries, taking note of the correct polarity displayed in the battery compartment.
4. Reseal the battery compartment.

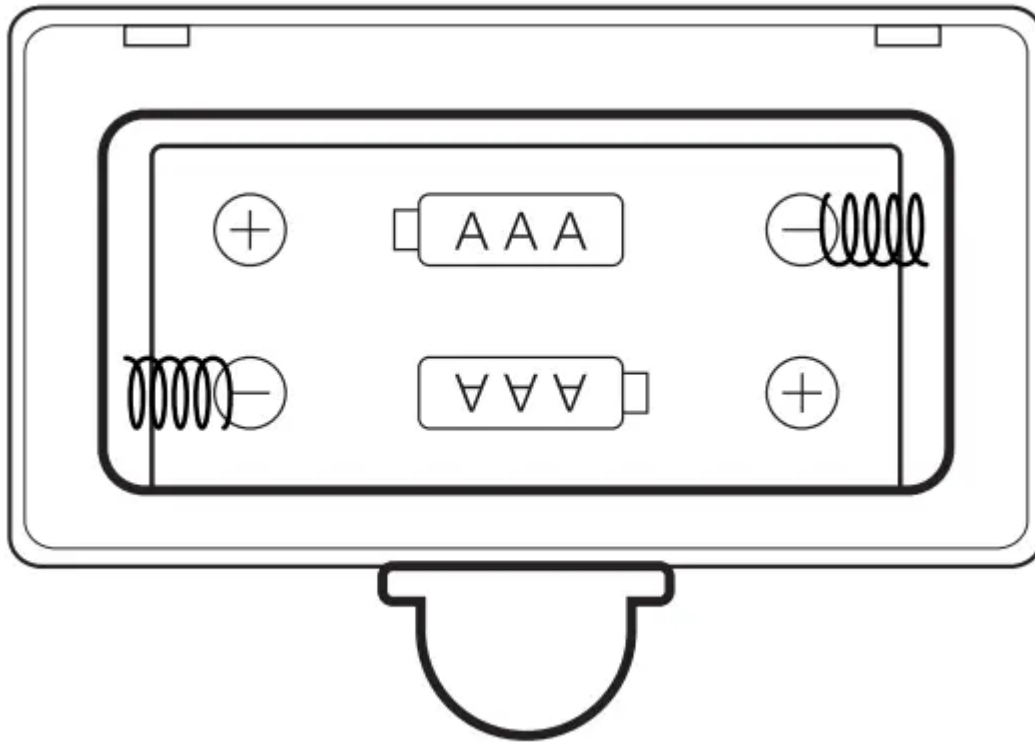

## Specifications

- Weight Capacity: 176 oz | 5000g | 11lbs
- Units: g|ml|oz|lb'oz
- Division Value: 0.010z | 1g
- Auto-Off: 2 minutes
- Power: 2x AAA15 V DC
- Dimensions: 180mm x 140mm x 18mm

## Package Contents

- 1x Digital Kitchen Scale
- 1x User Manual
- 2 x AAA 1.5 V DC batteries

## Troubleshooting

Message	Reason	Solution
"EEEE"	<ul style="list-style-type: none"><li>• Scale overload.</li><li>• Maximum weight capacity: 5,000g (176 oz).</li></ul>	<ul style="list-style-type: none"><li>• Remove the object from the scale to avoid damage</li></ul>
"Unuse"	<ul style="list-style-type: none"><li>• Calibration error.</li><li>• Unable to measure weight.</li></ul>	<ul style="list-style-type: none"><li>• Re-installed the batteries, and then put the scale on a flat surface immediately, keep weight stable when turning on scale.</li></ul>
	<ul style="list-style-type: none"><li>• Battery power is low.</li></ul>	<ul style="list-style-type: none"><li>• Install new batteries.</li></ul>

### Warning

This content is compiled from multiple sources and is provided for reference purposes only. It may not be complete or fully applicable to all situations. If you are unable to resolve your issue, please contact the product manufacturer or an authorized service provider for official support.