

## What's in the Box?

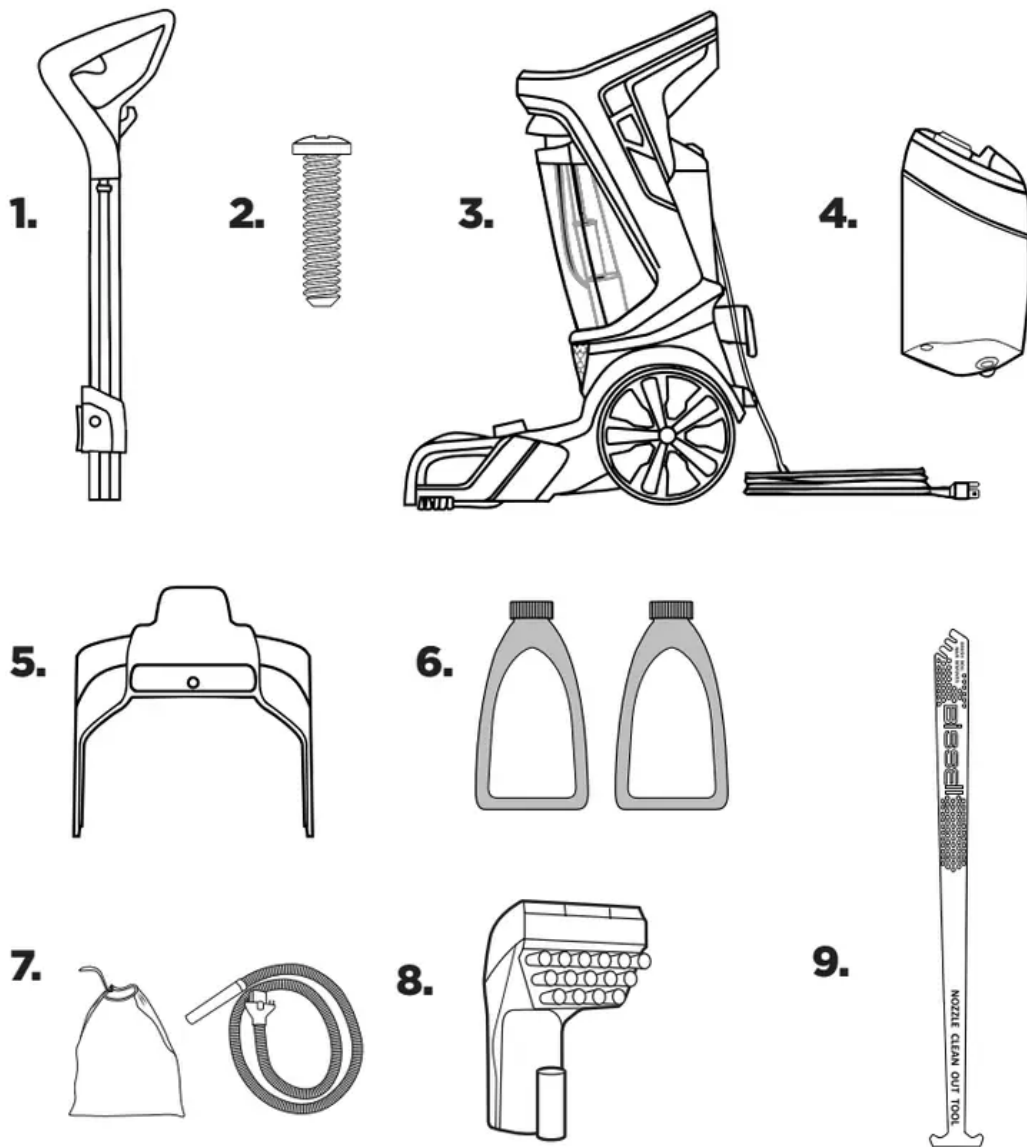

1. Upper Handle
2. 1 Screw attached to Upper Handle
3. Base with Dirty Water Tank
4. Clean Water Tank
5. Carry Handle
6. (2) Trial-Size Formulas
7. Accessory Bag & Hose
8. Attachments/Accessories (vary by model)

## 9. Nozzle Clean Out Tool

**NOTE:** Standard accessories may vary by model. To identify what should be included with your purchase, please refer to the "Carton Contents" list located on the carton top flap.

### Product View

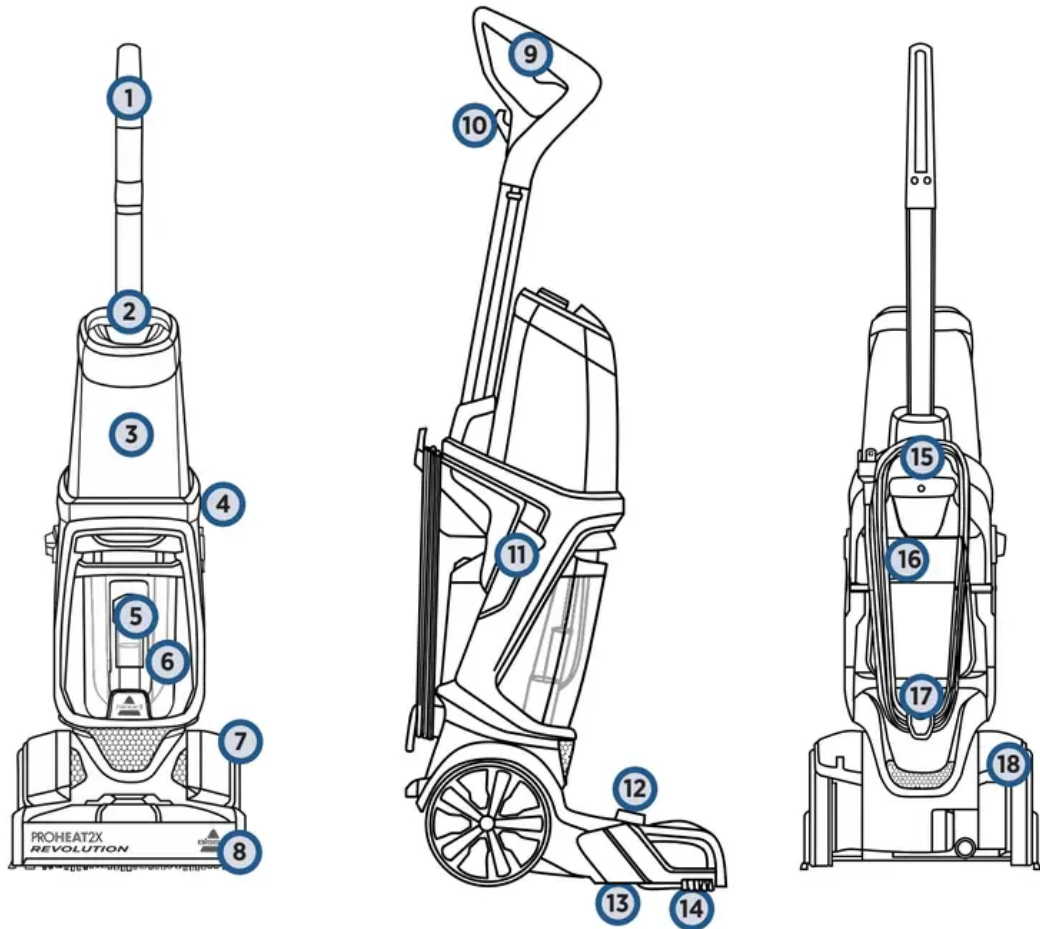

1. Upper Handle
2. Easy Fill/Formula Cap
3. Clean Water Tank (1 Gallon Capacity)
4. Power Switch
5. Float Stack
6. Dirty Water Tank
7. Belt Access Door
8. Foot
9. Spray Trigger
10. In-Use Cord Clip

11. Cleaning Mode Switch
12. Accessory Hose Door
13. Belt/Brush Access Plate
14. EdgeSweep® Brushes
15. Carry Handle
16. Rubber Tab (on Dirty Water Tank)
17. Quick Release™ Cord Wrap
18. Recline Pedal

## Assembly

**WARNING:** Do not plug in your deep cleaner until you are familiar with all instructions and operating procedures.

Your deep cleaner comes in four easy-to-assemble components and an accessory bag.

- Base
- Upper Handle
- Clean Water Tank
- Carry Handle

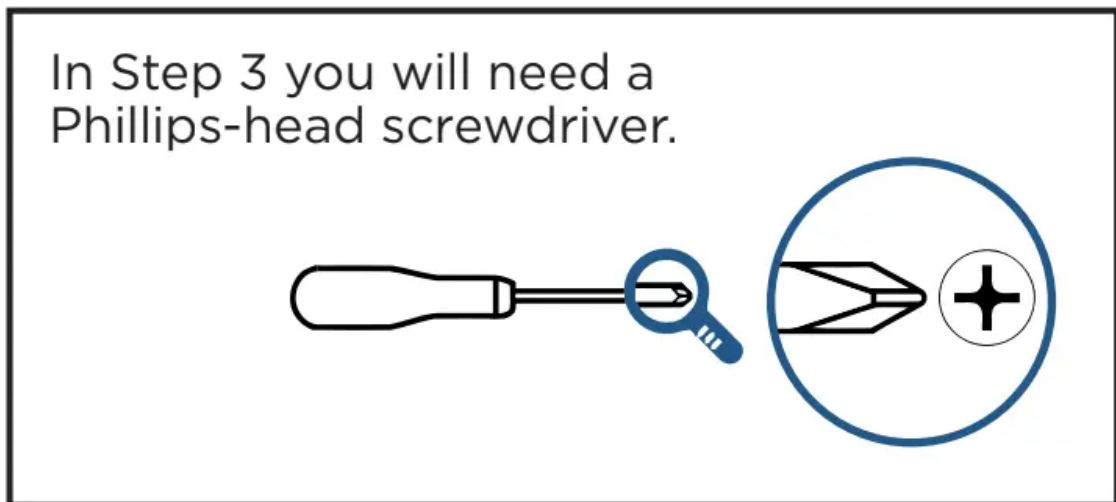

1

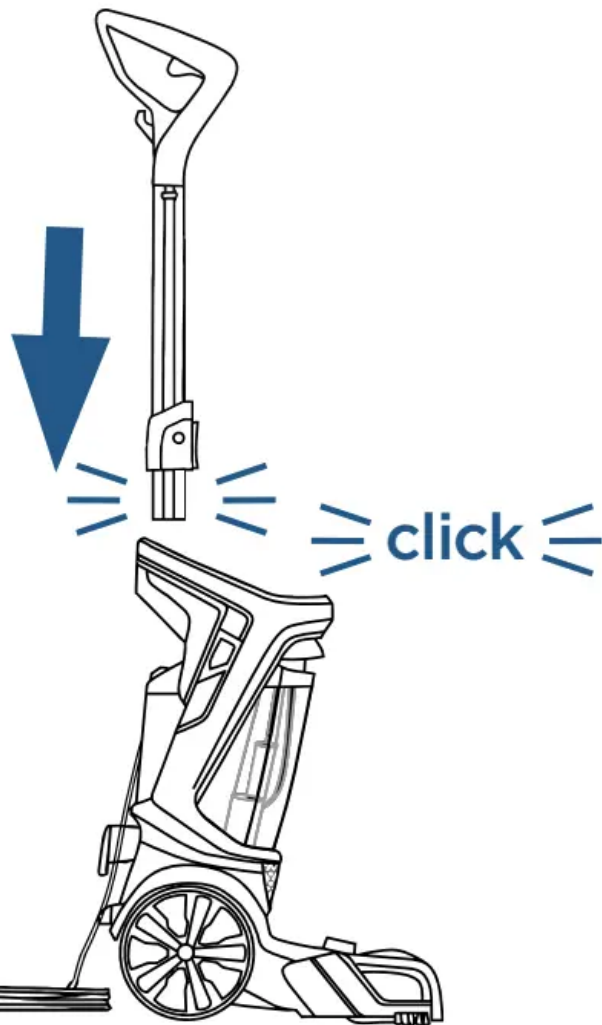

First, insert the Upper Handle at the top of the base until you hear a “click”.

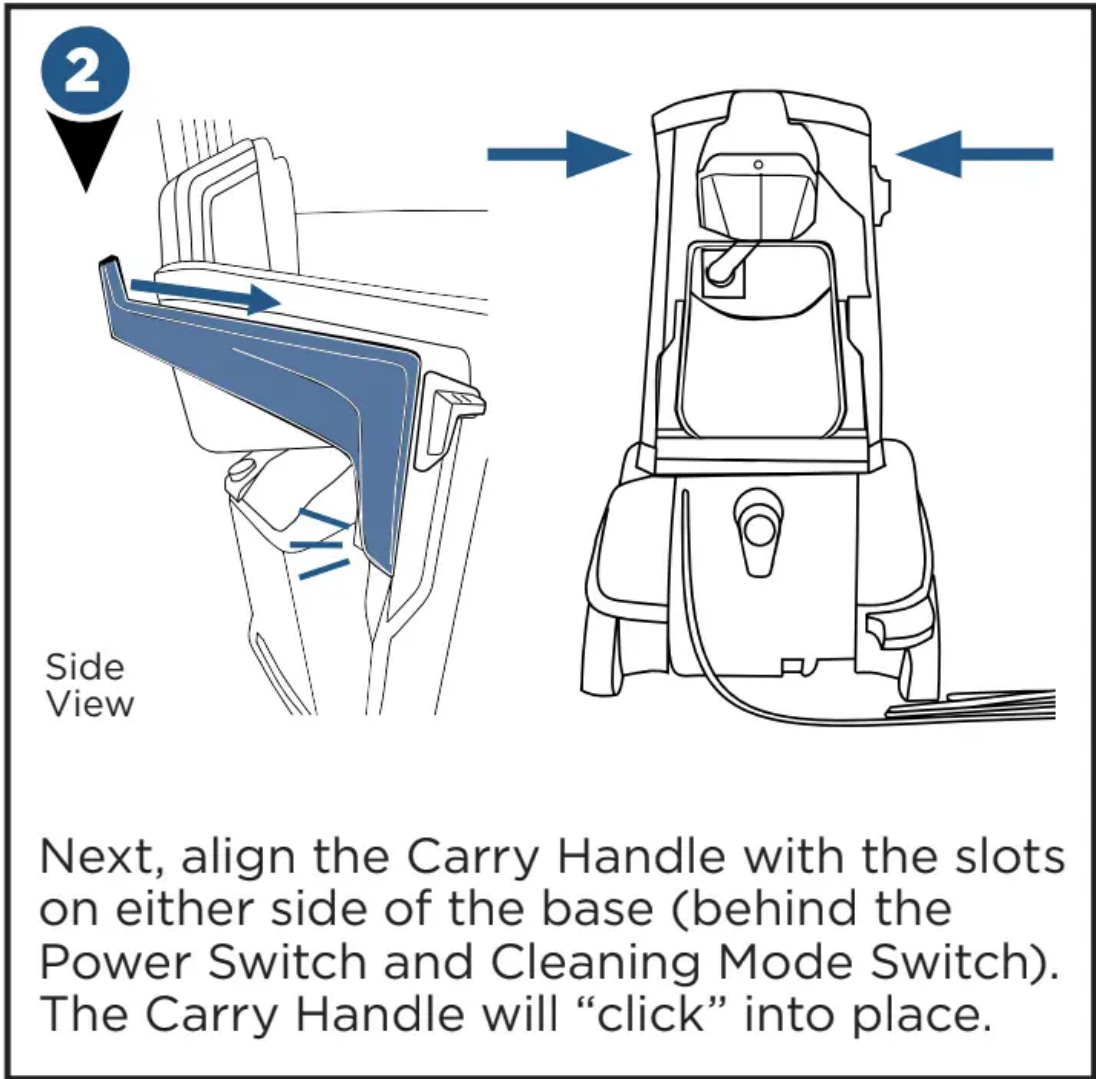

3

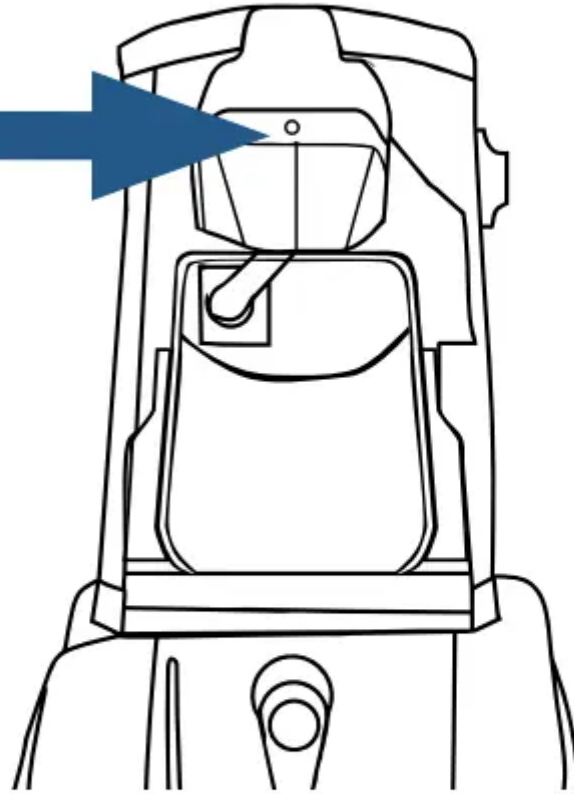
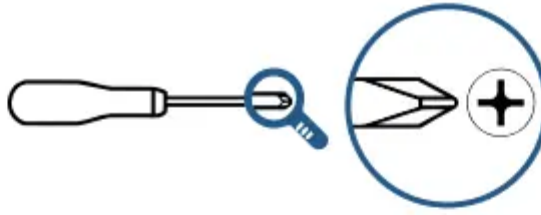

Using a Phillips-head screwdriver, secure the Carry Handle and the Upper Handle with the screw that's taped to the Upper Handle.

4

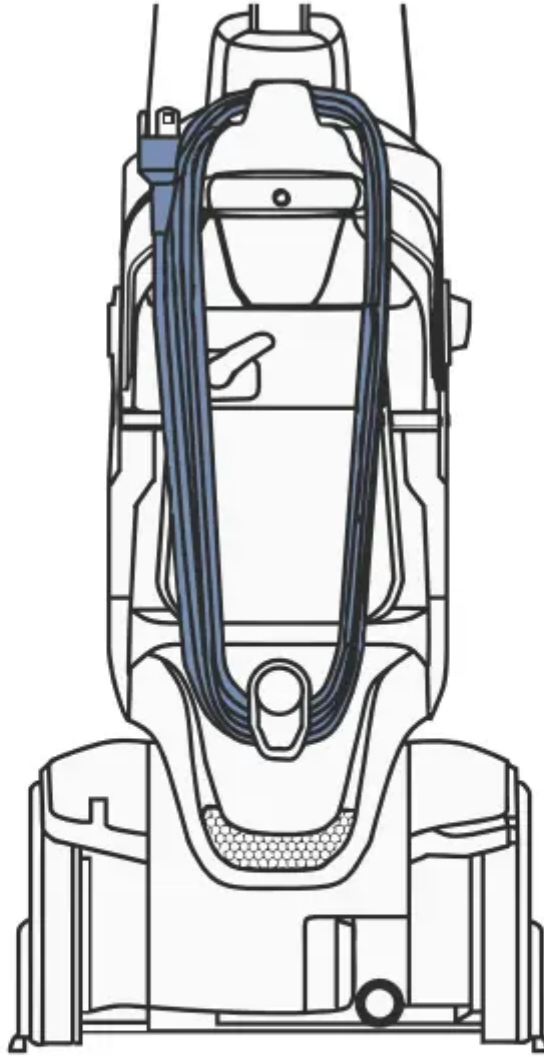

Wrap the cord around the Carry Handle and Quick Release™ Cord Wrap.



5

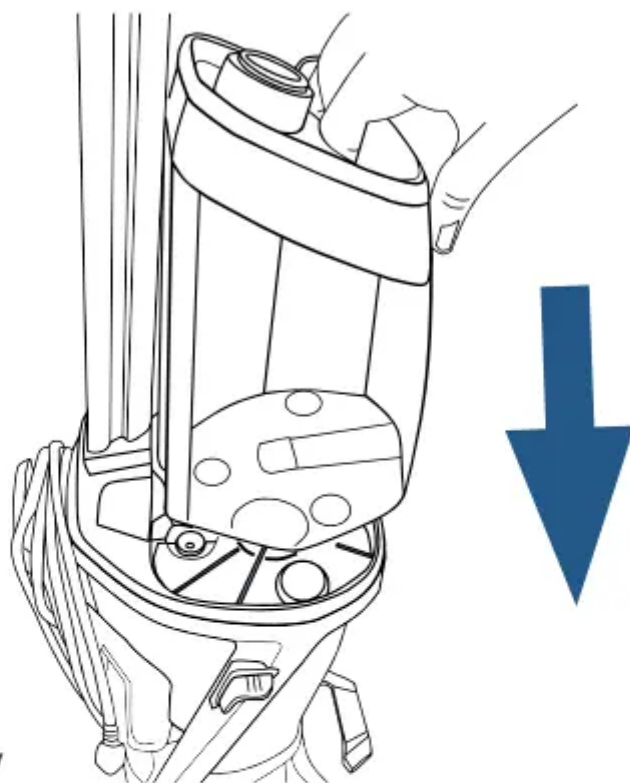

Side  
View

At the bottom of the Upper Handle, align the Clean Water Tank with the grooves and slide the tank into place.

### Cleaning Formula

**WARNING:** To reduce the risk of fire and electric shock due to internal component damage, use only BISSELL cleaning formula intended for use with this machine.

Keep plenty of BISSELL® cleaning formulas on hand so you can clean whenever it fits your schedule.

**NOTE:** Always use genuine BISSELL cleaning formulas for portable carpet and upholstery cleaners in your machine.

				
<p><b>Clean + Refresh</b> Powerful cleaning and odor elimination with Febreze freshness</p>	<p><b>PET Stain &amp; Odor</b> Removes tough pet stains <i>Includes StainProtect™ to protect against future stains</i></p>	<p><b>PRO MAX Clean + Protect</b> Our most powerful formula for tough, ground-in dirt &amp; stains <i>Includes StainProtect to protect against future stains</i></p>	<p><b>PET PRO OXY Urine Eliminator</b> Our best formula for pet urine stains &amp; odors <i>Includes StainProtect to protect against future stains</i></p>	<p><b>Pet Stain &amp; Odor + Antibacterial</b> Cleans and controls odor causing bacteria <i>Use with easy fill SYSTEM™</i></p>

Certain trademarks used under license from The Procter & Gamble Company or its affiliates.

### Pretreat

Pretreat spots and stains to improve carpet cleaning performance.

		
<p><b>PET Stain Pretreat</b> Permanently removes tough pet stains &amp; odors with Enzyme Action</p>	<p><b>PET PRO OXY Stain Destroyer</b> Permanently removes tough pet stains &amp; odors with OXY</p>	<p><b>PET Pretreat + Sanitize</b> Penetrates to sanitize and loosen tough stains</p>

### Boost

Add Boost carpet cleaning formula enhancers to any formula to increase its effectiveness.



		
<p><b>OXY Boost</b> Removes old, set-in stains permanently</p>	<p><b>PRO MAX Boost</b> Add to formula for 2X deep cleaning power</p>	<p><b>PET OXY Boost</b> Removes pet stains and odors permanently</p>

## Filling Your Clean Water Tank

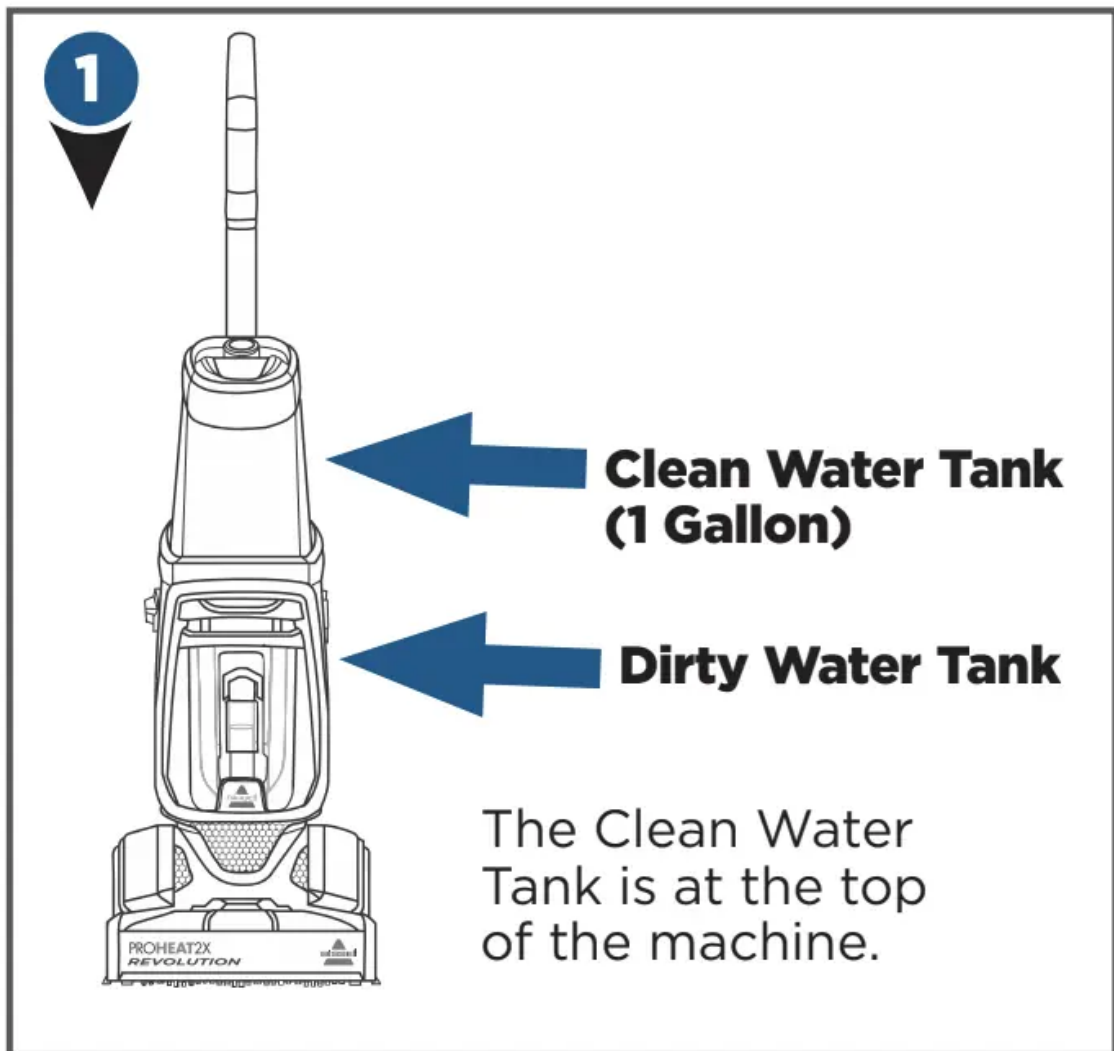

2

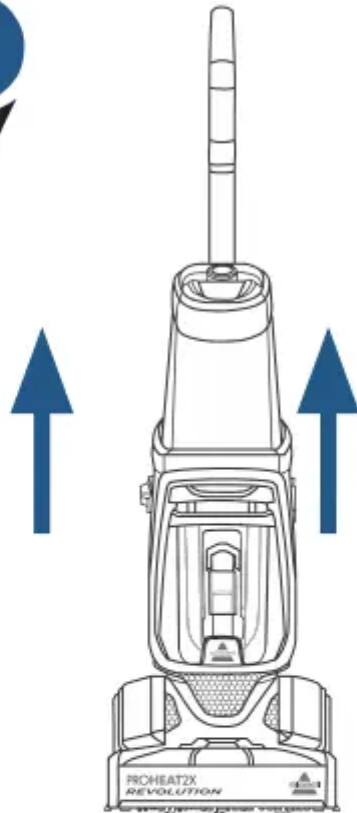

Lift the Clean Water Tank straight up to remove from the machine.

3

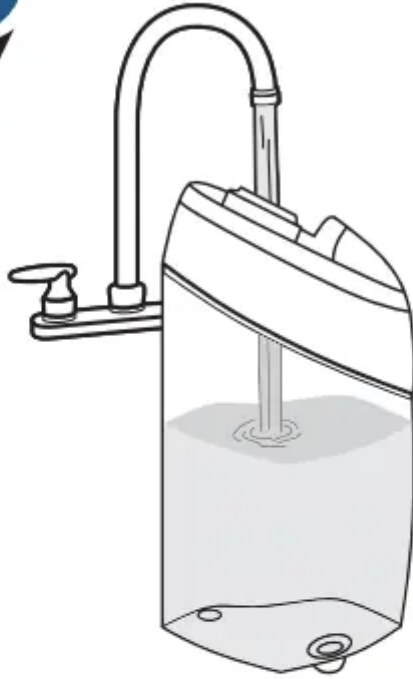

Unscrew the cap from the Clean Water Tank. Add hot tap water to the water fill line.

4

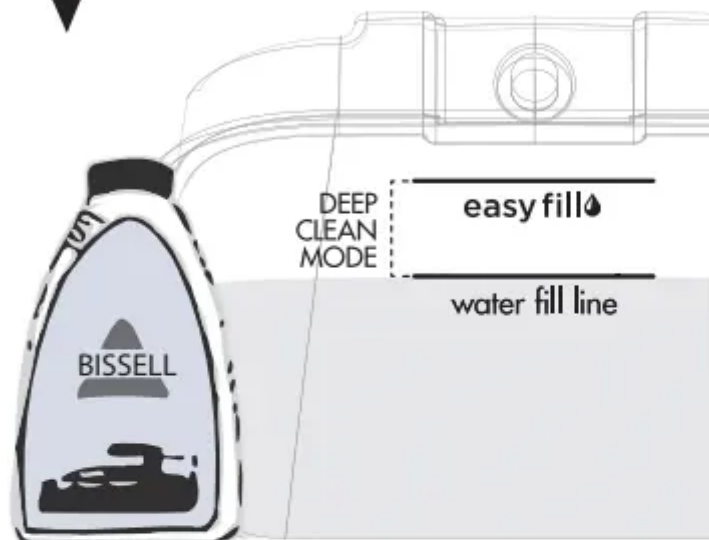

With Trial-Size  
Antibacterial Formula:

Pour into the Clean  
Water Tank up to the  
EasyFill line. Twist  
the cap back onto  
the tank.

5

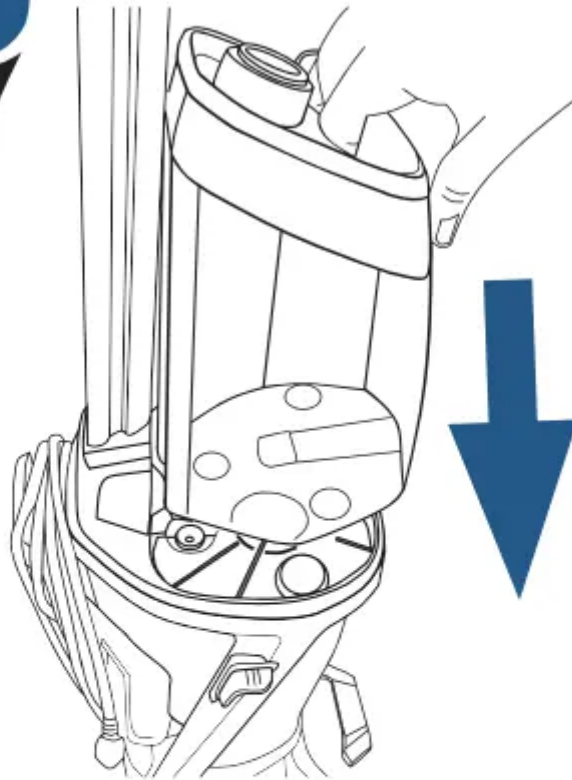

At the bottom of the Upper Handle, align the Clean Water Tank with the grooves and slide the tank into place.

## For Future Use with Full Size Antibacterial Formula:



After filling the Clean Water Tank with hot tap water, twist the yellow cap back onto the tank. Firmly insert the full-size formula bottle into the cap on the Clean Water Tank and squeeze until formula reaches the EasyFill line.

A few notes about filling the Clean Water Tank:

- Fill with hot (140°F/60°C MAX) tap water and add the appropriate BISSELL® formula. DO NOT USE BOILING WATER. DO NOT HEAT WATER OR TANK IN MICROWAVE.
- When using BISSELL Deep Clean + Antibacterial formula: Only fill your Clean Water Tank with the recommended amount of water and formula to achieve antibacterial benefits.

**NOTICE:** BISSELL Deep Clean + Antibacterial formula is only for BISSELL machines with EasyFill System.

**ATTENTION:** Do not overwet carpet. Be careful not to run over loose objects or edges of area rugs. Stalling the brush may result in premature belt failure.

1

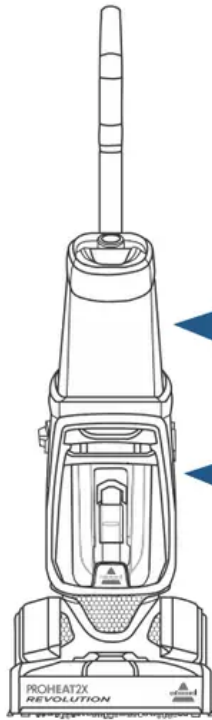

**Clean Water Tank  
(1 Gallon)**

**Dirty Water Tank**

The Clean Water Tank is at the top of the machine.

2

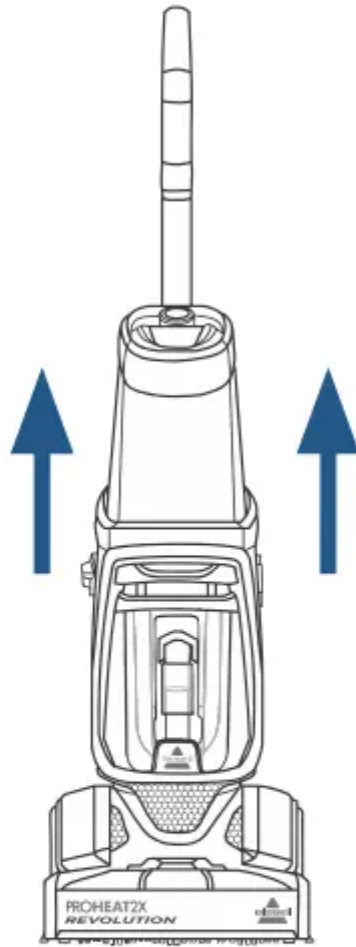

Lift the Clean Water Tank straight up to remove from the machine.

3

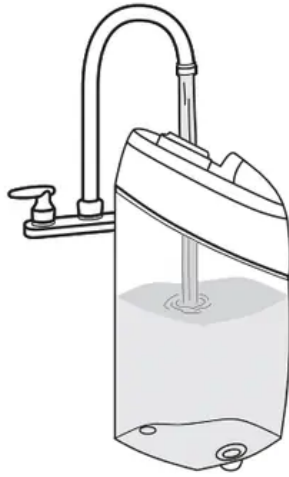

Unscrew the cap from the Clean Water Tank. Add hot tap water to the water fill line. Next, reference the chart below for formula amounts to add to the tank. Twist cap back into place.

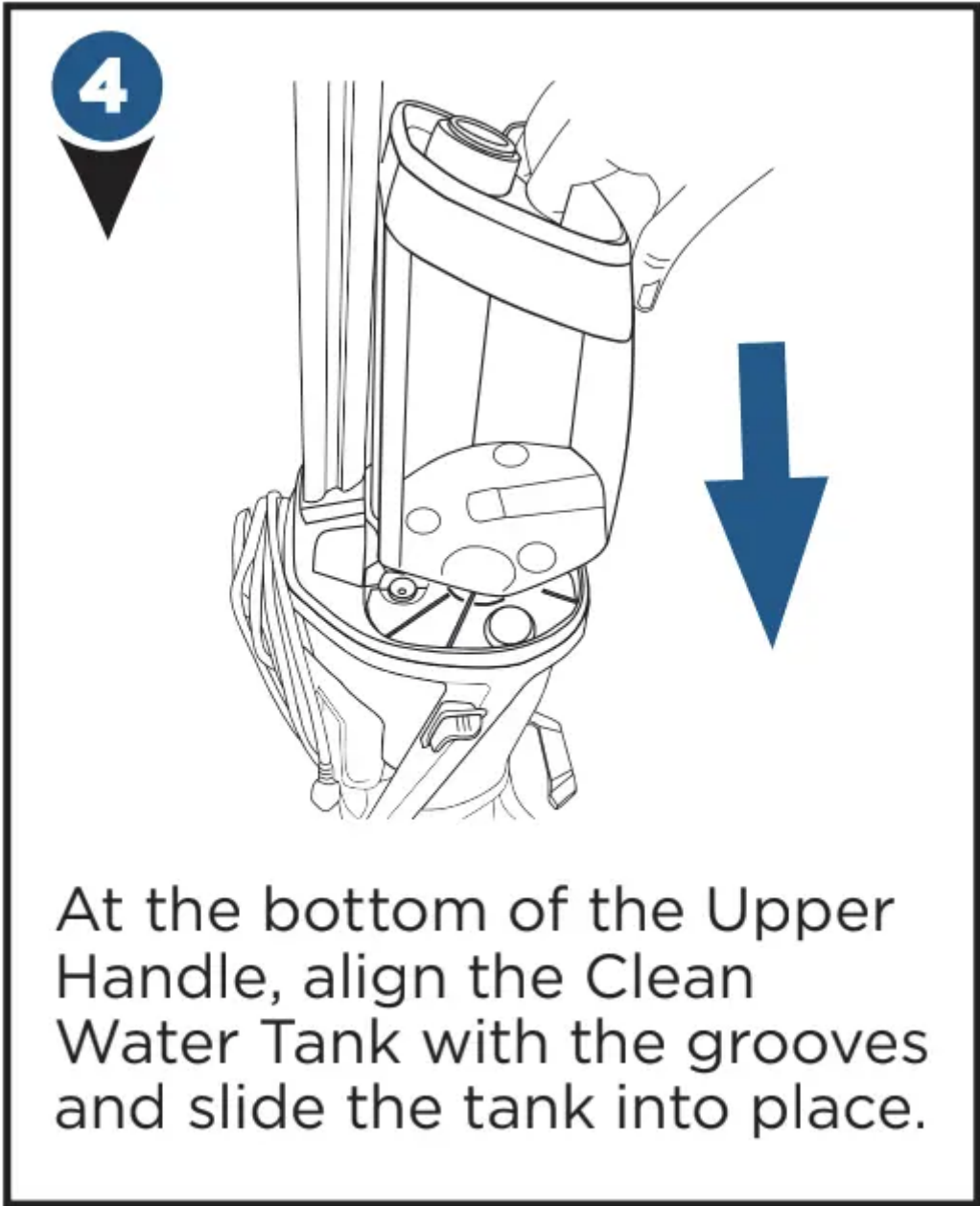

FORMULA FILLING INSTRUCTIONS	DEEP CLEAN MODE	EXPRESS CLEAN MODE
BISSELL Formulas	Fill water to the Water Fill Line, then add 2.5 oz of formula.	Fill water to the Water Fill Line, then add 1.25 oz of formula.

**NOTE:** Fill with hot (140°F/60°C MAX) tap water and add the appropriate BISSELL formula. **DO NOT USE BOILING WATER. DO NOT HEAT WATER OR TANK IN MICROWAVE.** Do not substitute BISSELL Formula with other household cleaning products.





### Pour in more power with BISSELL Boosts

- Fill tank with water and formula (step 3 above).
- Add 2 ounces of any BISSELL Boost per 1 gallon of water.
- The ProHeat 2X® Revolution™ has a 1-gallon Clean Water Tank.

## Cleaning Your Carpet

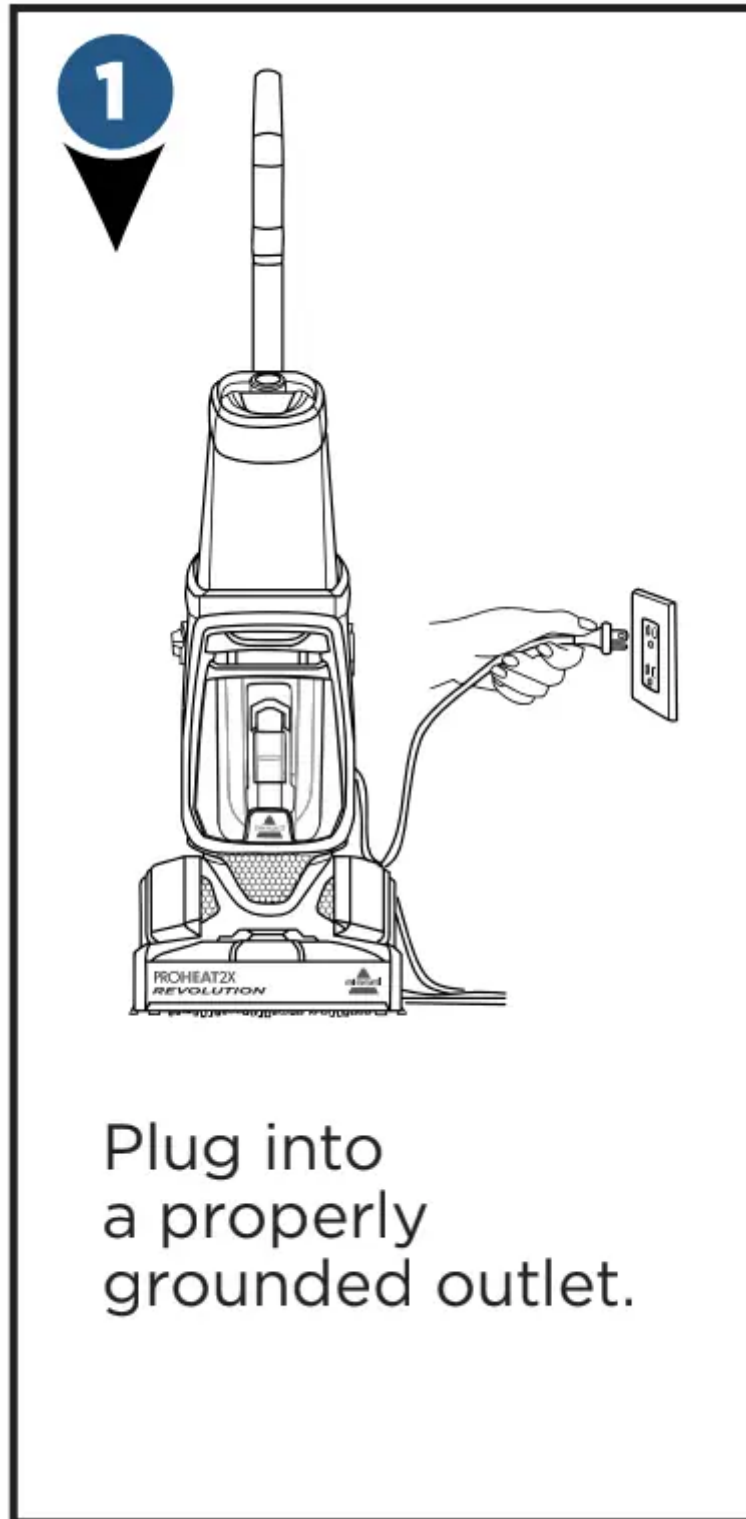

2

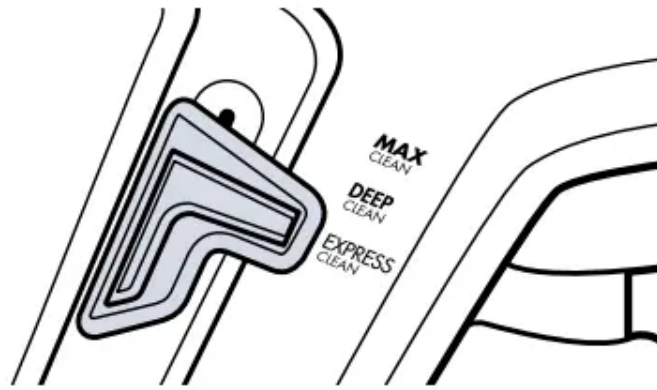

## Select Cleaning Mode

### Max Clean

- » Provides a heavy cleaning for your dirtiest carpets.
- » Dry Time: About 8 hours.

### Deep Clean

- » Delivers a deep clean to your carpet.

### Express Clean

- » Provides a lighter clean.
- » Dry Time: About 30 minutes.
- » Recommended Cleaning Pace: 12 inches per second

3

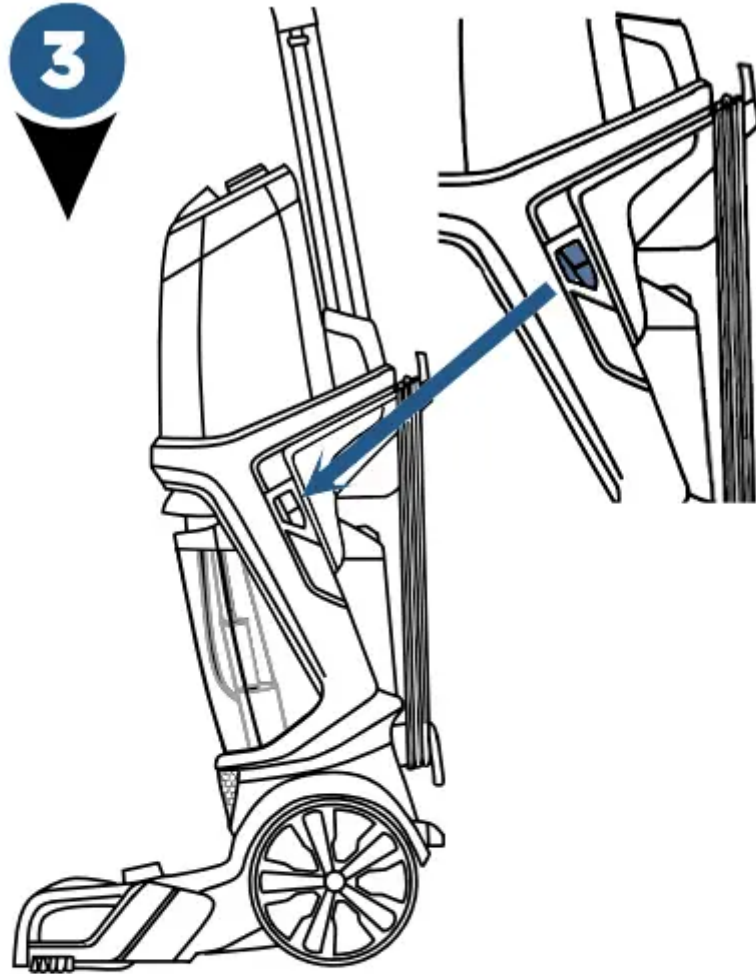

Press the Power Switch to turn the machine ON. To recline your machine for use, press the Recline Pedal with your foot.

**4**

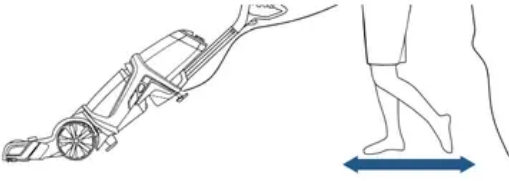

<b>Max Clean &amp; Deep Clean Modes:</b>		<b>Express Clean Mode:</b>
<p><b>Standard Cleaning</b></p> <ol style="list-style-type: none"> <li>1. Press the Spray Trigger to apply solution while making 2 slow, wet passes (1 forward, 1 back).</li> <li>2. Release the Spray Trigger.</li> <li>3. Make 2 slow, dry passes (1 forward, 1 back) to suck up the dirty solution. <b>Do not hold down the trigger for this step.</b></li> </ol>	<p><b>Using BISSELL® Deep Clean + Antibacterial Formula</b></p> <ol style="list-style-type: none"> <li>1. Press the Spray Trigger to apply solution while making 3 slow, wet passes (1 forward, 1 back and 1 forward again).</li> <li>2. Release the trigger.</li> <li>3. Make 1 slow, dry pass back to suck up the dirty solution. <b>Do not hold down the trigger for this step.</b></li> </ol>	<p><i>Recommended Cleaning Pace: 12 inches per second</i></p> <ol style="list-style-type: none"> <li>1. Press the Spray Trigger to apply solution while making 2 wet passes (1 forward, 1 back).</li> <li>2. Release the Spray Trigger.</li> <li>3. Make 2 dry passes (1 forward, 1 back) to suck up the dirty solution. <b>Do not hold down the trigger for this step.</b></li> </ol>

#### CLEANING TIPS:

- To prevent damage to Berber carpets, avoid repeated strokes in the same area.
- For best cleaning performance, clean with your machine in Deep Clean Mode.
- Choose Deep Clean Mode and use BISSELL Deep Clean + Antibacterial to deliver antibacterial benefits.
- In Max Clean Mode dry time is an estimated 8 hours. To expedite the drying process, place a fan in the room or near the carpet.
- In Express Clean Mode, the Dirty Water Tank will not get as full as when cleaning with Deep or Max Clean Mode.
- It is common to refill the Clean Water Tank and empty the Dirty Water Tank multiple times during the cleaning process. Room size and the speed at which you clean both affect how often the tank may need to be refilled and/or emptied.

## Cleaning Area Rugs

**IMPORTANT:** Please check manufacturer's tag before cleaning area rugs for any specialized cleaning instructions. We do not recommend deep cleaning delicate, silk, wool, antique, or area rugs without a manufacturer's tag.

#### Regularly clean your high-traffic area rugs in Express Clean Mode:

- Check the manufacturer's tag.
- Select Express Clean Mode.
- When cleaning area rugs, place the rug on a sealed surface to test for colorfastness in an inconspicuous area. Your cleaner should not be used on unsealed surfaces.

- Important: Keep the Foot of the deep cleaner perpendicular to the rug's edge with each cleaning pass to prevent damage.

## Cleaning with Hose and Tool

- Keep hair, loose clothing, fingers, and all parts of body away from openings and moving parts. The Brush Roll continues to rotate when in the upright position.
- The Brush Roll continues to turn while product is turned ON and handle is in upright position. To avoid damage to carpet, rugs, furniture, and flooring, avoid tipping cleaner or setting it on furniture, fringed area rugs or carpeted stairs during tool use.
- With Brush Roll on, do not allow cleaner to sit in one location for an extended period of time, as damage to floor can result.

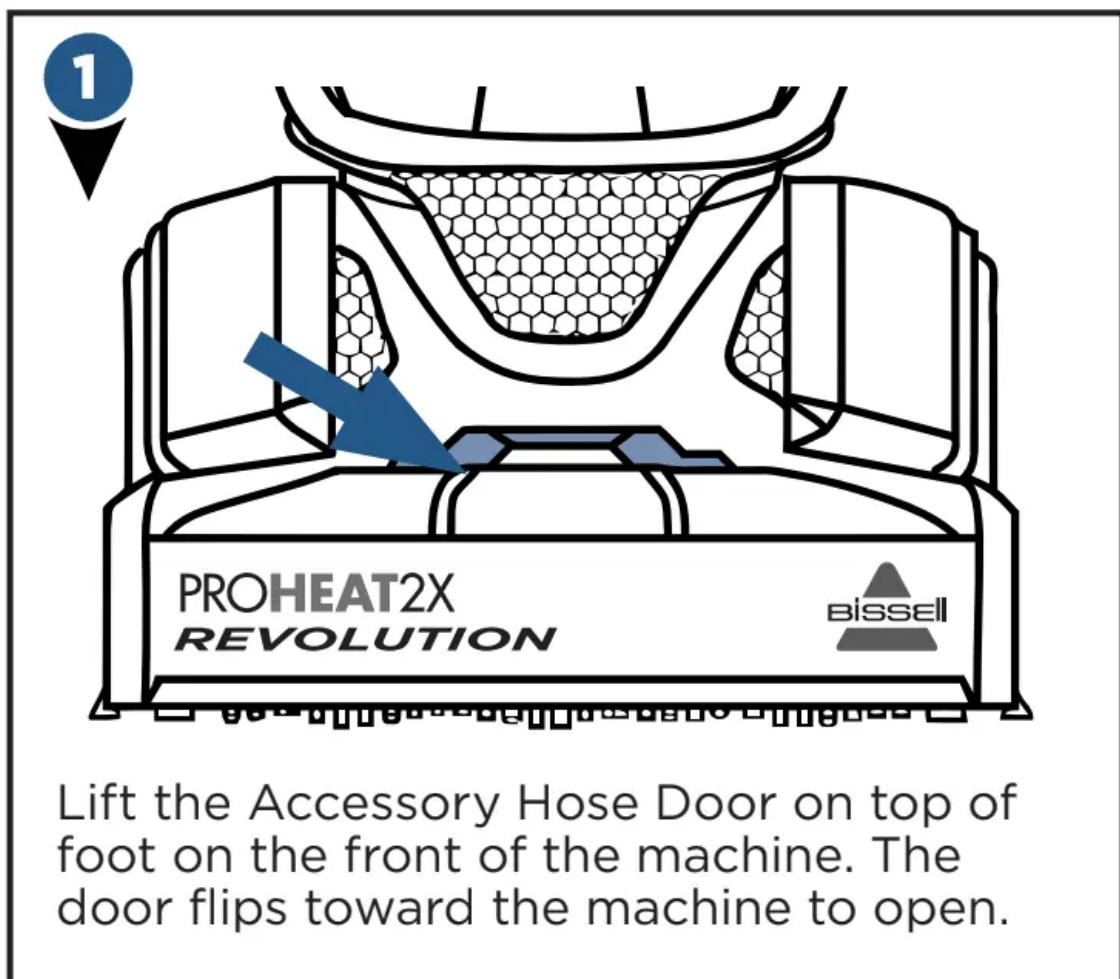

2

Insert the hose and snap into place. Be sure the colored hose release clip is facing out, away from machine.



3

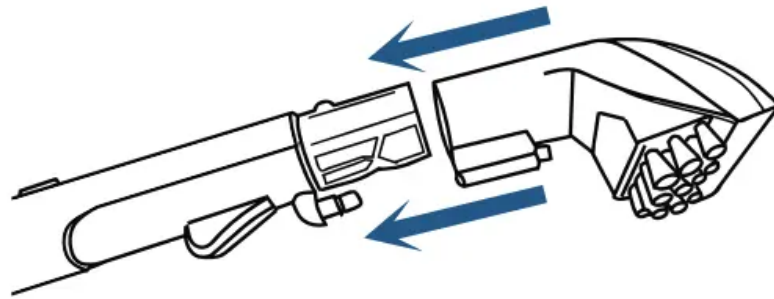

Attach the tool to the end of the hose. (Tools may vary by model.) Press the Power Switch to turn machine ON.

4

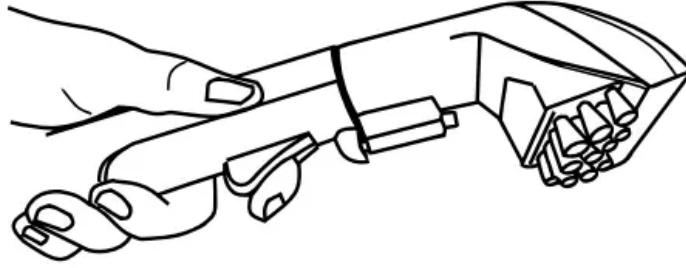

Press the Spray Trigger button to spray the soiled area, then slowly move tool back and forth over the area.

Release the trigger to suck up the dirty solution. Work in small sections until the area is clean.

When finished cleaning, turn the machine ON to suction up warm clean water to rinse the inside of the hose and tool. Detach the hose and tool and close the Accessory Hose Door. Let the hose and tool air dry before storing.

**NOTE:** If using the **Mini Deep Reach Tool**, be sure the needles of the tool are pressed down into the carpet so the spray gets into the carpet fibers.

### **Emptying the Dirty Water Tank**

**WARNING:** To reduce the risk of fire, electric shock or injury, turn power OFF and disconnect plug from electrical outlet before performing maintenance or troubleshooting.

1



To release Dirty Water Tank, press down on the colored tank handle.

2

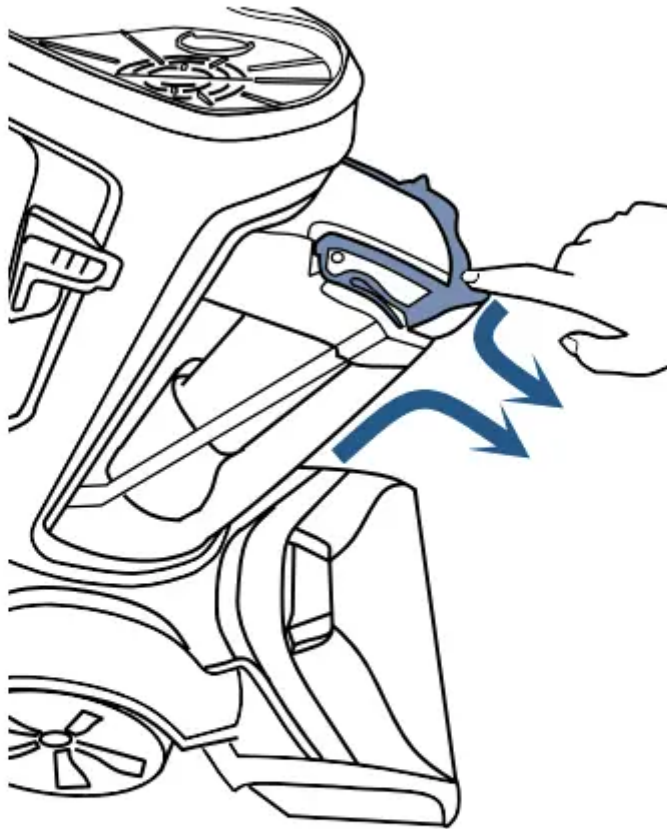

Tilt the tank slightly toward you. Grab the handle and tank with both hands.

3

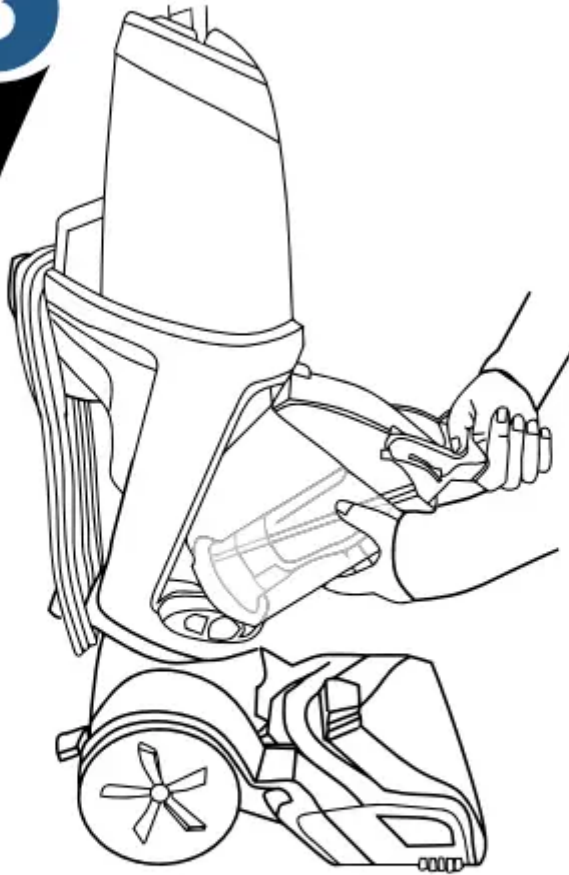

Pull Dirty Water Tank up  
and away to remove.

4



**For quick empty:**

Pull the Rubber Tab (located in the middle of the tank) and tilt to pour.

When closing the Rubber Tab, make sure all edges are sealed tight.

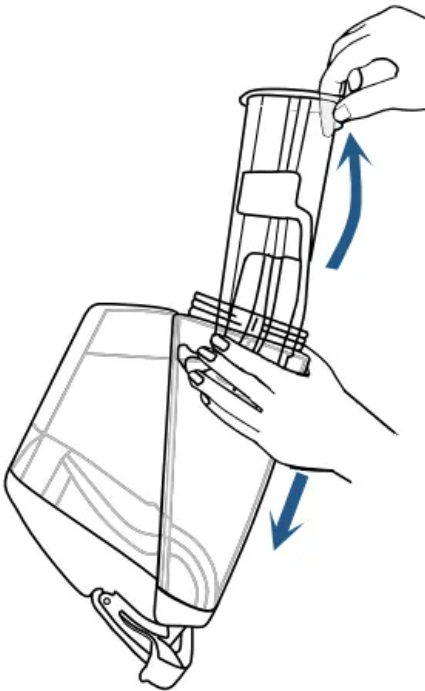

**For final clean and**

**rinse:** Unscrew the ring at the bottom of tank.

Gently remove the Float Stack, rinse, and clean.

Once clean, return Float Stack into the tank by lining up the arrows so they point at each other. This is the only way the Float Stack will fit into the tank.

With the arrows aligned, the Float Stack should lock into place.

Return the ring and twist to lock. Water may leak if the ring is not fully tightened.

5

Clean the red filter below the Dirty Water Tank by wiping off any remaining dirt or debris.

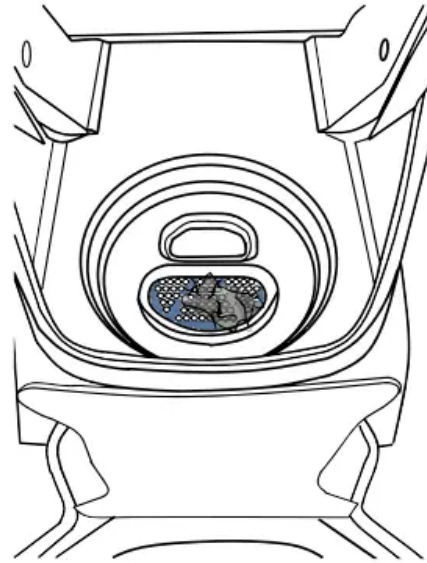

6

**To return the Dirty Water Tank:** Angle the tank and insert bottom first. Then tilt the tank toward the machine and push the top in until it clicks into place.



## Did You Know?

The Float Stack is what prevents your Dirty Water Tank from overflowing.

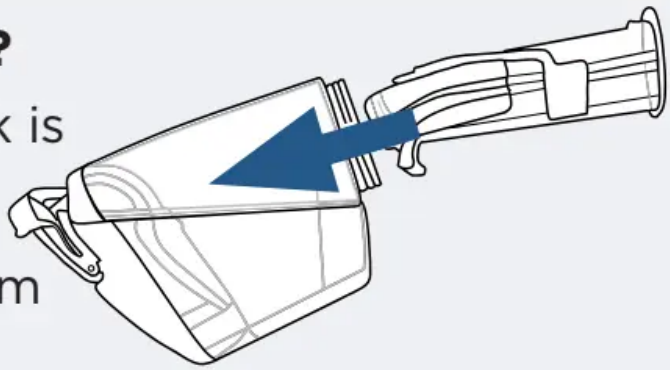

## Cleaning Machine After Use

**WARNING:** To reduce the risk of fire, electric shock or injury, turn power OFF and disconnect plug from electrical outlet before performing maintenance or troubleshooting.

**1**

Rinse the Clean Water Tank with warm tap water. Fill the tank with warm tap water, twist the cap on and return the tank to the machine. Twist cap back on tightly.

To flush and rinse machine turn it ON and press the Spray Trigger for 15 seconds while making forward and backward passes on carpet. Release the trigger and suck up water.

See page 11 to clean the Dirty Water Tank from the water that was just sucked up. Empty the Clean Water Tank and let dry before storing. Wipe your machine's exterior with a soft cloth.

**NOTE:** Be sure to clean the Brush Rolls and nozzle before storing your machine. Follow these steps if your nozzle becomes clogged with hair or debris.

**NOTICE:** To reduce the risk of a leaking condition, do not store unit where freezing may occur. Damage to internal components may result.

## Cleaning the Nozzle

**1**

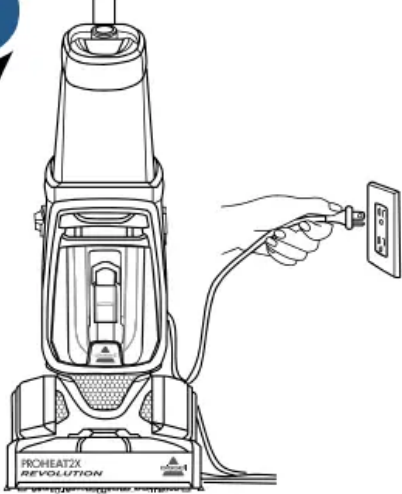

If pet hair or debris become clogged in the nozzle, it can be cleaned out of the nozzle with the Nozzle Clean Out Tool.

Turn OFF and unplug the machine.

**2**

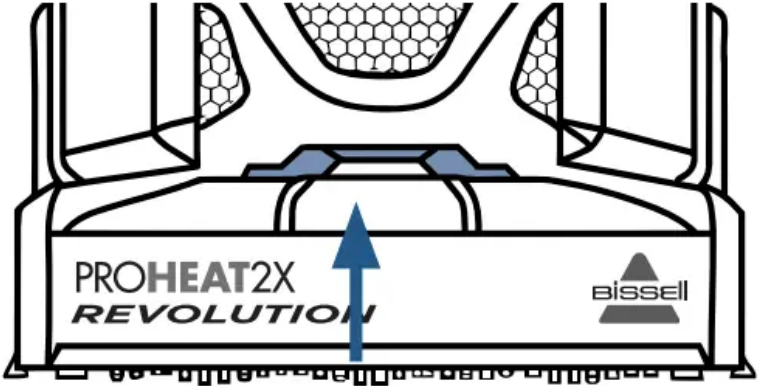

Remove the nozzle from the Foot: flip the Accessory Hose Door open and lift up on the nozzle and Accessory Hose Door.

3

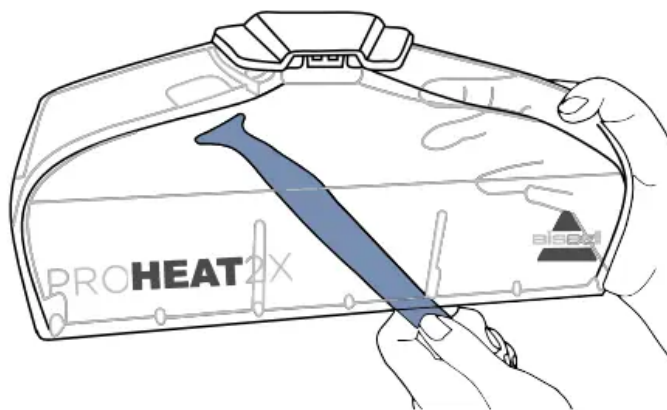

Hold the nozzle and insert the Nozzle Clean Out Tool into the thin slot at the front of the nozzle where it touches the floor. Clean until free of pet hair or debris.

4

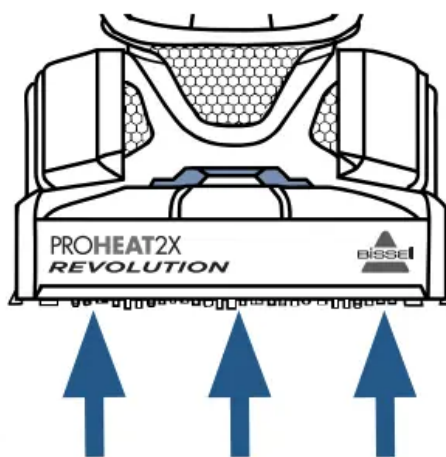

Return the nozzle back to the foot of the machine. Line up the three hooks on the nozzle to the bottom of the foot (see arrows for location).

Rotate the nozzle up and click into place. Close the Accessory Hose Door.

# Cleaning the Brush Rolls



Turn OFF and unplug the machine.



2

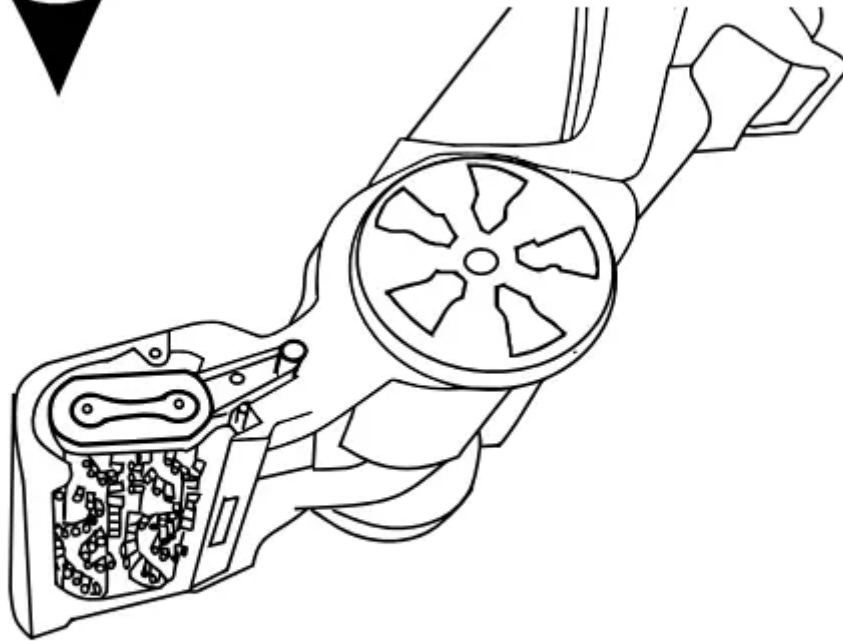

Lay the machine down on its back or side.

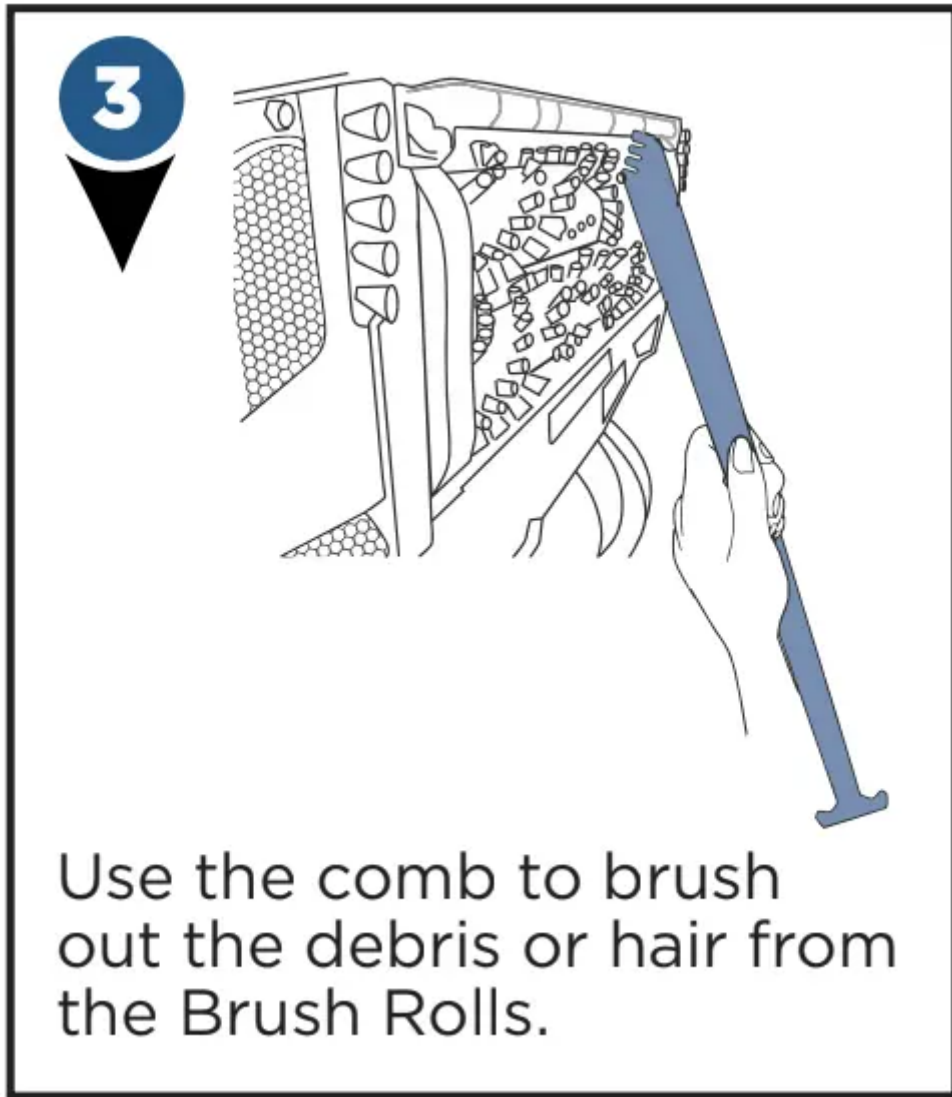

## Replacing Belts or Brush Rolls

What you will need: 1 Phillips-head screwdriver & 1 flathead screwdriver

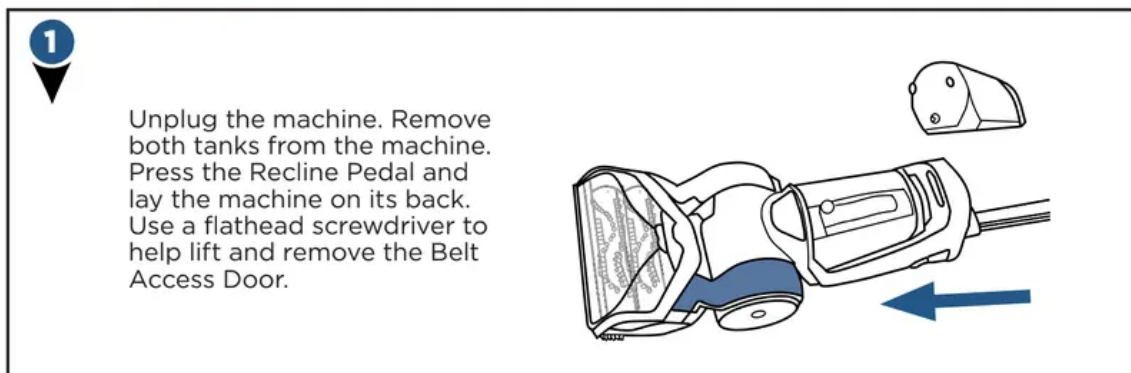

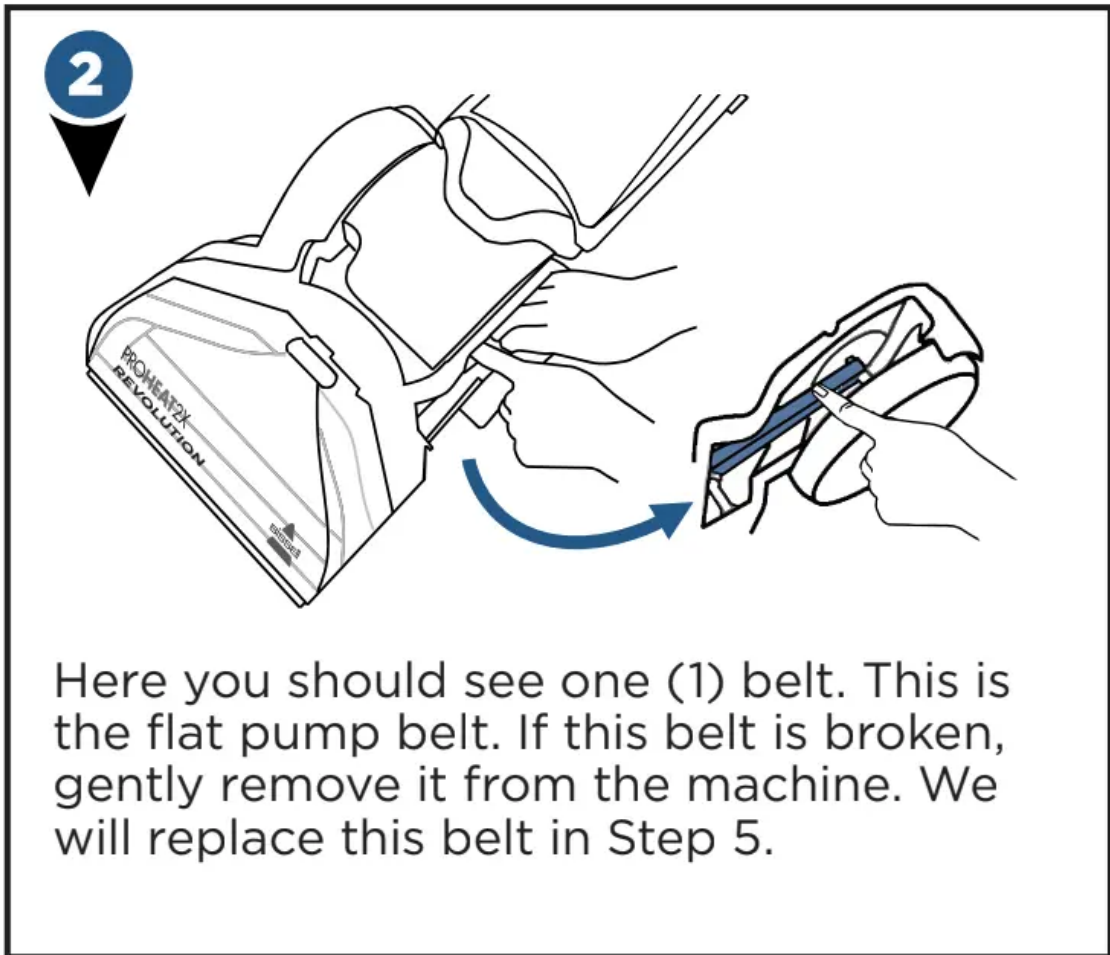

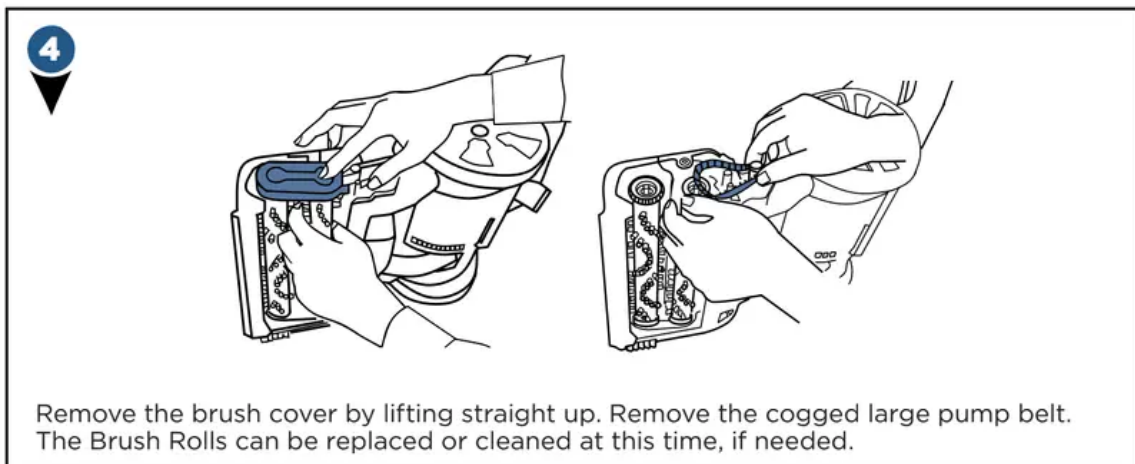
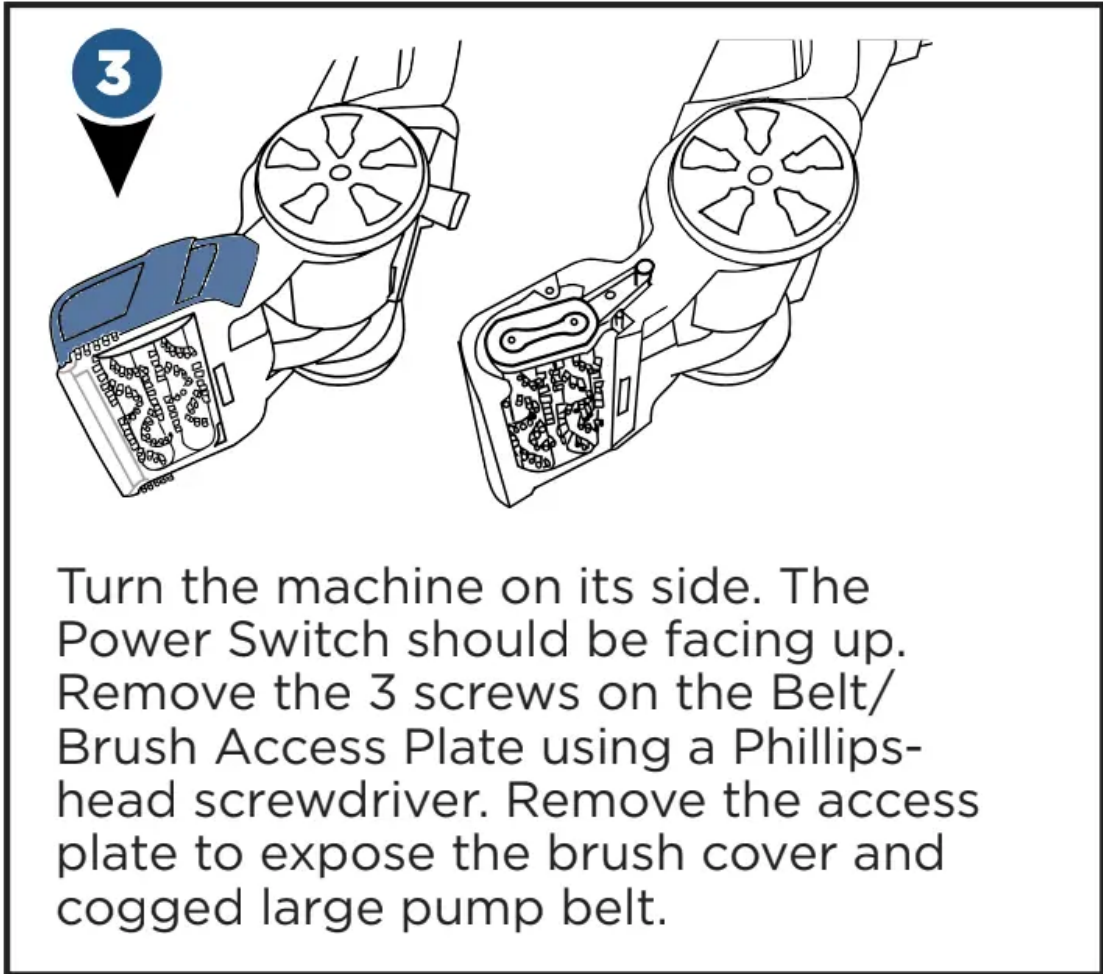

5

If the flat pump belt was broken, place a new belt around the red area of the large pulley. Then use your thumb to stretch it toward the back of the machine and transfer it onto the metal axle.

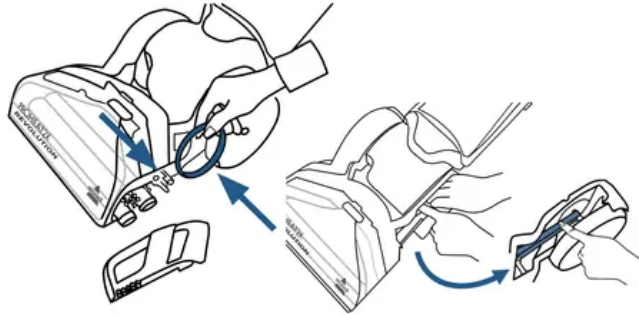

6

Spin either brush. If they both spin, continue to Step 7.

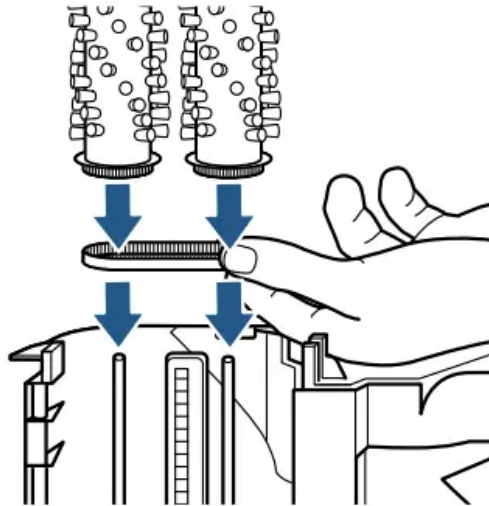

If only one spins, the opposite belt is broken and you must remove both brushes and replace the small cogged brush belt.

Place the new belt around both brush gears and slide them onto the thin metal axles.

7

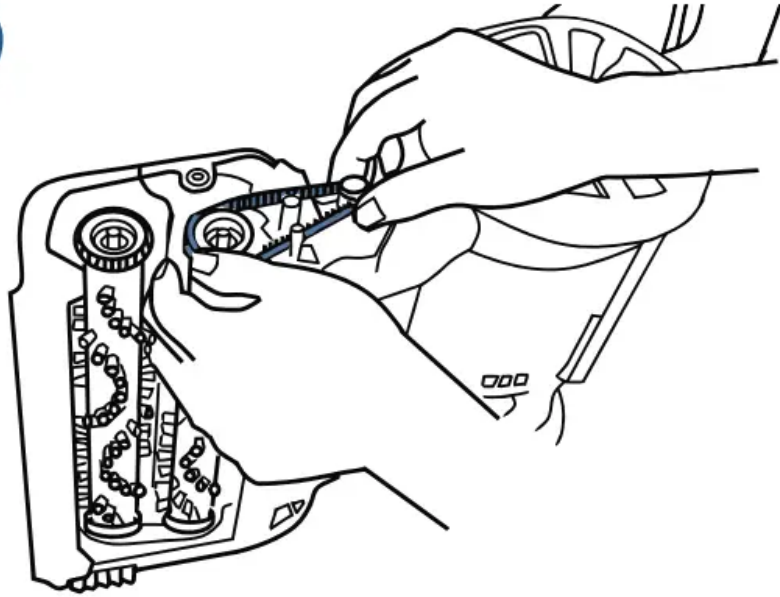

To replace the cogged large pump belt, make sure your deep cleaner is completely reclined. Begin by wrapping the cogged large pump belt around the small metal-toothed pulley. While wrapped around the pulley, stretch and wrap around the nearest brush gear.

8

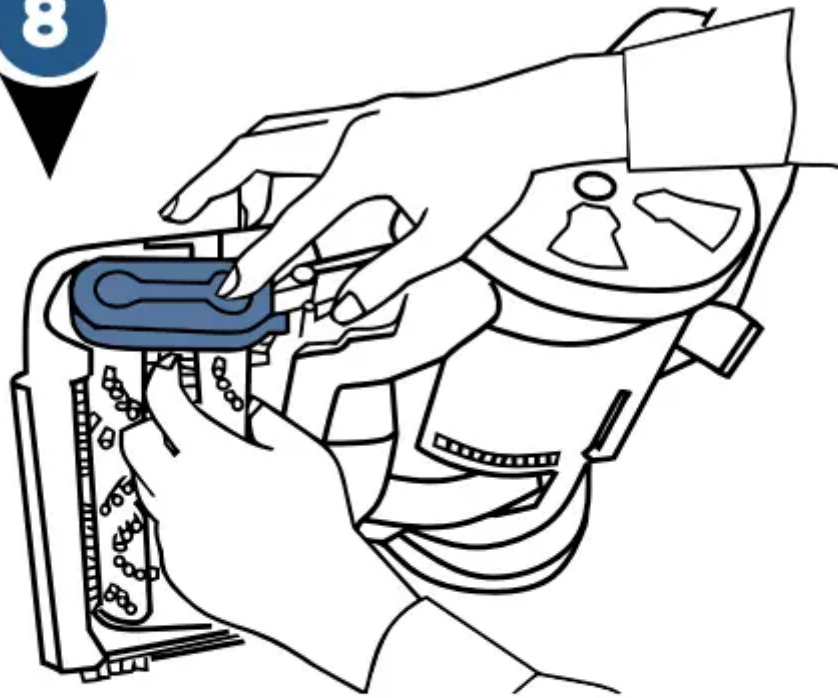

Return the brush cover.  
Make sure that the  
brushes are aligned and  
the cover is secure.

9

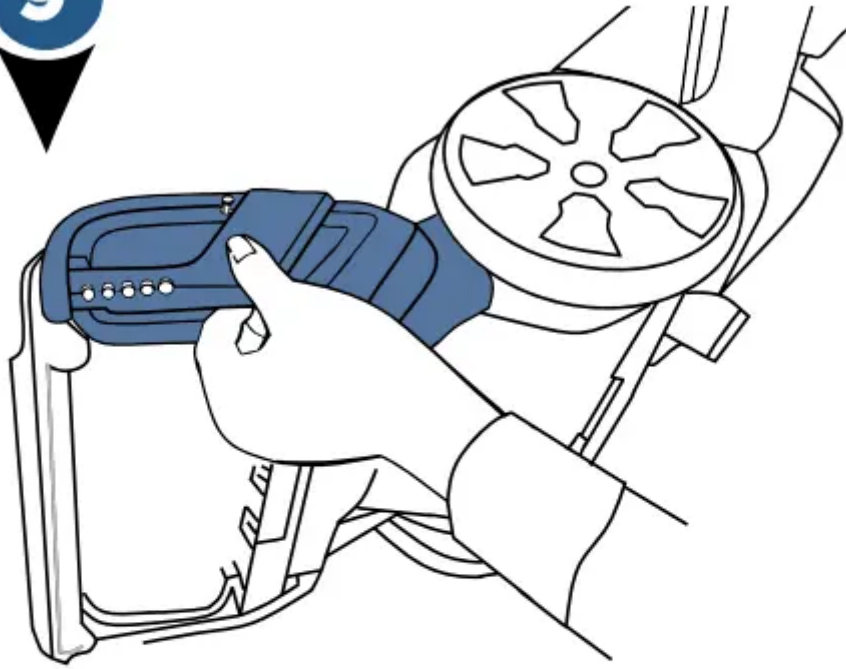

Return the Belt/Brush Access Plate to the end of the Brush Rolls by securing with the 3 screws.

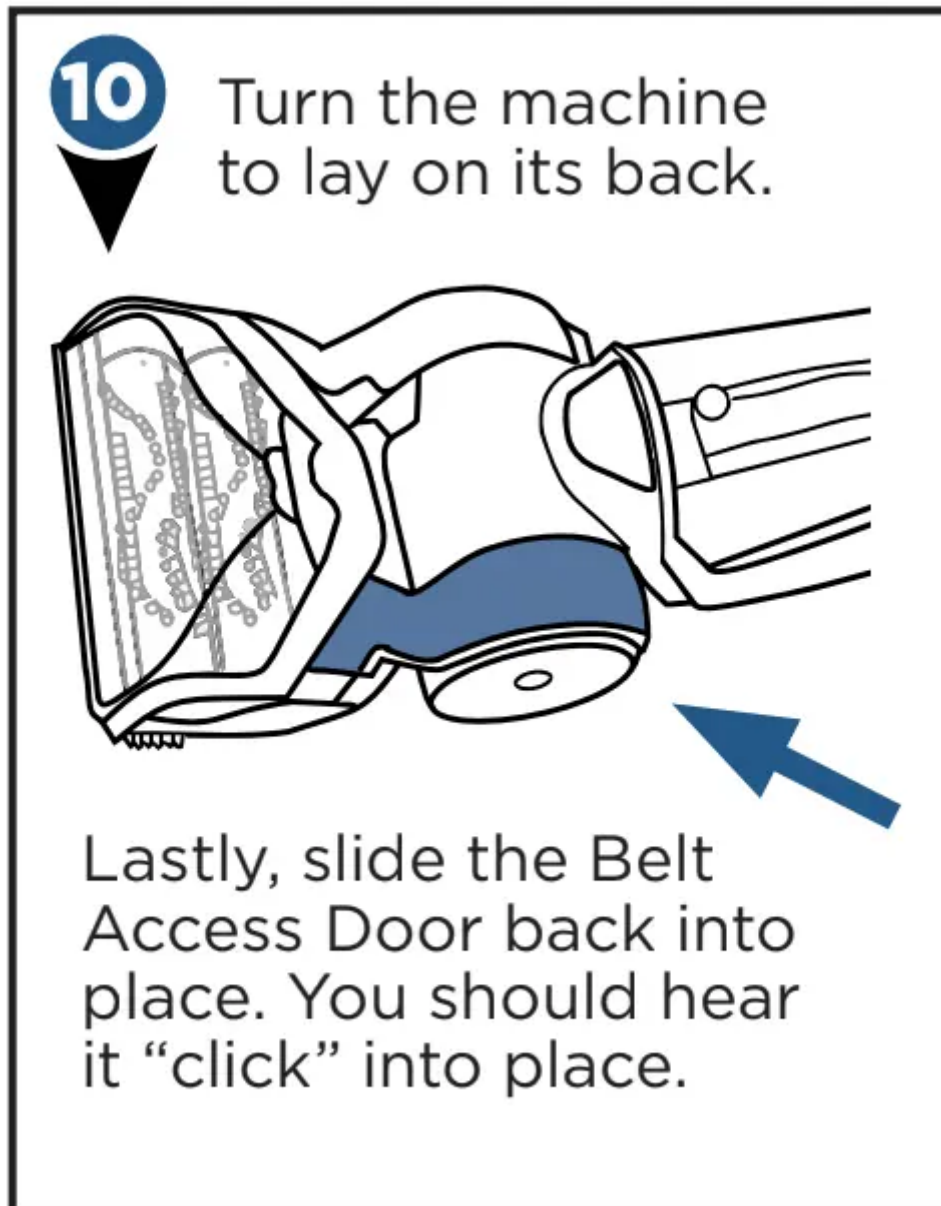

## Troubleshooting

**WARNING:** To reduce the risk of electric shock, turn OFF and disconnect plug from electrical outlet before performing maintenance or troubleshooting checks.

<b>Problem</b>	<b>Possible causes</b>	<b>Remedies</b>
<b>Reduced spray OR no spray</b>	Clean Water Tank may be empty.	Refill tank.
	Clean Water Tank may not be seated completely.	Turn power OFF. Remove and reseal tank.
	Pump may have lost prime in Hose Cleaning Mode.	Hold end of hose below water level in tank to prime.
<b>No spray through hose &amp; tool</b>	The hose to your machine is not primed.	With the machine OFF and unplugged, remove the nozzle from the foot. Place a ballpoint pen in the black cylinder next to the screw. When water bubbles up, remove the pen. Reassemble the nozzle and hose.
<b>Loss of suction power</b>	Tanks may not be seated properly.	Pick up both tanks and reseal them so they fit properly on the unit.
	Dirty Water Tank has picked up maximum amount of dirty water and has reached full line.	Empty Dirty Water Tank.
	Clean Water Tank is empty.	Check fluid levels in the Clean Water Tank. Refill the tank if it is empty.
	Rubber Tab on Dirty Water Tank is not sealed tight.	Check the Rubber Tab on the Dirty Water Tank and press firmly on all edges to secure it tightly (see step 4 on page 11 for details).
	Accessory Hose Door may not be closed tightly in place.	Check the Accessory Hose Door and make sure it is closed tightly – it should be locked into place.
	Nozzle may be clogged from pet hair or debris.	Use the Nozzle Clean Out Tool and follow steps on page 13 for “Cleaning Nozzle”.
<b>No power</b>	Cleaning Mode switch mistaken for Power Switch.	Press the Power Switch on the left side of the machine to turn the machine ON.
	Outlet may not be active.	

		Try plugging in a different device that uses a grounded outlet to test for power from the outlet.
<b>Leaking tank</b>	Tank may have been over-filled.	<ol style="list-style-type: none"> <li>1. Make sure your tank has the water and formula in it that you've prepared.</li> <li>2. With the cap twisted ON tightly, hold your tank at an angle, over a sink or drain, so any extra water can pour out of the space.</li> <li>3. Wipe the tank dry with a cloth.</li> </ol>
	Water may be caught in space between the tank and the tank's handle.	

**Warning**

This content is compiled from multiple sources and is provided for reference purposes only. It may not be complete or fully applicable to all situations. If you are unable to resolve your issue, please contact the product manufacturer or an authorized service provider for official support.

