

## OVERVIEW

### Packaging content



1. Soft touch controls. All controls are activated by touch

- R) Ristretto touch
- E) Espresso touch
- L) Lungo touch

2. Slider for capsule insertion

3. Used capsule container & drip tray

4. Adjustable cup support and drip grid

5. Coffee outlet

6. Adjustable water tank arm

7. Water tank

8. Water tank lid

## FIRST USE



First read the safety precautions to avoid risks of fatal electrical shock and fire.

1. Remove the water tank and capsule container. Adjust the cable length and store the excess under the machine.



2. Insert the remaining cable in the guide under water tank left or right socket, depending on the position chosen for the water tank. Ensure machine is in the upright position.

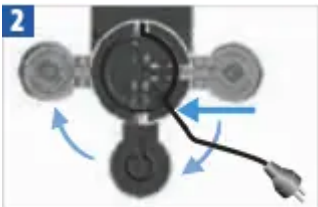

3. Plug the machine into the mains.



4. Rinse the water tank before filling it with potable water.



5. Place the water tank on its arm, it is fixed with magnets. Insert the drip tray and the capsule container in position. For your safety, operate the machine only with drip tray and capsule container in position.



6. Turn the machine ON by opening the slider and pushing it towards the back of the machine. Light will blink on one of the coffee touches: heating up for approximately 25

seconds

Steady light: ready



- The machine can be turned into OFF mode at any time when slider is closed by pushing and holding any touch control for more than 3 sec., confirmed by the other 2 controls flashing



- Place a container under coffee outlet. Press the Lungo control. Close the slider to rinse the machine. Repeat three times.



## COFFEE PREPARATION



- Fill the water tank with potable water.



- Place a cup under the coffee outlet.



3. Turn machine ON by either pushing the slider or touching the controls. Light will blink on one of the coffee touches: heating up for approximately 25 seconds Steady light: ready.



4. Select the Ristretto control (25 ml / 0.84 oz), Espresso (40 ml / 1.35 oz) or Lungo (110 ml / 3.7 oz) based on the chosen Grand Cru recommended cup size. You can select the desired coffee control even when the machine is still heating up. The coffee will then flow automatically when the machine is ready.

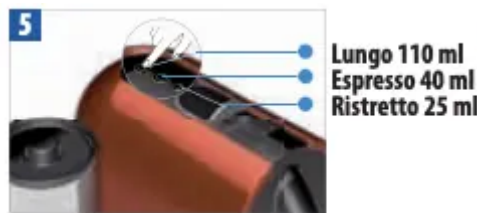

5. The machine suggests the most frequently chosen cup size (based on last 11 coffees). Espresso as factory setting. You can change this by selecting any other control.



6. Completely open the slider and insert a Nespresso capsule.



7. Close the slider.



8. Preparation will stop automatically. The capsule will be automatically ejected.



9. To stop the coffee flow before touch the lit control or move the slider towards the back of the machine until it stops.



10. To manually top up your coffee, touch any of the controls within 4 seconds from end of preparation and touch lit control again to stop.



11. To change the selected cup size during brewing select the new desired control. The machine will stop immediately if coffee volume extracted is larger than new desired control.



12. To accommodate a milk recipe glass, shift the cup support to either the left or right side magnets. The capsule will be automatically ejected.

## ENERGY SAVING CONCEPT

1. Automatic Off mode: the machine will turn into Off mode automatically after 9 minutes of non use.



2. The machine can be turned into OFF mode at any time when slider is closed by pushing any control for more than 3 sec., confirmed by the other 2 controls flashing



3. To change automatic OFF mode from 9 to 30 minutes, when slider is closed press and hold both the Lungo and Ristretto controls for more than 3sec. Espresso control makes flashes once for confirmation. To revert back to 9 minutes, repeat the same procedure. Espresso control flashes 3 times for confirmation.

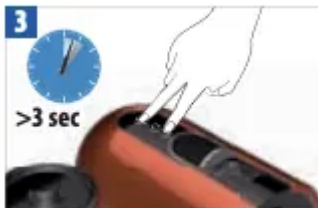

## PROGRAMMING THE WATER VOLUME

1. Any control can be programmed. Completely open the slider and insert a Nespresso capsule.



2. Touch and hold the control while closing the slider. Release control when desired volume is reached. The other 2 controls flash for confirmation. Water volume level is now stored

in the control used during programming



## RESET TO FACTORY SETTINGS

1. Press and hold the Espresso & Lungo controls together for at least 4 sec. The other control flashes for confirmation.



 frecuencia: Espresso (40 ml).

Factory settings are:

1. Lungo, Espresso, Ristretto controls 110 ml / 3.7 oz, 40 ml / 1.35 oz, 25 ml / 0.84 oz.
2. Automatic Off mode after 9 minutes.
3. Most frequently chosen cup size as Espresso control at 40 ml / 1.35 oz.

## EMPTYING THE SYSTEM before a period of non-use, for frost protection or before a repair

1. To note, the machine remains blocked for 10 minutes after emptying! Remove the water tank. Place a container under the coffee outlet.



2. Open slider. Press and hold the Ristretto & Lungo controls together for at least 6 sec. The other control flash for confirmation. Then close the slider to start procedure.



3. Machines turns to Off mode automatically when empty.



## CLEANING

 To ensure hygienic conditions, it is highly recommended emptying/cleaning the used capsule container every day

1. Empty the drip tray and the used capsule container.



2. Clean the coffee outlet regularly with a damp cloth.



3.  Never immerse the appliance or part of it in water.



4. Do not use any strong or abrasive solvent, sponge or cream cleaner. Do not put in the dishwasher.



## DESCALING

1. Empty the drip tray and the used capsule container.



2. Fill the water tank with 1 unit of Nespresso descaling liquid and add 0.5 l / 17 oz of water.



3. Place a container (minimum volume: 0.6 l / 20 oz) under the coffee outlet.



4. Activate the machine by pushing one of the cup selection touches.



5. Blinking light: heating up.  
Steady light: ready.



6. To enter the descaling mode, at slider closed push all the 3 controls simultaneously for at least 3 sec. A short beep will confirm it. Open the slider.

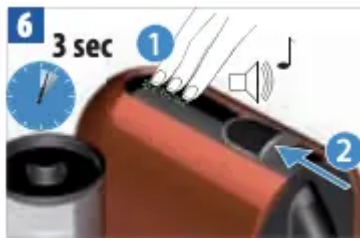

7. Push all the 3 controls simultaneously for at least 3sec. A short beep will confrm it. The control area will start blinking quickly.



8. Close the slider to start descaling. Machine stops when water tank is empty



9. Refill the water tank with the used descaling solution collected in the container and touch any control to repeat the procedure.



10. Empty and rinse the water tank, capsule container, drip tray and cup support thoroughly. Fill water tank with potable water.



11. When ready, touch any control to rinse the machine. Machine will stop when done.



12. To exit the descaling mode, push all the 3 controls simultaneously for at least 3 sec. A short beep will confirm this. The machine is now ready for use.









### DESCALING MODE

The descaling solution can be harmful. Avoid contact with eyes, skin and surfaces. Never use any product other than the Nespresso descaling kit available at the Nespresso Club to avoid damage to your machine. The following table will indicate the descaling frequency required for the optimum performance of your machine, based on water hardness. For any additional questions you may have regarding descaling, please contact your Nespresso Club.

Dureza del agua: Water hardness:		Descalcificar tras: Descalcify after:		fh	Grado francés French degree
fh	dH	CaCO <sub>3</sub>	Cups (40ml)	dh	Grado alemán German degree
36	20	360 mg/l	1000	dh	German degree
18	10	180 mg/l	2000	CaCO <sub>3</sub>	Carbonato cálcico
0	0	0 mg/l	4000	CaCO <sub>3</sub>	Calcium Carbonate

Nespresso descaling kit: Ref. 3035/CBU-2

### SPECIFICATIONS

	220 V, 50-60 Hz, <1260 W		0,8 l				
Pmax	19 bar		115 mm		251 mm		369 mm
	~ 3 kg						

### TROUBLESHOOTING

**No light on the controls.**

→ The machine has turned to Off mode automatically; touch one of the controls or push the slider. Check the mains: plug, voltage, fuse.

**No coffee, no water**

→ Check the water tank, if empty, fill with potable water. Descale it if necessary.

**Coffee is not hot enough.**

→ Preheat cup. Descale the machine if necessary

**The slider does not close completely or the machine doesn't start brewing.**

→ Empty the capsule container. Check that no capsule is blocked inside the machine.

**Leakage or unusual coffee flow.**

→ Check that the water tank is correctly positioned.

**Lights flash alternately from back to front.**

→ Empty the used capsule container and check no capsules are blocked. Then touch any control. If problem persists, call the Nespresso Club.

**Lights flash alternately from front to back.**

→ Fill the water tank. If problem persists, call the Nespresso Club.

**Lights flash quickly.**

→ Exit descaling procedure, push all the 3 controls simultaneously for at least 3sec. Disconnect plug from the mains and reconnect after 10 sec. If problem persists, call the Nespresso Club.

**No coffee, water just comes out (despite inserted capsule).**

→ Pull the slider to ensure it is closed. If problem persists, call the Nespresso Club.

**Machine turns to Off mode.**

→ To save energy the machine will turn to Off mode after 9 minutes of non use. See paragraph on "Energy saving concept".

**Water or coffee flow does not stop pushing any control.**

→ Move gently the slider towards the back of the machine to stop the flow.

**Warning**

This content is compiled from multiple sources and is provided for reference purposes only. It may not be complete or fully applicable to all situations. If you are unable to resolve your issue, please contact the product manufacturer or an authorized service provider for official support.

---

Document generated by [ManualsFile](#)

