

Machine Overview

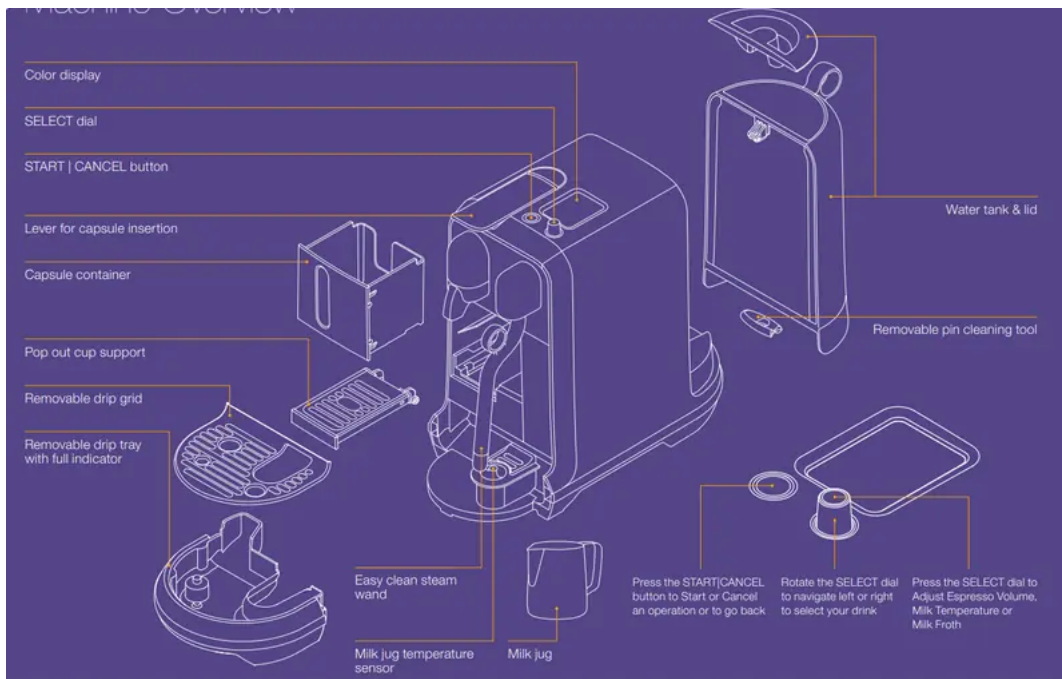

First Use

Read the important safeguards first to avoid risks of fatal electrical shock and fire.

- 1 Rinse the water tank before filling it with potable water.



2 Place the water tank, insert the drip tray and the capsule container in position. For your safety, operate the machine only with drip tray and capsule container in position.

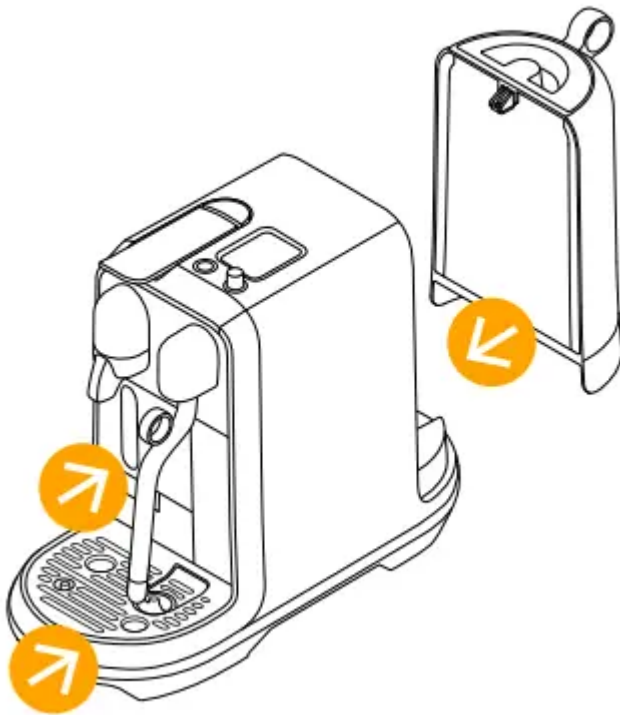

3 Plug the machine into the power outlet.

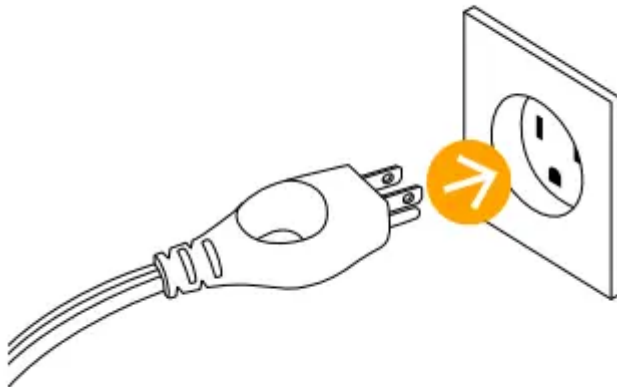

4 Turn the machine ON by pressing the START|CANCEL button. Heating up takes approximately 3 seconds.



⑤ Rotate the SELECT dial to set your language. Press SELECT to confirm.

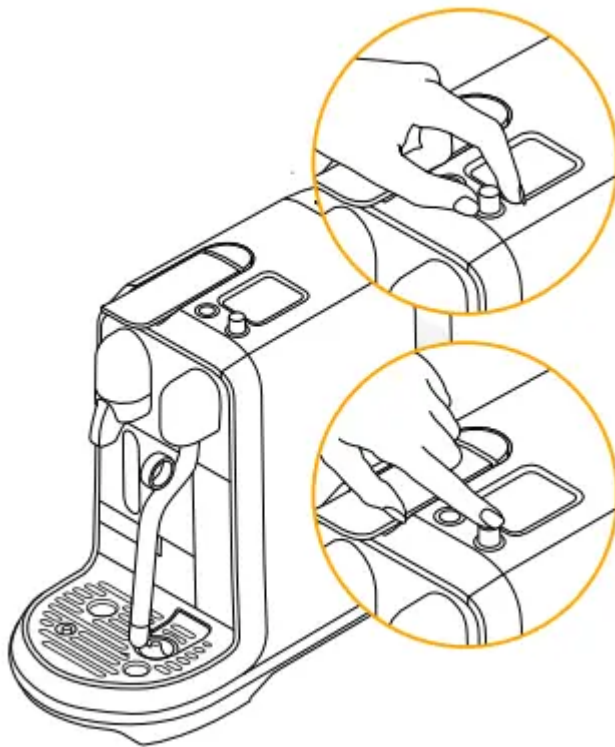

- ⑥ Setting your water hardness, dip the Water Hardness Test Strip in and out the water tank.
- Wait 1 minute. Set the water hardness by rotating the SELECT dial according to the results on the Test Strip. Press SELECT to confirm. For further information refer to pg 32.

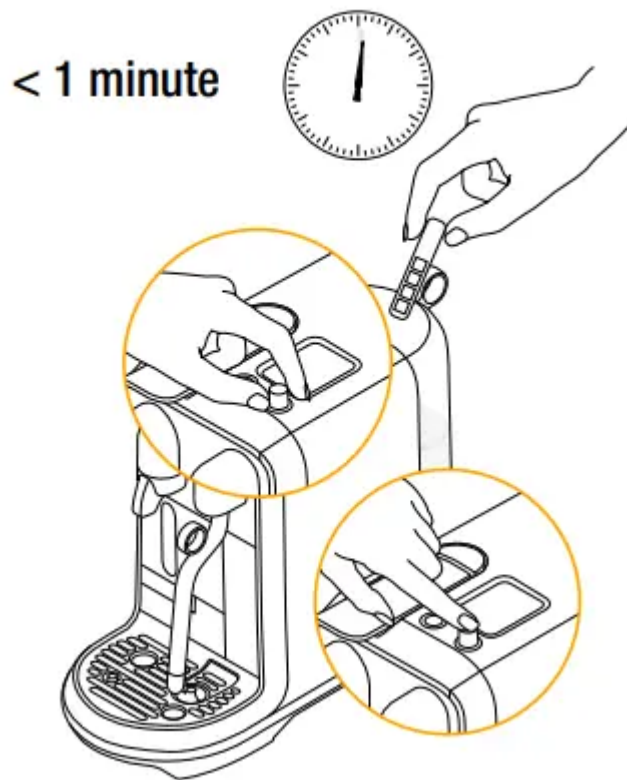

- 7 Follow the on-screen prompts to rinse & prepare your machine for use.



First use is to rinse the machine & prime the heating system

- 8 Follow the Quick Start Tutorial.



⑨ To turn OFF your machine, press and hold the START/CANCEL dial for 2 seconds until machine is off.



Navigation

① Rotate the SELECT dial to select your coffee

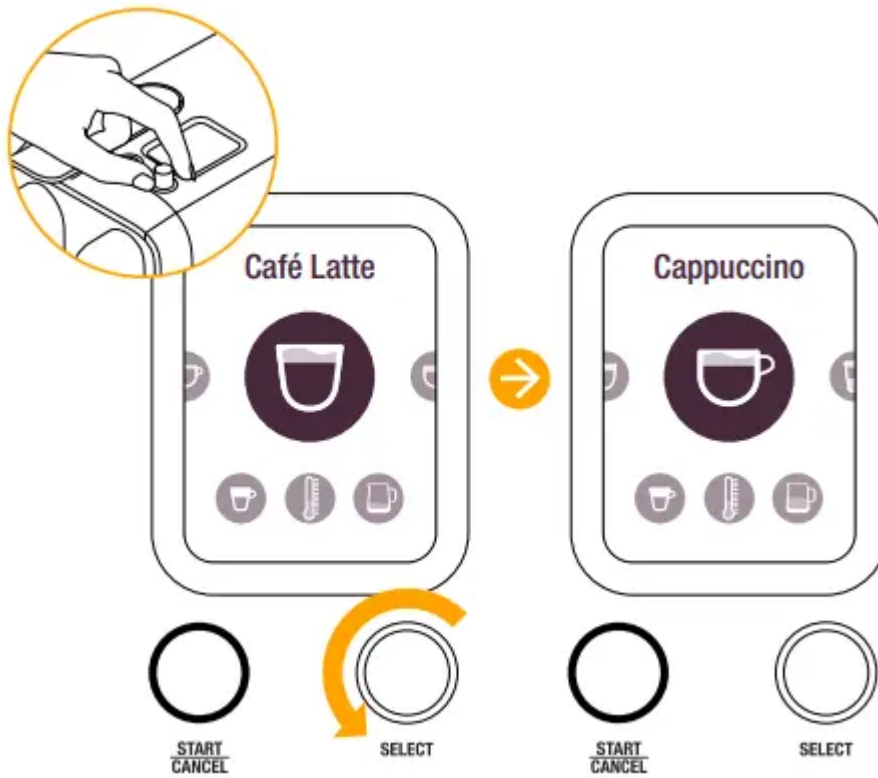

② Display shows current drink settings, Coffee Volume, Milk Temperature, Milk Texture.

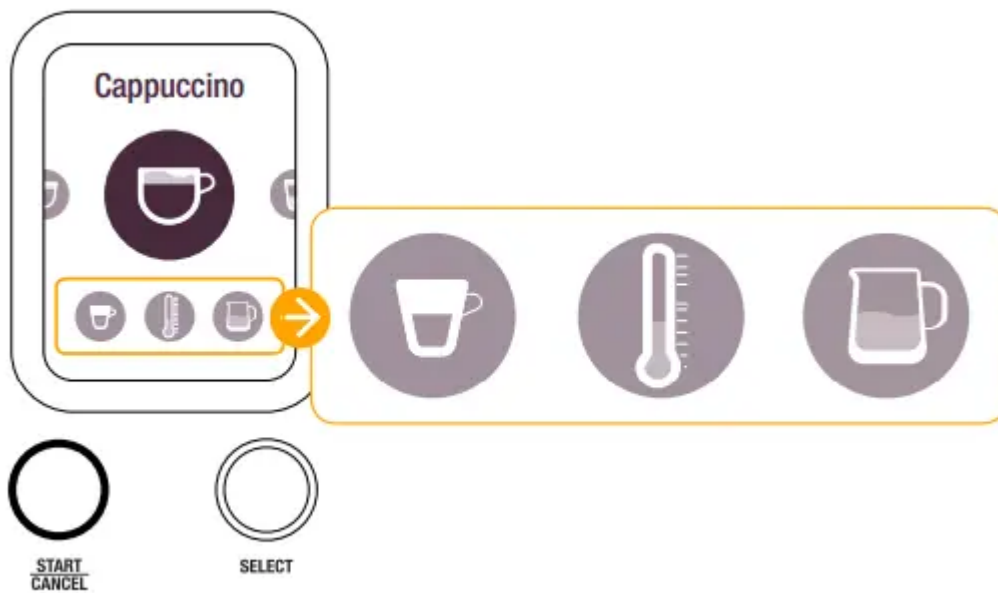

③ Press START|CANCEL to make a coffee with the current settings.



④ Press the SELECT dial to adjust the current settings. Refer Pg 25 & 26.



Regular Coffee Preparation

① Fill the water tank with potable water.





② Turn the machine ON by pressing the START|CANCEL button. Heating up takes approximately 3 seconds.



③ Place a cup under the coffee outlet. Use the cup support if required. PUSH the cup support to unlock.



④ Lift the Lever, insert a capsule and close the lever. Rotate SELECT dial to select your coffee

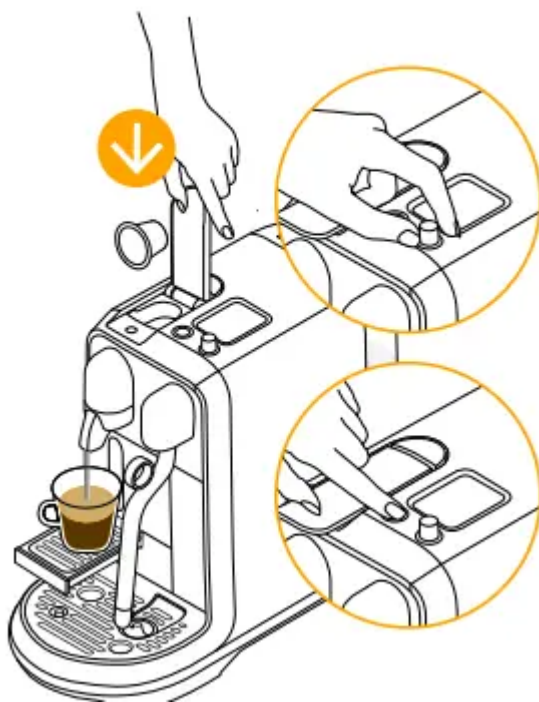

 Ristretto (25ml / 0.85 oz)

 Espresso (40 ml / 1.35 oz)

 Lungo (110 ml / 3.7 oz)

Press START|CANCEL button to extract

To ensure hygienic conditions, it is highly recommended to not reuse a used capsule.

- ⑤ Preparation will stop automatically. Lift the Lever to eject the capsule.



- ⑥ To stop the coffee flow press the START|CANCEL button.



Milk Coffee Preparation - Single Cup

Only use the milk jug provided.

TIP: For optimal milk froth, use pasteurized whole or semi skimmed milk at refrigerated temperature (about 4-6 °C / 39-43 °F).

- 1 Fill the water tank with fresh potable water.



- 2 To accommodate smaller cups, use the cup support. PUSH the cup support to unlock.

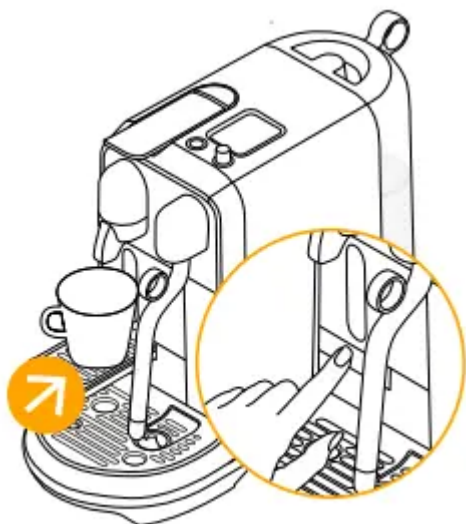

- 3 Rotate the SELECT dial to select your drink.



- 4 Fill the milk jug with enough fresh cold milk. Minimum and maximum levels are marked on the inside and outside of the milk jug.

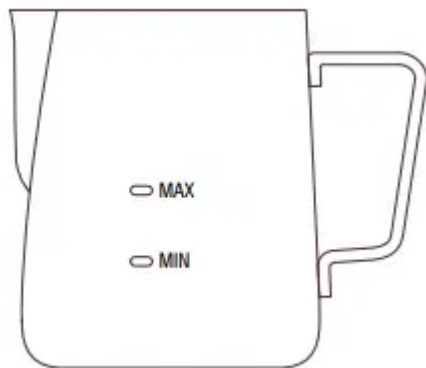

CAUTION: Do not fill milk jug above the maximum level marked on the inside & outside of the jug.

- 5 Lift the steam wand & position in the centre of the milk jug.



⑥ Ensure the milk jug is making contact with the temperature sensor located in the drip tray.

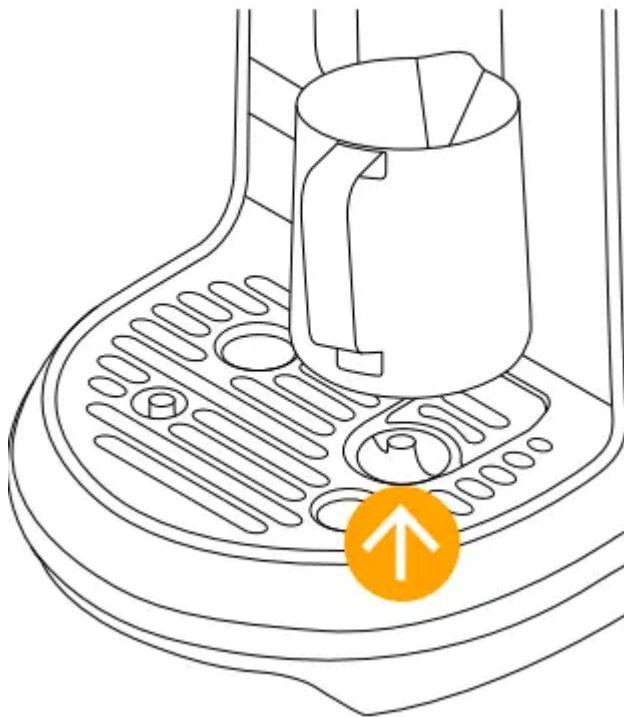

⑦ Lift the Lever & insert your capsule.



⑧ Press the START|CANCEL button to start the espresso extraction.



⑨ When the espresso extraction is complete, press START|CANCEL to begin milk frothing.



10. When milk frothing is complete, lift the steam wand, wipe with a clean damp cloth.



11. Allow steam wand to return to its down position & it will auto purge to rinse itself.



12. Pour milk into the espresso to finish your drink.



Milk Coffee Preparation - Two Cups

Only use the milk jug provided.

TIP: For optimal milk froth, use pasteurized whole or semi skimmed milk at refrigerated temperature (about 4-6 °C / 39-43 °F).

- 1 Fill the water tank with fresh potable water.



2 To accommodate smaller cups, use the cup support. PUSH the cup support to unlock.



3 Rotate the SELECT dial to select your drink.



4 Lift the Lever & insert your capsule.



⑤ Press the START|CANCEL button to start the espresso extraction.



⑥ Fill the milk jug with enough fresh cold milk for 2 drinks. Maximum level is marked on the inside and outside of the milk jug. Do not overfill.

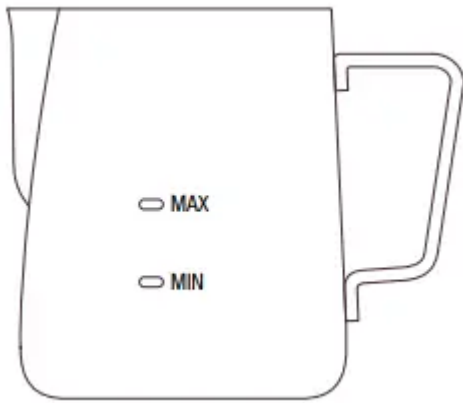

CAUTION: Do not fill milk jug above the maximum level marked on the inside & outside of the jug.

⑦ Lift the steam wand & position in the centre of the milk jug and press START|CANCEL to begin milk frothing.



⑧ Ensure the milk jug is making contact with the temperature sensor located in the drip tray.

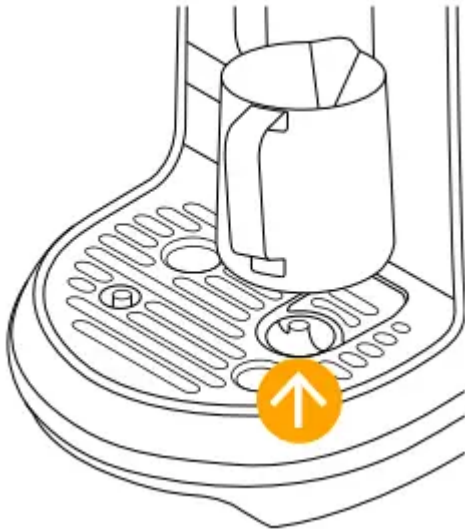

⑨ When milk frothing is complete, lift the steam wand, wipe with a clean damp cloth.



10. Allow steam wand to return to its down position & it will auto purge to rinse itself.



11. Place your second cup under the coffee spout.



12. Lift the Lever & insert your capsule.



13. Press the START|CANCEL button to start the espresso extraction.



14. Pour milk into the espresso to finish your drinks.



Latte Macchiato Preparation

- 1 Fill the water tank with fresh potable water.



- 2 To accommodate a Latte Macchiato glass, push the cup support in until it locks.



③ Rotate the SELECT dial to select your drink.



4. Fill the milk jug to the marked maximum level with fresh cold milk

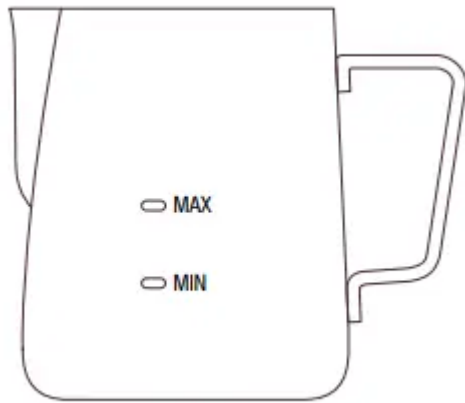

5 Lift the steam wand & position in the centre of the milk jug and press START|CANCEL to begin milk frothing



6. Ensure the milk jug is making contact with the temperature sensor located in the drip tray

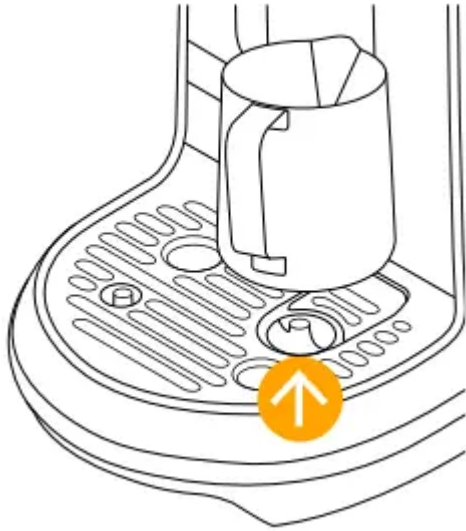

7. When milk frothing is complete, lift the steam wand, wipe with a clean damp cloth.



8. Allow steam wand to return to its down position & it will auto purge to rinse itself.



9. Pour milk into the Latte Macchiato glass and place under the coffee spout.



10. Lift the Lever & insert your capsule.

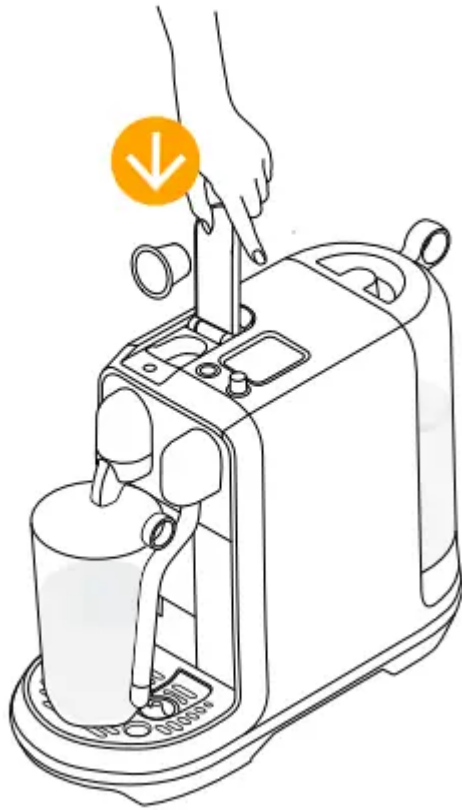

11. Press the START|CANCEL button to start the espresso extraction.





Reset to Factory Settings

① Drink Settings are:



- Coffee Volume, Milk Temperature and Milk Froth.



To reset your drink settings:

1. Select SETTINGS
2. Select RESET
3. Select COFFEE RESET
4. Select  to confirm
5. Select  to cancel

To reset factory settings:

1. Select SETTINGS
2. Select RESET
3. Select FACTORY RESET
4. Select  to confirm
5. Select  to cancel
6. Machine will power off
7. On next use, you will need to refer to first use instructions

Emptying the System before a period of non-use or for frost protection /

- 1 Remove the water tank. Place the empty Milk Jug under the coffee outlet.



② Rotate the SELECT dial to MAINTENANCE, press SELECT dial. Select "Empty Cycle" & press SELECT to start. When the pump stops, empty & wipe dry the capsule bucket & drip tray.

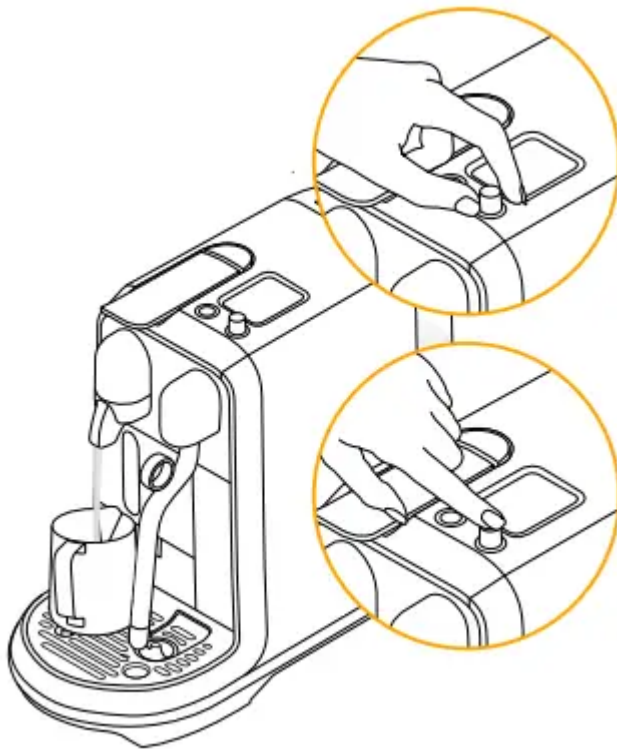

Energy Saving

- ① Energy efficient: Machine uses <math><0.2\text{W}</math> when not making a drink. The display dims after 2 mins of no use, after 10 mins of no use display turns off. Restart by pressing the START|CANCEL button.



Daily Cleaning

To ensure hygienic conditions, it is highly recommended emptying and cleaning the capsule container every day.

- ① Empty the drip tray and the capsule container every day. Remove cup support by first removing the capsule bucket, then unlocking the cup support, pulling the cup support forward & lifting it upwards to disengage from the machine. Clean cup support and wipe inside machine, reassemble with a clean damp cloth. Remove the water tank and lid and clean them both with odorless detergent and rinse with warm water. Refill the water tank with fresh potable water.

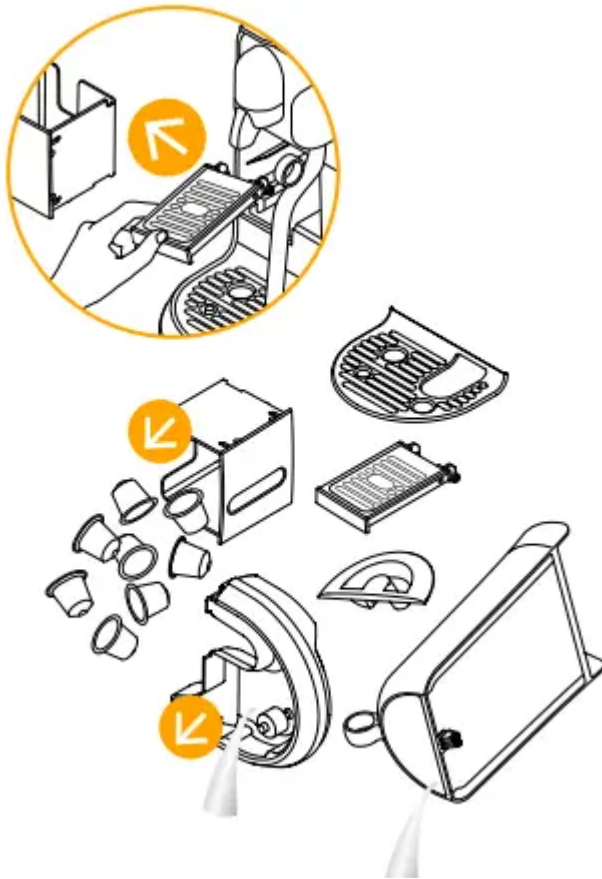

② Rinse the milk jug & dry after each use. If required, wash the jug with mild detergent.



③ Use the STEAM PURGE function on the display to further rinse the steam wand if required. Wipe the steam wand & tip with a clean damp cloth.

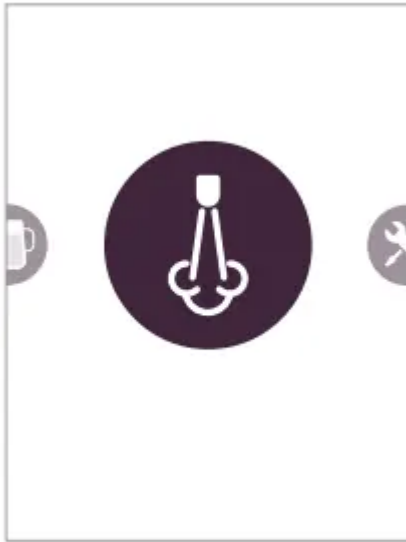

④ Do not use any strong or abrasive solvent, sponge or cream cleaner. Do not put in the dishwasher.



5. Dry all the parts with a repetitive soft clean cloth and reassemble all parts. Clean the coffee outlet and inside the machine regularly with a clean damp cloth.



6. Never immerse the appliance or part of it in water or any other liquid.



Steam Wand Cleaning Procedure

Milk System Cleaning Procedure. Recommended you perform this monthly to prevent steam tip blockages or when the display shows "Clean Steam Wand".

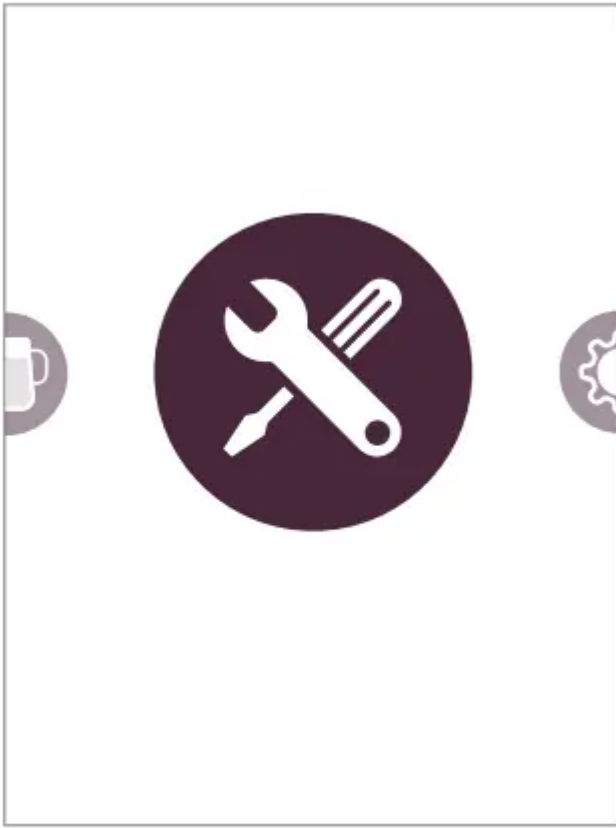

1 Select Maintenance

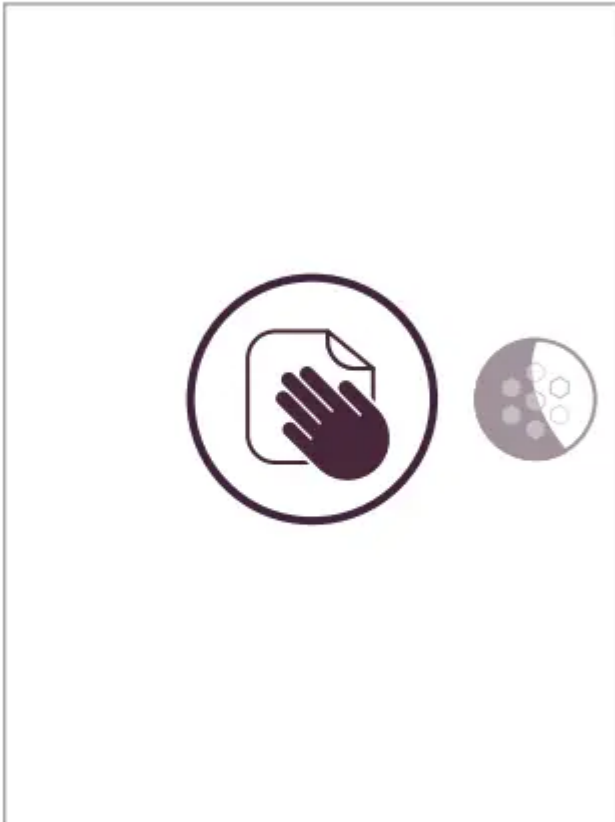

② Select Cleaning

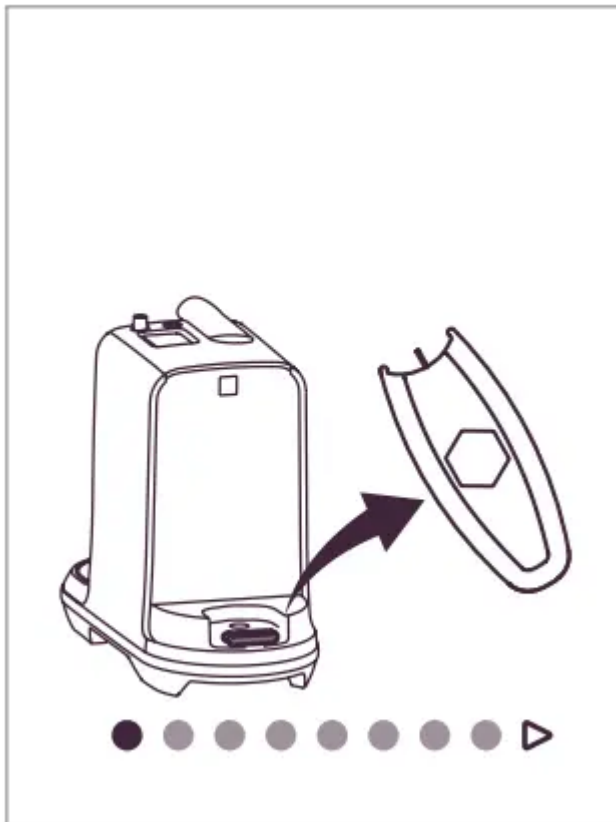

③ Follow the on-screen prompts

Descaling

Duration approximately 15 minutes.

Read the important safeguard on the descaling package and refer to the table for the frequency of use. The descaling solution can be harmful. Avoid contact with eyes, skin and surfaces. Never use any product other than the Nespresso descaling kit available at the Nespresso Club to avoid damage to your machine. The following table will indicate the descaling frequency required for the optimum performance of your machine, based on water hardness. For any additional questions you may have regarding descaling, please contact the Nespresso Club.

Descaling: Removes scale build-up, maintains coffee taste and prevents machine damage. Frequency will depend on your water hardness & amount of use. Descale when prompted on-screen. The machine will stop you from use if the descale cycle has not been performed after 10 uses. A "lockout" count-down will appear to alert you of the number of uses remaining until usage will stop.

① Rotate dial to select MAINTENANCE

② Select DESCALE

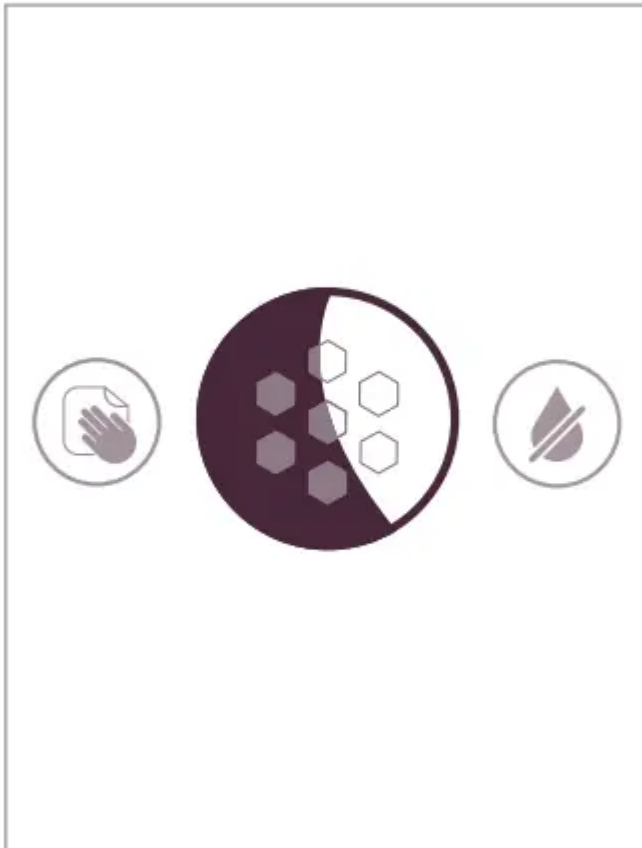

3 Follow the on-screen prompts to complete

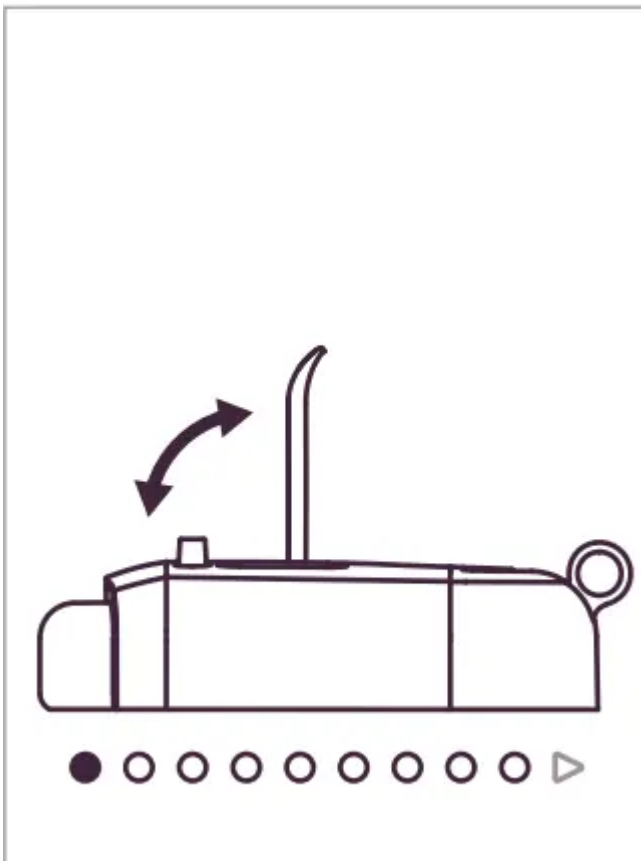

Water Hardness

To determine water hardness level use the test strip provided.

To change the water hardness setting:

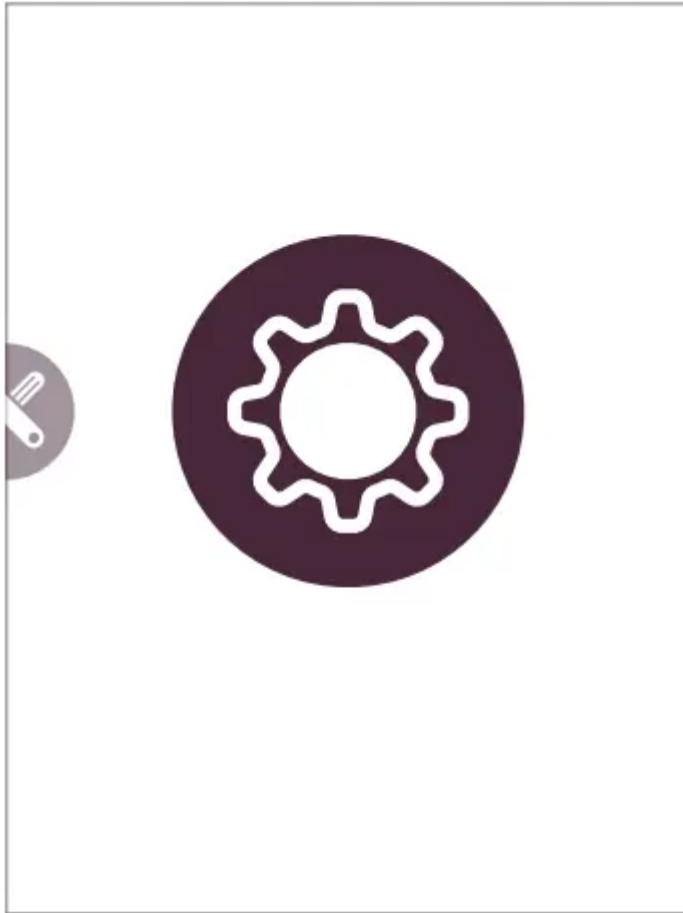



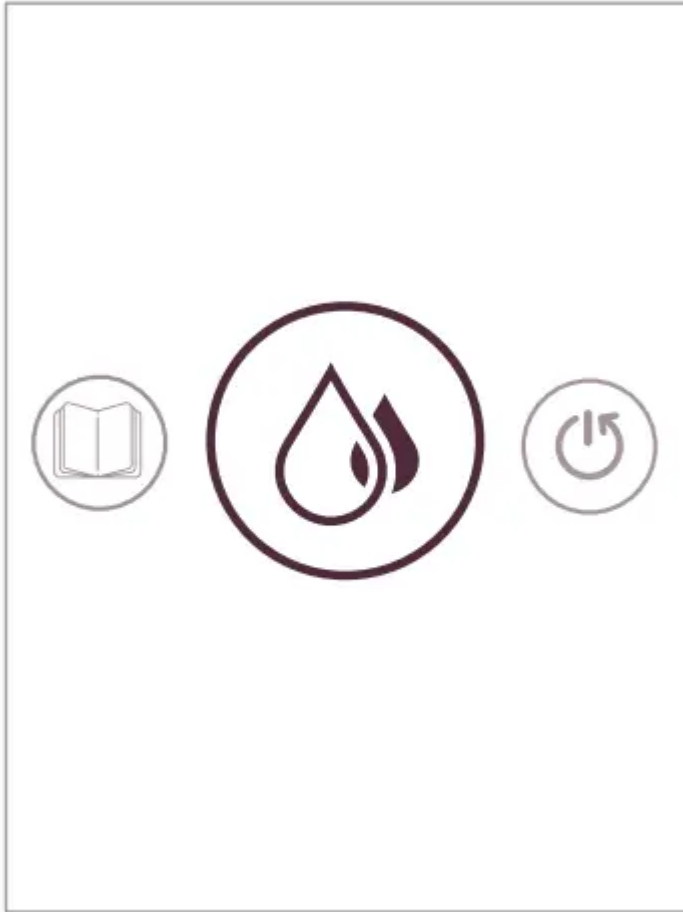



- 1 Rotate dial to select SETTINGS



② Select Water Hardness



③ Follow the on-screen prompts to complete

Water hardness:*	App.	fH	dH	Descaling after:*	
				CaCO ₃	 (40 ml)
	Level 0	<5	<3	< 50 mg/l	4 000
	Level 1	>7	>4	> 70 mg/l	3 000
	Level 2	>13	>7	> 130 mg/l	2 000
	Level 3	>25	>14	> 250 mg/l	1 500
	Level 4	>38	>21	> 380 mg/l	1 000

fH French degree
dH German Grade
CaCO₃ Calcium Carbonate

Troubleshooting



Buttons not illuminated.	<ul style="list-style-type: none"> • Machine turns OFF automatically. See paragraph on «Energy Saving Concept». • Press START/CANCEL or SELECT to turn to «ON-mode». 	<ul style="list-style-type: none"> • Check the outlet: plug, voltage, fuse.
No steam or hot water	<ul style="list-style-type: none"> • Press START/CANCEL or SELECT to turn to «ON-mode». 	<ul style="list-style-type: none"> • Check the outlet: plug, voltage, fuse.
No coffee, no water, unusual coffee flow.	<ul style="list-style-type: none"> • Check if the water tank is correctly positioned, if empty, fill with potable water. 	<ul style="list-style-type: none"> • Descale the machine, if necessary.
The capsule lever does not close completely	<ul style="list-style-type: none"> • Empty the capsule container. 	<ul style="list-style-type: none"> • Check that no capsule is stuck inside the machine. (Note: do not put the finger inside the machine)
Leakage (water under the machine).	<ul style="list-style-type: none"> • Empty drip tray if full. • Check drip tray is securely inserted. 	<ul style="list-style-type: none"> • If problem persists, call Nespresso Club.
No coffee flow, water goes directly into the capsule bucket (despite inserted capsule).	<ul style="list-style-type: none"> • Ensure capsule lever is closed. 	<ul style="list-style-type: none"> • Empty capsule bucket and check that no capsule is blocked inside the machine. (NOTE: do not put the finger inside the machine) If problem persists, call the Nespresso Club.
Colour display is dim and hard to see/read	<ul style="list-style-type: none"> • Machine display dims automatically after 2 minutes of non use. • See paragraph on «Energy Saving Concept». • Press START/CANCEL or SELECT to turn to «ON-mode». 	<ul style="list-style-type: none"> • Adjust the screen brightness setting. Navigate to Settings menu. Select Screen Brightness. Turn the dial and Select OK.
Buttons flashing	<ul style="list-style-type: none"> • Follow on screen prompt. • Check the water tank. If empty, fill with potable water and brew a coffee.- Check steam tip for blockages. Use pin cleaning tool 	<ul style="list-style-type: none"> • Descale machine, if necessary. • Complete a Cleaning cycle if necessary.

	stored under the water tank to unblock each of the holes.	
Fill Water Tank alert remains on display (water tank is full)	<ul style="list-style-type: none"> • Check if the water tank is correctly positioned. 	<ul style="list-style-type: none"> • If problem persists, call the Nespresso Club.
Descal Now alert is displayed	<ul style="list-style-type: none"> • Descale the machine. Navigate to Maintenance menu. • Select Descal and follow the on-screen prompts. 	
Machine Error message is displayed	<ul style="list-style-type: none"> • A major fault has occurred. 	<ul style="list-style-type: none"> • Visit Nespresso.com or call the Nespresso Club to contact your local service centre.
Machine is ON but ceases to operate	<ul style="list-style-type: none"> • Power machine off by holding START/CANCEL. • Wait 60 minutes and press START/CANCEL or SELECT to turn to «ONmode». 	<ul style="list-style-type: none"> • If problem persists, call the Nespresso Club.
Machine turns to OFF mode.	<ul style="list-style-type: none"> • To save energy the machine will turn to OFF mode after 10 minutes of non use. See paragraph on «Energy Saving Concept». 	<ul style="list-style-type: none"> • Press START/CANCEL or SELECT to turn to «ONmode».
Milk steam cycle does not start	<ul style="list-style-type: none"> • Check if the water tank is correctly positioned, if empty, fill with potable water. • Check steam tip for any blockages and ensure wand is lowered. 	
Quality of froth not up to standard	<ul style="list-style-type: none"> • Be sure to use whole or semi-skimmed milk at refrigerated temperature (about 4-6 °C / 39-40 °F). For a better result, the milk must be newly opened. • Check the milk froth setting. 	<ul style="list-style-type: none"> • Use the Breville milk jug • Clean both the milk jug and the steam wand after each use.- Clean the steam wand. Navigate to Maintenance menu. • Select Cleaning and follow the on-screen prompts.

Milk overflows	<ul style="list-style-type: none"> • Fill jug with appropriate milk volume. • Minimum fill level as marked on the inside & outside of the jug. • Maximum fill level as marked on the inside & outside of the jug. 	<ul style="list-style-type: none"> • To stop overflow, either reduce the initial volume of milk and/or the froth level. This varies depending on milk type.
Milk temperature is too hot	<ul style="list-style-type: none"> • Be sure to use the Breville milk jug provided. • Check the milk jug is positioned correctly on the milk jug temperature sensor. 	<ul style="list-style-type: none"> • Decrease the milk temperature setting.
Milk temperature is not hot enough	<ul style="list-style-type: none"> • Preheat cup. • Use the Breville milk jug provided. • Check the milk jug is positioned on the milk jug temperature sensor. 	<ul style="list-style-type: none"> • Increase the milk temperature setting. • Check the steam tip for blockage.
Lower Wand alert is displayed	<ul style="list-style-type: none"> • Ensure the steam wand is lowered. 	
Clean Steam Wand alert is displayed	<ul style="list-style-type: none"> • Clean the Steam Wand. 	<ul style="list-style-type: none"> • Navigate to Maintenance > Select Cleaning and follow the screen prompts.

Warning

This content is compiled from multiple sources and is provided for reference purposes only. It may not be complete or fully applicable to all situations. If you are unable to resolve your issue, please contact the product manufacturer or an authorized service provider for official support.