

DESCRIPTION

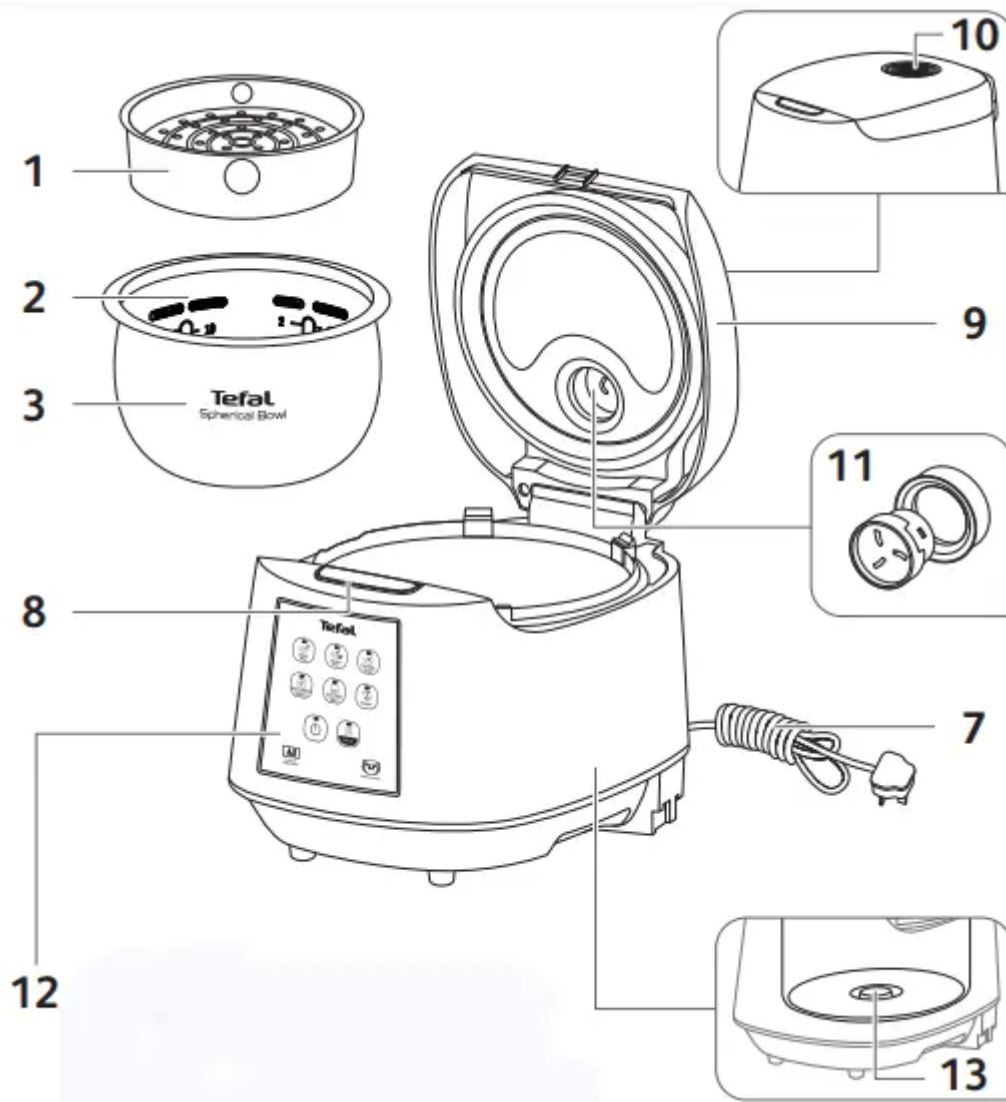

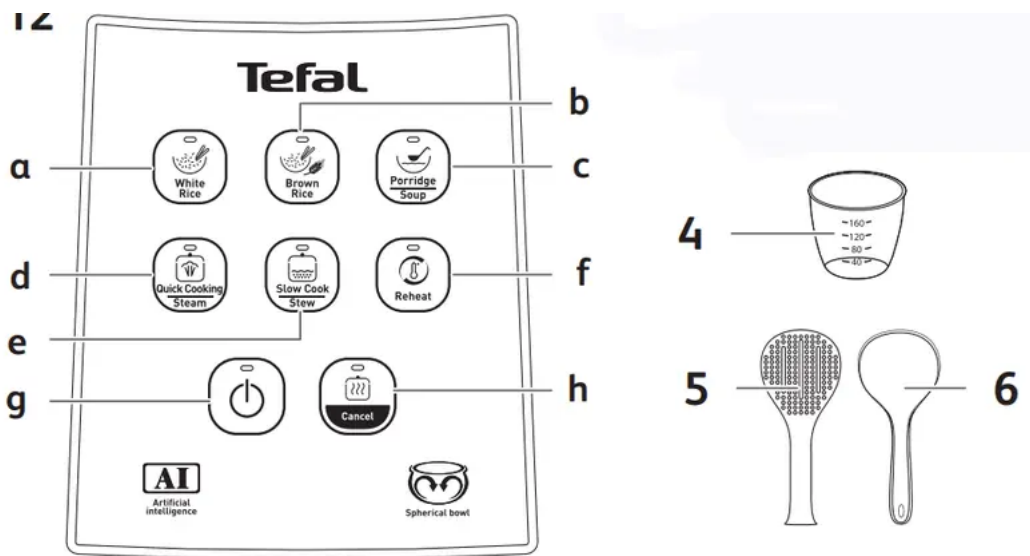

1. Steam basket
2. Graduation for water and rice
3. Removable Non-Stick bowl
4. Measuring cup
5. Rice spatula
6. Soup spoon
7. Power cord
8. Lid opening button
9. Lid
10. Steam vent
11. Steam valve
12. Control panel
 - a. White rice
 - b. Brown rice
 - c. Porridge/soup
 - d. Quick cooking/steam
 - e. Slow cook/stew
 - f. Reheat
 - g. Start
 - h. Keep warm/cancel
13. Sensor

IMPORTANT SAFEGUARDS SAFETY INSTRUCTIONS

Read and follow the instructions for use. Keep them safe.

- This appliance is not intended to be operated by means of an external timer or a separate remote- control system.
- This appliance can be used by children aged from 8 years and above if they have been given supervision or instruction concerning use of the appliance in a safe way and if they understand the hazards involved.Cleaning and user maintenance shall not be made by children unless they are older than 8 years and supervised. Keep the appliance and its cord out of reach of children aged less than 8 years.
- Appliances can be used by persons with reduced physical, sensory or mental capabilities or lack of experience and knowledge if they have been given supervision or instruction concerning use of the appliance in a safe way and understand the hazards involved.
- Children shall not play with the appliance.
- This appliance is not intended for use by persons (including children) with reduced physical, sensory or mental capabilities, or lack of experience and knowledge, unless they have been given supervision or instruction concerning use of the appliance by a person responsible for their safety.
- Children should be supervised to ensure that they do not play with the appliance.
- This appliance is for household use only. It is not intended for even use in the following applications and the guarantee will not apply for:
 - Staff kitchen areas in shops, offices and other working environments
 - Farm houses
 - By clients in hotels, motels and other such kind of residential type environments
 - Bed and breakfast type environments
- If your appliance is fitted with fixed power cord:** if the power supply cord is damage, it must be replaced by the manufacturer, the manufacturer's after-sales service department or similarly qualified person in order to avoid any danger.
- The appliance must not be immersed in water or any other liquid.
- Use a damp cloth or sponge with washing up liquid to clean the accessories and parts in contact with food. Rinse with a damp cloth or sponge. Dry carefully.
- If the symbol is marked on the appliance, this symbol means " Caution: surfaces may become hot during use ".
- Caution: the surface of heating element is subject to residual heat after use.

- Caution: risk of injury due to improper use of the appliance.
- Caution: if your appliance has a removable power cord, do not spill liquid on the connector.
- Always unplug the appliance:
 - immediately after use
 - when moving it
 - prior to any cleaning or maintenance
 - if it fails to function correctly
- Burns can occur by touching the hot surface of the appliance, the hot water, steam or the food.
- During cooking, the appliance gives out heat and steam. Keep face and hands away.
- Do not obstruct the steam outlet.
- For any problems or queries please contact our Customer Relations Team or consult our website.
- The appliance can be used up to an altitude of 2000 m.
- For your safety, this appliance complies with the safety regulations and directives in effect at the time of manufacture (Low-voltage Directive, Electromagnetic Compatibility, Food Contact Materials Regulations, Environment...).
- Check that the power supply voltage corresponds to that shown on the appliance (alternating current).
- Given the diverse standards in effect, if the appliance is used in a country other than that in which it is purchased, have it checked by an approved service centre.

CONNECTING TO THE POWER SUPPLY

- Do not use the appliance if:
 - the appliance or the cord is damaged.
 - the appliance has fallen or shows visible damage or does not work properly.
 - In the event of the above, the appliance must be sent to an approved service centre.
Do not take the appliance apart yourself.
- Do not leave the cord hanging.
- Always plug the appliance into an earthed socket.
- Do not use an extension lead. If you accept liability for doing so, only use an extension lead which is in good condition, has an earthed plug and is suited to the power of the appliance.
- Do not unplug the appliance by pulling on the cord.

USING

- Use a flat, stable, heat-resistant work surface away from any water splashes.
- Do not allow the base of the appliance to come into contact with water.
- Never try to operate the appliance when the pot is empty or without the pot.
- The cooking function/knob must be allowed to operate freely. Do not prevent or obstruct the function from automatically changing to the keep warm function.
- Do not remove the pot while the appliance is working.
- Do not put the appliance directly onto a hot surface, or any other source of heat or flame, as it will cause a failure or danger.
- The pot and the heating plate should be in direct contact. Ensure that no food or liquid is inserted between the pot and heating plate.
- Do not place the appliance near a heat source or in a hot oven, as serious damage could result.
- Do not put any food or water into the appliance until the pot is in place.
- Respect the levels indicated in the recipes.
- Should any part of your appliance catch fire, do not attempt to put it out with water. To smother the flames use a damp teatowel.
- Any intervention should only be made by a service centre with original spare parts.
- Always disconnect the appliance from the supply if it is left unattended and before assembling, disassembling or cleaning.

PROTECT THE ENVIRONMENT

- Your appliance has been designed to run for many years. However, when you decide to replace it, remember to think about how you can contribute to protecting the environment.
- Before discarding your appliance you should remove the battery from the timer and dispose of it at a local civic waste collection centre (according to model).

Environment protection first!

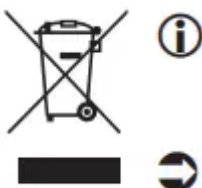

recycled.

Your appliance contains valuable materials which can be recovered or

Leave it at a local civic waste collection point.

BEFORE FIRST USE

- Open the lid by pressing the opening button located on the top lid. – Fig. 1



- Remove the spherical pot and clean the pot with a sponge and washing up liquid. – Fig. 2

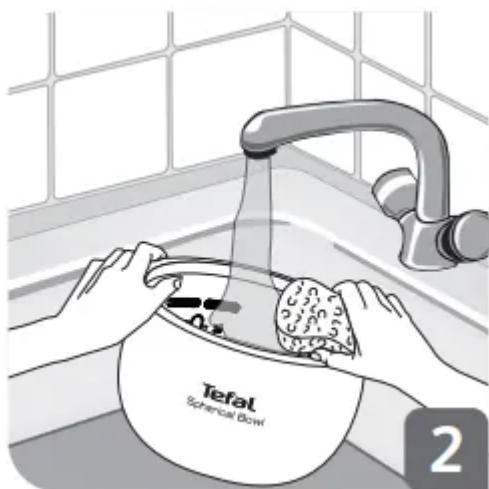

- Wipe the outside of the appliance with a damp cloth. – Fig. 3



USING YOUR RICE COOKER

Measuring the ingredients - Max capacity of the bowl

- The graduated markings on the inside of the bowl are given in cups, these are used for measuring the amount of water when cooking rice and other cereals. There are 3 kinds of water level marks for 3 different kinds of rice: white rice, brown rice, Jasmine rice. And one water level mark for porridge and congee.
- The maximum quantity of water + rice should not exceed the 10 cup mark inside the bowl. – Fig. 4.



- The plastic cup provided with your appliance is for measuring rice and other cereals.
- To cook 1 cup of white rice (serves 2 small or 1 large portion), use 1 measuring cup of white rice and then add 1 1/2 measuring cup of water. To cook other quantity of rice, refer to cooking guide below.

Measuring cups of white rice	Water level in the bowl (+ rice)	Serving per person
2	2 cup white rice mark	3-4
4	4 cup white rice mark	5-6
6	6 cup white rice mark	8-10
8	8 cup white rice mark	11
10	10 cup white rice mark	13

Note: Always add the rice first otherwise you will have too much water.

COOKING PROGRAM

- Press program name key to select different program – Fig. 5. The light of selected program lights up and the “Start” light will flash. Press “Start” to start cooking. – Fig. 6

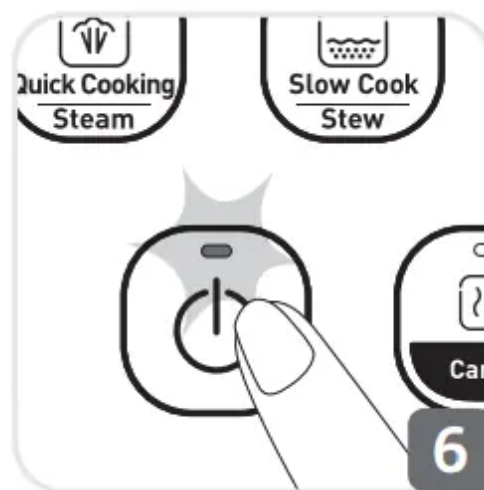

- After simmering, the rice cooker will enter keep warm automatically.
- If you wish to change the selected cooking menu or have chosen the incorrect setting, press “Keep warm/Cancel” button – Fig. 7 and choose the function you want. Press “Keep warm/Cancel” key under standby status, the light of “Keep warm/Cancel” button lights up, the appliance will start to keep warm.



	Programs	Cooking time	Temperature	Delayed Start	Keep warm
1	White Rice	Auto	Auto	NA	12h
2	Brown Rice	Auto	Auto	NA	12h
3	Porridge/ Soup	1h30min	Auto	NA	12h
4	Slow Cook	8h	95°C	NA	12h
5	Steam	Auto	Auto	NA	12h
6	Quick Cooking	Auto	Auto	NA	12h
7	Reheat	25min	Auto	NA	12h
8	Keep warm	12h	Auto	NA	-

Note: It takes around 43 minutes to cook 4 cups of white rice under the normal condition and if you use Quick Cooking function you will save around 9 minutes.

NOTE

- Do not open the lid during cooking as steam will escape and this will affect the cooking time and the taste.
- On completion of cooking, when the “KEEP WARM” indicate light is on, stir the rice and then leave it in the rice cooker for a few minutes longer in order to get perfect rice with separate grains.
- Do not touch the heating element when the product is plugged in.**

- Carefully wipe the outside of the bowl (especially the bottom). Make sure that there are no foreign residues or liquid underneath the bowl and on the heating element.
- Never place your hand on the steam vent during cooking, as there is a danger of burns. – Fig. 8



- Only use the inner pot provided with the appliance.
- Do not pour water or put ingredients in the appliance without the bowl inside.

TROUBLESHOOTING



Malfunction description	Cause	Solution
Any indicator light off and no heating.	Appliance not plugged in.	Check the power cord is plugged in the socket and on the Mains.
Any indicator light off and heating.	Indicator light is damaged or has a connection error.	Send to authorized service center for repair.
	Lid is not properly closed.	Open and ensure the lid is closed properly.
	Micro pressure valve incorrectly position or incomplete.	Stop the cooking (unplug the product) and check the valve is complete (2 parts locked together) and well positioned.
	Lid or micro pressure valve gasket is damaged.	Send to authorized service center for repair.
Rice undercooked or overcooked.	Too much or not enough water compared to rice quantity.	Refer to table for water quantity.
Automatic warm-keeping fails (product stay in cooking position, or no heating).		Send to the authorized service center for repair.
Lights under the “Start”and “Cancel” button light on at the same time (E1).	The sensor on the bottom open or short circuit.	Send to the authorized service center for repair.

Warning

This content is compiled from multiple sources and is provided for reference purposes only. It may not be complete or fully applicable to all situations. If you are unable to resolve your issue, please contact the product manufacturer or an authorized service provider for official support.

Document generated by [ManualsFile](#)