

Installing your lamp dimmer

1. Turn on the lamp

Turn on the lamp you want to control and unplug it.

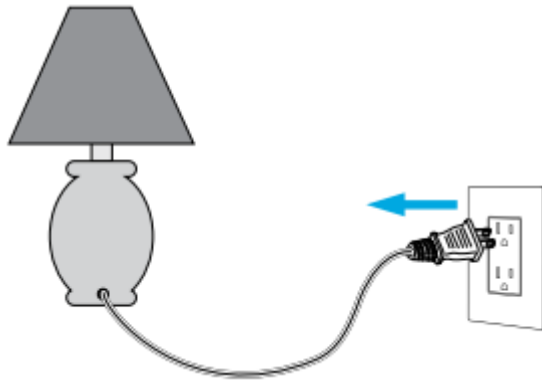

2. Connect the lamp(s)

Plug the lamp cord into either side of the Caséta wireless plug-in dimmer.

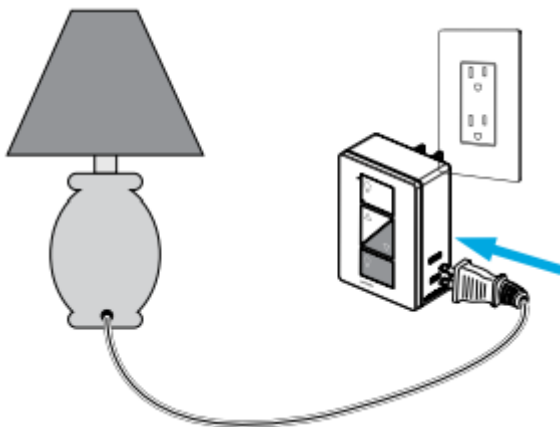

If you want to control a second lamp turn it on and plug it into the other side.

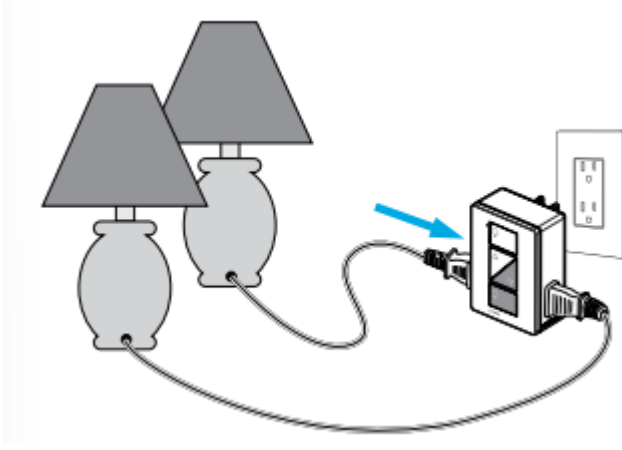

3. Plug in the lamp dimmer

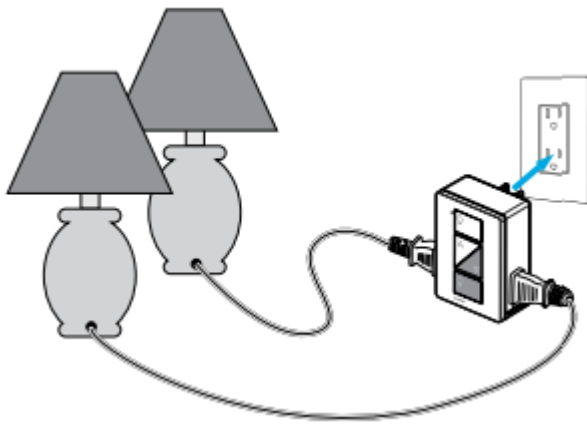

Important note:

Use only with dimmable LED, dimmable CFL, halogen, or incandescent lamps.

Do not exceed the total maximum wattage shown below:

Bulb	Maximum Wattage
LED & CFL	100 W
or*	
Incandescent & Halogen	300 W

Using your dimmer and remote control

Pairing the lamp dimmer and Pico remote control

1. Press and hold “off” button on dimmer

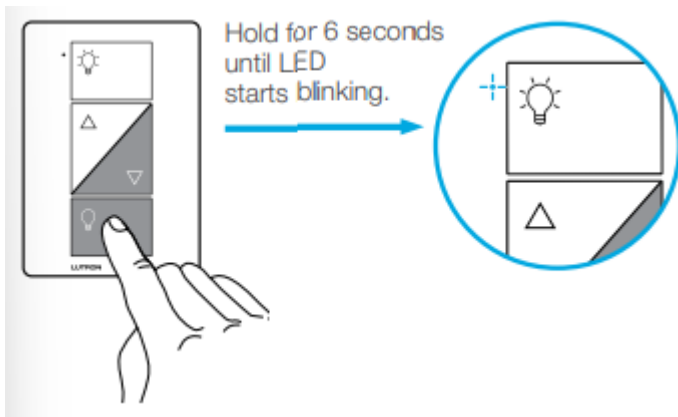

2. Press and hold “off” button on remote

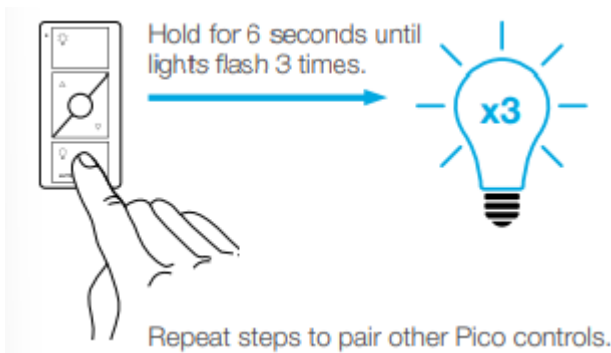

Changing the favorite light level on the Pico remote control (optional)

You can use the round “favorite” button on the Pico remote control to recall a favorite light level. We’ve set it to 50%, but you can change it to any level you like.

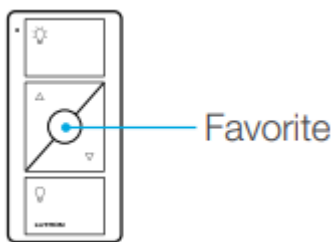

3. Set desired light level on dimmer

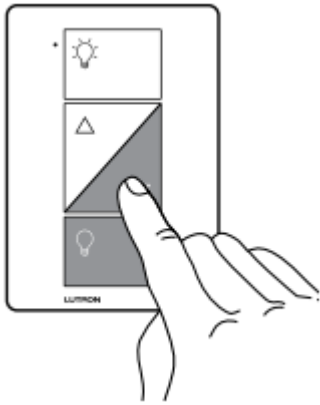

4. Press and hold “favorite” button on remote

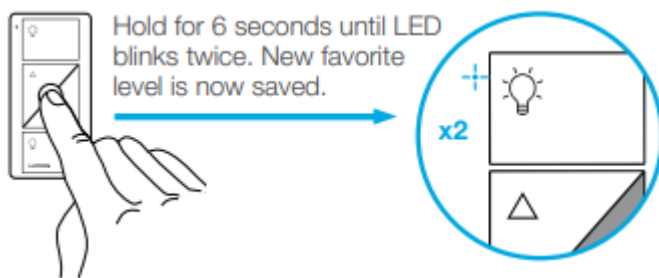

Using your controls

Now that you’ve installed the plug-in lamp dimmer, you can control your lights from either the dimmer or the Pico remote control.

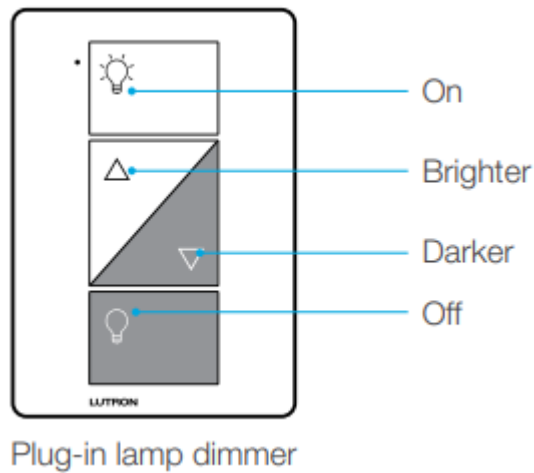

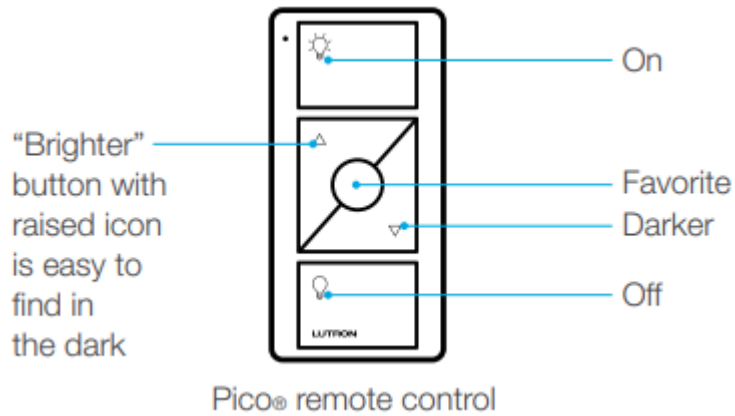

For advanced features, tips for using Caséta Wireless dimmers with CFLs and LEDs, the complete Caséta Wireless product line, and more, please visit website.

Important notes:

1. For indoor use only.
2. Operate between 32 °F (0 °C) and 104 °F (40 °C).

Device Ratings

Plug-in Lamp Dimmer

PD-3PCL-WH

120 V~ 50/60 Hz

Remote control

PJ2-3BRL-L01R

3 V- 10 mA

(1) CR2032 battery (included)

Troubleshooting



Symptoms	Probable cause and action
Lamp does not turn on or lamp dimmer LED does not light up.	<ul style="list-style-type: none"> • Light bulb(s) burned out. • Lamp is turned off. • Lamp is not plugged in.
Light does not respond to Pico remote control.	<ul style="list-style-type: none"> • The dimmer failed to pair with Pico remote control; see Pairing the lamp dimmer and Pico remote control. • The dimmer is already at the light level the Pico remote control is sending. • The Pico remote control is outside the 30 ft (9 m) operating range. • The Pico remote control batteries are low. • The Pico remote control batteries are installed incorrectly.
<ul style="list-style-type: none"> • Bulbs turn off while being dimmed. • Bulbs turn on at high light level but do not turn on at a low light level. • Bulbs flicker or flash when dimmed to a low light level. 	Verify bulbs are marked dimmable and visit website for information on adjusting the dimmer for best bulb performance.

CAUTION To avoid overheating and possible damage to other equipment, do not use to control motor-driven appliances, or transformer-supplied appliances.

Codes Install in accordance with all national and local electrical codes.

Warning

This content is compiled from multiple sources and is provided for reference purposes only. It may not be complete or fully applicable to all situations. If you are unable to resolve your issue, please contact the product manufacturer or an authorized service provider for official support.



