

## Parts and Features

### Front & Rear view

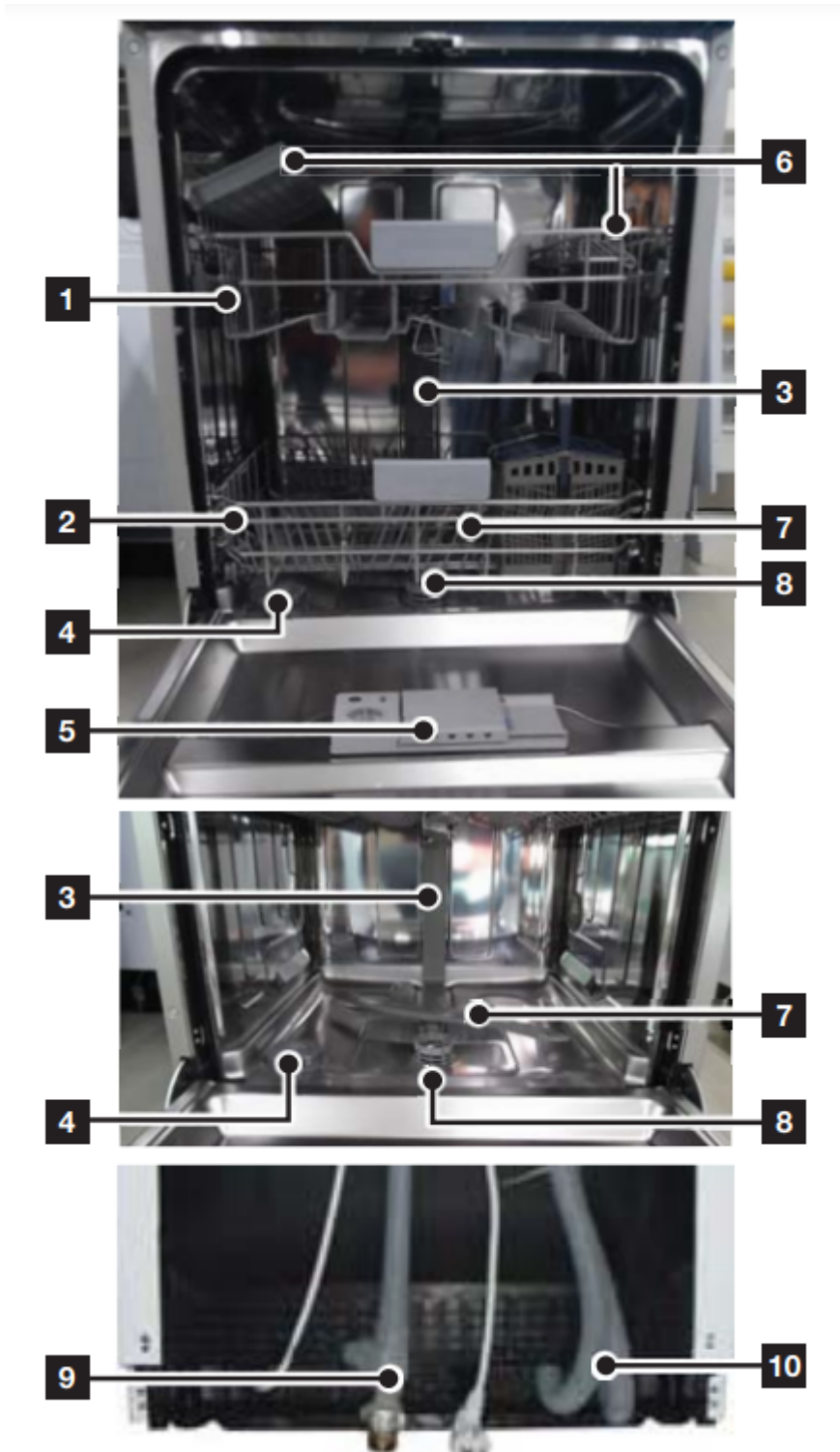

- 1. Upper Basket
- 2. Lower Basket



3. Duct Nozzle
4. Salt Container
5. Dispenser
6. Cup Shelf
7. Spray arms
8. Filter assembly
9. Drain hose
10. Inlet hose

## CONTROL PANEL



<b>1. Power</b>	Press this button to turn on your dishwasher: the screen lights up.
<b>2. Program</b>	To select washing program press this button.
<b>3. Half load</b>	For small amount of loading items, use either the upper or lower basket only to save energy.  Press the Half load button to select the upper or lower basket.
<b>4. Control lock</b>	This option allows you to lock the buttons on the control panel so children cannot accidentally start the dishwasher by pressing the buttons on the panel.  To lock and unlock the buttons on the control panel, hold down both the <b>Control lock</b> buttons for three (3) seconds.
<b>5. Display window</b>	Running indicator, delay time, error codes and etc.
<b>6. Start</b>	To start a cycle, press the <b>Start</b> button before closing the door.  <b>*Reset</b> : To cancel a currently running cycle and drain the dishwasher, press and hold the Start button for three (3) seconds.  Once the dishwasher is reset, select a cycle and option, and then press <b>Start</b> to restart the dishwasher.
<b>7. Delay start</b>	Press this button to set the delayed hours for washing. You can delay the start of washing up to 24 hours. One press on this button delays the start of washing by one hours.
<b>8. Hygiene</b>	Push the <b>Hygiene</b> button for the best possible hygiene in your dishwasher. At the final rinse it heat up to 67 °C and hold this temperature for a several minutes. This function is available with all program except Quick Wash and Pre Wash.
<b>9. Multi tab</b>	To select Multi tap option which needs salt and rinse aid but a Multi tab tablet. This option can be selected on Intensive, Auto or ECO program only.



**Notes:**

- When the door is open only the Power button will operate.
- You can select options (Multi tap, Delay start and/or Half load) before starting a cycle.

**IMPORTANT:** To get the best performance from your dishwasher, read all the operating instructions before using it for the first time.



m	<b>Power</b>	Press this button to turn on your dishwasher : the screen lights up.
©	<b>Cycle</b>	To select washing program press this button.
©	<b>Upper</b>	<p>When you select <b>Upper</b>, only the upper rack nozzle is activated. The lower nozzle will not operate.</p> <p>Use this feature to wash a small load of dishes or glasses placed in the upper rack.</p> <p><b>Note:</b> When you select <b>Upper</b>, place dishes, glasses, etc. in the upper rack only. The dishwasher will not wash items placed in the lower rack.</p> <p>Selecting <b>Upper</b> reduces both the cycle time and the amount of electricity consumed.</p>
s	<b>Lower</b>	<p>When you select <b>Lower</b>, only the lower rack nozzle is activated. The upper nozzle will not operate.</p> <p>Use this feature to wash a small load of dishes or glasses placed in the lower rack.</p> <p><b>Note:</b> When you select <b>Lower</b>, place items, glasses, etc. in the lower rack only. The dishwasher will not wash items placed in the upper rack.</p> <p>Selecting <b>Lower</b> reduces both the cycle time and the amount of electricity consumed.</p>
©	<b>Hygiene</b>	Push the <b>Hygiene</b> button for the best possible hygiene in your dishwasher. At the final rinse it heat up to 67 °C and hold this temperature for a several minutes. This function is available with all program except Quick Wash and Pre Wash.
©	<b>Multi tab</b>	To select <b>Multi tap</b> option which needs salt and rinse aid but a <b>Multi tap</b> tablet. This option can be used with all program except Auto, Quick Wash and Pre Wash.
0	<b>Control lock</b>	This option allows you to lock the buttons on the control panel so children cannot accidentally start the dishwasher by pressing the buttons on the panel.

		To lock and unlock the buttons on the control panel, hold down both the <b>Control lock</b> buttons for three (3) seconds.
0	<b>Indicator</b>	<p>If <b>Rinse Refill</b> or <b>Salt Refill</b> indicator is lit, it means rinse or salt is needed to refill.</p> <p> <b>Delay start</b> Indicator</p> <ul style="list-style-type: none"> <li>• If the "<b>Delay start</b>" indicator is lit, it means, you select "<b>Delay start</b>" option.</li> </ul> <p> <b>Rinse Refill</b> Indicator</p> <ul style="list-style-type: none"> <li>• If the "<b>Rinse Refill</b>" indicator is lit, it means the dishwasher is low on dishwasher rinse aid and requires a refill.</li> </ul> <p> <b>Salt Refill</b> Indicator</p> <ul style="list-style-type: none"> <li>• If the "<b>Salt Refill</b>" indicator is lit, it means the dishwasher is low on dishwasher salt and needs to be refilled.</li> </ul>
0	<b>Display</b>	Display the remaining time, error code, or delay time.
0	<b>Delay start</b>	Press this button to set the delayed hours for washing. You can delay the start of washing up to <b>24</b> hours. One press on this button delays the start of washing by one hours.
0	<b>Start</b>	<p>To start a cycle, press the <b>Start</b> button before closing the door.</p> <p><b>*Reset</b> : To cancel a currently running cycle and drain the dishwasher, press and hold the <b>Start</b> button for three (3) seconds.</p> <p>Once the dishwasher is reset, select a cycle and option, and then press <b>Start</b> to restart the dishwasher.</p>

**Note:**

You can select options (Multi tab, Half load, Delay, Hygiene) before starting a cycle.

To prevent the touchpad from losing response sensitivity, follow these instructions:

- Touch the center of each keypad using one finger. Do not push.
- Clean the touch control's surface regularly with a soft, damp cloth.
- Be careful not to touch more than one touch key pad at a time, except as directed.

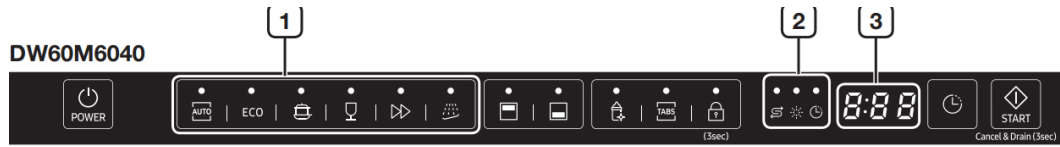
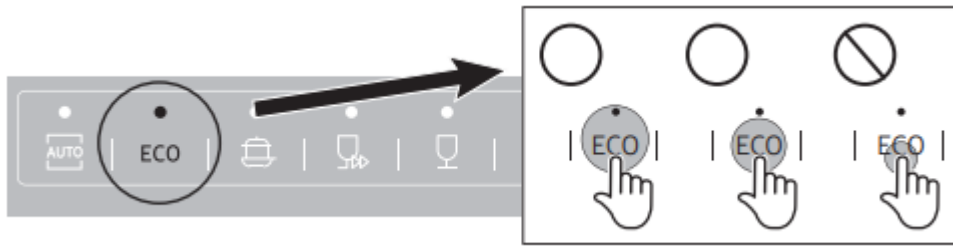

<b>1</b>	<b>Program icons</b>	Press the <b>Program</b> button to select each program.
	<b>Auto wash</b>	Lightly to heavily soiled daily using items, automatic detection of the amount of soils.
ECO	<b>ECO</b>	Normally soiled daily using items, with reduced energy and water consumptions.
	<b>Intensive</b>	Heavily soiled items include pots and pans
	<b>Quick wash</b>	Lightly soiled with very short cycle time. (DW60M6050/DW60M6051)
	<b>Delicate</b>	Lightly soiled delicate items.
	<b>Express</b>	Normal daily used items, with short cycle time.
	<b>Pre wash</b>	Cold water rinse for removing dirt before running another program.
<b>2</b>	<b>Refill indicators</b>	If Rinse or Salt Refill indicator is lit, it means rinse or salt is needed to refill.
	<b>Salt refill indicator</b>	If the "Salt Refill" indicator is lit, it means the dishwasher is low on dishwasher salt and needs to be refilled.  To refill the salt reservoir, refer to the " <b>Loading the salt into the softener</b> " section on page <b>20</b> .
	<b>Rinse refill indicator</b>	If Rinse or Salt Refill indicator is lit, it means rinse or salt needs to be refilled. To refill the rinse reservoir, refer to the " <b>Filling the rinse aid reservoir</b> " section on page <b>22</b> .

	<b>Delay start indicator</b>	If the "Delay start" indicator is lit, it means, you select "Delay start" option.
<b>3</b>	<b>Display</b>	Display the remaining time, error code, or delay time.

## Using the detergent and water softener

### WATER SOFTENER MODE (WATER HARDNESS LEVEL SETTING)

The dishwasher is designed to allow for adjusting the amount of salt consumed based on the hardness of the water used. This is intended to optimise the level of salt consumption. To set the salt consumption, proceed as below:

1. Switch on the appliance;
  2. Press the **Pre Wash o Program** button for more than 5 seconds to start the water softener set model within 60 seconds after the appliance was switched on;
    - • Press the **Pre Wash o Program** button to select the proper set according to your local environment, the sets will change in the following sequence: H1 H2 H3 H4 H5 H6; It is recommended that adjustments should be made in accordance with the following table.
- \* The manufactory setting: H3 (EN 50242)
3. Wait for 5 seconds to end the set up model.

WATER HARDNESS				Selector Position	Salt consumption (gram/cycle)
° dH	° fH	° Clark	mmol/l		
0-5	0-9	0-6	0-0.94	H1	0
6-11	10-20	7-14	1.0-2.0	H2	9
12-17	21-30	15-21	2.1-3.0	H3	12
18-22	31-40	22-28	3.1-4.0	H4	20
23-34	41-60	29-42	4.1-6.0	H5	30
35-55	61-98	43-69	6.1-9.8	H6	60

### WATER SOFTENER

The hardness of the water varies from place to place. If hard water is used in the dishwasher, deposits may form on dishes and utensils. The appliance is equipped with a special softener that uses a salt specifically designed to eliminate lime and minerals from the water.

[Deposits on utensils]



### LOADING THE SALT INTO THE SOFTENER

Always use salt intended for use with dishwasher. The salt container is located beneath the lower rack and should be filled as follows:

#### ATTENTION

- Only use salt specifically designed for use in dishwashers. All other types of salt not specifically designed for use in a dishwasher, especially table salt, will damage the water softener. In case of damages caused by the use of unsuitable salt the manufacturer does not give any warranty nor is liable for any caused damages.
- Only fill with salt just before starting one of the complete washing programs. This will prevent any grains of salt or salty water, which may have been split, remaining of the bottom of the machine for any period of time, which may cause corrosion.
- After the first wash cycle the control panel light expires.

1. Remove the lower basket and then unscrew and remove the cap from the salt container.

Open

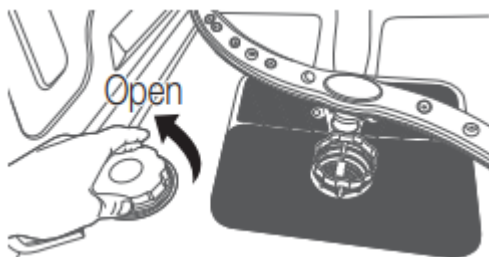

2. If you are filling the container for the first time, fill 2/3 of its volume with water (around 1 liter).

3. Place the end of the funnel (supplied) into the hole and introduce about 1.5 kg of salt. It is normal for a small amount of water to come out of the salt container.

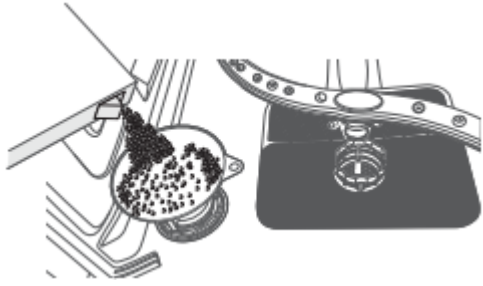

4. Carefully screw the cap back on.

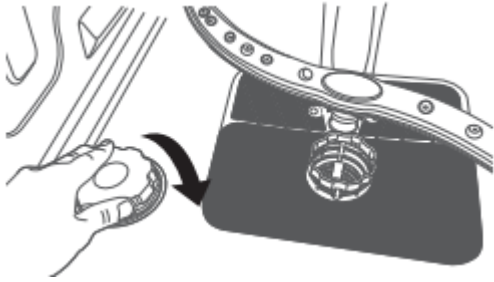

5. Usually, the salt warning light will be off after the salt container is filled with salt.

**Note:**

- The salt container must be refilled when the salt warning light on the control panel comes on. Although the salt container is filled enough, the indicator light may not switch off until the salt fully dissolves. If there is no salt warning light on the control panel, you can judge when to load the salt into the softener by the cycles that the dishwasher has run.
- If a lot of salt is spilt inside the dishwasher, run a pre wash program to reduce the spillage.

## USING DETERGENT

All dishwasher cycles require detergent in the detergent compartment. Add the correct amount of detergent for the selected cycle to ensure the best performance.

**CAUTION:** Use dishwasher detergent only. Regular detergent produces too much foam, which may decrease the dishwasher's performance or cause it to malfunction.

**WARNING:** Do not swallow dishwasher detergent. Avoid breathing in the fumes. Dishwasher detergent contains irritants and caustic chemicals that can induce respiratory conditions. If you have swallowed dishwasher detergent or inhaled the fumes, seek medical attention immediately.

**WARNING:** Keep dishwasher detergent out of the reach of children.

### Filling the detergent dispenser

1. Open the detergent dispenser flap by pushing the detergent dispenser release catch. The flap is always open at the end of a dishwashing cycle

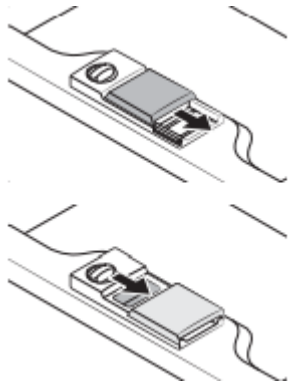

2. Add the recommended amount of detergent to the main wash detergent compartment.

3. Close the flap by sliding it to the left and then pressing it down. There is no separate button that is specific to using tablet detergents.

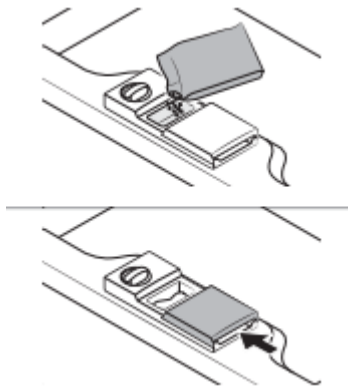

4. For better cleaning result, especially if you have very dirt items, add small amount (about 8 g) of detergent on the door. That will act in prewash phase.

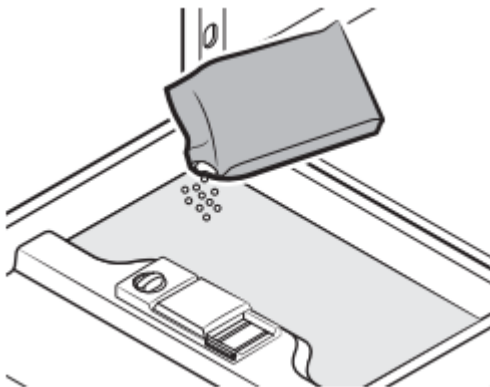

## USING RINSE AID

### Filling the rinse aid reservoir

When the Rinse Refill indicator lights up on the control panel, refill with rinse aid. Your dishwasher has been designed to use liquid rinse aid only. Using a powdered rinse aid will clog the reservoir

opening and cause the dishwasher to malfunction. Rinse aid improves the drying performance of the dishwasher.

**CAUTION:** Do not add regular detergent to the rinse aid reservoir.

1. Remove the rinse aid reservoir cap by rotating it counterclockwise. Adding rinse aid to tablet detergents will improve drying performance.

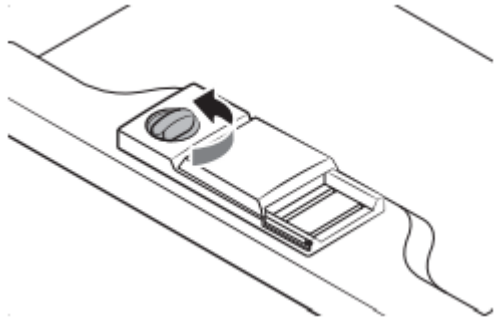

2. Fill the rinse aid reservoir with rinse aid. Use the viewing port when filling the rinse aid reservoir.

**CAUTION:** Do not fill the reservoir above the full level indicator. Excess rinse aid can overflow during the wash cycle.

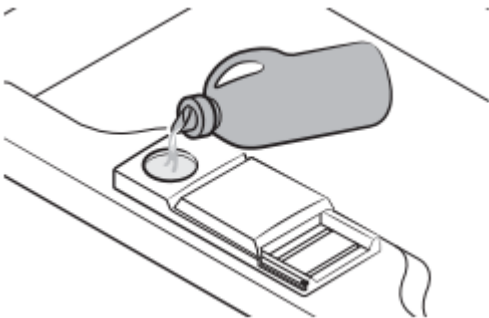

3. Turn the rinse aid indicator dial to a number between 1 and 6. The higher the number, the more rinse aid the dishwasher uses. If you are unable to rotate the rinse aid dial easily, try using a coin.
4. Close the rinse aid reservoir cap by rotating it clockwise.

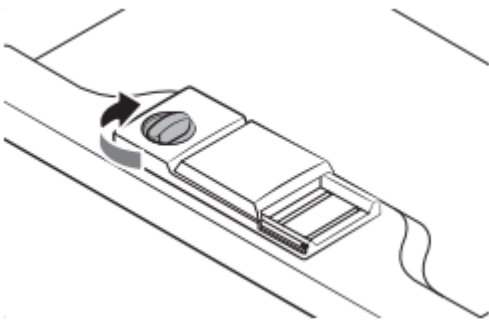

## HOW TO USE THE MULTI TAP OPTION

Your dishwasher has a Multi tap option which does not need salt and rinse aid but a 3 In1 tablet. This option can select on Intensive, Eco program only.

**Note:** The Multi tap setting is only for use with Multi tap tablets. If using Multi tap tablet without this option, the appliance will not get its best performance.

1. Put the Multi tap tablet into the container then start the Multi tap option.
2. Close the lid and press until it locks in place.

**Note:** When using Multi tap compact combination detergents ensure that the lid can be closed correctly.

**ATTENTION:** Keep all detergents in a safe place out of children's reach. Always add the detergent in the dispenser just before starting the dishwasher.



## Cleaning and care

### CLEANING THE FILTERS

#### Filtering system

For your convenience, we have placed the drain pump and filtering system within easy reach inside the tub. There are three components of the filtering system: the main filter, the coarse filter, and the fine filter.

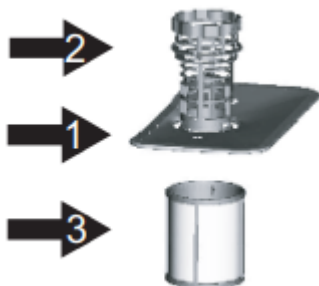

1. Main filter: Food and soil particles trapped by this filter are pulverized by a special jet on the lower spray arm and washed down the drain.

2. Coarse filter: Larger items, such as pieces of bone or glass, that could clog the drain are trapped in the coarse filter. To remove an item caught in this filter, gently squeeze the tabs on top of this filter and lift it out.
3. Fine filter: This filter holds soil and food residue in the sump area and prevents it from being redeposited on the dishes during a cycle.

**ATTENTION:** Do not put the fine filter upside down.

### Filter assembly

For best performance and results, the filter assembly must be cleaned. The filter efficiently removes food particles from the wash water, allowing it to be recirculated during the cycle. For this reason, it is a good idea to remove the larger food particles trapped in the filter after each wash cycle by rinsing the semicircular filter and cup under running water. To remove the filter assembly, turn it in anti-clockwise direction and lift the filter assembly up. The entire filter assembly should be cleaned regularly. To clean the coarse filter and the fine filter, use a cleaning brush. Then, reinsert the entire assembly in the dishwasher, positioning in its seat, pressing downward, turning it clockwise direction.

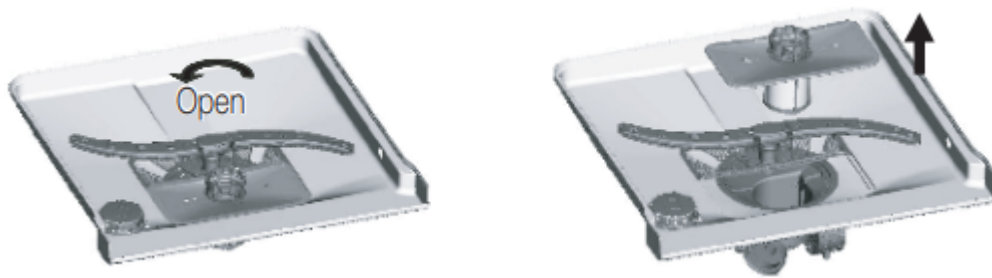

The dishwasher must never be used without the filters. Improper replacement of the filter may reduce the performance level of the appliance and damage dishes and utensils.

**WARNING:** Never run the dishwasher without the filters in place. When cleaning the filters, do not damage them. Otherwise the filters may not perform as intended and poor wash results or damage to the internal parts may be encountered.

### CLEANING THE SPRAY ARMS

It is necessary to clean the spray arms regularly as hard water chemicals may clog the spray arm jets and bearings. To remove the middle spray arm, hold the nut, rotate the arm clockwise to remove it. To remove the lower spray arm, pull out the spray arm upward. Wash the arms in soapy and warm water and use a soft brush to clean the jets. Replace them after rinsing them thoroughly

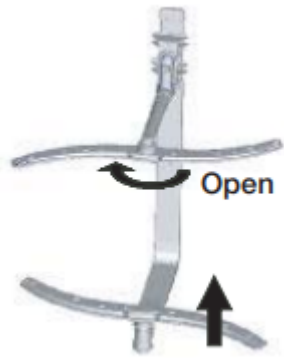

## CLEANING THE DOOR

To clean the edge around the door, you should use only a soft warm, damp rag. Also, never use abrasive cleaners or scouring pads on the outer surfaces because they will scratch the finish. Some papers towels can also scratch or leave marks on the surface.

**WARNING:** Never use a spray cleaner to clean the door panel for it could damage the door lock and electrical components. It is not advised to use the abrasive agent or some paper towel because of the risk of scratching or leaving spots on the stainless steel surface.

## CARING FOR THE DISHWASHER

To clean the control panel use a lightly damp cloth then dry thoroughly. To clean the exterior use a good appliance polish wax. Never use sharp objects, scouring pads or harsh cleaners on any part of the dishwasher.

## PROTECT AGAINST FREEZING

If your dishwasher is left in an unheated place during the winter:

1. Cut off electrical power to the dishwasher.
2. Turn off the water supply and disconnect the water inlet pipe from the water valve.
3. Drain water from the inlet pipe and water valve. (Use a pan to catch the water)
4. Reconnect the water inlet pipe to the water valve.
5. Remove the filter in the tub the bottom and use a sponge sock up water.

## HOW TO MAINTAIN YOUR DISHWASHER

- **After Every Wash** After every wash, turn off the water supply to the appliance and leave the door slightly ajar so that moisture and odours not trapped inside.
- **Remove the Plug** Before cleaning or performing maintenance, always remove the plug from the socket.
- **No Solvents or Abrasive cleaning** To clean the exterior and rubber parts of the dishwasher, do not use solvents or abrasive cleaning products. use only a cloth and warm soapy water. To remove spots or stains from the surface of the interior, Use a cloth

dampened with water and a little white vinegar, or a cleaning product made specifically for dishwashers.

- **When You Go on Holiday** When you go on holiday, it is recommended that you run a wash cycle with the dishwasher empty and then remove the plug from the socket, turn off the water supply and leave the door of the appliance slightly ajar. This will help the seals last longer and prevent odours from forming within the appliance.
- **Moving the Appliance** If the appliance must be moved, try to keep it in the vertical position. If absolutely necessary, it can be positioned on its back.
- **Seals** One of the factors that cause odours to form in the dishwasher is food that remains trapped in the seals. Periodic cleaning with a damp sponge will prevent this from occurring

## Troubleshooting

The manufacturer, following a policy of constant development and up-dating of the product, may make modifications without giving prior notice.

## BEFORE CALLING FOR SERVICE



<b>PROBLEM</b>	<b>POSSIBLE CAUSE</b>	<b>WHAT TO DO</b>
<b>Dishwasher doesn't run</b>	<ul style="list-style-type: none"> <li>• Fuse blown or the circuit breaker acted.</li> </ul>	<ul style="list-style-type: none"> <li>• Replace fuse or reset circuit breaker. Remove any other appliances sharing the same circuit with the dishwasher.</li> </ul>
	<ul style="list-style-type: none"> <li>• Power supply is not turned on.</li> </ul>	<ul style="list-style-type: none"> <li>• Make sure the dishwasher is turned on and the door is closed securely.</li> </ul> <p>Make sure the power cord is properly plugged into the wall socket.</p>
	<ul style="list-style-type: none"> <li>• Water pressure is low.</li> </ul>	<ul style="list-style-type: none"> <li>• Check that the water supply is connected properly and the water is turned on.</li> </ul>
<b>Drain pump doesn't stop</b>	<ul style="list-style-type: none"> <li>• Overflow.</li> </ul>	<ul style="list-style-type: none"> <li>• The system is designed to detect an overflow. When it does, it shuts off the circulation pump and turns on the drain pump.</li> </ul>
<b>Noise</b>	<ul style="list-style-type: none"> <li>• Some audible sounds are normal.</li> </ul>	<ul style="list-style-type: none"> <li>• Sound from soft food shredding action and detergent cup opening.</li> </ul>
	<ul style="list-style-type: none"> <li>• Utensils are not secure in the baskets or something small has dropped into the basket.</li> </ul>	<ul style="list-style-type: none"> <li>• To ensure everything is secured in the dishwasher.</li> </ul>
	<ul style="list-style-type: none"> <li>• Motor hums.</li> </ul>	<ul style="list-style-type: none"> <li>• Dishwasher has not been used regularly. If you do not use it often, remember to set it to fill and pump out every</li> </ul>

		week, which will help keep the seal moist.
<b>Suds in the tub</b>	<ul style="list-style-type: none"> <li>• Improper detergent.</li> </ul>	<ul style="list-style-type: none"> <li>• Use only the special dishwasher detergent to avoid suds.</li> <li>• If this occurs, open the dishwasher and let suds evaporate.</li> <li>• Add 1 gallon of cold water to the tub. Close and latch the dishwasher, then start the "soak" wash cycle to drain out the water. Repeat if necessary.</li> </ul>
	<ul style="list-style-type: none"> <li>• Spilled rinse agent.</li> </ul>	<ul style="list-style-type: none"> <li>• Always wipe up rinse agent spills immediately.</li> </ul>
<b>Stained tub interior</b>	<ul style="list-style-type: none"> <li>• Detergent with colorant was used.</li> </ul>	<ul style="list-style-type: none"> <li>• Make sure that the detergent is the one without colorant.</li> </ul>
<b>Dishes are not dried</b>	<ul style="list-style-type: none"> <li>• Rinse agent dispenser is empty.</li> </ul>	<ul style="list-style-type: none"> <li>• Make sure that the rinse agent dispense is filled.</li> </ul>
<b>Dishes and flatware not clean</b>	<ul style="list-style-type: none"> <li>• Improper program.</li> </ul>	<ul style="list-style-type: none"> <li>• Select a more intensive wash program.</li> </ul>
	<ul style="list-style-type: none"> <li>• Improper rack loading.</li> </ul>	<ul style="list-style-type: none"> <li>• Make sure that the action of the detergent dispenser and spray arms are not blocked by large dishware.</li> </ul>



<p><b>Spots and filming on glasses and flatware</b></p>	<ol style="list-style-type: none"> <li>1. Extremely hard water.</li> <li>2. Low inlet temperature.</li> <li>3. Overloading the dishwasher.</li> <li>4. Improper loading.</li> <li>5. Old or damp powder detergent.</li> <li>6. Empty rinse agent dispenser.</li> <li>7. Incorrect dosage of detergent.</li> </ol>	<p>To remove spots from glassware:</p> <ol style="list-style-type: none"> <li>1. Take out all metal utensils out of the dishwasher.</li> <li>2. Do not add detergent.</li> <li>3. Choose the longest cycle.</li> <li>4. Start the dishwasher and allow it to run for about 18 to 22 minutes, then it will be in the main wash.</li> <li>5. Open the door to pour 2 cups of white vinegar into the bottom of the dishwasher.</li> <li>6. Close the door and let the dishwasher complete the cycle.</li> </ol> <p>If the vinegar does not work: Repeat as above, except use 1/4 cup (60 ml) of citric acid crystals instead of vinegar.</p>
<p><b>Cloudiness on glassware</b></p>	<ul style="list-style-type: none"> <li>• Combination of soft water and too much detergent.</li> </ul>	<ul style="list-style-type: none"> <li>• Use less detergent if you have soft water and select a shortest cycle to wash the glassware and to get them clean.</li> </ul>
<p><b>Yellow or brown film on inside surfaces</b></p>	<ul style="list-style-type: none"> <li>• Tea or coffee stains.</li> </ul>	<ul style="list-style-type: none"> <li>• Using a solution of 1/2 cup of bleach and 3 cups warm water to remove the stains by hand.</li> </ul> <p><b>WARNING:</b> You have to wait for 20 minutes after a cycle to let the heating elements cool down before cleaning interior; Failing to follow this instruct may result in the risk of burns.</p>



	<ul style="list-style-type: none"> <li>• Iron deposits in water can cause an overall film.</li> </ul>	<ul style="list-style-type: none"> <li>• You have to call a water softener company for a special filter.</li> </ul>
<b>White film on inside surface</b>	<ul style="list-style-type: none"> <li>• Hard water minerals.</li> </ul>	<ul style="list-style-type: none"> <li>• To clean the interior, use a damp sponge with dishwasher detergent and wear rubber gloves. Never use any other cleaner than dishwasher detergent for the risk of foaming or suds.</li> </ul>
<b>Detergent cup lid won't latch</b>	<ul style="list-style-type: none"> <li>• Dial is not in the OFF position.</li> </ul>	<ul style="list-style-type: none"> <li>• Turn the Dial to OFF position and slide the door latch to the left.</li> </ul>
<b>Detergent left in dispenser cups</b>	<ul style="list-style-type: none"> <li>• Dishes block detergent cups.</li> </ul>	<ul style="list-style-type: none"> <li>• Re-loading the dishes properly.</li> </ul>
<b>Steam</b>	<ul style="list-style-type: none"> <li>• Normal phenomenon.</li> </ul>	<ul style="list-style-type: none"> <li>• There is some steam coming through the vent by the door latch during drying and water draining.</li> </ul>
<b>Black or gray marks on dishes</b>	<ul style="list-style-type: none"> <li>• Aluminum utensils have rubbed against dishes.</li> </ul>	<ul style="list-style-type: none"> <li>• Use a mild abrasive cleaner to eliminate those marks.</li> </ul>
<b>Water standing in the bottom of the tub</b>	<ul style="list-style-type: none"> <li>• This is normal.</li> </ul>	<ul style="list-style-type: none"> <li>• A small amount of clean water around the outlet on the tub bottom keeps the water seal lubricated.</li> </ul>
<b>Dishwasher leaks</b>	<ul style="list-style-type: none"> <li>• Overfill dispenser or rinse aid spills.</li> </ul>	<ul style="list-style-type: none"> <li>• Be careful not to overfill the rinse aid dispenser.</li> </ul> <p>Spilled rinse aid could cause overusing and lead to overflowing.</p>

		Wipe away any spills with a damp cloth.
	<ul style="list-style-type: none"> <li>• Dishwasher isn't level.</li> </ul>	<ul style="list-style-type: none"> <li>• Make sure the dishwasher is level.</li> </ul>
<b>Buttons are not working on power on state</b>	<ul style="list-style-type: none"> <li>• Door is open.</li> </ul>	<ul style="list-style-type: none"> <li>• When door is opened, buttons are not working except <b>Power</b> button. Close the door and press the button.</li> </ul>
	<ul style="list-style-type: none"> <li>• Control lock function is selected.</li> </ul>	<ul style="list-style-type: none"> <li>• When selected Control lock function, buttons are not responded. To unlock this function, hold down both the <b>Multi tap</b> and <b>Delay start</b> buttons for three (3) seconds. Also, Control lock function is released when power cord is reconnected.</li> </ul>

## ERROR CODES

If an error occurs an error code may be displayed to inform you:

Codes	Meanings	Possible Causes
<b>4C</b>	Water supply check	Faucets is not opened, or water intake is restricted, or water pressure is too low
<b>LC</b>	Leakage	Some element of dishwasher leaks.
<b>HC</b>	Not reaching required temperature	Malfunction of heating element
<b>PC</b>	Divider valve failed	Divider valve failed
<b>AC</b>	Failure of communication between main PCB with sub PCB	Open circuit or break wiring for the communication
<b>bC2</b>	Button pressed long time	Button pressed 30 seconds

**WARNING:** If overflow occurs, turn off the main water supply before calling a service. If there is water in the base pan because of an over fill or small leak, the water should be removed before restarting the dishwasher.

#### Warning

This content is compiled from multiple sources and is provided for reference purposes only. It may not be complete or fully applicable to all situations. If you are unable to resolve your issue, please contact the product manufacturer or an authorized service provider for official support.