

Assembly

Use both hands to lift the machine out of the box, taking care to hold by the base of the machine only. Do not lift out by the amplifier loop.



Take the carbon filters out of the box and remove the protective packaging. Attach both carbon filters to the machine.



Remove the glass HEPA filters from their protective packaging and push into the shrouds until secure.



Position the shrouds onto the base and push gently until they click securely into place. Place the remote control on the top of the machine with the buttons facing down. Plug in and switch on.

Controls

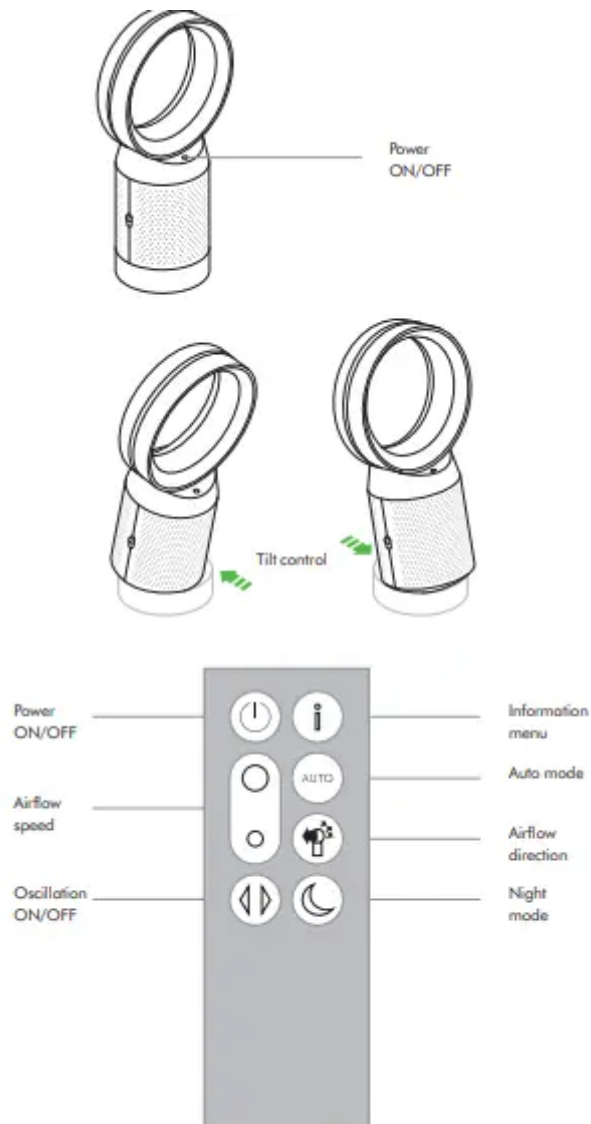

Additional functions

Power ON/OFF

Press the Power ON/OFF button on the appliance or remote control to stop the purifying fan. The machine will continue to monitor the air quality.

Continuous monitoring

The continuous monitoring function will:

- Collect extensive environmental information (see the "Information menu" section).
- Allow historical air quality information to be displayed on the screen and in the Dyson Link app.

Continuous monitoring is active at all times unless standby is selected. To stop continuous monitoring, press and hold the Auto mode button for 5 secs.

Standby

To exit standby and reactivate the machine, press the Power ON/OFF button on the machine or the remote control.

Connecting to the Dyson Link app

The Dyson Link app allows you to control, schedule, monitor, and customize your settings for your machine from your mobile device. Wi-Fi is enabled by default. To disable or enable the Wi-Fi press and hold the ON/OFF button on the appliance for 5 seconds. Plug in your machine to the electrical outlet and turn on the power. Check your mobile device is compatible with the app, switched on, connected to a Wi-Fi network and Bluetooth enabled. If you do not already have the Dyson Link app you will need to download it from the App Store or Google Play. Open the Dyson Link app and follow the instructions to create a new account if you do not already have one. Follow the on-screen instructions to pair your machine to the Dyson Link app. You will now be able to use the Dyson Link app to create custom settings, monitor information from the machine, control your machine, schedule use and also keep up to date with system upgrades. If you experience problems downloading the Dyson Link app or pairing your device; first check that you are connected to a Wi-Fi network and Bluetooth is enabled on your mobile device and try again. If you continue to experience problems downloading the app or pairing your device, please contact the Dyson Helpline. Standard data and messaging rates may apply.

Plug in your machine to the electrical outlet and turn on the power. Check your mobile device is compatible with the app, switched on, connected to a Wi-Fi network and Bluetooth enabled. If you do not already have the Dyson Link app you will need to download it from the App Store or Google Play. Open the Dyson Link app and follow the instructions to create a new account if you do not already have one. Follow the on-screen instructions to pair your machine to the Dyson Link app.

You will now be able to use the Dyson Link app to create custom settings, monitor information from the machine, control your machine, schedule use and also keep up to date with system upgrades. If you experience problems downloading the Dyson Link app or pairing your device; first check that you are connected to a Wi-Fi network and Bluetooth is enabled on your mobile device and try again. If you continue to experience problems downloading the app or pairing your device, please contact the Dyson Helpline.

Information menu

Scroll through the options to monitor the performance of your machine. The menu will also allow you to access information about the pollutants in the air and the temperature and humidity levels. When a particular type of pollutant causes air quality to decrease, the symbol for that pollutant will show in the display

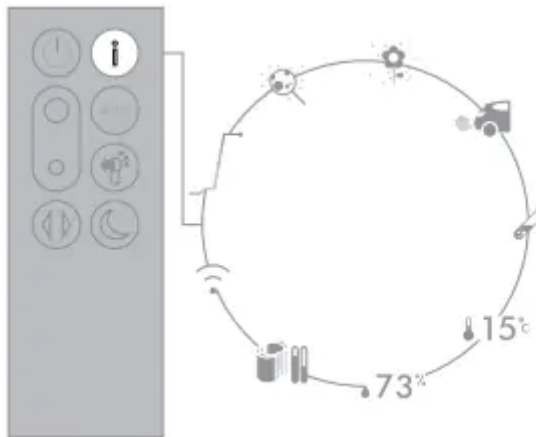

Indoor air quality - 12 seconds

Monitor the current air quality with a graph showing the last 12 seconds of data.



Particulate matter (PM2.5)

Microscopic particles up to 2.5 microns in size, suspended in the air we breathe. These include smoke, bacteria and allergens.



Particulate matter (PM10)

Larger microscopic particles up to 10 microns in size, suspended in the air we breathe. These include dust, mold spores and pollen



Nitrogen dioxide and other oxidizing gases

These potentially harmful gases are released into the air by combustion, for example the burning gas when cooking and in vehicle exhaust emissions.



Volatile organic compounds

VOC's are typically odors that may be potentially harmful. These can be found in cleaning products, paints and new furnishings.



Indoor temperature

Monitor the ambient temperature to help maintain a comfortable environment.



Indoor humidity

The amount of water vapor in the air, shown as a percentage of the maximum possible humidity at the current temperature.



Filters

The remaining filter life is shown in the display and will indicate when either filter needs replacing.



Wi-Fi

The current status of connection to the Wi-Fi network.



Auto mode

When Auto mode is selected the onboard sensors will intelligently adjust the settings of the machine according to the quality of air. The machine will pause once the sensors detect that the target air quality level has been reached. The sensors will continue to monitor the air quality, switching the machine back on when air quality levels have dropped. Customise your Auto mode and air quality settings in the Dyson Link app

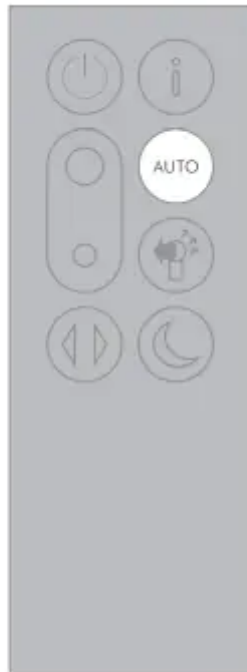

Airflow

Air will be purified continuously, whether the air is set to flow from the front or the back. For purification and cool airflow, select the airflow direction to the front. For purification without cool airflow from the front, select the airflow direction to the back. Press the Airflow speed button to increase and decrease the airflow speed.

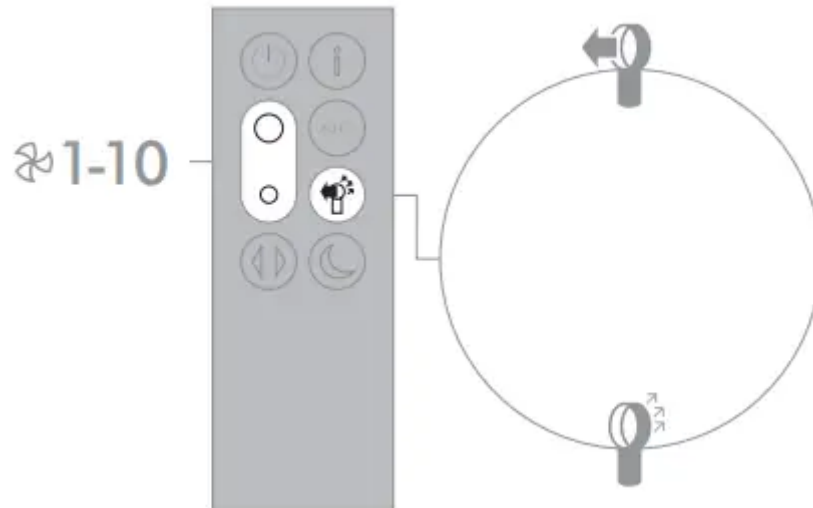

Night mode

Night mode will dim the display and the machine will run more quietly, making it ideal for use while sleeping. If Auto mode has been set, Night mode will reduce airflow speeds to range from 1 to 4. You can manually change the airflow from 1-10. Customize your Night mode settings in the Dyson Link app.



Oscillation

Press the Oscillation button to scroll through the options from 0° to 350°. Customize your oscillation settings in the Dyson Link app and it will appear as an option as you scroll through.

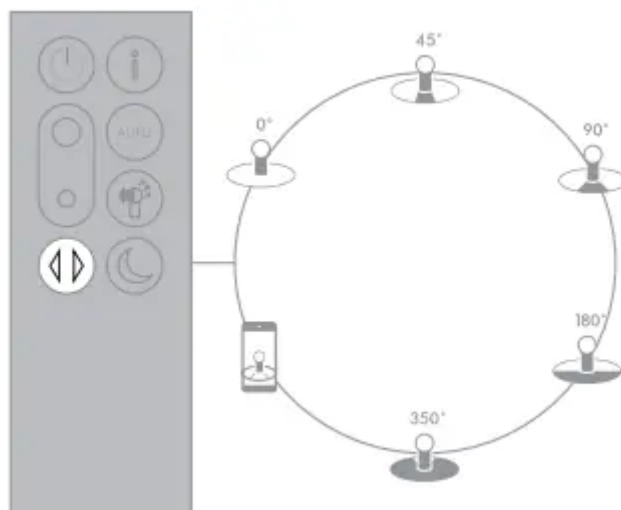

Changing the glass HEPA filters

Important: Always unplug the machine before changing filters.

The remaining filter life is shown in the display and will indicate when the non-washable glass HEPA filter needs replacing. Dispose of used filter units in accordance with local regulations.



Unplug the machine from the electrical outlet. Slide the buttons down on both sides of the shrouds.

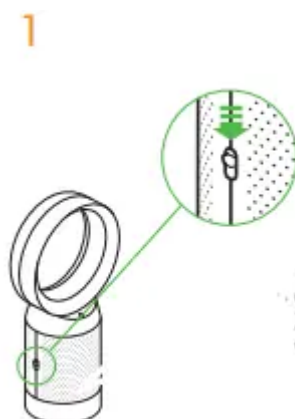

The shrouds will release with the glass HEPA filters attached.

2



Empty the glass HEPA filters directly into the bin by pushing in both the purple tabs on the shrouds.

3



Push the new glass HEPA filters into the shrouds until secure.

4



Push the shrouds until they click back into position in the base.

5



Plug the machine in to the electrical outlet and switch on.

6



Important : Press and hold the Night mode button on the remote control. The display on the machine will countdown from five, finishing with the default screen. The glass HEPA filter level will be reset and the machine is ready to use.

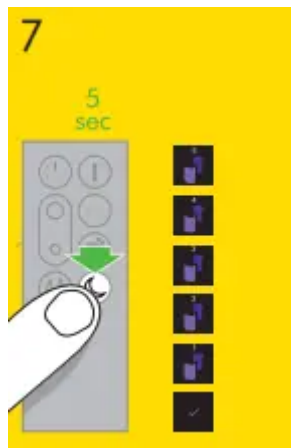

Changing the carbon filters

Important: Always unplug the machine before changing filters. The remaining filter life is shown in the display and will indicate when the non-washable carbon filter needs replacing. Dispose of used filter units in accordance with local regulations.



Unplug the machine from the electrical outlet. Slide the buttons down on both sides of the shrouds

1

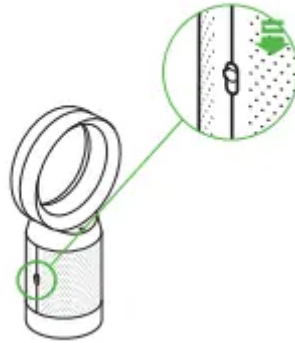

The shrouds will release with the glass HEPA filters attached.

2



To remove the carbon filters: pull the tabs on both sides of the filters. Dispose of the carbon filters in the bin.

3



Push the new carbon filters onto the base until secure.

4



Push the shrouds until they click back into position in the base.

5



Plug the machine in to the electrical outlet and switch on.

6



Important : Press and hold the Oscillation button on the remote control. The display on the machine will countdown from five, finishing with the default screen. The carbon filter level will be reset and the machine is

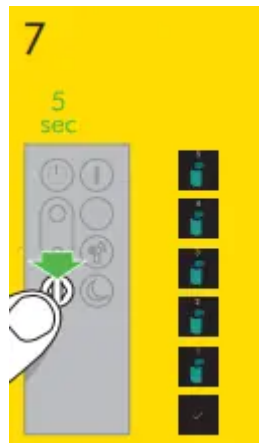

Cleaning

To ensure that your machine works efficiently, it is important to clean and check for blockages regularly. Unplug your machine from the electrical outlet before cleaning.



Look for blockages in the air inlet holes on the filter and the small aperture inside the loop amplifier. Use a soft brush to remove dust and debris.



Dust may accumulate on the surface of the machine. Wipe dust from the loop amplifier, filter unit and other parts with a dry or damp cloth.



Do not use detergents or polishes to clean the machine.



Troubleshooting

For further information and support: Online: www.dyson.com/support On the phone: 866-277-9896 Mon-Fri 8am to 8pm CT; Sat 9am to 6pm CT

If the machine has been used without a filter in place or the filters have not been changed when prompted, blockages may occur.

To remove a blockage: Remove the filter shrouds and look for blockages in the air inlet holes under the filters. Use a soft brush to remove dust and debris.

If an error code is displayed, first try unplugging the machine and plugging it in again. If an error code continues to be displayed, contact the Dyson Helpline.

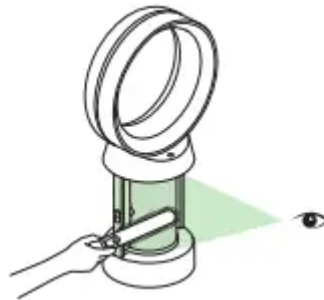

Important Safety instructions

BEFORE USING THIS MACHINE READ ALL INSTRUCTIONS AND CAUTIONARY MARKINGS IN THIS MANUAL AND ON THE MACHINE

When using an electrical machine, basic precautions should always be followed, including the following:

WARNING : Chemical Burn and Choking Hazard. Keep batteries away from children. This product contains a lithium button/coin cell battery. If a new or used lithium button/coin cell battery is swallowed or enters the body, it can cause severe internal burns and can lead to death in as little as 2 hours. Always completely secure the battery compartment. If the battery compartment does not close securely, stop using the product, remove the batteries,

and keep it away from children. If you think batteries might have been swallowed or placed inside any part of the body, seek immediate medical attention.

THE FAN AND THE REMOTE CONTROL BOTH CONTAIN MAGNETS

3. Pacemakers and defibrillators may be affected by strong magnetic fields. If you or someone in your household has a pacemaker or defibrillator, avoid placing the remote control in a pocket or near to the device.
4. Credit cards and electronic storage media may also be affected by magnets and should be kept away from the remote control and the top of the machine.
5. This Dyson machine is not intended for use by persons (including children) with reduced physical, sensory or mental capabilities, or lack of experience and knowledge, unless they have been given supervision or instruction by a responsible person concerning use of the machine to ensure that they can use it safely. Cleaning and user maintenance should not be performed by children without supervision.
6. Ensure that the machine is fully assembled in line with the instructions before use.
7. Do not allow to be used as a toy. Close attention is necessary when used by or near children. Children should be supervised to ensure that they do not play with the machine.
8. Use only as described in this Dyson Operating Manual. Do not carry out any maintenance other than that shown in this manual, or advised by the Dyson Helpline.
9. Suitable for dry locations ONLY. Do not use outdoors or on wet surfaces and do not expose to water or rain.
10. Do not handle any part of the plug or machine with wet hands.
11. Do not operate any machine with a damaged cord or plug. Discard the machine or return to an authorized service facility for examination and/or repair. If the supply cord is damaged it must be replaced by Dyson, its service agent or a similarly qualified person in order to avoid a hazard.
12. If the machine is not working as it should, has received a sharp blow, has been dropped, damaged, left outdoors, or dropped into water, do not use and contact the Dyson Helpline
13. Do not stretch the cord or place the cord under strain. Keep cord away from heated surfaces.
14. Do not run the cord under carpeting. Do not cover the cord with throw rugs, runners or similar coverings. Do not route the cord under furniture or appliances. Arrange the cord away from traffic area and where it will not be tripped over.
15. Do not unplug by pulling on the cord. To unplug, grasp the plug, not the cord. The use of an extension cord is not recommended.

16. Do not put any object into openings or the inlet grille. Do not use with any opening blocked; keep free of dust, lint, hair, and anything that may reduce airflow.
17. Do not use any cleaning agents or lubricants on this machine. Unplug before cleaning or carrying out any maintenance.
18. Always carry the machine by the base, do not carry it by the loop amplifier.
19. Turn off all controls before unplugging. Unplug from outlet when not in use for extended periods. To avoid a tripping hazard, safely coil the cord.
20. Do not use near furnaces, fireplaces, stoves or other high temperature heat sources.
21. Do not use in conjunction with or directly next to an air freshener or similar products. Do not spray or apply perfumes directly on or near the filter. Keep essential oils and chemicals away from the machine.
22. When removing or replacing the filter, take care to keep your fingers clear between the filter and the purifier base.
23. This machine is only to be used with the power supply unit provided with it.

Warning

This content is compiled from multiple sources and is provided for reference purposes only. It may not be complete or fully applicable to all situations. If you are unable to resolve your issue, please contact the product manufacturer or an authorized service provider for official support.