

What's In The Box?

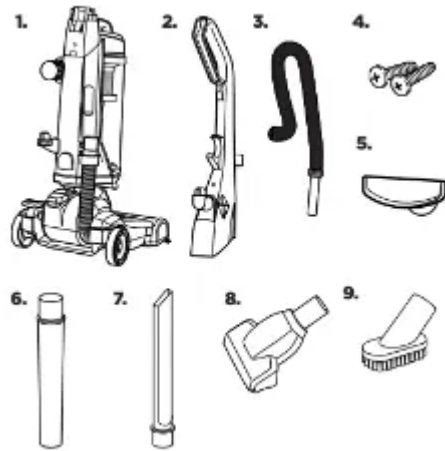

1. Vacuum Base
2. Handle
3. Hose
4. Screws (taped to Handle)
5. Lower Cord Wrap
6. Extension Wand
7. Crevice Tool (stored inside Extension Wand)
8. Pet TurboEraser® Tool
9. Dusting Brush

NOTE: Not all accessories come with every model. Be sure to check the carton for additional tools.

Product View

WARNING: Do not plug in your vacuum until you are familiar with all instructions and operating procedures.

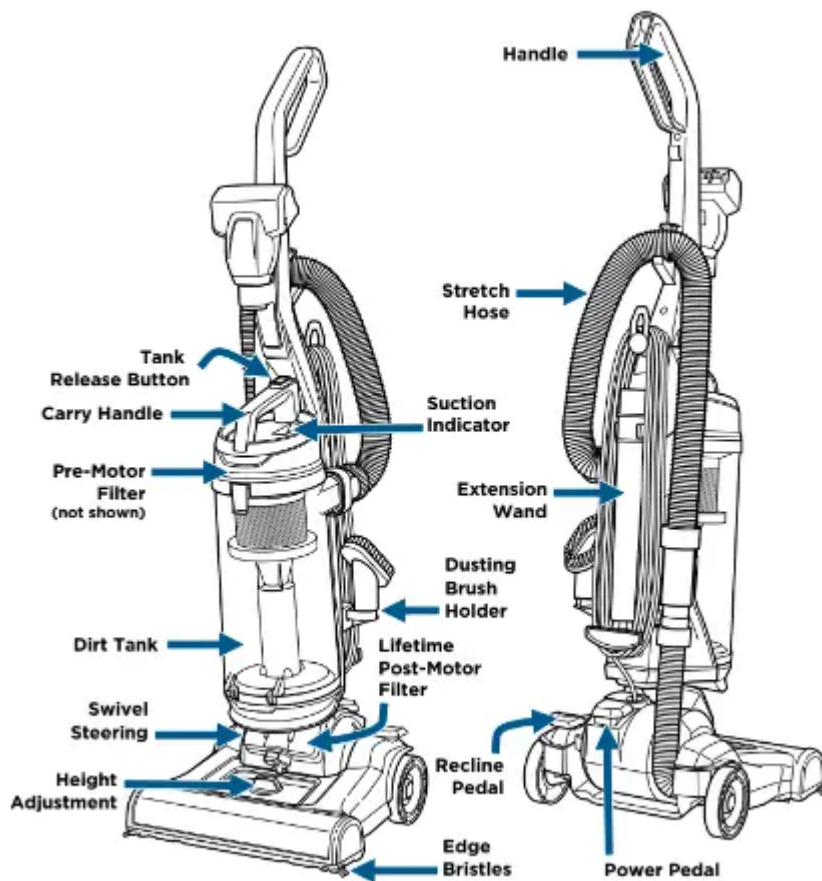

NOTE: The Crevice Tool is stored inside the Extension Wand.

Assembly

The only tool you will need to assemble your vacuum is a



Phillips screwdriver.



1. Place the upper handle onto the base and push it down. Then attach the handle with the 2 screws taped to the handle in a plastic bag.



2. Insert the lower cord wrap and turn it to the right to lock in place.

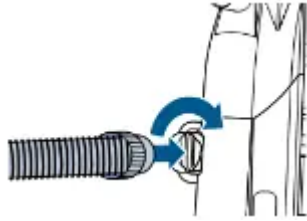

3. Insert the hose end into the back of the vacuum and twist right to lock in place.



4. Wrap hose up and around the hose wrap on the handle. Slide end of hose into vacuum base.

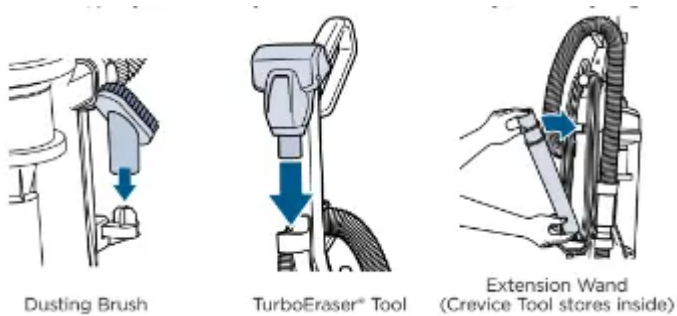



5. Now, put your accessory tools on the vacuum and you're ready to go!

NOTE: The Powerfoot will not suction properly unless the hose is firmly attached.

Operations

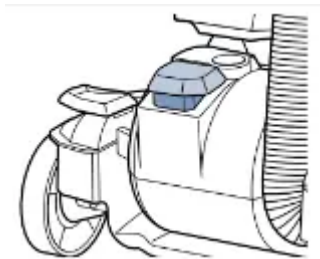
Power On & Settings



1. Press the red power button with your foot to turn the vacuum ON  and once again to turn your vacuum OFF .

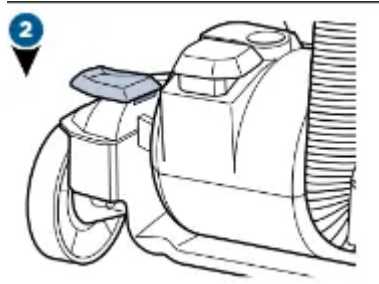

2. Press the recline pedal and pull handle back towards you.

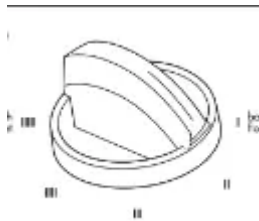

3. Turn the dial on the foot of the vacuum to the desired setting. If the dial is difficult to turn, tilt the vacuum back slightly to take the weight off the foot while turning.

Lowest setting – For low pile carpet or bare floors. To pick up debris, it may be necessary to move up one setting.

Medium setting – For medium pile carpet.

Highest setting – For high pile and most shag carpet.

TIP: For optimal carpet cleaning performance, adjust to the lowest practical setting. If your vacuum is difficult to push, adjust to the next higher setting.

WARNING: To reduce the risk of injury from moving parts while the vacuum is turned on, always move the vacuum via the rolling wheels by using the upper handle at the back of the vacuum. Do not carry the vacuum while it is running. Always place vacuum on floor with handle in upright position when using tools.

NOTE: Rotating floor brush continues to rotate while tools are in use. Never place fingers under the vacuum when it is running. Never place Powerfoot on furniture or uneven surfaces. Do not place vacuum close enough to objects to pull into rotating brush.

NOTE: Certain carpets and low humidity conditions may generate small static discharges. Static discharges are entirely harmless and are not associated in any way with the main power supply.

Maintenance & Care

Empty the Dirt Tank

WARNING: To reduce the risk of electric shock, turn power switch off and disconnect polarized plug from electrical outlet before performing maintenance or troubleshooting checks.

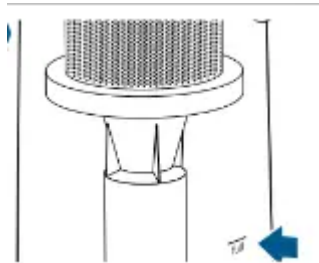

1. Empty once tank is full.

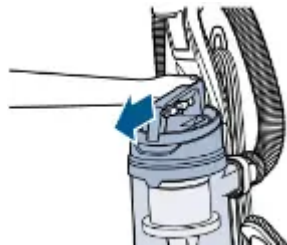

2. Press the tank release button and pull out to remove dirt tank.

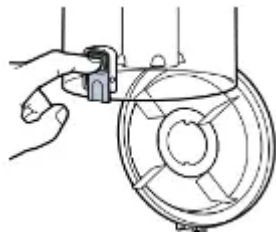

3. Hold the dirt tank over a trash container. Press the bottom release button to empty. Once empty, close the lid.



4. Twist cyclone left and pull down to remove from tank.

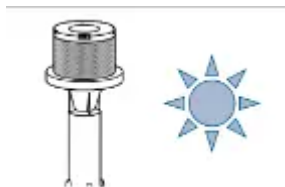

5. Clean cyclone with warm water and mild detergent. Let cyclone completely dry before replacing. To replace, fit into place and twist to the right.



6. After emptied, place tank back on vacuum and press firmly until you hear “click”.

NOTE: The dirt tank may be washed in warm water with a mild detergent. Make sure it is completely dry before replacing.

Clean the Pre-Motor Filter

WARNING: To reduce the risk of electric shock, turn power switch off and disconnect plug from electrical outlet before performing maintenance or troubleshooting checks.

WARNING: Do not operate vacuum with damp or wet filters or without all filters in place.



1. Press the tank release button and pull out to remove dirt tank.



2. Remove carbon and foam filter from lid. Hand wash in warm water and rinse well; mild detergent may be used if desired.



3. Allow filter to air dry completely before placing back into the tank lid. The carbon filter should be on top of the foam filter.



4. Return tank back on vacuum and press firmly until you hear “click”.

Maintain the TurboEraser® Tool



1. Twist gray collar counter clockwise, until slot appears, then separate faceplate.



2. Remove brush roll, belt, and paddle wheel. Inspect for damages and replace if necessary.

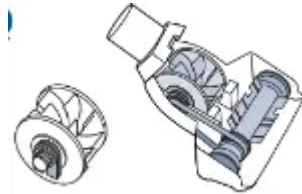

3. To reassemble, align two clips on each end of paddle wheel with belt on and pop back into place. Place brush roll with belt back in. Faceplate will not close properly if all parts are not aligned correctly.

Replace Brush & Belt

WARNING: To reduce the risk of electric shock, turn power switch off and disconnect plug from electrical outlet before performing maintenance or troubleshooting checks.

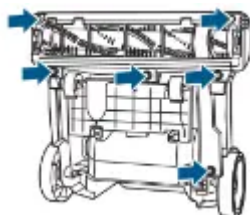

1. Unplug vacuum, turn over and unscrew six (6) Philips head screws to remove the bottom cover. Lift brush straight out.



2. Clean debris from brush roll. Inspect by placing on its end and spin. The brush roll should spin freely, multiple times by one flick. If it doesn't, replace brush roll. Check belt for wear or cuts and replace if necessary.

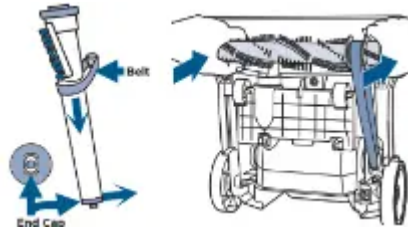

3. Replace the brush roll and belt by looping the belt over the motor shaft and the brush roll. Line up the end caps and pull the brush forward into place. This will stretch the belt. Return bottom cover back on and replace the screws.

Clearing a Clog

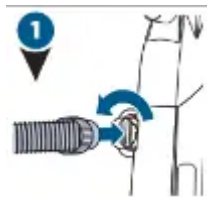

1. Remove the hose from the back of the vacuum by twisting it to the left. Remove any debris that may have gotten clogged.

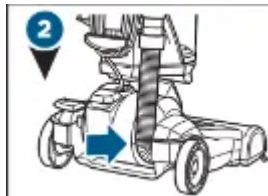

2. Check the foot hose on the back of your vacuum down towards the bottom. If necessary, remove the screw from the foot hose and check for clogs.

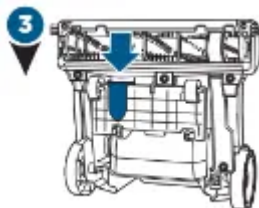

3. Check the air passageway on the bottom of your vacuum. Remove the bottom cover and the brush. Remove any debris.

Troubleshooting

WARNING: To reduce the risk of electric shock, turn power switch off and disconnect plug from electrical outlet before performing maintenance or troubleshooting checks.

Vacuum won't turn on

- Power cord not plugged in
 - Check electrical plug
- Blown fuse/tripped breaker
 - Check/replace fuse or reset breaker

Vacuum won't pick up dirt

- Incorrect height adjustment
 - Adjust powerfoot to correct height setting
- Hose not attached to suction opening
 - Grasp the hose wand and firmly push into the hose wand base
- Crack or hole in hose
 - Check hose and replace if needed
- Broken or worn drive belt
 - Replace drive belt, see page 9
- Rotating floor brush jammed
 - Remove brush and clean debris from brush ends, see page 9
- Clog in vacuum
 - Check for debris build-up or clogs in the inner tank, hose and foot/lower hose; See online video for more help
- Dirt tank full
 - Empty dirt tank
- Dirt tank or upper tank not installed properly
 - Position correctly and lock in place, see page 7
- Filters are dirty
 - Check and clean or replace pre-motor and post-motor filters, see page 8

Tool won't pick up

- Crack or hole in hose
 - Check hose and replace if needed

- Clog in vacuum
 - Check for debris build-up or clogs in the inner tank, hose and foot/lower hose; See online video for more help
- Dirt tank full
 - Empty dirt tank
- Dirt tank or upper tank not installed properly
 - Position correctly and lock in place, see page 7
- Filters are dirty
 - Check and clean or replace pre-motor and post-motor filters, see page 8

Vacuum difficult to push

- Incorrect height adjustment
 - Adjust powerfoot to correct height setting, see page 6

Visible dirt escaping from vacuum

- Dirt tank full
 - Empty dirt tank
- Filters missing or installed incorrectly
 - Check pre-motor and post-motor filters for correct installation, see page 8

Parts & Supplies

For Parts and Supplies, go to web BISSELL and enter your model number in the search field.

Warranty

This warranty gives you specific legal rights, and you may also have other rights which may vary from state to state. If you need additional instruction regarding this warranty or have questions regarding what it may cover, please contact BISSELL Consumer Care by E-mail, telephone, or regular mail as described below.

Limited Three-Year Warranty

Subject to the *EXCEPTIONS AND EXCLUSIONS identified below, upon receipt of the product BISSELL will repair or replace with new or remanufactured components or products), at BISSELL's option, free of charge from the date of purchase by the original purchaser, for three years any defective or malfunctioning part.

See information below on "If your BISSELL product should require service".

This warranty applies to product used for personal, and not commercial or rental service. This warranty does not apply to fans or routine maintenance components such as filters, belts, or brushes. Damage or malfunction caused by negligence, abuse, neglect, unauthorized repair, or any other use not in accordance with the User's Guide is not covered.

BISSELL IS NOT LIABLE FOR INCIDENTAL OR CONSEQUENTIAL DAMAGES OF ANY NATURE ASSOCIATED WITH THE USE OF THIS PRODUCT. BISSELL'S LIABILITY WILL NOT EXCEED THE PURCHASE PRICE OF THE PRODUCT.

Some states do not allow the exclusion or limitation of incidental or consequential damages, so the above limitation or exclusion may not apply to you.

***EXCEPTIONS AND EXCLUSIONS FROM THE TERMS OF THE LIMITED WARRANTY**
THIS WARRANTY IS EXCLUSIVE AND IN LIEU OF ANY OTHER WARRANTIES EITHER ORAL OR WRITTEN. ANY IMPLIED WARRANTIES WHICH MAY ARISE BY OPERATION OF LAW, INCLUDING THE IMPLIED WARRANTIES OF MERCHANTABILITY AND FITNESS FOR A PARTICULAR PURPOSE, ARE LIMITED TO THE THREE YEAR DURATION FROM THE DATE OF PURCHASE AS DESCRIBED ABOVE.

Some states do not allow limitations on how long an implied warranty lasts so the above limitation may not apply to you.

NOTE: Please keep your original sales receipt. It provides proof of date of purchase in the event of a warranty claim.

Warning

This content is compiled from multiple sources and is provided for reference purposes only. It may not be complete or fully applicable to all situations. If you are unable to resolve your issue, please contact the product manufacturer or an authorized service provider for official support.