





Custom-designed Features

Camera features

Flash Jump-Cut



You can create a GIF by taking photos at three second intervals.

1. Tap  > , then tap **MODE > Flash Jump-Cut** .
2. Tap  to set the number of cuts you want to take.
3. Tap  to take photos.

Gallery features

Creating a movie

You can create a new movie by putting images and videos together.

1. Tap  > , select an album, then tap  > **Create movie.**
2. Select images or videos for your movie and tap **NEXT.**
3. Edit the selected images and videos and then tap **SAVE.**

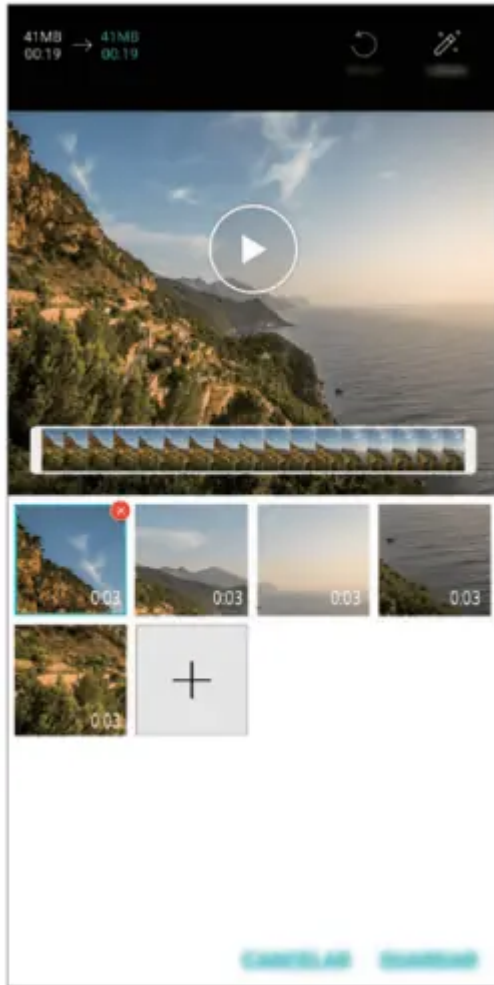

Deleting files

You can select images or videos to delete from your video by tapping  at the top right corner of its thumbnail.

Adding files

You can select images or videos to add after tapping  at the bottom of the screen. You can also select the images or videos you have already previously added.

NOTE: Touch and hold a file, and then tap another file for multiple selection.

Rearranging files

To rearrange the images and videos, touch and hold the file you want to move, then dragging it to the desired location.

Adding file effects

Tap  to add a theme or background music, or change the font.

Resetting the movie edits

You can reset the edits made to the movie (e.g. play time) by tapping .

Previewing a file

Check your new video before saving it by tapping . After the playback time elapses, the next file is played automatically.

NOTE:

- A maximum of 50 images and videos can be used to create a video.
- The playback time for an image is 3 seconds by default and it cannot be changed. Videos can be trimmed down to a minimum of 1 second.
- This feature may not support some image or video formats.

Making a GIF

You can easily make a GIF file using recorded video.

1. At the desired starting point while watching a video, tap .
2. Select the length of the GIF you want to create.
 - GIF is generated for the time selected from the current time.
 - For videos less than 5 seconds, GIF images are automatically generated for the remaining time.

CAUTION: You may use this feature solely for creative purposes. The use of this feature involving infringement of any other person's rights, such as copyright or defamatory or offensive statements, may be subject to civil, criminal, or administrative liabilities and/or penalties under applicable laws. You shall not copy, reproduce, distribute, or otherwise make illegal use of any copyrighted materials without permission of the rightful owner or copyright holder. To the fullest extent permitted by applicable law, LG Electronics disclaims all expressed and implied warranties as well as liabilities associated thereto.

Google Assistant

You can manage tasks, plan your day, get answers, and much more.

NOTE: To use this feature, first connect to the network and sign in to your Google account.

Launching Google Assistant

1. Press and hold  from the Home screen to launch Google Assistant.
2. Tap GET STARTED.
3. Follow the on-screen instructions to configure the voice settings.
 - The device saves your voice data for recognition.

Launching Google Assistant with your voice

1. Say “**Ok Google**” when the screen is turned off or locked.
2. Say a command or question when **Hi, how can I help?*** appears on the screen.

Launching Google Assistant from the Home screen

1. Touch and hold  from the Home screen.
2. Say a command or question when **Hi, how can I help?*** appears on the screen.



NOTE: Voice recognition accuracy may decrease if you speak with an unclear voice or in a noisy place. When you use the voice recognition feature, increase its accuracy by speaking with a clear voice in a quiet place.

The Hi, how can I help? message may change depending on the software version.



Multi-tasking feature

Multi-Window

You can use two apps at the same time by separating the screen into multiple windows.



1. Tap  from the Home touch buttons.
 - Recently-used apps appear.
2. Tap  at the top of the desired app to use the Multi-Window feature.
 - The selected app appears at the top half of the screen.

You can also access this feature by doing the following:

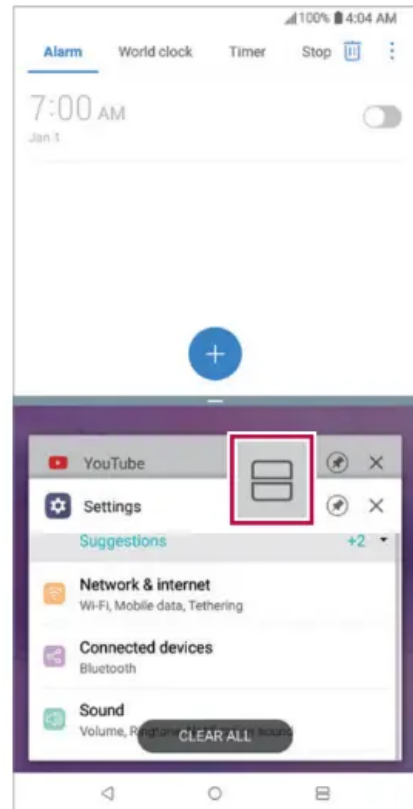
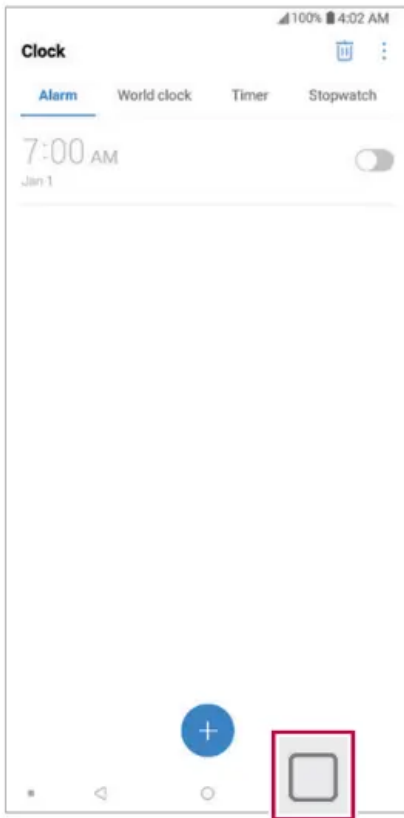
1. Touch and hold  while using an app.
 - Recently-used apps appear on the split screen.
2. Tap  at the top of the desired app to use the Multi-Window feature.
 - The selected app appears at the bottom of the screen.





NOTE:

- To deactivate the Multi-Window feature, touch and hold  on the Home touch button.
- To adjust the size of the split screen, drag  at the center of the screen.
- The Multi-Window feature is not supported by some LG apps and apps downloaded from the Play Store.

Overview screen

The Overview screen provides a preview of your recently-used apps.

To view the list of recently-used apps, tap  on the Home touch buttons.

- Touch and hold an app and drag it to the top of the screen to start the app with the Multi-Window feature. You can also tap  at the top of each app preview.



Basic Functions

Parts overview

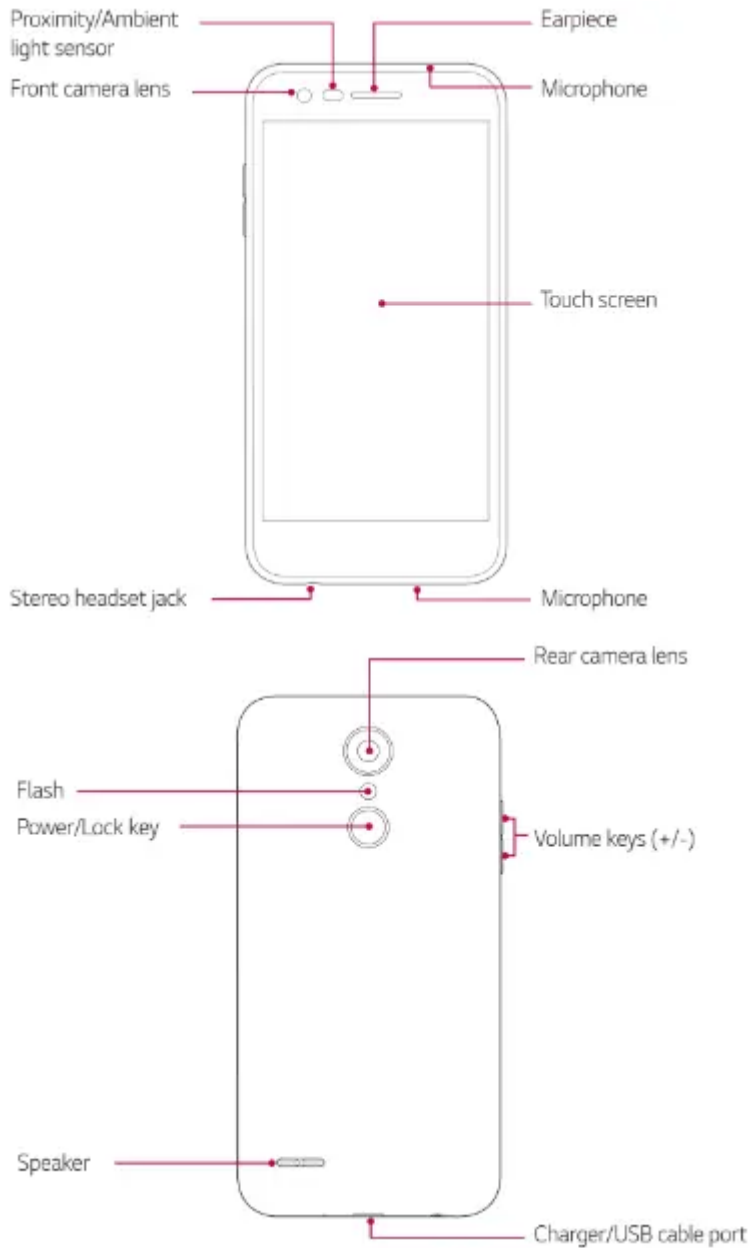

NOTE: Press and hold the volume down (-) key and Power/Lock key at the same time for a second to take a screenshot.

- Proximity/Ambient light sensor
 - Proximity sensor: During a call, the proximity sensor turns off the screen and disables touch functionality when the device is in close proximity to the human body. It turns the screen back on and enables touch functionality when the device is outside a specific range.

- Ambient light sensor: The ambient light sensor analyzes the ambient light intensity when the auto-brightness control mode is turned on.
- Laser detection auto-focus
 - Detect the distance from the camera to your subject for automatic focusing.
 - Quickly focus on closer or farther objects when you use the rear camera to take photos.
- Volume keys
 - Adjust the volume for ringtones, calls or notifications.
 - While using the Camera, gently press a Volume key to take a photo. To take continuous photos, press and hold the Volume key.
 - Press the Volume Down (-) key twice to launch the Camera app when the screen is locked or turned off. Press the Volume Up (+) key twice to launch Capture+.
- Power/Lock key
 - Briefly press the key when you want to turn the screen on or off.
 - Press and hold the key when you want to select a power control option.

NOTE:

- Some functions may be restricted for access, depending on the device specifications.
- Do not put heavy objects on the device or sit on it. Doing so may damage the touch screen.
- Screen-protective film or accessories may interfere with the proximity sensor.
- If your device is wet or is being used in a humid place, the touch screen or buttons may not function properly.

Hold the device correctly as shown below. If you cover the microphone hole with a hand, finger, or protective case while using the device, you may sound unclear during a call.

Turning the power on or off

Turning the power on

When the power is turned off, press and hold the Power/Lock key.

NOTE: When the device is turned on for the first time, initial configuration takes place. The first booting time for the smart phone may be longer than usual.

Turning the power off

Press and hold the Power/Lock key, then select Power off.

Power control options

Press and hold the Power/Lock key, then select an option.

- **Power off:** Turn the device off.
- **Power off and restart:** Restart the device.
- **Turn on Airplane mode:** Block telecommunication-related functions, including making phone calls, messaging and browsing the Internet. Other functions remain available.

Installing the SIM card

Insert the SIM (Subscriber Identity Module) card provided by your service provider to start using your device.

1. To remove the back cover, hold the phone firmly in one hand. With your other hand, lift off the back cover with your thumbnail as shown in the figure below.



2. Slide the SIM card into the SIM card slot with the gold-colored contacts facing downwards.

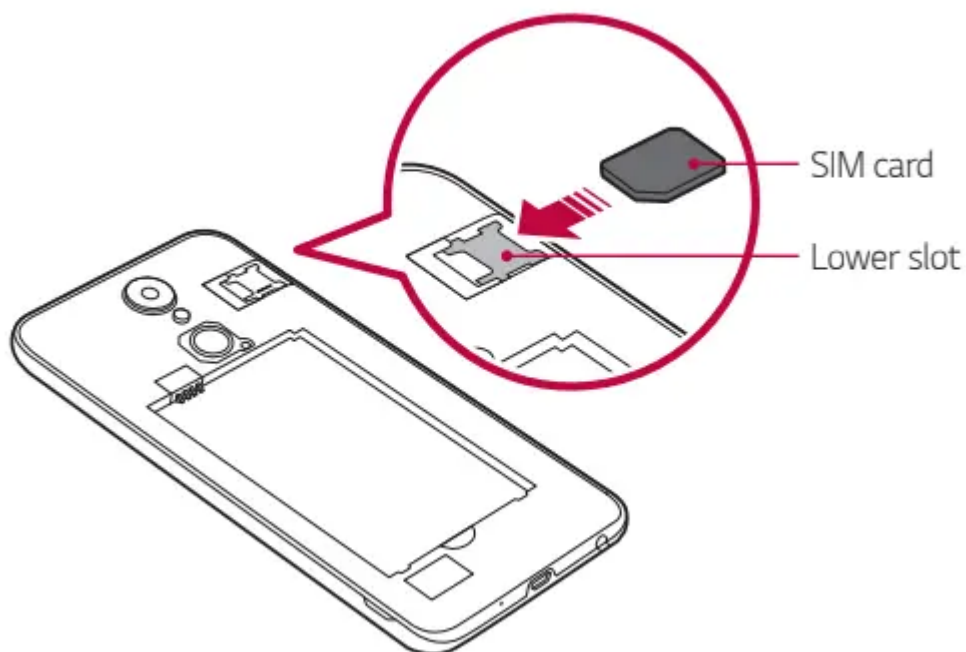

NOTE:

- This device supports only Nano SIM cards.

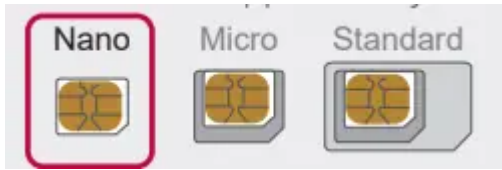

- For problem-free performance, it is recommended to use the phone with the correct type of SIM card. Always use a factory-made SIM card supplied by the service provider.

To remove the SIM card

Push the pin on the left of the SIM card slot downwards, as indicated in the image below.

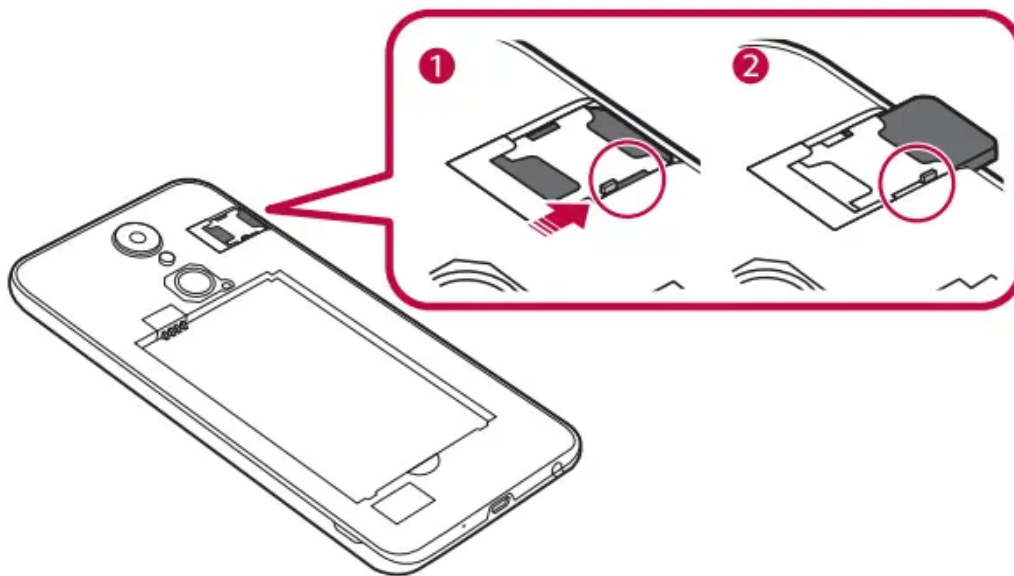

Precautions when using the SIM card

- Do not lose your SIM card. LG is not responsible for damage and other issues caused by loss or transfer of a SIM card.
- Be careful not to damage the SIM card when you insert or remove it.

Battery

Installing the battery

1. To remove the back cover, hold the phone firmly in one hand. With your other hand, lift off the back cover with your thumbnail as shown in the figure below.

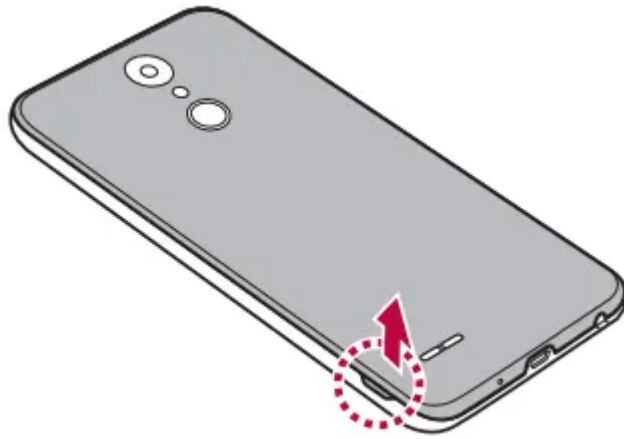

2. Insert the battery.

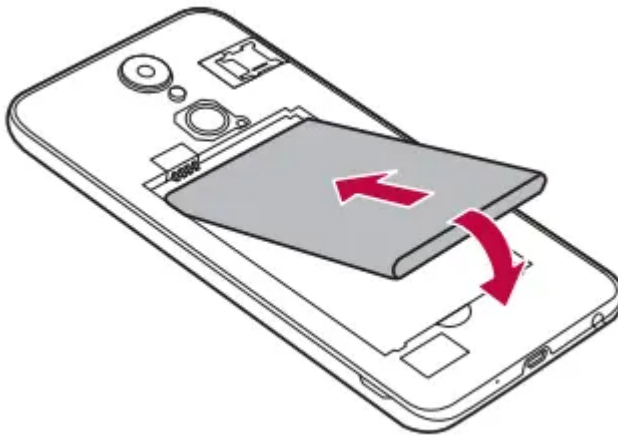

3. To replace the cover onto the device, align the back cover over the battery compartment and press it down until it clicks into place.

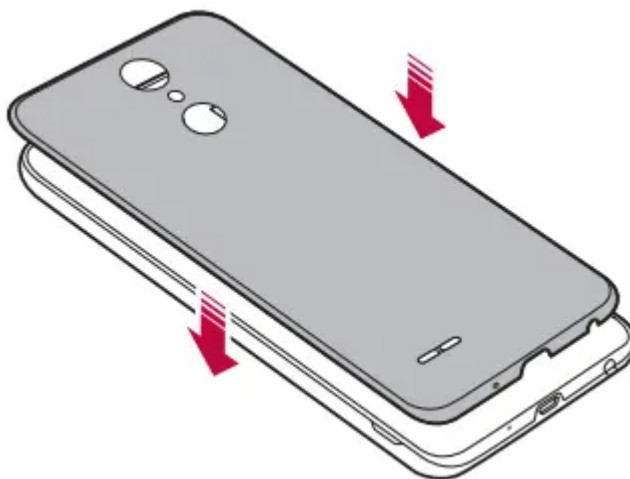

CAUTION: Follow the instructions in this user guide cautiously when handling the device. Failure to do so may damage the device or cause injury to yourself or others.

Charging the battery

Before using the device, fully charge the battery.

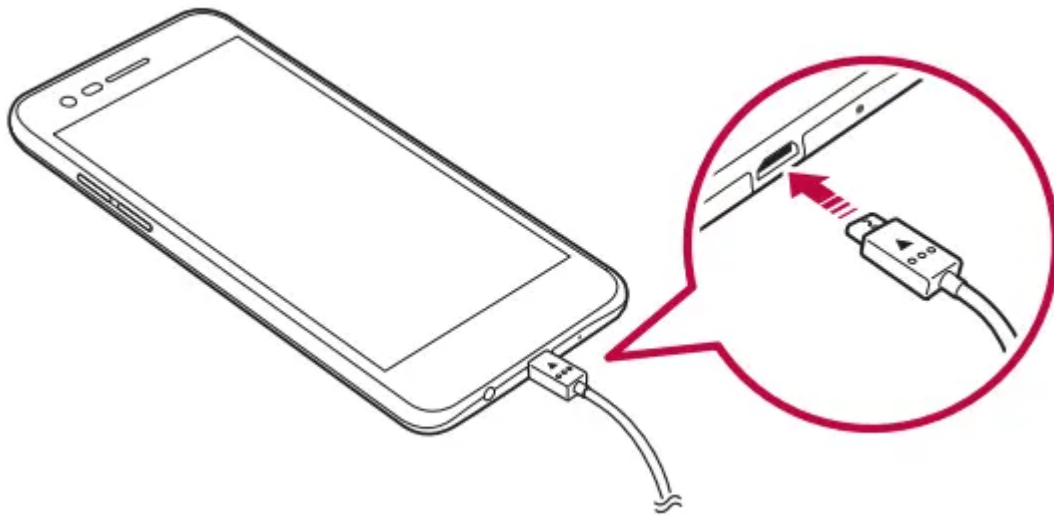

CAUTION:

- Make sure to use the USB cable provided with your device.
- Make sure to use an LG-approved charger, battery and charging cable.
- Charging the battery with a third-party charger may cause the battery to explode or may damage the device.
- Using the device when it is charging may cause electric shock. To use the device, stop charging it.

NOTE: Remove the charger from the power socket after the device is fully charged. This prevents unnecessary power consumption.

Precautions when using the device

- When replacing the battery, take extra care to ensure that no foreign substances or water enter the device.
- Ensure that the inside of the device does not make contact with a metallic object or water.
- Make sure to use the USB cable provided; do not use third party USB cables or chargers with your device. The LG limited warranty does not cover the use of third party accessories.
- Failure to follow the instructions in this guide and improper use may damage the device.

Using the battery efficiently

Battery lifespan may decrease if you keep many apps and functions running simultaneously and continuously.

Stop apps and functions from running in the background to increase battery life.

To minimize battery consumption, follow these tips:

- Turn off the Bluetooth® or Wi-Fi network function when not using them.
- Set the screen timeout to as short a time as possible.
- Minimize the screen brightness.
- Set a screen lock when the device is not in use.
- Check the battery usage details and close any downloaded apps that are draining the battery.

Touch screen

You can familiarize yourself with how to control your device by using touch screen gestures.

Tapping

Lightly tap with your fingertip to select or run an app or option.

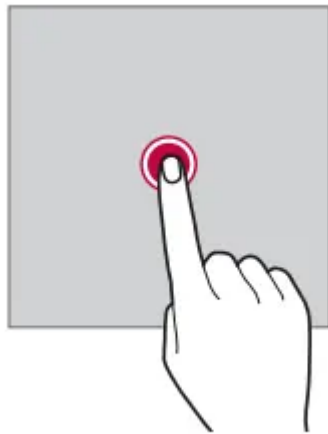

Touching and holding

Touch and hold for several seconds to display a menu with available options.



Double-tapping

Tap the screen twice quickly to zoom in or out on a specific app.

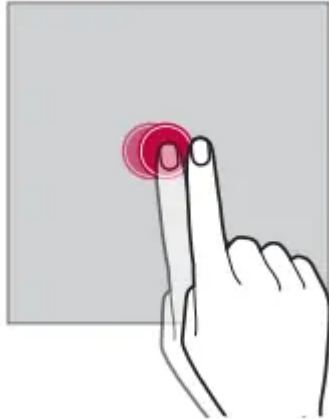

Dragging

Touch and hold an item, such as an app or widget, then move your finger to a desired location in a controlled motion. You can use this gesture to move an item.

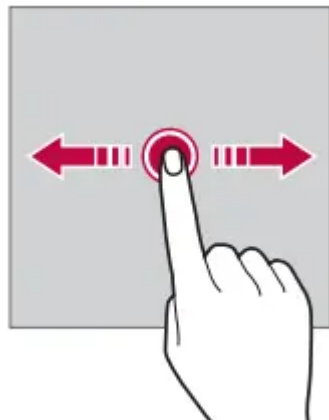

Home screen

Home screen overview

The Home screen is the starting point for accessing various functions and apps on your device. Tap  on any screen to directly go to the Home screen.

You can manage all apps and widgets on the Home screen. Swipe the screen left or right to view all installed apps at a glance.

Home screen layout

You can view all apps and organize widgets and folders on the Home screen.



NOTE: The Home screen may differ depending on the manufacturer policy, user settings, software version or service provider.

- **Status bar:** View status icons, the time and the battery level.
- **Weather widget:** View the weather information or time for a specific area.
- **Google search widget:** Perform a Google search by inputting spoken or written keywords.
- **Page icon:** Display the total number of Home screen canvases. You can tap the desired page icon to go to the page. The icon reflecting the current canvas will be highlighted.
- **Quick access area:** Fix main apps at the bottom of the screen so that they can be accessed from any Home screen canvas.
- **Home touch buttons**

-  Return to the previous screen. Close the keypad or pop-up windows.

-  Tap to go to the Home screen. To launch Google Assistant, touch and hold.

-  Tap to view a list of recently used apps or run an app from the list. To delete all the recently used apps, tap CLEAR ALL. To use two apps at the same time with the Multi-Window feature, touch and hold the button while using an app.

Lock/hide icon

The icon to lock or hide the Home touch buttons appears at the bottom left of the screen.













If you want to lock the Home touch buttons while shown, tap  on the left of the Home touch buttons.

To hide the Home touch buttons again, double-tap .

To deactivate the Lock/hide buttons feature, tap  > **Tools > Settings > Display > Home touch buttons > Show lock/hide icon**, then tap .

Status icons

When there is a notification for an unread message, calendar event or alarm, the status bar displays the corresponding notification icon. Check your device's status by viewing notification icons displayed on the status bar.

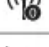
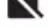
	No signal
	Data is being transmitted over the network
	Alarm is set
	Vibrate mode is on
	Bluetooth is on
	Connected to a computer via USB
	Battery level
	Airplane mode is on
	Missed calls
	Wi-Fi is connected
	Mute mode is on
	GPS is on
	Hotspot is on
	No SIM card

NOTE:

- Some of these icons may appear differently or may not appear at all, depending on the device's status. Refer to the icons according to the actual environment and area in which you are using the device and your service provider.
- Displayed icons may vary, depending on the area or service provider.

Switching the screen orientation

You can set the screen orientation to automatically switch according to the device's physical orientation.

On the notification panel, tap Rotation from the quick access icon list.

You can also tap  > **Tools > Settings > Display** and activate **Auto-rotate screen**.



Editing the Home screen

On the Home screen, touch and hold on an empty space, then select the desired action from below.

- To rearrange the Home screen canvases, touch and hold on a canvas, then drag it to a desired location.
- To add a widget to the Home screen, touch and hold on a blank area of the Home screen, then select **Widgets**.
- To change a wallpaper or theme, touch and hold on a blank area of the Home screen, then select Wallpaper & theme.

You can also tap  > **Tools > Settings > Display > Wallpaper & theme**, then select a wallpaper or theme to apply to the device.

- To configure the Home screen settings, touch and hold on a blank area of the Home screen, then select **Home screen settings**. See Home screen settings for details.
- To view or reinstall the uninstalled apps, touch and hold on a blank area of the Home screen, then select **App trash**. See App trash for details.
- To change the default screen, touch and hold on a blank area of the Home screen, move to desired screen, tap , then tap the screen once more.

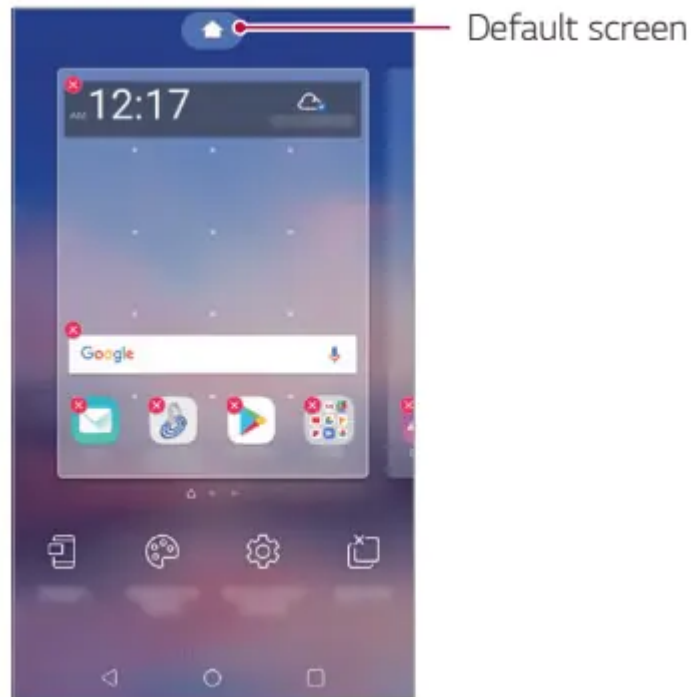

Screen lock

Screen lock overview

Your device's screen turns off and locks itself if you press the Power/Lock key. This also happens after the device is left idle for a specified period of time.

If you press the Power/Lock key when a screen lock is not set, the Home screen appears immediately.

To ensure security and prevent unwanted access to your device, set a screen lock.

NOTE: A screen lock prevents unnecessary touch input on the device screen and reduces battery consumption. We recommend that you activate the screen lock while not using the device.

Secure start-up settings

For additional security for your device, you can enable the Secure start-up option when setting a screen lock.

- You cannot use all functions, except for emergency calls, until you unlock the device.
- If you forget your decryption password, you cannot restore encrypted data and personal information.

Precautions for the secure start-up feature

- If you forget your decryption password, you cannot restore encrypted data and personal information.
- Be sure to keep your screen lock passwords separately.
- If you enter the screen lock passwords incorrectly more than the specified times, the device automatically resets itself and the encrypted data and your personal information are deleted automatically and they cannot be restored.
- Be cautious not to enter incorrect screen lock passwords more than the specified times.
- When you turn on the device right after the device reboots, encryption also starts. If you stop the encryption arbitrarily, the data may be damaged. Be sure to wait until the reboot is completed.

Memory card encryption

You can encrypt and protect data saved on the memory card. The encrypted data in the memory card cannot be accessed from another device.

1. Tap  > **Tools** > **Settings** > **Lock screen & security** > **Encryption & credentials** > **Encrypt SD card**.
2. Read the on-screen overview of memory card encryption and then tap **CONTINUE** to continue.
3. Select an option and tap **ENCRYPT NOW**.
 - **New data encryption:** Encrypt only data that is saved on the memory card after encryption.
 - **Full encryption:** Encrypt all the data currently saved on the memory card.
 - **Exclude media files:** Encrypt all files, except for media files such as music, photos and videos.



NOTE:

- To encrypt the memory card, make sure that a screen lock is set using a PIN or password.
- Once memory card encryption starts, some functions are not available.
- If the device is turned off while encryption is underway, the encryption process will fail, and some data may be damaged. Therefore, be sure to check that the battery level is sufficient before starting encryption.
- Encrypted files are accessible only from the device where the files were encrypted.

- The encrypted memory card cannot be used on another device. To use the encrypted memory card on another mobile device, format the card.
- You can activate memory card encryption even when no memory card is installed into the device. Any memory card that is installed after encryption will automatically be encrypted.

Adding languages to the keyboard

You can make additional languages available for keyboard input.

1. Tap  > **Tools > Settings > System > Language & input > On-screen keyboard > LG Keyboard > Select languages.** You can also tap  on the keyboard and tap **Select languages.**
2. Select the languages you want to use on the keyboard.

Do not disturb

You can limit or mute notifications to avoid disturbances for a specific period of time.

Tap  > **Tools > Settings > Sound > Do not disturb.**

- **Mode** and select the mode you want:
 - **Priority only:** Receive sound or vibrate notifications for the selected apps. Even when Priority only is turned on, alarms still sound.
 - **Total silence:** Disable both the sound and vibration.
- **Select priorities:** Receive alarms and the notifications for the selected apps.
 - **App notifications:** Select apps to receive the notifications.
 - **Calls from:** Set up a range of notifications when receiving a call.
 - **Repeated calls:** Second call from same caller within 15 min is not silenced.
 - **Messages from:** Set up a range of notifications when receiving a message.
- **Use Do not disturb:** Turn on the Do not disturb feature.
- **SCHEDULE:** Set the schedule for which you want to turn on the Do not disturb feature.
- **Help:** View the help for Do not disturb.

Useful Apps

Installing and uninstalling apps

Installing apps

Access an app store to search and download apps.

- You can use SmartWorld, Play Store or the app store provided by your service provider.

NOTE:

- Some app stores may require you to create an account and sign in.
- Some apps may charge fees.
- If you use mobile data, you may be charged for data usage, depending on your pricing plan.
- SmartWorld may not be supported depending on the area or service provider.

Uninstalling apps

Uninstall apps that you no longer use from your device.

Uninstalling with the touch and hold gesture

On the Home screen, touch and hold the app to uninstall, then drag it over Remove at the top of the screen.

- Uninstalled apps can be reinstalled within 24 hours of uninstallation. See App trash for details.

Uninstalling by using the settings menu

Tap  > **Tools > Settings > Apps & notifications > App info**, select an app, then tap **Uninstall**.

Uninstalling apps from the app store

To uninstall an app, access the app store from which you download the app and uninstall it.

NOTE: Some apps cannot be uninstalled by users.

App trash

You can view the uninstalled apps on the Home screen. You can also reinstall apps within 24 hours of uninstallation.



1. Touch and hold an empty area of the Home screen, then tap **App trash**.
2. Choose the desired option.
 - **Restore:** Reinstall the selected app.
 - : Remove the uninstalled apps permanently from the device.

NOTE:

- Uninstalled apps are automatically removed from the device 24 hours after they were uninstalled. If you want to reinstall the uninstalled apps, you must download them again from the app store.
- This feature is activated on the default Home screen only. If you uninstall apps while using the EasyHome screen or other launcher, they are immediately and permanently removed from the device.



Answering a call

To answer a call, drag  on the incoming call screen.



- When the stereo headset is connected, you can make calls by using the call/end button on the headset.
- To answer a call using a shortcut key, tap  > **Tools > Settings Network & internet > Call > Answer and end calls > Press the Volume Up key to**, and select **Answer call**.
- To end a call without turning off the screen, tap  **Tools > Settings > Network & internet > Call > Answer and end calls**, and activate **End call with the Power key**.

Rejecting a call

To reject an incoming call, drag  across the incoming call screen.

- To send a rejection message, drag the rejection message option  across the screen.
- To add or edit a rejection message, tap  > **Tools > Settings > Network & internet > Call > Call blocking & Ignore with message > Allow ignore with message**.
- When a call is coming in, press the Volume Up (+), Volume Down (-) or Power/Lock key to mute ringtone or vibration, or to hold the call.

Viewing call records



To view recent call records, tap  >  > **Call logs**. Then, you can use the following functions:

- To view detailed call records, select a contact. To make a call to the selected contact, tap .
- To delete call records, tap  > **Delete**.

NOTE: The displayed call duration may differ from the call charge. Consult with your service provider for more information.

Configuring call options

You can configure various call options.

1. Tap  >  > **Dial** or **Call logs**.
2. Tap  > **Call settings** and then configure the options to suit your preferences.

Camera

Starting the camera

You can take a photo or record a video to cherish all of your memorable moments.



Tap  > .

NOTE:

- Before taking a photo or recording a video, wipe the camera lens with a soft cloth.
- Be careful not to stain the camera lens with your fingers or other foreign substance.
- Images included in this user guide may be different from the actual device.
- Photos and videos can be viewed or edited in Gallery. See Gallery overview for details.

Changing the camera mode

You can select a camera mode that suits your environment to take a photo or record a video easily and conveniently.

Tap  >  > **MODE**, then select the desired mode.



Other useful features in the Camera app

Auto-Exposure/Auto-Focus lock

You can fix the current exposure level and focus position by touching and holding the screen in the Auto mode. To turn off the feature, tap a blank area on the screen.

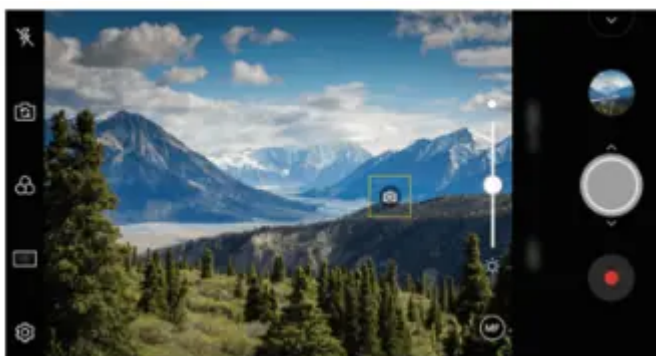

NOTE: This feature is available only in specific modes.

Selfie shot

You can use the front camera to view your face on the screen and take selfies.

Gesture shot

You can take selfies by using gestures.

Show your palm to the front camera and then clench your fist.

You can also clench your fist and then open it towards the front camera.

- In three seconds, a photo is taken.



Auto shot

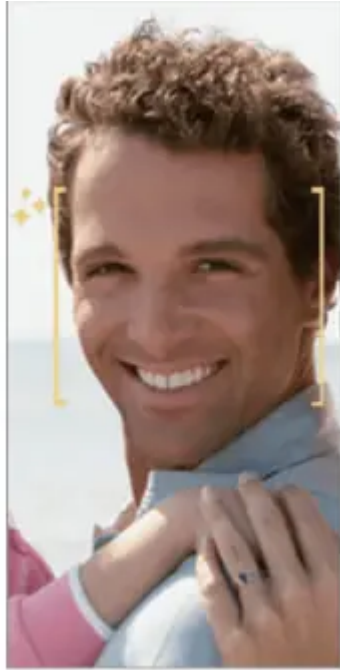

You can use the face detection feature to take selfies easily and conveniently. You can set the device so that, when you look at the screen, the front camera detects your face and takes a selfie automatically.

- The white colored guide frame appears when the front camera detects your face. If the subject within the guide frame stops moving, the guide frame color turns yellow, then the camera takes a photo.



quick share

You can share a photo or video using a desired app immediately after taking it.

1. Tap   , then take a photo or record a video.
2. Tap the app icon that appears on the screen to share it using that app.

You can also swipe the icon towards the opposite direction to see what other apps you can use to share your photos and videos.

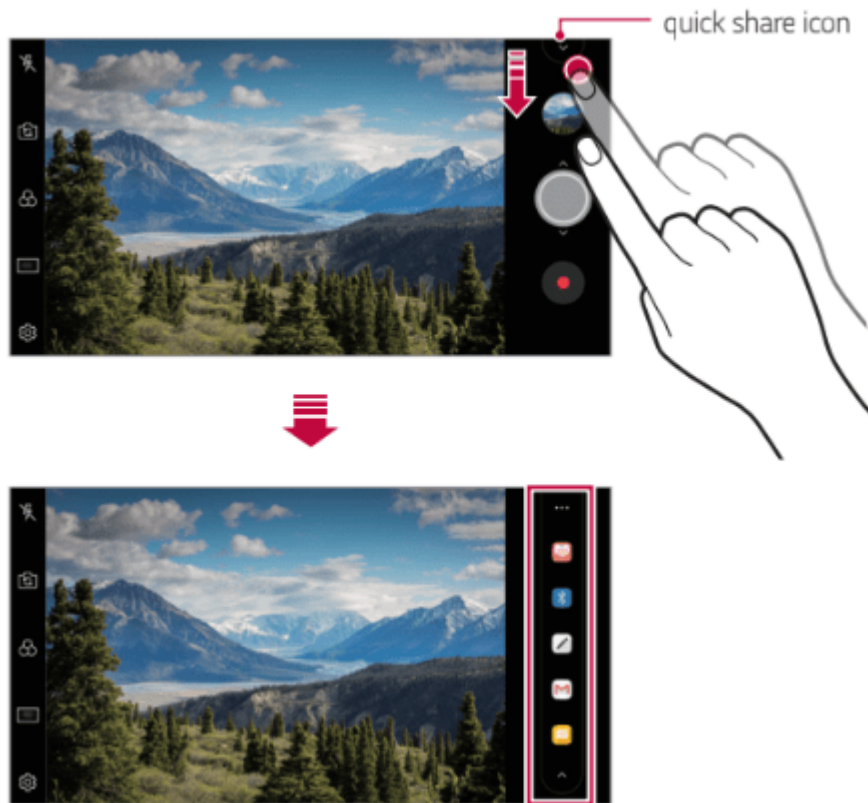

NOTE:

- The app displayed by the quick share icon may vary, depending on the type and frequency of access to the apps installed on the device.
- This feature is available only in specific modes.

Gallery

Gallery overview

You can view and manage photos and videos saved on your device.

1. Tap > .

- Saved photos and videos are displayed by folder.
2. Tap a folder and select a file.
- View the selected file in full-screen mode.
 - While viewing a photo, swipe left or right to view the previous or next photo.
 - While viewing a video, swipe left or right to rewind or fast-forward the video.

NOTE:

- Some file formats may not be supported, depending on the installed software.
- Some files may not be opened due to encoding.
- Files that exceed the size limit may cause an error.



Viewing photos

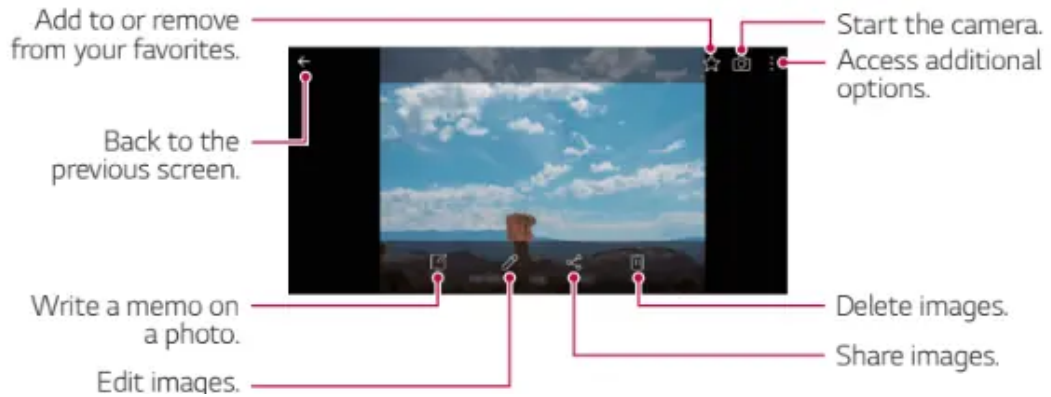



NOTE: To display the menu items, gently tap the screen. To hide the menu items, tap the screen again.

Writing a memo on the photo

1. While viewing a photo, tap .
2. Write a memo on the photo and tap **SAVE**.
 - The memo is applied to the photo.



NOTE: Some photos may not support the photo memo feature.

Editing photos

1. While viewing a photo, tap .
2. Use a variety of effects and tools to edit the photo.
3. Tap **SAVE** to save changes.
 - The changes are overwritten to the original file.
 - To save the edited photo as another file, tap  > **Save copy**.

Deleting files

You can delete files by using one of the following options:

- Touch and hold a file from the file list, then tap **Delete**.
- Tap  in an album, select files to delete, then tap **DELETE**.
- Deleted files are automatically moved to **Trash** and they can be restored to Gallery within 7 days.
- In Gallery, tap  > **Trash**, then tap  to permanently delete the files. In this case, the files cannot be restored.

Google apps

You can use Google apps by setting a Google account. The Google account registration window appears automatically when you use a Google app for the first time. If you do not have a Google account, create one from your device. For details on how to use an app, see the Help section in the app.

NOTE: Some apps may not work depending on the area or service provider.

Docs

Create documents or edit documents created online or from another device. Share and edit documents together with others.

Drive

Upload, save, open, share and organize files from your device. Files accessible from apps can be accessed from anywhere, including online and offline environments.

Duo

Make a video call with your family, friends and anyone else who uses the app.

Gmail

Register your Google email account to your device to check or send email.

Google

Use Google to search for web pages, images, news and more by entering or speaking keywords.

Maps

Find your location or the location of a place on the map. View geographical information.

Photos

View or share photos or albums saved on your device.

Play Movies & TV

Use your Google account to rent or purchase movies. Purchased contents can be played anywhere.

Play Music

Purchase music files from the Play Store. Play music files saved on your device.

Sheets

Create spreadsheets or edit spreadsheets created online or from another device. Share and edit spreadsheets together with others.

Slides

Create presentation material or edit presentation material created online or from another device. Share and edit presentation material together with others.

YouTube

Search and play videos. Upload videos on YouTube to share them with people around the world.

Contact list

Editing contacts

1. On the contact list screen, select a contact.
2. On the contact detail screen, tap  and edit details.
3. Tap **SAVE** to save changes.

Deleting contacts

You can delete contacts by using one of the following options:

- On the contact list screen, touch and hold a contact you want to delete, tap **Delete contact**, then tap **DELETE** to confirm.
- Tap  > **Delete** on the contact list screen, select contacts you want to delete, then tap **DELETE**.

Adding favorites



You can register frequently used contacts as favorites.

1. On the contact list screen, select a contact.
2. On the contact detail screen, tap .

Clock

Alarm

You can set an alarm to trigger it at a specified time.



1. Tap  > **Tools > Clock > Alarm**.
2. Tap  to add a new alarm.
3. Configure the alarm settings and tap **SAVE**.

NOTE:

- If you select a previously set alarm, you can edit the alarm.
- To delete an alarm, tap  at the top of the screen. You can also touch and hold the alarm.

World clock

You can view the current time in cities around the world.

1. Tap  > **Tools** > **Clock** > **World clock**.
2. Tap  and add a city.

Timer

You can set the timer to trigger an alarm after a specified period of time.

1. Tap  > **Tools** > **Clock** > **Timer**.
 2. Set the time and tap **Start**.
- To suspend the timer, tap **Pause**. To resume the timer, tap **Resume**.
3. Tap **Stop** to stop the timer alarm.

Stopwatch

You can use the stopwatch to record a lap time.



1. Tap  > **Tools** > **Clock** > **Stopwatch**.
 2. Tap **Start** to initiate the stopwatch.
- To record a lap time, tap **Lap**.
3. Tap **Pause** to suspend the stopwatch.
- To resume the stopwatch, tap **Resume**.
 - To clear all the records and restart the stopwatch, tap **Reset**.

Calendar

Calendar overview

You can use the calendar to manage events and tasks.

Adding events

1. Tap  > **Productivity** > **Calendar**.
2. Select a date and then tap  .
3. Enter event details and tap **SAVE**.



Syncing events

Tap  > **Calendars to sync** and select a calendar to sync.

NOTE: When your events are saved from the device to your Google account, they are automatically synced with the Google calendar, too. Then, you can sync other devices with the Google calendar in order to make those devices have the same events that your device has and to manage your events on those devices.

Tasks

You can register tasks to your device to easily manage schedules.

1. Tap  > **Tools > Tasks**.
2. Tap  to add a task.
3. Enter task details and then tap **SAVE**.

Email

Use the Email application to send and receive emails from your webmail or other accounts, using POP3 or IMAP, or access your Exchange account for your corporate email needs.

Set up Email account

Your phone supports several types of email accounts and allows you to have multiple email accounts set up at one time.

Before setting up an email account, make sure you have the username user ID), password, server name, etc., so you can get set up successfully.

1. Tap  > **Email**.
 2. Follow the onscreen instructions to set up your email account.
- The email account is set up and you will begin receiving email.

FM Radio

You can listen to FM Radio.

Tap  > **Media > FM Radio**.

NOTE:

- To use this app, first connect earphones to the device. The earphones function as the radio antenna.
- This function may not be supported depending on the area.

Settings

You can customize the device settings in accordance with your preferences.

Tap  > **Tools > Settings.**

Network & internet

Airplane mode

You can turn off the call and mobile data functions. When this mode is on, functions that do not involve data, such as games and music playback, remain available.

1. On the settings screen, tap **Network & internet > Airplane mode.**
2. Tap **TURN ON** in the confirmation screen.

Wi-Fi

You can connect to nearby devices over a Wi-Fi network.

Connecting to a Wi-Fi network

1. On the settings screen, tap **Network & internet > Wi-Fi.**
2. Tap to activate it.
 - Available Wi-Fi networks appear automatically.
3. Select a network.
 - You may need to enter the network's Wi-Fi password.
 - The device skips this process for previously accessed Wi-Fi networks. If you do not want to automatically connect to a certain Wi-Fi network, tap the network and then tap **FORGET.**

Wi-Fi Direct

You can connect your device to other devices that support Wi-Fi Direct to share data directly with them. You do not need an access point. You can connect with more than two devices by using Wi-Fi Direct.

1. On the settings screen, tap **Network & internet > Wi-Fi >  > Advanced Wi-Fi > Wi-Fi Direct.**

- Nearby devices that support Wi-Fi Direct automatically appear.
2. Select a device.
 - Connection occurs when the device accepts the connection request.

Mobile data

You can turn mobile data on and off. You can also manage mobile data usage.

Turning on mobile data

1. On the settings screen, tap **Network & internet > Mobile data.**

2. Tap  to activate it.

Customizing mobile data settings

1. On the settings screen, tap **Network & internet > Mobile data**.
2. Customize the following settings:
 - **On:** Enable to use data connections on mobile networks.
 - **Limit mobile data usage:** Set a limit for mobile data usage to block mobile data if the limit is reached.
 -  : Customize the desired mobile data settings.

Mobile networks

You can customize the following mobile network settings.

1. On the settings screen, tap **Network & internet > Mobile networks**.
2. Customize the following settings:
 - **VoLTE (This function may not be available depending on the service provider):** You can enable HD Voice and advanced communication services where available.
 - **Data roaming:** Turn data roaming on or off.
 - **Network type and strength (This function may vary depending on the service provider):** Displays the current network type and the signal strength.
 - **Access Point Names:** View or change the access point for using mobile data services. To change the access point, select a choice from the access point list.
 - **Roaming state (This function may vary depending on the service provider):** Displays your current roaming state.

Sound

You can customize sound, vibration and notification settings.

On the settings screen, tap Sound and customize the following settings:

- **Sound profile:** Change the sound mode to Sound, Vibrate only, or Silent.
- **Volume:** Adjust the sound volume for various items.
- **Ringtone:** Select a ringtone for incoming calls. Add or delete ringtones.
- **Ringtone ID:** Create a ringtone for an incoming call from a particular contact.
- **Ring with vibration:** Set the device to vibrate and play a ringtone simultaneously.
- **Notification sound:** Select a notification ringtone. Set music saved on the device as a notification ringtone.

- **Do not disturb:** Set the time, range and app type to receive notification messages. Receive notification messages only on particular days of the week.
- **Vibration type:** You can select the type of vibration when receiving calls.
- **Vibrate on tap:** Set the device to vibrate when you tap certain items on the screen.
- **Dialing keypad sound:** Enable the keypad sound effect.
- **LG Keyboard sound:** Enable the LG keyboard sound effect.
- **Touch sound:** Enable the sound effect for tapping an item.
- **Screen lock sound:** Enable the sound effect to play when the screen is locked or unlocked.
- **Emergency tone:** Set behavior when an emergency call is made.

Display

The Display category allows you to manage various display settings.

On the settings screen, tap **Display** and customize the following settings:

- **Home screen:** Customize settings for the Home screen. See Home screen settings for details.
- **Wallpaper & theme:** Select wallpaper or screen theme for your device.
- **Font:** Change the font size, boldness, or face.
- **Home touch buttons:** Rearrange Home touch buttons or change their background colors.
- **Display size:** Set the items on the screen to a size that is easy for you to see. Some items may change position.

NOTE: When you change the screen resolution, currently running apps are closed.

- **Comfort view:** Set the device to reduce amount of blue light on screen to reduce eye strain.
- **Brightness:** Use the slide bar to change the device's screen brightness. To automatically adjust screen brightness according to ambient light intensity, tap the Auto switch.
- **Auto-rotate screen:** Automatically rotate the screen according to the device's orientation.
- **Screen timeout:** Automatically turn off the screen when the device is left idle for a specified period of time.
- **Screen saver:** Display a screen saver when the device is connected to the holder or charger. Select a screen saver type to display.

Extensions

Smart cleaning

You can clean up temporary files or apps that are no longer used to free up storage space.

1. On the settings screen, tap **Extensions > Smart cleaning**.
2. Select a category, then select an item to delete.
3. Tap **DELETE > DELETE** to delete the selected item.

Apps & notifications

You can check a list of installed apps, and configure the settings for notifications, app permissions, and more.

1. On the settings screen, tap **Apps & notifications**.
2. Customize the settings as desired.

Battery

You can view the current battery information or turn on power-saving mode.

1. On the settings screen, tap **Battery**.
2. Customize the following settings:
 - **Battery usage:** View the battery usage details. To view more details, select a specific item.
 - **Battery percentage on status bar:** Display the remaining battery level as a percentage on the status bar.
 - **Battery saver:** Reduce battery consumption by cutting down some device settings, such as the display brightness, speed and vibration intensity.
 - **Power saving exclusions:** Select apps to use without any functional limitation while in power saving or battery optimization mode.

Accounts

You can add or manage accounts, including a Google account. You can also sync particular apps or user information automatically.

1. On the settings screen, tap **Accounts**.
2. Customize the following settings:
 - **Auto-sync accounts:** Sync all the registered accounts automatically.
 - **ACCOUNTS:** View a list of registered accounts. To view or change details of an account, tap the account.
 - **Add account:** Add accounts.

Google

You can use Google settings to manage your Google apps and account settings.

On the settings screen, tap **Google**.

System

Update center

From time to time, updates may become available for your phone. You can download and apply updates through the Settings menu.

On the settings screen, tap System Update center.

Language & input

You can customize language and keyboard settings for your device.

1. On the settings screen, tap System Language & input.
2. Customize the following settings:
 - **Language:** Select a language to apply for the device.
 - **Current keyboard:** View the keyboard currently in use. Select a keyboard to use when entering text.
 - **On-screen keyboard:** Change the LG keyboard settings or voice recognition feature of Google Voice.
 - **Physical keyboard:** Select to use the physical keyboard, or check keyboard shortcut keys.
 - **Text-to-speech output:** Configure the settings for text-to-speech output.
 - **Pointer speed:** Adjust the pointer speed of a mouse or trackpad.
 - **Reverse mouse buttons:** Reverse the right mouse button to perform primary direct-manipulation actions.

Date & time

You can customize date and time settings for your device.

1. On the settings screen, tap **System > Date & time**.
2. Customize the desired settings.

Backup

You can back up data saved on your device to another device or account.

1. On the settings screen, tap System Backup.

2. Customize the following settings:

- **Google backup:** Change Google drive backup settings. You can also check the backup account currently used, or add a new backup account.

Restart & reset

You can reset the device including network and app settings.

1. On the settings screen, tap **System > Restart & reset**.

2. Customize the following settings:

- **Auto-restart:** Automatically restart the phone once a week. The phone will restart within one hour of the set time.

NOTE: Any unsaved data and notifications, including badges, will be cleared after a restart. Make sure you save what you are doing.

- **Network settings reset:** Reset Wi-Fi, Bluetooth and other network settings.
- **Reset app preferences:** Reset the settings for an app. The data saved in the app will not be deleted.
- **Factory data reset:** Reset all settings for the device and delete data.

NOTE: Resetting your device deletes all data on it. Enter your device name, Google account and other initial information again.

About phone

You can view information about your device, such as the name, status, software details and legal information.

On the settings screen, tap **System > About phone** and view information.

Appendix

LG Mobile Phone software update via Over-the-Air (OTA)

This feature allows you to conveniently update your phone's software to a newer version via OTA, without connecting a USB cable. This feature will only be available if and when LG makes a newer firmware version available for your device.

To perform the phone software update, tap  > **Tools > Settings > System > Update center > Software Update**.

NOTE:

- Your personal data from internal phone storage—including information about your Google account and any other accounts, your system/ application data and settings, any downloaded applications and your DRM license—might be lost in the process of

updating your phone's software. Therefore, LG recommends that you backup your personal data before updating your phone's software. LG does not take responsibility for any loss of personal data.

- This feature depends on the area or service provider.

Anti-Theft Guide

You can set up your device to prevent other people from using it if it's been reset to factory settings without your permission. For example, if your device is lost, stolen, or wiped, only someone with your Google account or screen lock information can use the device.

All you need to make sure your device is protected is:

- Set a screen lock: If your device is lost or stolen but you have a screen lock set, the device can't be erased using the Settings menu unless your screen is unlocked.
- Add your Google account on your device: If your device is wiped but you have your Google account on it, the device can't finish the setup process until your Google account information is entered again.

After your device is protected, you'll need to either unlock your screen or enter your Google account password if you need to do a factory reset. This ensures that you or someone you trust is doing the reset.

NOTE: Do not forget the Google account and password you had added to your device prior to performing a factory reset. If you can't provide the account information during the setup process, you won't be able to use the device at all after performing the factory reset.

FAQ

This chapter lists some problems you might encounter when using your phone. Some problems require you to call your service provider, but most are easy to fix yourself.

SIM card error

- There is no SIM card in the phone or it is inserted incorrectly.
 - Make sure the SIM card is correctly inserted.

No network connection/ Dropped network

- Signal is weak or you are outside the carrier network.
 - Move toward a window or into an open area. Check the network operator coverage map.

No applications can be set

- Not supported by service provider or registration required.
 - Contact your service provider.

Downloaded application causes a lot of errors.

- Remove the application.
 1. Tap  > **Tools > Settings.**
 2. Tap **Apps & notifications > App info.**
 3. Tap the app > **Uninstall.**

Calls not available

- Dialing error
 - New network not authorized.
- New SIM card inserted.
 - Check for new restrictions.

Device cannot be turned on

- Battery is not charged.
 - Charge battery. Check the charging indicator on the display.

Charging error

- Battery is not charged.
 - Charge the battery.
- Outside temperature is too hot or cold.
 - Make sure to charge the device in a moderate temperature environment.
- Contact problem
 - Check the charger and its connection to the device.
- No voltage
 - Plug the charger into a different outlet.
- Charger defective
 - Replace the charger.
- Wrong charger
 - Use only original LG accessories.

Number not allowed.

- The Fixed dialing number function is on.
 - Check the Settings menu and turn the function off.

Files do not open

- Unsupported file format
 - Check the supported file formats.

The screen does not turn on when I receive a call.

- Proximity sensor problem
 - If you use a protection tape or case, make sure it has not covered the area around the proximity sensor. Make sure that the area around the proximity sensor is clean.

No sound

- Vibration mode
 - Check the settings status in the sound menu to make sure the device is not in vibration or no interruptions mode.

Hangs up or freezes

Intermittent software/ hardware problem

- Restarting the device

If your device freezes or hangs, you may need to close apps or turn off the device and turn it on again.

- Performing a boot-up

Press and hold the Power/Lock key and the Volume Down (-) key for about 10 seconds to restart your device.

- Resetting the device

If the methods above do not solve your problem, perform a factory data reset.

On the settings screen, tap **System > Restart & reset > Factory data reset**.

* Reset all settings for the device and delete data. Before performing the factory data reset, remember to make backup copies of all important data stored in the device.

* If you registered a Google account to the device, you must sign in to the same Google account after resetting the device.

Warning

This content is compiled from multiple sources and is provided for reference purposes only. It may not be complete or fully applicable to all situations. If you are unable to resolve your issue, please contact the product manufacturer or an authorized service provider for official support.

