

Package Contents

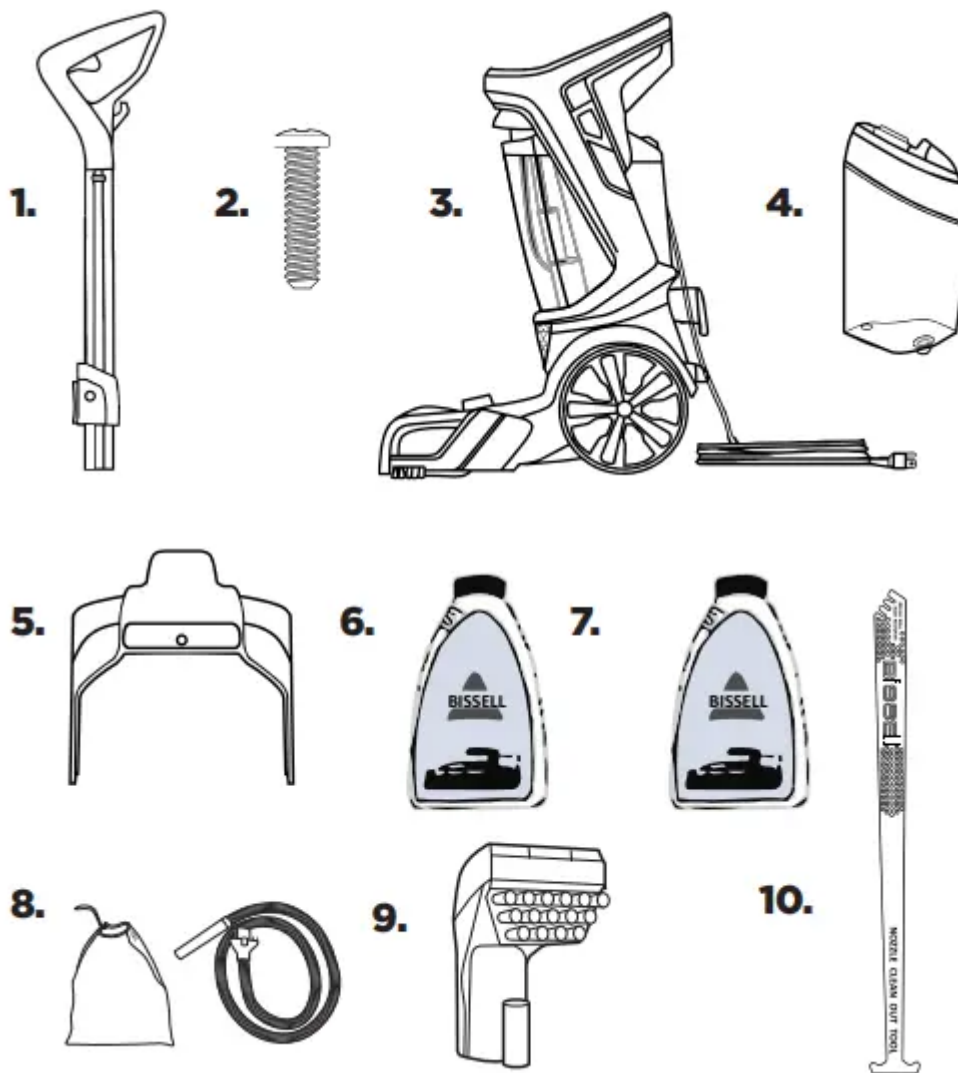

1. Upper Handle
2. 1 Screw attached to Upper Handle
3. Base with Dirty Water Tank
4. Clean Water Tank
5. Carry Handle
6. BISSELL Professional Deep Cleaning Formula
7. BISSELL Deep Clean + Antibacterial Formula
8. Accessory Bag & Hose
9. Attachments/Accessories (vary by model)
10. Nozzle Clean Out Tool

NOTE: Standard accessories may vary by model. To identify what should be included with your purchase, please refer to the “Carton Contents” list located on the carton top flap.

Getting to Know Your Deep Cleaner

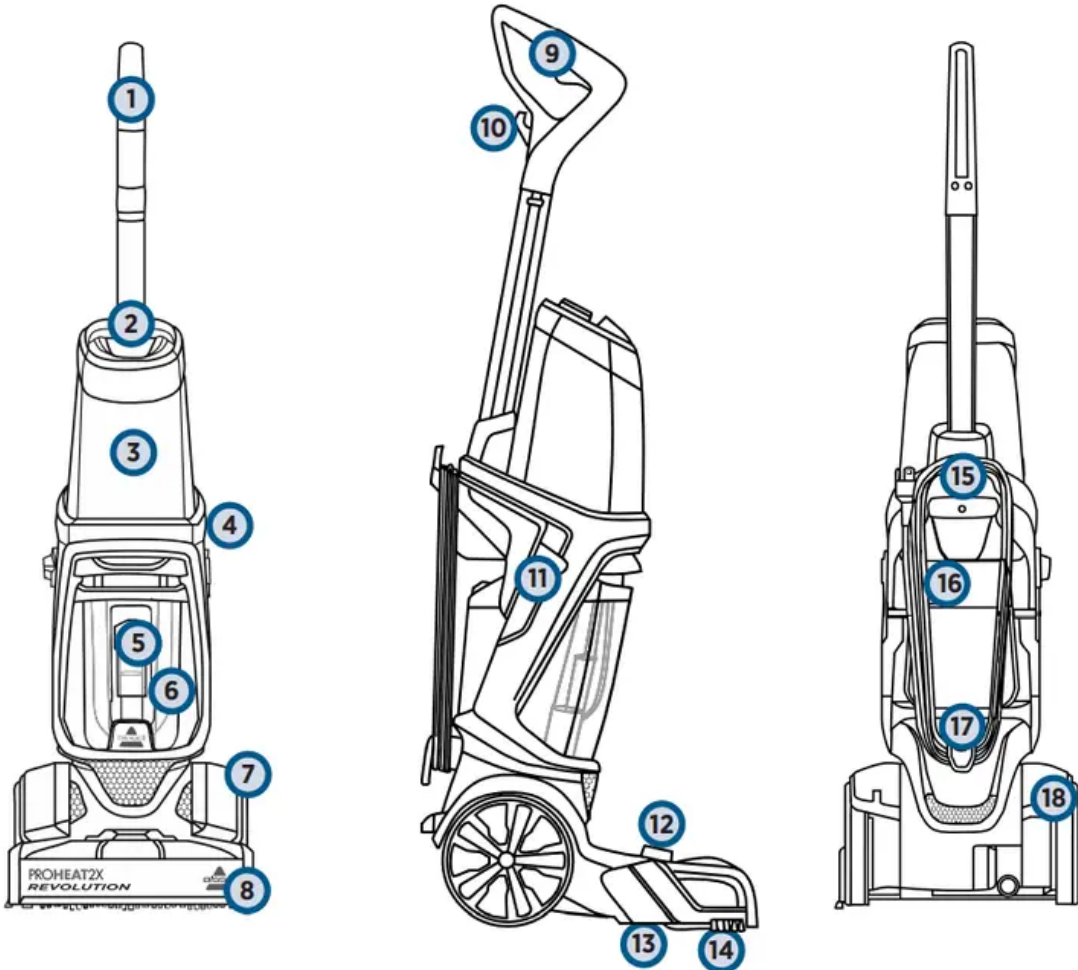

1. Upper Handle
2. Easy Fill/Formular Cap
3. Clean Water Tank (1 Gallon Capacity)
4. Power Switch
5. Float Stack
6. Dirty Water Tank
7. Belt Access Door
8. Foot
9. Spray Trigger
10. In-Use Cord Clip
11. Cleaning Mode Switch

- 12. Accessory Hose Door
- 13. Belt/Brush Access Plate
- 14. EdgeSweep® Brushes
- 15. Carry Handle
- 16. Rubber Tab (on Dirty Water Tank)
- 17. Quick Release™ Cord Wrap
- 18. Recline Pedal

Assembly

1. First, insert the Upper Handle at the top of the base until you hear a “click”.

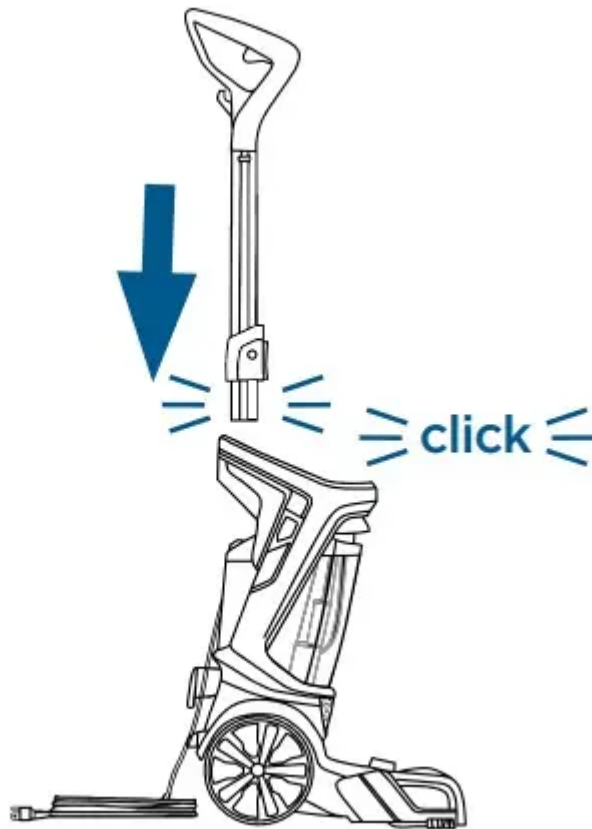

2. Next, align the Carry Handle with the slots on either side of the base (behind the Power Switch and Cleaning Mode Switch). The Carry Handle will “click” into place.

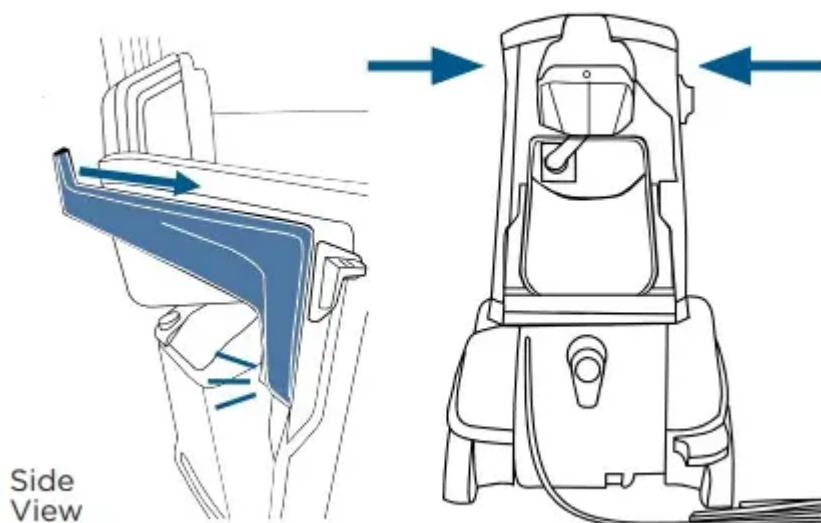

3. Using a Phillips-head screwdriver, secure the Carry Handle and the Upper Handle with the screw that's taped to the Upper Handle.

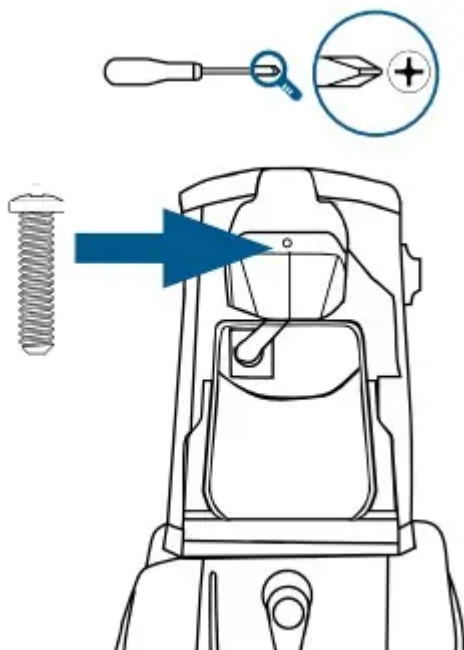

4. Wrap the cord around the Carry Handle and Quick Release™ Cord Wrap.

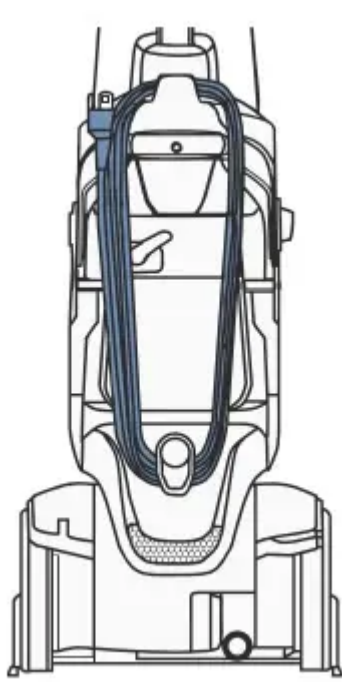

5. At the bottom of the Upper Handle, align the Clean Water Tank with the grooves and

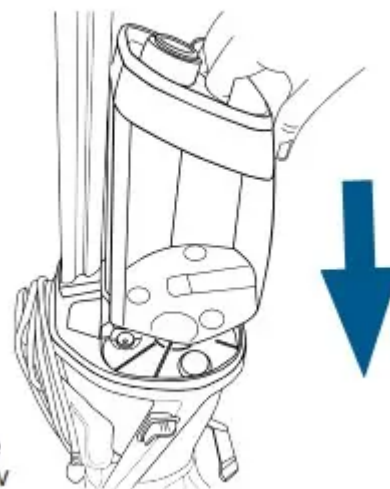















slide the tank into place.

Cleaning Formulas

Keep plenty of genuine BISSELL 2X®* formula on hand so you can clean and protect whenever it fits your schedule.

Always use genuine BISSELL deep cleaning formulas. Non-BISSELL cleaning formulas may harm the machine and may void the warranty.

PRETREAT PRETREAT SPOTS AND STAINS TO IMPROVE CARPET CLEANING PERFORMANCE			BOOST CARPET CLEANING FORMULA ENHANCER			
						
Stain Pretreat	Pet Stain Pretreat	Pet Pretreat + Sanitize	Oxy Boost	Renew Boost	Prevent Boost	Pet Oxy Boost
Pretreat to penetrate and loosen tough stains	Pretreat to help remove tough pet stains and odors	Penetrates to sanitize and loosen tough stains	Removes old, set-in stains permanently	Revives carpets to look their best	Repels stains from soaking into carpet fibers	Removes pet stains and odors permanently

easy fill SYSTEM™	PROFESSIONAL FORMULA	2X CLEANING FORMULA					BARE FLOOR FORMULAS
							
DeepClean + Antibacterial	Professional Deep Cleaning	Pet Stain & Odor	Deep Clean & Protect	Allergen Cleansing	Deep Clean + Refresh	Deep Clean + Oxy	Hard Floor Solutions
2-in-1 formula	Outcleans all other formulas Includes Scotchgard™ Protector	Removes tough pet stains and contains patented odor removal technology Includes Scotchgard™ Protector	Deep cleans carpets and protects from future stains with Scotchgard™ Protector	Helps remove pet & pollen allergens	Powerful cleaning with a refreshing scent	Removes deep down dirt, pet stains & pet odor	Safe use for linoleum, vinyl and ceramic tile; removes tough dirt and grime

Tips Before Carpet Cleaning

- If cleaning an entire room, consider moving your furniture to another area.
- Use a dry vacuum cleaner over area before using your deep cleaner.
- Pretreat stains with BISSELL Pretreat to improve performance on coffee stains and ground-in dirt.
- Please reference pages 11-13 for important tips on cleaning carpet and area rugs.



Filling Your Clean Water Tank

1. The Clean Water Tank is at the top of the machine.

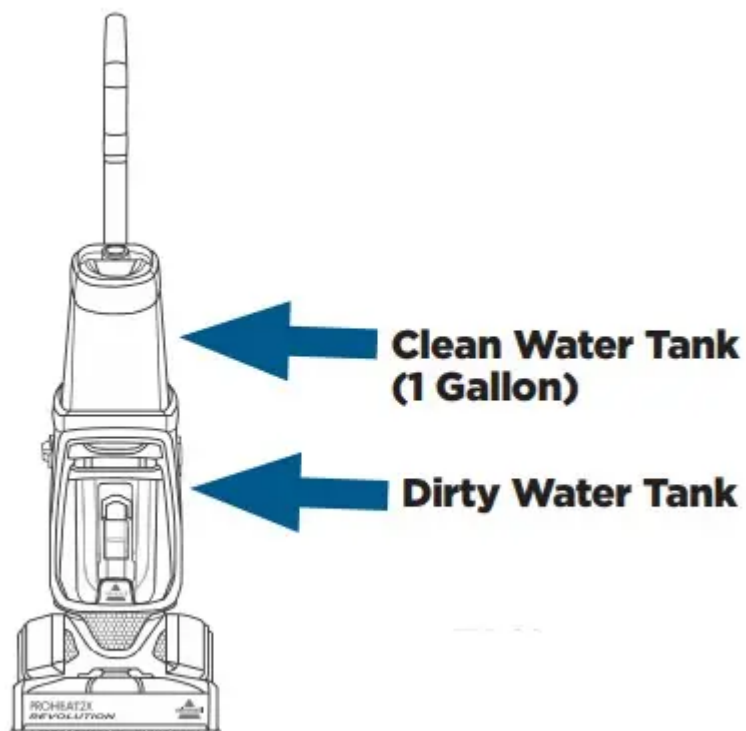

2. Lift the Clean Water Tank straight up to remove from the machine.

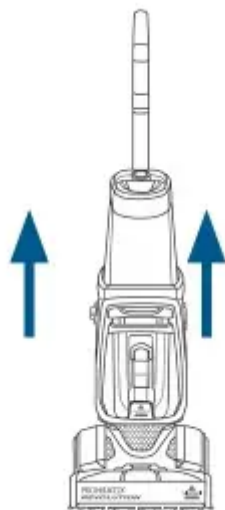

3. Unscrew the cap from the Clean Water Tank. Add hot tap water to the water fill line.



4. With Trial Size Antibacterial Formula: Pour into the Clean Water Tank up to the EasyFill line.

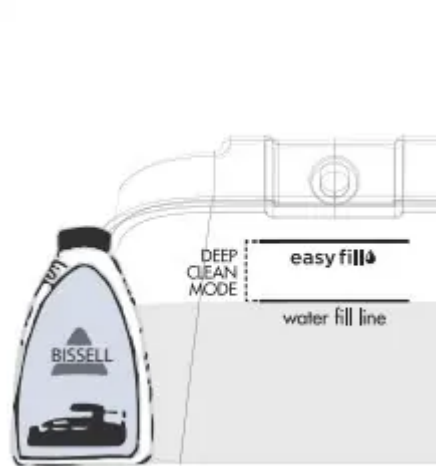

line. Twist the cap back onto the tank.

5. At the bottom of the Upper Handle, align the Clean Water Tank with the grooves and



slide the tank into place.

For Future Use with Full Size Antibacterial Formula: After filling the Clean Water Tank with hot tap water, twist the yellow cap back onto the tank. Firmly insert the full size formula bottle into the cap on the Clean Water Tank and squeeze until formula reaches the EasyFill line.

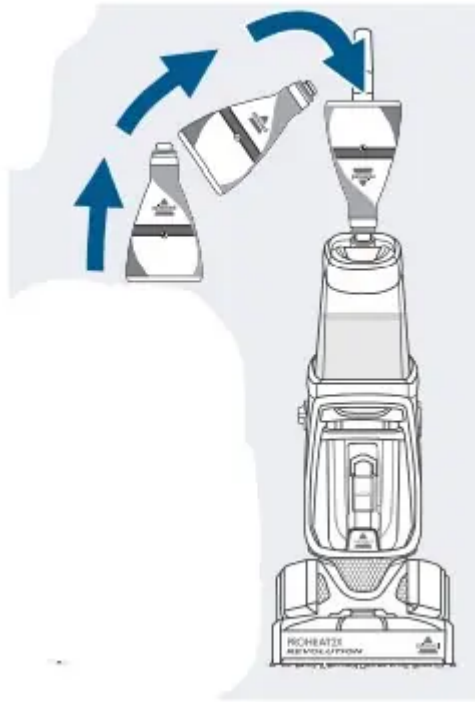

A few notes about filling the Clean Water Tank:

- Fill with hot (140°F/60°C MAX) tap water and add the appropriate BISSELL® formula. DO NOT USE BOILING WATER. DO NOT HEAT WATER OR TANK IN MICROWAVE.
- When using BISSELL Deep Clean + Antibacterial formula: Only fill your Clean Water Tank with the recommended amount of water and formula to achieve antibacterial benefits.

BISSELL® 2X® Concentrated Formula

1. The Clean Water Tank is at the top of the machine.

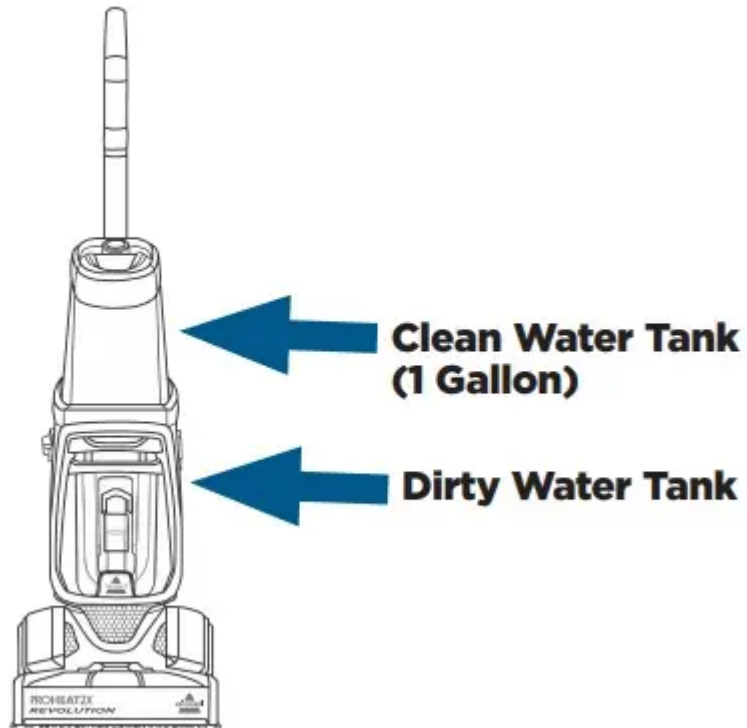

2. Lift the Clean Water Tank straight up to remove from the machine.

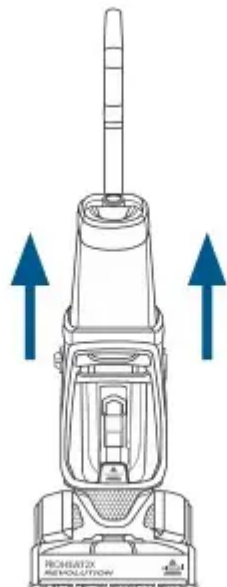

3. Unscrew the cap from the Clean Water Tank. Add hot tap water to the water fill line. Next, reference the chart below for formula amounts to add to the tank. Twist cap back into place.



place.

4. At the bottom of the Upper Handle, align the Clean Water Tank with the grooves and

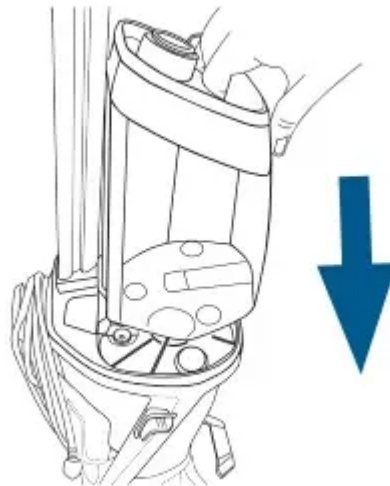

slide the tank into place.

NOTE: Fill with hot (140°F/60°C MAX) tap water and add the appropriate BISSELL formula. DO NOT USE BOILING WATER. DO NOT HEAT WATER OR TANK IN MICROWAVE. Do not substitute BISSELL 2X Formula with other household cleaning products.



Pour in more power with BISSELL Boosts

- Fill tank with water and 2X® formula (step 3 above).
- Add 2 ounces of any BISSELL Boost per 1-gallon of water.
- The ProHeat 2X® Revolution™ has a 1 gallon Clean Water Tank.

Cleaning Your Carpet

1. Plug into a properly grounded outlet.

2. Select Cleaning Mode

Max Clean

- Provides a heavy cleaning for your dirtiest carpets.
- Dry Time: About 8 hours.

Deep Clean

- Delivers a deep clean to your carpet.

Express Clean

- Provides a lighter clean.
- Dry Time: About 30 minutes.
- Recommended Cleaning Pace: 12 inches per second

3. Press the Power Switch to turn the machine ON. To recline your machine for use, press the recline pedal with your foot.

4. Max Clean & Deep Clean Modes:

Standard Cleaning

1. Press the Spray Trigger to apply solution while making 2 slow, wet passes (1 forward, 1 back).
2. Release the Spray Trigger.
3. Make 2 slow, dry passes (1 forward, 1 back) to suck up the dirty solution. Do not hold down the trigger for this step

Using BISSELL® Deep Clean + Antibacterial Formula

1. Press the Spray Trigger to apply solution while making 3 slow, wet passes (1 forward, 1 back, and 1 forward again).
2. Release the trigger.
3. Make 1 slow, dry pass back to suck up the dirty solution. Do not hold down the trigger for this step.

Express Clean Mode:

Recommended Cleaning Pace: 12 inches per second

1. Press the Spray Trigger to apply solution while making 2 wet passes (1 forward, 1 back).
2. Release the Spray Trigger.

3. Make 2 dry passes (1 forward, 1 back) to suck up the dirty solution. Do not hold down the trigger for this step.

CLEANING TIPS:

- To prevent damage to Berber carpets, avoid repeated strokes in the same area.
- For best cleaning performance, clean with your machine in Deep Clean Mode.
- Choose Deep Clean Mode and use BISSELL Deep Clean + Antibacterial to deliver antibacterial benefits
- In Max Clean Mode dry time is an estimated 8 hours. To expedite the drying process, place a fan in the room or near the carpet.
- In Express Clean Mode, the Dirty Water Tank will not get as full as when cleaning with Deep or Max Clean Mode.
- It is common to refill the Clean Water Tank and empty the Dirty Water Tank multiple times during the cleaning process. Room size and the speed at which you clean both affect how often the tank may need to be refilled and/or emptied.

Cleaning Area Rugs

IMPORTANT: Please check manufacturer's tag before cleaning area rugs for any specialized cleaning instructions. We do not recommend deep cleaning delicate, silk, wool, antique, or area rugs without a manufacturer's tag.

Regularly clean your high-traffic area rugs in Express Clean Mode:

- Check the manufacturer's tag.
- Select Express Clean Mode.
- When cleaning area rugs, place the rug on a sealed surface to test for colorfastness in an inconspicuous area. Your cleaner should not be used on unsealed surfaces.
- Important: Keep the foot of the deep cleaner perpendicular to the rug's edge with each cleaning pass to prevent damage.

Cleaning with Hose and Tool

- Keep hair, loose clothing, fingers, and all parts of body away from openings and moving parts. The Brush Roll continues to rotate when in the upright position.
- The Brush Roll continues to turn while product is turned on and handle is in upright position. To avoid damage to carpet, rugs, furniture, and flooring, avoid tipping cleaner or setting it on furniture, fringed area rugs or carpeted stairs during tool use.

- With Brush Roll on, do not allow cleaner to sit in one location for an extended period of time, as damage to floor can result.

1. Lift the Accessory Hose Door on top of foot on the front of the machine. The door flips toward the machine to open.



2. Insert the hose and snap into place. Be sure the colored hose release clip is facing out, away from machine.



3. Attach the tool to the end of the hose. (Tools may vary by model.) Press the Power Switch to turn machine ON.

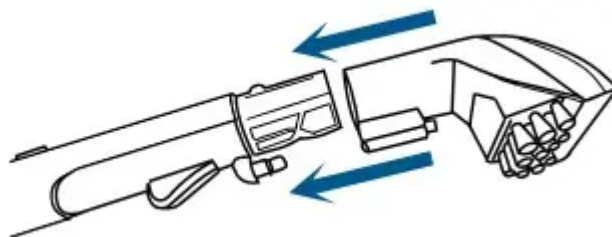

4. Press the Spray Trigger button to spray the soiled area, then slowly move tool back and forth over the area. Release the trigger to suck up the dirty solution. Work in small sections until the area is clean. When finished cleaning, turn the machine ON to suction up warm clean water to rinse the inside of the hose and tool. Detach the hose and tool

and close the Accessory Hose Door. Let the hose and tool air dry before storing.

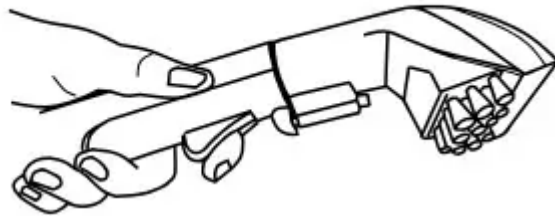

NOTE: If using the Mini Deep Reach Tool, be sure the needles of the tool are pressed down into the carpet so the spray gets into the carpet fibers.

Cleaning with the Bare Floor Tool*

*The Bare Floor Tool that is compatible with the ProHeat 2X® Revolution™ is not included. It is available for purchase by contacting our team by phone or visiting us online

1. With the machine unplugged, attach the Bare Floor Tool to the bottom of the machine by lining the tool to the edge of the nozzle. Rotate down until it clicks into place. Follow filling instructions on pages 9 and 10 and switch Cleaning Mode to Express Clean.

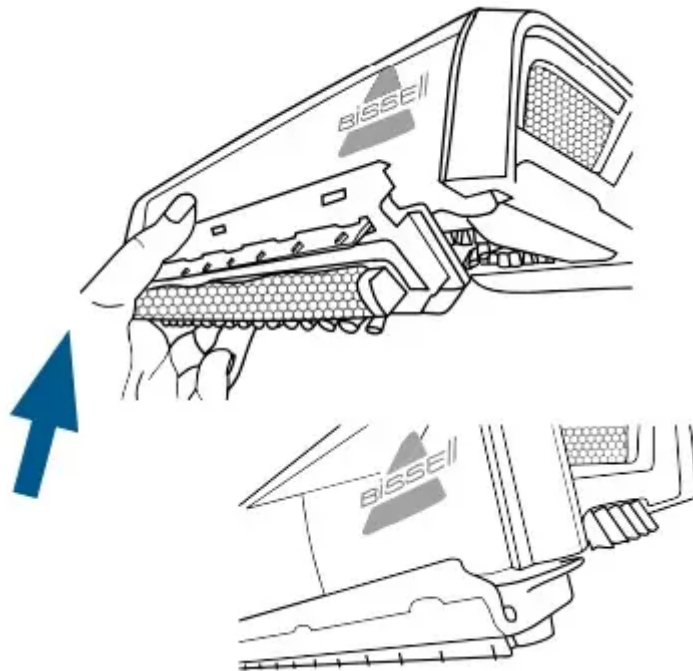

2. Plug into a properly grounded outlet and press the Power Switch. Clean by pressing the trigger for 1 wet pass forward, 1 wet pass back. Then release the trigger and make 1 dry

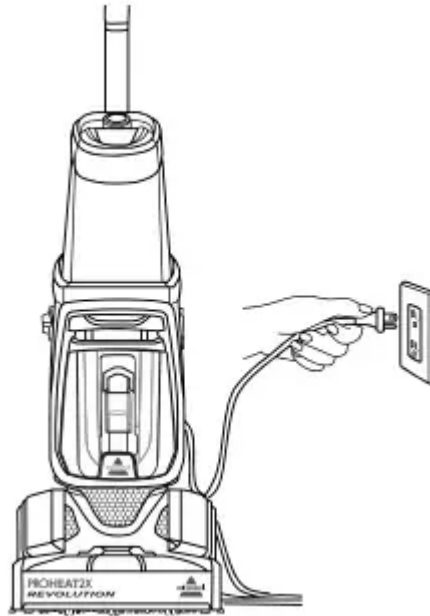

pass forward, 1 dry pass back.

3. When finished, unplug the machine and remove the Bare Floor Tool by rotating the tool up to unhook from the nozzle. Rinse and let dry before storing. Refer to page 14 for “Emptying the Dirty Water Tank”. Refer to page 15 for “Cleaning Machine After Use”.

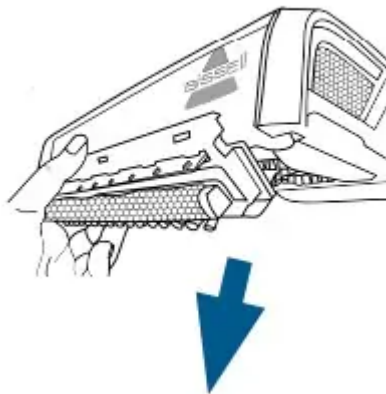

Emptying the Dirty Water Tank

1. To release Dirty Water Tank, press down on the colored tank Handle.

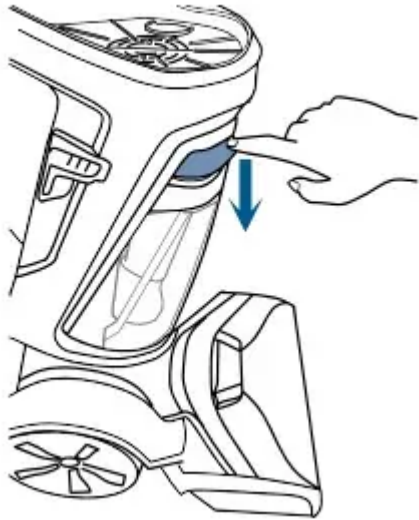

2. Tilt the tank slightly toward you. Grab the handle and tank with both hands.



3. Pull Dirty Water Tank up and away to remove.



4.



For quick empty:

- Pull the rubber tab (located in the middle of the tank) and tilt to pour.
- When closing the rubber tab, make sure all edges are sealed tight.

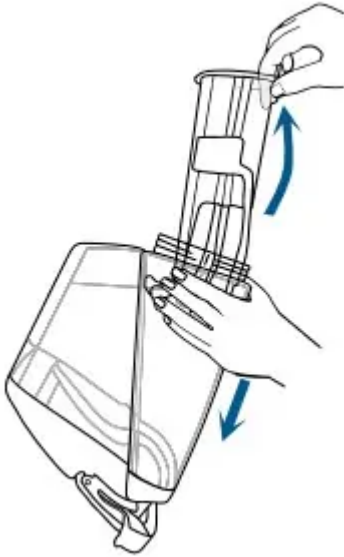

For final clean and rinse: Unscrew the ring at the bottom of tank.

- Gently remove the Float Stack, rinse, and clean.
- Once clean, return Float Stack into the tank by lining up the arrows so they point at each other. This is the only way the Float Stack will fit into the tank.
- With the arrows aligned, the Float Stack should lock into place.
- Return the ring and twist to lock. Water may leak if the ring is not fully tightened.

5. Clean the red filter below the Dirty Water Tank by wiping off any remaining dirt or debris.

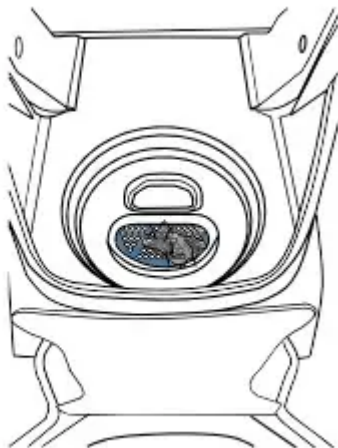

6. To return the Dirty Water Tank: Angle the tank and insert bottom first. Then tilt the tank toward the machine and push the top in until it clicks into place.

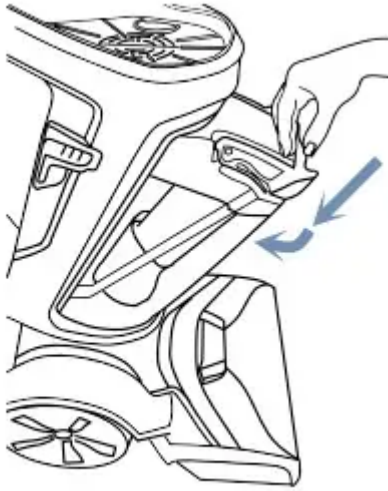

Cleaning the Nozzle

1. If pet hair or debris become clogged in the nozzle, it can be cleaned out of the nozzle with the Nozzle Clean Out Tool. Turn OFF and unplug the machine.

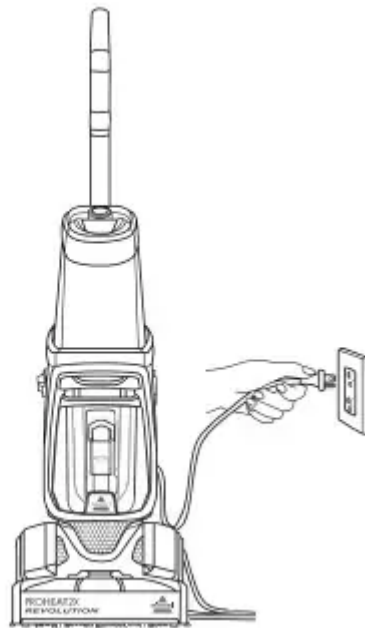

2. Remove the nozzle from the foot: flip the Accessory Hose Door open and lift up on the nozzle and Accessory Hose Door.

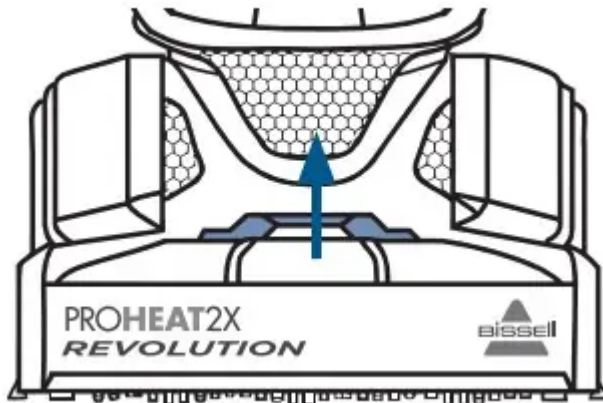

3. Hold the nozzle and insert the Nozzle Clean Out Tool into the thin slot at the front of the nozzle where it touches the floor. Clean until free of pet hair or debris.

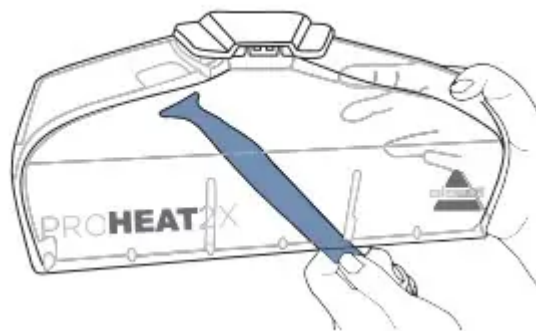

4. Return the nozzle back to the foot of the machine. Line up the three hooks on the nozzle to the bottom of the foot (see arrows for location). Rotate the nozzle up and click into place. Close the Accessory Hose Door.

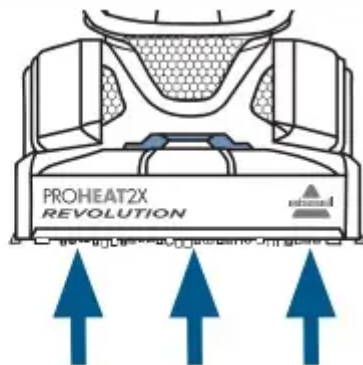

Cleaning the Brush Rolls

1.

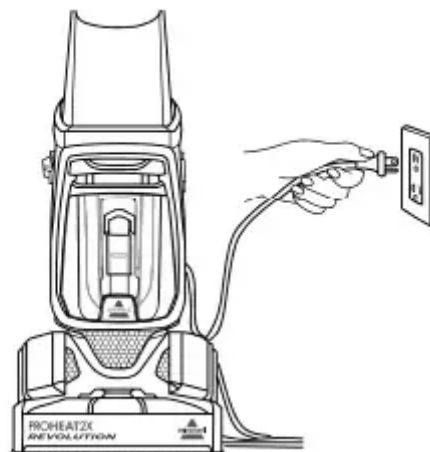

Turn OFF and unplug the machine.

2.

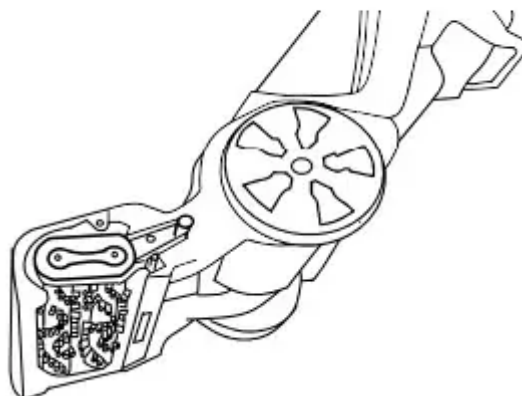

Lay the machine down on its back or side.

3. Use the comb to brush out the debris or hair from the Brush Rolls.

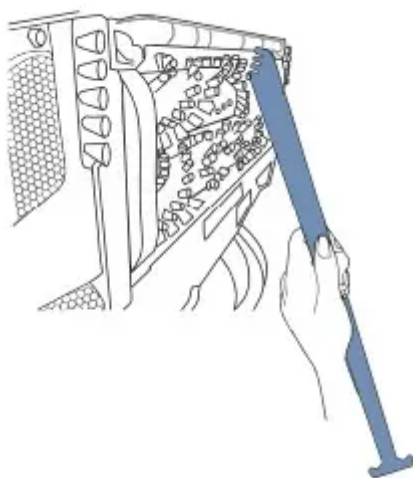

Replacing Belts or Brush Rolls

What you will need: 1 Phillips-head screwdriver & 1 flat-head screwdriver

1. Unplug the machine. Remove both tanks from the machine. Press the recline pedal and lay the machine on its back. Use a flat-head screwdriver to help lift and remove the Belt

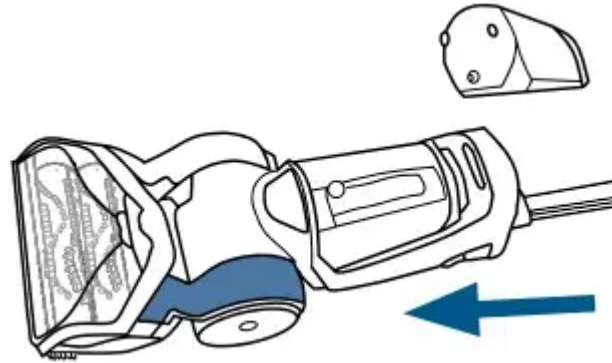

Access Door.

2. Here you should see one (1) belt. This is the Flat Pump Belt. If the Flat Pump Belt is broken, gently remove it from the machine. We will replace this belt in Step 5.

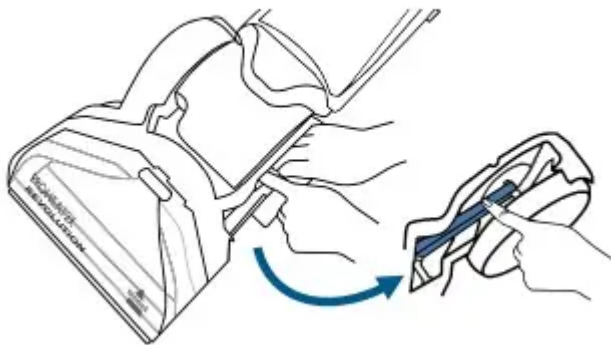

3. Turn the machine on its side. The Power Switch should be facing up. Remove the 3 screws on the Belt/Brush Access Plate using a Phillips-head screwdriver. Remove the Access Plate to expose the Brush Cover and Cogged Large Pump Belt.

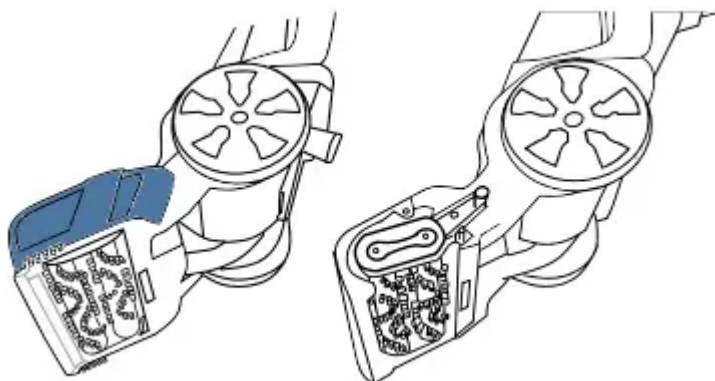

4. Remove the Brush Cover by lifting straight up. Remove the Cogged Large Pump Belt. The Brush Rolls can be replaced or cleaned at this time, if needed.

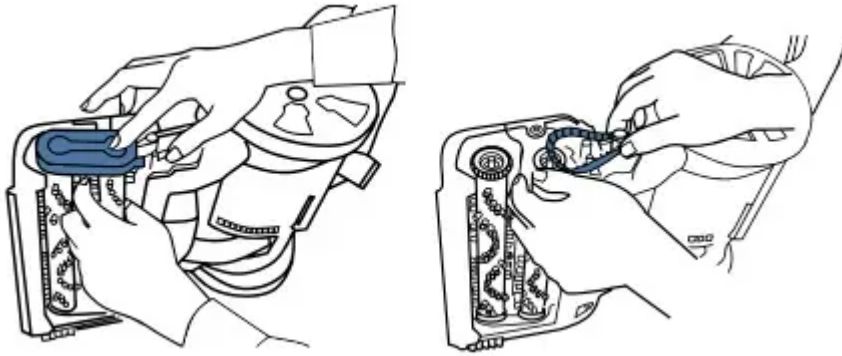

5. Now, if the Flat Pump Belt was broken, place a new Flat Pump Belt around the red area of the large pulley. Then use your thumb to stretch it toward the back of the machine and transfer it onto the metal axle.

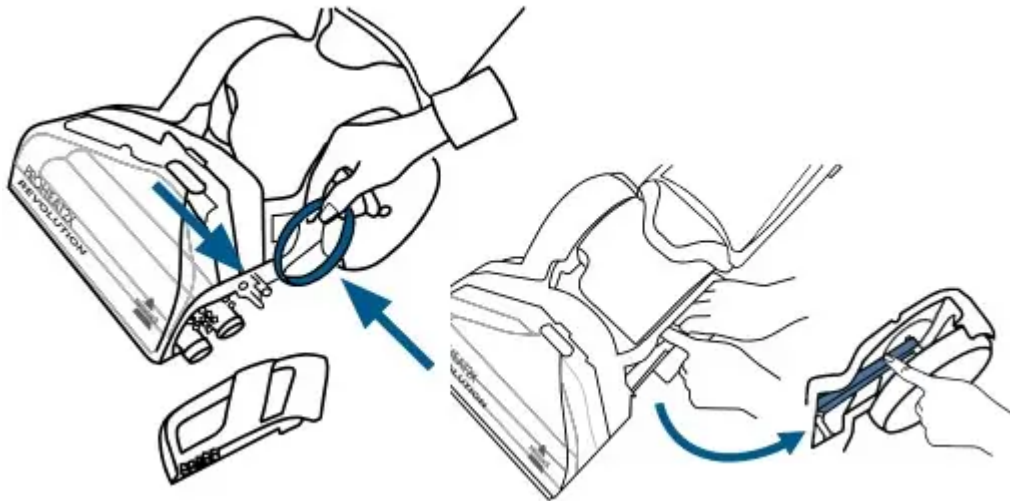

6. Spin either brush. If they both spin, continue to Step 7. If only one spins, the opposite belt is broken and you must remove both brushes and replace the Small Cogged Brush Belt. Place the new belt around both brush gears and slide them onto the thin metal

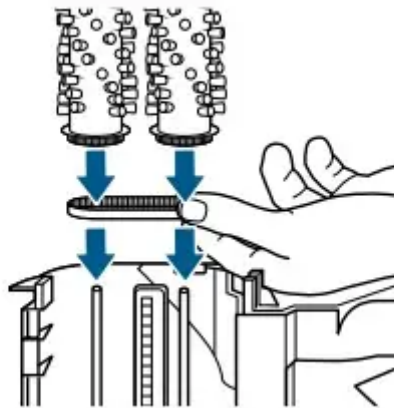

axles.

7. To replace the Cogged Large Pump Belt, make sure your deep cleaner is completely reclined. Begin by wrapping the Cogged Large Pump Belt around the small metal-

toothed pulley. While wrapped around the pulley, stretch and wrap around the nearest

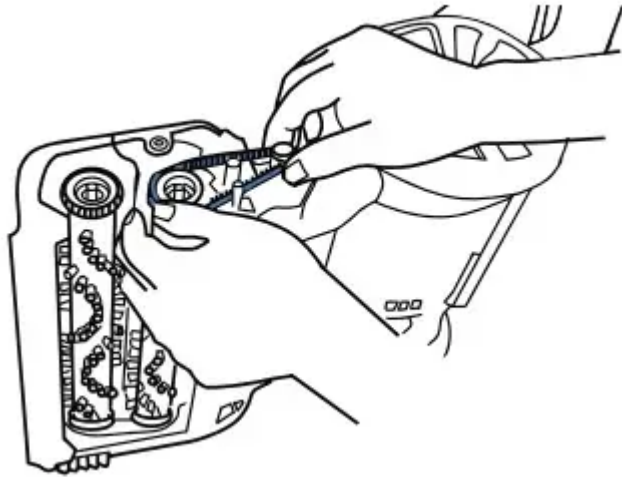

brush gear.

8. Return the Brush Cover. Make sure that the brushes are aligned and the cover is secure.

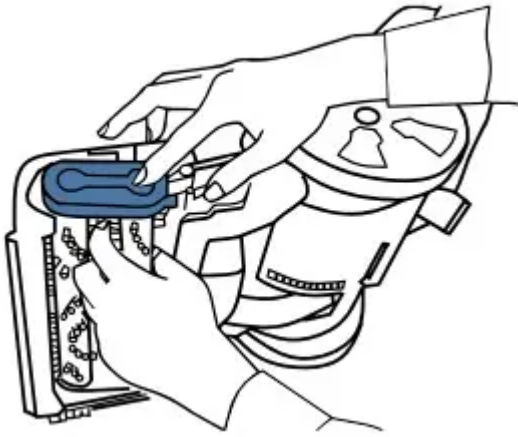

9. Return the Belt/Brush Access Plate to the end of the Brush Rolls by securing with the 3

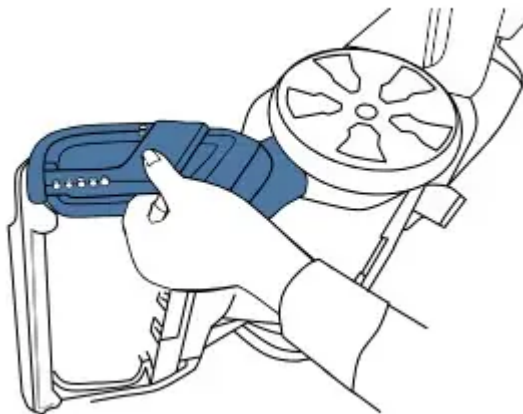

screws.

10. Turn the machine to lay on its back. Lastly, slide the Belt Access Door back into place.

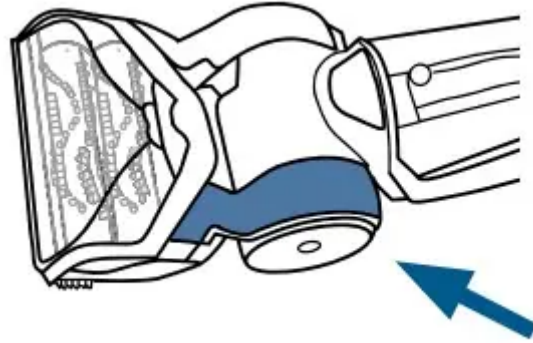

You should hear it “click” into place.

Troubleshooting

To reduce the risk of electric shock, turn OFF and disconnect plug from electrical outlet before performing maintenance or troubleshooting checks.

Problem	Possible causes	Remedies
Reduced spray OR no spray	Clean Water Tank may be empty.	Refill tank.
	Clean Water Tank may not be seated completely	Turn power OFF. Remove and reseal tank
	Pump may have lost prime in Hose Cleaning Mode.	Hold end of hose below water level in tank to prime.
No spray through hose & tool	The hose to your machine is not primed.	With the machine OFF and unplugged, remove the nozzle from the foot. Place a ballpoint pen in the black cylinder next to the screw. When water bubbles up, remove the pen. Reassemble the nozzle and hose.
Loss of suction power	Tanks may not be seated properly	Pick up both tanks and reseal them so they fit properly on the unit .
	Dirty Water Tank has picked up maximum amount of dirty water and has reached full line.	Empty Dirty Water Tank.
	Clean Water Tank is empty.	Check fluid levels in the Clean Water Tank. Refill the tank if it is empty.
	Rubber tab on Dirty Water Tank is not sealed tight.	Check the rubber tab on the Dirty Water Tank and press firmly on all edges to secure it tightly (see step 4 on page 14 for details).
	Accessory Hose Door may not be closed tightly in place	Check the Accessory Hose Door and make sure it is closed tightly – it should be locked into place.
	Nozzle may be clogged from pet hair or debris.	Use the Nozzle Clean Out Tool and follow steps on page 15 for “Cleaning Nozzle”.
No power	Cleaning Mode switch mistaken for Power Switch.	Press the Power Switch on the left side of the machine to turn the machine ON.
	Outlet may not be active.	Try plugging in a different device that uses a grounded outlet to test for power from the outlet.

Problem	Possible causes	Remedies
Leaking tank	Tank may have been over-filled	<ol style="list-style-type: none"> 1. Make sure your tank has the water and formula in it that you've prepared. 2. With the cap twisted ON tightly, hold your tank at an angle, over a sink or drain, so any extra water can pour out of the space. 3. Wipe the tank dry with a cloth.
	Water may be caught in space between the tank and the tank's handle.	

Warning

This content is compiled from multiple sources and is provided for reference purposes only. It may not be complete or fully applicable to all situations. If you are unable to resolve your issue, please contact the product manufacturer or an authorized service provider for official support.

