

USING YOUR OVEN

Features

1. Door Handle.

2. Door Latches.

3. Window with Metal Shield.

- Screen allows cooking to be viewed while keeping microwaves confined in the oven.

4. Charcoal Filter Door.

- Push down two button to open the door. You can change charcoal filter easily.

5. Control Panel and Selector Dial.

6. Removable Turntable.

- Do not operate the oven in the microwave mode without the turntable and turntable support seated and in place.

7. Removable Turntable Support.

- Do not operate the oven in the microwave mode without the turntable and turntable support seated and in place.

8. Shelves.

- Use with Convection Bake, Convection Roast or Combination Fast Bake. (Do not use when microwave cooking.)
- For best results, use one shelf in the lower position and leave at least a 1-inch gap between the cooking dish and the sides of the oven. For two-level Baking or Fast Baking use both shelves.

9 Deflector.

- Provides robustness from cooktop heat. Do not remove.

Time and Auto Microwave Features

Using the Dial

- You can make selections on the oven by turning the dial and pressing it to enter the selection.
- Pressing the dial can also be used in place of the Start/ Pause button for quicker programming of the oven

Cook Time

Cook Time I

Allows you to microwave for any time between 15 seconds and 99 minutes.

Power level 10 (High) is automatically set, but you may change it for more flexibility.

1. Press the Cook Time button.
2. Turn the dial to set the cook time and press the dial to enter.
3. Change power level if you don't want full power. (Press Power Level. Turn the dial to select. Press the dial to enter.)
4. Press the dial or the Start/Pause button to start cooking.

You may open the door during Cook Time to check the food. Close the door and press the dial or Start/Pause to resume cooking.

NOTE: You may change the cook time at any time during cooking by turning the dial. You may also change the power level by pressing the Power Level button.

Cook Time II

Lets you change power levels automatically during cooking. Here's how to do it:

1. Press the Cook Time button.
2. Turn the dial to set the first cook time and press the dial to enter.
3. Change the power level if you don't want full power. (Press Power Level. Turn the dial to select. Press the dial to enter.)
4. Press the Cook Time button again.
5. Turn the dial to set the second cook time and press the dial to enter.
6. Change the power level if you don't want full power. (Press Power Level. Turn the dial to select. Press the dial to enter.)
7. Press the dial or the Start/Pause button to start cooking.

At the end of Cook Time I, Cook Time II counts down.

NOTE: You may change the cook time at any time during cooking by turning the dial. You may also change the power level by pressing the Power Level button.

Weight Defrost

Weight Defrost automatically sets the defrosting times and power levels to give even defrosting results for meats, poultry and fish weighing up to one pound.

1. Press the Defrost button once.
2. Turn the dial to the food weight, using the Conversion Guide at right. For example, dial .5 for .5 pounds (8 oz.) Press the dial to enter.

3. Press the Start/Pause button to start defrosting.
4. Turn the food over if the oven signals TURN FOOD OVER.

Time Defrost

Use Time Defrost to defrost for a selected length of time.

1. Press the Defrost button twice.
2. Turn the dial to select the time you want. Press the dial to enter.
3. Press the Start/Pause button to start defrosting.
4. Turn the food over if the oven signals TURN FOOD OVER

Power Level

The power level may be entered or changed immediately after entering the time for Cook Time, Time Defrost or Combination Fast Cook. The power level may also be changed during time countdown.

1. First, follow directions for Cook Time, Time Defrost or Combination Fast Cook.
2. Press the Power Level button.
3. Turn the dial clockwise to increase and counterclockwise to decrease the power level. Press the dial to enter.
4. Press the Start/Pause button to start cooking.

Variable power levels add flexibility to microwave cooking. The power levels on the microwave oven can be compared to the surface units on a range. Each power level gives you microwave energy a certain percent of the time. Power Level 7 is microwave energy 70% of the time. Power Level 3 is energy 30% of the time. Most cooking will be done on High (Power Level 10) which gives you 100% power.

A lower setting will cook more evenly and need less stirring or rotating of the food. Some foods may have better flavor, texture or appearance if one of the lower settings is used. Use a lower power level when cooking foods that have a tendency to boil over, such as scalloped potatoes.

Sensor Microwave Features

Popcorn (Do not use the shelves when microwave cooking.)

To use the Popcorn feature:

1. Follow package instructions, using Cook Time if the package is less than 1.5 ounces or larger than 3.5 ounces. Place the package of popcorn in the center of the turntable.
2. Press the Popcorn button. The oven starts immediately.

Use only with prepackaged microwave popcorn weighing 1.5 to 3.5 ounces.

NOTE: Do not use this feature twice in succession on the same food portion—it may result in severely overcooked or burnt food.

Cook (Do not use the shelves when microwave cooking.)

1. Place covered food in the oven and close the door. Press the Cook button. ENTER FOOD TYPE appears in the display.
2. Turn the dial to the desired food type. Press to enter.

NOTE: If the door was open while the control was being set, close the door and press the Start/Pause button to begin cooking.

NOTE: Do not use this feature twice in succession on the same food portion—it may result in severely overcooked or burnt food.

If ground meat was selected, the oven may signal you to drain and stir the meat. Open the door, drain the meat and close the door. Press the Start/Pause button if necessary to resume cooking.

Baking and Roasting Features

- Baking or roasting uses a heating element to raise the temperature of the air inside the oven. Any oven temperature from 225°F to 425°F may be set. A fan gently circulates this heated air throughout the oven, over and around the food, producing golden brown exteriors and rich, moist interiors. This circulation of heated air is called convection.
- Because the heated air is kept constantly moving, not permitting a layer of cooler air to develop around the food, some foods cook faster than in regular oven cooking.

Convection Bake or Convection Roast with Preheat

1. Press the Convection Bake or Convection Roast button.
2. Turn the dial to set the oven temperature and press dial to enter. Do not enter bake time now. (The cook time will be entered later, after the oven is preheated.) See the Convection Bake Offset section below.
3. Press the dial or the Start/Pause button to start preheating.
4. When the oven is preheated, it will signal. If you do not open the door within 1 hour, the oven will turn off automatically.
5. Open the oven door and, using caution, place the food in the oven.
6. Close the oven door. Turn the dial to set the cook time and press the dial or Start/Pause to start cooking.
7. When cooking is complete, the oven will signal and turn off.

NOTE: You may change the cook time at any time during cooking by turning the dial.

You may change the oven temperature at any time during cooking by pressing the Power Level button. Turn the dial to set the oven temperature and press the dial to enter

To view the cook time and oven temperature during cooking, press the Bake button.

Convection Bake Offset

- When using Convection Bake, the Convection Bake Offset feature will automatically convert entered regular baking temperatures to convection baking temperatures.
- This feature is activated so that the display will show OFFSET ON and the actual converted (reduced) temperature. For example, if you enter a regular recipe temperature of 350°F and press the Start/Pause button, the display will show the converted temperature of 325°F.
- This feature can be turned off in the Settings menu. See the Convection Bake Offset Selection in the Other features section.

NOTE: If convection baking and the Convection Bake Offset feature is turned off, reduce the oven temperature 25°F from the recipe to prevent overbrowning on the top of baked goods.

Fast Cook Feature

Fast Cook offers the best features of microwave energy and convection cooking. Microwaves cook food fast and convection circulation of heated air browns foods beautifully. Any oven temperature from 225°F to 425°F may be set.

Fast Cook with Preheat

1. Press the Combination Fast Cook button.
2. Turn the dial to set the oven temperature and press dial to enter. Do not enter Fast Cook cook time now. (The cook time will be entered later, after the oven is preheated.) Press the dial or the Start/Pause button to start preheating.
3. When the oven is preheated, it will signal. If you do not open the door within 1 hour, the oven will turn off automatically.
4. Open the oven door and, using caution, place the food in the oven.
5. Close the oven door. Turn the dial to set the cook time and press to enter. Press the dial or the Start/ Pause button to start cooking.
6. When cooking is complete, the oven will signal and turn off.

NOTE: You may change the cook time at any time during cooking by turning the dial.

You may change the oven temperature and microwave power level at any time during cooking by pressing the Power Level button. Turn the dial to set the oven temperature and press the dial to enter. Then, turn the dial to set microwave power level 1 through 4 and press the dial to enter. The default power level is 4.

To view the cook time and oven temperature during cooking, press the Fast Cook button.

- Check the Cookware Tips section for correct cookware when using Fast Cook.

- Do not use metal cookware with Fast Cook.
- Reduce the recipe cook time by 25%.
- See the Best Method of Cooking section to determine the which foods are appropriate to cook using Fast Cook

Other Features

Cooking Complete Reminder

To remind you that you have food in the oven, the oven will display FOOD IS READY and beep once a minute until you either open the oven door or press the Cancel/ Off button.

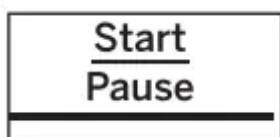

Start/Pause

In addition to starting many functions, Start/Pause allows you to stop cooking without opening the door or clearing the display.

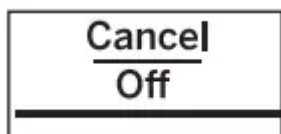

Cancel/Off

Press the Cancel/Off button to stop and cancel cooking at any time.



Timer On/Off

The Timer operates as a minute timer and can be used at any time, even when the oven is operating.

1. Press the Timer button.
2. Turn the dial to select the minutes. Press the dial to enter.
3. Turn the dial to select the seconds. Press the dial to enter
4. Press the dial or Timer to start.

To cancel, press the Timer button.

When time is up, the oven will signal. To turn off the timer signal, press Timer.

NOTE: The TIMER indicator will be lit while the timer is operating.

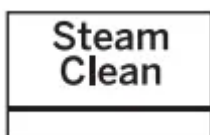

Steam Clean

1. Press the Steam Clean button.
2. Put steam bowl with 1/4 cup of water.
3. Press the dial or Start/Pause to start.

Once the cycle is terminated, wipe oven cavity with paper towel or cloth.



Turntable

For best cooking results, leave the turntable on. It can be turned off for large dishes.

Press the Turntable On/Off button to stop or start rotating the turntable.

Sometimes the turntable can become too hot to touch.

Be careful touching the turntable during and after cooking.



Mute On/Off

You can control sound using Mute On/Off button.

Control Lock-Out

You may lock the control panel to prevent the oven from being accidentally started during cleaning or being used by children.

To lock or unlock the controls, press and hold 3 seconds. When the control panel is locked, CONTROL LOCKED will be displayed briefly anytime a button or dial is pressed.

Auto Night Light

Auto Night Light can be set for light on during the night. The surface light will be set to the LOW brightness setting at the ON time. At the OFF time the surface light will be turned off.

1. Press the Settings button and turn the dial to select
2. Auto Night Light. Press the dial to enter.
3. Turn the dial to select Off to turn off Auto Night Light function. Press the dial to enter.
Turn the dial to select New to turn on Auto Night Light function. Press the dial to enter.
Enter ON time and OFF time. Press the dial to enter.

Turn the dial to select Review to review the Auto Night Light function setting. Press the dial to enter.

Set Clock

1. Press the Settings button and turn the dial to select Clock Set. Press the dial to enter..
2. Turn the dial to set hours. Press the dial to enter.
3. Turn the dial to set minutes. Press the dial to enter.
4. Turn the dial to set AM/PM. Press the dial to enter.

Clock Mode

Clock Mode can be set for 12 hours and 24 hours.

1. Press the Settings button and turn the dial to select Clock Mode. Press the dial to enter.
2. Turn the dial to set 12 hours or 24 hours Clock Mode. Press enter to activate.

Display Speed

Display Speed can be adjusted for Slow, Normal, or Fast

1. Press the Settings button and turn the dial to select Display Speed. Press the dial to enter.
2. Turn the dial to set Display Speed (Slow, Normal, Fast). Press enter to activate.

My Cycle

The Add 30 Sec. button can be adjusted to the My Cycle features.

1. Press the Settings button and turn the dial to select My Cycle. Press the dial to enter.
2. Turn the dial to select time (from 5 Sec to 60 Sec) and press the dial to complete the setting.

Sound Level

Sound Level can be adjusted for Mute, Low, Normal or Loud.

1. Press the Settings button and turn the dial to select Sound Level. Press the dial to enter.
2. Turn the dial to set Sound Level (Mute, Low, Normal, or Loud). Press enter to activate.

Surface Light Sync

1. Press the Settings button and turn the dial to select Surface Light Sync. Press the dial to enter.
2. Turn the dial to select Sync Mode (Off, Low, High).
3. Press the dial to activate.

Vent Fan Sync

1. Press the Settings button and turn the dial to select Vent Fan Sync. Press the dial to enter.
2. Turn the dial to select Vent Fan Sync Mode (Off, Low, Medium or High).
3. Press the dial to activate.

Sync Auto Off

1. Press the Settings button and turn the dial to select Sync Auto Off Press the dial to enter.
2. Turn the dial to select Sync Auto Off (up to 15 minutes and manual). Press enter to activate.

Convect Bake Offset

1. Press the Settings button and turn the dial to select Convect Bake Offset. Press the dial to enter.
2. Turn the dial to select Convect Bake Offset On/Off Press enter to activate.

Bake Temp Adjust

1. Press the Settings button and turn the dial to select Bake Temp Adjust Press the dial to enter.
2. Turn the dial to select Bake Temp Adjust range from -25 degree to 25 degree. Press enter to activate.



Filter Replace Reminder

When the Filter Replace light turned on, replace filter and press Reset Filter and hold for 3 seconds to reset.

A filter is only needed for models that are not vented to the outside.



Surface Light

Press Surface Light once for bright light, twice for the night light or a third time to turn the light off.



Vent Fan

The vent fan removes steam and other vapors from surface cooking.

Press Vent Fan once for high fan speed, twice for medium fan speed, three times for low fan speed or a fourth time to turn the fan off.

Automatic Fan



An automatic fan feature protects the microwave from too much heat rising from the cooktop below it. It automatically turns on if it senses too much heat.

If you have turned the fan on you may find that you cannot turn it off. The fan will automatically turn off when the internal parts are cool. It may stay on for 30 minutes or more after the cooktop and microwave controls are turned off.

Chef Connect



Use the Chef Connect feature for connecting your microwave to a Café range to sync your vent fan, cooktop surface lights and clock via Bluetooth technology.

1. You must have a Chef Connect enabled range. To pair your microwave for the first time, initiate the Chef Connect process on the Café range. Refer to the range owner's manual for instructions
2. On the microwave, hold Chef Connect button for 3 seconds. The Bluetooth icon  on the display will start flashing as the microwave starts to search and pair with your Café range. The icon  will remain ON after pairing successfully.

If a Café range is not found within 2 minutes during search mode the microwave will stop searching and the Bluetooth icon  will turn OFF.

On initial setup, the setup protocol will start.

If the Chef Connect feature is enabled the default settings are as follows:

- Display clock sync: ON
- Auto surface light: ON (HIGH setting)

- Auto vent fan: OFF
- Auto off: 15 minutes

3. Turn the dial to select Surface Light Sync On/Off. Press the dial to confirm. If on, it allows the microwave surface lights to turn on at HIGH level automatically when the paired range's cooktop burner turns ON. If OFF, the microwave surface lights will not automatically turn on when a cooktop burner turns on.

4. Turn the dial to select Vent Fan Sync ON/OFF. Press the dial to confirm. If ON, it allows the microwave vent fan to turn on at LOW speed automatically when the paired range's cooktop burner turns on. If OFF, the vent fan will not turn ON automatically when a cooktop burner is turned on.

Pairing is now complete, the Chef Connect feature is now on.

NOTE: If there is no sync option selected during set up, 5 minutes after icon  turns ON, the units will return to stand-by mode and use the default settings. After completing the setting per above steps, your microwaves vent fan and surface light could be set to turn on automatically when the cooktop burner is turned on. The cooktop and range clock display will be synced to display the same time. The vent fan and cooktop light will be set to automatically turn off 15 minutes after the cooktop burner is turned OFF.

If desired, the light, fan, and auto off settings can now be changed using option in Settings.

Press Chef Connect once to temporarily turn OFF communication between the microwave and range. Press again to turn communication back ON. The icon  will illuminate when ON.

In the case of an unintended disconnect such as lost power to the microwave or range the connection will remain after power resumed. For very short power interruptions, the power may need to be reset in order to reconnect

NOTE: To unpair the microwave from the range, press and hold the Chef Connect button on the microwave for 3 seconds. The Bluetooth icon will start to flash. Press cancel or wait 2 minutes for the flashing to stop. You may need to unpair when the Café range is replaced or serviced.

CARE AND CLEANING

How to Clean the Inside

Walls, Floor, Inside Window, Metal and Plastic Parts on the Door

- Some spatters can be removed with a paper towel; other many require a damp clothes. Remove greasy spatters with a sudsy cloth, then rinse with a damp cloth. Do not use abrasive cleaners or sharp utensils on oven walls.
- Never use a commercial oven cleaner on any part of your microwave.

Removable Turntable and Turntable Support

- To prevent breakage, do not place the turntable into water just after cooking. Wash it carefully in warm, sudsy water or in the dishwasher. The turntable and support can be broken if dropped. Remember, do not operate the oven in the microwave mode without the turntable and support seated and in place.

Shelves

- Clean with mild soap and water or in the dishwasher.
- Do not clean in a self-cleaning oven.

How to Clean the Outside

We recommend against using cleaners with ammonia or alcohol, as they can damage the appearance of the microwave oven. If you choose to use a common household cleaner, first apply the cleaner directly to a clean cloth, then wipe the soiled area.

Case

- Clean the outside of the microwave with a sudsy cloth. Rinse and then dry. Wipe the window clean with a damp cloth.

Control Panel

- Wipe with a damp cloth. Dry thoroughly. Do not use cleaning sprays, large amounts of soap and water, abrasives or sharp objects on the panel—they can damage it. Some paper towels can also scratch the control panel.

Door Panel

- Before cleaning the front door panel, make sure you know what type of panel you have. Refer to the 11th digit of the model number. "S" is stainless steel, "L" is CleanSteel, "D" is for black slate or dark matte finish and "B", "W" or "C" are plastic colors.

Stainless Steel (on some models)

- The stainless steel panel can be cleaned with Stainless Steel Magic or a similar product using a clean, soft cloth. Apply stainless cleaner carefully to avoid the surrounding plastic parts. Do not use appliance wax, polish, bleach or products containing chlorine on Stainless Steel finishes.

Plastic Color Panels

- Use a clean, soft, lightly dampened cloth, then dry thoroughly.

Door Seal

- It's important to keep the area clean where the door seals against the microwave. Use only mild, nonabrasive detergents applied with a clean sponge or soft cloth. Rinse well.

Bottom

- Clean off the grease and dust on the bottom often. Use a solution of warm water and detergent.

Replacing LED Lamp



Remove screw.

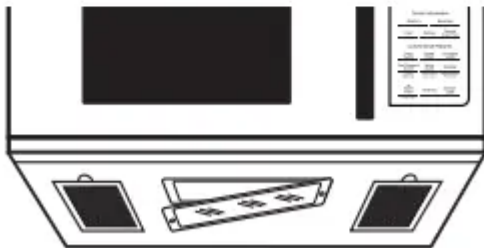

Cooktop Light/Nite Light Replace with LED lamp. Order WB02X26814 from your Café supplier.

1. To replace the cooktop light/nite light, first disconnect the power at the main fuse or circuit breaker panel, or pull the plug.
2. Remove the screw from the side of the light compartment cover and lower the cover until it stops.
3. Be sure the LED lamp is cool before removing. Remove a screw and connector from LED lamp.
4. Connect LED lamp and secure using the screw. Raise the light cover and replace the screw. Connect electrical power to the oven.

Exhaust Feature

Vent Fan

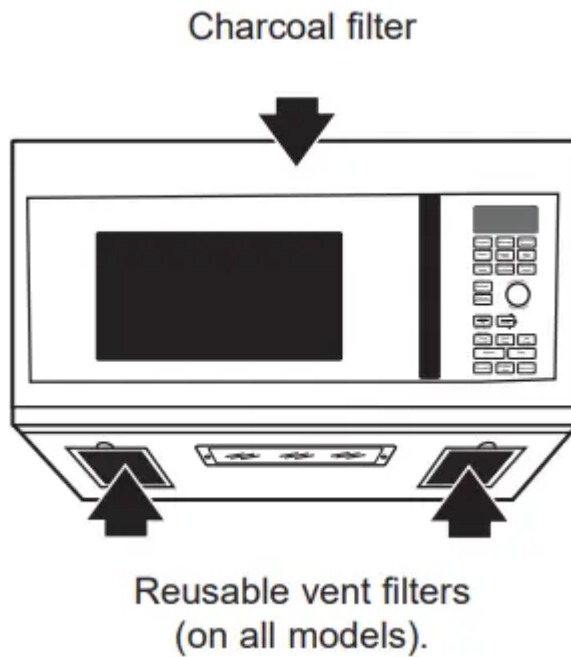

The vent fan has two metal reusable vent filters.

Models that recirculate air back into the room also use a charcoal filter.

Reusable Vent Filters

The metal filters trap grease released by foods on the cooktop. They also prevent flames from foods on the cooktop from damaging the inside of the oven.

For this reason, the filters must always be in place when the hood is used. The vent filters should be cleaned once a month, or as needed.

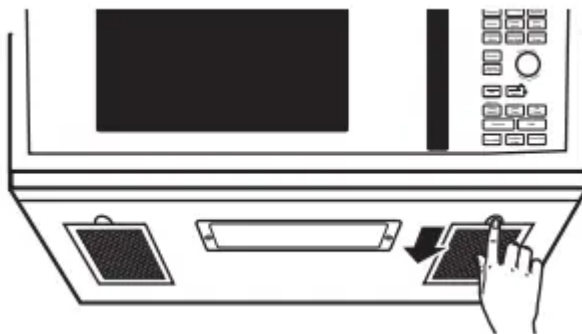

Removing and Cleaning the Filters

To remove, slide them to the rear using the tabs. Pull down and out.

To clean the vent filters, soak them and then swish around in hot water and detergent. Don't use ammonia or ammonia products because they will darken the metal.

Light brushing can be used to remove embedded dirt.

Rinse, shake and let dry before replacing.

To replace, slide the filters into the frame slots on the back of each opening. Press up and to the front to lock into place.

Charcoal Filter

The charcoal filter cannot be cleaned. It must be replaced. Order Part No. WB02X29749 from your Café supplier.

If the model is not vented to the outside, the air will be recirculated through a disposable charcoal filter that helps remove smoke and odors.

The charcoal filter should be replaced when it is noticeably dirty or discolored (usually after 6 to 12 months, depending on usage). See Optional Kits page for more information.

To Remove the Charcoal Filter

To remove the charcoal filter, first disconnect power at the main fuse or circuit breaker, or pull the plug. Push down 2 buttons on the filter door.

Lift the filter at the bottom until it comes free of the tabs. Slide the filter down and out.

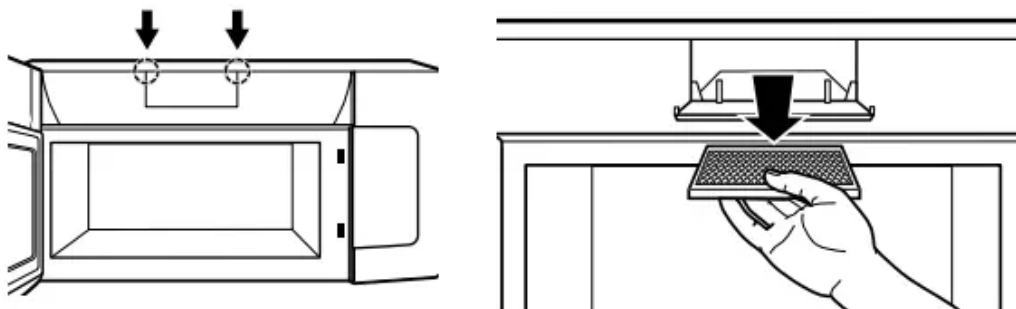

To Install the Charcoal Filter

To install a new charcoal filter, remove plastic and other outer wrapping from the new filter.

Insert the top of the filter up. Push the bottom of the filter in until it rests in place behind the tabs. Close filter door.

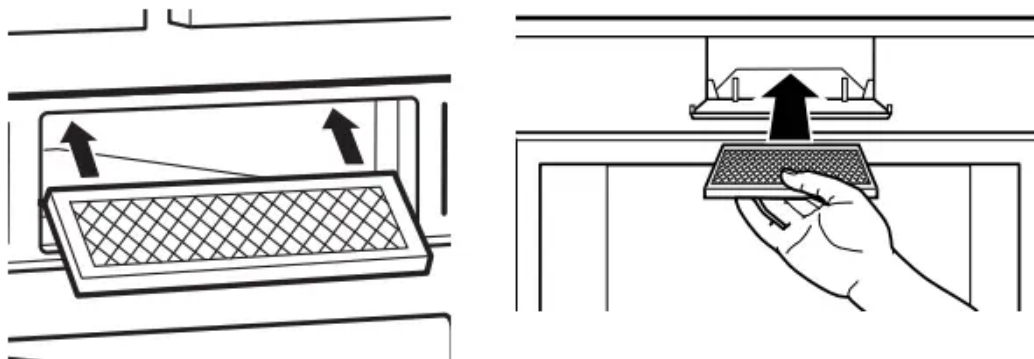

TROUBLESHOOTING TIPS

Oven will not start

- A fuse in your home may be blown or the circuit breaker tripped.
 - Replace fuse or reset circuit breaker.
- Power surge.
 - Unplug the microwave oven, then plug it back in.
- Plug not fully inserted into wall outlet.
 - Make sure the 3-prong plug on the oven is fully inserted into wall outlet.
- Door not securely closed.
 - Open the door and close securely.

Control panel lighted, yet oven will not start

- Door not securely closed.
 - Open the door and close securely.
- Start/Pause button not pressed after entering cooking selection.
 - Press Start/Pause.
- Another selection entered already in oven and Cancel/Off button not pressed to cancel it.
 - Press Cancel/Off
- Cooking time not entered after pressing Cook Time.
 - Make sure you have entered cooking time after pressing Cook Time.
- Cancel/Off was pressed accidentally.
 - Reset cooking program and press Start/ Pause.
- Food weight not entered after selecting Auto Defrost or Fast Defrost.
 - Make sure you have entered food weight after selecting Auto Defrost or Fast Defrost.
- Food type not entered after pressing Auto Cook.
 - Make sure you have entered a food type.

CONTROL LOCKED appears on display

- The control has been locked.
 - Press and hold Mute On/Off for about 3 seconds to unlock the control.

OVEN TOO HOT FOR SENSOR COOKING-- -USING ALTERNATE METHOD appears on display

- One of the sensor cooking buttons was pressed when the temperature inside the oven was greater than 200°F.
 - These features will not operate when the oven is hot. The oven will automatically change to cook by time (follow the directions in the display) or once the oven is cool enough, the sensor features will function normally.

Floor of the oven is warm even when the oven has not been used

- The cooktop light is located below the oven floor. When light is on, the heat it produces may make the oven floor get warm.
 - This is normal.

You hear an unusual lowtone beep

- You have tried to change the power level when it is not allowed.
 - Many of the oven's features are preset and cannot be changed.

Oven emits a smoky odor and gray smoke after using the Bake feature

- Oils on the stainless steel cavity are burning off after using the Bake feature the first few times.
 - This is normal.

Food browns on top much faster than on the bottom

- Rack has been placed in the "high" position.
 - Always use the rack in its "low" position.

Oven temperature fluctuates during cooking

- The cooking element cycles on and off to maintain the oven temperature at the desired setting.
 - This is normal.

Vent fan comes on automatically

- The vent fan automatically turns on to protect the microwave if it senses too much heat rising from the cooktop below.
 - This is normal.
- During Bake, Roast or Fast Bake (after preheating), the vent fan will automatically come on to cool the oven components.
 - This is normal.

SENSOR ERROR appears on the display

- When using a Sensor feature, the door was opened before steam could be detected.
 - Do not open door until steam is sensed and time is shown counting down on the display.
- Steam was not detected in a maximum amount of time.
 - Use Cook Time to heat for more time.

Things That Are Normal With Your Microwave Oven

- Moisture on the oven door and walls while cooking. Wipe the moisture off with a paper towel or soft cloth.
- Moisture between the oven door panels when cooking certain foods. Moisture should dissipate shortly after cooking is finished.
- Steam or vapor escaping from around the door.
- Light reflection around door or outer case.
- Dimming oven light and change in the blower sound at power levels other than high.
- The vent fan operating while the microwave is operating. The vent fan will not go off nor can it be turned off until the microwave is off.
- Dull thumping sound while oven is operating.
- Warm, convection bake, convection roast and combination fast cook have a maximum cooking time of 179 minutes (2 hours and 59 minutes). When the maximum cooking time is reached, the oven will automatically indicate that cooking is complete and turn off the cooking element.
- When using convection bake, convection roast or combination fast cook with a preheat, the oven door must be opened and the cooking time set after preheat or the oven will turn off the cooking element after 1 hour.

Warning

This content is compiled from multiple sources and is provided for reference purposes only. It may not be complete or fully applicable to all situations. If you are unable to resolve your issue, please contact the product manufacturer or an authorized service provider for official support.