

Environmental protection

Packaging/used appliance



Dispose of packaging in an environmentally-responsible manner.

The following Do's and Don'ts provide a framework for the return and recycling of used products when available in your area.

Do's

- Hand over the old/discarded electronic equipment only to authorized collection centers for disposal
- Consult the authorized service center as to whether the Electronic Equipment can be repaired or not, before discarding
- Consult the retailer about appliance take back schemes

Don'ts

- Don't dump the discarded Electronic Equipment in the open or in any land fill site, as this will result in contamination of the soil and the ground water
- Don't dispose of the discarded Electronic Equipment in household bins or Municipal bins
- The product is not meant for re-sale to any unauthorized agencies/scrap dealers
- Don't keep any replaced spare part(s) from the product in an exposed area

Tips on economical use

- Always fill the appliance with the maximum amount of laundry for each programme.
- Wash normally soiled laundry without pretreating.
- For light and normal soiling in laundry, you can save energy and detergent.
- The selectable temperatures apply to the care labels on the textiles. The temperatures in the appliance may deviate from this so that you get the optimum mix of energy-saving and washing results.
- Information on the energy consumption:

The displays provide information about the relative level of energy consumption in the selected programmes.

The more indicator lights light up, the higher the programme's consumption.

This enables you to compare the consumption levels of the different programmes when choosing your programme settings and to decide on an energy-saving programme setting for the selected programme.

- Low power mode: If the appliance is not operated for a prolonged period (approx. 5 minutes), the display panel lighting goes out before the programme starts and after the programme has ended,  flashes. Select any button to activate the display backlighting.

Low power mode is not be activated when the programme is running.

- If the laundry will be dried in a dryer, select the spin speed according to the dryer manufacturer's instructions.

Positioning and connecting

Standard accessories

Note: Check the appliance for transport damage. Never use a damaged appliance. If you have any complaints, contact the dealer from whom you purchased the appliance or our Customer Service.

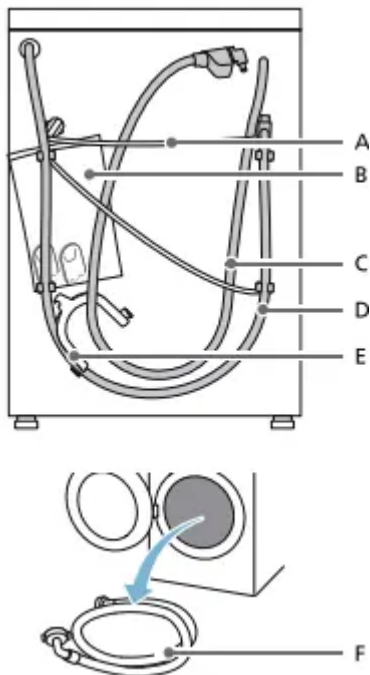

A Mains lead

B Bag:

- Installation and operating instructions
- Customer Service location directory*
- Warranty*

- Supplementary sheet for the installation and operating instructions*
- Cover caps for openings after the transport braces have been removed
- Home Connect Installation Guides*

C Water inlet hose on aquaStop models

D Water outlet hose

E Elbow for securing the water outlet hose*

F Cold water inlet hose on Standard/Aqua-Secure models

Depending on the model

In addition, a hose clamp (24 - 40 mm diameter, available from specialist retailers) is required to connect the water outlet hose to a siphon.

Useful tool

- Spirit level for aligning
- Wrench with:
 - WAF13 for loosening the transport braces and
 - WAF17 for aligning the appliance feet

Safety instructions

- The appliance is very heavy.

Be careful when lifting/transporting the appliance.

- When the appliance is lifted by its protruding parts (e.g. the appliance door), the components may break off and cause injuries.

Do not lift the appliance by protruding parts.

- If the hose and mains cables are not routed properly, there is a risk of tripping and injury.

Lay hoses and cables in such a way that there is no risk of tripping.

Installation surface

Note: The appliance must be stable aligned so that it does not move around.

- The installation surface must be firm and level.
- Soft floors/floor coverings are not suitable.

Installation on a base or a wooden joist floor

Caution!

Damage to the appliance

The appliance may "wander" and tip/ topple from the base when spinning.

The feet of the appliance must be secured with holding brackets.

Order no. WMZ 2200, WX 975600, CZ 110600, Z 7080X0.

Note: On wooden joist floors, install the appliance:

- In a corner, if possible,
- On a water-resistant wooden board min. 30 mm thick) which is screwed tightly to the floor.

Installation on a platform with drawer*

Platform order no.: WMZ 20490, WZ20490, WZ 20510, WZ 20520.

Installing the appliance in a kitchenette

Warning

Risk of death!

There is a risk of electric shock if you touch live components.

Do not remove the appliance covering plate.

Notes

- Recess width of 60 cm required.
- Only install the appliance underneath a continuous worktop that is securely connected to adjacent cabinets.

Removing the transport locks

Caution!

Damage to the appliance

- The appliance is secured for transportation using transport locks. If the transport locks are not removed, the appliance may become damaged when it is operated.

Before using the appliance for the first time, make sure that you completely remove all four transport locks. Keep the locks in a safe place.

- To prevent transport damage from occurring if the appliance is moved at a later date, you must refit the transport locks before transporting the appliance.

Note: Keep the screws and sleeves in a safe place.

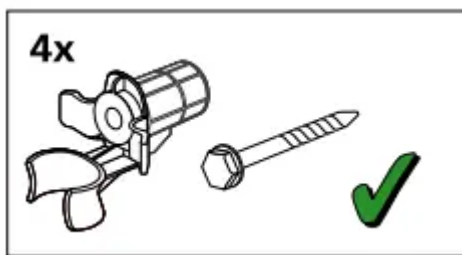

1. Take the hoses out of the holders.

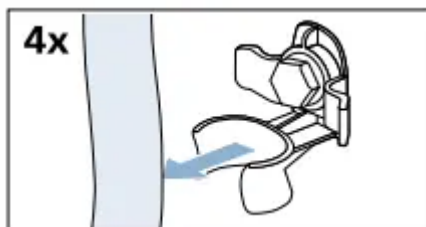

2. Unscrew and remove all four transport brace screws.

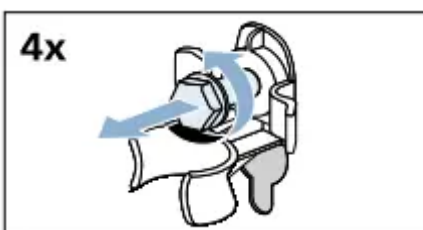

a) Remove the mains cable from the holders.

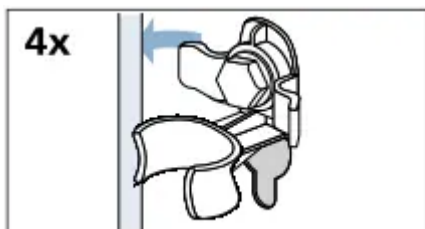

b) Remove the sleeves.

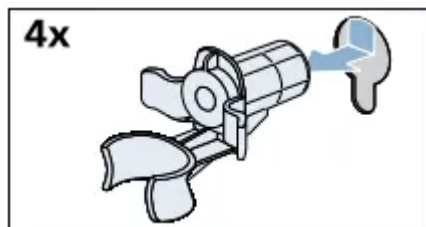

3. Fit the covers.

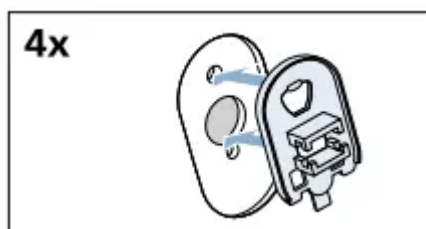

4. Lock the covers firmly in place by applying pressure to the snap-in hooks.

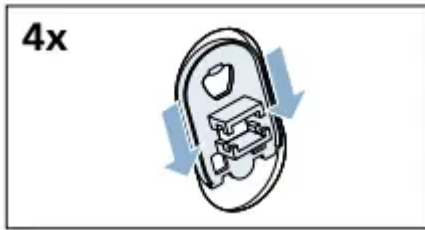

Hose and cable lengths

Connection on left side

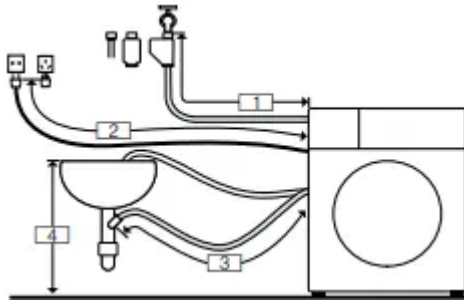

1 ~ 95 cm

2 ~ 140 cm

3 ~ 140 cm

4 0 cm~ 100 cm

Or

Connection on right side

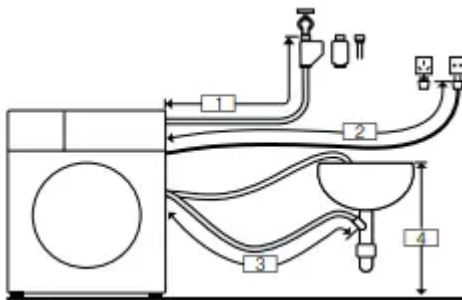

1 ~ 135 cm

2 ~ 105 cm

3 ~ 95 cm

4 0 cm~ 100 cm

Note: If the supply hose is too short for your connection, you can order an extension from the after-sales service.

Water inlet

Observe the following when connecting the appliance:

Notes

- Only operate the appliance using cold mains water.
- Do not connect the appliance to the mixer tap of an unpressurised hot water boiler.
- Do not use a used supply hose. Only use the supply hose supplied or one that was purchased from an authorised specialist retailer.
- Do not bend, squash, modify or cut through the water supply hose (otherwise its strength is no longer guaranteed).
- Only tighten the screw connections by hand. If the screw connections are tightened too much with a tool pliers), the thread may be damaged.

Optimum water pressure in the supply network

At least 100 kPa (1 bar)

Maximum 1000 kPa (10 bar)

When the tap is open, the water flow is at least 8 l/min.

If the water pressure is higher than this, a pressure-reducing valve must be installed.

Connection

1. Connect the water supply hose to the water tap ($\frac{3}{4}$ " = 26.4 mm) and to the appliance:

- Model: Standard

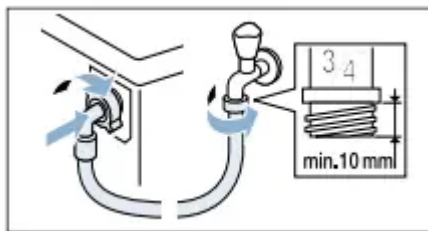

- Model: AquaSecure

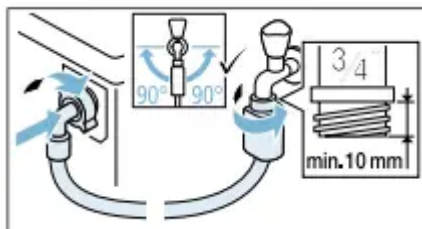

- Model: Aqua-Stop

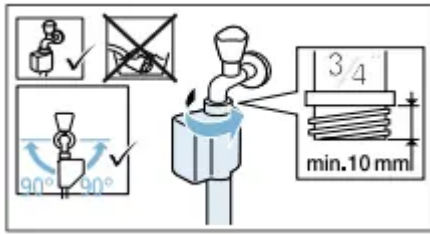

Tip: Connect also an external water filter (depending on the model) between water supply hose and tap. The filter filters dirt particles out of the water.

Water filter must be cleaned regularly to remove contaminants. This will prevent blockages. See also ~ separate installation and cleaning instruction for water filter.

2. Open the water tap carefully, checking the leak tightness of the connection points. The screw connection is under mains water pressure.

Water outlet

Caution!

Water damage

When water is being pumped away, the outlet hose is under water pressure and may slip out of the wash basin or connection point.

Secure the drain hose so that it cannot slip out.

Caution!

Damage to the appliance/fabrics

If the end of the drain hose is immersed in the drained water, water may be sucked back into the appliance and may damage the appliance/fabrics.

Make sure that:

- The plug does not block drainage from the washbasin.
- The end of the drain hose is not immersed in the drained water.
- The water drains away quickly enough.

Note: Do not kink the water drain hose or put strain on it lengthways.

Connection

- Drainage into a siphon

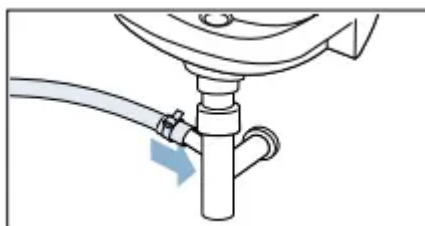

The connection point must be secured using a hose clamp with a diameter of 24 - 40 mm (available from specialist dealers). en Positioning and connecting

- Drainage into a washbasin

Secure the outlet hose so that it cannot slip out.

Elbow available from after-sales service:

Individual part number 00655300

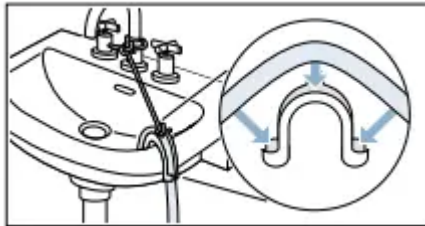

- Drainage into a plastic pipe with rubber bushing or into a drainage pit

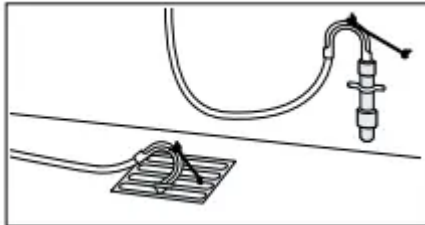

Alignment

Level the appliance using a spirit level. Incorrect levelling may result in intense noise, vibrations and "wandering".

- 1 Loosen the lock nuts using a wrench, by turning it in a clockwise direction.

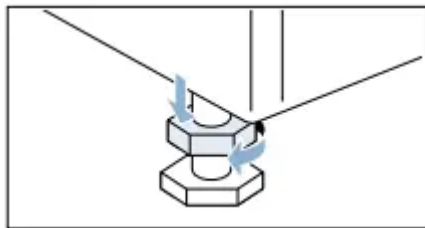

2. Check the alignment of the appliance with a spirit level, and adjust it if necessary. Change the height by turning the appliance feet. All four appliance feet must stand firmly on the ground.

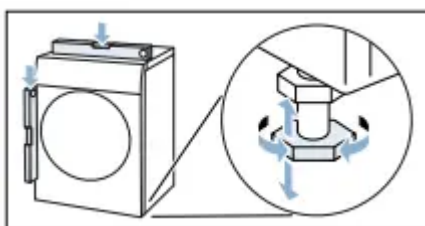

3. Tighten the lock nut against the housing.

In doing so, hold the foot tight and do not adjust its height.

The lock nuts on all four appliance feet must be screwed tightly against the housing.

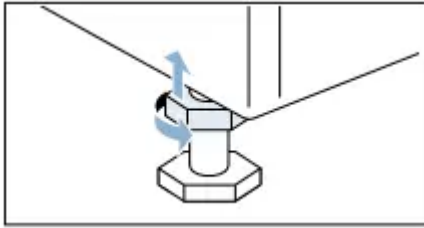

Electrical connection

Observe the following information and ensure that:

Notes

- The mains voltage and voltage indicated on the appliance (rating plate) are the same.

The connected load and fuse required are specified on the rating plate.

- The appliance is only connected to an alternating current via a properly installed earthed socket.
- The mains plug fits the socket.
- The earthing system is properly installed.
- The mains cable is only replaced by a qualified electrician (if this is necessary). Replacement mains cables are available from the after sales service.
- No multiple plugs/couplings or extension cables are used.
- If an earth-leakage circuit breaker is used, only a type which displays this symbol is used: .

Only this symbol guarantees compliance with the currently applicable regulations.

- The mains plug can be accessed at all times.
- The mains cable is not bent, squashed, modified, cut through, or in contact with heat sources.

Before washing for the first time

The appliance was inspected thoroughly before leaving the factory. To remove any residual test water, run the  Drum Clean programme the first time without laundry.

1. Insert mains plug.
2. Turn the water tap on.
3. Close the door. Do not load any laundry.

4. Depending on the model, run the 🌀 Drum Clean 90 °C or 🧺 Cottons 90 °C programme.
For AU variant, two cycles of Cottons C programme without laundry are required to be run at initial setup, and this operation only needs to be completed once
5. Open the detergent drawer.
6. Pour approx. 1 litre of water into dispenser II. en Positioning and connecting
7. Add standard detergent to dispense. II according to manufacturer's instructions for light soiling.
8. Close the detergent drawer.
9. Select Start/Reload ▶️🔊
10. When the programme ends, turn the programme selector to Off. Your appliance is now ready for use.

Transportation e.g. when moving home

Preparatory work:

1. Turn off the water tap.
2. Reduce the water pressure in the supply hose. ~ Page 41
3. Drain any residual water. Page 39
4. Disconnect the appliance from the mains.
5. Remove the hoses.
6. Empty the dispensers.

Installing the transport locks:

1. Remove the covers and keep them in a safe place.

Note: Use a screwdriver if necessary.

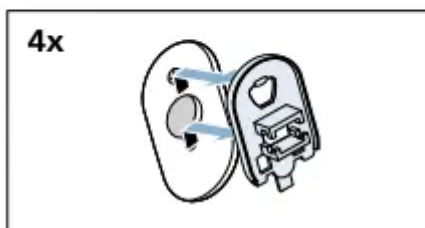
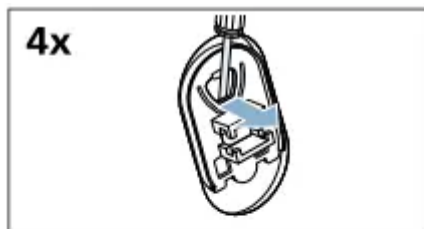

2. Insert all four sleeves.



a) Clip the hoses securely in the holders.



b) Clip the mains cable securely in the holders.



c) Insert and tighten the screws.



Before switching on the appliance again:

Notes

- The transport braces must be removed. Removing the transport locks" on page 14
- Pour approx. 1 litre of water into dispenser II, select the 0 Spin programme and start.

This will prevent detergent from flowing straight into the drain during the next wash. en
Getting to know the appliance



Getting to know the appliance

Appliance

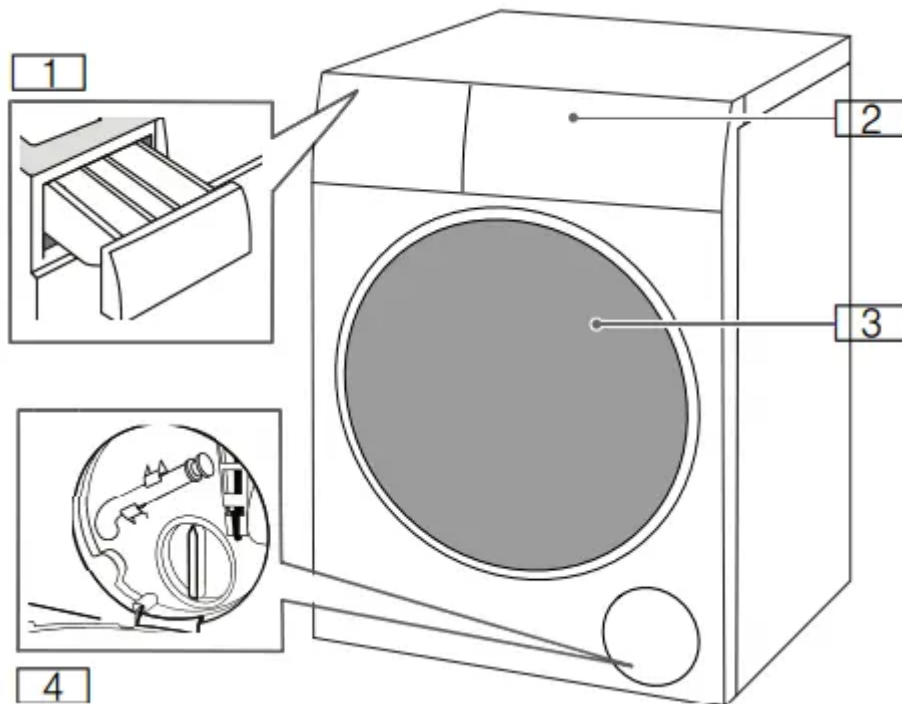

- 1 Detergent drawer
- 2 Control panel
- 3 Loading door
- 4 Service flap

Control panel

You can find possible programme default settings and additional programme settings in the overview; these differ depending on the model.



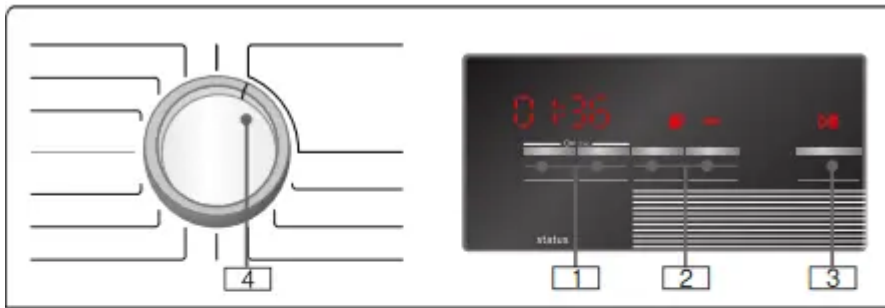

1 Programme default settings can be changed.

Overview of all programme default settings ~ Page 31

2 additional programme settings can be selected.

Overview of all additional programme settings ~ Page 32

3 Start button for starting, interrupting, (e.g. adding laundry) and cancelling a programme.

4 Programme selector for selecting the programme and for switching the washing machine on and off.

Display panel

In the table you can find possible settings and information in the display panel; these differ depending on the model.

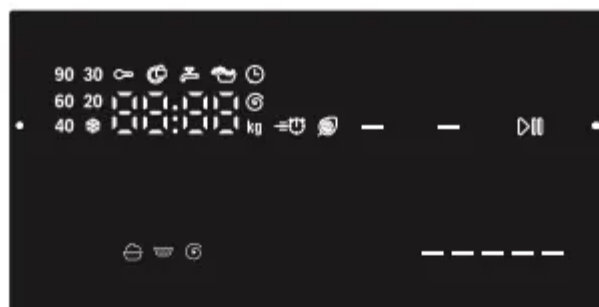

Settings for the selected programme		
* - 90*	Temperature in °C	Temperature
----, 0 - 1400*	Spin speed in rpm (revolutions per minute)	Maximum spin speed or ---- (Rinse stop = no final drain, washing remains in the water after the last rinse)
1:30	Programme length	Depends on the programme selection in h: min (hours: minutes)
1 - 24	Finish in h (hours)	End of programme after ... Hours
10,0 kg	Load in kg	Maximum load
* Depending on the model		

Status indicators for the programme progress (programme sequence)		
☺, 🌊, Ⓜ, End		Wash, rinse, spin/drain, programme end.
🔒	Childproof lock	Lights up: The childproof lock is activated. Flashes: The childproof lock is activated, and if the programme selector has been adjusted or the buttons have been pressed.
🔒	Door lock	Lights up: When the door can not be opened.
🚰	Tap	Lights up: Water pressure is too low. This extends the programme duration. Flashes: The tap has not been turned on or there is no water supply.
🧼	Overdosage	On if too much foam detected, one additional rinse cycle switched on.
---- ⚡*		Power consumption.
* Depending on the model		

Laundry

Protecting your laundry and appliance

The following instructions must be observed when preparing your laundry:

- Always follow the manufacturer's instructions when dosing all detergents, cleaning aids, care products and cleaning agents.
- Do not exceed maximum load.
- Overfilling will impair the washing result.
- Keep detergents and agents for the pretreatment of laundry (e.g. stain remover, prewash sprays, etc.) away from the surfaces of the appliance. Using a damp cloth, immediately remove any fine spray residue and other residue or droplets.
- Empty any pockets. Remove any foreign objects.

- Remove metal parts (paper clips, etc.).
- Trousers, knitwear and knitted textiles, e.g. jersey garments, T-shirts or sweatshirts, should be turned inside out.
- Ensure that underwired bras are appliance-washable.
- Wash delicates in a net or (bag tights, underwired bras, etc).
- Close zips, button up covers.
- Brush sand out of pockets and collars.
- Remove curtain fittings or include in the net/bag.

Sorting laundry



Sort your laundry according to the care instructions and manufacturer's information on the care labels, depending on:

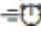

- Type of fabric/fibre
- Colour
- Soiling

Wash laundry with the same level of soiling together.

- Light: Do not need to pretreat, select the  SpeedPerfect setting if necessary.
- Normal
- Heavy: Load less laundry, need to pretreat or soak laundry firstly.
- Stains: Remove/pretreat stains while they are fresh. First dab with soapy water; do not rub.
- Then wash the items of laundry with the appropriate programme. Stubborn or dried-in stains can sometimes only be removed by washing several times.
- Symbols on the care labels

 Suitable for normal washing process; e.g.  Cottons programme

 A gentle washing process is required; e.g.  Easy Care programme

 An especially gentle washing process is required; e.g.  Delicates/ Silk programme



 Suitable for washing by hand; e.g.  Wool  programme

 Do not machine wash.

Starching

Note: Laundry should not be treated with fabric softener.

1. Switch on the appliance.

2. Select the  Rinse programme.
3. Measure starch into dispenser I in accordance with the manufacturer's instructions (clean first if necessary).
4. Touch the Start/Reload  button.

Dyeing/bleaching







Dye should only be used in normal household quantities. Salt may damage stainless steel. Always follow the dye manufacturer's instructions.

Do not use the appliance to bleach clothes.

Detergent

Correct selection of detergent

The care label is crucial to ensure correct detergent selection, temperature and laundry treatment.

- Standard detergent with optical brighteners suitable for heat-resistant white washing made from linen or cotton Programme:  Cottons/ cold – max. 90 °C
- Detergent for colours without bleach or optical brighteners suitable for coloured washing made from linen or cotton Programme:  Cottons/ cold – max. 60 °C
- Detergent for colours/delicates without optical brighteners suitable for coloured laundry made from easy-care fibres, synthetic fibres Programme:  Easy Care/ cold – max. 60 °C
- Detergent for delicates suitable for delicate, fine fabrics, silk or viscose Programme:  Delicates/Silk/ cold – max. 40 °C
- Detergent for woollens suitable for woollen fabrics Programme:  Wool  / cold – max. 40 °C









Saving energy and detergent

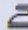
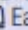

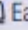

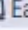

For light and normal soiling, you can save energy (lower washing temperature) and detergent.



Saving	Soiling/note
<p>Reduced temperature and detergent quantity as per the recommended dosage</p>	<p>Light No visible dirt or stains. Clothing has taken on some body odour, e.g.:</p> <ul style="list-style-type: none"> ■ Light summer/sports clothing (worn for a few hours) ■ T-shirts, shirts, blouses (worn for up to one day) ■ Guest bed linen and hand towels (used for one day)
	<p>Normal Visible dirt or a few light stains, e.g.:</p> <ul style="list-style-type: none"> ■ T-shirts, shirts, blouses (sweat soaked, worn a few times) ■ Towels, bedding (used for up to one week)
	<p>Heavy Dirt and/or stains clearly visible, e.g. tea towels, baby items, work clothing</p>
<p>Temperature as per the care label and detergent quantity as per the recommended dosage for heavy soiling</p>	

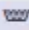

Overview of programmes

Programme/Type of washing	Options/Information
Name of the programme Brief explanation of the programme and for which fabrics it is suitable.	Max. load * as kg depending on the model and the programme selectable temperature* as °C selectable spin speed* in rpm possible additional programme settings* softener
 Cottons Hard-wearing fabrics, heat-resistant fabrics made of cotton or linen.	10,0 kg/5,0** kg * - 90 °C ----, 400 - 1400 rpm =⏪ SpeedPerfect, ⏪ EcoPerfect,  Easy-Iron,  Water/Rinse Plus possible
 Mix Mixed load of cottons and synthetic fabrics.	4,0 kg * - 60 °C ----, 400 - 1400 rpm =⏪ SpeedPerfect, ⏪ EcoPerfect,  Easy-Iron,  Water/Rinse Plus possible
 Easy Care Textiles made of synthetic materials or blended fabrics.	4,0 kg * - 60 °C ----, 400 - 1200 rpm =⏪ SpeedPerfect, ⏪ EcoPerfect,  Easy-Iron,  Water/Rinse Plus possible
 Delicates/Silk For delicate, washable textiles, e.g. made of silk, satin, synthetic fibres or blended fabrics (e.g. silk blouses, silk scarf). Note: Use a detergent suitable for appliance-washing delicates or silk.	2,0 kg * - 40 °C ----, 0 - 800 rpm  Easy-Iron,  Water/Rinse Plus possible
* Depending on the model and the programme. ** Reduced load with =⏪ SpeedPerfect additional programme setting.	

Programme/Type of washing	Options/Information
 Wool Hand or appliance-washable wool or rich-wool textiles. Especially gentle wash program to prevent shrinkage, longer program pauses (textiles rest in wash liquor). Notes <ul style="list-style-type: none"> ■ Wool is of animal origin, e.g.: Angora, alpaca, llama, sheep. ■ Use a detergent that is suitable for appliance-washing wool. 	2,0 kg * - 40 °C ----, 0 - 800 rpm - possible
 Jeans/Dark Wash Programme suitable for washing Jeans and other dark color textiles made of cotton or synthetic textiles.	4,0 kg * - 40 °C ----, 400 - 1200 rpm =⏪ SpeedPerfect, ⏪ EcoPerfect, =⏪ Easy-Iron, ⏪ Water/Rinse Plus possible
 Rinse For rinsing with a subsequent spin cycle.	- - ----, 0 - 1400 rpm =⏪ Easy-Iron, Water/Rinse Plus possible
 Spin For spinning with a selectable spin speed and subsequent draining. If you have selected 0, the water is only drained after rinse process, no spin cycle.	- - 0 - 1400 rpm =⏪ Easy-Iron not possible
 Drum Clean Special programme for drum hygiene or fluff removal. Do not load any laundry. Note: Use washing powder or a detergent containing bleach. To prevent foaming, only use half the amount of detergent recommended by the detergent manufacturer. Do not use detergents designed for woollens or delicates.	0,0 kg - 1200 rpm - not possible
 Quilt/Duvet For gentle cleaning of microfibre blankets, pillows and clothing filled with down or synthetic fibres. Wash larger items individually. We recommend using a small dose of a detergent designed for delicates.	2,5 kg * - 60 °C ----, 400- 1200 rpm ⏪ Water/Rinse Plus possible
* Depending on the model and the programme. ** Reduced load with =⏪ SpeedPerfect additional programme setting.	

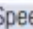
Programme/Type of washing	Options/Information
 Down Wear Appliance-washable items stuffed with synthetic fibres, such as pillows, quilts and bedspreads; also suitable for items stuffed with down. Note: Wash large items separately. Use a detergent designed for delicates and follow the instructions on the item's care label. Use detergent sparingly.	2,0 kg * - 60 °C ----, 400 - 1200 rpm  Water/Rinse Plus not possible
 Shirts/Blouses For cleaning blouses and shirts made from cotton, linen or mixed fabrics. Reduced spinning prevents creases.	2,0 kg * - 60 °C ----, 400 - 800 rpm  Easy-Iron,  Water/Rinse Plus possible
 AllergyPlus Hard-wearing fabrics made of cotton or linen. Note: Particularly suited to washing items that need to be hygienically clean and especially kind to sensitive skin thanks to the longer wash cycle at a defined temperature, higher water level and longer spin cycle.	6,5 kg * - 60 °C ----, 400 - 1400 rpm  SpeedPerfect,  EcoPerfect,  Easy-Iron,  Water/Rinse Plus possible
 Sportswear Sportswear and leisure wear made from microfibre fabrics. Notes <ul style="list-style-type: none"> Laundry must not be treated with fabric softener. Before washing, clean the detergent drawer thoroughly (all compartments) to remove fabric-softener residue. 	2,0 kg * - 40 °C ----, 400 - 800 rpm  Easy-Iron,  Water/Rinse Plus not possible
 Super 15'/30'  Super 15' programme: For less soiling and low load capacity, e.g., daily changing laundry or new laundry.  Super 30' programme: For less soiling cotton or linen laundry. Note: The default programme is  Super 15' , when you deactivate  SpeedPerfect setting, it will run  Super 30' programme.	4,0 kg/2,0** kg * - 40 °C ----, 400 - 1200 rpm  SpeedPerfect,  Water/Rinse Plus possible
* Depending on the model and the programme. ** Reduced load with  SpeedPerfect additional programme setting.	

Programme default settings

You can change the default settings for selected programmes. The settings can be changed even while the selected programme is running. The effects depending on the progress of the programme.

Temp. °C

Before and after the programme starts, you can change the set temperature depending on how far through the programme the appliance is.

The maximum temperature that can be set depends on the programme that has been selected.

rpm

Depending on what stage the programme is in, you can change the spin speed (in rpm; revolutions per minute) before and during the programme.

Setting 0: The rinsing water is drained but there is no spin cycle. The laundry stays wet inside the drum, e.g. for items that should not be spun.

Setting - - - -: "Rinse hold" = no final drain. The laundry stays in the water after the final rinse.

You can select "Rinse hold" to prevent creasing if the laundry will not be taken out of the appliance immediately after the programme has ended.

To continue/end the programme Page 36

The maximum speed that can be set depending on the model and the programme that has been selected.

Finished in

Before starting the programme, you can preselect the programme end ("Finish in" time) in 1h (h = hour) increments up to a maximum of 24 hours.



To do this:

1. Select a programme (except My time* programme). The programme duration is displayed for the selected programme, e.g. 2:30 (hours: minutes).
2. Touch the Finished in button repeatedly until the required number of hours is displayed.
3. Touch the Start/Reload button. The programme starts.

The selected number of hours (e.g. 8h) is shown in the display panel and counts down until the programme starts. The duration of the programme is then displayed.

Note: The length of the programme is automatically adjusted when the programme is running. Changes to the programme default settings or programme additional settings may also change the programme duration.

After starting the programme (if a "Finish in" time has been selected and the programme has not yet started), you can change the preselected number of hours as follows:

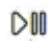
1. Touch the Start/Reload  button.
2. Touch the  Finished in button to change the number of hours.
3. Touch the Start/Reload  button.

Additional programme settings

G/F SpeedPerfect/EcoPerfect

Button with two possible settings for adapting the selected programme:

-  SpeedPerfect

Washing in a shorter time while achieving a washing result that is consistent with, but uses more energy than, the selected programme, without the  SpeedPerfect/EcoPerfect setting.

-  EcoPerfect

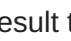
Energy-optimised washing by reducing the temperature while achieving a washing result that is consistent with the selected programme, without the  SpeedPerfect/EcoPerfect setting.

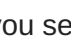
Select the button to do this. First of all, you can select the  SpeedPerfect setting. If you select the button again, the  EcoPerfect setting is active. The respective symbol is shown in the display when the setting is activated.

If you select the button again, no setting is active.

Easy-Iron

Reduces creasing by means of a special spin sequence followed by fluffing and reduced spin speed.

Touch Easy-Iron and activate or deactivate it.

Water/Rinse Plus

Additional rinse cycle depending on the programme; longer programme length for particularly sensitive skin and/or for areas with very soft water.

Longer programme duration.

Meanwhile the water level is raised during washing process for better soaking performance and gentler treatment of the laundry.

Operating the appliance

Preparing the appliance

The appliance was tested before delivery. To remove residual water from the test procedure, the first wash cycle should be run without laundry using the  Drum Clean programme.

Before washing for the first time" on page 19

1. Insert mains plug.

Warning

Risk of death from electric shock!

Risk of death if live parts are touched.

- Never pull out the mains plug by tugging the power cord.
- Insert/pull out the mains plug with dry hands only.

2. Turn the water tap on.



3. Open the appliance door.



Select programme/switch on the appliance

Note: If you have activated the childproof lock, you must first deactivate it before you can set a programme.

Use the programme selector to select the required programme. The programme selector can be rotated in either direction.

The appliance is switched on.

The programme default settings for the selected programme alternately appear in the display panel:

- The maximum load and the duration of the programme and

Placing laundry into the drum

Insert the laundry.

Close the door.

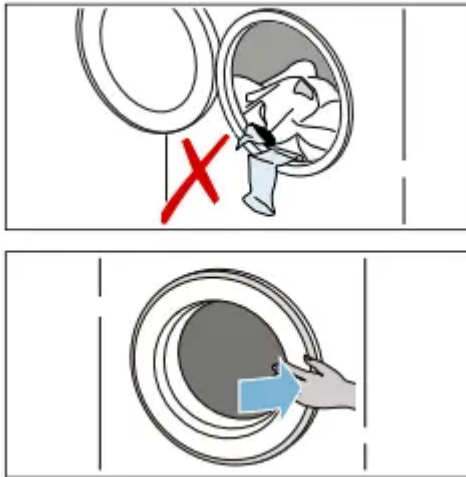

Notes

- Unfold and load presorted items of laundry. Mix large and small items. Washing items of different size distribute themselves better during the spin cycle. Individual items of washing may cause an unbalanced load.
- Observe the maximum specified load. Overfilling adversely affects the washing result and promotes creasing. Make sure that no items of laundry are trapped between the door and the rubber seal, and close the door.

Dosing and adding detergent and care product

Caution!

Damage to the appliance

Detergents and agents for the pretreatment of laundry (e.g. stain remover, prewash sprays, etc.) may damage the surfaces of the appliance.

Keep these agents away from the surfaces of the appliance. Using a damp cloth, immediately remove any fine spray residue and other residue/ droplets.

Dosing

Dose the detergents and care products according to:

- water hardness (ask your water supply company),
- the manufacturer's specifications on the packaging,
- the amount of laundry,
- soiling.

Filling the dispensers

1. Pull out the detergent drawer.

Warning

Eye / skin irritation!

If the detergent drawer is opened while the appliance is running, detergent/care product may run out. Carefully open the drawer.

If detergent/care product comes into contact with eyes or skin, rinse thoroughly.

If accidentally swallowed, seek medical advice.

2. Pour in detergent and/or cleaning product.

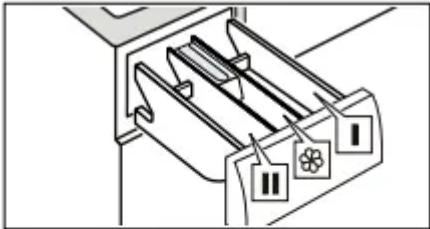

Dispenser I	Detergent for pretreat and clothing disinfectant. (only for the appliance with pretreat and disinfectant function)
Dispenser II	Softener, starch. Do not exceed the maximum load.
Dispenser III	Detergent for main wash, water softener, bleach, stain remover.

Notes

- Always follow the manufacturer's instructions when dosing all detergents, cleaning aids, care products and cleaning agents.
- Dilute viscous fabric softener and fabric conditioner with water. This will prevent blockages.
- Be careful when opening the detergent drawer while the appliance is running.

Starting the programme

Touch and hold Start/Reload button for 1~2 seconds, then release the button. The programme starts and the appliance door is locked.

The Finished in is shown in the display panel and counts down until the programme starts. After the programme has started, the programme duration is displayed. And the displays for the programme's progress light up.

Note: Foam detection

If the symbol  also lights up in the display panel, the appliance has detected too much foam during the wash cycle and automatically activated additional rinse cycles to remove the foam.



If you want to lock the programme to prevent it from being adjusted inadvertently, you can select the childproof lock.

Childproof lock

You can lock the appliance to prevent the settings you have set from being changed inadvertently. To do this, activate the childproof lock.

To activate the childproof lock:

After the programme starts, Touch and hold the  rpm and Finished in buttons for 3 seconds. The symbol lights up in the display panel.

-  lights up: The childproof lock is activated.
-  flashes: If the programme and programme settings are adjusted while childproof lock is activated



To deactivate the childproof lock:

Touch and hold the rpm and Finished in buttons until the symbol  disappears.

Adding/removing laundry

After starting the programme, you can add or remove laundry if necessary. Touch the Start/Reload  button. The appliance checks whether reloading is possible.

If the following appears on the display panel:

- The symbol  disappears, reloading is possible.
- The symbol  lights up, reloading is not possible.

To continue the programme, touch the Start/Reload button. The programme continues automatically.

Notes

- Do not leave the door open for too long when adding laundry as water from the laundry may leak out.
- For safety reasons, the door remains locked when the water level or temperature is high, or while the drum is turning, and it is not possible to add laundry during this time.

Changing the programme

If you have started the wrong programme by mistake, you can change the programme as follows:

1. Touch the Start/Reload button.
2. Select another programme.
3. And touch the Start/Reload button again. The new programme starts from the beginning.

Cancel the programme

For programmes at high temperatures:

1. Touch the Start/Reload button.
2. To cool down laundry: Select Rinse.
3. And touch the Start/Reload button again.

For programmes at low temperatures:

1. Touch the Start/Reload button.
2. Select Spin.
3. And touch the Start/Reload button again.

Programme end during rinse hold

---- appears in the display panel and the indicator lamp of the Start/ Reload button flashes.

Continue the programme by:

- Touch the Start/Reload button or
- Change the spin speed (if necessary) and then touch the Start/ Reloadbutton again.

Programme end

End lights up on the display panel and  and  displays are off.

If you have selected 0, the water is only drained after rinse process, no spin cycle.

Removing laundry/switching off the appliance

1. Set programme selector to Off.
2. Open the door and remove the laundry.
3. Turn off the water tap.

Note: Not required for Aqua-Stop models.

Notes

- Do not leave any items of laundry in the drum. They may shrink in the next wash or discolour another item.
- Remove any foreign objects from the drum and the rubber seal – risk of rusting.
- Wipe the rubber seal dry.

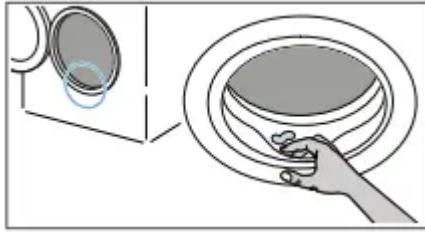

- Leave the door and detergent drawer open so that any residual water can evaporate.
- Always wait until the programme ends, as the appliance could still be locked. Then switch the appliance on and wait for it to unlock. depending on the model

Appliance settings

Appliance settings You can change the following settings:

- The volume of the end signal.
- The volume of the button signal.

You will need to activate the setting mode in order to change these settings.

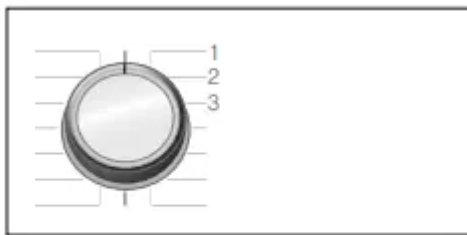

1/2/3/... positions on the programme selector

Activate setting mode:

1. Set the programme selector to position 1. The appliance is switched on.
2. Touch and hold the Start/Reload button and, at the same time, turn the programme selector clockwise to position 2. Release the Start/Reload button.

The setting mode is activated and the preset setting appears in the display panel.

Changing the volume

Use the Finished in button to change the following settings at the corresponding programme selector positions:

- 2: The volume of the end signal.
- 3: The volume of the button signals.

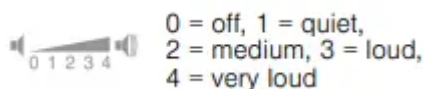

Exiting setting mode

You can now end the process and set the programme selector to the Off position. The settings are saved.

Sensors

Unbalanced load detection system

The automatic unbalanced load detection system detects imbalances and ensures even distribution of the laundry by repeatedly starting and stopping drum spinning.

If the laundry is extremely unevenly distributed, the spin speed is reduced or the spin cycle is not performed for safety reasons.

Note: Place large and small items of laundry evenly in the drum.

Cleaning and maintenance

Appliance housing/control panel

- Remove the detergent residue immediately.
- Wipe the housing and the control panel with a soft, damp cloth.
- Do not use abrasive cloths, sponges or detergents (stainless steel cleaner).
- Do not clean the appliance with a water jet.

Drum

Use chlorine-free cleaning agents, do not use steel wool.

If there are odours in the appliance, or to clean the drum, run the  Drum Clean 90 °C programme without laundry.

Descaling

Descaling should not be necessary if the detergent is measured out correctly. However, if it is required, follow the manufacturer's instructions for the descaling agent. Suitable descalers can be obtained via our website or from customer services.

Emptying the detergent draw, cleaning the detergent drawer and its housing

If the appliance contains detergent or fabric softener residues:

1. Pull out the detergent drawer. Press down the insert and fully remove the drawer.

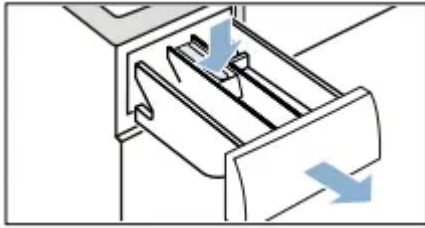

2. To remove the insert: Push the insert upwards from below with your finger.

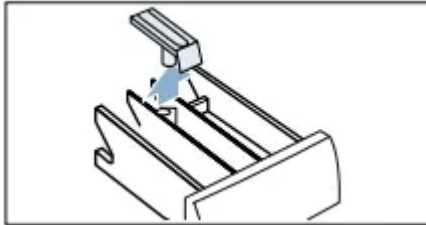

3. Clean the detergent dispenser tray and insert with water and a brush, and dry it. Clean the inside of the housing as well.

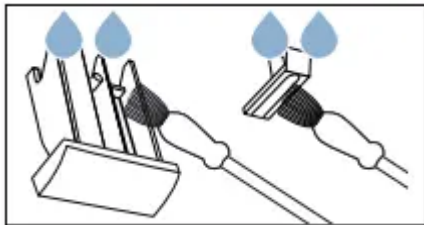

4. Fit the insert and lock it in place (push the cylinder onto the guide pin).

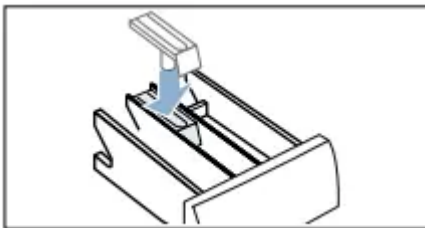

5. Push in the detergent drawer.

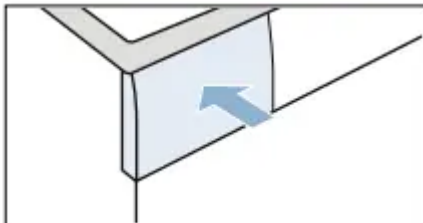

Note: Leave the detergent drawer open so that any residual water can evaporate.

Drain pump is blocked

Note: Turn the water tap off to prevent more water from flowing in and to ensure that it is drained via the pump.

1. Turn the programme selector to Off. Pull out the mains plug.
2. Open the service flap. en Cleaning and maintenance

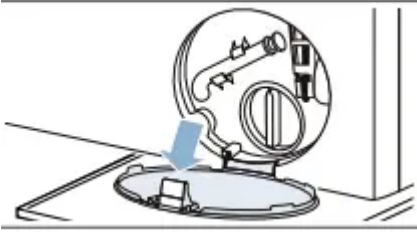

3. Take the drain hose out of the retainer.

Remove the sealing cap and pour the water out into a suitable container.

Replace the sealing cap and place the drain hose back in the retainer.



4. Carefully unscrew the pump cover; residual water may leak out. Clean the interior, pump cover thread and pump housing. The impeller in the drain pump must be able to rotate.

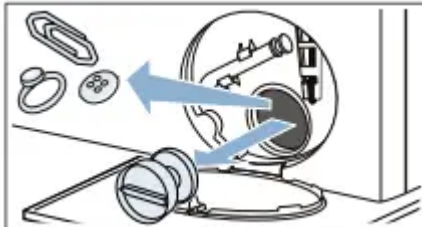

5. Refit and screw on the pump cover. The handle must be in a vertical position.

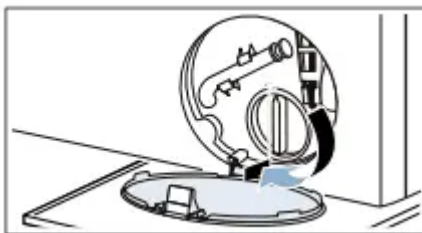

6. Close the service flap.

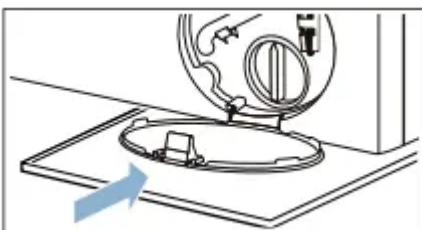

The drain hose at the siphon is blocked

1. Turn the programme selector to Off. Pull out the mains plug.
2. Loosen the hose clamp. Carefully remove the drain hose; residual water may leak out.
3. Clean the drain hose and siphon connecting piece.

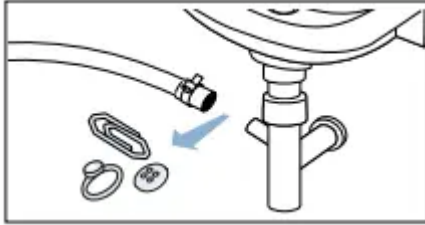

4. Re-attach the drain hose and secure the connection point using the hose clamp.

Filter in the water supply is blocked

Release water pressure in the supply hose:

1. Turn off the water tap.
2. Select any programme (except Rinse and Spin programmes).
3. Select the Start/Reload button. Allow the programme to run for approx. 40 seconds.
4. Turn the programme selector to Off.
5. Pull out the mains plug.

Clean the filters:

1. Disconnect the hose from the rear of the appliance.



2. Use pliers to remove the filter.

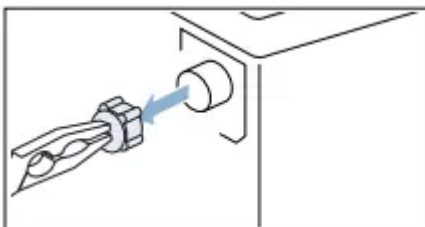

3. Clean the filter with a small brush.



4. Connect the hose and check for leaks.



Faults and what to do about them

Emergency release

E.g. power outage or in the event of a loss of power

The programme continues when the power supply is restored.

However, if the laundry has to be removed, the appliance door can be opened as follows:

1. Turn the programme selector to Off. Pull out the mains plug.
2. Open the service flap.

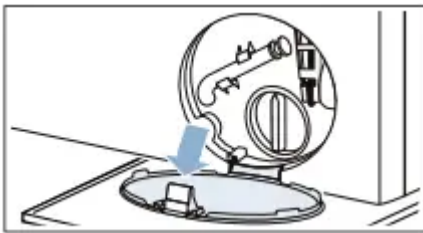

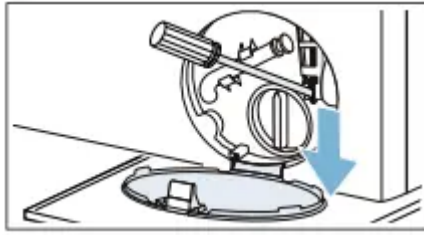

3. Drain the water. ~ Page 39

4. Pull the emergency release downwards with a tool and release. The door can then be opened



Information on the display panel

Faults and what to do about them

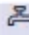
Display	Cause/Remedy
	<ul style="list-style-type: none"> ■ Flashes fast + warning signal: The door was opened and the water level is too high. Close the door, continue the programme with Start/Reload  button or select  Spin programme. ■ Flashes slowly: The door lock temperature is too high to open the door. Wait approx. 30 seconds until the door lock temperature cools down.
	<ul style="list-style-type: none"> ■ Flashes (no water supply): Tap turned on? Water inlet filter blocked? Clean the water inlet filter. If an additional water filter has been installed (depending on the model), check for contaminants and clean if required → separate installation and cleaning instruction for water filter. Water hose kinked or blocked? ■ Lights up (low water pressure): For information only. This will not affect the programme progress. The programme duration is extended.
E:18	Drain pump blocked; clean the drain pump. Clean the drainage hose on the siphon.
Other displays	Switch off the appliance, wait for five seconds and then switch it on again. If the display appears again, call customer services.

Water is leaking from the machine.

- Attach the drain hose correctly or replace it.
- Tighten the screw connection of the drain hose.

The machine is not filling with water.

Detergent is not being dispensed.

- Have you pressed the Start/Reload button?
- Is the tap turned on?
- Could the filter be clogged? Clean the filter ~ Page 41

Note: If an additional water filter has been installed (depending on the model), check for contaminants and clean if required ~ separate installation and cleaning instruction for water filter.



- Is the supply hose kinked or trapped?

The door cannot be opened.

- The safety function is activated. Stop the program?
- Is the  childproof lock activated? Deactivate.

- Is “- - -” selected (Rinse Stop = no final drain)?
- Can the door only be opened by the emergency release?

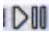
The program will not start.

- Have you pressed the Start/Reload  or  Finished in button?
- Is the door closed?
- Is the  childproof lock activated? Deactivate.

The drum briefly jerks or judders after the program has started.

- Not a fault – the internal motor test may cause the drum to jerk or judder briefly when the wash program starts.

The water is not draining.

- Is “- - -” selected (Rinse Stop = no final drain)?
- Clean the drain pump
- Clean the drain pipe and/or the drain hose.

Water is not visible in the drum.

- Not a fault – the water is below the visible area.

The spin result is not satisfactory.

- Laundry is wet/too damp.
- Not a fault – the unbalanced load detection system has interrupted the spin cycle because the laundry is unevenly distributed. Distribute small and large items of laundry evenly in the drum.
- Anti-crease (depending on the model) selected?
- Is the selected speed too low?

The spin cycle runs several times.

- Not a fault – the unbalanced load detection system is adjusting an imbalance.

The program is taking longer than usual.

- Not a fault – the unbalanced load detection system is adjusting an imbalance by repeatedly distributing the laundry.
- Not a fault – the foam detection is system active – a rinse cycle has been switched on.

The length of the program changes during the wash cycle.

- Not a fault – the program sequence is optimised for the specific washing process. This may change the length of the program shown in the display panel.

Residual water in the care-product compartment

- Not a fault – the effect of the care product is not affected.
- Clean the insert if necessary.

Odours in the washing machine.

- Depending on the model, run the  Drum Clean 90 °C or i Cottons 90 °C program without laundry.
- Add washing powder or a detergent containing bleach.

The symbol lights up in the display panel. Foam may also be leaking from the detergent drawer.

- Have you used too much detergent?
- Mix one tablespoon of fabric softener with 1/2 litre of water and pour it into compartment  (not suitable for outdoor clothing, sportswear or items stuffed with down).
- Use less detergent in the next wash cycle.

Loud noises, vibrations and machine "movement" during the spin cycle.

- Is the appliance aligned? Align the appliance
- Are the appliance's feet fixed? Secure the appliance's feet
- Have the transport braces been removed?
- Remove the transport braces ~ Page 14

The display panel/indicator lights do not work while the appliance is running.

- Has there been a power failure?
- Have the fuses blown? Reset/replace the fuses.
- If the fault occurs repeatedly, call customer services

There is detergent residue on the laundry.

- Some phosphate-free detergents contain water-insoluble residue.
- Select  Rinse or brush the laundry after washing.

The symbol lights up in the display in pause mode.

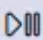
- Door is locked due to safety reasons (water level and/or temperature are too high). It is not possible to add laundry. Close the door immediately, if necessary.
- Press the Start/Reload  button to continue the program.

If you cannot rectify a fault yourself (after switching the machine off and on again) or a repair is required:

- Switch off the appliance and pull out the mains plug.

- Turn off the tap and call customer services.

Warning

This content is compiled from multiple sources and is provided for reference purposes only. It may not be complete or fully applicable to all situations. If you are unable to resolve your issue, please contact the product manufacturer or an authorized service provider for official support.

Document generated by [ManualsFile](#)

