

Overview

The Yaber L2 Plus3 is a smart projector with native 1080P resolution and 4K input support. It features built-in streaming apps, WiFi and Bluetooth connectivity, JBL speakers, and automated setup functions including auto focus and keystone correction.



Features

Display & Image Quality

- **Native Resolution:** 1920 x 1080 (Full HD).



- **4K Support:** Accepts 4K input signals and downscales them to 1080P for playback.
- **Brightness:** 460 ISO lumens.
- **Contrast Ratio:** 20,000:1.
- **Image Size:** Adjustable from 40 inches to 150 inches.
- **Throw Distance:** 3.5 feet (minimum) to 15 feet (maximum).
- **HDR Support:** Yes.
- **Video Encoding:** H.264, H.265.



Smart Features & Connectivity

- **Operating System:** Latest TV OS with native app support.
- **Built-in Apps:** Includes Netflix, YouTube, Prime Video, Hulu, and Disney+. Additional apps can be downloaded via the built-in "APP Store".
- **WiFi:** Dual-band WiFi 6 (2.4G/5G) for wireless screen mirroring and streaming.
- **Bluetooth:** For connecting external speakers or using the projector as a standalone Bluetooth speaker.
- **Ports:**
 - HDMI (supports ARC for connecting to soundbars or AV receivers)
 - USB
 - 3.5mm Audio Jack
- **Compatible Devices:** Smartphones, tablets, laptops, speakers, and televisions.

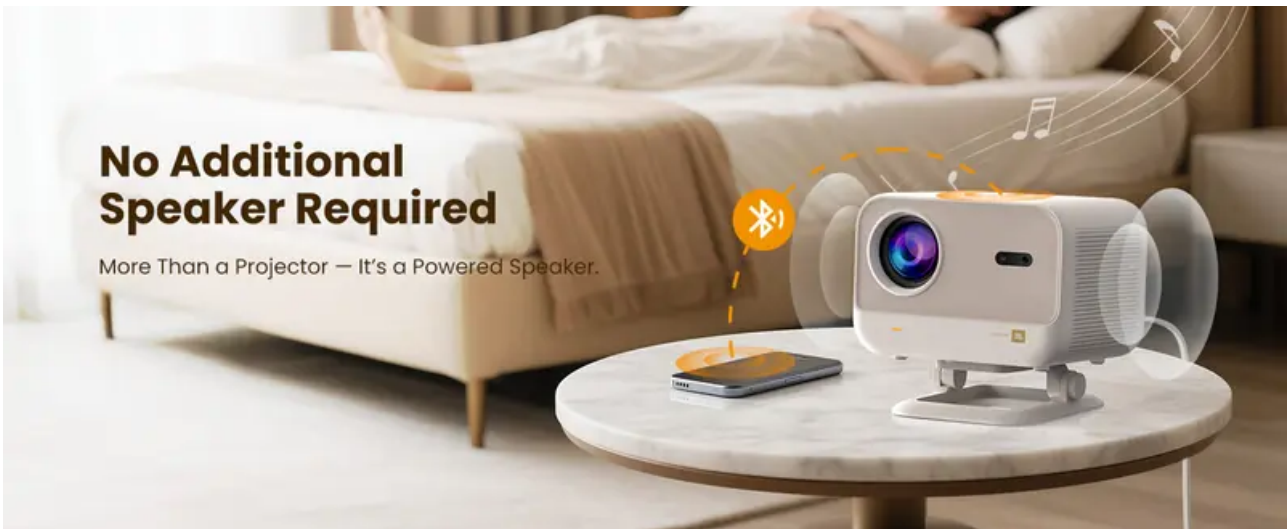

Audio

- **Speakers:** 2 x 8W JBL speakers.
- **Audio Technology:** Dolby Audio support.
- **Noise Level:** Low-noise operation.

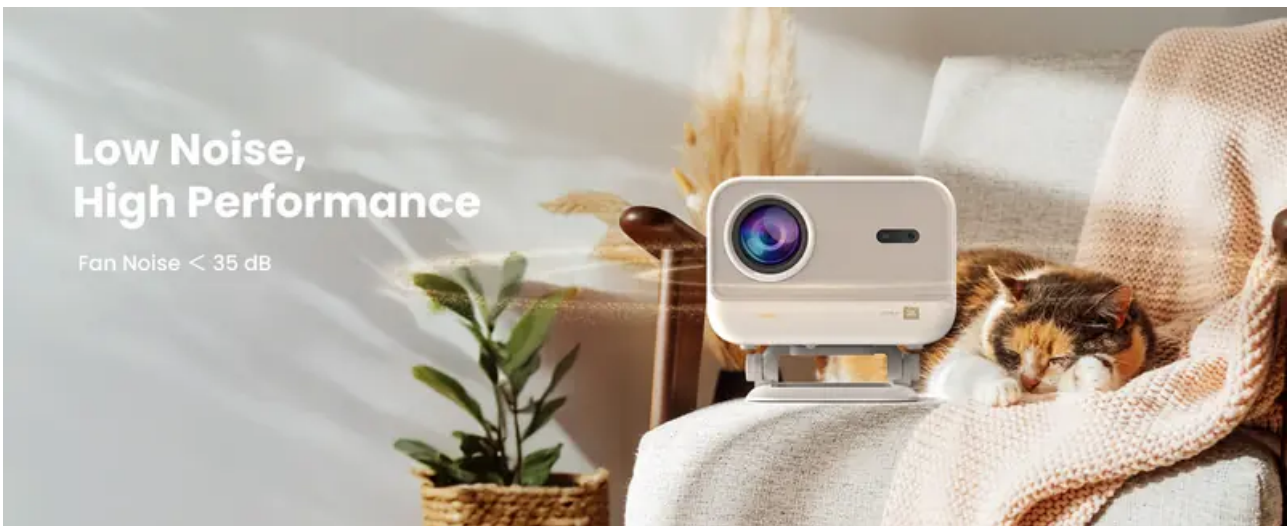

Automated Setup & Adjustment

- **Auto Focus:** Automatically adjusts for a clear image.
- **Auto Keystone Correction:** Automatically corrects image distortion.
- **Auto Screen Alignment:** Aligns the projected image to the screen.
- **Auto Obstacle Avoidance:** Detects and adjusts the image to avoid objects in the projection path.
- **Zoom:** 50% digital zoom.

Physical Design

- **Dimensions:** 8" L x 7.24" W x 8.93" H.
- **Weight:** 5.4 pounds.
- **Form Factor:** Desktop.
- **Mounting:** Supports table mount, ceiling mount, and includes a foldable/adjustable stand. The base stand has a maximum adjustment angle of $\pm 30^\circ$.
- **Dustproof Design:** Yes.
- **Light Source Life:** Up to 30,000 hours.

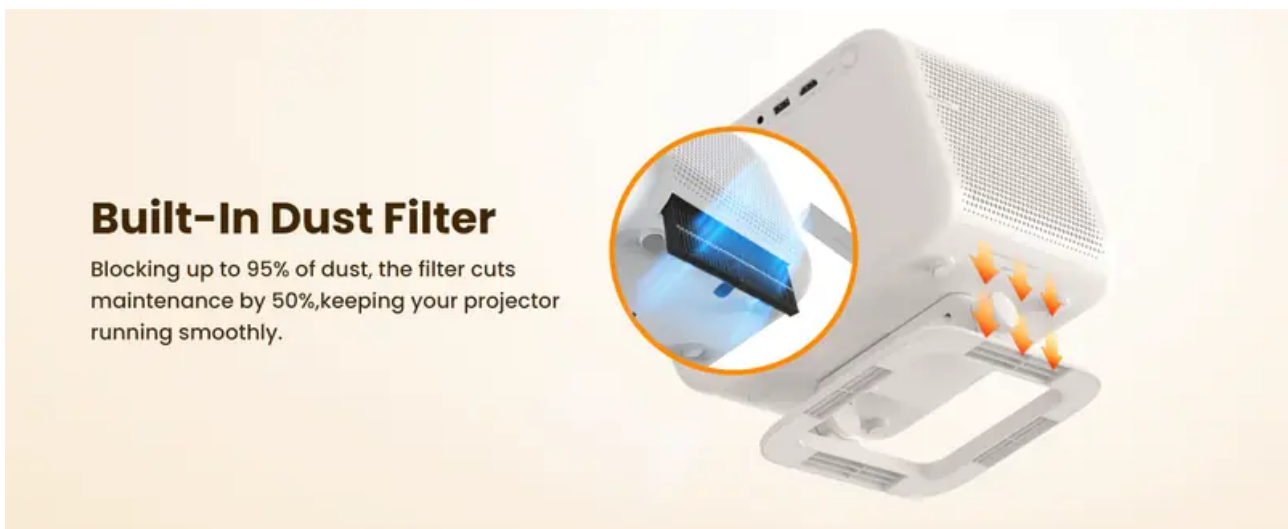

Use Guide

Initial Setup

1. **Unpack the Box:** Confirm all items are present:
 - Yaber L2 Plus3 Projector

- Power Cord
 - HDMI Cable
 - Remote Controller
 - Cleaning Kit
 - User Manual
2. **Position the Projector:** Place the projector on a stable, flat surface between 3.5 ft and 15 ft from your screen or wall. Ensure it is facing the screen directly for best results.
 3. **Connect to Power:** Plug the power cord into the projector and a wall outlet.
 4. **Power On:** Press the power button on the projector or remote.

Connecting to Video & Audio Sources

Using Built-in Smart Apps

1. Connect the projector to your WiFi network via the settings menu.
2. Use the remote to navigate the home screen and launch apps like Netflix, YouTube, or Prime Video.
3. Log in to your accounts within each app to start streaming.

Connecting External Devices via HDMI

1. Connect your device (laptop, gaming console, TV stick) to the projector's HDMI port using the provided cable.
2. Use the remote or source button to select the HDMI input.
3. The image should appear. Use the projector's auto-adjustment features or manual settings to optimize the picture.

Wireless Screen Mirroring (Casting)

For iOS (iPhone/iPad):

1. Ensure both your iOS device and the projector are connected to the same WiFi network.
2. On the projector, open the "iOS Cast" screen from the menu.
3. On your iOS device, open Control Center and tap "Screen Mirroring".
4. Select the projector from the list of available devices.

For Android/Windows:

1. Ensure both devices are on the same WiFi network.

2. Use the built-in casting function on your device (e.g., "Cast" in Google Chrome or "Connect" in Windows settings).
3. Select the projector from the list.

Note: For the best picture quality, use the native apps on the projector or an HDMI connection. Wireless mirroring may compress the video stream.

Using Bluetooth Audio

1. To connect external Bluetooth speakers:
 1. Put your speaker into pairing mode.
 2. On the projector, go to Settings > Bluetooth.
 3. Select your speaker from the discovered devices list.
2. To use the projector as a Bluetooth speaker:
 1. On the projector, go to Settings > Bluetooth to make it discoverable.
 2. On your phone or tablet, go to Bluetooth settings and select "Yaber L2 Plus3".
 3. Play audio from your device; it will output through the projector's speakers.

Using Automated Adjustment Features

The projector will typically run auto-adjustments upon startup. You can also trigger them manually from the settings menu or remote control.

- **Auto Focus:** Ensures the image is sharp.
- **Auto Keystone:** Corrects trapezoidal distortion if the projector is not perfectly aligned with the screen.
- **Auto Alignment & Obstacle Avoidance:** Adjusts the image to fit your screen and avoid objects in the way.

Tip: For optimal auto-focus and keystone performance, keep the projector's tilt angle within $\pm 15^\circ$ using the adjustable stand.

Mounting the Projector

1. **Ceiling Mount:**
 1. Remove the base stand by unscrewing it from the bottom of the projector.
 2. Attach a standard ceiling mount bracket (not included) to the projector's mounting thread.
 3. Secure the bracket to the ceiling.
 4. In the projector's settings menu, navigate to "Projection Mode" and select "Ceiling" to flip the image orientation.

2. **Tripod Mount:** Use the same mounting thread on the bottom of the projector to attach it to a tripod.



**Distance de projection /
Taille de l'écran**
Trouvez la configuration idéale !

Distance (m)	Taille (po)
1,22 m	40"
1,83 m	60"
2,44 m	80"
3,06 m	100"
3,67 m	120"
4,58 m	150"

The image shows a projector screen displaying a lion in a savanna. The text '150"' is overlaid on the screen. A potted plant is visible on the left, and a floor lamp is on the right.

Troubleshooting

Issue	Possible Solution
WiFi connection is unstable or won't connect.	<ol style="list-style-type: none">1. Ensure the projector is within 10 meters of the router, with no thick walls blocking the signal.2. Try updating the projector's software or performing a factory reset.3. Test the connection using a mobile phone hotspot.4. Contact Yaber support if the issue persists.
iOS screen mirroring does not work.	<ol style="list-style-type: none">1. Restart both your iPhone/iPad and the projector.2. Confirm both devices are connected to the same WiFi network.3. On the projector, open the "iOS Cast" screen.4. On your iOS device, use Screen Mirroring in Control Center to connect.
The projected picture is blurry.	<ol style="list-style-type: none">1. Try a factory reset.2. Ensure the projector is placed 4.5–16.4 ft from the screen, facing it directly.3. Clear any obstructions between the projector and the screen.4. Manually adjust focus using the remote control.
Picture quality is poor when casting wirelessly.	Wireless mirroring can compress the video stream. For the best quality, use the native apps on the projector or connect your device via HDMI.
Can the projector be used in daylight?	For best results, use the projector in a dim environment. Image quality will appear faded in bright daylight.
Does it have a built-in battery?	No. For outdoor use, you must connect it to a power source such as a wall outlet, extension cord, or portable power station.

Specifications

- **Brand:** Yaber PROJECTOR
- **Model:** L2 Plus3

- **Display Type:** LCD
- **Lamp Wattage:** 100W
- **Control Method:** Remote Control, App Control
- **Warranty:** 1 Year
- **ASIN:** B0GJD99JF7

Safety & Maintenance

- Use the included cleaning kit to gently clean the lens. Do not use abrasive materials.
- Ensure the ventilation ports are not blocked during operation.
- Allow the projector to cool down before storing it.
- Use only the provided power cord or a compatible replacement.

Warning

This content is compiled from multiple sources and is provided for reference purposes only. It may not be complete or fully applicable to all situations. If you are unable to resolve your issue, please contact the product manufacturer or an authorized service provider for official support.