

1. Overview

The ROVSUN 11LBS Portable Washing Machine is a compact, twin-tub laundry appliance designed for small spaces. It combines a 7lb washing tub and a 4lb spinner tub for washing and drying clothes. The unit operates on 110V power and uses gravity draining, requiring no permanent installation.



2. Product Specifications

Specification	Detail
Total Capacity	11 Pounds (Washer: 7lbs, Spinner: 4lbs)
Product Dimensions	14"D x 21.6"W x 23.6"H
Voltage	110 Volts / 60Hz
Motor Speed	1300 RPM
Controls Type	Knob
Cycle Options	Wash, Drain, Spin
Access Location	Top Load
Body Material	Plastic (Rust-resistant)
Washing/Dewatering Cylinder	Stainless Steel
Included Components	Drain Hose

3. Features & Components



3.1 Control Panel & Knobs

- **Wash Timer Knob:** Sets the washing duration. Timer runs for up to 15 minutes per load.
- **Wash Selector Knob:** Chooses between wash modes (e.g., standard).
- **Drain Selector Knob:** Controls the draining function for the wash tub.

- **Spin Timer Knob:** Sets the spinning duration. Timer runs for up to 5 minutes per load.

3.2 Physical Components

- **Wash Tub (Left):** 7lb capacity. Blue transparent lid allows you to monitor the wash.
- **Spin Tub (Right):** 4lb capacity. Used for extracting water from clothes.
- **Drain Hose:** Attaches to the unit for gravity draining of wastewater.
- **Pressing Plate (for Spin Tub):** A plate that should be placed on top of clothes in the spinner to prevent small items from being thrown out.

4. Use Guide

4.1 Setup & Placement

1. Place the machine on a flat, stable surface near a standard 110V electrical outlet and a drain point (e.g., sink, bathtub).
2. Ensure there is adequate space around the unit for air circulation and access to the lids.
3. Connect the provided drain hose to the outlet on the washing machine. Position the other end into a sink, drain, or bucket.
4. Plug the power cord into the 110V outlet.

4.2 Washing Clothes

1. **Loading:** Open the wash tub lid. Load clothes, not exceeding the 7lb capacity. Do not overload.
2. **Adding Water & Detergent:** Fill the tub with water using a separate hose or container. Add a small amount of detergent suitable for portable washers. The unit uses less water and detergent than standard machines.
3. **Setting the Cycle:** Close the lid. Set the **Wash Timer** knob to the desired duration (up to 15 minutes). Select the appropriate setting on the **Wash Selector** knob.
4. **Starting:** The wash cycle will begin. You can observe clothes through the transparent blue lid.
5. **Draining:** After washing, set the **Drain Selector** knob to drain the dirty water from the wash tub. Ensure the drain hose is properly positioned.



4.3 Spinning (Drying) Clothes

Important: When using the spinner tub, always place the provided pressing plate on top of the clothes. This prevents small items (like socks) from being thrown out and potentially causing a drain pipe blockage.

1. **Transfer Clothes:** Move the washed clothes from the wash tub to the spin tub. Do not exceed the 4lb capacity.
2. **Load Evenly:** Distribute clothes evenly around the center of the spin basket to maintain balance.
3. **Use the Pressing Plate:** Place the pressing plate on top of the load.
4. **Set the Cycle:** Close the spinner lid. Set the **Spin Timer** knob to the desired duration (up to 5 minutes).
5. **Starting:** The spin cycle will begin, extracting water from the clothes.
6. **Rinsing During Spin (Optional):** Some models may have an inlet to add rinse water to the spin tub. If yours has this feature, you can add water during the spin cycle for rinsing.

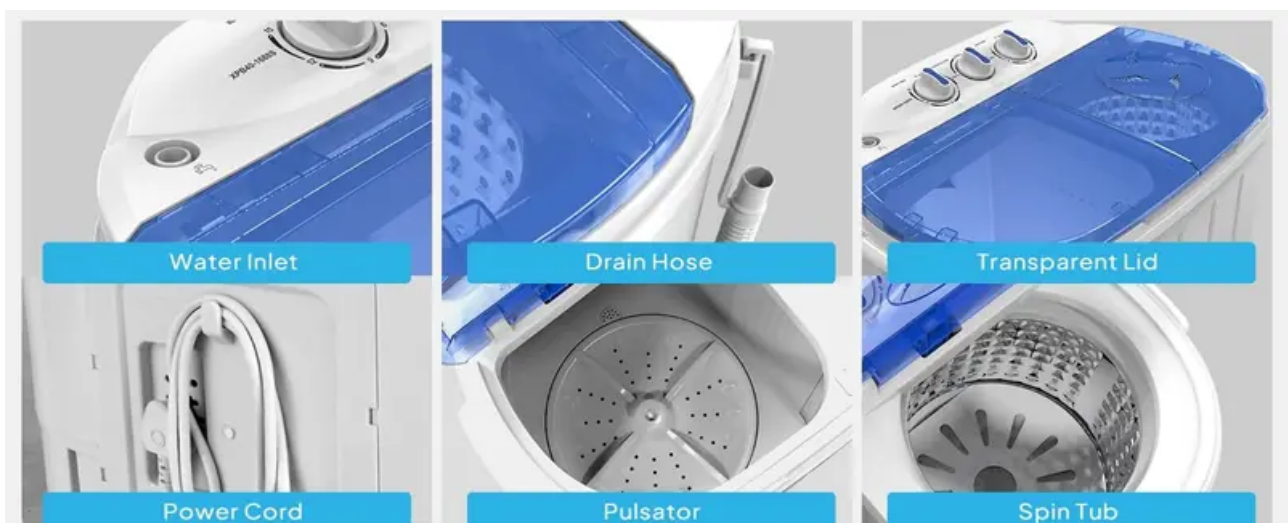

4.4 Completion & Cleanup

1. Once the spin cycle is complete, unplug the machine.
2. Remove the spun clothes. They will be damp, not fully dry.
3. Ensure all water has been drained from both tubs.
4. Wipe down the interior of the tubs and the exterior of the machine with a dry cloth.
5. Leave the lids open to allow the interior to air dry and prevent odors.

5. Care & Maintenance

- **Cleaning:** Periodically clean the tubs with a soft cloth and mild cleaner. Do not use abrasive materials.
- **Lint Filter:** Some models may have a removable lint filter/screen. Check the wall of the washer tub and clean it if present.
- **Drain Hose:** Keep the drain hose clear of kinks and blockages.
- **Storage:** When not in use, store the unit in a dry place. Ensure it is completely drained and dry before storage.
- **Power:** Always unplug the machine before cleaning or when not in use for extended periods.

6. Troubleshooting

Issue	Possible Cause & Solution
Machine doesn't start	Check if the unit is plugged into a working 110V outlet. Ensure the lid is closed properly.
Spin timer doesn't move or spinner doesn't turn	Unplug the machine, check for an overload or unbalanced load. Redistribute clothes evenly and ensure the pressing plate is used. Plug back in and try again.
Water doesn't drain	Check that the Drain Selector knob is set correctly. Ensure the drain hose is not kinked, blocked, or positioned higher than the drain outlet on the machine.
Excessive vibration or noise	The load may be unbalanced. Stop the machine, redistribute the clothes evenly in the tub, and ensure the machine is on a level surface.
Small items get stuck or cause blockage	Always use the pressing plate in the spin tub as instructed. For the wash tub, consider using a mesh laundry bag for small items like socks.

7. Warranty and Support

The product comes with a 1-Year warranty from ROVSUN. For support or warranty claims, contact the seller through your Amazon purchase history or the ROVSUN store page.

Brand: ROVSUN

Warning

This content is compiled from multiple sources and is provided for reference purposes only. It may not be complete or fully applicable to all situations. If you are unable to resolve your issue, please contact the product manufacturer or an authorized service provider for official support.

Document generated by [ManualsFile](#)