

Model: CQB-3Y

1. Overview

The DIHOOM Cordless Tyre Inflator is a portable, rechargeable air compressor designed for inflating tyres and various inflatables. It combines inflation, device charging, and emergency lighting functions in one compact unit.



Key characteristics of the device include:

- **Cordless Operation:** Powered by a built-in 6000mAh rechargeable battery.
- **Dual Power Supply:** Can also be powered via the included 12V car power cord.
- **Digital Display & Control:** Features a screen and buttons for setting target pressure.

- **Automatic Shut-off:** Stops inflation automatically when the preset pressure is reached.
- **Multi-function:** Includes a USB power bank output and a multi-mode LED light.

2. Package Contents

- 1 x Electric Inflatable Pump (Main Unit)
- 1 x Inflatable Hose
- 4 x Inflatable Converter Heads (Nozzles)
- 1 x USB Charging Cable
- 1 x Car Power Cord (12V)
- 1 x Storage Bag

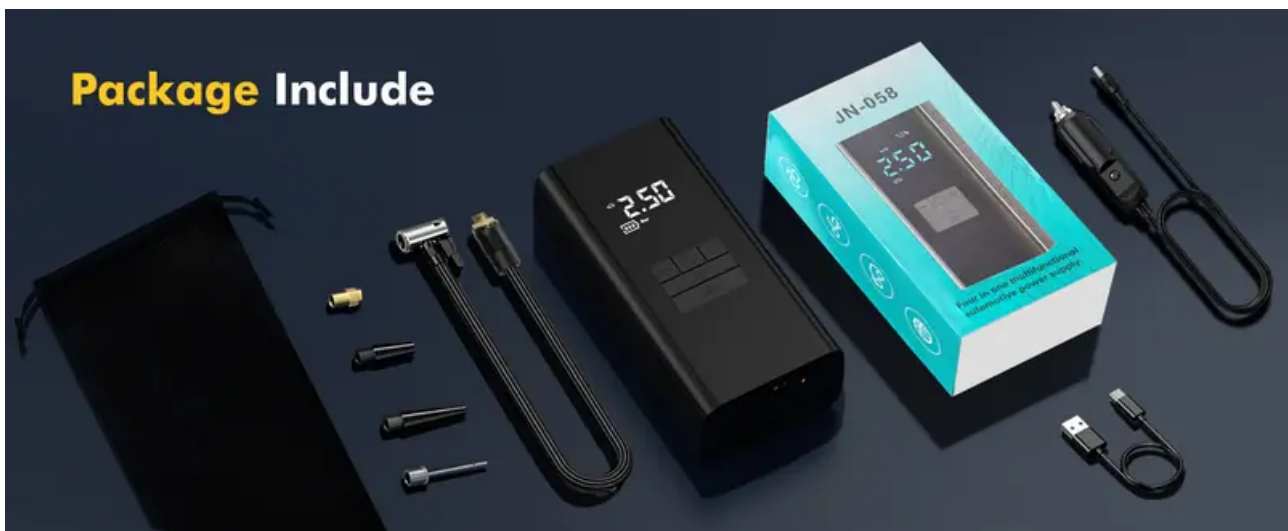

3. Specifications

Specification	Detail
Brand	DIHOOM
Model Name / Number	CQB-3Y / 03
Air Flow Capacity	45 Litres Per Minute (L/min)
Battery Capacity	6000mAh Lithium-ion
Voltage	12 Volts (DC)
Power Source	Battery Powered & 12V Car Socket
Noise Level	72 Decibels
Included Components	Pump, hose, 4 nozzles, USB cable, car cord, storage bag

4. Features & Components

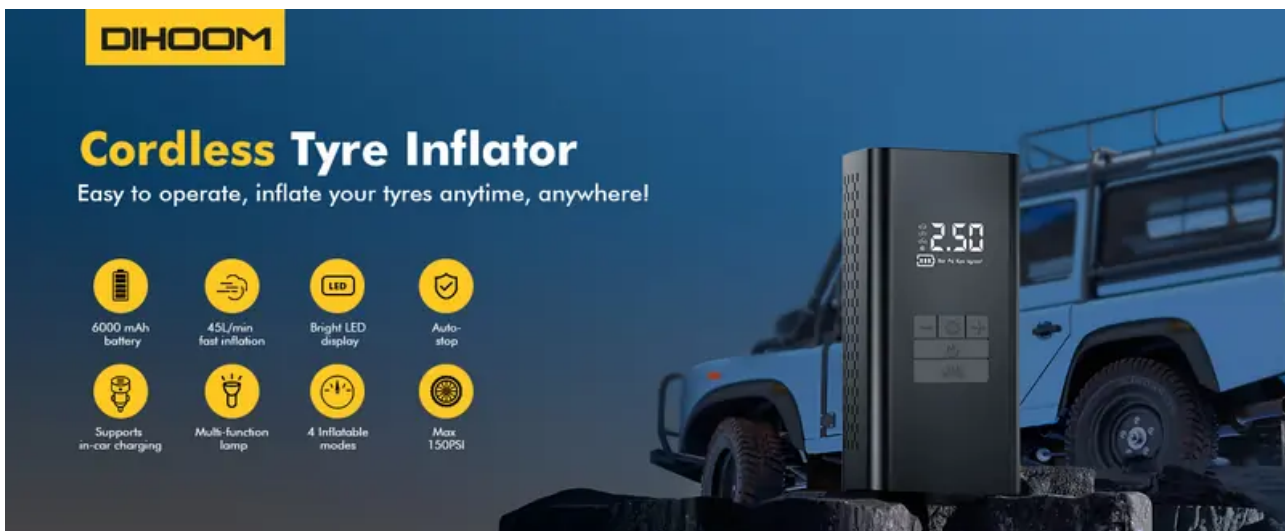

4.1 Main Unit Controls and Indicators

- **Digital Display:** Shows current pressure reading (PSI/Bar) and target pressure.
- **Power Button:** Turns the unit on/off and starts/stops inflation.
- **Mode (M) Button:** Cycles through the four preset inflation modes.
- **Pressure Adjustment Buttons (+ / -):** Manually raise or lower the target pressure setting.
- **Unit Button:** Toggles the pressure display unit between PSI and Bar.

- **LED Light Button:** Controls the top-mounted LED light (multiple modes).
- **USB Output Port:** For charging external devices (e.g., phones).
- **USB Input Port:** For charging the inflator's internal battery.
- **Air Hose Connection Point:** Where the supplied hose attaches.

4.2 Preset Inflation Modes

The unit has four preset modes for common items, allowing one-click setup:



- **Car Mode:** Default setting approximately 2.5 Bar (36 PSI).
- **Motorcycle Mode:** Default setting approximately 45 PSI.
- **Bicycle Mode:** Default setting approximately 2.4 Bar.
- **Ball Mode:** Default setting approximately 8 PSI.

You can override these presets and set a custom pressure using the + and - buttons.

4.3 Dual Power Supply

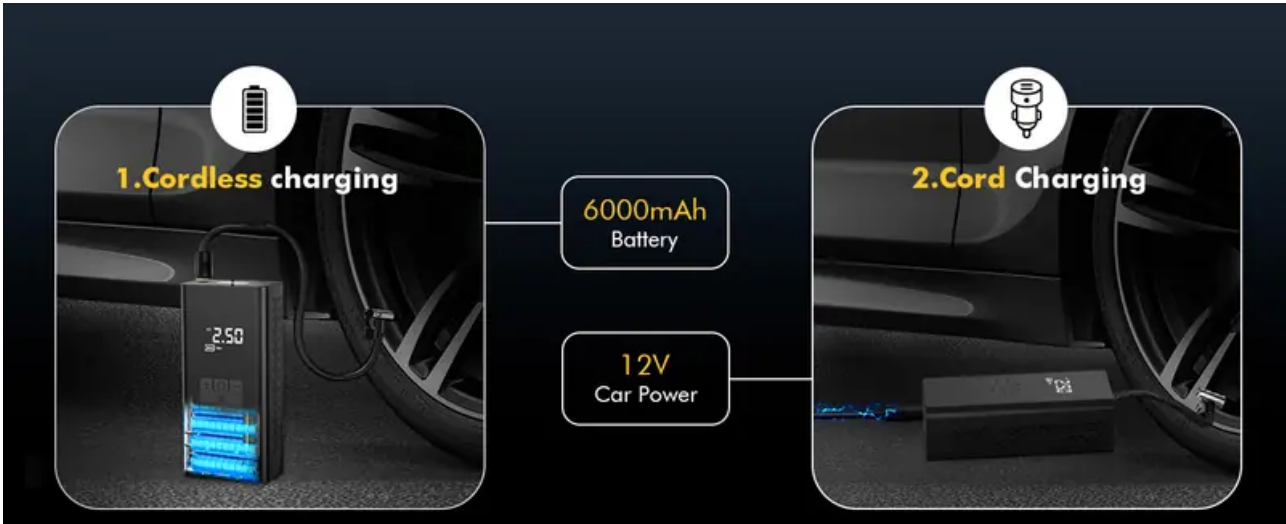

- **Battery Power:** The built-in 6000mAh battery provides cordless operation. A full charge offers up to 30 minutes of runtime.
- **12V Car Power:** Connect the included car power cord to the unit and your vehicle's 12V socket (cigarette lighter) to operate or charge simultaneously. This is useful when the battery is low.

4.4 Additional Functions

- **Power Bank:** The USB output port can be used to charge mobile phones, tablets, or other USB devices.
- **LED Light:** The top light has three modes: steady (for illumination), flashing (warning), and SOS. Press the light button to cycle through modes.

5. Use Guide

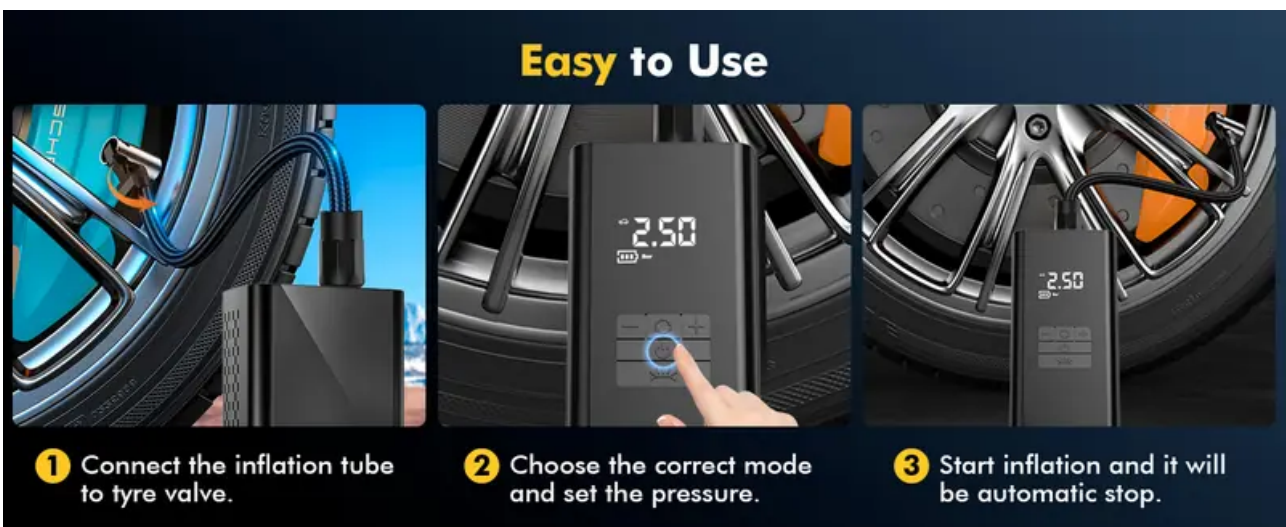

5.1 Charging the Inflator

1. Connect the provided USB cable to the inflator's **USB Input Port**.
2. Connect the other end to a standard USB power adapter (5V, not included) or a computer USB port.
3. The display may illuminate to indicate charging status. A full charge takes several hours.

5.2 Inflating a Tyre (Basic Operation)

1. **Power On:** Press the Power button. The display will light up.
2. **Set Target Pressure:**
 - Press the **Mode (M) button** to select a preset (Car, Motorcycle, Bicycle, Ball).
 - OR, use the **+ and - buttons** to manually set your desired pressure. Use the **Unit button** to switch between PSI and Bar if needed.
3. **Attach the Hose:**
 - Screw the appropriate nozzle onto the inflatable hose if needed (for balls, inflatables).
 - Firmly press the hose connector onto the tyre valve stem. Ensure it is locked in place to prevent air leakage.
4. **Start Inflation:** Press the **Power button** again to begin. The display will show the rising current pressure.
5. **Automatic Stop:** The pump will stop automatically when the target pressure is reached. The display will show the final pressure.
6. **Disconnect:** Remove the hose from the tyre valve. Press the Power button to turn off the unit.

5.3 Using the 12V Car Power Cord

1. Plug the car power cord into the inflator's power input port.
2. Plug the other end into your vehicle's 12V accessory socket.
3. Operate the inflator as normal. It will draw power from the car, conserving the internal battery.

5.4 Using the Power Bank Function

1. Ensure the inflator has sufficient battery charge.
2. Connect your device's charging cable to the inflator's **USB Output Port**.
3. The external device should begin charging. The inflator does not need to be turned on for this function.

5.5 Using the LED Light

Press the dedicated Light button on the unit to cycle through the modes: Off → Steady Light → Flashing → SOS → Off.

Important Usage Note: To prevent overheating, it is recommended to not use the pump continuously for more than 10 minutes. Allow it to rest for 10 minutes before resuming use, especially when inflating large volumes (e.g., airbeds, kayaks).

6. Care and Maintenance

- Store the inflator and accessories in the provided storage bag in a cool, dry place.
- Keep the air outlet and hose connectors clean and free from debris.
- Periodically check the battery level and recharge the unit every 3-6 months if not in use for extended periods to maintain battery health.
- Do not submerge the unit in water or use it in heavy rain.
- Do not attempt to disassemble the unit.

7. Troubleshooting

Problem	Possible Cause & Solution
Unit does not turn on.	Battery is depleted. Connect to 12V car power or charge via USB. Ensure connections are secure.
Pump does not inflate / stops quickly.	Hose not properly connected to tyre valve. Re-attach firmly. Check for blockage in hose or nozzle.
Pump runs but air output is low or zero.	Internal motor or chip may be overheated. Turn off and allow to cool for 10-15 minutes. Ensure air outlet is not obstructed.
Pressure reading seems inaccurate.	Ensure the hose connection to the tyre valve is airtight. Compare with a separate pressure gauge for calibration.
Pump does not stop automatically.	Check that the target pressure is set correctly. The automatic shut-off may not function if there is a significant air leak.
USB power bank not working.	Inflator battery may be too low. Recharge the inflator. Try a different USB cable.

Warning

This content is compiled from multiple sources and is provided for reference purposes only. It may not be complete or fully applicable to all situations. If you are unable to resolve your issue, please contact the product manufacturer or an authorized service provider for official support.

Document generated by [ManualsFile](#)