

Model: Neakhmer Air Compressor

Style: Horizontal, Ocean Blue

1. Product Overview

The Neakhmer Portable Tire Inflator is a 12V DC, dual-cylinder air compressor designed for inflating car tires and other inflatables. It features a digital pressure gauge, an automatic shut-off function, and an integrated LED light.



This device is intended for use with standard 12V vehicle power outlets (cigarette lighter sockets) or by connecting directly to a 12V car battery. It is not suitable for high-pressure applications exceeding 130 PSI, such as large inflatable boats or paddle boards.

2. Package Contents

- 1 x Air Compressor Unit
- 1 x Power Cord with Battery Clamps and Cigarette Lighter Plug
- 1 x Yellow Coiled Air Hose
- 4 x Valve Adapters (Nozzles) for different inflatables
- 2 x Spare Fuses
- 1 x Portable Storage Bag



3. Technical Specifications

Specification	Detail
Brand	Neakhmer
Voltage	12 Volts DC Only
Maximum Pressure	130 PSI
Maximum Power	180 Watts
Air Flow	60 Liters per Minute
Noise Level	Approx. 75 Decibels
Power Cord Length	9.8 Feet (3 meters)
Hose Length	9.8 Feet (3 meters)
Item Weight	6.28 lbs (2.85 kg)
Dimensions (LxWxH)	8.8 x 7.0 x 4.0 in (22.4 x 17.8 x 10.2 cm)
Pressure Units	PSI, kPa, BAR, KG/CM ²
Special Features	Automatic Shut-Off, Dual Metal Cylinders, Digital Gauge, LED Light

4. Features & Controls



4.1 Digital Display & Controls

- **Digital Pressure Gauge:** Shows current pressure in real-time. Use the unit buttons to cycle between PSI, kPa, BAR, and KG/CM².
- **Pressure Setting Buttons (+/-):** Used to preset your desired target pressure.
- **Power/Start Switch:** Turns the compressor motor on and off.
- **Independent LED Light Switch:** Controls the built-in flashlight separately from the compressor motor.

4.2 Dual Metal Cylinder Motor

Features a dual copper motor construction, which provides faster inflation compared to single-cylinder models and is designed for durability.

4.3 Automatic Shut-Off

The compressor will automatically stop when the preset target pressure is reached. A small amount of air may escape when disconnecting the hose, so it is recommended to set the pressure 1-2 PSI higher than your desired final pressure.

4.4 Quick-Connect Air Valve

The air hose uses a quick connector that attaches to tire valves without twisting.

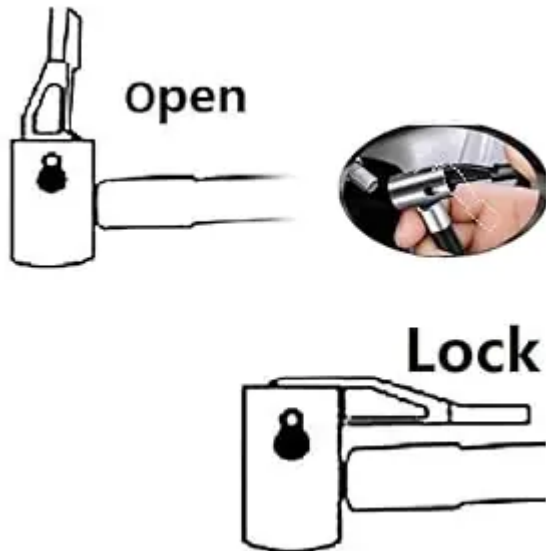

5. Operating Instructions



1 Start the engine



2 Connect to 12V outlet



3 Connect to tire valve



4 preset the tire pressure



5 Turn the switch ON



6 Wait for auto shut-off

5.1 Before First Use

1. Unpack all components and ensure the air hose is securely connected to the compressor outlet.
2. Familiarize yourself with the valve adapters. The standard Schrader valve adapter is typically pre-attached for car tires.

5.2 Step-by-Step Inflation

1. **Connect the Air Hose:** Attach the appropriate nozzle to the yellow air hose. Press the quick-connect fitting firmly onto the tire valve.
2. **Connect to Power:**
 - **Preferred Method (Battery Clamps):** Connect the red clamp to the positive (+) terminal and the black clamp to the negative (-) terminal of your car battery.
 - **Alternative Method (Cigarette Lighter):** Plug the 12V adapter into your vehicle's cigarette lighter socket.
3. **Start the Vehicle:** Turn the car's ignition to the "ON" position or start the engine. This ensures a stable power supply and prevents battery drain.
4. **Set Target Pressure:** Use the "+" and "-" buttons on the unit to set your desired pressure. Refer to your vehicle's manual for recommended tire pressure.

5. **Begin Inflation:** Press the Power/Start switch. The digital display will show the rising pressure. The compressor will shut off automatically when the preset pressure is reached.
6. **Disconnect:** First, turn off the compressor switch. Then, quickly remove the air hose from the tire valve. Re-check pressure with a separate gauge if desired.
7. **Power Down:** Disconnect the power cord from the battery or cigarette lighter.

⚠ Warnings & Limitations

- **Power Source:** Use with 12V DC power ONLY. Do not connect to 20V, 36V, or 110V AC outlets.
- **Duty Cycle:** Do not operate the compressor continuously for more than 20 minutes. Allow it to cool down between uses to prevent overheating and fuse damage.
- **High-Pressure Items:** This inflator is not designed for items requiring over 120 PSI (e.g., paddle boards, large boats).
- **Heat:** The unit will become warm during operation; this is normal. Ensure it is placed on a stable, non-flammable surface.

Usage Tips

- For best accuracy, check tire pressure when tires are cold.
- If the pressure reading jumps to 50-100 PSI immediately upon starting, air flow is blocked. Stop immediately, disconnect the hose, and re-attach it properly.
- Use the LED light switch independently to illuminate your work area without running the compressor.

6. Maintenance & Troubleshooting

6.1 Care and Storage

- Store the unit in the provided bag in a cool, dry place.
- Keep the air hose and power cord loosely coiled to prevent damage.
- Wipe the exterior with a dry cloth if dirty.

6.2 Replacing the Fuse

If the compressor loses power, the fuse may be blown. Spare fuses are included in the package. Refer to the power cord's fuse compartment for replacement instructions.

6.3 Troubleshooting

Problem	Possible Cause	Solution
Compressor does not turn on	No power, blown fuse, loose connection.	Check power connections. Ensure car ignition is on. Inspect and replace fuse if necessary.
Pressure reading is inaccurate or jumps	Air hose not connected properly to tire valve.	Stop compressor. Disconnect and firmly re-attach hose to valve.
Compressor stops before reaching target pressure	Overheating.	Allow unit to cool down for 30 minutes. Do not exceed 20 minutes of continuous operation.
Air leaks from connection	Worn or damaged valve adapter.	Try a different valve adapter from the included set.
Slow inflation	Low battery voltage, extremely low starting pressure.	Ensure vehicle engine is running. For very flat tires, initial inflation may be slow.

7. Warranty and Support

This product is backed by a **1-Year Manufacturer's Warranty** from Neakhmer.

For product support, inquiries, or to make a warranty claim:

- Contact the seller directly through your Amazon.ca order page.
- Manufacturer: Neakhmer

Please have your model number and Amazon order information ready when contacting support.

Warning

This content is compiled from multiple sources and is provided for reference purposes only. It may not be complete or fully applicable to all situations. If you are unable to resolve your issue, please contact the product manufacturer or an authorized service provider for official support.