

## OVERVIEW



## TROUBLESHOOTING

|                                                                  |                                                                                                                                                                                                                                                                                   |
|------------------------------------------------------------------|-----------------------------------------------------------------------------------------------------------------------------------------------------------------------------------------------------------------------------------------------------------------------------------|
| <b>No light indicator</b>                                        | Check the mains, plug, voltage, and fuse. In case of problems, call the Nespresso Club.                                                                                                                                                                                           |
| <b>No coffee, no water.</b>                                      | <ul style="list-style-type: none"> <li>• First use: fill water tank with warm water (max. 55°C) and run through machine according to instructions on page 13.</li> <li>• Water tank is empty. Fill water tank.</li> <li>• Descale if necessary; see Descaling section.</li> </ul> |
| <b>Coffee comes out very slowly.</b>                             | Flow speed depends on the coffee variety<br>Descal if necessary; see Descaling section.                                                                                                                                                                                           |
| <b>Coffee is not hot enough.</b>                                 | Preheat cup<br>Descal if necessary                                                                                                                                                                                                                                                |
| <b>Capsule area is leaking (water in capsule container).</b>     | Position capsule correctly. If leakages occur, call the Nespresso Club                                                                                                                                                                                                            |
| <b>Irregular blinking.</b>                                       | Send appliance to repair or call the Nespresso Club.                                                                                                                                                                                                                              |
| <b>No coffee, just water runs out (despite inserted capsule)</b> | In case of problems, call the Nespresso Club.                                                                                                                                                                                                                                     |

## FIRST USE OR AFTER A LONG PERIOD OF NON USE

**Notice;** Place the coffee maker on a surface which is resistant to water, coffee, descalermor other fluids.

|                                   |                                                                                   |                           |
|-----------------------------------|-----------------------------------------------------------------------------------|---------------------------|
|                                   |  |                           |
| <b>1. Remove the plastic film</b> | <b>2. Fill water tank with drinking water</b>                                     | <b>3. Place container</b> |

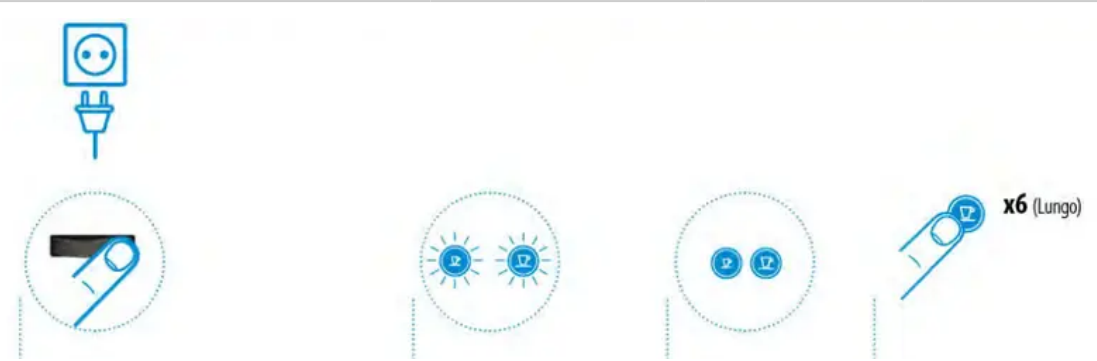
|                                                                                     |                      |                 |                                           |
|-------------------------------------------------------------------------------------|----------------------|-----------------|-------------------------------------------|
|  |                      |                 |                                           |
| <b>4. Plug into mains then switch ON</b>                                            | <b>5. Heating up</b> | <b>6. Ready</b> | <b>7. Rinse: Let water run through x6</b> |

## COFFEE PREPARATION

**Notice** Damage possible Never use deformed capsules.

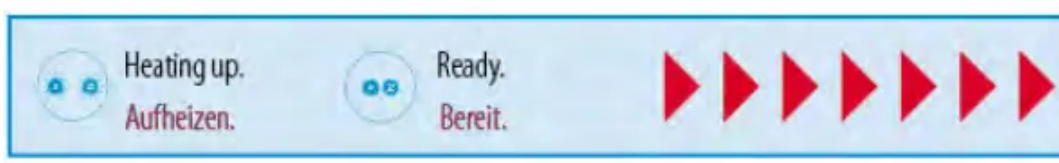



## PREHEAT COFFEE CUP

**Tip:** Preheated coffee cups keep your coffee warmer for longer

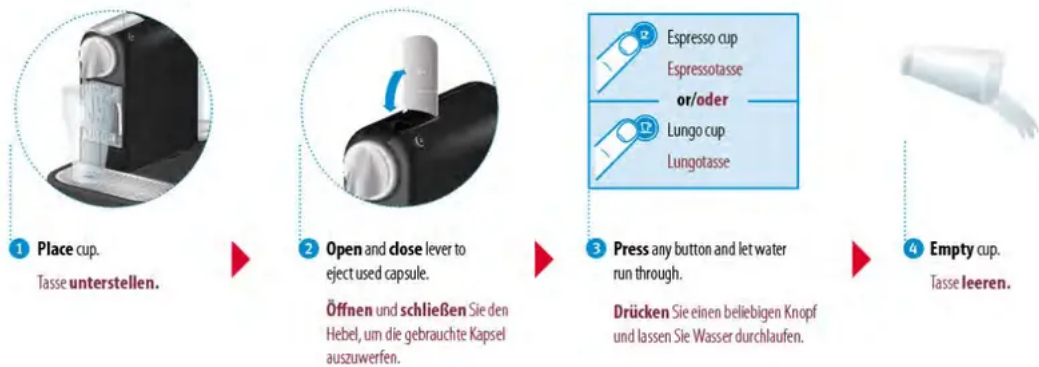

While heating up you can pre-select your coffee. Once the machine is ready coffee will begin to flow automatically.



4 Flow speed depends on coffee variety.

Die Durchlaufgeschwindigkeit ist abhängig von der Kaffeesorte.



5 Eject capsule (Drops into capsule container).

Kapsel **auswerfen** (fällt in den Kapselbehälter).

## MILK PREPARATION

**Warning** Risk of electrical shock and fire! Make sure the under side of the milk frother is dry.

1 Place milk frother on connector.  
Setzen Sie den Milchaufschäumer auf den Anschluss.

Milk frother is provided with:  
Milchaufschäumer wird mit einem Satz geliefert bestehend aus:

- 1 whisk / 1 Quirl
- 1 mixer / 1 Mixer

or/oder

2 Attach whisk or mixer; see Recipe section.  
Quirl oder Mixer **befestigen**; siehe Abschnitt „Rezeptideen“.

3 Fill milk frother with desired amount of milk.  
Füllen Sie den Milchaufschäumer mit der gewünschten Menge Milch.

**Caution** Spattered milk may cause burns. Only use milk frother with lid.

**Milk frother's maximum level indicated:**

|                          |                                                         |
|--------------------------|---------------------------------------------------------|
| <b>max.</b> ☉ Milk froth | 2 Nespresso Cappuccino cups<br>1 Nespresso Recipe glass |
| <b>max.</b> ☉ Hot milk   | 2 Nespresso Recipe glasses                              |

**Angaben über die max. Füllhöhe des Milchaufschäumers:**

|                           |                                                        |
|---------------------------|--------------------------------------------------------|
| <b>max.</b> ☉ Milchschaum | 2 Nespresso Cappuccinotassen<br>1 Nespresso Rezeptglas |
| <b>max.</b> ☉ Heiße Milch | 2 Nespresso Rezeptgläser                               |

**Milk frother's minimum level:**  
Make sure to cover the base of whisk/mixer

**min. Füllhöhe des Milchaufschäumers:**  
Sicherstellen, dass das Unterteil von Quirl bzw. Mixer bedeckt ist.

4 Press button to start. Lamp lights up. Milk frother stops automatically.  
Zum Starten Taste **drücken**. Die Kontrollleuchte leuchtet auf. Der Milchaufschäumer hält automatisch an.

- For hot preparation, **briefly press** button to start. Takes approx. 70–80 s.
- Für heiße Zubereitungen die Starttaste **kurz drücken**. Zeitaufwand ca. 70–80 Sekunden.
- For cold milk froth, **keep button pressed** for approx. 2 seconds. Takes approx. 60 s.
- Für kalten Milchschaum die Taste ca. 2 Sekunden **gedrückt halten**. Zeitaufwand ca. 60 Sekunden.

Tip: Use cold and newly opened UHT, full-fat or semi-skimmed milk.

## MILK CLEANING FROTHER

**NOTICE:** Milk frother is waterproof but NOT dishwasher safe. Clean milk frother after max 3 consecutive uses.

|                                                                  |                                                                                             |
|------------------------------------------------------------------|---------------------------------------------------------------------------------------------|
| <b>1. Remove milk frother from connector and dismantle whisk</b> | <b>2. Remove seal from lid to clean both parts. Rinse and clean with a soft damp cloth.</b> |
|------------------------------------------------------------------|---------------------------------------------------------------------------------------------|

### Adjust volume level

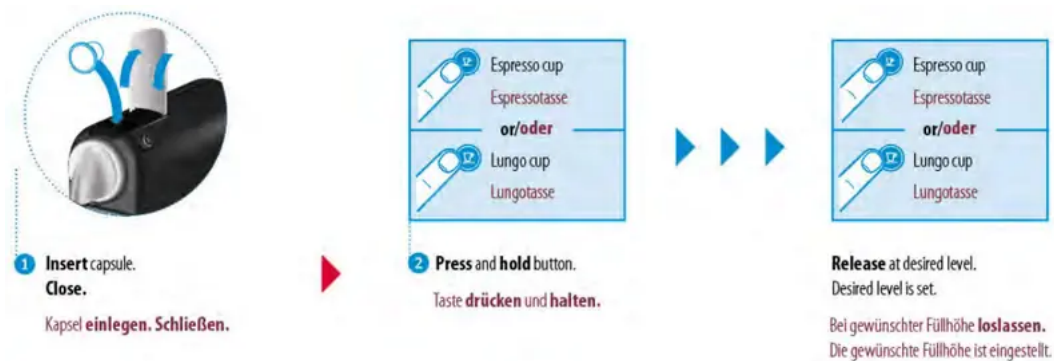

## CLEANING APPLIANCE: WEEKLY OR WHEN NECESSARY

**WARNING** Risk of fatal electrical shock and fire.



Clean appliance with a damp cloth.

### Descaling

#### Caution

Descaler may be harmful.

Carefully read and follow the safety instruction on the descaler package.

#### NOTICE

Damage from vinegar.

Use suitable descaler only.

Descaler can damage casing and contact surface. Immediately up drips.

| Water hardness: |    |                   | Descal after:       |                                                                                    |
|-----------------|----|-------------------|---------------------|------------------------------------------------------------------------------------|
| Wasserhärte:    |    |                   | Entkalkung nach:    |                                                                                    |
| fH              | dH | CaCO <sub>3</sub> | Cups, Tassen (40ml) |                                                                                    |
| 36              | 20 | 360 mg/l          | 300                 |  |
| 18              | 10 | 180 mg/l          | 600                 |                                                                                    |
| 0               | 0  | 0 mg/l            | 1200                |                                                                                    |

fH French grade  
Französische Skala

dH German grade  
Deutsche Skala

CaCO<sub>3</sub> calcium carbonate  
Kalziumkarbonat (Kesselstein)



**5 Do not lift** lever during descaling process.  
Den Hebel während des Entkalkungsvorgangs **nicht öffnen**.



**6 Press** both buttons simultaneously for 3 seconds.  
Beide Tasten gleichzeitig 3 Sekunden **drücken**.



**7 Ready** to descale.  
Bereit zum Entkalken.



**8 Press** any button to start. Just **wait** until water tank is empty.  
**Drücken** Sie einen beliebigen Knopf zum Start. **Warten** Sie, bis der Wasserbehälter leer ist.

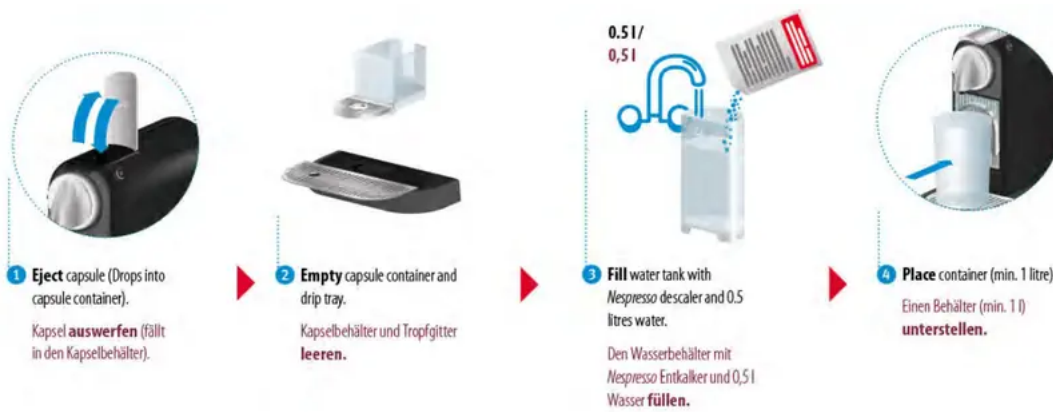

## SPECIFICATIONS

|          |                                  |
|----------|----------------------------------|
|          | 220–240 V, 50/60 Hz, max. 1710 W |
| <b>P</b> | Max. 19 bar                      |
|          | ~ 4.6 kg                         |
|          | 1 l                              |
|          | 5 °C to/bis 45 °C                |
|          | 23.7 cm   27.7 cm   37.2 cm      |

### Warning

This content is compiled from multiple sources and is provided for reference purposes only. It may not be complete or fully applicable to all situations. If you are unable to resolve your issue, please contact the product manufacturer or an authorized service provider for official support.

