

Product Description

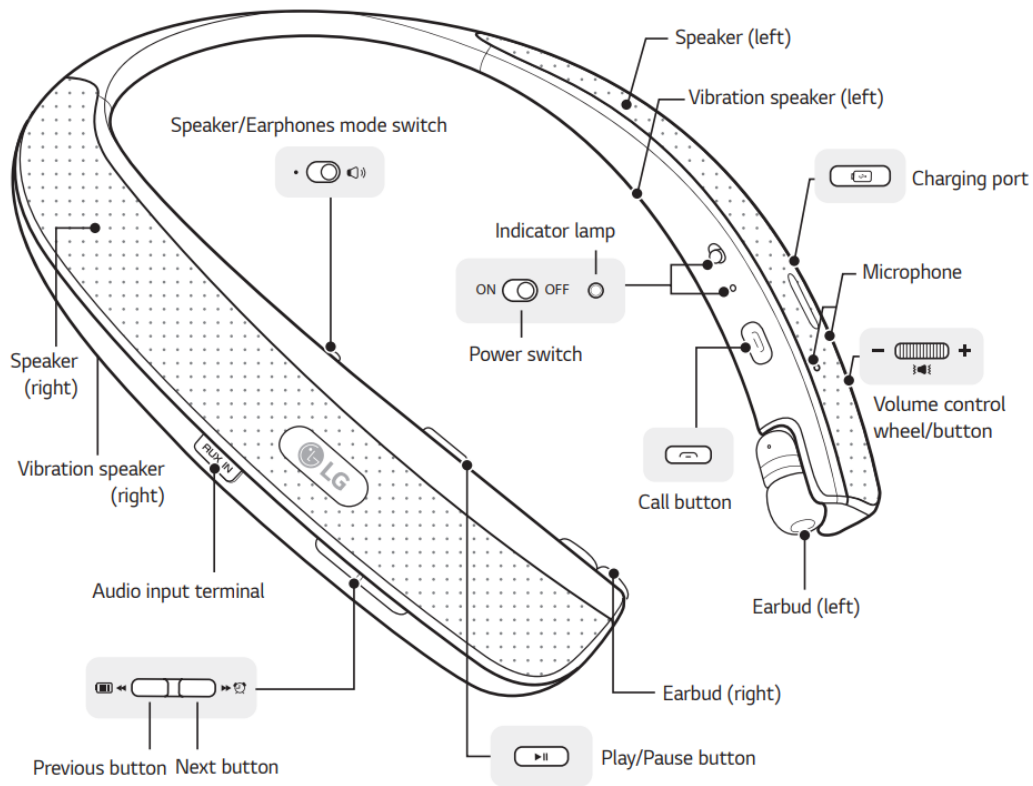

NOTE: To prevent hearing loss, the control sound is played for a long time when controlling the volume at high volumes.

HBS-W120 Pairing and Connecting

You can easily pair and connect the device following the voice prompts from the earbuds or the speaker.

If you hear that the battery is insufficient, recharge the battery before proceeding with pairing.

If pairing is not completed within three minutes, power automatically turns off. When power automatically turns off, slide the Power switch from the OFF to the ON position to turn power on again.



Connecting Quickly

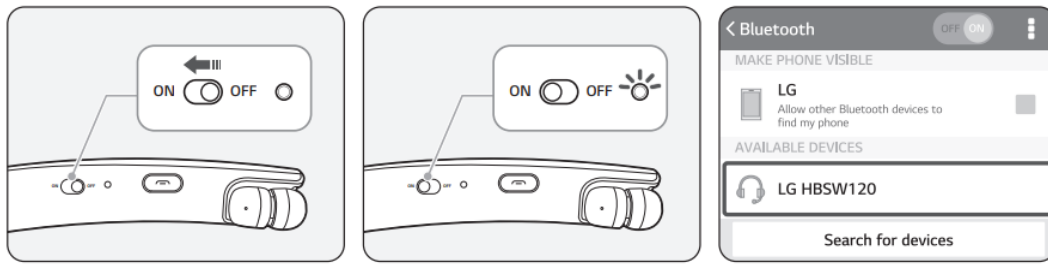

1. Slide the Power switch toward the ON position to turn on power.
2. The blue Indicator lamp turns on and HBS-W120 switches to Search mode.
3. From the mobile phone or device list, select LG HBSW120 to connect.
4. A voice message will indicate that the connection is completed.
5. Use the same process to pair HBS-W120 with other devices.

Connecting Manually (connecting to other devices or reconnecting)

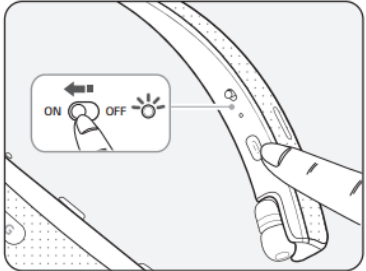
	<ol style="list-style-type: none">1. Press and hold the Call button and slide the Power switch to the ON position to turn it on.2. The blue Indicator lamp turns on and HBS-W120 switches to Search mode.3. Select LG HBSW120 from the device list to connect.
--	--

Multiple Connections

HBS-W120 can be connected to two devices like a mobile phone and a PC, etc., and used on them simultaneously.

An additional device can be connected while HBS-W120 is connected to one device.

1. Press and hold the Call button and slide the Power switch to the ON position to turn it on.
2. The blue Indicator lamp turns on and HBS-W120 switches to Search mode.
3. From the mobile phone or device list, select LG HBSW120 to connect.
4. A voice message will indicate that the connection is completed. This device becomes the "Main Connected Device."
5. Try to connect to HBS-W120 using a previously connected device. This device becomes the "Sub Connected Device."

NOTE: If the HBS-W120 is simultaneously connected to two devices, the last connected device becomes the Main Connected Device. The main functions work based on the Main Connected Device.



Automatic Reconnection



If you turn on HBS-W120, it automatically connects to the previously connected device (Main Connected Device or Sub Connected Device). (If the product cannot find the device, it switches to Search mode.)

If the product does not automatically connect to the device you want, search HBS-W120 in the device you want to connect to and connect it manually.

Dual Play

You can connect two HBS-W120 headsets to listen to the same music.

1. Connect the first HBS-W120 to your mobile phone or device.
2. Press and hold the Next () button and Play/Pause button of the first HBS-W120 simultaneously for more than one second. (This HBS-W120 becomes the Master headset.)
3. Press and hold the Previous () button and Play/Pause button of the second HBS-W120 simultaneously for more than one second. (This HBS-W120 becomes the Slave headset.)
4. An alert will indicate the connection status once the two HBS-W120 headsets are connected.

To disconnect Dual Play, press the Previous () button or the Next () button and the Play/Pause button simultaneously for at least one second.

NOTE:

- Dual Play supports both Android and iOS.
- The music playback functions can only perform in the Master headset while Dual Play is activated. (Except Equalizer Mode Change and volume control)
- If the Master headset and Slave headset are disconnected during Dual Play and they later enter an environment in which they can reconnect, they will automatically attempt a Dual Play connection.
- Multi-connection is not available during Dual Play

Wired connection (audio input terminal)

When the headset is turned on, use a wired connection through the audio input terminal to play music through speakers.

NOTE:

- When wired audio is connected, the Dual Play connection and the Bluetooth connection will be cut. The audio cable is purchased separately and is not provided when purchasing the product
- When the audio cable is disconnected, an automatic connection is established with the most recently connected device. (If no device is found, Search mode is activated.)
- Earphones mode is unavailable when the audio cable is connected.
- Use a portable 3.5 mm audio cable.

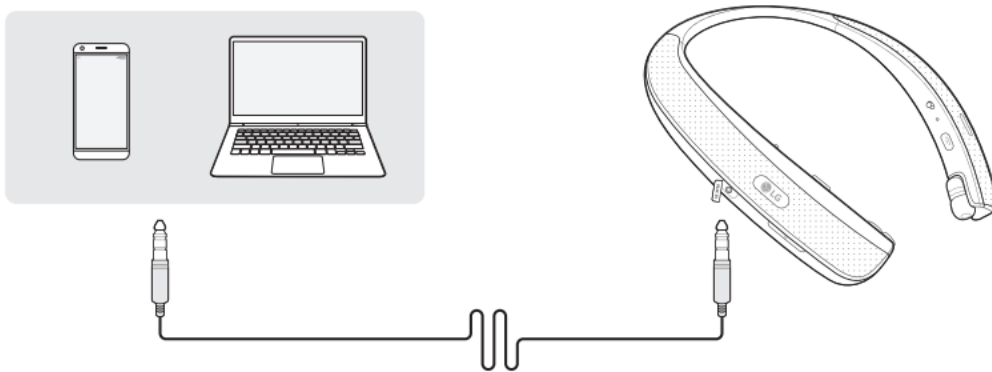

Pairing with TV and other devices (tablet, notebook PC, etc.)

You can connect and use HBS-W120 with TV and other devices that support the Bluetooth function.

For details on how to connect, refer to the user manual supplied with the product.

Compatible with TV and other devices

Compatible with Bluetooth enabled devices (Smartphone, Tablet and Laptops).

Compatible with Bluetooth audio enabled LG Smart TV's running WebOS, manufactured from 2015 onward. For other Smart TV compatibility, please consult with the TV manufacturer.



Battery Charging and Alerts

Open the Charging port cover and connect your charger to the Charging port.

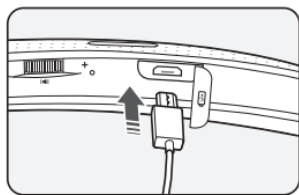

Indicator Lamp	Red	Purple	Blue
Battery Status	Charging	80%	Completed

Press and hold the Previous (◀) button for a few seconds to check the battery status using the voice prompt and the Indicator lamp.

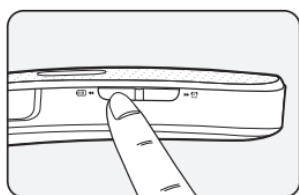

Battery Status	Sufficient	Normal	Insufficient
Indicator Lamp	Blue flashes three times	Purple flashes three times	Red flashes three times

Indicator Lamp

HBS-W120 Status	Description
Power On	The blue Indicator lamp flashes four times.
Power Off	The blue Indicator lamp flashes four times.
Bluetooth Search Mode	The blue Indicator lamp is on.
Connected to a Device	The blue Indicator lamp flashes once every five seconds.
Dual Play Search Mode	Master: The green Indicator lamp flashes. Slave: The green Indicator lamp is on.
Connected to Dual Play	Master/Slave: The green Indicator lamp flashes once every five seconds.

Mobile Calling Functions

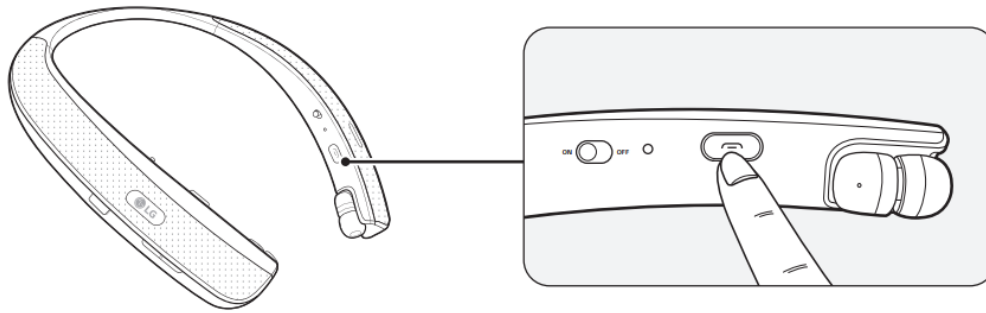

Function	Status	Description
Receiving a Call/ Hanging Up	Accepting a Call	Briefly press the Call button.
Making a Call	Standby Mode	If you make a call using a mobile phone, the call is automatically connected to HBS-W120
Redial	Standby Mode	Press and hold the Call button for one second to dial the last number you called.
Voice Dial	Standby Mode	Briefly press the Call button
Switching Calls	Call in Progress	Briefly press the Play/Pause button twice. (Every time you press this button, the call switches to the mobile phone or HBS-W120.)
Call in Progress Accepting Another Call	Call in Progress	Press and hold the Call button for one second to accept another call while on the phone. The existing call switches to call waiting status. Press and hold the Call button again for one second to switch back to the previous call.
Rejecting a Call	Accepting a Call	Press and hold the Call button for two seconds.

NOTE

- The Voice Dial and Redial functions work on the “Main Connected Device” or on the device on which you made the last call. (The Voice Dial and Redial functions may work differently depending on the mobile phone being used.)

- Some features may not be supported depending on the connected device.

Playing Music

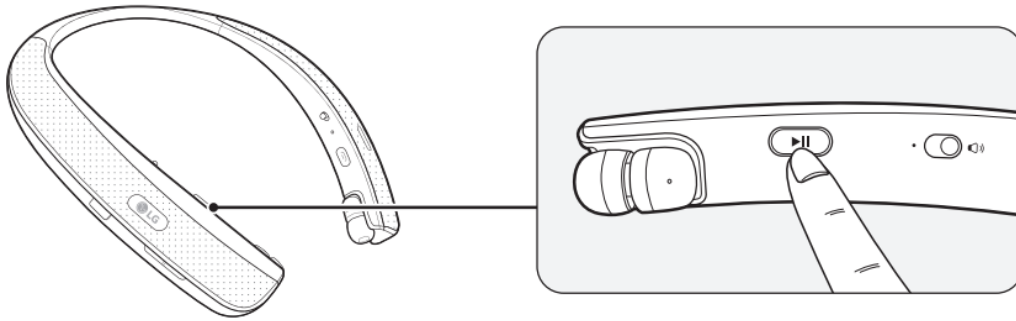

Function	Status	Description
Playing Music	Standby Mode	Briefly press the Play/Pause button.
Pause	Music in Play	Briefly press the Play/Pause button.
Play Previous/ Next Song	Music in Play	Briefly press the Previous (◀◀) button or Next (▶▶) button
Fast Rewind/ Forward	Music in Play	Press and hold the Previous (◀◀) button or Next (▶▶) button until you reach the desired part
Mute	Music in Play	Briefly press the Volume control wheel/button twice. Briefly press the Volume control wheel/button twice again to turn off Mute
Equalizer Mode change	Music in Play	Press and hold the Volume control wheel/button to change the mode in the following order: Bass (default) > Normal (general) > Treble (emphasis on high notes) NOTE: The Vibration Speaker operates depending on the set equalizer mode.

NOTE:

- To change the music player when multiple devices are connected, stop the current music in play and play the music on the desired device.
- Some features may not be supported depending on the connected device

Switching Music Players

If you stop the current music in play, and then play music on either of the two connected devices, HBS-W120's music playback and control change to those of such device.

Setting up the Vibration Speaker (Wearable Bass™)

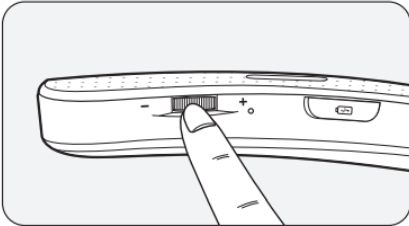
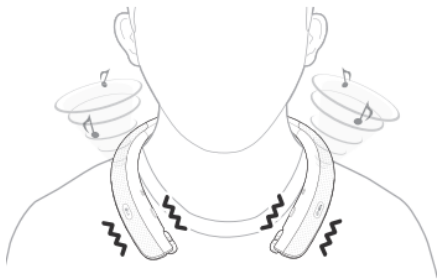
	<p>The strength of the bass and vibration is adjusted in stages depending on the equalizer mode.</p> <p>Press and hold the Volume control wheel/button while playing audio (music) to change the equalizer mode.</p> <p>Bass (default) > Normal (general) > Treble (emphasis on high notes)</p>
	<p>Put on the product and turn on the Vibration Speaker to enjoy immersive surround sound and vibrations.</p>

Out of Range

If the device connected to HBS-W120 is out of effective communication range (33 feet/10 meters), the communication signal becomes weak and the communication is lost.

If the device comes back within the effective communication range, the product automatically reconnects to HBS-W120.

If the device is not automatically reconnected, press the Call button on HBS-W120 to connect to it manually.



If a device that is not in use moves out of range in multi-connection mode, automatic reconnection function is not supported.







LG Tone & Talk™

Search for “LG Tone & Talk” in Google Play™ store or scan the QR code on the right to install LG Tone & Talk.

HBS-W120 can use the following functions in LG Tone & Talk:



NOTE: The LG Tone & Talk feature can only be used one function at a time. LG Tone & Talk can be used on Android™ smartphones.

Function	Description
Current Time Alert	<ol style="list-style-type: none"> 1. Go to Tone & Talk and select Current Time Alert. 2. Press and hold the Next () button for one second.
Voice Memo	<ol style="list-style-type: none"> 1. Go to Tone & Talk and select Voice Memo. 2. Press and hold the Next () button for one second.
Using Speed Dial to Make a Call	<ol style="list-style-type: none"> 1. Go to Tone & Talk and select a speed dial contact. 2. Briefly press the Call button twice. (The number should be specified in the Tone & Talk app.)
Using Favorites to Make a Call	<ol style="list-style-type: none"> 1. Go to Tone & Talk and select a favorite contact. 2. Briefly press the Call button twice. 3. Press and hold the Previous () button or Next () button for one second to select a number. 4. Briefly press the Call button twice.
Using Call History to Make a Call	<ol style="list-style-type: none"> 1. Go to Tone & Talk and select a number from the Call History. 2. Briefly press the Call button twice. 3. Press and hold the Previous () button or Next () button for one second to select a number. 4. Briefly press the Call button twice.
Changing the Voice Prompt Language	<ol style="list-style-type: none"> 1. Go to Tone & Talk and select Headset settings. 2. Select Voice prompt language to change the language.
Changing Equalizer Mode	You can change the equalizer mode through the app.

Bass (default) > Normal (general) > Treble (emphasis on high notes)

NOTE:

- The Current Time Alert and the Voice Memo features cannot be used at the same time.
- When making selections in the Tone & Talk app, you can only use one function at a time.
- The Voice Memo feature may not be supported on some devices.

Troubleshooting

Problem	Solution
The power does not turn on	Check the battery level and charge it.
Cannot make a call with HBS-W120	If the mobile phone does not support headset and hands-free function, you cannot use the calling features. Check the battery level and charge it.
Cannot register HBS-W120 to the mobile phone	<p>Check whether HBS-W120 is turned on.</p> <p>Check whether HBS-W120 is in Search mode.</p> <p style="padding-left: 40px;">- If you press and hold the Call button while you slide the Power switch to the ON position to turn the power on, the HBS-W120 switches to Search mode.</p>
The sound is low	Control the sound level of the device connected to HBS-W120.
Connection to TV is lost, or TV cannot be connected	<p>Check whether the TV is turned off or switched to sleep mode.</p> <p>If you turn off the TV and turn it on again, you will need to reconnect it (refer to the user manual provided with the TV)</p>
Dual Play cannot be connected	<p>Please check your battery level and charge the battery.</p> <p>Refer to the Connecting Quickly/Connecting Manually instructions and connect your HBS-W120 to your mobile phone or device.</p> <p>Position two HBS-W120 headsets within 1 foot (30 centimeters) of each other.</p> <p>Refer to the Dual Play connection instructions to connect the two HBS-W120 headsets.</p> <p>NOTE: Connections are only supported between two identical HBS-W120 models.</p>

Specifications and Features

Item	Comments
Bluetooth Specifications	V 4.2 (Headset/Hands-Free/A2DP/AVRCP)
Battery	3.7 V / 445 mAh* 2, lithium-ion polymer
Standby Time	Up to 61 days*
Talk Time	Up to 40 hours (16 hours when in Speaker mode)*
Music Play Time	Up to 35 hours (6 hours when in Speaker mode, Based on 50% volume level)*
Charging Time	Less than 2.5 hours
Rated Input Voltage	DC 4.75 ~ 5.3 V, 700 mA
Operating Temperature	-10°C (+14°F) ~ +50°C (+122°F)
Dimension/Weight	7.6" (W) X 6.9" (L) X 0.7" (H) / 4.4 oz
Operating Frequency	2402 MHz to 2480 MHz

*Duration of use may vary depending on the connected mobile device, features being used, settings, signal strength, operating temperature, frequency band, and other methods of use.

NOTE: When using the speaker mode, the usage time may vary depending on the volume size set by the user

Warning

This content is compiled from multiple sources and is provided for reference purposes only. It may not be complete or fully applicable to all situations. If you are unable to resolve your issue, please contact the product manufacturer or an authorized service provider for official support.