

# INSTRUCTIONS Vacuum Cleaner

## GETTING TO KNOW YOUR SHARK® LIFT-AWAY SPEED

WELCOME! Congratulations on your purchase. Use this Owner's Guide to learn about your new vacuum's great features

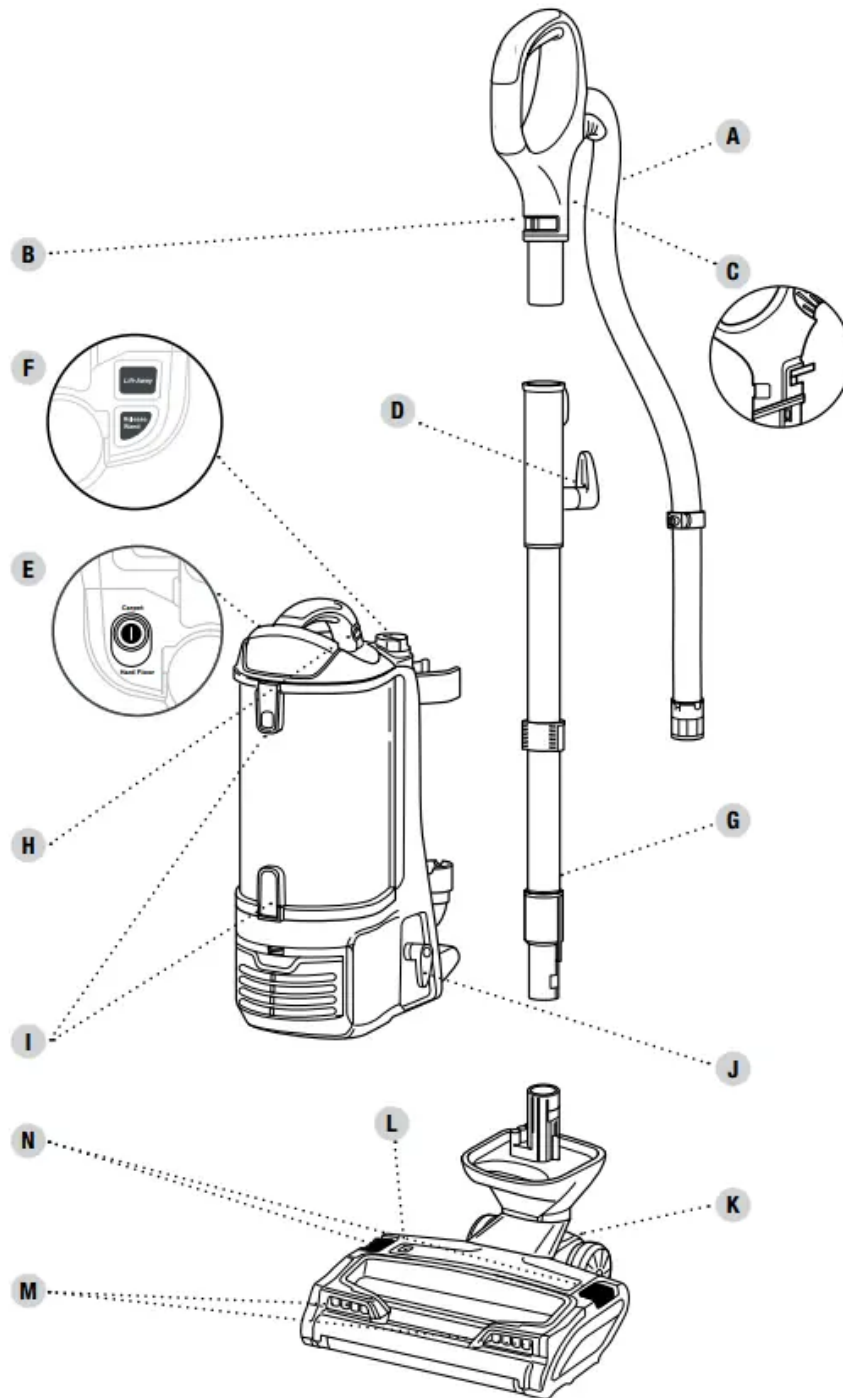

### PARTS

A. Hose



- B. Suction Control
- C. Handle Release Latch
- D. Upper Cord Hook
- E. Power/Surface Selector
- F. Lift-Away® Button/Release Wand Button
- G. Wand
- H. Dust Cup Release Latch
- I. Dust Cup Emptying Buttons
- J. Lower Cord Hook
- K. Motorized Floor Nozzle
- L. Brushroll Indicator Light
- M. Headlights
- N. Brushroll Garage Access Buttons

## ASSEMBLING YOUR VACUUM



Cord Care: Rotate hook down to unwind cord.

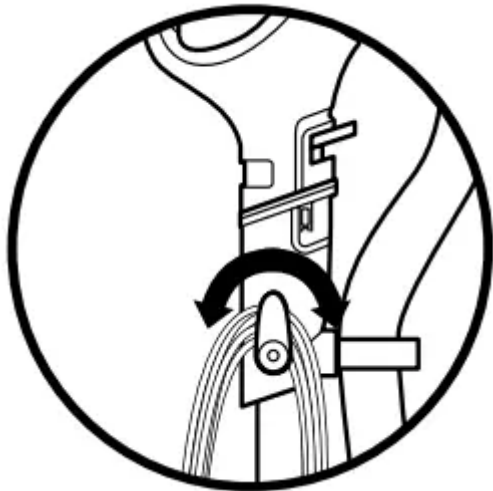

To store, wrap cord around hooks.

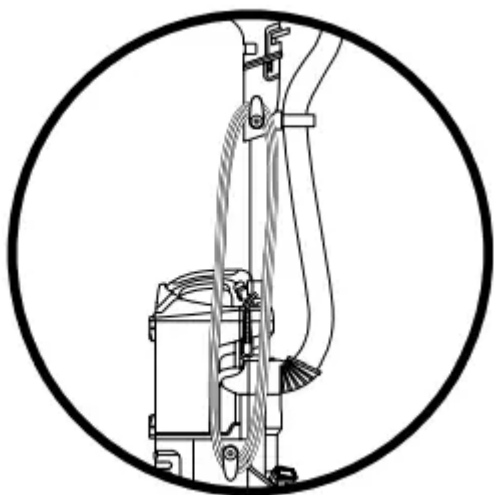

Use cord clip located on the side of wand to hold cord in place while vacuuming.

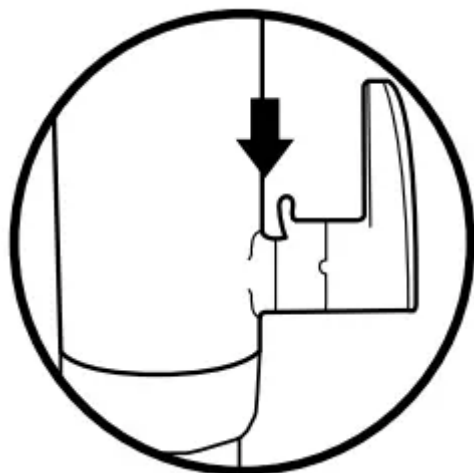

**STEP 1**

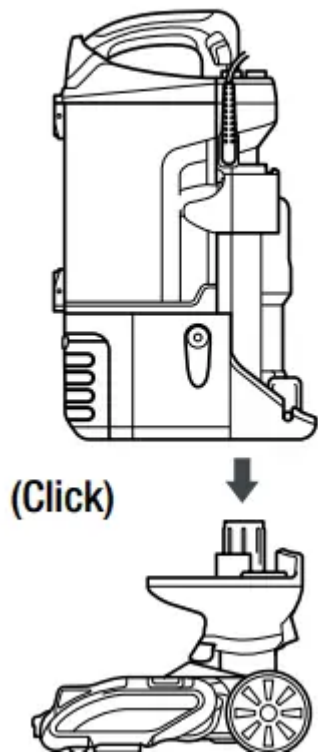

1. Place pod on nozzle

**STEP 2**



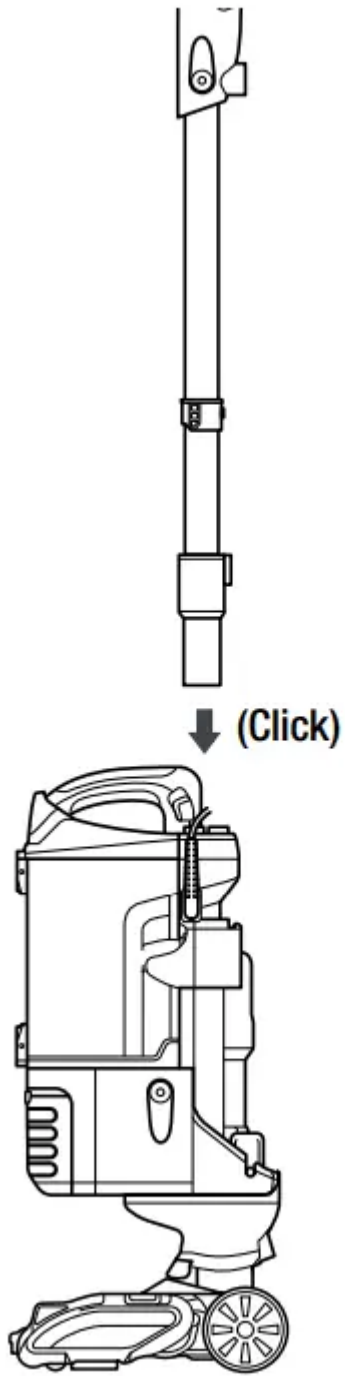

2. Wand clicks into pod.

**STEP 3**



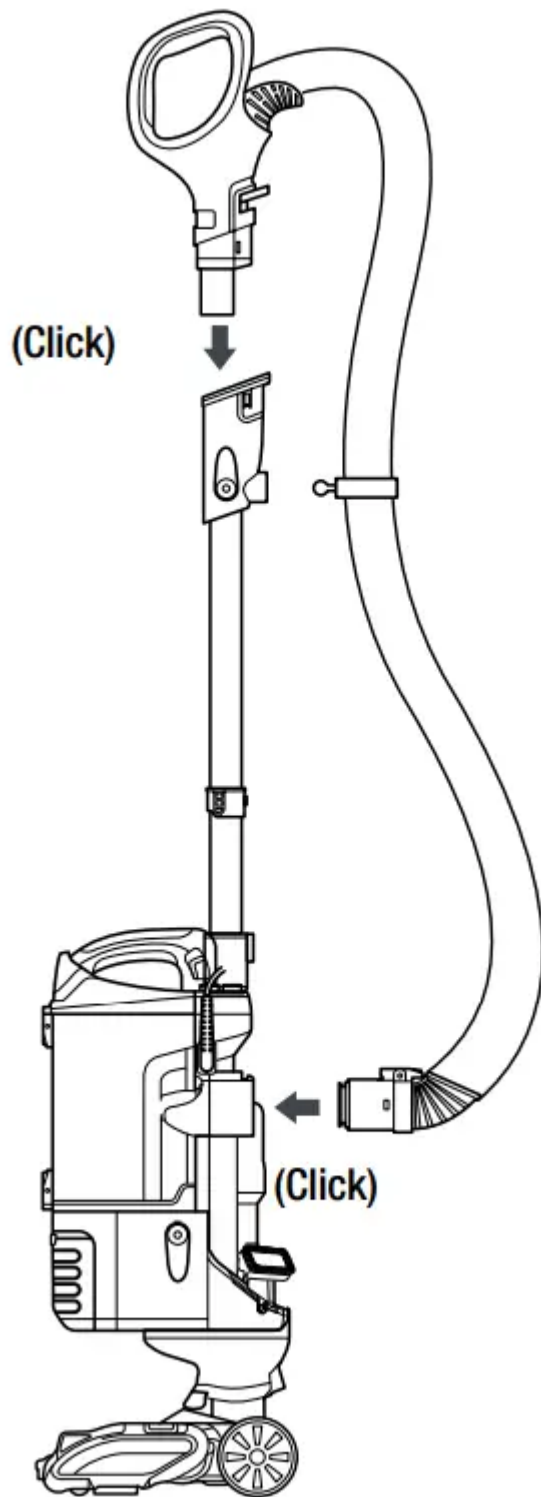

3. Handle clicks into top of wand, and hose connects to pod with a click.

**STEP 4**



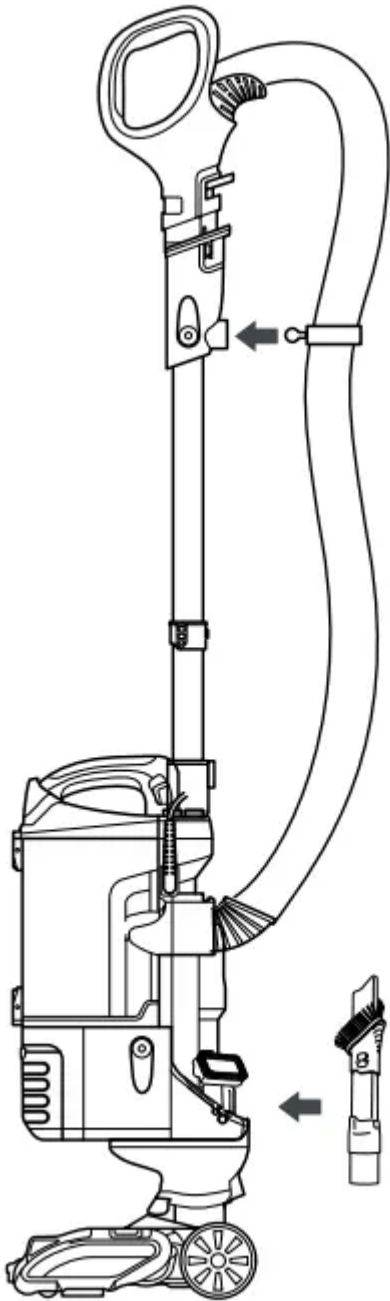

4. Tools sit on holders. Clip hose to wand

## USING YOUR VACUUM IN UPRIGHT MODE

### BRUSHROLL INDICATOR LIGHT

- GREEN: Brushrolls spinning.
- RED: Brushroll jam.
- NO LIGHT: Vacuum is off

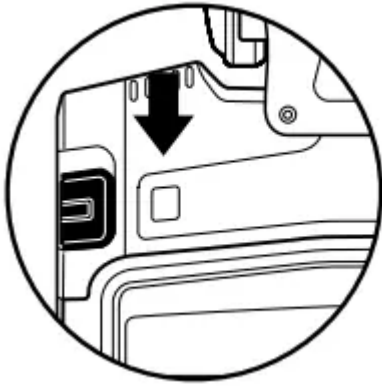

**STEP 1**

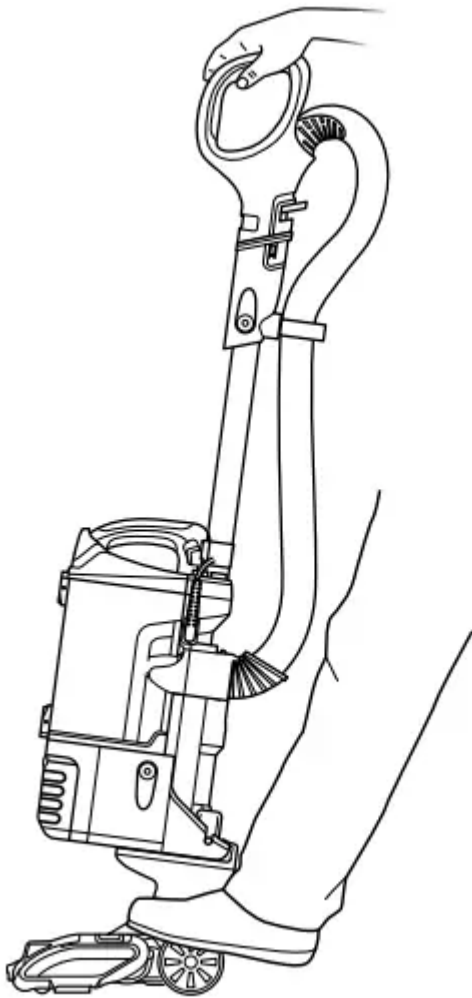

1. Plug in cord, tilt handle back

**STEP 2**

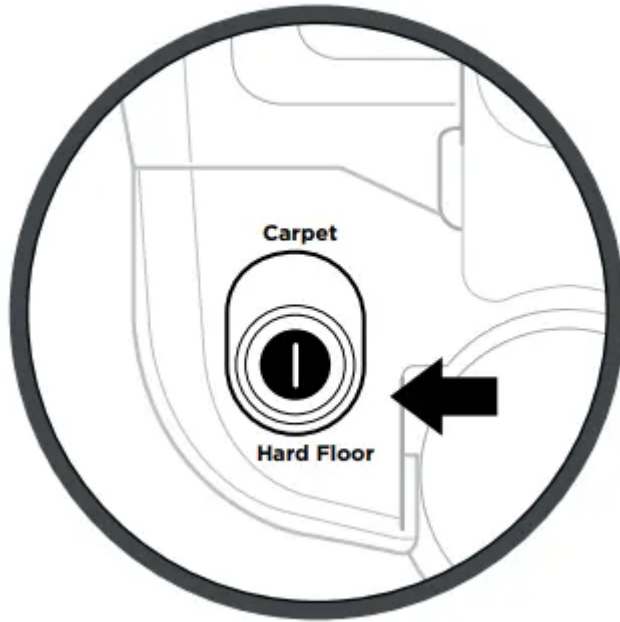

### HARD FLOOR SETTING

2. Slide selector to Hard Floor, press button for power. Brushrolls will spin slowly

### STEP 3

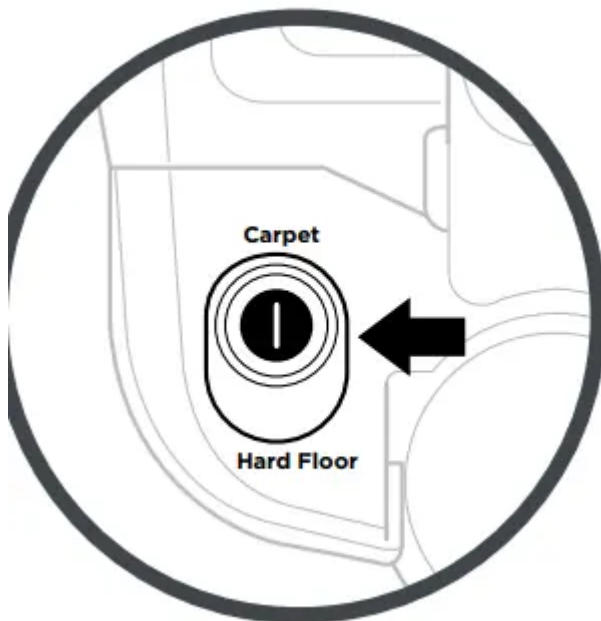

### CARPET SETTING

3. Slide selector to Carpet, press button for power. Brushrolls will spin faster. NOTE: For deep cleaning per ASTM F 608 (embedded dirt in carpets) please ensure Power/Surface Selector is set to Carpet setting, with the suction control closed

## USING YOUR VACUUM IN ABOVE-FLOOR MODE

**THE BENEFITS OF SUCTION CONTROL:** Suction Control is a way for you to adjust suction power when you are using different tools or vacuuming different surfaces. For example, if you are feeling resistance while vacuuming thick carpet or upholstery, sliding the Suction Control to MIN will help reduce your push/pull effort.

### STEP 1

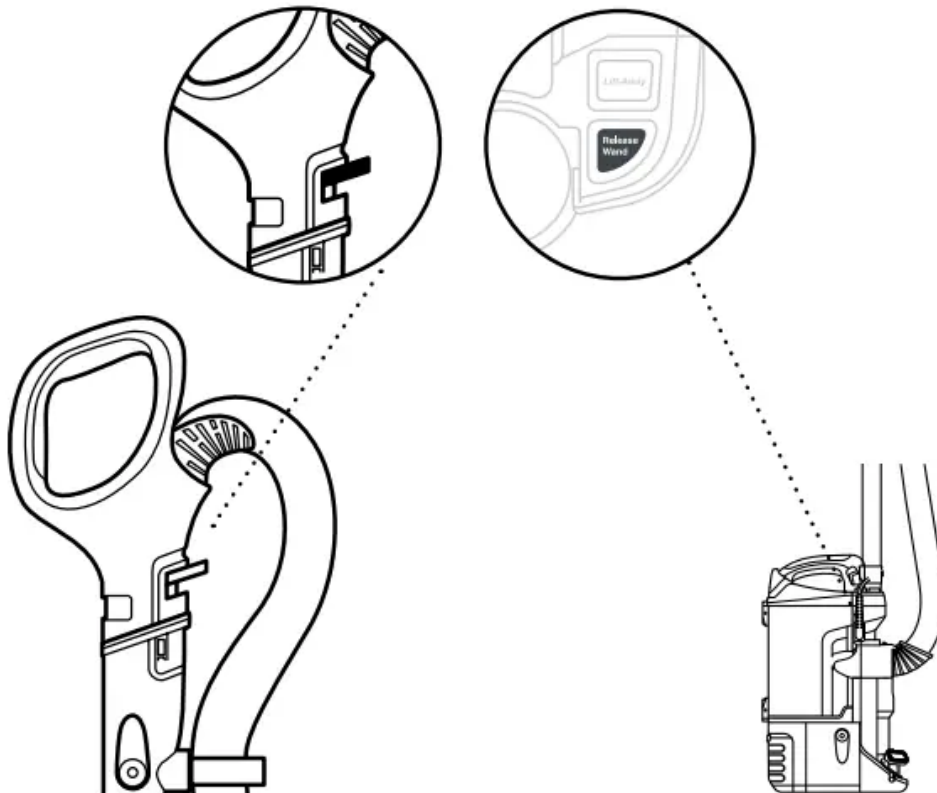

1. To clean with handle only, press latch to remove.

**OR:** To clean with more reach, press button on pod to release wand.

### STEP 2

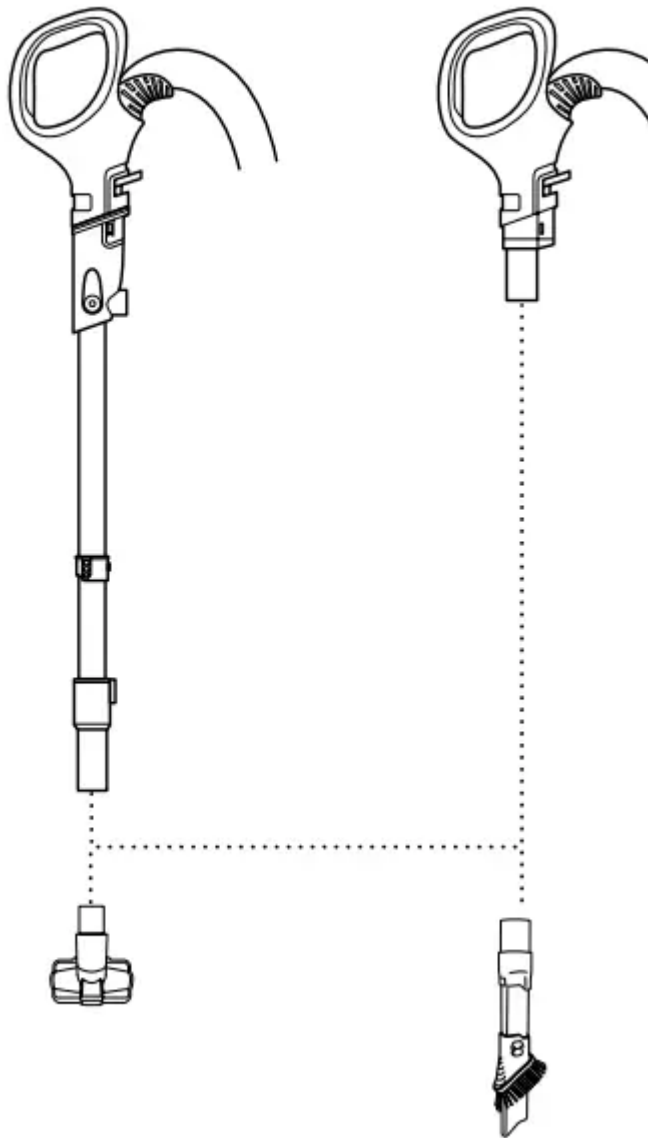

2. Attach desired accessories to the wand or handle.

**STEP 3**



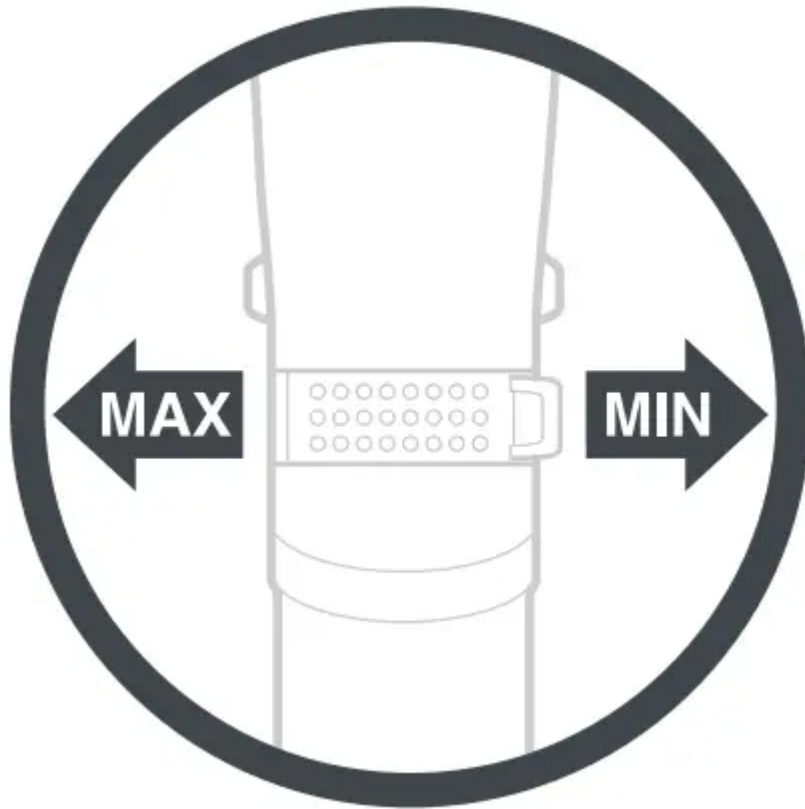

3. Suction Control is located on handle. To decrease suction and reduce resistance, slide toward MIN. Slide toward MAX to increase.

## USING YOUR VACUUM IN LIFT-AWAY® MODE

**WHAT IS LIFT-AWAY?** Our Lift-Away feature allows you to remove the pod from the floor nozzle to easily clean stairs and above-floor areas with accessories.

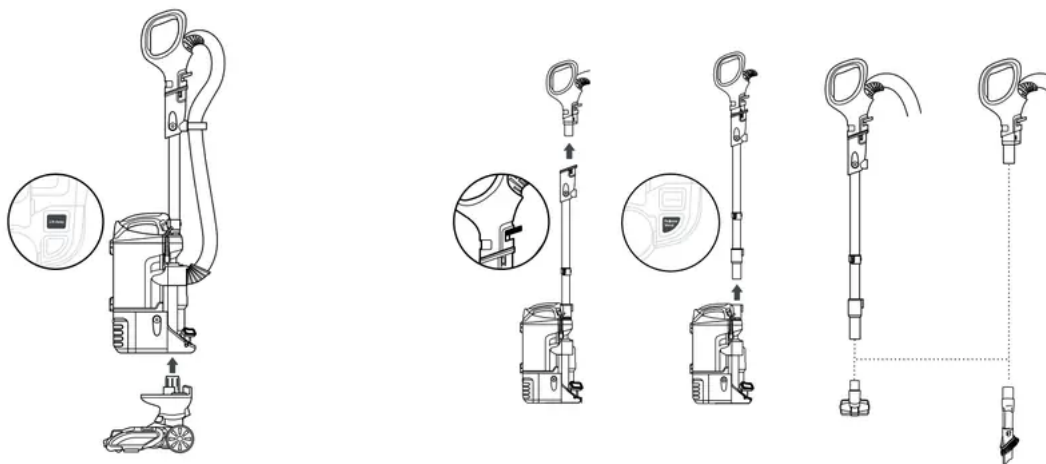

## LIFT-AWAY CLEANING

1. Press Lift-Away button to release pod.
2. Press latch to remove handle, or press button to release wand.
3. Attach accessory to handle or wand.

## COMPATIBLE ACCESSORIES

- There are a variety of accessories that are compatible with this vacuum series.
  - Your Quick Start Guide shows the select accessories included with your vacuum. To purchase additional accessories, go to [sharkaccessories.com](http://sharkaccessories.com)
- A. Pet Multi-Tool: A single tool that offers two ways to battle tough pet messes: first, a stiff bristle brush removes stuck-on debris. Then take off the bristles to reveal an upholstery tool for cleaning stubborn pet hair
- B. Duster Crevice Tool: Two cleaning tools in one. The crevice tool provides extended reach into small spaces, while the dusting brush cleans a multitude of surfaces.
- C. Pet Power Brush: Designed to remove pet hair and ground-in dirt from carpeted stairs and upholstery.

**A**

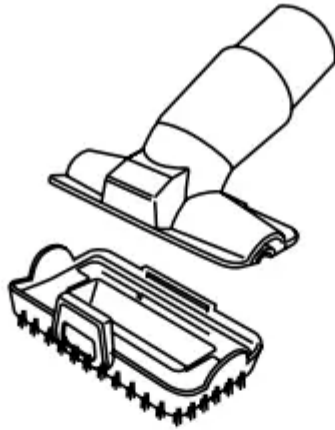

**B**

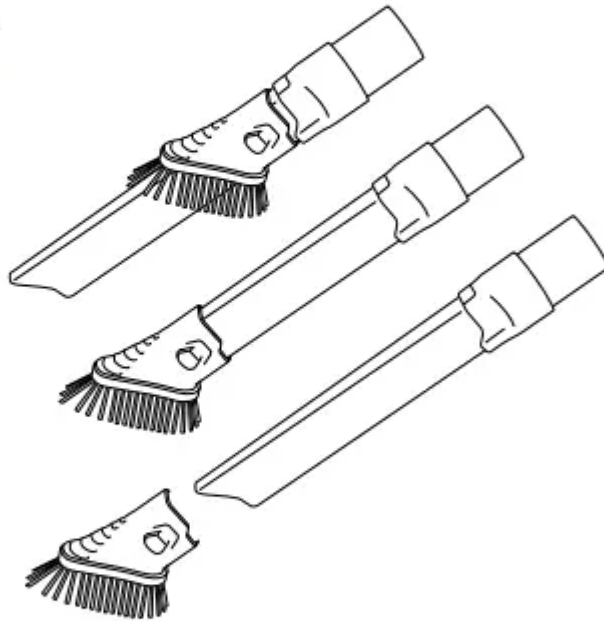

**C**





## MAINTENANCE

### RECOMMENDED FILTER CLEANING SCHEDULE:

- Pre-Motor Filter Kit (Foam & Felt): XFF600 Clean every 3 months.

- Post-Motor Filter (HEPA): XHF600 Clean once a year.
- To keep your vacuum's suction power optimal, follow these instructions. Make sure unit is off and cord is unplugged.

## EMPTYING THE DUST CUP

- Hand wash filters only with water to prevent damage from cleaning chemicals. Allow ALL filters to air-dry completely before replacing them in the vacuum to prevent liquid from being drawn into electric parts.
-  **IMPORTANT:** DO NOT use soap when cleaning the filters. DO NOT scrub HEPA filter material.
-  **NOTE:** Clean the dust screen inside the dust cup as required.

### STEP 1

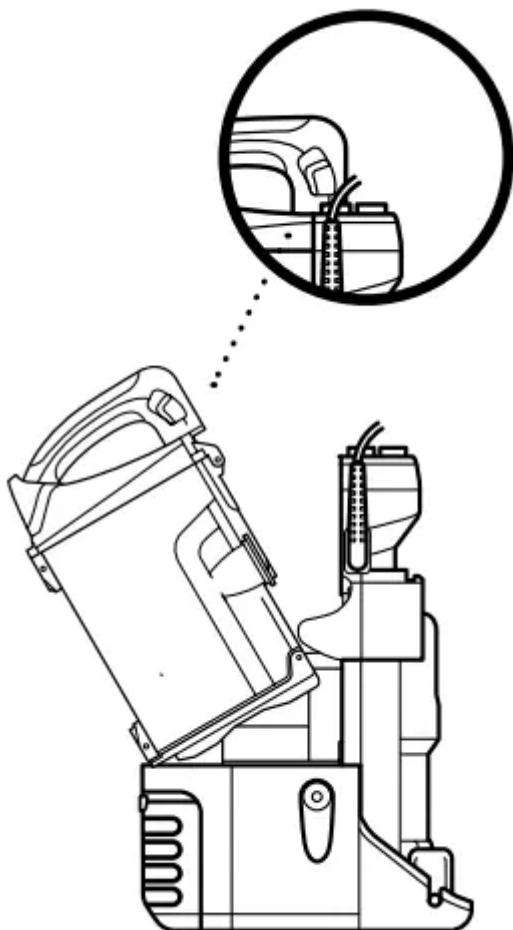

1. Empty dust cup when debris reaches MAX fill line. Remove by pulling up on latches on dust cup handle.

## STEP 2

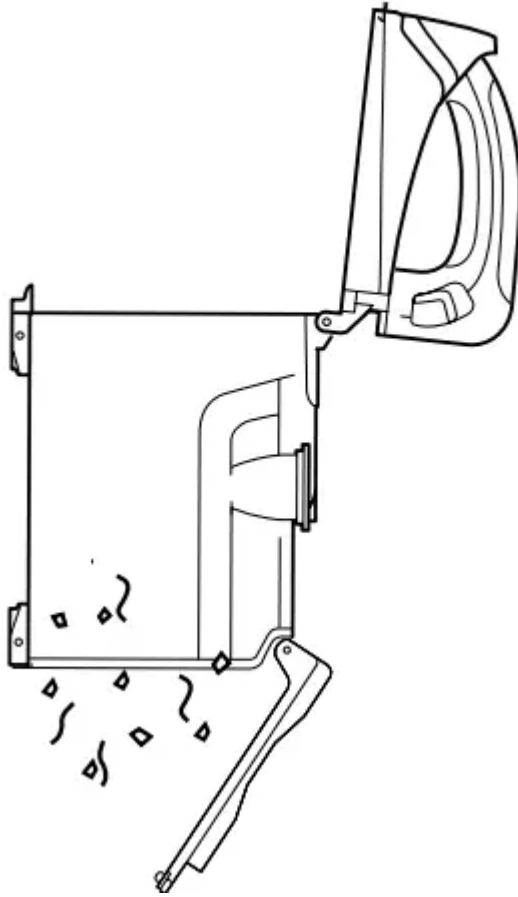

2. Hold dust cup over trash and press bottom release latch. Turn dust cup over and press top release latch to empty

**FOAM FILTER**



**FILTER FRAME**

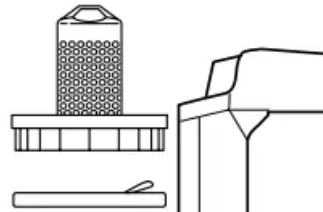

**FELT FILTER**

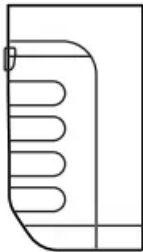

**HEPA**

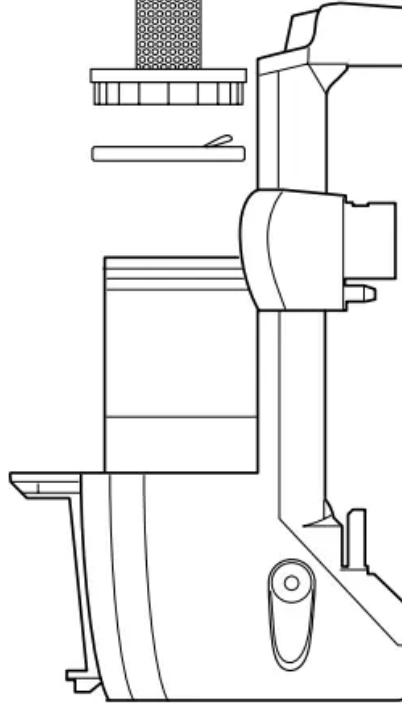

## CLEANING THE FILTERS

1. Pre-Motor (foam and felt): With the dust cup removed, take out the foam and felt filters and rinse with water. Let filters air-dry completely before reinstalling. Tap loose dirt off filters between washes as needed.
2. Post-Motor (HEPA): To access the HEPA filter, reach under the grill, pull the latch forward, and pull the grill away from the vacuum. Remove and rinse the HEPA filter. Let filter air-dry completely before reinstalling.



**WARNING:** To reduce the risk of shock and unintended operation, turn power off and unplug unit before servicing.

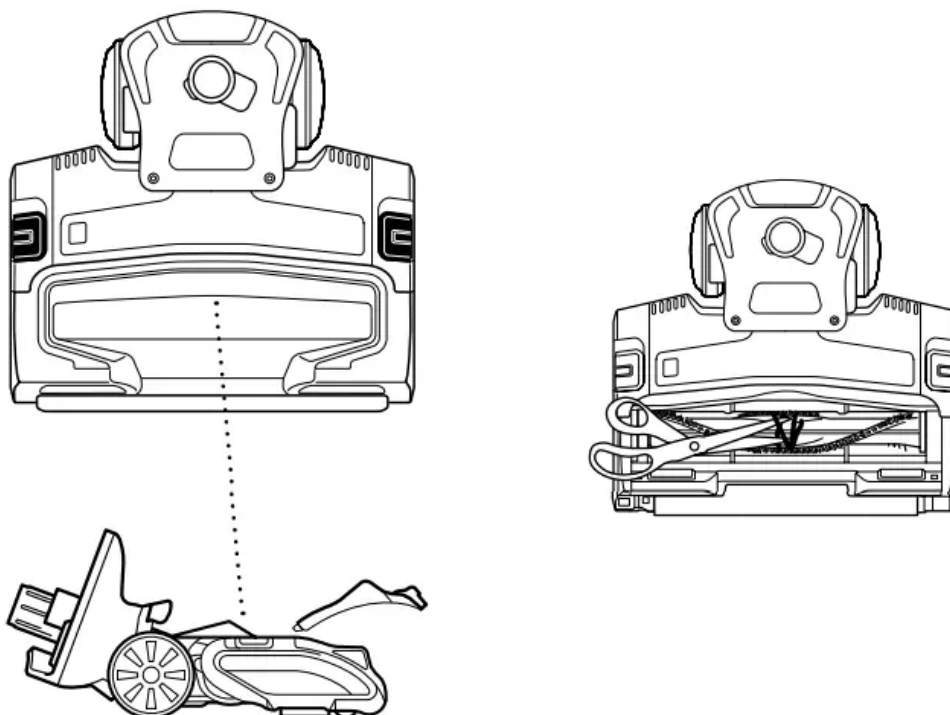

## MAINTAINING THE BRUSHROLL

1. To open garage, slide back both access buttons, then lift off lid. Use scissors to remove debris from brushroll.
2. To reinstall lid, insert tabs into slots. Press down on both sides of lid until it clicks into place. If headlights flash, press down on both sides of lid until it is closed completely.

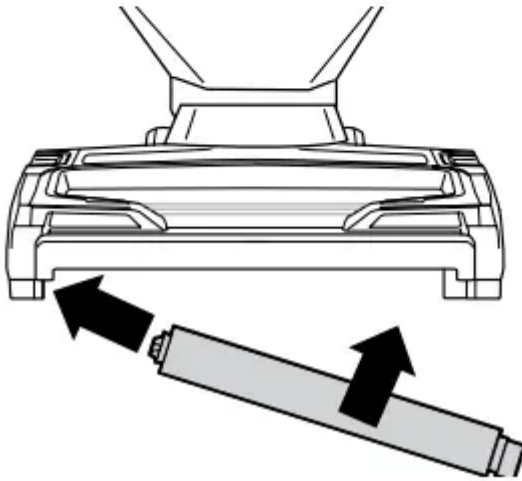
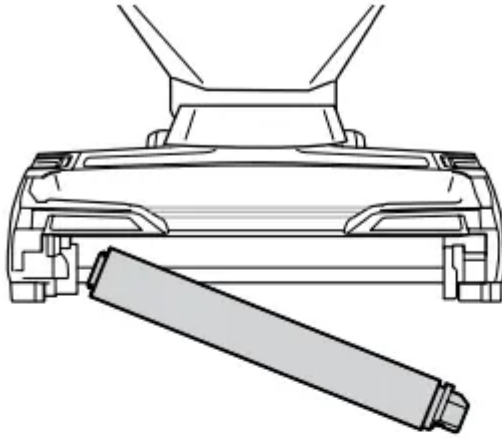

## MAINTAINING THE SOFT ROLLER

1. To open garage, slide back both access buttons, then lift off lid. Lift out Soft Roller by the PULL tab. Clear debris from roller and roller housing.
2. Wash the Soft Roller as needed, using only water. Air-dry completely for at least 24 hours before reinstalling.
3. Reinstall lid. See Step 2 of “Maintaining the Brushroll.”

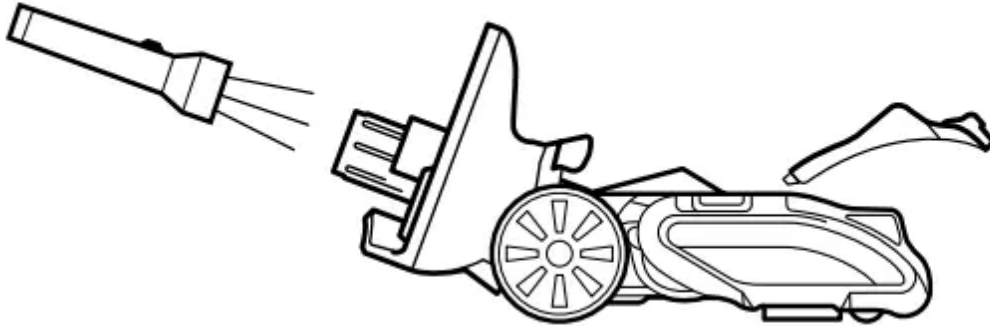

## CHECKING THE NOZZLE FOR BLOCKAGES

1. Tilt neck of motorized floor nozzle back to straighten the airway. Open the brushroll garage lid, and clear away any blockages.

## TROUBLESHOOTING GUIDE

**WARNING:** To reduce the risk of shock and unintended operation, turn power off and unplug unit before servicing.

**Vacuum is not picking up debris. No suction or light suction. (Refer to Maintenance section for more information.)**

- Check filters to see if they need cleaning. Follow instructions for rinsing and drying the filters before reinstalling in the vacuum.
- Dust cup may be full; empty dust cup.
- Check hose, hose connections, nozzle, and accessories for blockages; clear blockages if required.
- Remove any string, carpet fibers, or hair that may be wrapped around the brushroll.

**Vacuum lifts area rugs.**

- Turn off unit to disengage the brushroll.
- Suction is powerful. Take care when vacuuming area rugs or rugs with delicately sewn edges.
- To minimize suction, slide Suction Control toward MIN. See the Suction Control section for more information.

**Brushroll and/or Soft Roller does not spin or the Brushroll Indicator Light turns red.**

- If Brushroll Indicator Light on the floor nozzle turns red, the brushroll and/or Soft Roller have stopped spinning. Immediately turn off and unplug vacuum. Check hose, hose

connections, nozzle, and accessories for blockages. Clear any blockages, then plug in vacuum and press Power/Surface Selector.

- If Brushroll Indicator Light on the floor nozzle is green, the blockage has been successfully cleared. If the light is still red, please contact Customer Service at 1-800-798-7398.
- If nozzle headlights are flashing, this means the brushroll garage is not completely closed. Turn off and unplug the vacuum. Ensure the brushroll garage is locked by inserting the tabs on the lid into the slots, then pressing down on both sides of the lid until it clicks into place.
- With the power on, recline the handle, which will automatically turn on the brushrolls.

#### **Brushroll Garage will not close.**

- Make sure the Soft Roller was reinserted correctly and press down firmly on both sides of the garage lid until it clicks into place.

#### **Vacuum turns off on its own or Brushroll Indicator Light flashes red.**

- This vacuum is equipped with a motor-protective thermostat. If your vacuum overheats, the thermostat will automatically turn the suction motor off. Perform the following steps to restart the thermostat:
  1. Turn vacuum off and unplug it.
  2. Empty dust cup and clean filters (see Maintenance section).
  3. Check for blockages in hose, accessories, and inlet openings.
  4. Allow unit to cool for a minimum of 45 minutes.
  5. Plug in vacuum and turn it on.
  6. Restart the unit in either the Hard Floor or Carpet setting.

Note: If vacuum still does not start, contact Customer Service at 1-800-798-7398.

#### **Warning**

This content is compiled from multiple sources and is provided for reference purposes only. It may not be complete or fully applicable to all situations. If you are unable to resolve your issue, please contact the product manufacturer or an authorized service provider for official support.