

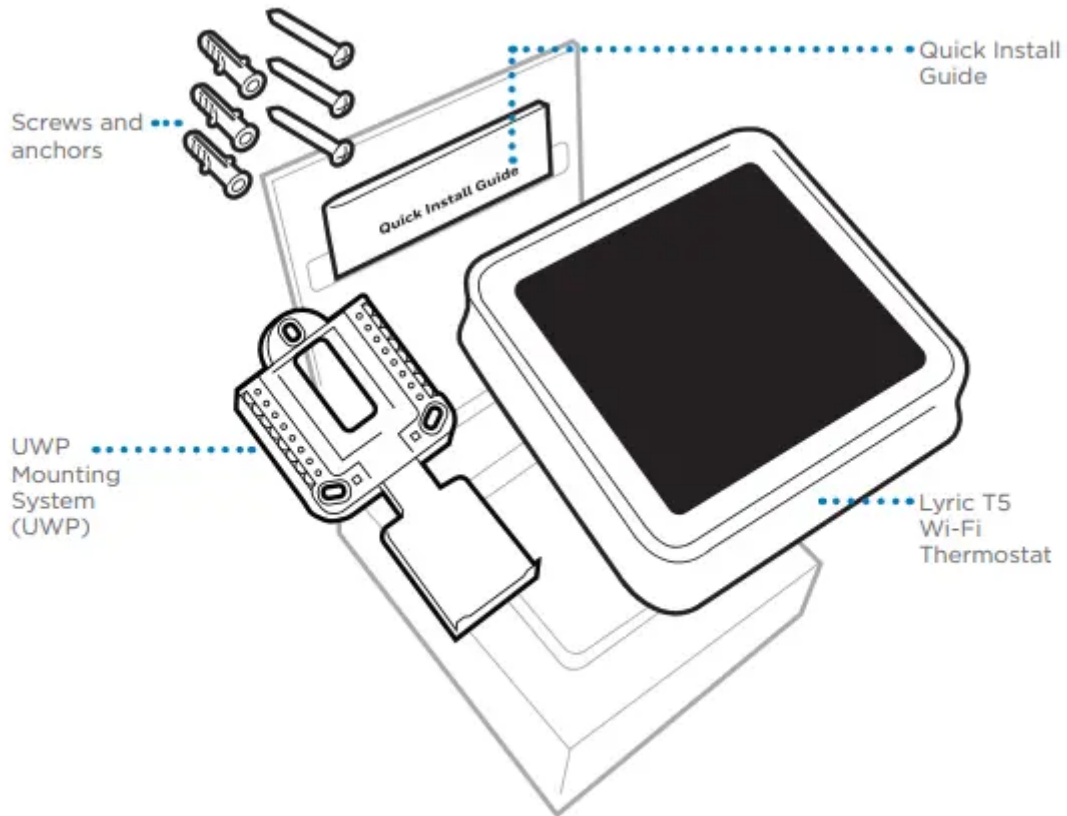

Quick Install Guide Thermostat

Included in your box:



Get the most from Lyric T5 Wi-Fi Thermostat

Multiple programming options that fit your lifestyle:

1.  Location-Based scheduling – The Lyric thermostat uses your smartphone's location to know when you're away, and saves you energy. Through geofence technology, it senses your return and helps make you comfortable upon arrival. You can always manually change your preset Home and Away temperature either on the thermostat or on the app.
2. Smart scheduling – Use a combination of geofencing and time scheduling to fit your busy, active lifestyle.
3. Time-Based scheduling – Program your thermostat for one week; each day (each day is a different schedule); Mon-Fri, Sat, Sun; or Mon-Fri, Sat-Sun. All days with four adjustable periods per day.
4. No scheduling – Control your comfort manually by adjusting temperature set points only.



Smart Alerts. Push notifications remind you of filter changes and warn you of extreme indoor temperatures.



Smart Response. Learns your heating and cooling system to deliver the optimal temperature at the right time.



Auto Change From Heat to Cool. Automatically determine if your home needs heating or cooling to provide maximum comfort.

Tools you will need:

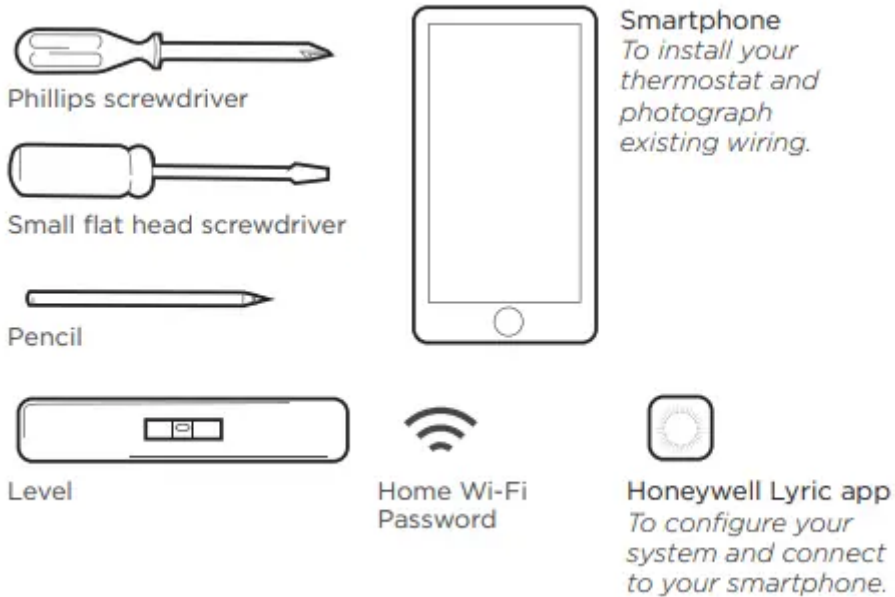

You may need:

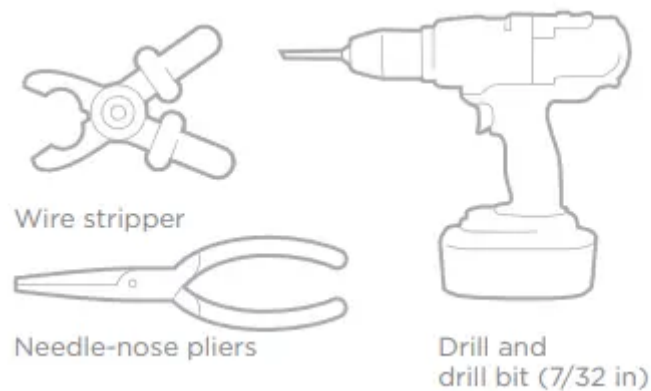

Compatibility

- Compatible with most heating, cooling, and heat pump systems
- Required: 24 VAC power ("C" wire)
- Does not work with electric baseboard heat (120-240V)
- Does not work with millivolt systems
- Does not support Universal Input (S terminals) for indoor and outdoor sensors
- Does not support Universal Relay (U terminals) for ventilation
- Android or iOS smartphone, tablet, or device

Removing your old thermostat

1 Turn power OFF: To protect yourself and your equipment, Turn off the power at the breaker box or switch that controls your heating/ cooling system.

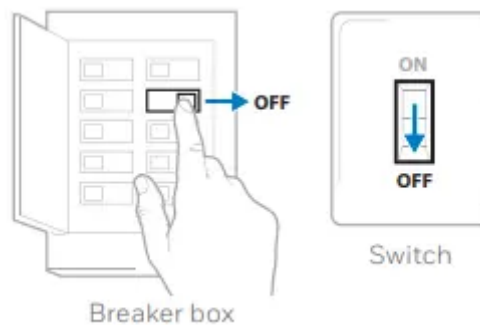

2 Check that your system is off: Change the temperature on your old thermostat. If you don't hear the system turn on within 5 minutes, the power is off. Note: If you have a digital thermostat that has a blank display, skip this step.



3 Remove your old thermostat from the wall plate: On most thermostats, you can take off the thermostat by grasping and gently pulling. Some thermostats may have screws, buttons, or clasps.



4 Make sure there are no 120/240V wires: Do you have thick black wires with wire nuts? Is your thermostat 120V or higher? If you answered yes to either of these questions, you have a line voltage system and the Lyric thermostat will not work

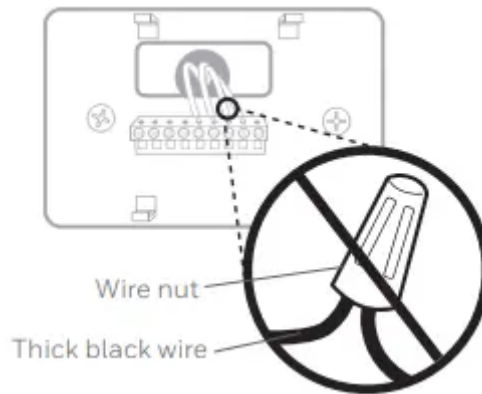

5 Take a picture of how your wiring looks right now: Be sure to include the letters next to the terminals where the wires are inserted. This will be a helpful reference when wiring your Lyric thermostat. Tip: If the color of your wires has faded or if 2 terminals have the same wire color, use the wire labels provided in the package to label each wire.



6 Remove any jumpers: A jumper connects one terminal to another terminal. It may look like a small staple or even a colored wire and must be removed before continuing. Use a screwdriver to release wires from terminal. The Lyric thermostat does not need jumpers.

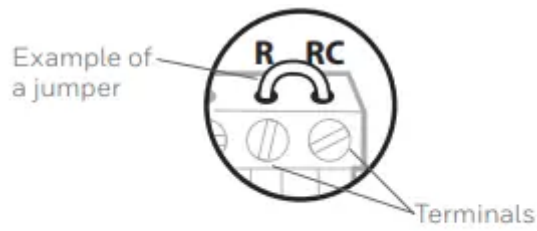

7 Record if you have wires in the following terminals: Do not include jumpers as a part of your count. The Lyric thermostat does not need jumpers.

Terminal	Wire Color
<input type="checkbox"/> R	_____
<input type="checkbox"/> RH	_____
<input type="checkbox"/> Rc	_____

8 Write down the color of the wires: Check mark the wires that are connected to terminals. Next to the check mark, write down the color of the wire. Do not include jumpers as a part of your count. Check all that apply (Not all will apply):

Terminal	Wire Color	Terminal	Wire Color
<input type="checkbox"/> Y	_____	<input type="checkbox"/> A or L/A	_____
<input type="checkbox"/> Y2	_____	<input type="checkbox"/> O/B	_____
<input type="checkbox"/> G	_____	<input type="checkbox"/> W2 or AUX	_____
<input type="checkbox"/> C	Required	<input type="checkbox"/> E	_____
		<input type="checkbox"/> W	_____
		<input type="checkbox"/> K	_____

S and U terminals are not supported with this thermostat.

9 Disconnect the wires and remove the old wall plate: Use a screwdriver to release wires from terminals. Tip: To prevent wires from falling back into the wall, wrap the wires around a pencil.



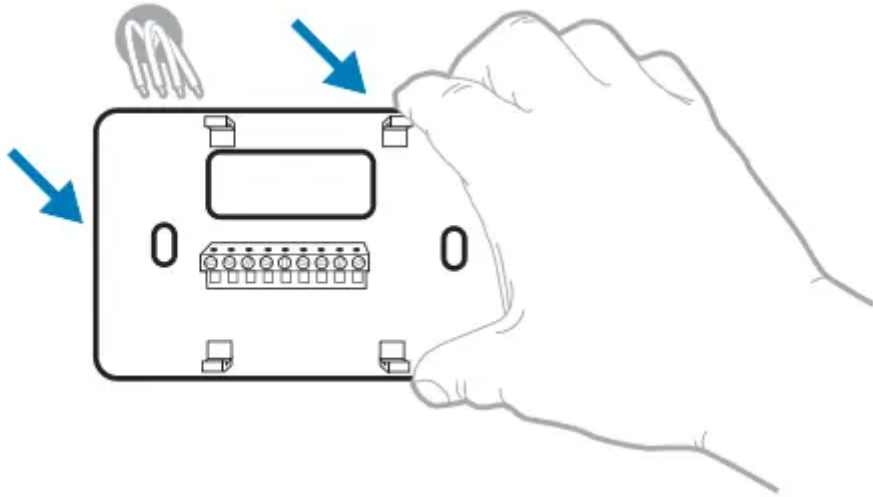

Installing your Lyric T5 Wi-Fi Thermostat

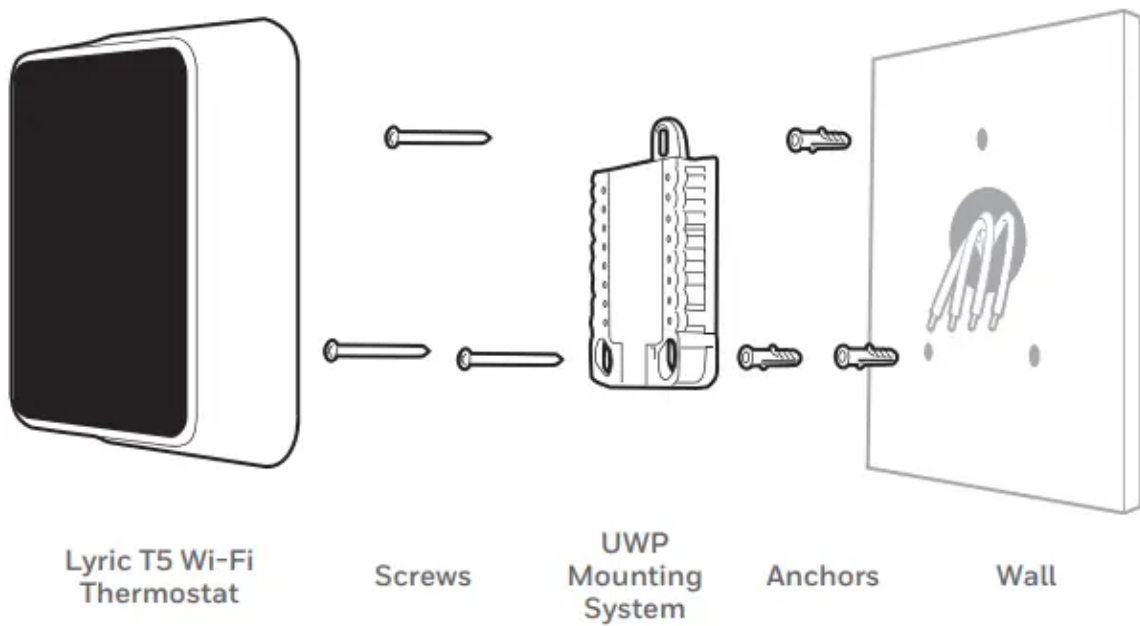

10 Bundle and insert wires through the UWP: Pull open the UWP and insert the bundle of wires through the back of the UWP. Make sure at least 1/4-inch of each wire is exposed for easy insertion into the wire terminals.

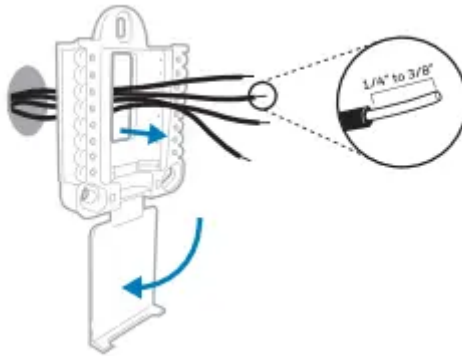

11 Insert the wall anchors It is recommended that you use the wall anchors included in the box to mount your thermostat. You can use the UWP to mark where you want to place the wall anchors.

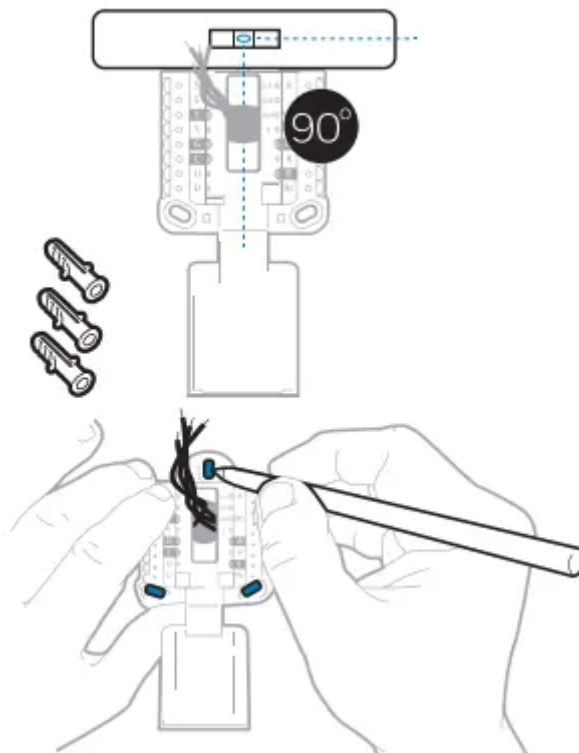

- Level the wall plate.
- Mark the location of the wall anchors using a pencil.
- Drill the holes.
- Insert wall anchors.
- Make sure anchors are flush with wall.

Tip: Use a 7/32 drill bit.

12 Set R-switch position and insert R-wire or wires: Set the R-switch up or down based on your wiring notes in Step 7. Insert wires into the inner holes of the terminals on the UWP. The tabs will stay down once the wire is inserted.

If you have 1 R-wire (R, Rh, or Rc)

1.

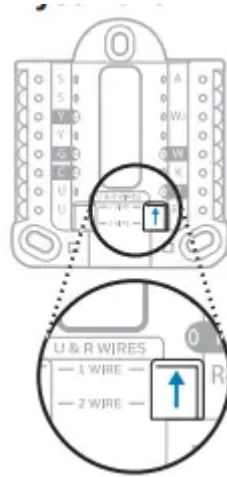

Set R-switch to the up position

2.

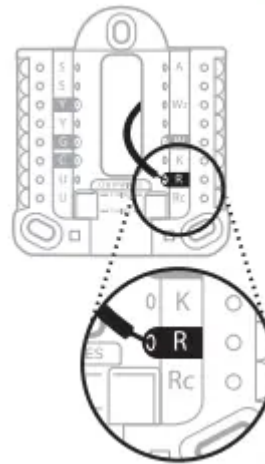

Insert your R-wire (R, Rh or Rc) into R-terminal.

If you have 2 R-wires (R or Rh, and Rc)

1.

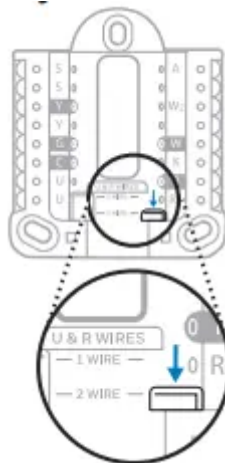

Set R-switch to the down position.



2.

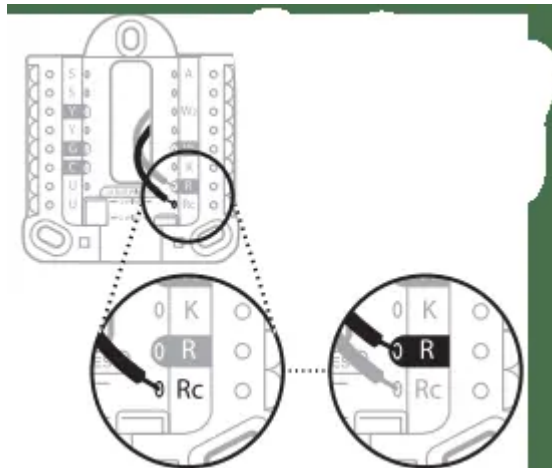

Insert your Rc wire into Rc-terminal.

3. Insert your R or Rh wire into R-Terminal.

13 Connect remaining wires from Step 8: Tip: Do not mount the UWP to the wall prior to connecting the wires. Depress the tabs to put the wires into the inner holes of their corresponding terminals on the UWP (one wire per terminal) until it is firmly in place. Gently tug on the wires to verify they are secure. Tip: If you need to release the wires again, push down the terminal tabs on the sides of the UWP.

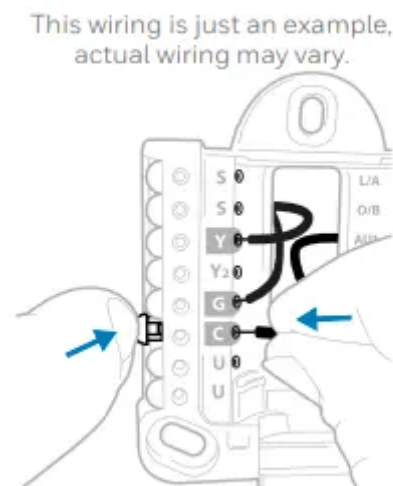

14 Mount the UWP and close the door Mount the UWP using the provided screws. Install all three screws for a secure fit on your wall. Close the door after you're finished.

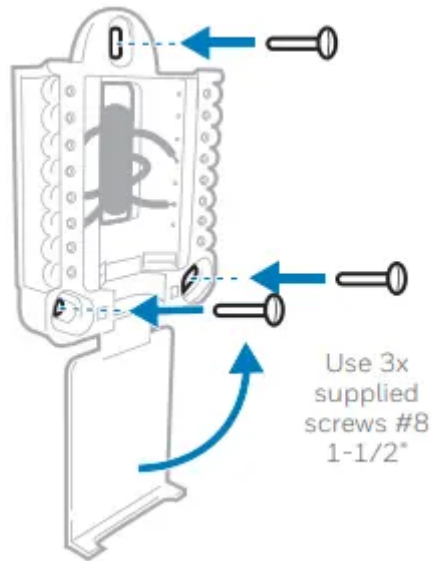

15 Attach your thermostat" Align the thermostat onto the UWP and firmly snap it into place.

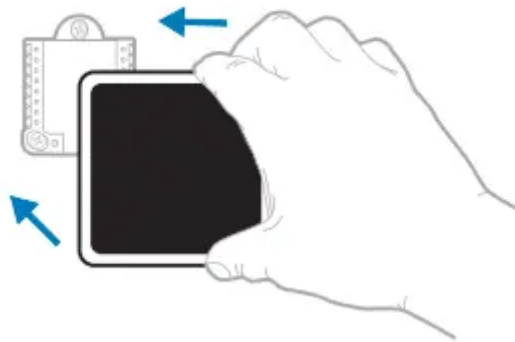

16 Turn your power ON: Turn on the power at the breaker box or switch that controls the heating/ cooling system.

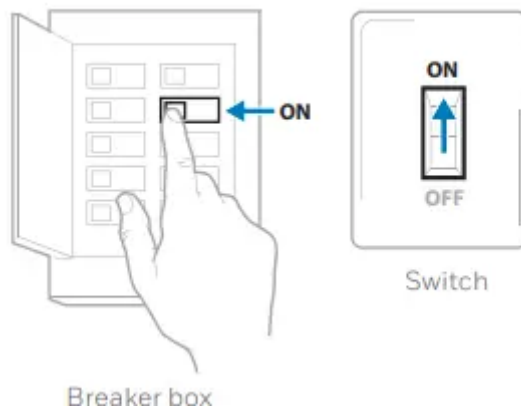

17 Return to the thermostat: Return to the thermostat. Confirm the screen shows START SETUP. If it does, continue to "Setup with Lyric App". If your thermostat does not show START SETUP, please contact Honeywell support.



Setup with Lyric App

1. Start Setup with app: Touch START SETUP on thermostat.



2. Select to setup with app Touch Yes on the USE LYRIC APP screen.



3 Your thermostat is now ready to be configured using the Honeywell Lyric app

- Download the "Honeywell Lyric" app from the App store or Google play.
- Open the Honeywell Lyric app. Your thermostat should appear under Thermostat Found. Tap SET UP NOW as shown below to continue. If your thermostat doesn't appear, tap INSTALL A DEVICE and follow the prompts to continue.
- The Lyric app will walk you through the rest of setup.



How to use your Honeywell Lyric App

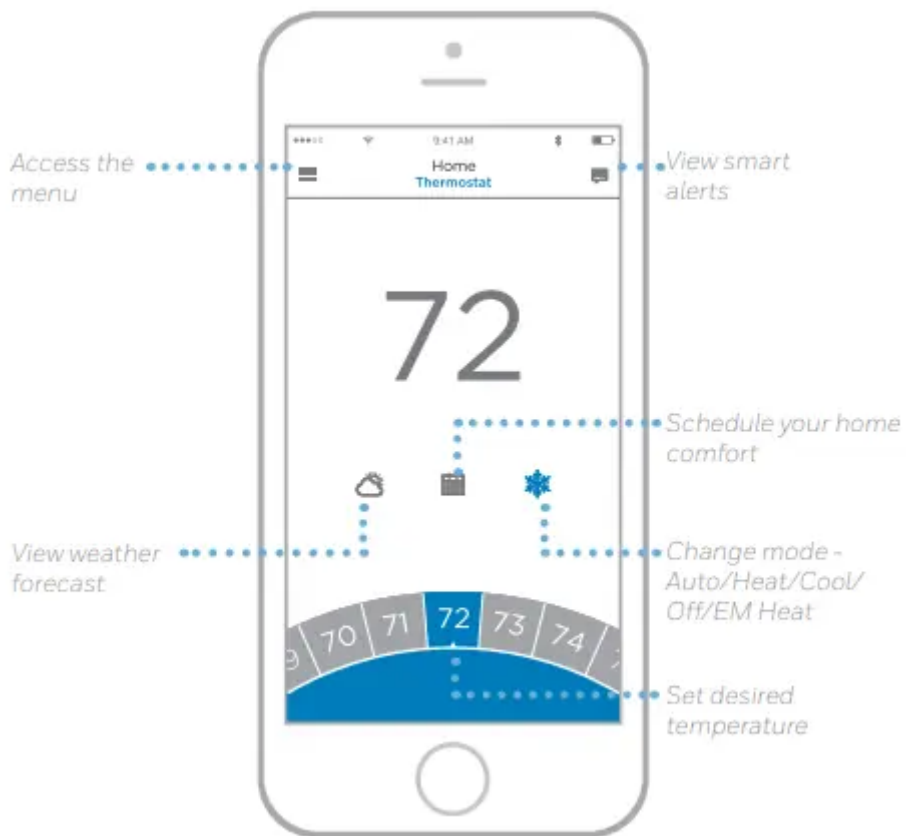

Interested in more Lyric products? Visit yourhome.honeywell.com to learn about all available products connected by the Honeywell Lyric App.

App is regularly enhanced and may change.

How to use your Lyric T5 Wi-Fi Thermostat

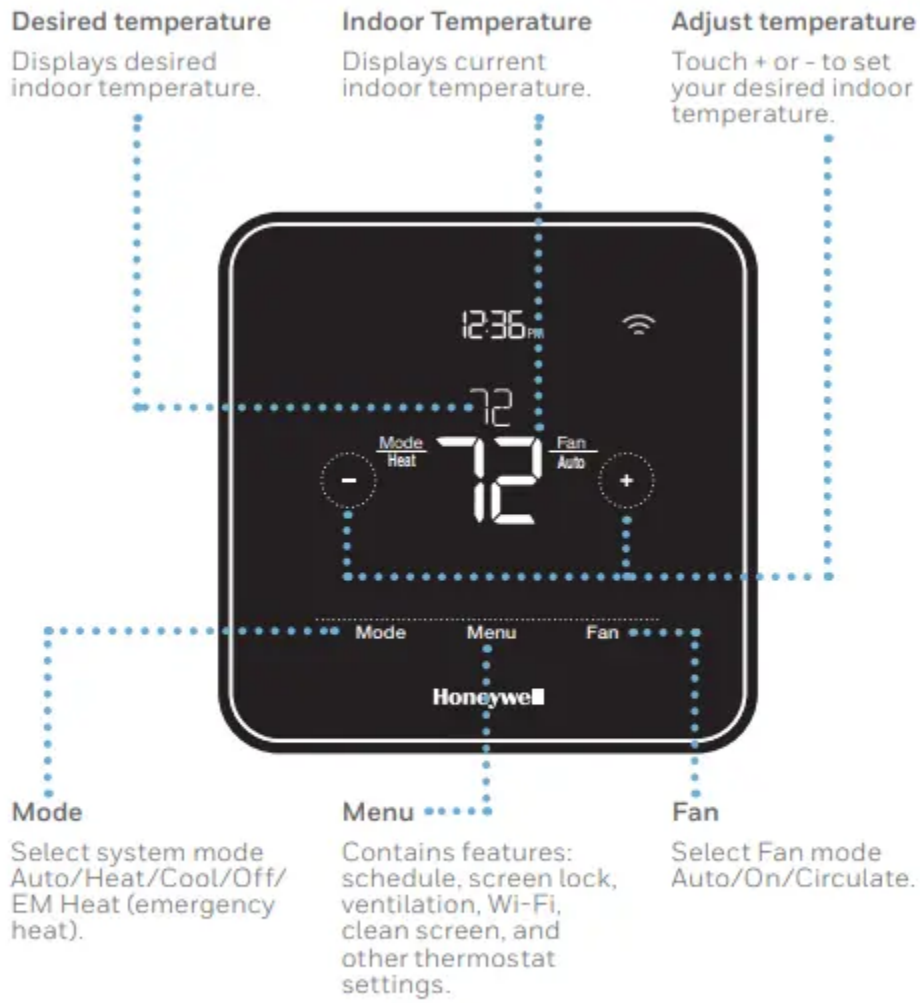

The screen will wake up by touching the center area of displayed temperature.



Manual Setup



If your Wi-Fi network is not working, you can alternatively setup your thermostat manually and connect your phone later.

1. Start manual setup: Touch START SETUP to begin.
2. Select manual setup: On the USE LYRIC APP screen, touch No.
3. Navigate and edit setup options: Use < or > to navigate through all the setup options. To see a list of all setup options. To edit an option value, touch Edit or touch text area. The value is now blinking. Use < or > to select the correct value. Touch Done or touch text area once the correct value is selected.



4. Finish Setup: Touch > until you see Finish Setup. Touch Select or touch text area. Manual Setup (cont.) Select No Yes Back No Yes Back

5. Setup Wi-Fi: At the end of setup process you will be prompted to SETUP WIFI. If your Wi-Fi is still not working, you have to manually set the time and date. Select No on the SETUP WIFI screen.

6. Set time and date: Set daylight saving time if you are in an area that follows daylight saving time. Set date, clock format and time on the next screens.

7. Your thermostat is now setup: Refer to page 17 for more information about basic operation.

Equipment Setup Options

Option # -- Option Name --Option Value (factory default in bold)

120 - Schedule Type

- No Schedule
 - MO-SU = Every day the same
 - MO-FR SA SU = 5-1-1 schedule
 - MO-FR SA-SU = 5-2 schedule
 - Each Day = Every day different
- Note: You can change default MO-FR, SA-SU schedule here. To edit periods during days, temperature setpoints, or to turn Schedule On/ Off, touch MENU from the Home screen and go to SCHEDULE.

200 - System Type

- Conventional Forced Air, Heat Pump, Boiler, Cool Only Note: This option selects the basic system type your thermostat will control.

205 - Equipment Type

- Conventional Forced Air Heat: Standard Gas, High Efficiency Gas, Oil, Electric, Fan Coil
- Heat Pump: Air to Air, Geothermal
- Boiler: Hot Water, Steam Note: This option selects the equipment type your thermostat will control.
- Note: This feature is NOT displayed if feature 200 is set to Cool Only

218 - Reversing Valve

- O/B on Cool, O/B on Heat Note: This option is only displayed if the Heat Pump configured. Select whether reversing valve O/B should energize in cool or in heat.

220 - Cool Stages/ Compressor Stages (#200=Conv./ #200=HP)

- 0, 1, 2 Note: Select how many Cool or Compressor stages of your equipment the thermostat will control. Maximum of 2 Cool/Compressor Stages.

221 - Heat Stages/ Aux/E Stages (#200=Conv./ #200=HP)

- Heat Stages: 0, 1, 2
- Aux/E stages: 0, 1
- Note: Select how many Heat or Aux/E stages of your equipment the thermostat will control. Maximum of 2 Heat Stages for conventional systems. Maximum of 1 Aux/E stage for systems with more than 1 heating equipment type.

Frequently Asked Questions

Will the Lyric T5 Wi-Fi thermostat still work if Wi-Fi connection is lost?

- Yes, the temperature can be adjusted directly at the thermostat. However, some features, including geofencing, are managed only through the Lyric app and will not function while the connection is down. The Lyric thermostat will automatically reconnect to Wi-Fi once the network is restored.

The Lyric T5 Wi-Fi thermostat is not finding the in home Wi-Fi network.

- Lyric thermostat operates in the 2.4GHz range. That may be why the Lyric thermostat does not see the network but the smartphone, which operates in both the 2.4 and 5.0 GHz range, sees the network. Most routers will broadcast two networks, one SSID on the 5.0 GHz radio and one SSID on the 2.4 GHz radio.

A change was made on the Honeywell

- Lyric App but it has not shown up on the Lyric T5 Wi-Fi thermostat. There may be a short delay after making temperature and setting changes in the app.

Can there be multiple users for geofencing? Yes, there can be multiple users. Geofencing will trigger based on the last person to leave and the first person to return. To properly use geofencing with multiple users:

- Each user needs to create their own Lyric account.
- Each user should use their login ID and password across his or her devices, including smartphones and tablets.
- No two users should share the same account.

How are multiple users set up with Lyric thermostat?

- Access can be given to any or all Lyric thermostat locations through the Honeywell Lyric App. Start by touching the three-line menu icon in the upper left-hand corner of the home screen. Select Manage Users and touch Add User located at the bottom of the screen. Type in the email address of the person to be invited. If they have a Lyric account set up, the location will be automatically added to their account. If they don't have an account, they will receive an email invitation prompting them to download the app and create their own account.
- Note: All individuals with access to a thermostat share the same user privileges. Users added will be able to change the thermostat's settings, as well as add or delete other users.

Is there a way to extend the signal strength?

- The range or distance of the Wi-Fi signal is determined by the router. Check the router's manual for additional information.

There is an alert that says Wi-Fi Signal Lost. What does that mean?

- The Wi-Fi signal to the Lyric thermostat has been lost. Wait for the thermostat to reconnect or select a new network within the Honeywell Lyric App configuration menu. If the thermostat is unable to reconnect, you will need to troubleshoot the router to determine the cause.

Why is the thermostat showing up as offline (strike-through Wi-Fi icon) on top of right corner of thermostat display?

- If the Lyric thermostat displays a strike-through Wi-Fi icon on its screen or shows up as offline on the Honeywell Lyric App, it has lost connection to the network. Make sure the router is powered and broadcasting. The home's Wi-Fi network may need to be reset by power cycling the router. Consult the router's instruction manual for directions on power cycling. When the network has been restored, the thermostat will automatically reconnect.

An activation email hasn't been received.

- An email will be sent from connected-Home@alarmnet.com. An activation email is needed to complete the Lyric account setup. If an activation email is not received after five minutes, check the Spam folder of the email account.

Warning

This content is compiled from multiple sources and is provided for reference purposes only. It may not be complete or fully applicable to all situations. If you are unable to resolve your issue, please contact the product manufacturer or an authorized service provider for official support.