

USE AND CARE GUIDE ELECTRIC OR GAS DRYER

USE SENSOR DRY/AUTOMATIC DRY CYCLES FOR BETTER FABRIC CARE AND ENERGY SAVINGS

Use the Sensor Dry/Automatic Dry cycles to provide the most energy savings and enhanced fabric care from the dryer. During Sensor Dry/Automatic Dry cycles, drying air temperature or moisture level is sensed in the load. This sensing occurs throughout the drying cycle and the dryer shuts off when the load reaches the selected dryness. With Timed Dry, the dryer runs the amount of time set and sometimes results in shrinkage, wrinkling, and static due to over-drying.

Use Timed Dry for the occasional damp load that needs a little more drying time or when using the drying rack.

CONTROL PANEL & FEATURES

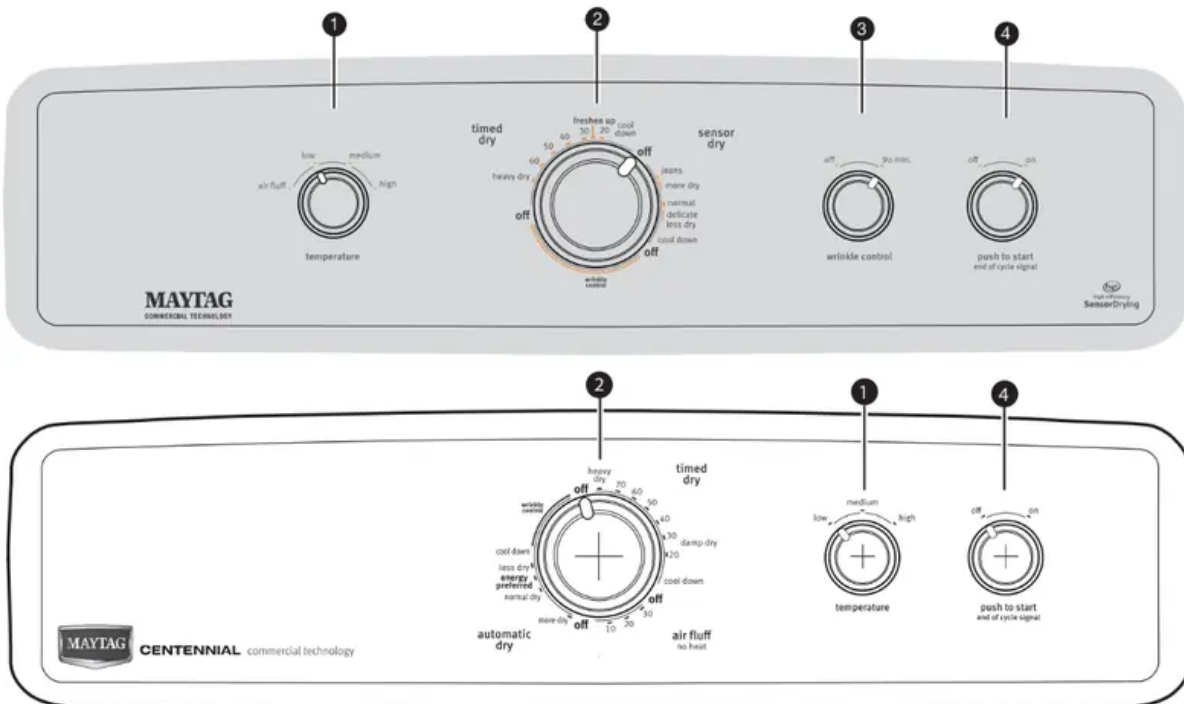

Not all features and options are available on all models.
Appearance may vary.

1 TEMPERATURE/FABRIC

Select a drying temperature based on the fabrics in your load. If you are unsure of the temperature to select for a load, select the lower setting rather than the higher setting.

2 CYCLE KNOB

Use Cycle Knob to select available cycles on your dryer. Turn the knob to select a cycle for your laundry load. See Cycle Guide for detailed descriptions of cycles.

TIMED DRY



Will run the dryer for the specified time on the control. On models with a selectable temperature knob, you may choose a setting based on the fabrics in your load. On some models, temperature is included in the cycle

selections. Drying time and temperature will depend on your dryer model.

SENSOR DRY/AUTOMATIC DRY

Senses moisture in the load or air temperature and shuts off when the load reaches the selected dryness level.

Gives the best drying in the shortest time. Drying time will vary based on fabric type, load size, and temperature setting.

WRINKLE CONTROL Feature (on some models)

The WRINKLE CONTROL feature will run after your drying cycle is complete. It periodically starts and stops the dryer, tumbling the load without heat to help avoid wrinkling. On some models, WRINKLE CONTROL automatically starts at the end of the cycle. Opening the door will stop this feature.

NOTE: A signal will sound periodically when the WRINKLE CONTROL setting is selected, but only if the End of Cycle signal is also selected

3 WRINKLE CONTROL option (on some models)

When you are unable to remove a load of clothes from the dryer as soon as it stops, wrinkles can form. The WRINKLE CONTROL option periodically tumbles, rearranges, and fluffs the load to help keep wrinkles from forming.

- Get up to 90 minutes of heat-free, periodic tumbling at the end of a cycle. Turn the WRINKLE CONTROL knob to select OFF or 90 min. at any time before the cycle has ended.

4 PUSH TO START/END OF CYCLE SIGNAL

The End of Cycle Signal produces an audible sound when the drying cycle is finished. Promptly removing clothes at the end of the cycle reduces wrinkling.

Turn the END OF CYCLE SIGNAL knob to select the desired setting (On or Off). Press the PUSH TO START knob to start the dryer.

CYCLE GUIDE — SENSOR DRY/AUTOMATIC DRY CYCLES

SENSOR DRY/AUTOMATIC DRY - Senses moisture in the load or air temperature and shuts off when the load reaches the selected dryness level.

Not all cycles and settings are available on all models. Settings and options shown in **bold** are default settings for that cycle.

NOTE: Government energy certifications for the Maytag Gas and Electric models were based on the Timed Dry cycle with the Maximum drying temperature setting. The as - shipped defaults of Sensor Dry, Normal cycle, Low heat, wrinkle shield were not used.

1. Jeans, heavy work clothes, towels

- More Dry Less Dry Normal Energy Preferred
 - High
 - End of Cycle Signal Wrinkle Control

2. Work clothes, medium weight fabrics, sheets

- More Dry Less Dry Normal Energy Preferred
 - Medium or Low
 - End of Cycle Signal Wrinkle Control

3. Casual, shirts, pants, lightweight items, synthetics, delicates, athletic wear

- More Dry Less Dry Normal Energy Preferred
 - Low
 - End of Cycle Signal Wrinkle Control

Automatic cycles give the best drying in the shortest time. Drying time varies based on fabric type, load size, and dryness setting. Select a drying temperature based on the fabrics in your load. If you are unsure of the temperature to select for a load, select the lower setting rather than the higher setting.

NOTE: If loads do not seem as dry as you would like, select More Dry next time you dry a similar load. If loads seem drier than you like, select Less Dry next time you dry a similar load.

CYCLE GUIDE — TIMED DRY CYCLES

TIMED DRY - Will run the dryer for the specified time on the control.

Not all cycles and settings are available on all models.

1. Heavy or bulky items

- Heavy Dry
 - Any
 - End of Cycle Signal
 - Completes drying if items are still damp



2. Any load

- Freshen Up
 - Any
 - End of Cycle Signal
 - Use low to medium temperature to smooth out wrinkles, such as those found in clothes packed in a suitcase or in items wrinkled from being left in the dryer too long.

3. Any load

- Damp Dry
 - Any
 - End of Cycle Signal
 - Dries items to a damp level or for items that do not require an entire drying cycle.

4. Rubber, plastic, heat sensitive fabrics

- Air Fluff
 - Air Fluff
 - End of Cycle Signal
 - No heat drying

Setting the Drying Temperature

If your dryer has multiple heat settings:

A High temperature setting may be used for drying heavyweight items such as towels and work clothes.

A Low to Medium temperature setting may be used for drying medium-weight items such as sheets, blouses, dresses, underwear, permanent press fabrics, and some knits.

Use the Air Fluff (no heat) setting for foam, rubber, plastic, or heat-sensitive fabrics. Line dry bonded or laminated fabrics.

NOTE: If you have questions about drying temperatures for various loads, refer to the care label directions.

USING YOUR DRYER

⚠ WARNING

Explosion Hazard
Keep flammable materials and vapors, such as gasoline, away from dryer.
Do not dry anything that has ever had anything flammable on it (even after washing).
Failure to follow these instructions can result in death, explosion, or fire.

⚠ WARNING

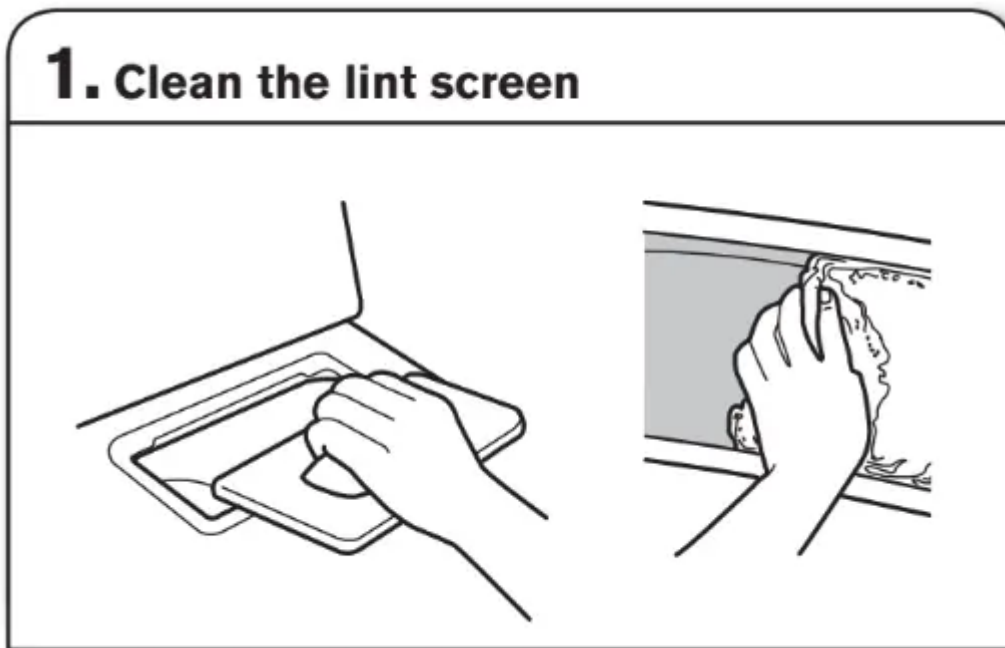
Fire Hazard
No washer can completely remove oil.
Do not dry anything that has ever had any type of oil on it (including cooking oils).
Items containing foam, rubber, or plastic must be dried on a clothesline or by using an Air Cycle.
Failure to follow these instructions can result in death or fire.

WARNING: To reduce the risk of fire, electric shock, or injury to persons, read the IMPORTANT SAFETY INSTRUCTIONS before operating this dryer. Before using your dryer, wipe the dryer drum with a damp cloth to remove dust from storing and shipping.



Clean the lint screen before each load. Pull the lint screen out of its holder. Roll lint off the screen with your fingers. Do not rinse or wash screen to remove lint. Push the lint screen firmly back into place.

For additional cleaning information, see “Dryer Care”.

2. Load the dryer

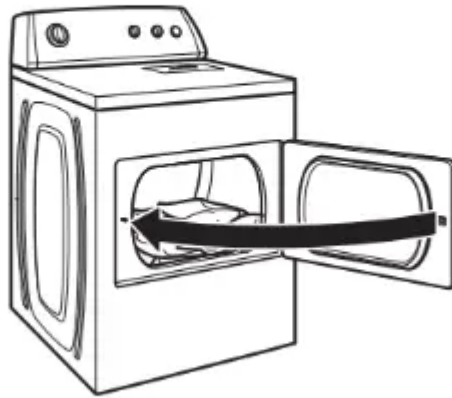

Place laundry in the dryer. Close the door. Do not tightly pack the dryer; clothes should be able to tumble freely.

NOTE: Your model may have a different door than the one shown. Some models have drop down doors.

3. Select the desired cycle

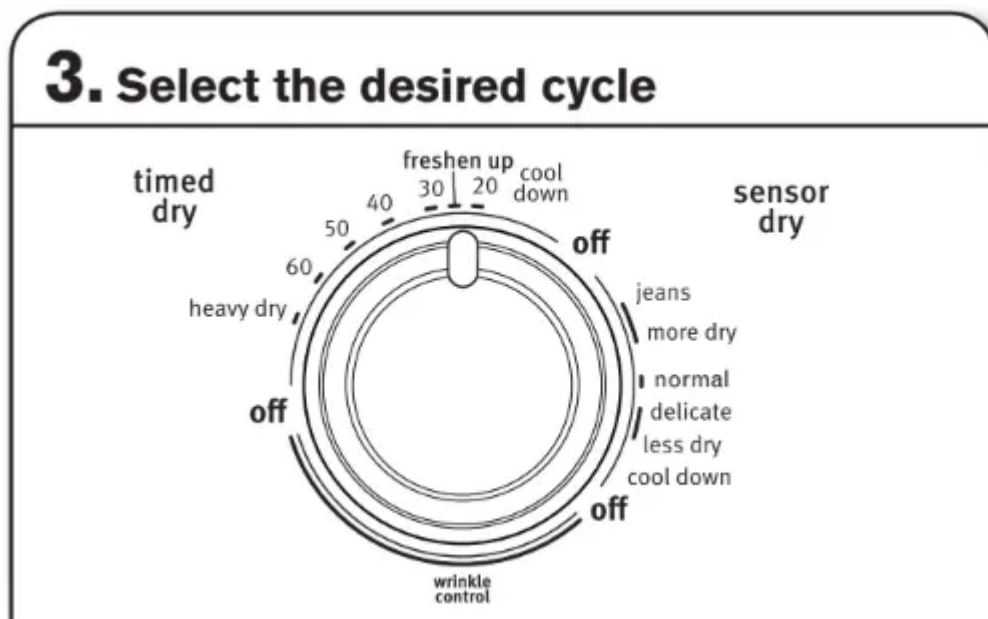

Select the desired cycle for your load. See the Cycle Guide for more information about each cycle.

SENSOR DRY/AUTOMATIC DRY Cycles

You can select a different dryness level, depending on your load, by turning the knob to dryness level.

Selecting More Dry, Energy Preferred, Normal, or Less Dry automatically adjusts the dryness level of the fabrics at which the dryer will shut off.

Sensor Dry/Automatic Dry cycles give the best drying in the shortest time. Drying time varies based on fabric type, load size, and dryness setting. Less Dry removes less moisture and is used for loads you may want to put on a hanger to complete drying.

More Dry removes more load moisture. Energy Preferred is used for a starting point for Sensor Dry/Automatic Dry cycles.

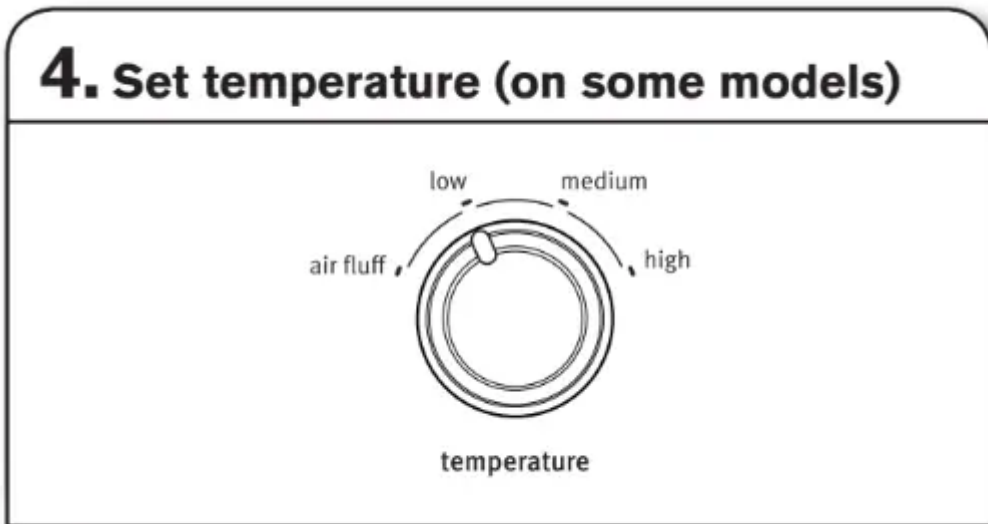

Select temperature by turning the knob to the desired position or select the Automatic Dry Cycle that has the temperature included in the cycle selections. See “Setting the Drying Temperature”.

NOTE: Not all options and settings are available with all cycles.

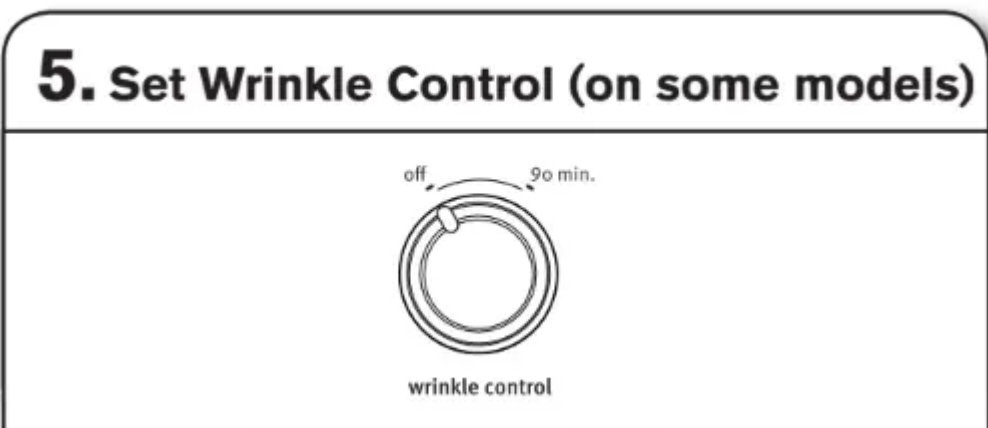

Select Wrinkle Control by turning the knob to the desired position.

Get up to 90 minutes of heat-free, periodic tumbling at the end of a cycle. Turn the WRINKLE CONTROL knob to OFF or 90 min. at any time before the cycle has ended.

NOTE: Not all options and settings are available with all cycles.

6. Select End of Cycle Signal (if desired)



Turn the END OF CYCLE SIGNAL knob to select the desired setting (On or Off). The End of Cycle Signal produces an audible sound when the drying cycle is finished. Promptly removing clothes at the end of the cycle reduces wrinkling.

7. Press PUSH TO START to begin cycle



Push and hold the PUSH TO START knob to begin the cycle.

DRYING RACK ACCESSORY

To purchase a drying rack for your dryer, please refer to "Assistance or Service" on the back cover of the manual or contact the dealer from whom you purchased your dryer.

Part Number - 3406839

Accessory - Drying rack - fits 29" Super Capacity Plus

Cleaning the dryer location

Keep dryer area clear and free from items that would block the air flow for proper dryer operation. This includes clearing piles of laundry in front of the dryer.

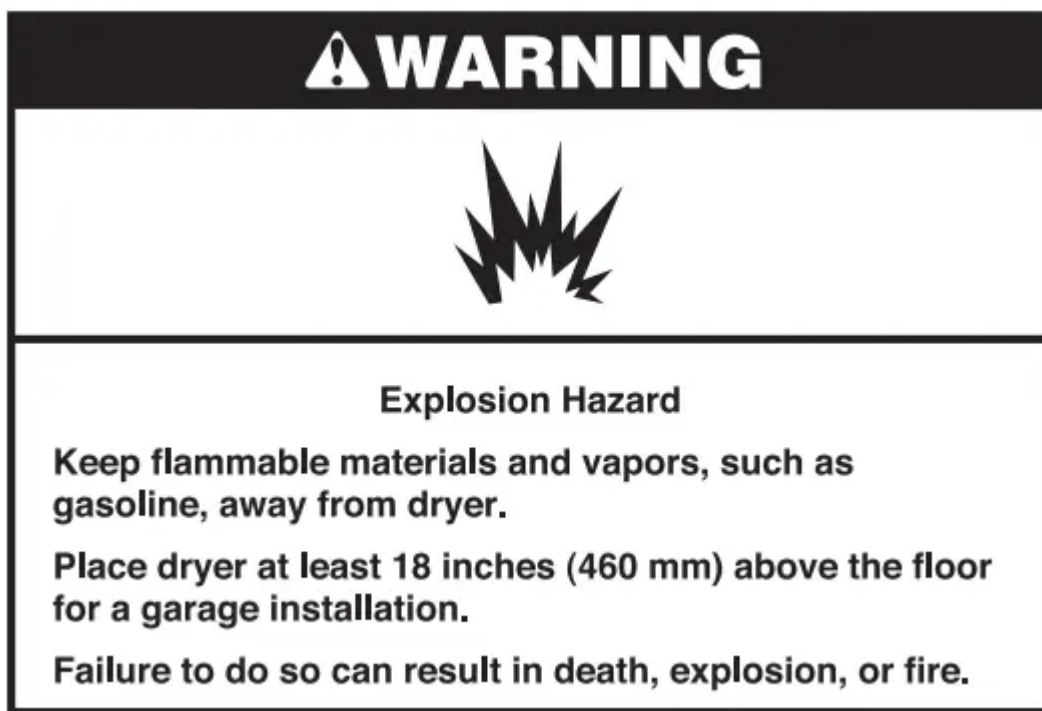

Cleaning the dryer interior

To clean dryer drum

1. Apply a liquid, nonflammable household cleaner to the stained area of the drum and rub with a soft cloth until stain is removed.
2. Wipe drum thoroughly with a damp cloth.
3. Tumble a load of clean cloths or towels to dry the drum.

NOTE: Garments that contain loose dyes, such as denim blue jeans or brightly colored cotton items, may discolor the dryer interior. These stains are not harmful to your dryer and will not stain future loads of clothes. Dry these items inside out to avoid drum staining.

Removing accumulated lint

From Inside the Dryer Cabinet

Lint should be removed every 2 years, or more often, depending on dryer usage. Cleaning should be done by a qualified servicer.

From the Exhaust Vent

Lint should be removed every 2 years, or more often, depending on dryer usage.

Cleaning the lint screen

Every load cleaning

The lint screen is located in the dryer. A screen blocked by lint can increase drying time.

To clean:

1. Pull the lint screen out of its holder. Roll lint off the screen with your fingers. Do not rinse or wash screen to remove lint. Wet lint is hard to remove.

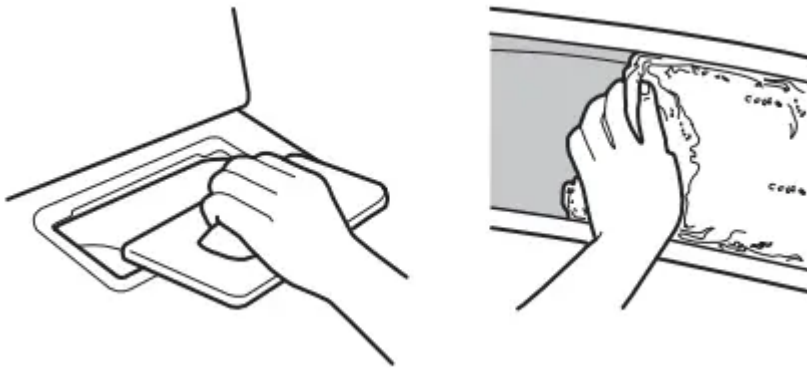

2. Push the lint screen firmly back into place.

IMPORTANT:

- Do not run the dryer with the lint screen loose, damaged, blocked, or missing. Doing so can cause overheating and damage to both the dryer and fabrics.
- If lint falls off the screen into the dryer during removal, check the exhaust hood and remove the lint. See Venting Requirements. As needed cleaning Laundry detergent and fabric softener residue can build up on the lint screen. This buildup can cause longer drying times for your clothes, or cause the dryer to stop before your load is completely dry. The screen is probably clogged if lint falls off while the screen is in the dryer. Clean the lint screen with a nylon brush every 6 months, or more frequently, if it becomes clogged due to a residue buildup.

To wash:

1. Roll lint off the screen with your fingers.
2. Wet both sides of lint screen with hot water.
3. Wet a nylon brush with hot water and liquid detergent. Scrub lint screen with the brush to remove residue buildup.

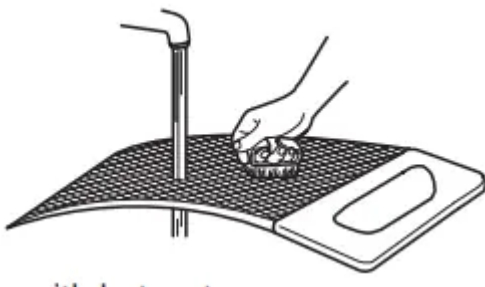

4. Rinse screen with hot water.

5. Thoroughly dry lint screen with a clean towel. Reinstall screen in dryer.

Vacation, storage, and moving care

Non-Use or Storage Care

Operate your dryer only when you are at home. If you will be on vacation or not using your dryer for an extended period of time, you should:

1. Unplug dryer or disconnect power.
2. (For gas dryers only): Close shut-off valve to gas supply line.
3. Clean lint screen.

See "Cleaning the Lint Screen."

Moving Care

For power supply cord-connected dryers:

1. Unplug the power supply cord.
2. Make sure leveling legs are secure in dryer base.
3. Use tape to secure dryer door.

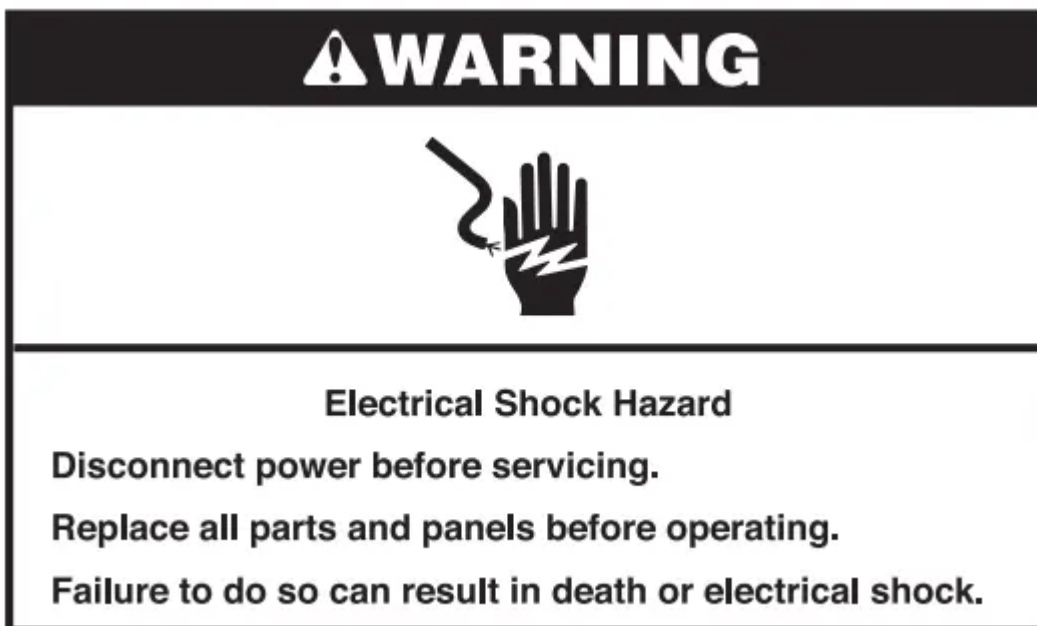

For direct-wired dryers:

1. Turn off power at fuse or breaker box.
2. Disconnect wiring.
3. Make sure leveling legs are secure in dryer base.
4. Use tape to secure dryer door.

For gas dryers:

1. Unplug or disconnect power to dryer.
2. Close shut-off valve in gas supply line.
3. Disconnect gas supply line pipe and remove fittings attached to dryer pipe.
4. Cap the open fuel supply line.
5. Make sure leveling legs are secure in dryer base.
6. Use tape to secure dryer door.

Reinstalling the Dryer

Follow the Installation Instructions to locate, level, and connect the dryer.

Changing the drum light (on some models)

1. Unplug dryer or disconnect power.
2. Open the dryer door. Locate the light bulb cover on the back wall of the dryer. Using a Phillips-head screwdriver, remove the screw located in the lower right-hand corner of the cover. Remove the cover.

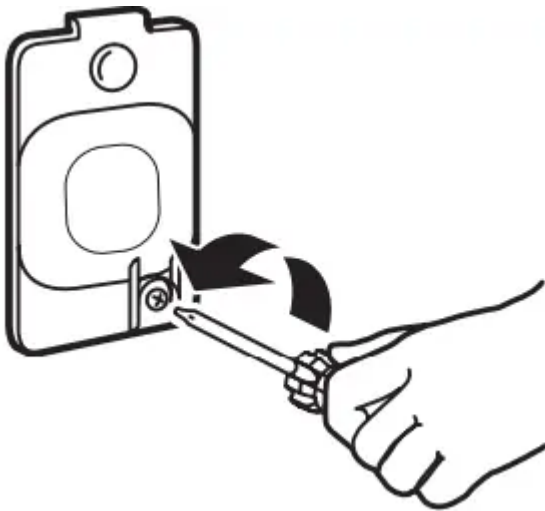

3. Turn bulb counterclockwise. Replace the bulb with a 10-watt appliance bulb only. Replace the cover and secure with the screw.
4. Plug into a grounded outlet or reconnect power.

TROUBLESHOOTING

1. Dryer will not run

- Door not closed completely.
 - Make sure the dryer door is closed completely

- PUSH to START knob not pressed firmly or held long enough.
 - Press and hold the PUSH to START knob until you hear the dryer drum moving.
- Household fuse is blown or circuit breaker has tripped.
 - Electric dryers use 2 household fuses or circuit breakers. The drum may be turning, but you may not have heat. Replace both fuses or reset the circuit breaker. If the problem continues, call an electrician.
- Incorrect power supply.
 - Electric dryers require 240-volt power supply. Check with a qualified electrician.
- Wrong type of fuse.
 - Use a time-delay fuse

2. Dryer will not heat

- Household fuse is blown or circuit breaker has tripped.
 - The drum may be turning, but you may not have heat. Electric dryers use 2 household fuses or circuit breakers. Replace the fuses or reset the circuit breaker. If the problem continues, call an electrician.
- Incorrect power supply.
 - Electric dryers require 240-volt power supply. Check with a qualified electrician.
- Supply line valve not open.
 - For gas dryers, make sure that the valve on the gas supply line is open.

Unusual Noise

1. Thumping noise Dryer hasn't been used in a while.

- This is normal.
 - The thumping sound should diminish after a few minutes of use.

2. Rattling or vibrating noise

- A small object caught between the edges of dryer drum.
 - Check the front and rear edges of the drum for small objects. Clean out pockets before laundering.
- Dryer isn't properly leveled.
 - The dryer may vibrate if not properly installed. See the Installation Instructions. All four dryer feet should be in firm contact with the floor.

- Clothing is balled up in dryer.
 - When balled up, the load will bounce, causing the dryer to vibrate. Separate the load items and restart the dryer.

3. Clicking noise

- Gas valve operating.
 - On gas dryers, you may hear the gas valve clicking as it opens and closes. This is normal.

Dryer Results

1. Thumping noise Dryer hasn't been used in a while.

- This is normal.
 - The thumping sound should diminish after a few minutes of use.

2. Rattling or vibrating noise

- A small object caught between the edges of dryer drum.
 - Check the front and rear edges of the drum for small objects. Clean out pockets before laundering.
- Dryer isn't properly leveled.
 - The dryer may vibrate if not properly installed. See the Installation Instructions. All four dryer feet should be in firm contact with the floor.
- Clothing is balled up in dryer.
 - When balled up, the load will bounce, causing the dryer to vibrate. Separate the load items and restart the dryer.

3. Clicking noise

- Gas valve operating.
 - On gas dryers, you may hear the gas valve clicking as it opens and closes. This is normal.

Dryer Results

1. Clothes are not drying satisfactorily or drying times are too long

- Lint screen is clogged with lint.
 - Clean lint screen before each load.
- The exhaust vent or outside exhaust hood is clogged with lint, restricting air movement.
 - Run the dryer for 5-10 minutes. Hold your hand under the outside exhaust hood to check air movement. If you do not feel air movement, clean exhaust

system of lint or replace exhaust vent with heavy metal or flexible metal vent.
See Installation Instructions.

- The exhaust vent is not the correct length.
 - The dryer is not level. Clothes not contacting the moisture sensors during Automatic cycles. See “Level the Dryer” in the Installation Instructions.
- The exhaust vent diameter is not the correct size.
 - Use 4" (102 mm) diameter vent material.
- The Air Fluff cycle has been selected.
 - Select the right cycle for the types of garments being dried. See Cycle Guide.
- The load is too large and heavy to dry quickly.
 - Separate the load to tumble freely

2. Clothes are not drying satisfactorily or drying times are too long (cont.)

- Fabric softener sheets are blocking the grille.
 - The air outlet grille is just inside the door, behind the lint screen. Check that it is not blocked by a fabric softener sheet. Use only one fabric softener sheet, and use it only once.
- The dryer is located in a room with temperature below 45°F (7°C).
 - Proper operation of dryer cycles requires temperatures above 45°F (7°C).
- The dryer is located in a closet.
 - Closet doors must have ventilation openings at the top and bottom of the door. The front of the dryer requires a minimum of 1" (25 mm) of airspace, and, for most installations, the rear of the dryer requires 5" (127 mm). See Installation Instructions.

3. Cycle time is too short Automatic cycle ending early.

- The load may not be contacting the sensor strips.
 - Level the dryer.
 - Use Timed Dry for very small loads. Change the Dry Level setting on Sensor Dry/Automatic Dry cycles.
 - Increasing or decreasing the Dry Level setting will change the amount of drying time in a cycle.

4. Lint on load

- Lint screen is clogged with lint.
 - Clean lint screen before each load.

5. Stains on load

- Improper use of fabric softener.
 - Add dryer fabric softener sheets at the beginning of the cycle. Fabric softener sheets added to a partially dried load can stain your garments.

6. Stains on drum

- Loose dyes in clothes.
 - Drum stains are caused by dyes in clothing (usually blue jeans). These will not transfer to other clothing.

7. Loads are wrinkled

- The load was not removed from dryer at the end of the cycle.
 - Use a cycle with Wrinkle Control to tumble the load without heat to avoid wrinkling.
- Dryer tightly packed.
 - Dry smaller loads that can tumble freely and reduce formation of wrinkles.

8. Odors

- Recent painting, staining, or varnishing in the area where your dryer is located.
 - Ventilate the area. When the odors or fumes are gone from the area, rewash and dry the clothing.
- The electric dryer is being used for the first time.
 - The new electric heating element may have an odor. The odor will be gone after the first cycle.

9. Load too hot

- Laundry items were removed from the dryer before the end of the cycle.
 - Allow Cool Down cycle to finish before removing laundry from dryer. All cycles are cooled slowly to reduce wrinkling and make it easier to handle. Items removed before Cool Down may feel very warm.
- A high temperature cycle was used or Temperature/Fabric control was set to high.
 - Select a lower temperature, and use an automatic drying cycle. These cycles sense the temperature or the moisture level in the load and shut off when the load reaches the selected dryness. This reduces overdrying.

Warning

This content is compiled from multiple sources and is provided for reference purposes only. It may not be complete or fully applicable to all situations. If you are unable to resolve your issue, please contact the product manufacturer or an authorized service provider for official support.

Document generated by [ManualsFile](#)

