

ASSEMBLY

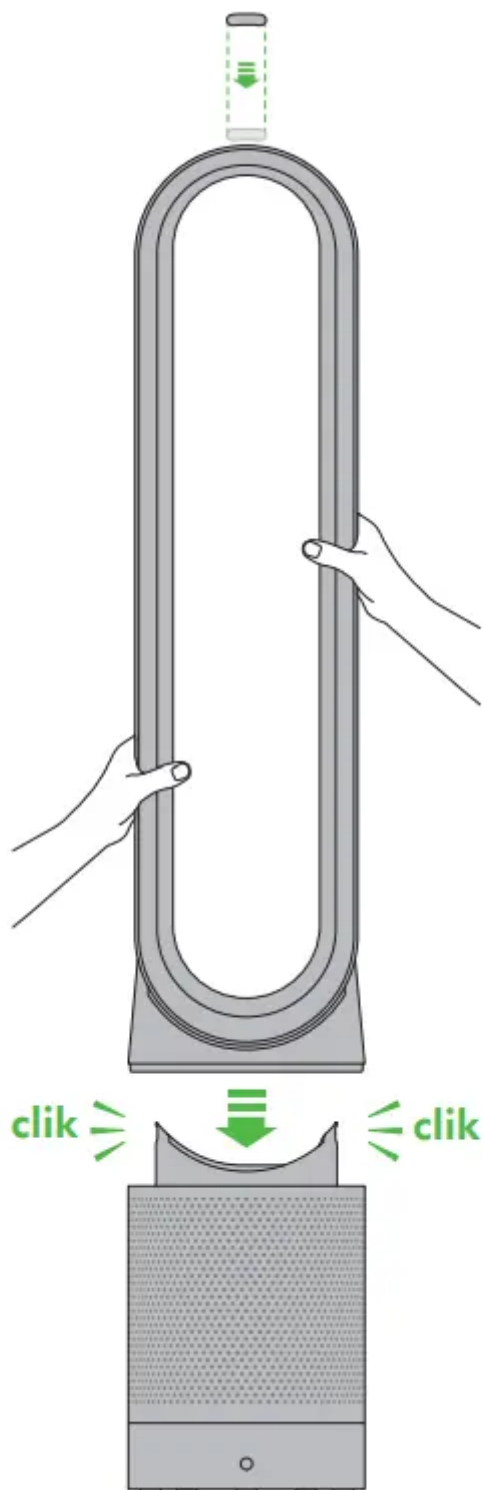

Control

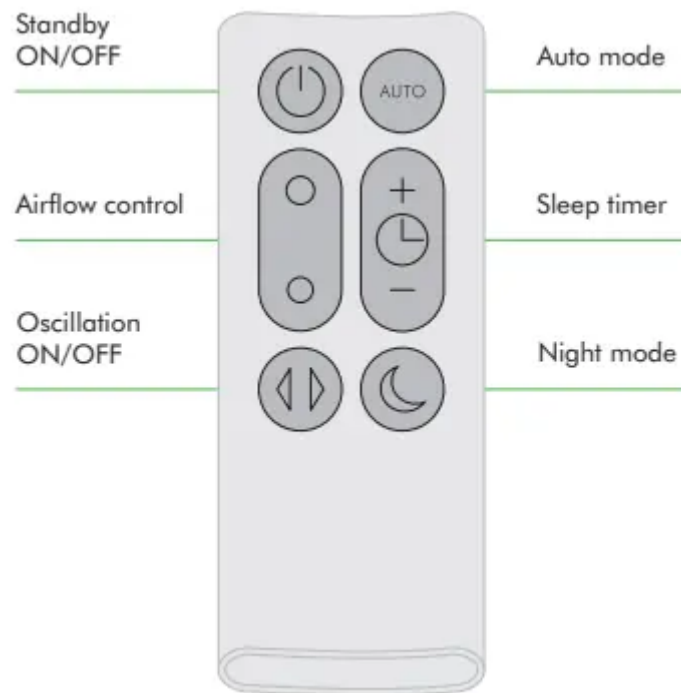



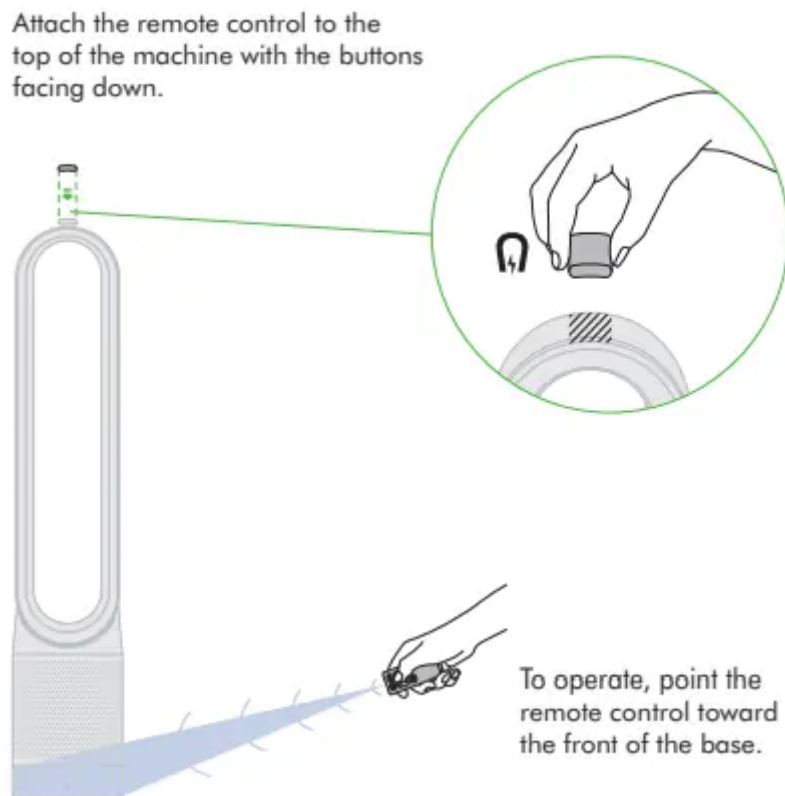



Attach the remote control to the top of the machine with the buttons facing down.



Display icons



-  : Flashing green = Wi-Fi is ready to connect to your Dyson Link app
-  : Flashing white = Wi-Fi connecting
-  :
 - Solid white = Wi-Fi connected
 - Off = Wi-Fi disabled
-  : Solid white = cleaning/below air quality target
-  : Solid green = clean/air quality target has been met
 - Off = machine is not in auto cleaning mode
-  : Solid white = machine is in night mode
 - Off = appliance is not in night mode

Airflow

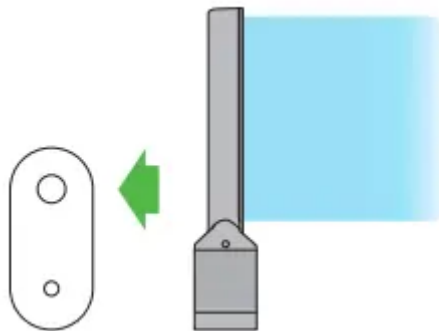

Select a high flow of air.

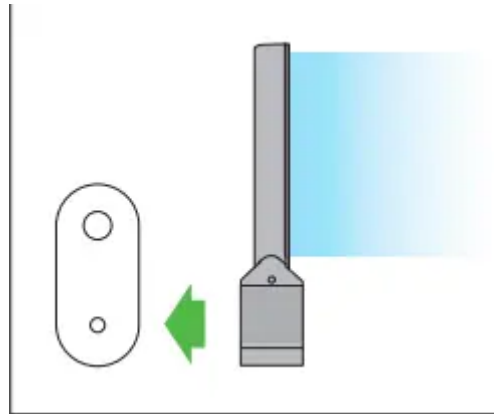

Select a low flow of air.

Sleep timer

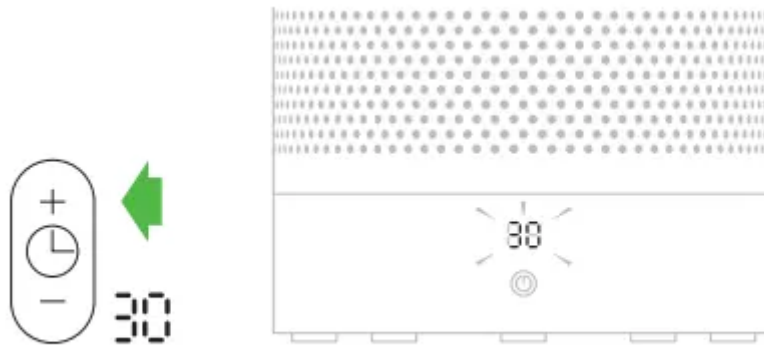

To set the sleep timer, select the desired time. When time reaches zero, the machine will go into standby mode. To cancel, reduce the time until two dashes appear.

Night mode



The night mode will dim the display and run quietly, making it ideal for use while sleeping.

- When night mode is enabled (indicated by an illuminated half moon symbol in the top right corner of the display), the display will dim and after 5 seconds will fade to off. The half moon symbol remains illuminated.



- If in manual mode, the power will reduce to level 4. When night mode is activated, if it is already below level 4, it will remain the same. This can be manually changed if desired. The display will illuminate briefly, then fade as before.
- If in Auto mode the power will be reduced automatically.

Auto mode



Auto mode adjusts the power according to the air quality in the room.

- When Auto mode is enabled (indicated by an A symbol in the bottom left corner of the display), the on-board sensors will intelligently adjust the speed of the machine according to the air quality.

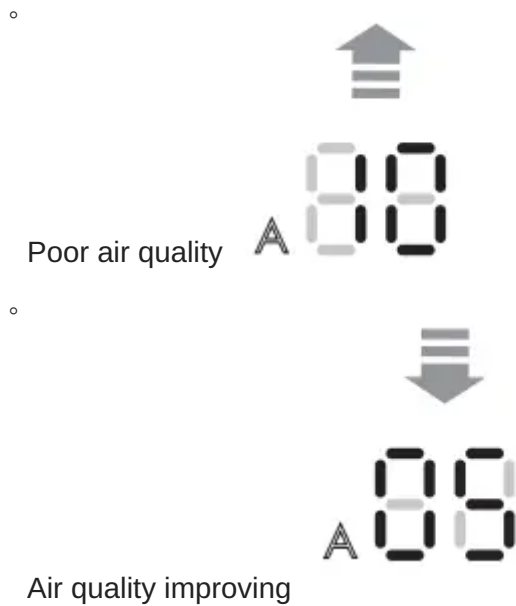

- If the air is clean the A symbol will turn green and the numerical display will switch off. If the air quality worsens the A symbol will turn white and the machine will automatically restart cleaning the room.

Air quality target has been met.



- For additional control the Dyson Link app can be used to further adjust the sensitivity of the machine
- A period of 6 days is required after the machine is first used for the sensor to calibrate. During this period the machine may be more sensitive to VOCs than normal.

Setting up Dyson Link app

The machine can be enhanced when connected to the Dyson Link app on your smart device.

-



: Download the Dyson Link app, available on iOS and Android.

-



: Select 'Add a Product' from within the app and follow the on screen instructions.

-



: In order to connect the machine, you will need the information on the front of this manual.

Clearing blockages

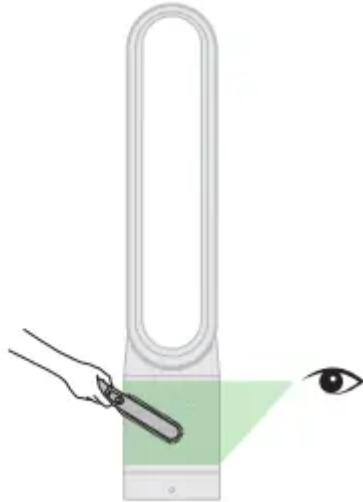

: Ensure the machine is unplugged.

Look for blockages in the air inlet holes on the filter. Use a soft brush to remove debris.

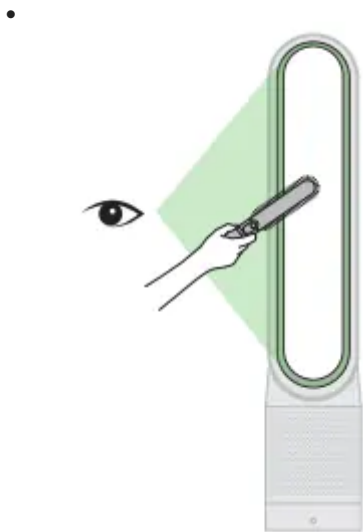

: Look for blockages in the small aperture inside the loop

amplifier. Use a soft brush to remove debris.

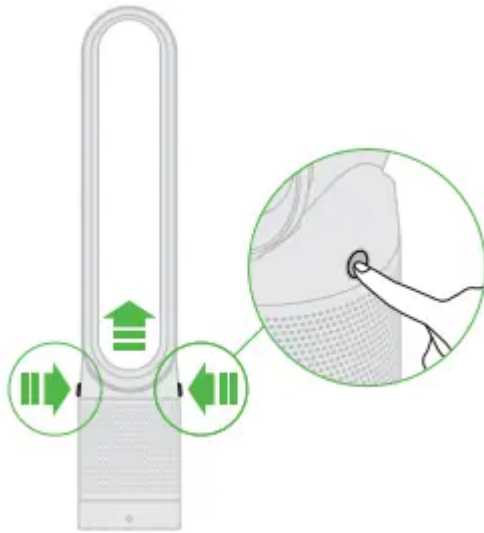

• : Press buttons to lift off loop amplifier and lift off filter.

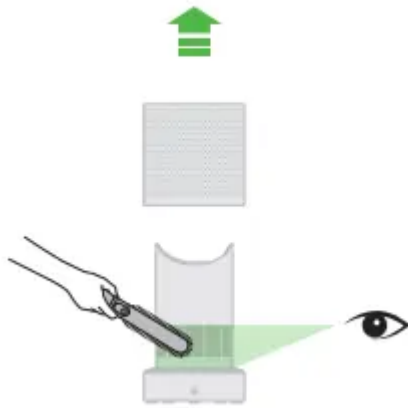

• : Look for blockages in the air inlet holes under the filter and use a soft brush to remove debris. Replace the filter and then the loop amplifier.

Cleaning

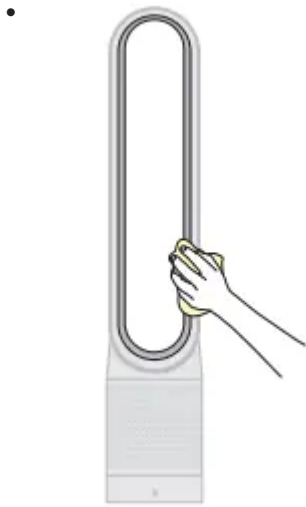

: Ensure the machine is unplugged. Dust may accumulate on the surface of the machine. Wipe dust from the loop amplifier, filter unit and other parts with a dry or damp cloth when dust accumulates.

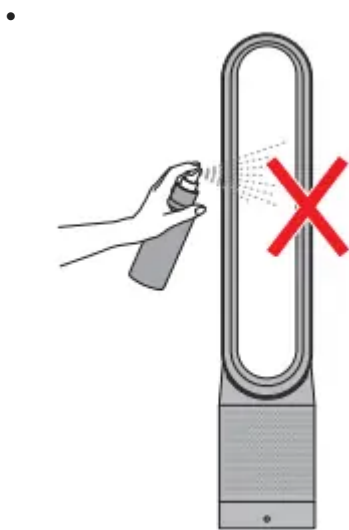

: Do not use detergents or polishes to clean the machine.



: Clean the hatch every time the filter is replaced. Open the small hatch on the side of the machine. Use a cotton swab to clean inside and remove any debris. This maintains sensor accuracy and ensures the continuing high performance of the machine.

Replacing the filter unit

1. When your non-washable filter unit needs replacing the machine will display the pattern shown. To replace the non-washable filter unit, follow these steps. Ensure your machine is unplugged. Your Dyson machine is programmed to remind you to replace the filter unit after 12 months based on 12 hours usage a day. Please note your indicator will activate sooner with more use. The indicator is only a guide and you may need to replace the filter unit more regularly.

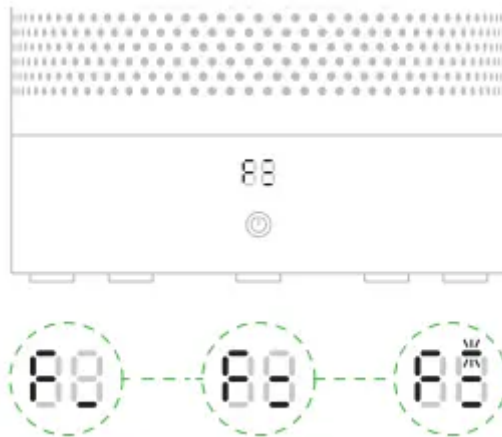

2

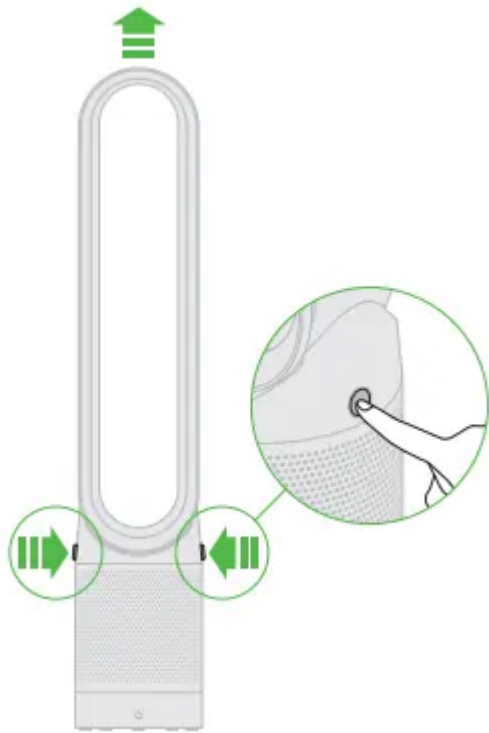

3

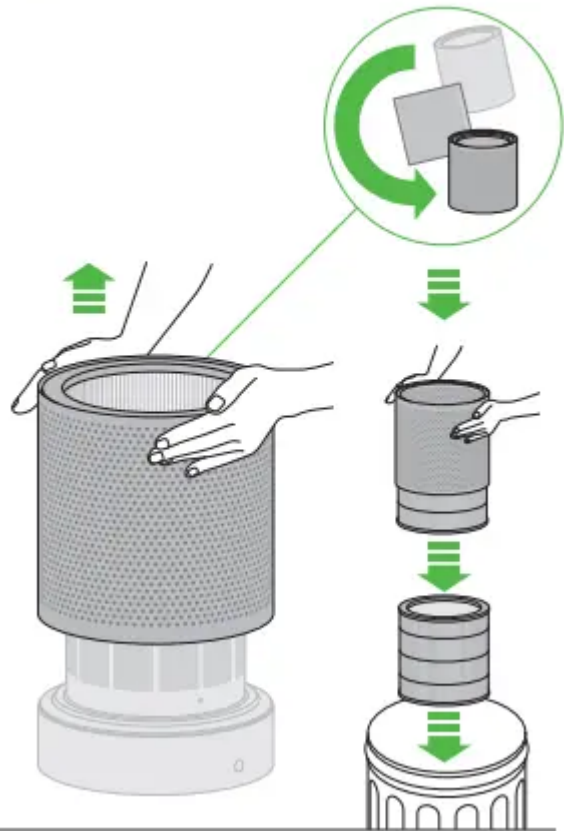

4

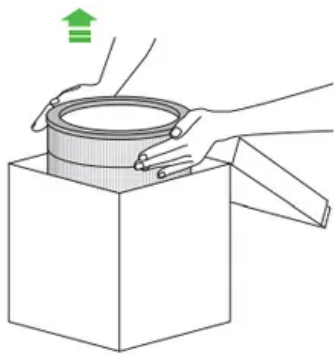

5

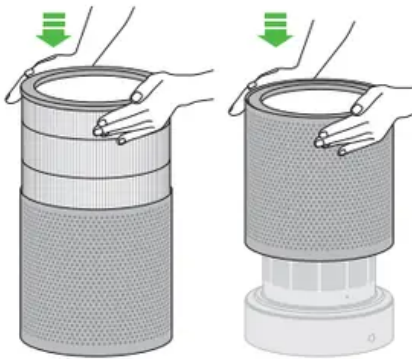

6

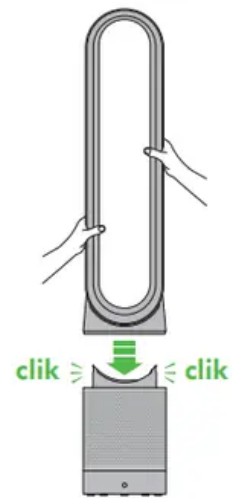

7. When you have re-assembled your appliance, press and hold the 'Standby ON/OFF' button for 6 seconds.



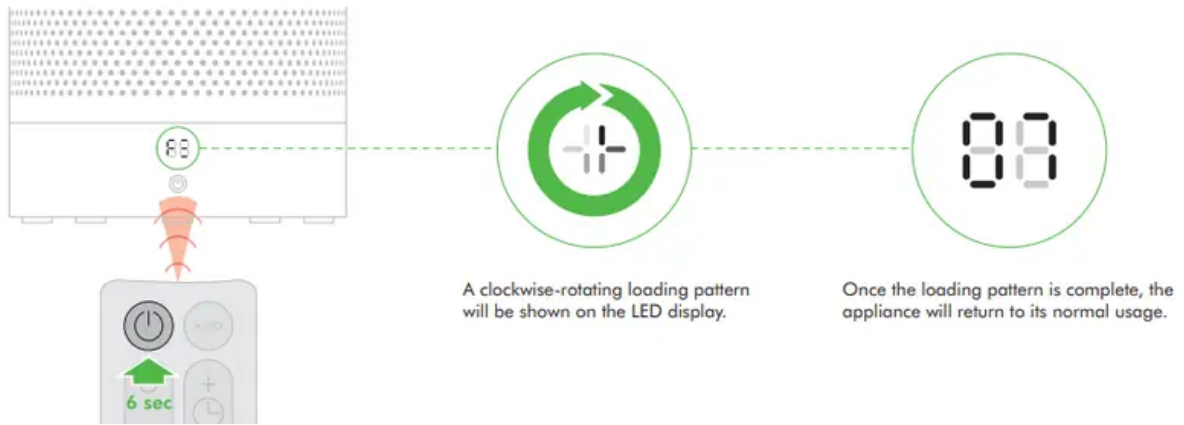

Clearing your Wi-Fi settings



21 secs

: It is possible to remove your network details from the appliance.



- Press and hold the ON/ OFF button on the appliance for longer than 20 seconds.
- The Wi-Fi symbol will flash alternately between white and green to indicate that your network details have been removed.

If you clear your network settings the appliance will not connect to the Dyson Link app.

Enabling or Disabling Wi-Fi



10-20 secs



Wi-Fi can be enabled or disabled by pressing and holding the ON/ OFF button on the appliance for between 10 and 20 seconds.

Wi-Fi disabled



Wi-Fi enabled



-  Solid white = Wi-Fi connected
-  Flashing white = Wi-Fi connecting
-  Flashing green = Wi-Fi is ready to connect to your Dyson Link app
 - Off = Wi-Fi disabled

If Wi-Fi is disabled, the appliance will not connect to the Dyson Link app.

Troubleshooting



If you see a flashing 'E' when trying to use the appliance, it is unable to do what has been requested.



If you see a solid 'E' when trying to use the appliance, it shows the appliance has stopped functioning correctly

Make sure you have checked the following:

- The room temperature is above 5°C/ 41°F.

- There are no blockages in the inlet grille or loop amplifier outlet.
- The filter has been correctly assembled and doesn't need to be replaced.
- The appliance is correctly plugged in directly to the wall outlet.

If the message still displays, unplug and leave for 10 seconds before turning on again.

If the problem persists, please call the Dyson Helpline.

USER SERVICING INSTRUCTIONS

DO NOT REPLACE ATTACHMENT PLUG - Risk of fire. Do not replace attachment plug. Contains a safety device (fuse) that should not be removed. Discard product if the attachment plug is damaged.

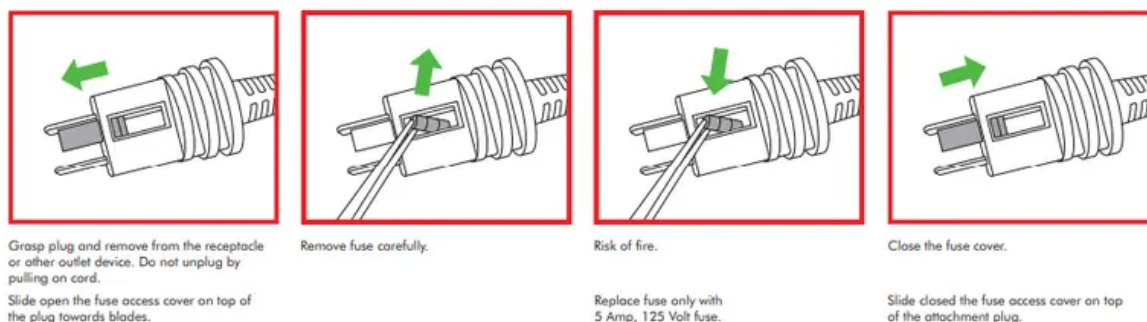

USING YOUR DYSON MACHINE PLEASE READ THE "IMPORTANT SAFETY INSTRUCTIONS" IN THIS DYSON OPERATING MANUAL BEFORE PROCEEDING.

LOOKING AFTER YOUR DYSON MACHINE

- Do not carry out any maintenance or repair work other than that shown and described in this Dyson Operating Manual, or advised by the Dyson Helpline.
- Always disconnect the plug from the main outlet before inspecting for problems. If the machine will not operate, first check the main outlet has electricity supply and that the plug is properly inserted into the outlet.
- If the fuse needs replacing, please check 'User servicing instructions'.

CONTROL WITHOUT REMOTE

- The machine can be controlled through your Dyson Link app.

REPLACEABLE PARTS

BATTERY REPLACEMENT - CAUTION

- Unscrew the battery compartment on the remote control. Loosen the base and pull to remove the battery.
- Do not install backwards or short circuit the batteries.

- Do not attempt to dismantle or charge the batteries. Keep away from fire.
- Follow battery manufacturers' instructions when installing new batteries (battery type CR 2032).
- Choking hazard – This remote control unit contains a small battery. Keep the remote control away from children and do not swallow the battery. If the battery is swallowed seek medical advice at once.

NON-WASHABLE FILTER UNIT

- Your filter unit is non-washable and non-recyclable.
- To replace your filter unit follow the steps as shown.
- To dispose of your old filter unit: remove it from the appliance and place it in your household waste bin.
- A new filter unit can be purchased at www.dyson.com/filter.

AUTO MODE

- A period of 6 days is required after the machine is first used for the sensor to calibrate. During this period the machine may be more sensitive to VOCs than normal.

DYSON CUSTOMER CARE

- THANK YOU FOR CHOOSING TO BUY A DYSON MACHINE
- If you have a question about your Dyson machine, call the Dyson Helpline with your serial number and details of where and when you bought the machine. Most questions can be solved over the phone by one of our Dyson Helpline staff. If your Dyson machine needs service, call the Dyson Helpline so we can discuss the available options. If your Dyson machine is under warranty, and it is a covered repair, it will be repaired at no cost. Your serial number can be found on your rating plate which is on the base of the machine.

PLEASE REGISTER AS A DYSON MACHINE OWNER

- To help us ensure you receive prompt and efficient service, please register as a Dyson appliance owner. There are four ways to do this:
- Online at www.dyson.com
- Telephone the Dyson Helpline
- Complete the enclosed Warranty Form and mail it to us.
- SMARTPHONE. Download the Dyson Link app and you will be taken through registration as part of the set up. This will confirm ownership of your Dyson machine in the event of an insurance loss, and enable us to contact you if necessary

IMPORTANT SAFETY INSTRUCTIONS

BEFORE USING THIS MACHINE READ ALL INSTRUCTIONS AND CAUTIONARY MARKINGS IN THIS MANUAL AND ON THE MACHINE

When using an electrical machine, basic precautions should always be followed, including the following:

WARNING: THE FAN AND THE REMOTE CONTROL BOTH CONTAIN MAGNETS

1. Pacemakers and defibrillators may be affected by strong magnetic fields. If you or someone in your household has a pacemaker or defibrillator, avoid placing the remote control in a pocket or near to the device.
2. Credit cards and electronic storage media may also be affected by magnets and should be kept away from the remote control and the top of the machine.

WARNING: These warnings apply to the machine, and also where applicable, to all tools, accessories, chargers or mains adaptors. **TO REDUCE THE RISK OF FIRE, ELECTRIC SHOCK, OR INJURY:**

1. This Dyson machine is not intended for use by persons (including children) with reduced physical, sensory or reasoning capabilities, or lack of experience and knowledge, unless they have been given supervision or instruction concerning use of the machine by a person responsible for their safety.
2. Ensure machine is fully assembled in line with the instructions before use. Do not dismantle the machine or use without the loop amplifier fitted.
3. Do not allow to be used as a toy. Close attention is necessary when used by or near children. Children should be supervised to ensure that they do not play with the machine.
4. Use only as described in this Dyson Operating Manual. Do not carry out any maintenance other than that shown in this manual, or advised by the Dyson Helpline.
5. Suitable for dry location ONLY. Do not use outdoors or on wet surfaces and do not expose to water or rain.
6. Do not handle any part of the plug or machine with wet hands.
7. Do not operate any machine with a damaged cord or plug. Discard the machine or return to an authorized service facility for examination and/or repair. If the supply cord is damaged it must be replaced by Dyson, its service agent or similarly qualified person in order to avoid a hazard.
8. If the machine is not working as it should, has received a sharp blow, has been dropped, damaged, left outdoors, or dropped into water, do not use and contact the Dyson Helpline.
9. Do not stretch the cord or place the cord under strain. Keep cord away from heated surfaces.

10. Do not run cord under carpeting. Do not cover cord with throw rugs, runners or similar coverings. Do not route cord under furniture or appliances. Arrange cord away from traffic area and where it will not be tripped over.
11. Do not unplug by pulling on the cord. To unplug, grasp the plug, not the cord. The use of an extension cord is not recommended.
12. Do not put any object into openings or the inlet grill. Do not use with any opening blocked; keep free of dust, lint, hair, and anything that may reduce airflow.
13. Do not use any cleaning agents or lubricants on this machine. Unplug before cleaning or carrying out any maintenance.
14. Always carry the machine by the base, do not carry it by the loop amplifier.
15. Turn off all controls before unplugging. Unplug from outlet when not in use for extended periods. To avoid a tripping hazard, safely coil the cord.
16. Do not use near furnaces, fireplaces, stoves or other high temperature heat sources.
17. Do not use in conjunction with or directly next to an air freshener or similar products. Keep essential oils and chemicals away from the appliance.
18. This product employs overload protection (fuse). A blown fuse indicates an overload or short-circuit situation. If the fuse blows, unplug the product from the outlet. Replace the fuse as per the user servicing instructions (follow product marking for proper fuse rating) and check the product. If the replacement fuse blows, a short-circuit may be present and the product should be discarded or returned to an authorized service facility for examination and/or repair.
19. Choking hazard – This remote control unit contains a small battery. Keep the remote control away from children and do not swallow the battery. If the battery is swallowed seek medical advice at once.
20. When removing or replacing the filter, take care to keep your fingers clear between the filter and the purifier base.
21. **WARNING:** This product contains chemicals known to the State of California to cause cancer, birth defects or other reproductive harm.

POLARIZATION INSTRUCTIONS

- To reduce the risk of electric shock, this machine has a polarized plug (one blade is wider than the other). This plug will fit in a polarized outlet only one way. If the plug does not fit fully in the outlet, reverse the plug. If it still does not fit, contact a qualified electrician to install the proper outlet. Do not attempt to defeat this safety feature and do not change the plug in any way



Do not pull
on the cord.



Do not store
near heat
sources.

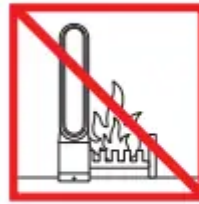

Do not use near
open flames.



Do not carry
by the loop
amplifier.

Warning

This content is compiled from multiple sources and is provided for reference purposes only. It may not be complete or fully applicable to all situations. If you are unable to resolve your issue, please contact the product manufacturer or an authorized service provider for official support.