

## Package Contents and Technical Specifications

### Package Contents



Robot



Charging Dock



Remote Control  
(with batteries)



Instruction Manual



(4) Side Brushes



Battery Pack



(2) Advanced Wet/Dry  
Cleaning Cloths

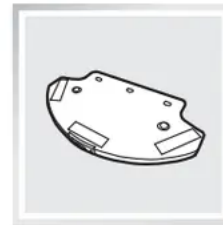

Advanced Wet/Dry  
Reservoir

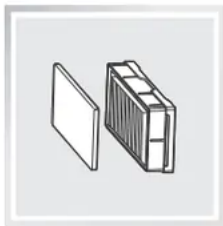

Sponge Filter and  
High Efficiency Filter



Measuring Cup



Quick Start Guide

### Specifications

<b>Model</b>	<b>DB3G.11</b>		
Working Voltage	12V DC	Rated Power	40W
<b>Charging Dock Model</b>	<b>CH1465A</b>		
Rated Input Voltage	100-240V AC	Rated Output Voltage	20V DC
Rated Output Current	1A	Rated Power	25W
<b>Remote Control Model</b>	<b>RC1507</b>	Input Voltage	3V DC
<b>Battery</b>	Ni-MH 3000mAh		

- Technical and design specifications may be changed in the course of continuous product improvement .

## Product Diagram

### Robot

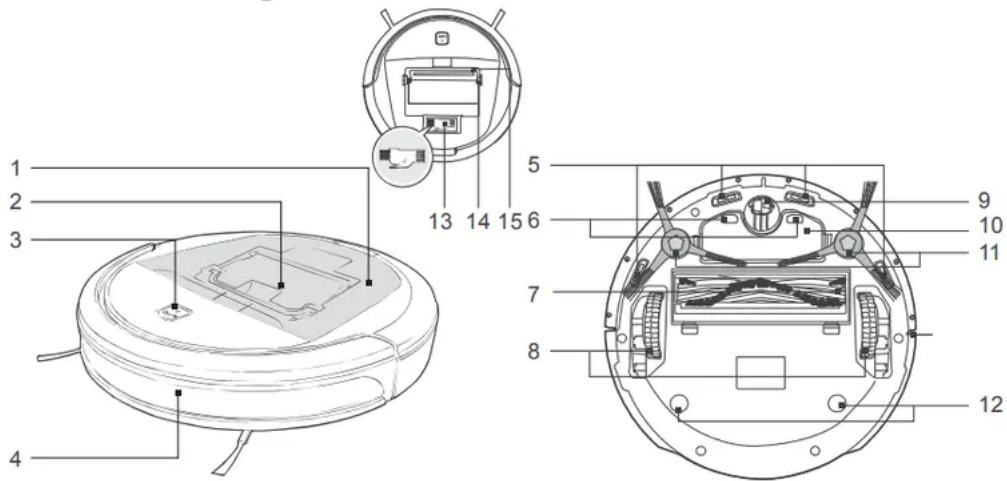

1. Top Cover
2. Dust Bin
3. AUTO Mode Button
4. Anti-Collision Sensors
5. Anti-Drop Sensors
6. Charging Contacts
7. Main Brush
8. Driving Wheels
9. Universal Wheel
10. Battery Pack
11. Side Brushes
12. Advanced Wet/Dry Reservoir Slots
13. Multi-Function Cleaning Tool
14. Upgrade Port (for Customer Service only)
15. Infrared Receiver for the Remote Control

### Control Panel



1. AUTO Mode Button
2. Wi-Fi Indicator Light

### Charging Dock

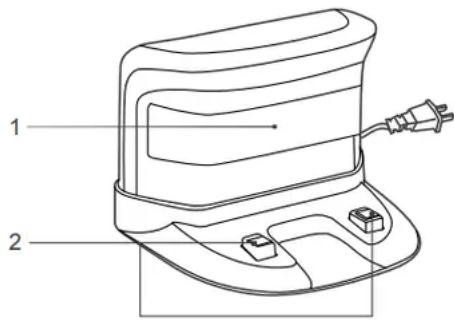

- 1. Infrared Signal Generators
- 2. Charging Dock Pins

**Remote Control**

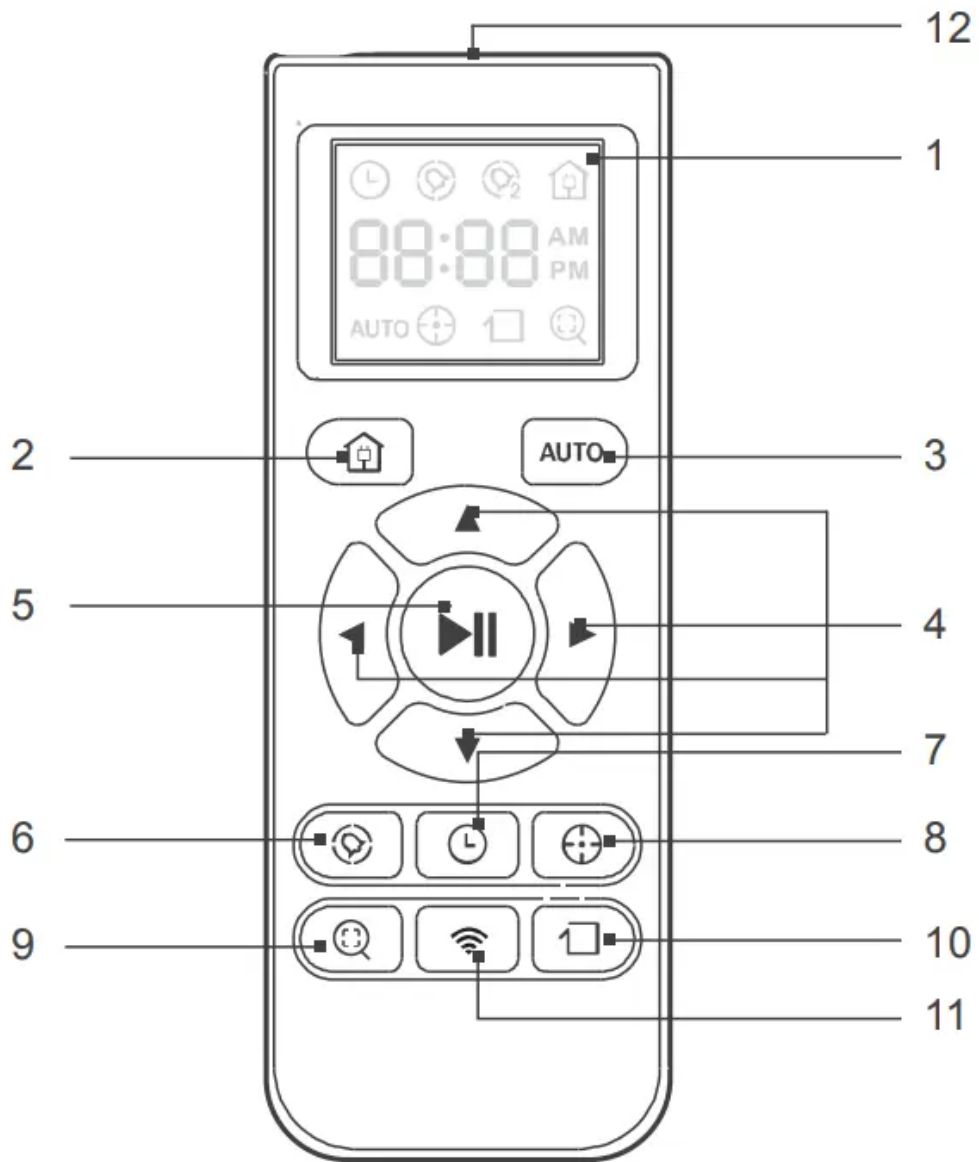

- 1. LCD Screen
- 2. Return to Charger Mode Button
- 3. AUTO Mode Button
- 4. Direction Control Buttons



- 5. START/PAUSE Button
- 6. Time Scheduling Button
- 7. Set Current Time Button
- 8. Spot Cleaning Mode Button
- 9. Intensive Cleaning Mode Button
- 10. Edge Cleaning Mode Button
- 11. Network Setup Button
- 12. Infrared Emitter

**Dust Bin**

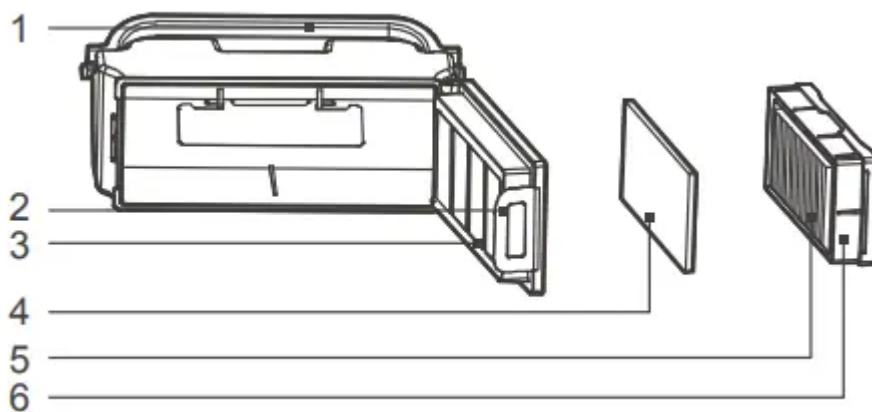

- 1. Dust Bin Handle
- 2. Dust Bin Lock
- 3. Filter Net
- 4. Sponge Filter
- 5. High Efficiency Filter
- 6. Dust Bin Cover

**Advanced Wet/Dry Reservoir**

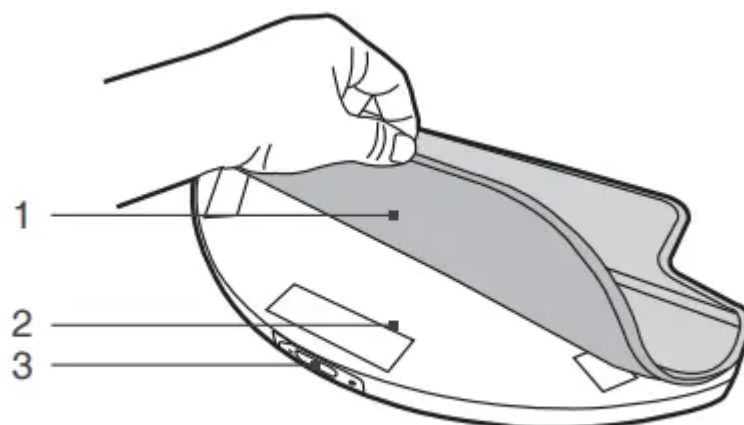

1. Advanced Wet/Dry Cleaning Cloth
2. Advanced Wet/Dry Reservoir
3. Water Inlet

## Operating and Programming

### Notes Before Cleaning

Before operating DEEBOT, take a few moments to survey the area to be cleaned and remove any obstacles.

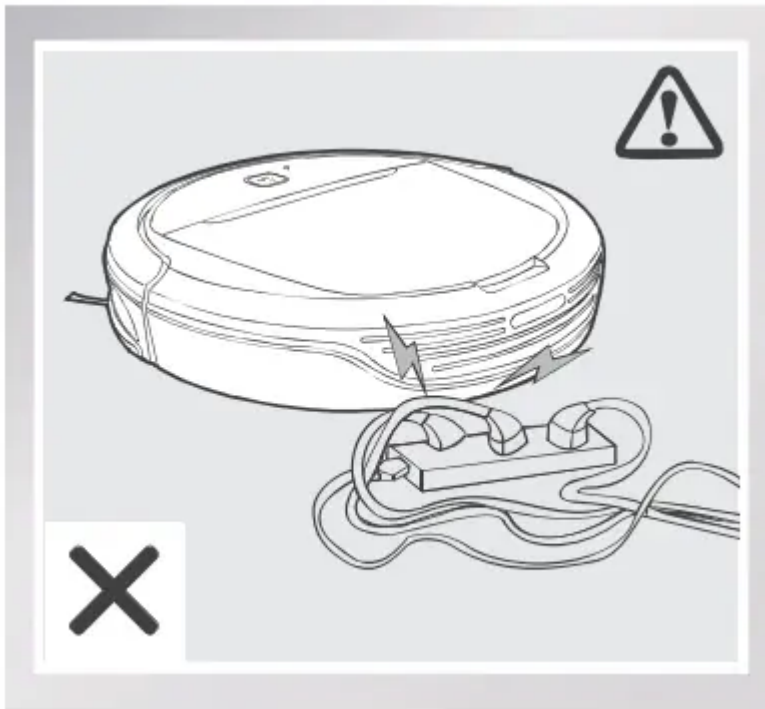

Remove power cords and small objects from the floor that could entangle the product

The product is not suitable for use on long-pile carpet. Before using the product near an area rug or on a short-pile area rug with tasseled edges, please fold area rug edges under themselves.

Please be aware that the robot needs at least an 8 cm (3") clearance to clean under furniture without complications.

If there is a step or stairs in the cleaning area, please operate DEEBOT to ensure its AntiDrop Sensors can detect the drop off. It may be necessary to place a physical barrier at the edge of the drop off to keep the unit from falling over the edge.

## Quick Start

### Charging Dock Placement

- Place the Charging Dock on a level floor surface against the wall with the base perpendicular to the ground. Keep the immediate area 2m (6.6') in front of the charger and 1 m (3.3') on both sides of the charger clear of objects and reflective surfaces.
- Plug the Charging Dock in. The Power Indicator Light on the Charging Dock glows

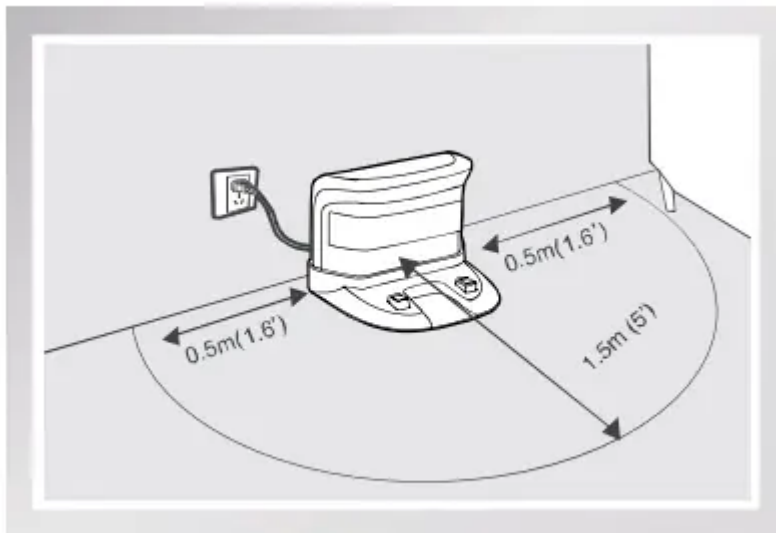

### Install Side Brushes

- Attach Side Brushes to the bottom of DEEBOT by pressing a brush into each slot until it clicks



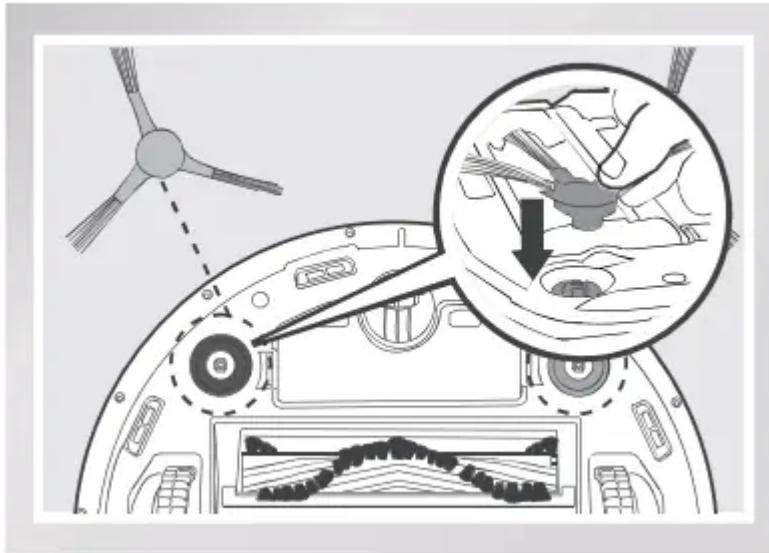

### Install Side Brushes

Attach Side Brushes to the bottom of DEEBOT by pressing a brush into each slot with the matching color until it clicks.



### Power ON

- Press and hold the  button on the robot. DEEBOT is powered ON when the  glows a continuous BLUE.

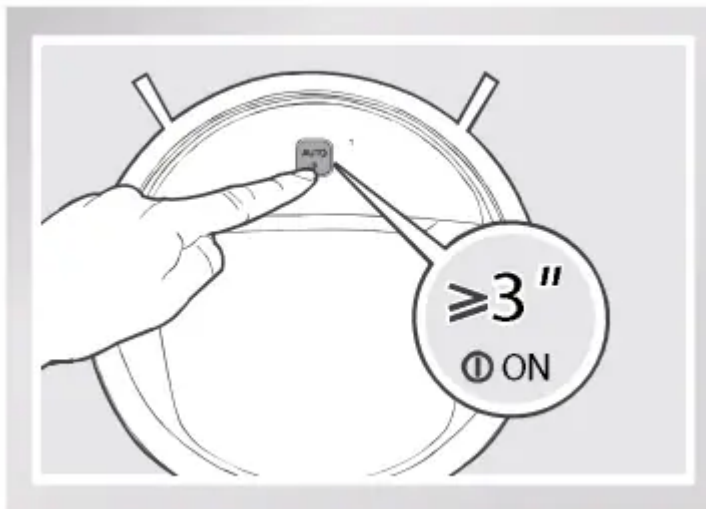

### Charge DEEBOT

- Remove the Advanced Wet/Dry Reservoir before charging DEEBOT.
- Place DEEBOT on the Charging Dock making sure the Charging Contacts on DEEBOT and the Charging Dock Pins make a connection.
- Charge DEEBOT for at least 4 hours before the first use.

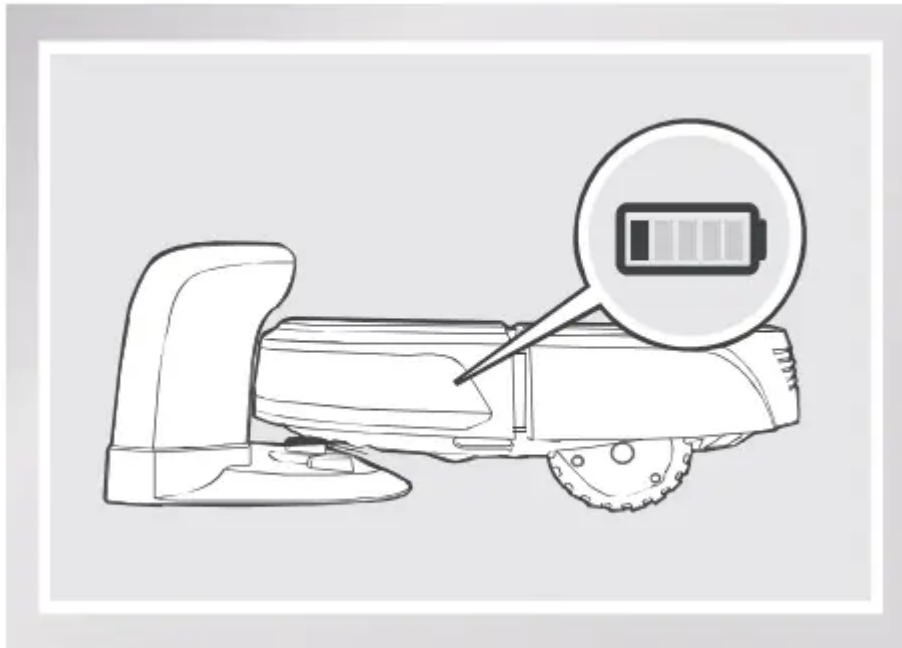

### Attach a Cleaning Cloth, if Desired

- To use DEEBOT's Optional Advanced Mopping System, attach the provided Cleaning Cloth.

\* When using the optional mopping feature, fold area rug edges under themselves so DEEBOT will avoid the rug.

\* Please see section 3.6 Optional Advanced Wet/Dry Mopping System for complete instructions.



### Start



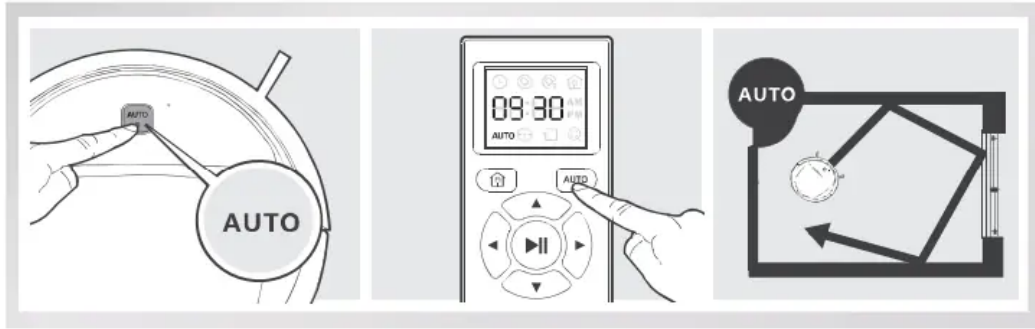

Press the  button on DEEBOT or the AUTO Mode Button on the Remote Control. DEEBOT starts to work immediately in AUTO Cleaning Mode.



\* To choose another Cleaning Mode, please refer to section 3.3 Cleaning Mode Selection for details.

\* DEEBOT can be directed using the Direction Control Buttons on the Remote Control or App when Paused.

### Pause

- 
 Pause DEEBOT by pressing the  button on DEEBOT or the START/PAUSE Button on the Remote Control.

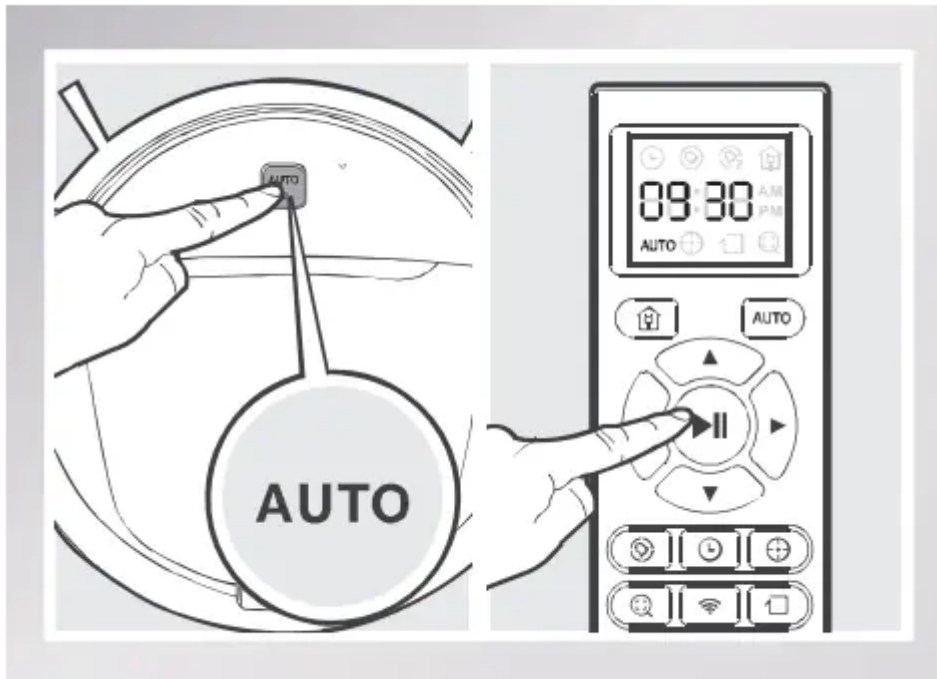

\* The AUTO Mode Button on the robot's Control Panel stops glowing when the robot is paused for more than 10 minutes. Press AUTO Mode Button on the robot to wake up the robot, or press any button on the Remote Control to start the DEEBOT immediately.

## Power OFF

- Pause DEEBOT. Press and hold the button on the robot. DEEBOT is powered OFF when the button stops glowing.

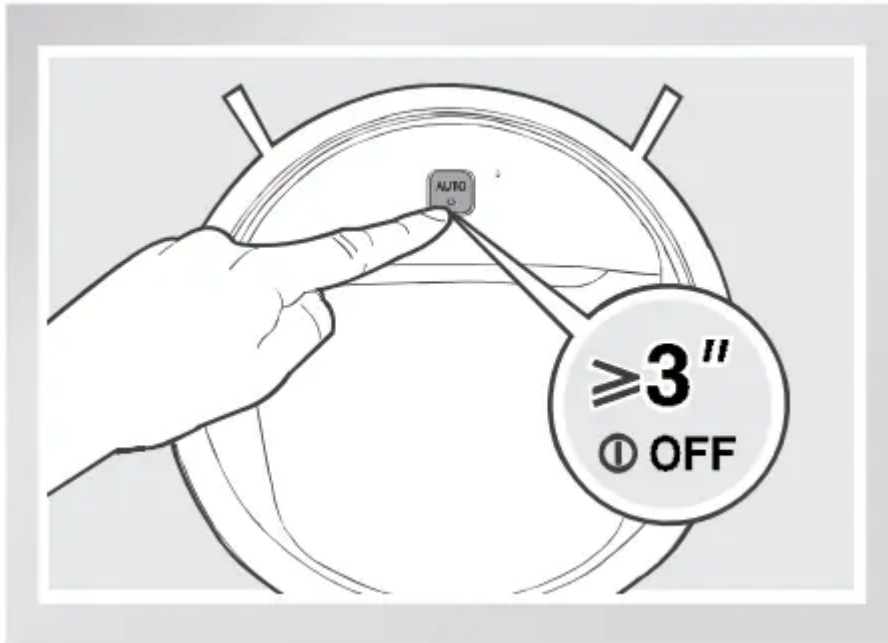

\* When DEEBOT is not cleaning, it is suggested to keep it powered ON and charging instead of powered OFF.

## Cleaning Mode Selection

DEEBOT has several cleaning modes to choose from to effectively clean different floors. Cleaning modes are selected using the Remote Control

### AUTO Cleaning Mode

- This is the most commonly used mode. In AUTO Cleaning Mode, DEEBOT cleans in a straight line and changes direction when it meets an obstacle.
- To start AUTO Cleaning Mode, press the AUTO Mode Button on the robot, or on the App main screen.

### Intensive Cleaning Mode

This mode is good for aggressive cleaning or for extremely dirty or dusty floors. To start Intensive Cleaning, press the Intensive Cleaning Button on the Remote Control. In this mode, DEEBOT follows the same cleaning pattern as Automatic Cleaning Mode, but with stronger suction power and higher Main Brush rotating speed and performs a more thorough cleaning.

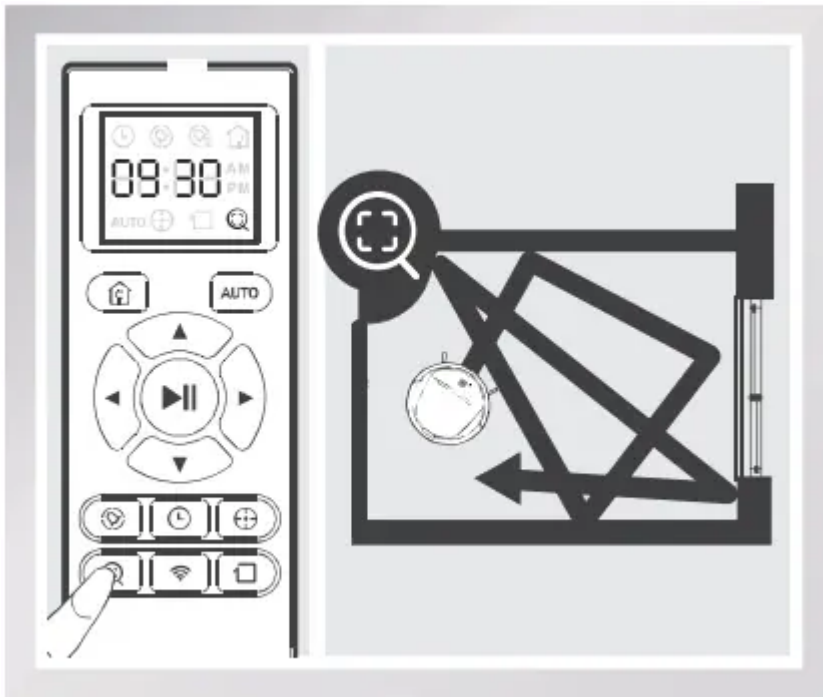

### Spot Cleaning Mode (2-5 minutes)

- This mode is applicable for an area of highly concentrated dirt or dust. In Spot Cleaning Mode, DEEBOT focuses on a specific area to clean. DEEBOT cleans the area in a spiral pattern and stops when it completes Spot Cleaning.
- To start Spot Cleaning Mode, press the Spot Mode Button on the Remote Control, or  on the App main screen.

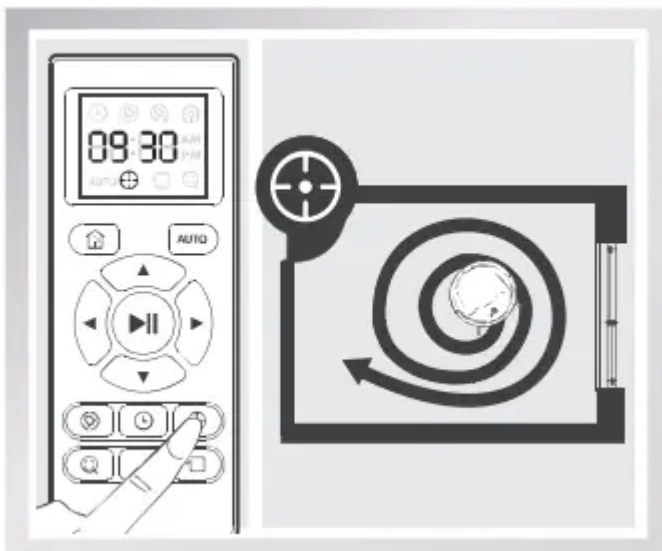

## Edge Cleaning Mode

- This mode is good for cleaning the edges and corners of a room. To start Edge Cleaning Mode, press the Edge Cleaning Mode Button on the Remote Control or  on the App main screen. In Edge Cleaning Mode, DEEBOT cleans along a border (e.g. wall).

\* Use the App to adjust the suction power of AUTO Cleaning Mode, Spot Cleaning Mode and Edge Cleaning Mode already in process.

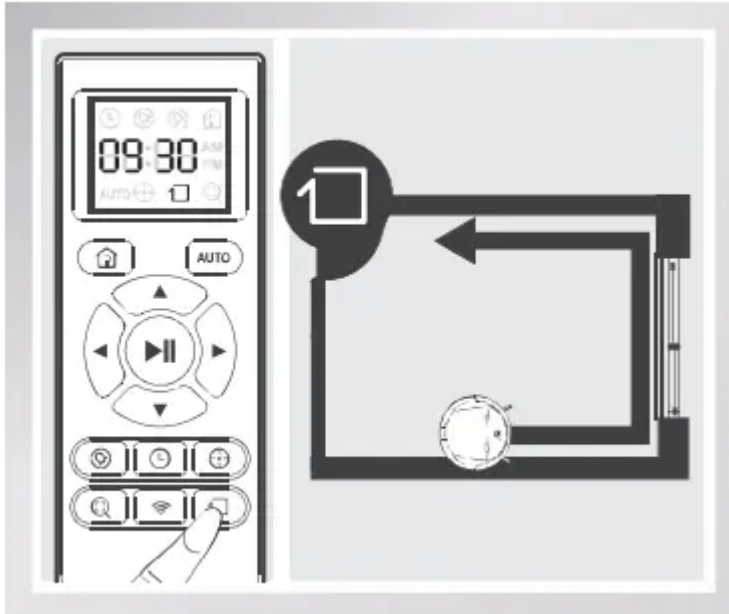

## Return to Charger Mode

When battery power gets low, DEEBOT automatically switches to Return to Charger Mode and returns to the Charging Dock to recharge itself.

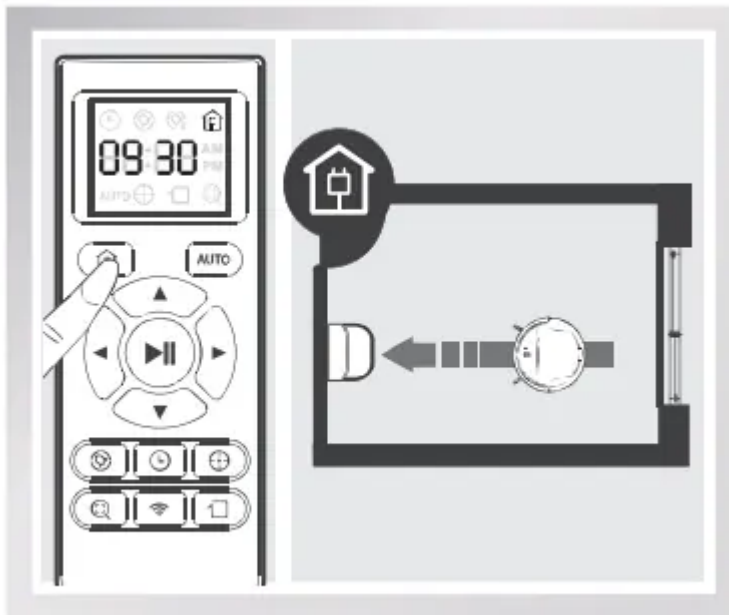

\* DEEBOT can also be sent back to the Charging Dock at any time by pressing the Return to Charger Button on the Remote Control or on the App main screen.

### **Programming the Robot**

DEEBOT has a Time Scheduling function. DEEBOT can be programmed to automatically clean at a specific time using the Remote Control, even if nobody is at home. The current time of day and the cleaning times are scheduled using the Remote Control.

\* All scheduled cleanings are performed in AUTO Cleaning Mode.

\* The Remote Control uses a 12-hour clock with "AM" and "PM" indicators.

#### **Set the Current Time of Day**

Press button on the Remote Control and the "hour" (first two digits) flashes on the Remote Control LCD Screen.

Press the up and down Direction Control Buttons to adjust "hour" and "minute" number. Press the left and right Direction Control Buttons to switch between "hour" and "minute."

Press button on the Remote Control to confirm and save the current time of day.

#### **Schedule the Cleaning Time using Remote Control**

Press button on the Remote Control and the "hour" (first two digits) flashes on the Remote Control Screen.

Press the up and down Direction Control Buttons to adjust "hour" and "minute" number. Press the left and right Direction Control Buttons to switch between "hour" and "minute."

Press button on the Remote Control to confirm and save the scheduled cleaning time.

DEEBOT beeps. DEEBOT automatically cleans at the scheduled cleaning time every day.

## Cancel Scheduled Cleaning Time using Remote Control

To cancel the scheduled cleaning time, press and hold button for 3 seconds until disappears from the Remote Control LED Screen and the robot beeps. The scheduled cleaning time is cancelled.

## Alarm Indicator and Sounds

If DEEBOT detects a problem and needs your assistance, it emits alarm beeps and the AUTO Mode Button flashes RED.

Alarm Sound	Problems	Solution
One Beep	Driving Wheel Malfunction	Check Driving Wheels for tangled hair or debris and clean as described in section 4 Maintenance
Three Beeps	Driving Wheel Malfunction	Turn over the robot. Press Driving Wheels to check for a clicking sound. If they do not click, please contact Customer Service.
	DEEBOT gets into trouble while working and stops	Manually remove the obstacles and restart DEEBOT.
Four Beeps	Dust Bin Malfunction	Remove the Dust Bin and re-install it properly. If the robot still emits the alarm, please contact Customer Service.
Five Beeps	Low Battery	Manually place the robot on the Charging Dock to charge.
Six Beeps	Side Brush Malfunction	Check Side Brushes for tangled hair or debris and clean as described in section 4 Maintenance.
Seven Beeps	Anti-Drop Sensor Malfunction	Check Anti-Drop Sensors for dust and clean as described in section 4 Maintenance.

## Maintenance

Before performing cleaning and maintenance, power OFF DEEBOT and unplug the Charging Dock

## Dust Bin and Filters

Open DEEBOT's Top Cover and remove the Dust Bin. Open the Dust Bin Cover and empty the Dust Bin.

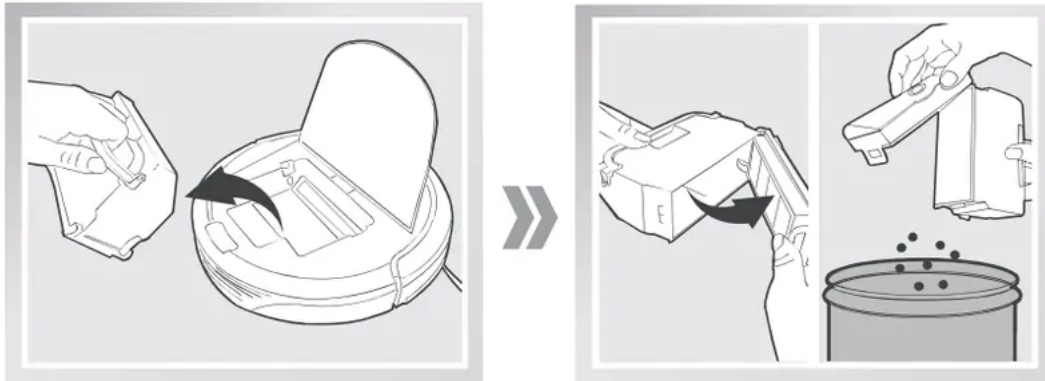

Remove the Sponge Filter and High Efficiency Filter. Pat the High Efficiency Filter clean. Do not rinse the High Efficiency Filter under water.

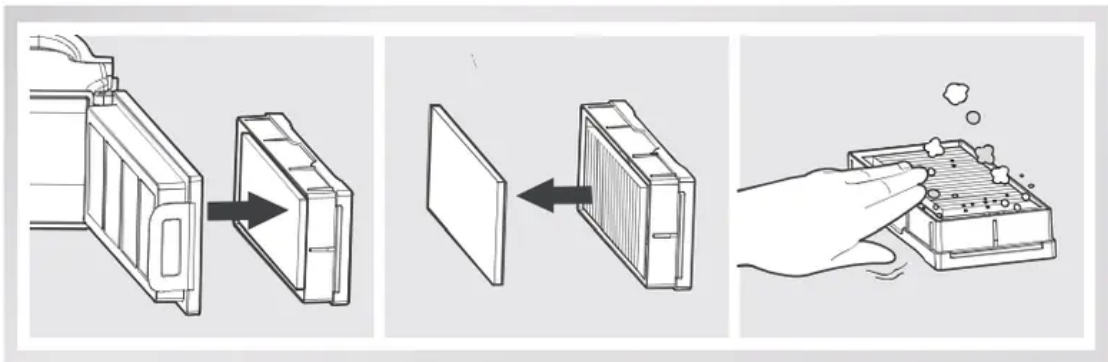

Rinse the Sponge Filter, Dust Bin and Filter Net under running water.

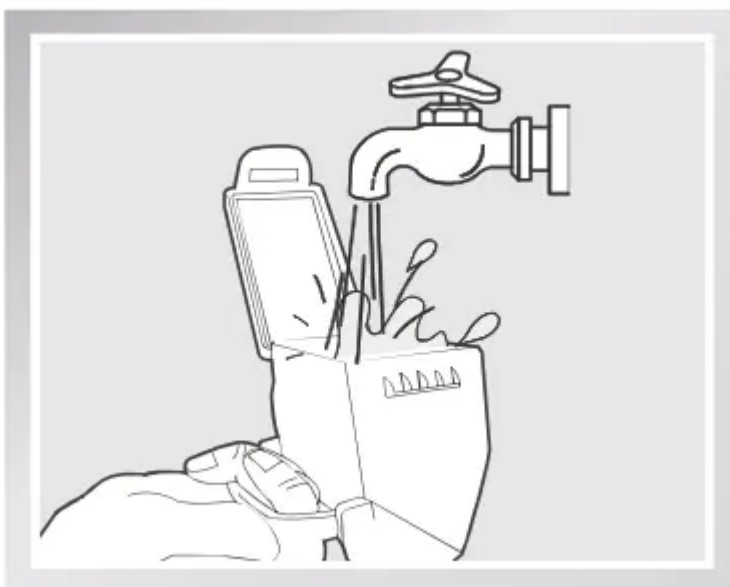

Dry the Sponge Filter, Dust Bin and Filter Net completely before reinstalling.

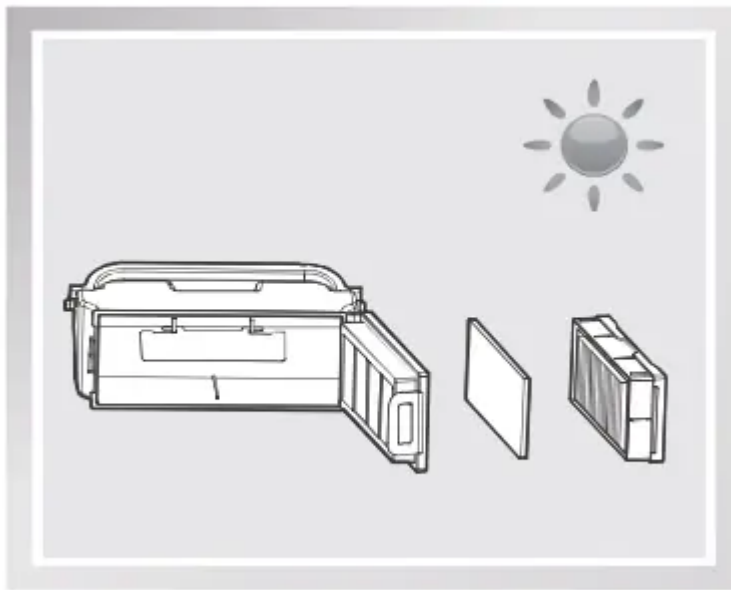

### **Advanced Wet/Dry Cleaning Cloth, Advanced Wet/Dry Reservoir**

Cleaning the Advanced Wet/Dry Cleaning Cloth If the mopping system was used, remove the Advanced Wet/Dry Reservoir from the bottom of DEEBOT and remove the Cleaning Cloth.

Empty any remaining water from the Reservoir.

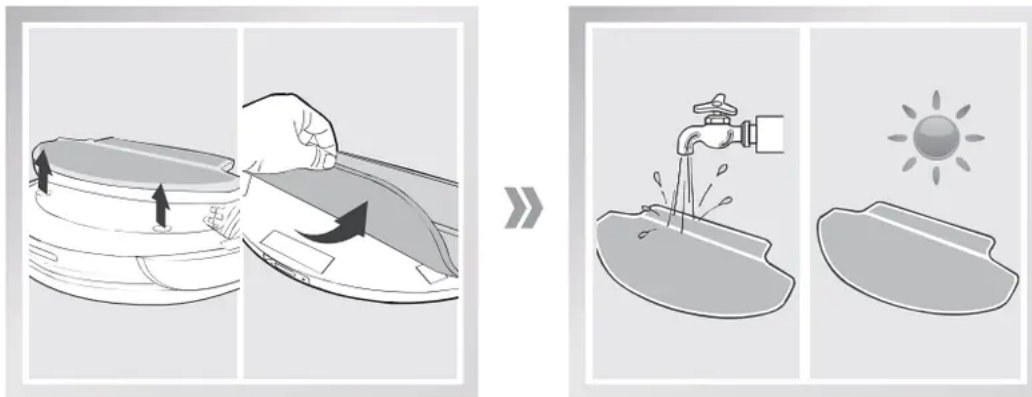

### **Cleaning the Advanced Wet/Dry Reservoir**

If the mopping system was used, remove the Advanced Wet/Dry Reservoir from the bottom of DEEBOT.

Empty any remaining water from the Reservoir and set out to dry.

Wipe the outside of the Advanced Wet/Dry Reservoir with a dry cloth.



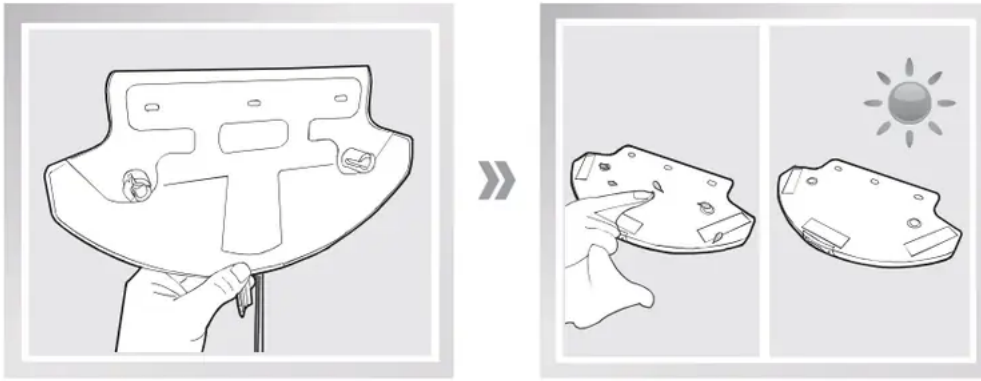

## Main Brush and Side Brushes

\* A Multi-Function Cleaning Tool is provided for easy maintenance. Handle with care, this cleaning tool has sharp edges.

### Cleaning the Main Brush

Turn the robot over. Push both buttons on the Main Brush Cover and remove it.

Remove the Main Brush.

Use the Multi-Function Cleaning Tool to cut off and remove any hair tangled around the Main Brush.

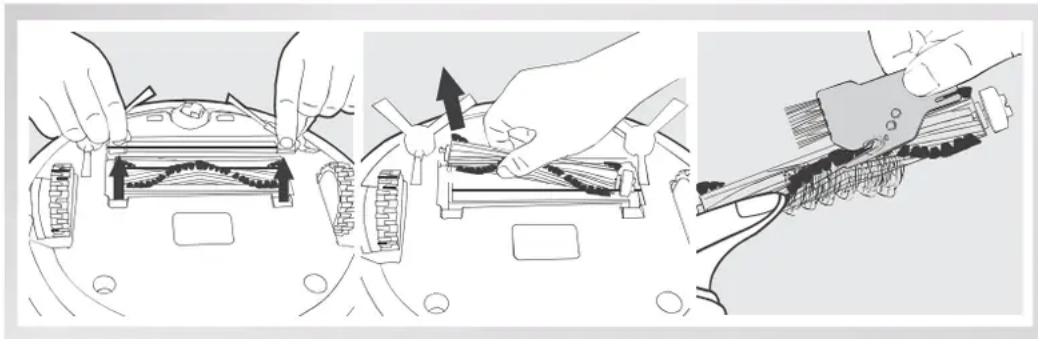

### Cleaning the Side Brushes

Remove the Side Brushes. Wipe the Side Brushes and their slots with a dry cloth.

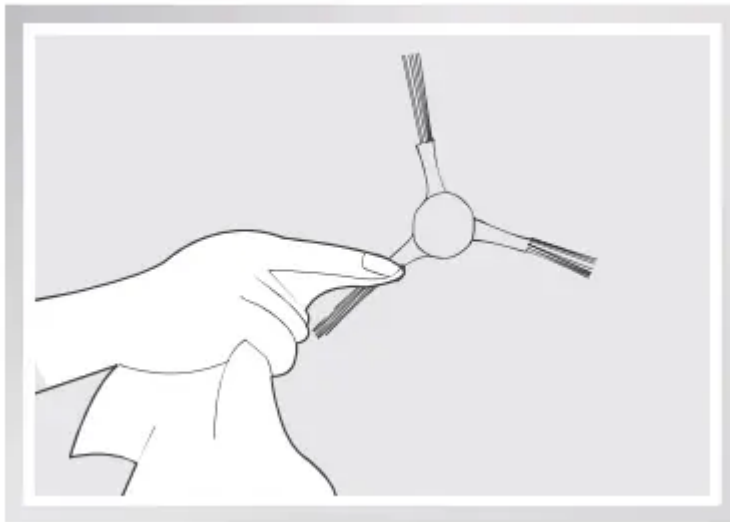

### Other Components

Use the Multi-Function Cleaning Tool to cut off and remove any hair tangled around the Universal Wheel.

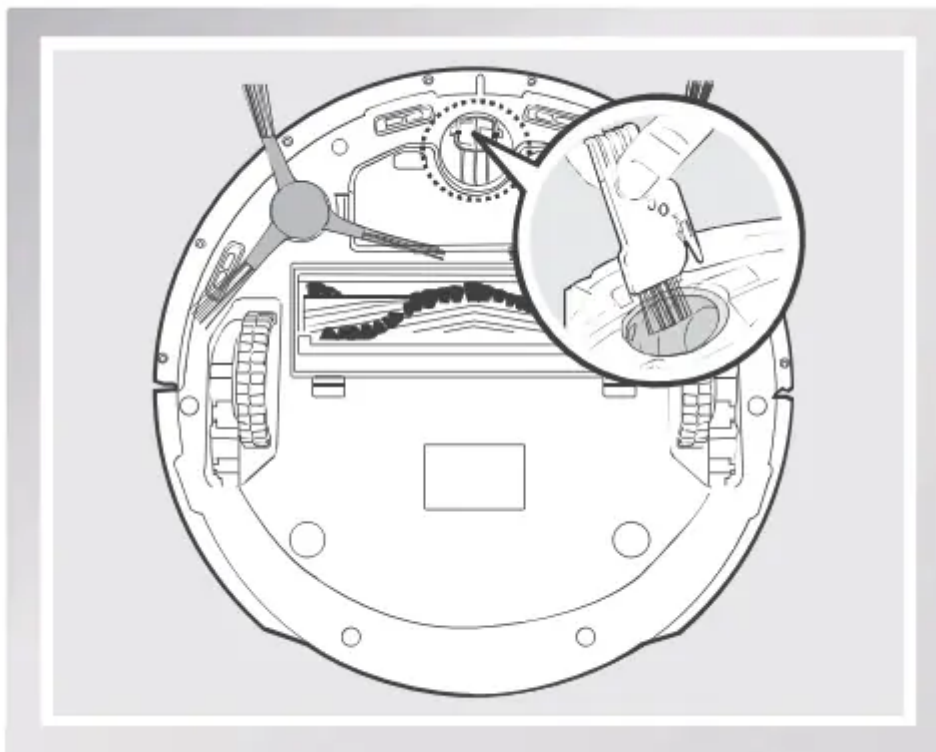

Wipe the Anti-Drop Sensors with the brush or the felt side of the Multi-Function Cleaning Tool to maintain their effectiveness.

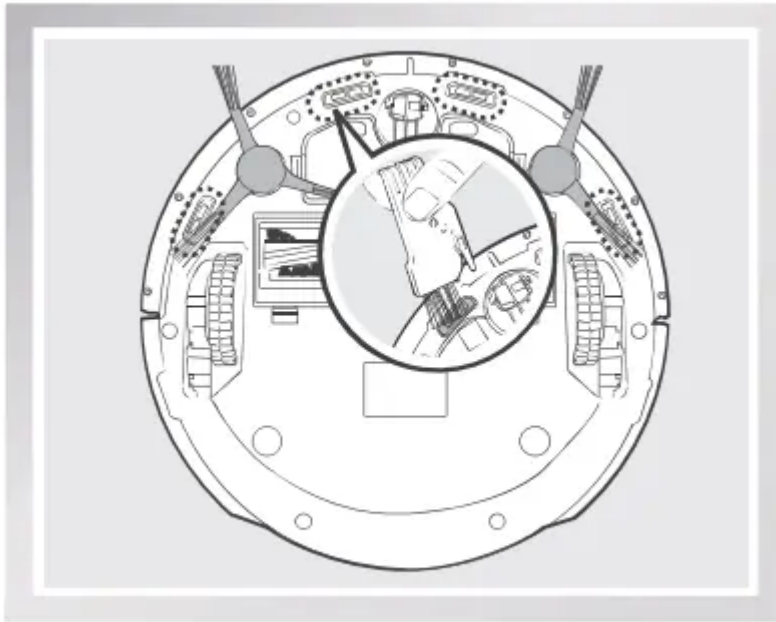

Wipe the Charging Contacts and Charging Dock Pins with the brush of the Multi-Function Cleaning Tool or a dry clean cloth to maintain their effectiveness.

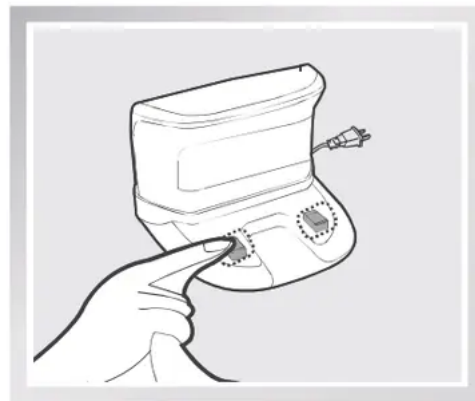
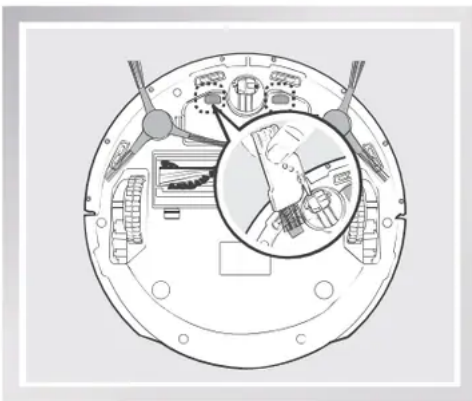

## Regular Maintenance

To keep DEEBOT running at peak performance, perform the maintenance and replacement according to the following frequency. A multi-Function Cleaning Tool is provided for easy maintenance. Handle with care, this cleaning tool has sharp edges.

<b>Robot Part</b>	<b>Maintenance Frequency</b>	<b>Replacement Frequency</b>
Dust Bin	After each use	/
Side brush	Once every 2 weeks	Every 3-6 months
Main Brush	Once per week	Every 6-12 months
Sponge Filter/ HighEfficiency Filter	Once per week (twice per week with pets in home)	Every 4-6 months
Universal Wheel Anti-Drop Sensors Charging Contacts Charging Dock Pins	Once per week	/

## Troubleshooting

Please use this chart to troubleshoot common problems using DEEBOT.



No.	Malfunction	Possible Causes	Solutions
1	DEEBOT will not charge.	DEEBOT is not powered ON.	Press and hold AUTO Mode Button on DEEBOT to power ON.
		DEEBOT has not made a connection with the Charging Dock.	Be sure that DEEBOT's Charging Contacts have made a connection with the Charging Dock Pins. You may move the robot manually to make the connection if necessary.
		Charging Dock is unplugged while DEEBOT is powered ON, which causes battery consumption.	Plug in the Charging Dock and ensure DEEBOT is powered ON. Keep DEEBOT on the Charging Dock to make sure it has a full battery to work at any time.
		The battery is completely discharged.	Re-activate the battery. Place DEEBOT on the Charging Dock by hand, remove after charging for 3 minutes, repeat 3 times; then charge normally
2	DEEBOT gets into trouble while working and stops.	DEEBOT is tangled with something on the floor (electrical cords, drooping curtains, carpet fringe etc.)	DEEBOT will try various ways to get itself out of trouble. If it is unsuccessful, manually remove the obstacles and restart.
		Side Brush is stuck or the rotation speed of the Side Brush decreases.	Remove the debris tangled around the Side Brush. If the Side Brush still rotates slowly, contact Customer Service
			Remove the debris tangled around the Main Brush with the provided Multi-Function



		Main Brush is stuck or the rotation speed of the Main Brush decreases	Gleaning Tool. If the Main Brush still rotates slowly, contact Customer Service.
3	DEEBOT returns to the Charging Dock before it finishes cleaning.	When battery power gets low, DEEBOT automatically switches to Return to Charger Mode and returns to the Charging Dock to recharge itself	This is normal. No solution necessary.
		Working time varies according to floor surface, room complexity and the selected Cleaning Mode.	This is normal. No solution necessary.
4	DEEBOT will not clean automatically at scheduled time.	Time Scheduling function is cancelled.	Set Time Scheduling function as described in section 3.4.
		DEEBOT is powered OFF.	Power ON DEEBOT.
		The robot's battery is low.	Keep DEEBOT powered ON and on the Charging Dock to make sure it has a full battery to work at any time.
		The robot's components are tangled with debris.	Power OFF DEEBOT, clean the Dust Bin, and invert the robot. Clean Side Brushes and the Main Brush as described in section 4.
5	Remote Control failure (effective control range of Remote Control is 5m (16')	The batteries in the Remote Control need to be replaced.	Replace with new batteries making sure they are installed correctly.
		DEEBOT is powered OFF or DEEBOT's battery is low.	Make sure DEEBOT is powered ON and fully charged.



		The infrared signal cannot be transmitted because the Infrared Emitter on the Remote Control or DEEBOT Infrared Receiver on DEEBOT is dirty.	Use a dry cloth or the Multi-Function Cleaning Tool to wipe the Infrared Emitter on Remote Control and the Infrared Receiver on DEEBOT.
		There is other equipment interfering with the infrared signal to DEEBOT.	Avoid using the Remote Control near other equipment using infrared signals.

**Warning**

This content is compiled from multiple sources and is provided for reference purposes only. It may not be complete or fully applicable to all situations. If you are unable to resolve your issue, please contact the product manufacturer or an authorized service provider for official support.

