

Assembly

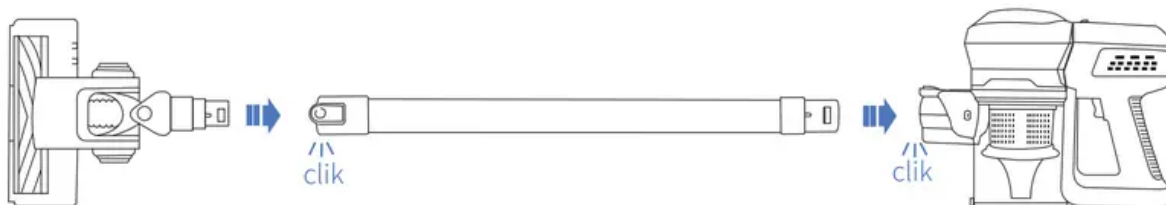

Wash filters: Wash filters with cold water at least every month. Ensure the filters are completely dry before refitting.



Recharging on the dock

Recharging on the dock

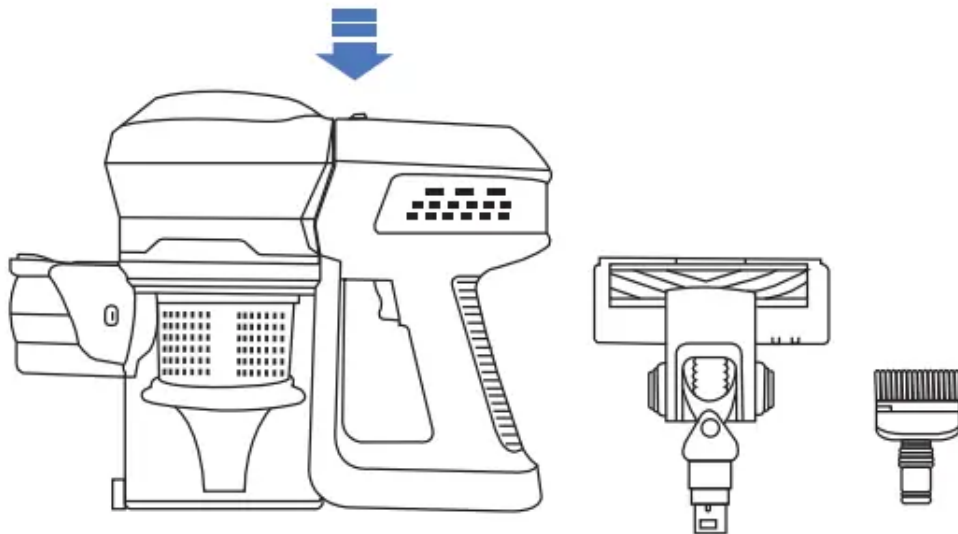
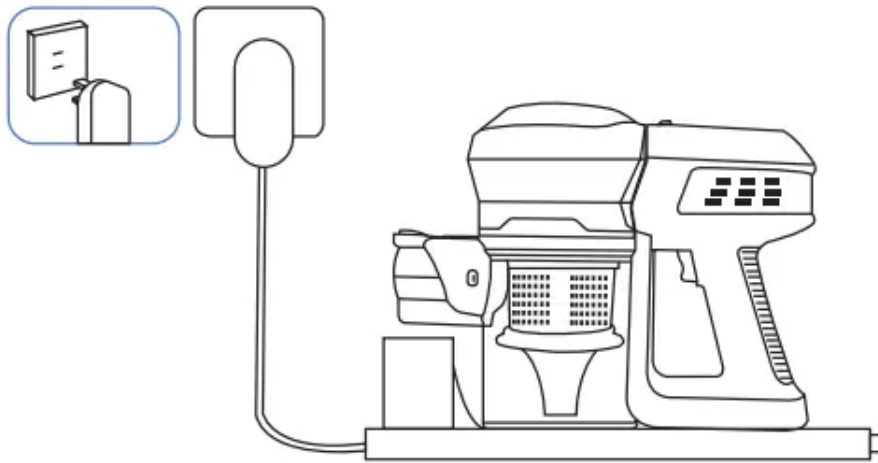

Power mode and two speed switch

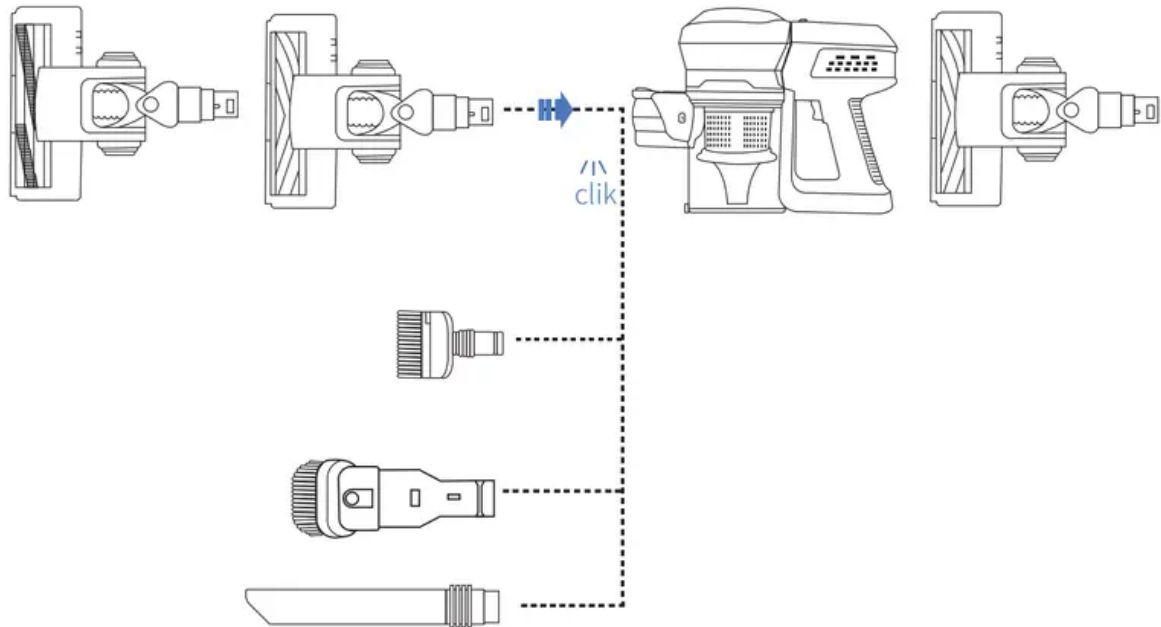
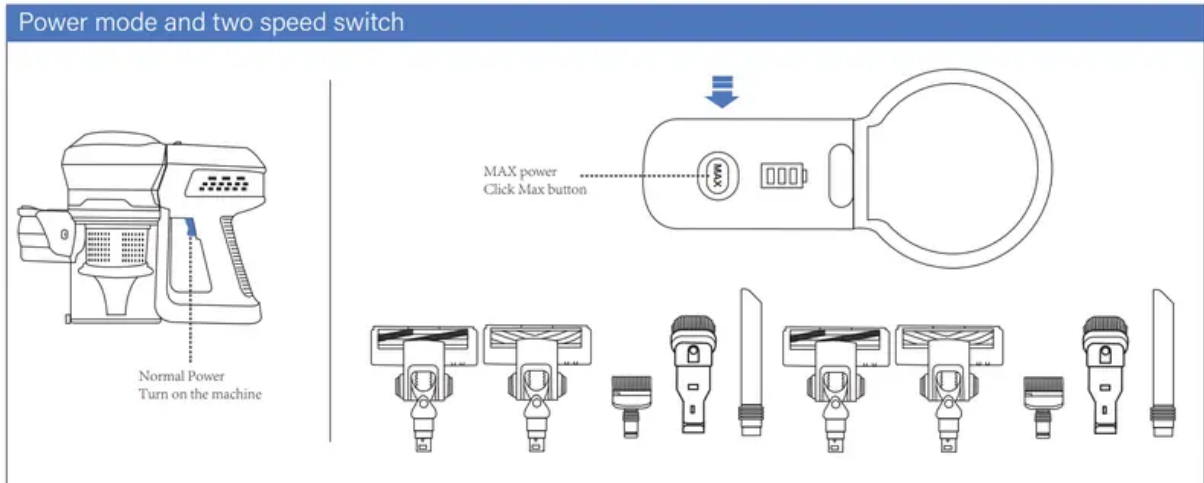

Recharging on the dock

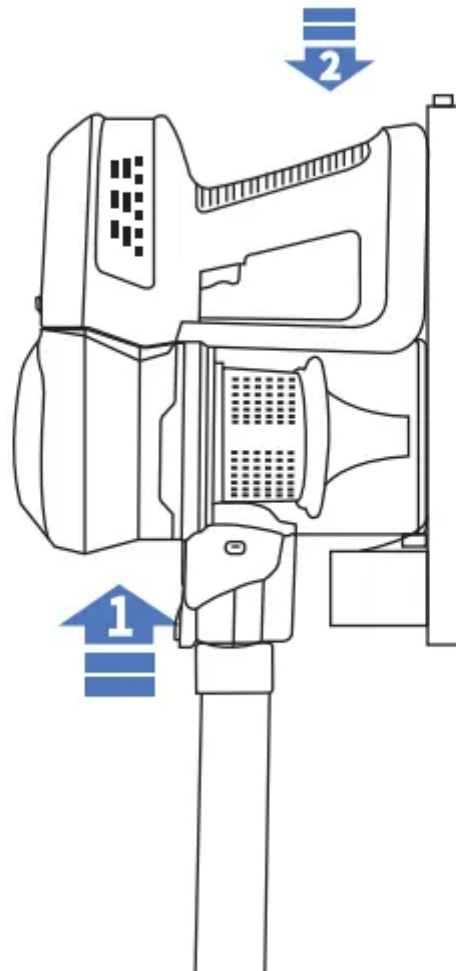

Removing from the dock

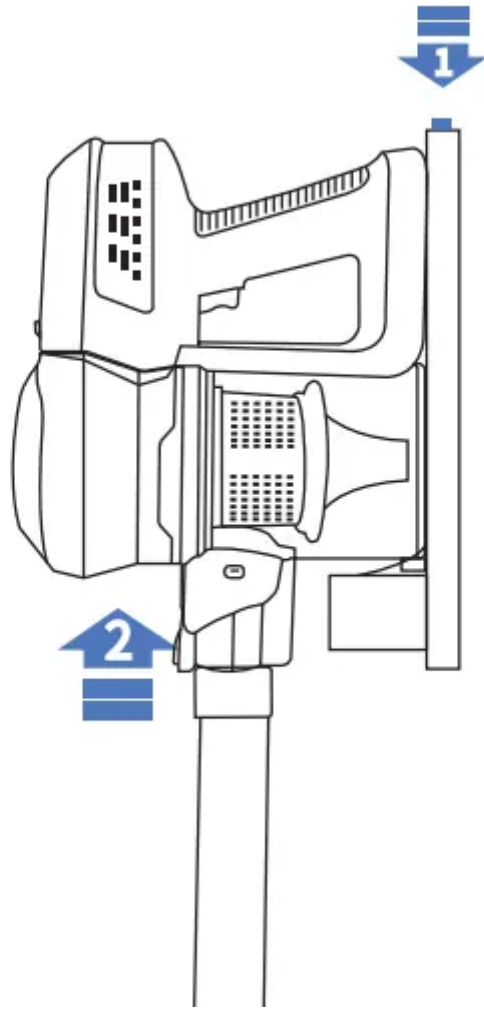

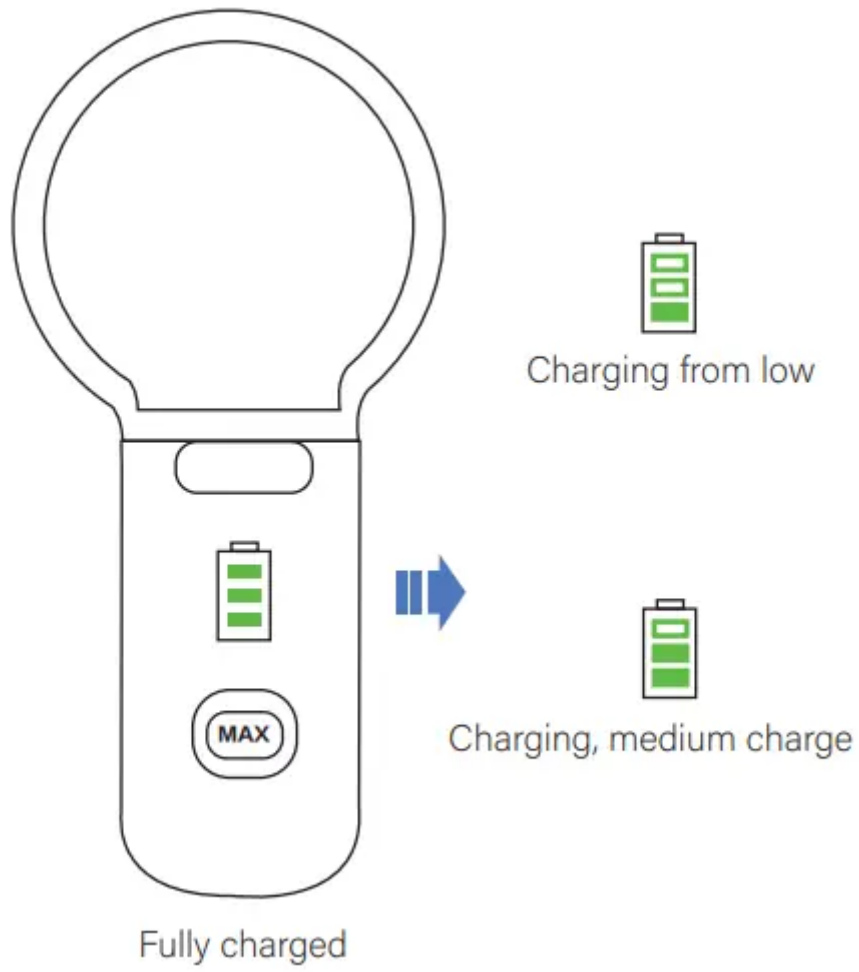

Empty the clear bin

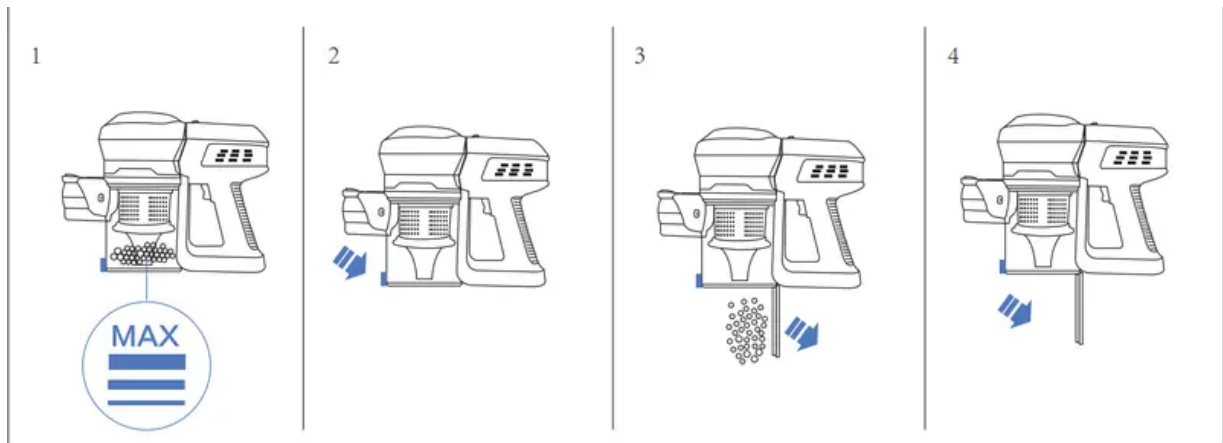

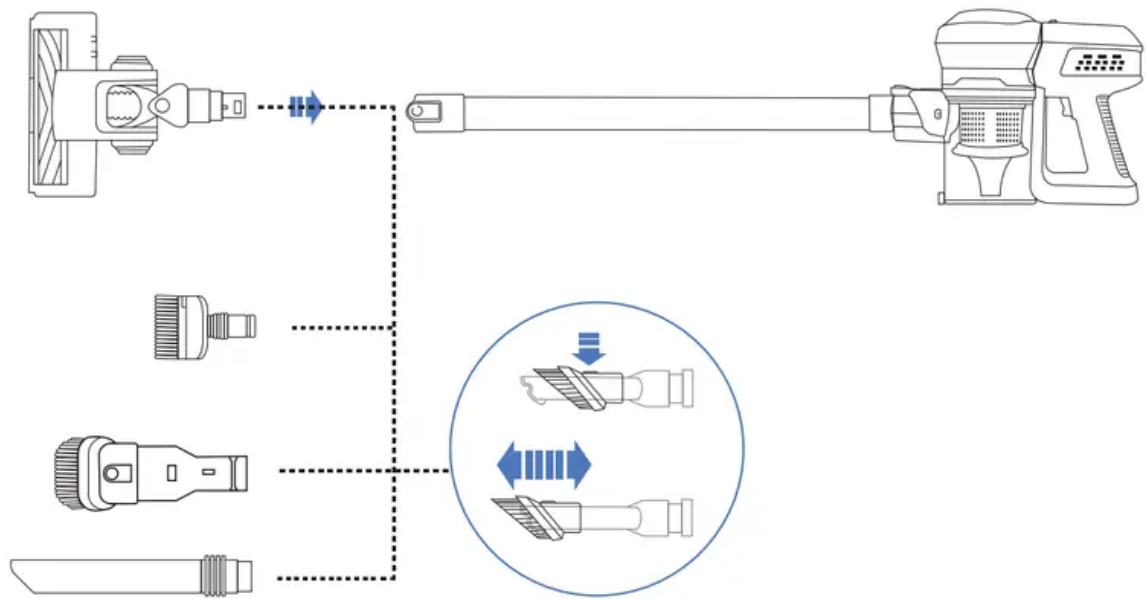

Stubborn blockages - Diassembly

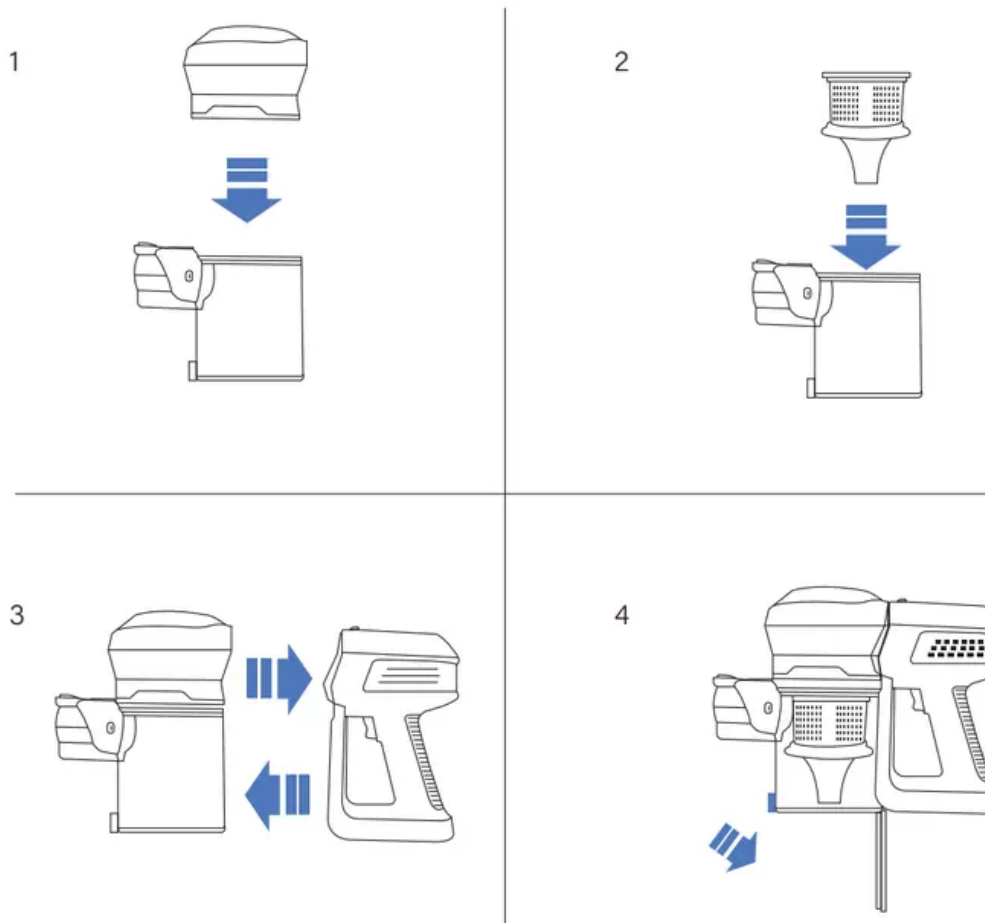

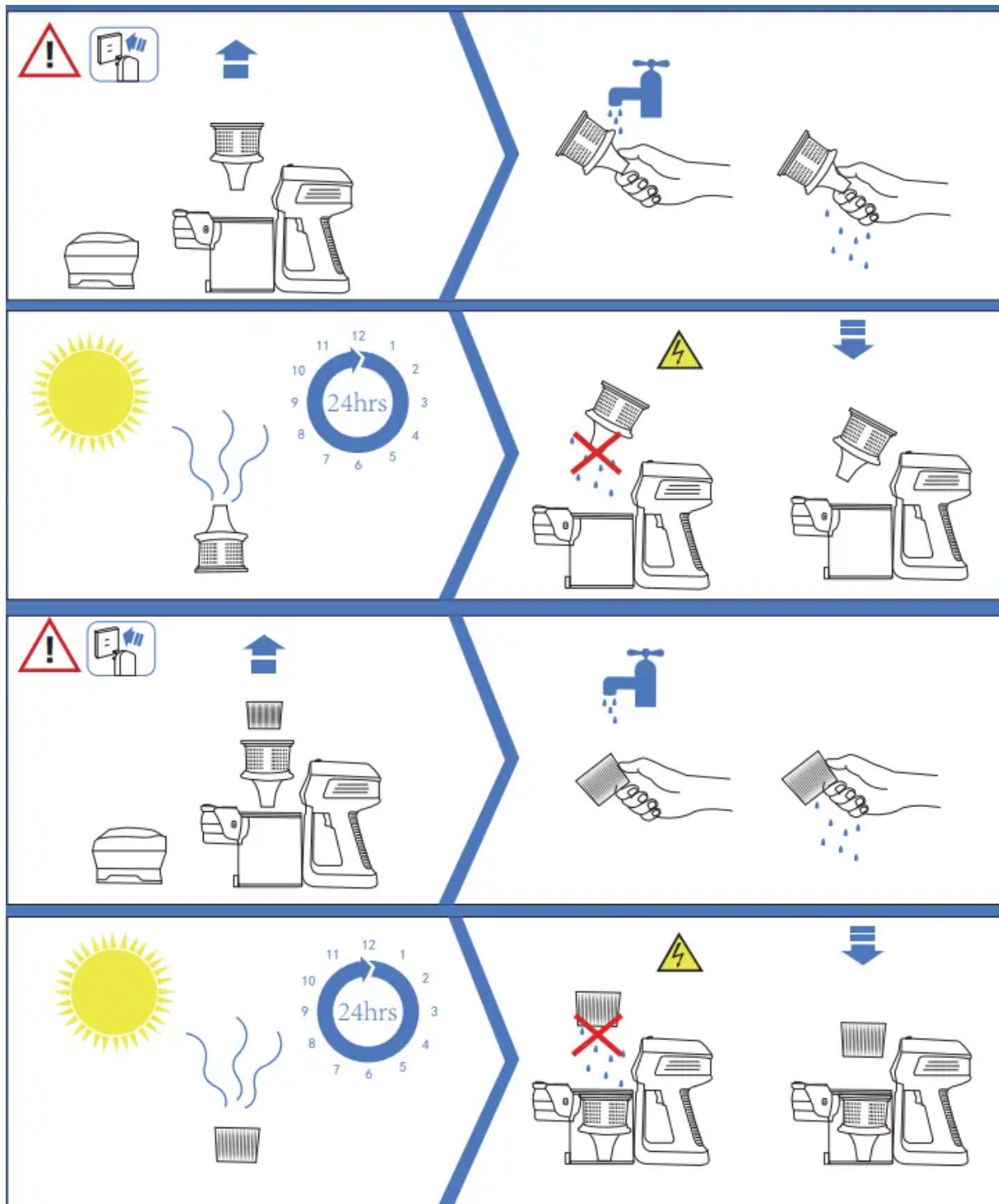

Direct drive cleaner head: Clearing obstructions



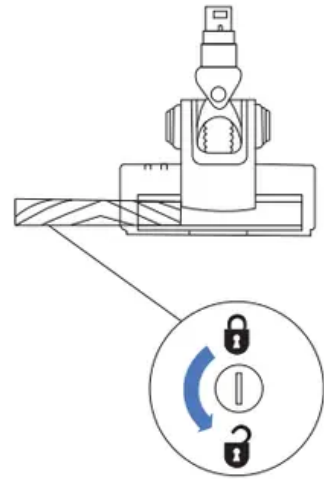
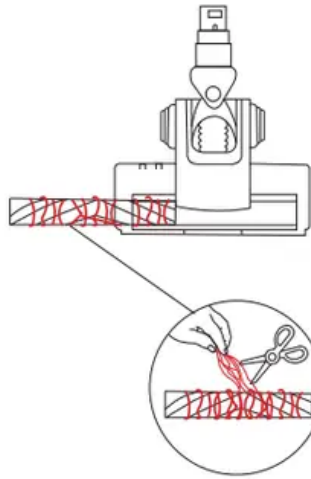
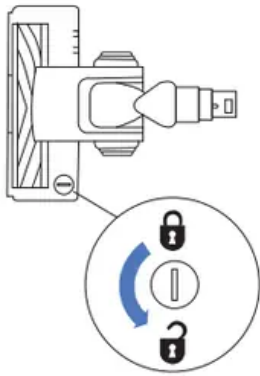

Clearing mini motorized tool brush bar obstructions

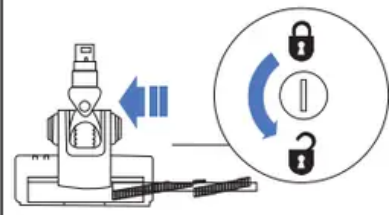
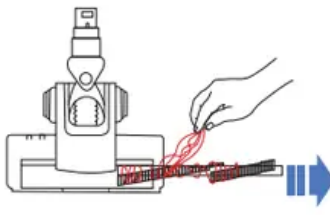
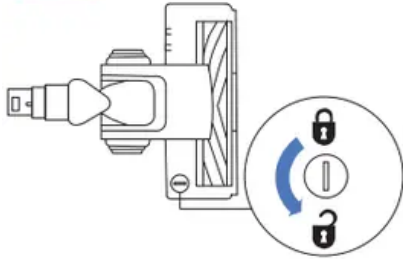

Soft roller cleanerhead: Clearing brush bar obstructions

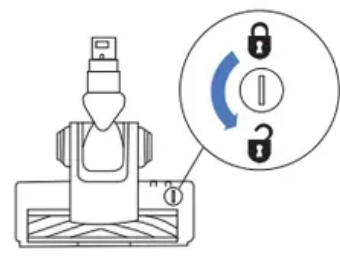
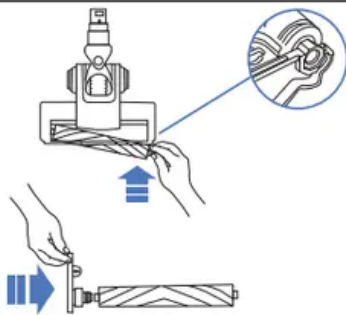
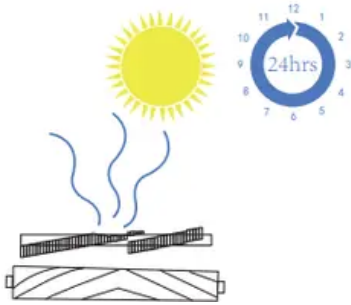
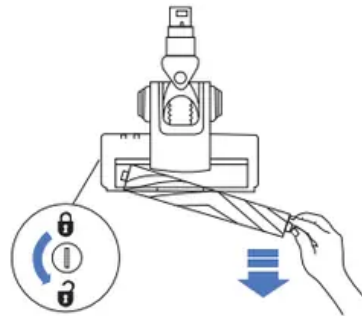
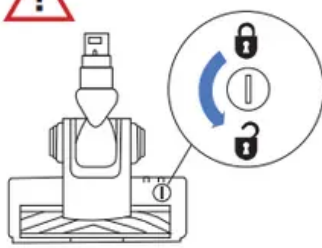

USING YOUR MACHINE: PLEASE READ THE “IMPORTANT SAFETY INSTRUCTIONS” IN THIS OPERATING MANUAL BEFORE PROCEEDING.

OPERATION

- Do not use outdoors or on wet surfaces or to vacuum water or other liquids ~ electric shock could occur.
- Ensure the machine remains upright in use. Dirt and debris may be released if it is turned upside down.
- Do not operate while checking for blockages as doing so could result in personal injury.
- For domestic indoor and car use only. Do not use it while the car is in motion or while driving.
- To operate the MAX mode, locate the button on the top of the appliance. Click the MAX button to the Max mode.
- Use appropriate mounting hardware for your wall type and ensure that the docking station is mounted securely. Ensure no pipe work (gas, water, air) or electrical cables, wires or ductwork are located directly behind the mounting area.

CARPETS OR HARD FLOORS

- Before vacuuming your flooring, rugs and carpets, check the manufacturer’s recommended cleaning instructions.
- The brush bar on the machine can damage certain carpet types and floors. Some carpets will fuzz if a rotating brush bar is used when vacuuming. If this happens, we recommend vacuuming without the motorized floor tool and consulting with your flooring manufacturer.
- Before vacuuming highly polished floors, such as wood or linoleum, first check that the underside of the floor tool and its brushes are free from foreign objects that could cause marking.

LOOKING AFTER YOUR MACHINE

- Do not carry out any maintenance or repair work other than that shown and described in this
- Operating Manual.
- Store the machine indoors. Do not use or store it below 37.4 °F(3 °C). Ensure the machine is at room temperature before operating.

- Clean the machine only with a dry cloth. Do not use any lubricants, cleaning agents, polishes or air fresheners on any part of the machine.

VACUUMING

- Do not use without the clear bin and filters in place.
- Fine dirt such as plaster dust or flour should only be vacuumed in very small amounts.
- Do not use the machine to pick up sharp hard objects, small toys, pins, paperclips, etc. They may damage the machine.
- When vacuuming, certain carpets may generate small static charges in the clear bin or wand. These are harmless and are not associated with the central electricity supply. To minimize any effect from this, do not put your hand or insert any object into the clear bin unless you have first emptied it. Clean the clear bin with a damp cloth only.
- Use extra care when cleaning on stairs.
- Do not rest the machine on chairs, tables, etc.
- Do not press down on the nozzle with excessive force when using the machine as this may cause damage.
- Do not leave the cleaner head in one place on delicate floors.
- On waxed floors, the movement of the cleaner head may create an uneven luster. If this happens, wipe with a damp cloth, polish the area with wax, and wait for it to dry.

EMPTYING THE CLEAR BIN

- To make emptying the clear bin easier, it is advisable to remove the wand and floor tool.
- To minimize dust/allergen contact when emptying, encase the clear bin tightly in a plastic bag and empty.
- To release the dirt, hold the appliance by the handle, lift upwards to release the cyclone. Continue until the bin base automatically opens and releases the dirt.
- Remove the clear bin carefully from the bag.
- Seal the bag tightly, dispose as normal.

CLEANING THE CLEAR BIN

- Ensure the machine is disconnected from the charger before removing the clear bin.
- Remove the wand and floor tool.
- To remove the cyclone, hold the appliance by the handle, lift upwards until the bin opens, then push in the red button located behind the cyclone and lift the cyclone out.

- To detach the clear bin from the appliance, pull back on the red catch located at the base, slide the clear bin down and carefully remove forwards from the main body.
- Clean the clear bin with a damp cloth only.
- + Do not use detergents, polishes or air fresheners to clean the clear bin.
- + Do not put the clear bin in a dishwasher.
- Ensure the clear bin is completely dry before replacing.
- To replace the clear bin, align the tabs on the clear bin with the grooves on the main body and slide upwards into place until the catch clicks.

WASHABLE PARTS

- Your appliance has washable parts, which require regular cleaning. Follow the instructions below.

WASHING THE FILTERS.

- Wash the filters at least once a month according to the following instructions to maintain performance.
- More frequent washing may be required where the user: vacuums fine dust. uses the machine intensively.

WASHING FILTER

- Ensure the machine is disconnected from the charger before removing the filter.
- Check and wash the filter regularly according to instructions to maintain performance.
- The filter may require more frequent washing if vacuuming fine dust.
- To remove the filter. lift it out of the top of the machine.
- Wash the filter with cold water only.
- Run water over the outside of the filter until the water runs clear.
- Squeeze and twist with both hands to make sure the excess water is removed.
- Lay the filter on it
- Do not put the filter in a dishwasher. washing machine, tumble dryer, oven, icrowave or near an ide to dry. Leave to dry completely for a minimum of 24 hours, open flame.
- To refit, place the dry filter back into the top of the machine. Make sure it is seated properly.

CHARGING AND STORING

- Do not charge the machine and then move it to an area with a temperature below 37.4°F (3° C) for storage purposes.
- To help prolong battery life, avoid recharging immediately after a full discharge. Allow to cool for a few minutes.
- Avoid using the machine with the battery flush to a surface. This will help it run cooler and prolong battery run time and life.

BATTERY SAFETY INSTRUCTIONS

- If the battery needs replacing please contact the NEQUARE support
- Use only NEQUARE chargers for charging this NEQUARE machine.
- The battery is a sealed unit and under normal circumstances poses no safety concerns. In the unlikely event that liquid leaks from the battery do not touch the liquid and observe the following precautions:
 - Skin contact — can cause irritation. Wash with soap and water.
 - Inhalation — can cause respiratory irritation. Expose to fresh air and seek medical advice.
 - Eye contact — can cause irritation. Immediately flush eyes thoroughly with water for at least 15 minutes.
 - Seek medical attention.
 - Disposal — wear gloves to handle the battery and dispose of it immediately, following local ordinances or regulations.

CAUTION: The battery used in this device may present a risk of fire or chemical burn if mistreated. Do not disassemble, short contacts, heat above 140° F (60° C), or incinerate. Keep away from children. Do not disassemble and do not dispose of in fire.

DISPOSAL INFORMATION

- Dispose of or recycle the battery in accordance with local ordinances or regulations.
- Keep the used batteries away from children as these can still harm children if swallowed.
- The battery should be removed from the product before disposal.

Trouble Shooting



Trouble Shooting		
Problem	Possible cause	Solution
Brush not rotating	HEPA installed improperly (LED light won't ON even motor is working)	Re-install the HEPA filter
	Extension tube not connect properly	Check the connection of extension tube
	Brush is clogged or defective	Check the connection of extension tube
The appliance doesn't work	Out of battery	Charge the battery
	The suction mouth is blocked	Check and remove blockages
	The battery is still connected to the adaptor	Disconnect the battery from the adaptor
Weak suction power	Dust bin is full	Empty the the dust bin
	Floor brush is clogged	Removing clogging
	Filter is clogged	Clean the filter
	Tube is not connected with the floor brush properly	Connect the extendable tube and floor brush properly
Abnormal motor sounds	The appliance is blocked(such as tube, suction mouth or Remove blockage)	Remove blockages
Battery can not be charged	The adaptor is not correctly inserted	Remove the adaptor and insert correct adaptor again
Decreasing of using time	Battery loss	Replace the battery

	Battery not fully charged	Recharge the battery
--	---------------------------	----------------------

Warning

This content is compiled from multiple sources and is provided for reference purposes only. It may not be complete or fully applicable to all situations. If you are unable to resolve your issue, please contact the product manufacturer or an authorized service provider for official support.

Document generated by [ManualsFile](#)

