

Description of the appliance

View of the appliance

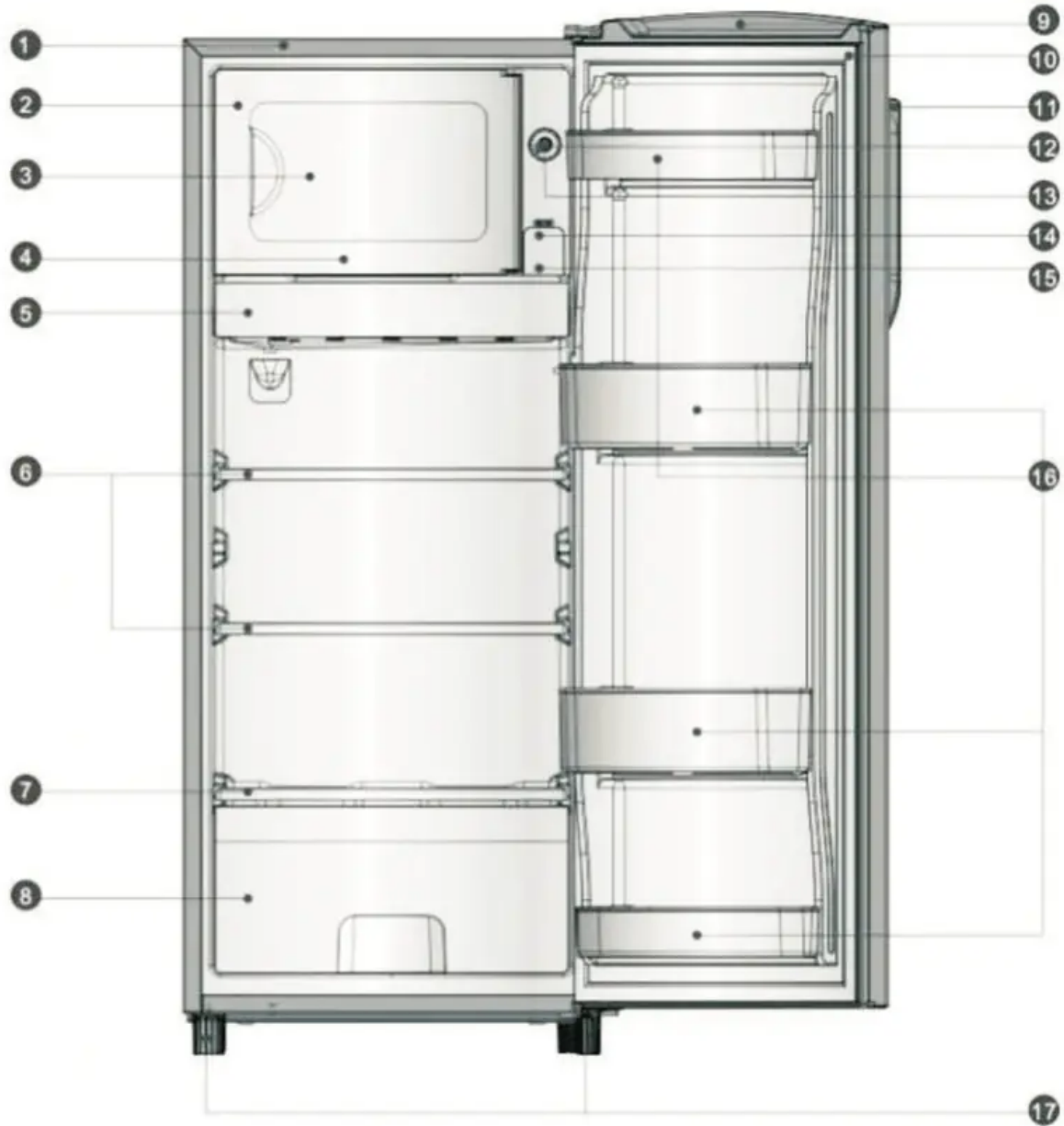

- 1. Cabinet
- 2. Freezer
- 3. Freezer cover
- 4. Ice tray
- 5. Draining box
- 6. Shelf part



7. Crisper cover
8. Fruit and vegetable crisper
9. Fridge door
10. Door seal
11. Handle(optional)
12. Control knob
13. Button
14. Lamp bulb or LED
15. Lamp cover
16. Door rack
17. Bottom feet

NOTE: Due to unceasing modification of our products.your refrigerator may be slightly different from this instruction manual, but its functions and using methods remain the same.

Controls

The appliance has 7 choices of temperature. Turn the dial clockwise for colder temperature, with "7" being the coldest setting. Turn the knob clockwise to the proper position by your requirement.

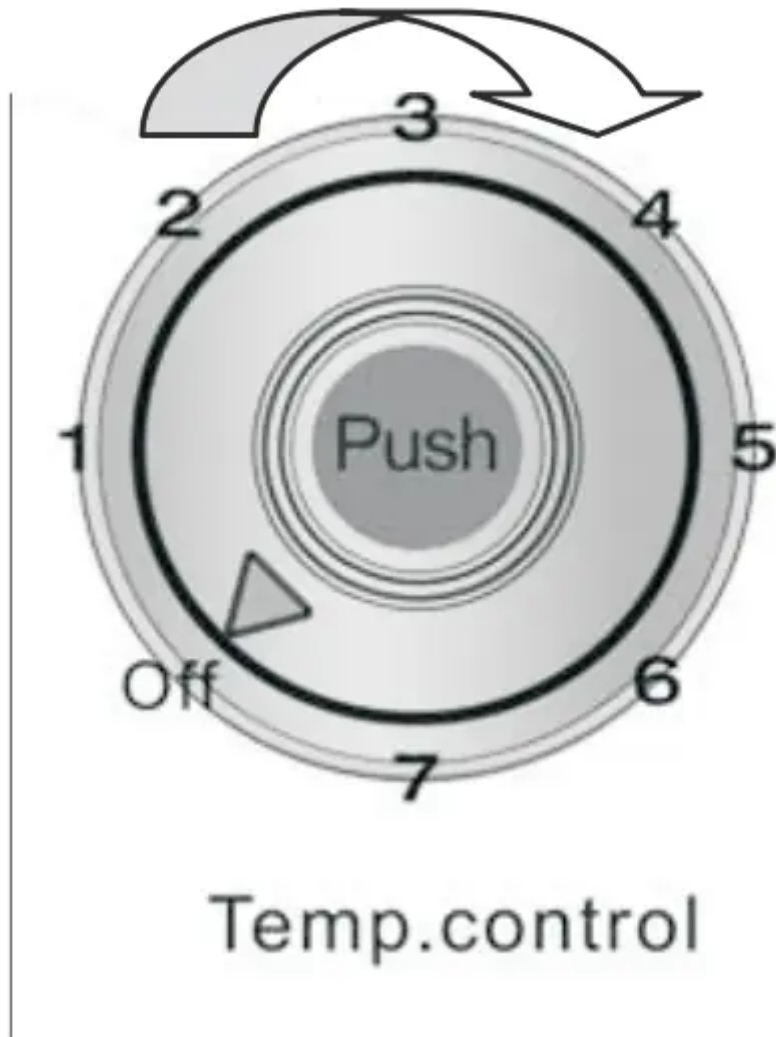

Starting

- When you use your appliance for the first time, please turn the control knob at position "1" keep the appliance running about 2 or 3 hours unload inside to stabilize the temperature.
- If interrupted, please restart again 5minutes later.

Temperature control

- For normal operation, the control knob is advised to be set at position "3" or "4".
- In case of the maximum amount of food to be stored or the requirement of a colder temperature, you can turn the control knob to a higher position.
- If you only want to store small food, or the ambient temperature is low, you may turn the control knob to a lower position.
- If there is no need to use the appliance, you can turn the control knob to the position "OFF" to shut off the appliance.

Defrosting

In order to keep high efficiency of the appliance, it is necessary to defrost regularly. If the frost on the freezer grows up to 3/16 inches/5mm, or the frost is going to exceed the defrosting indicator, please press the defrost button to defrost. The button will return to normal position automatically about 3 to 4 hours later when defrosting completes and the appliance will operate normally.

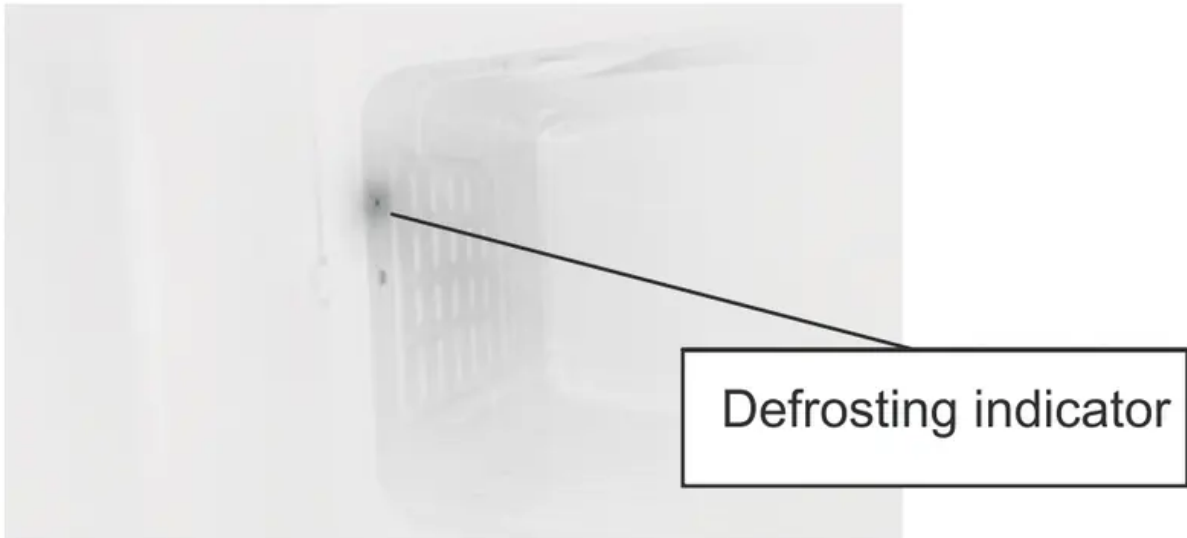

Defrosting indicator

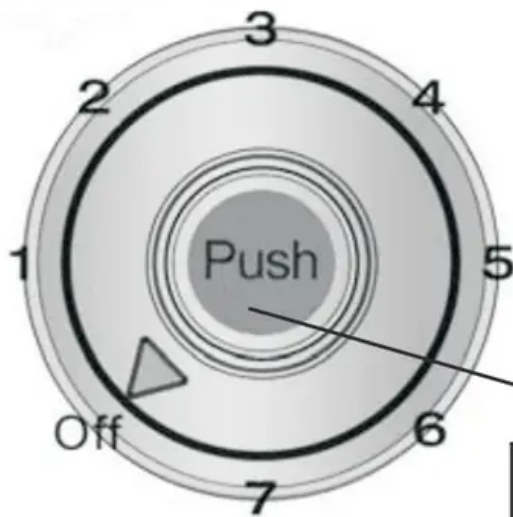

Defrost button

Temp.control

- If there is a need to use the freezer during defrost, or you want to discontinue the defrosting process, turn the control knob to position "OFF" and then set the control knob to the proper position you need. And then the appliance will operate properly.

Note:

1. Before starting defrosting, please remove the food in the freezer and the drain pan. It is recommended to there is no frozen food needed, such as during thawing.
2. When defrosting completes, remove the drain pan, empty the water and residual ice. Put the drain pan back to the proper position. Clean and dry the interior thoroughly.



3. If the thickness of frost exceeds the defrost indicator, the defrosted water may flow over the evaporating pan. Please pay attention to this regard.

Using your appliance

Door rack

Do not place too many heavy things in the racks.

Note: There are egg trays in the upper shelf.

The freezer

The freezer is capable of "hard freezing".

Note:

1. Don't store bottled or canned drinks (especially carbonated drinks) in the freezer compartment. Bottles and cans may explode.

Shelf in Refrigerator chamber

- There are two shelves in the refrigerator chamber, and they can be taken out to be cleaned or or more space.

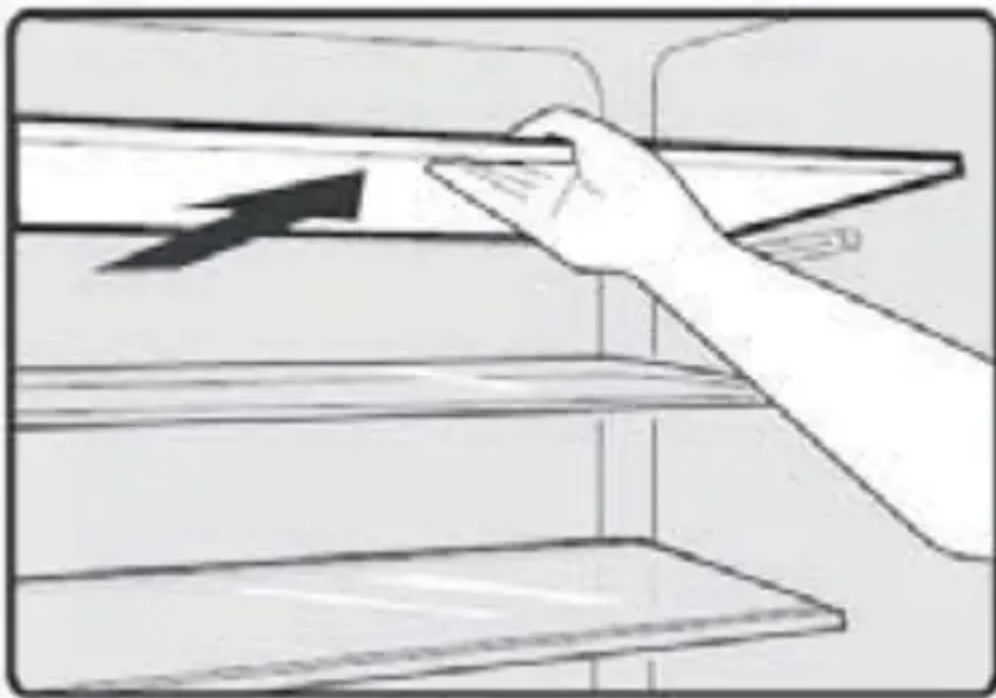

Crisper cover

- Controls the temperature of the crisper and preventing vegetables from losing moisture.

Fruit and vegetables crisper

- It is suitable for the storage of fruits and vegetable.

Ice tray

- It is used for making ice.
- There are some notes for ice making:
 1. If the ice tray is used for the first time or has not been used for a long time, please clean it before using.
 2. When you pour water into the ice tray, the water level shall not exceed the top line.

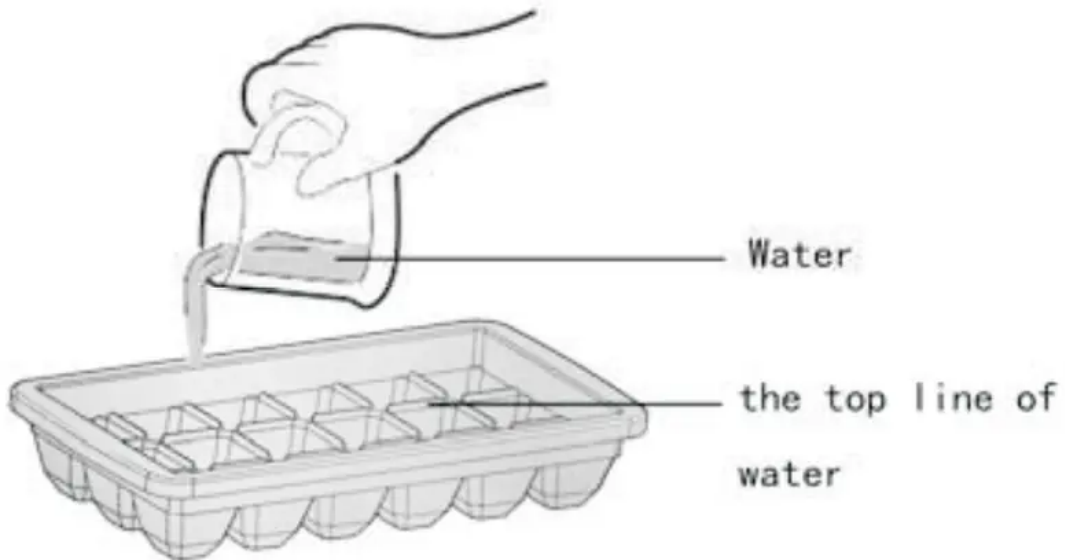

3. The ice tray should be carefully placed in the freezer to avoid spilling.
4. To make ice quickly, it is advised to set the control button position to "7".

5. To take out the ice cubes, gently twist the ice tray and bend it over.



Helpful hints and tips

Energy saving tips

We recommend that you follow the tips below to save energy.

- Try to avoid keeping the door open for long periods in order to conserve energy. Ensure the appliance is away from any sources of heat (Direct sunlight, electric oven or cooker etc).
- Don't set the temperature colder than necessary.
- Don't store warm food or evaporating liquid in the appliance.

- Place the appliance in a well ventilated, humidity free, room. Please refer to the instructions on installing your new appliance.
- The diagram shows the correct combination for the drawers, crisper and shelves, designed to be the most energy efficient configuration.

Hints for fresh food refrigeration

- Do not place hot food directly into the refrigerator or freezer, as the internal temperature will increase resulting in the compressor having to work harder and will consume more energy.
- Cover or wrap the food particularly if it has a strong flavor.
- Place food properly so that air can circulate freely around it.

Hints for refrigeration

- Meat (All Types) Wrapped in PVDC(plastic) wrap: Wrap and place on the shelf above the vegetable drawer. Always follow food storage times and use by dates suggested by manufacturers.
- Cooked food, cold dishes, etc.: Dishes should be covered and may be placed on any shelf.
- Fruit and vegetables: Fruit and vegetables should be stored in the special drawer provided.
- Butter and cheese: Be wrap in airtight foil or plastic film wrap.
- Milk bottles: Bottles should have a lid and be stored in the door racks.

Hints for freezing

- When first starting-up or after a period out of use, let the appliance run at least 2hours on the higher settings before putting food in the freezer compartment.
- Prepare food in small portions to enable it to be rapidly and completely frozen and to make it possible to subsequently thaw only the quantity required.
- Wrap up the food in aluminum foil or PVDC food wrap to be airtight,
- Do not allow fresh unfrozen food to touch the food which is already frozen.
- It is recommended to label and date each frozen package in order to keep track of the storage time.

Hints for the storage of frozen food

- Ensure that frozen food has been stored correctly by the food retailer
- Once defrosted, food will deteriorate rapidly and should not be re-frozen. Do not exceed the storage period indicated by the food manufacturer.

Switching off your appliance

If the appliance needs to be switched off for an extended period, the following steps should be taken prevent mould on the appliance.

1. Remove all food.
2. Remove the power plug from the main socket.
3. Clean and dry the interior thoroughly.
4. Ensure that all the doors are wedged open slightly to allow air to circulate.

Cleaning and care

For hygienic reasons the appliance (including exterior and interior accessories) should be cleaned regularly at least every two months.

Caution! The appliance must not be connected to the power out let during cleaning.

Danger of electrical shock! Before cleaning switch the appliance off and remove the plug from the main socket.

Exterior cleaning

To maintain good appearance of your appliance, you should clean it regularly.

- Spray water onto the cleaning cloth instead of spraying directly on the surface of the appliance. This helps ensure an even distribution of moisture to the surface.
- Clean the doors, handles and cabinet surfaces with a mild detergent and then wipe dry with a soft cloth.

Caution!

- Don't use sharp objects as they are likely to scratch the surface.
- Don't use Thinner, Car detergent, Clorox, ethereal oil, abrasive cleansers or organic solvent such as Benzene for cleaning. They may damage the surface of the appliance and may cause fire.

Interior cleaning

- You should clean the appliance interior regularly. It will be easier to clean when food stocks are low. Wipe the inside of the fridge freezer with a weak solution of bicarbonate of soda, and then rinse with warm water using a wrung-out sponge or cloth. Wipe completely dry before replacing the shelves and baskets. Thoroughly dry all surfaces and removable parts.

Caution! Don't use sharp objects to remove frost from the freezer compartment. Only after the interior is completely dry should the appliance be switched back on and plugged back into the main socket.

Door seals cleaning

Take care to keep door seals clean. Sticky food and drinks can cause seals to stick to the cabinet and tear when you open the door. Wash seal with a mild detergent and warm water. Rinse and dry it thoroughly after cleaning.

Caution! Only after the door seals are completely dry should the appliance be powered on.

Replacing the lamp bulb (or LED) :

Warning: The LED must not be replaced by the user! If the LED is damaged, contact the customer helpline for assistance. To replace the Lamp bulb (or LED), the below steps can be followed:

1. Unplug your appliance.
2. Remove lamp cover by pushing out.



3. Swivel out the Lamp bulb (or LED).

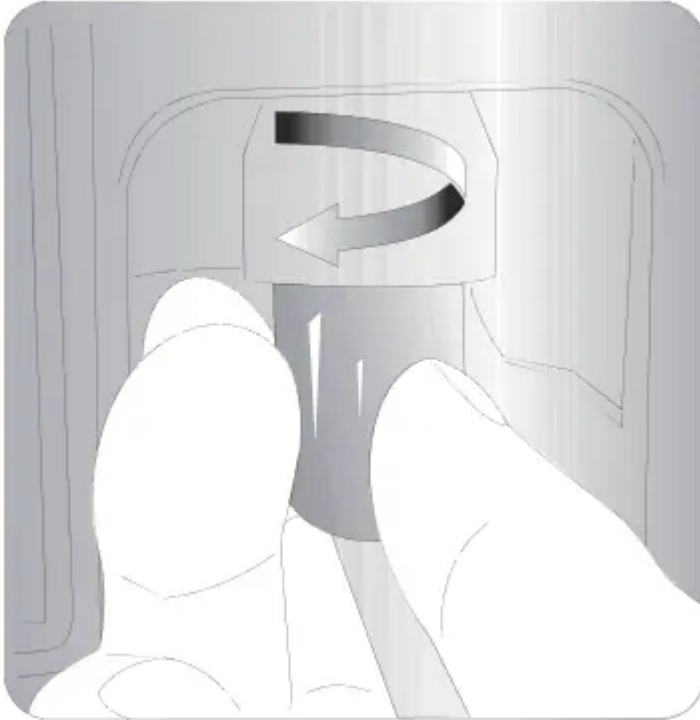

4. Replace Lamp bulb (or LED) and push light cover to correctly position.



Troubleshooting

If you experience a problem with your appliance or are concerned that the appliance is not functioning correctly, you can carry out some easy checks before calling for service, please see below.

Warning! Don't try to repair the appliance yourself. If the problem persists after you have made the checks mentioned below, contact a qualified electrician, authorized service engineer or the shop where you purchased the product.

Problem	Possible cause & Solution
Appliance is not working correctly	Check whether the power cord is plugged into the power outlet properly.
	Check the fuse or circuit of your power supply, replace if necessary.
	The ambient temperature is too low. Try setting the chamber temperature to a colder level to solve this problem.
	It is normal that the freezer is not operating during the defrost cycle, or for a short time after the appliance is switched on to protect the compressor.
Odours from the compartments	The interior may need to be cleaned
	Some food, containers or wrapping cause odours.
Noise from the appliance	<p>The sounds below are quite normal:</p> <ul style="list-style-type: none"> • Compressor running noises. • Gurgling sound similar to water boiling. • Clicking noise before the compressor starts.
	<p>Other unusual noises are due to the reasons below and may need you to check and take action:</p> <p>The cabinet is not level.</p> <p>The back of appliance touches the wall.</p> <p>Bottles or containers fallen or rolling.</p>



Problem	Possible cause & Solution
The motor runs continuously	<p>It is normal to frequently hear the sound of the motor, it will need to run more when in following circumstances:</p> <ul style="list-style-type: none"> • Temperature setting is set colder than necessary • Large quantity of warm food has recently been stored within the appliance. • The temperature outside the appliance is too high. • Doors are kept open too long or too often. • After your installing the appliance or it has been switched off for a long time.
A layer of frost occurs in the compartment	Check that the air outlets are not blocked by food and ensure food is placed within the appliance to allow sufficient ventilation. Ensure that door is fully closed. To remove the frost, please refer to defrosting chapter.
Temperature inside is too warm	You may have left the doors open too long or too frequently; or the doors are kept open by some obstacle; or the appliance is located with insufficient clearance at the sides, back and top
Temperature inside is too cold.	Increase the temperature by following the "Controls" chapter.
Doors can't be closed easily	Check whether the top of the refrigerator is tilted back by 10~15mm~1/2 inch to allow the doors to self close, or if something inside is preventing the doors from closing.
Water drips on the floor	The water pan (located at the rear bottom of the cabinet) may not be properly leveled, or the draining spout (located underneath the top of the compressor depot) may not be properly positioned to direct water into this pan, or the waterspout is blocked. You may need to pull the refrigerator away from the wall to check the pan and spout.
The light is not working	The Lamp bulb may be damaged.Refer to replace Lamp bulbs in cleaning and care chapter.

Warning

This content is compiled from multiple sources and is provided for reference purposes only. It may not be complete or fully applicable to all situations. If you are unable to resolve your issue, please contact the product manufacturer or an authorized service provider for official support.

Document generated by [ManualsFile](#)