

Function Diagram

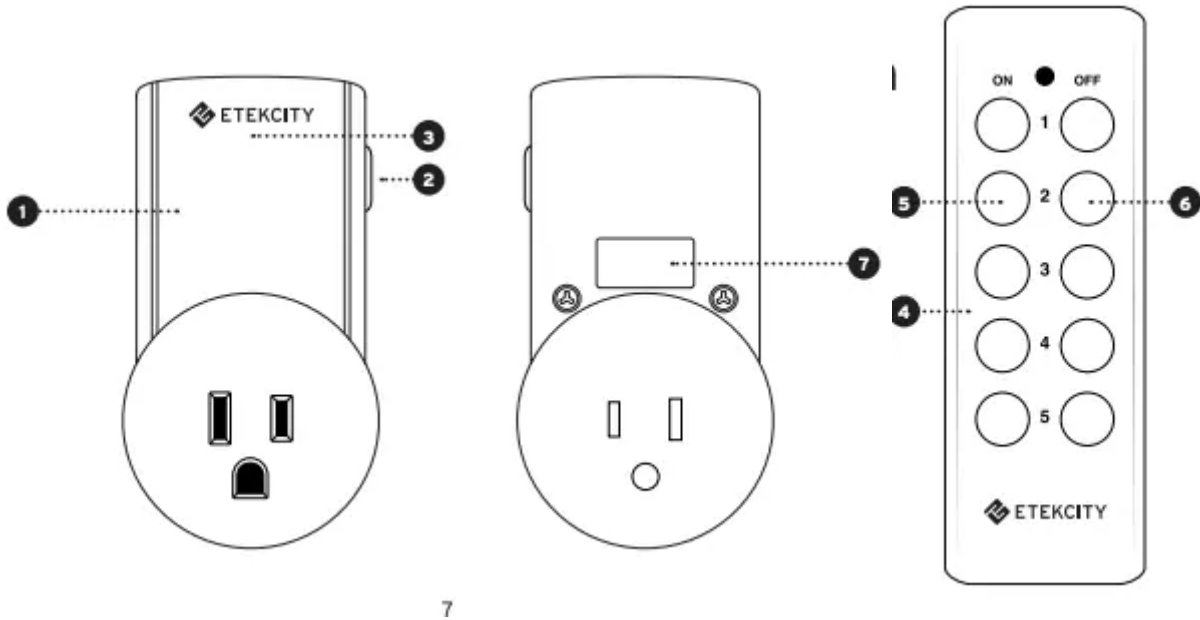

1. Outlet
2. Power / Program Button
3. Outlet Indicator Light
4. Remote Control
5. On Buttons
6. Off Buttons
7. Outlet Number

Operation

The outlets are pre-programmed for immediate use, but the configuration can be customized to meet your needs.

1. Install one 12V/23A battery to each remote control.

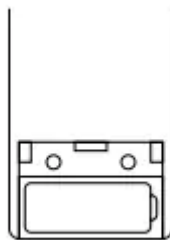

2. Plug each outlet into a powered socket.

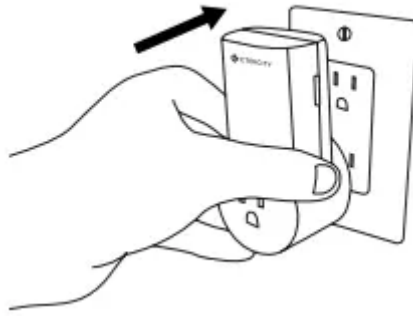

3. Plug an appliance into each outlet. Keep the appliance switch to 'ON' in order to allow the outlet to control the device.

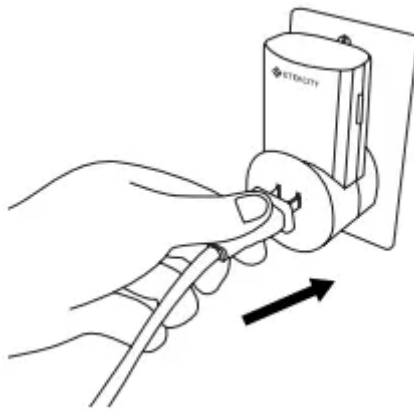

4. Press the 'ON' or 'OFF' button for the corresponding number on remote. The indicator light on the corresponding outlet will turn on, confirming that the outlet is now in use.

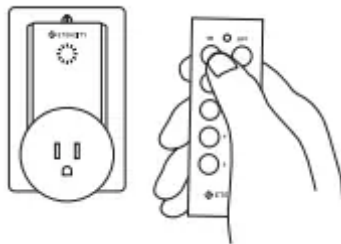

NOTE: The outlet number can be found on the back of each outlet in the following format from 1 to 5: xxxx-1, xxxx-2, etc.

Re-programming an Outlet

1. Unplug device from outlet.

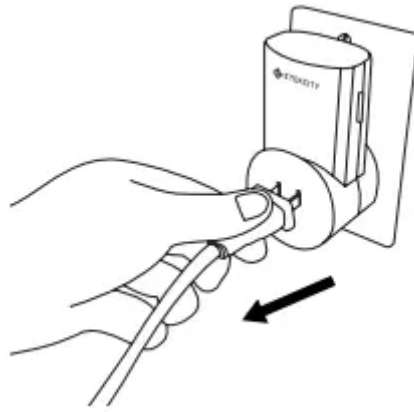

2. Press and hold programming button until indicator light starts to blink.

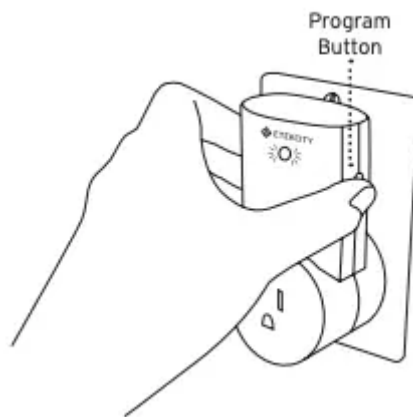

3. Release program button, press the "ON" or "OFF" button for the desired number on the remote

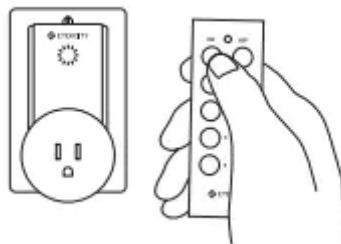

4. Pairing is successful when indicator light stops blinking.

NOTE: You may repeat the re-programming steps to assign up to 10 outlets to a single number to simultaneously control multiple devices with a single click.



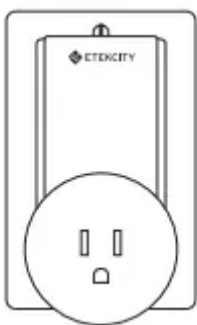

Resetting an Outlet

To remove an outlet from all remote control pairings:

1. Unplug any devices connected to the remote outlet.



2. Remove the outlet from the power socket.

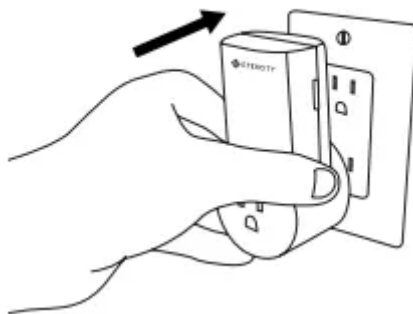

3. Press and hold the program button.
4. Plug outlet back into power socket while continuing to hold program button.

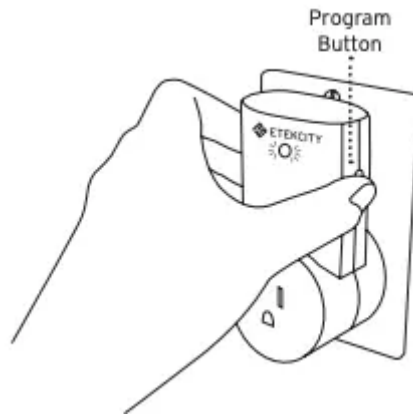

5. Hold the program button for approximately 5 seconds until the LED indicator begins to flash
6. Program reset will be complete when the indicator light stops blinking.

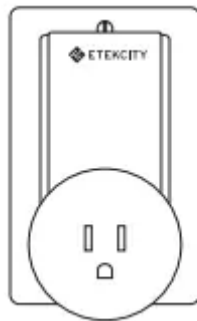

Troubleshooting

Issue	Solution
Outlet is unresponsive to remote commands.	Replace the remote batteries with new 12V 23A batteries. Low battery power may decrease readable wireless remote range.
	Make sure the outlet and device are properly connected and powered on.
	Make sure that the outlet is placed in an area with proper air circulation without overheating.
	Make sure the maximum load current of 10A (approximately 1200W) isn't being exceeded. If so, unplug the device from the outlet immediately.
	If the outlet is still unresponsive, refer to the "Resetting" and "Reprogramming" sections in the manual.

Safety Information

IMPORTANT: Please read, understand, and comply with all of the instructions provided in this manual before using this device. Failure to comply with the instructions given in this manual and/or using the device in ways other than the ones mentioned herein may result in physical harm and/or damage to the device

Important Safety Information

- The wireless range may be shortened by other electronic devices, appliances, walls, and other physical barriers.
- The outlets are intended for indoor use only.
- Avoid exposing to high-temperature sources, direct sunlight, or exposure to moisture.
- DO NOT exceed the maximum load current of 10A (approximately 1200W).
- DO NOT use appliances such as refrigerators, air conditioning units, and washing machines with the outlets. Such appliances exceed the maximum load current of 10A (1200W).
- Keep out of reach of children.
- The outlets are best used in areas with proper air circulation.
- When cleaning, use a dry cleaning cloth to wipe the outlet and remote surfaces.
- For your safety, make sure the batteries within the remotes are correctly installed before use.
- DO NOT dispose any part of this product in a fire.
- The remote is not compatible with rechargeable batteries.
- This device is not intended for use in areas with high humidity, such as bathrooms.
- For best performance, regularly change the batteries in the remote controls.
- If the remote is not in use for an extended period of time, remove batteries.
- Discard all parts of this products in accordance with local environmental regulations. Do not dispose in regular household waste.
- These outlets are not compatible with the ZAP 3VX remote outlets.

Warning

This content is compiled from multiple sources and is provided for reference purposes only. It may not be complete or fully applicable to all situations. If you are unable to resolve your issue, please contact the product manufacturer or an authorized service provider for official support.

