

Installation

Follow these instructions carefully to ensure proper installation of the washing machine and to prevent accidents when doing laundry.

What's included

Make sure all the parts are included in the product package. If you have a problem with the washing machine or the parts, contact a local Samsung customer centre or the retailer

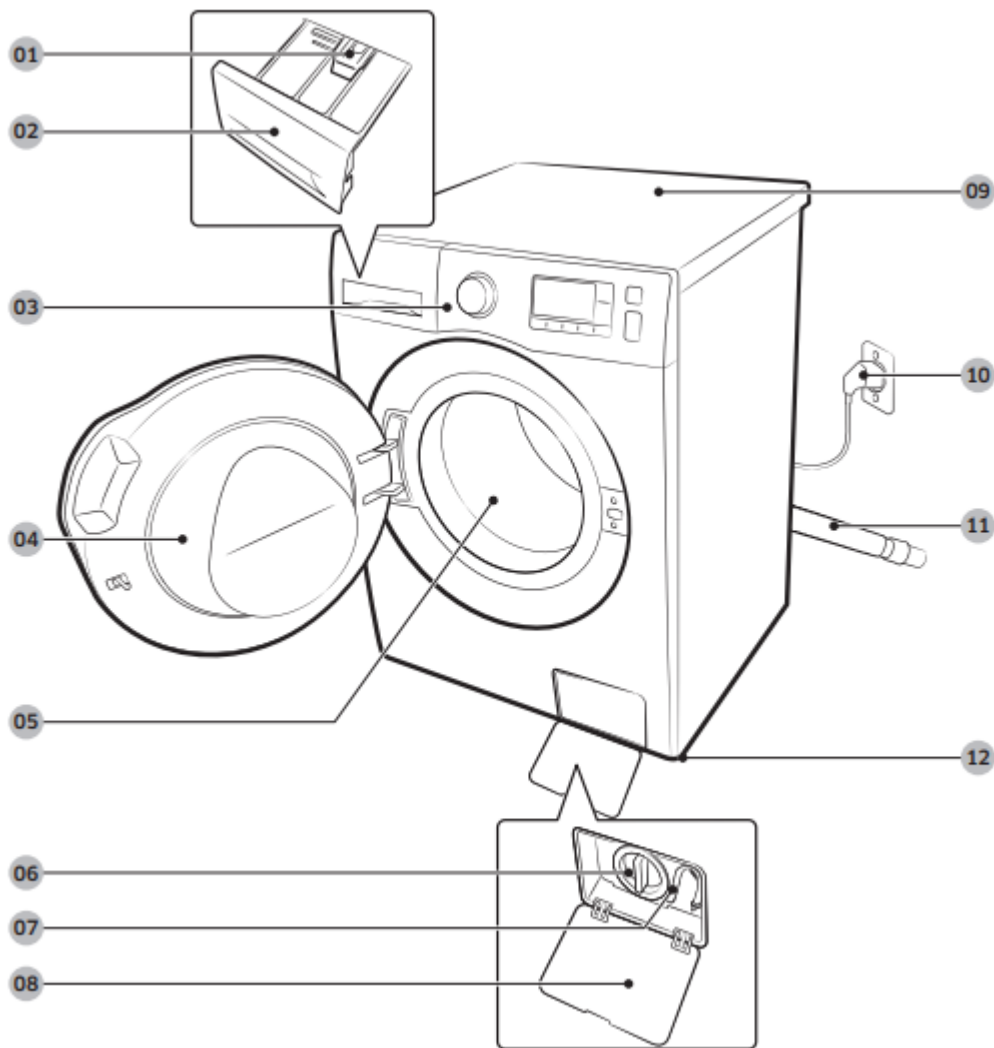

01. Release lever

02. Detergent drawer

03. Control panel

04. Door

05. Drum

06. Lint filter

07. Emergency drain tube 08 Filter cover

09. Worktop

10. Power plug

11. Drain hose

12. Levelling feet

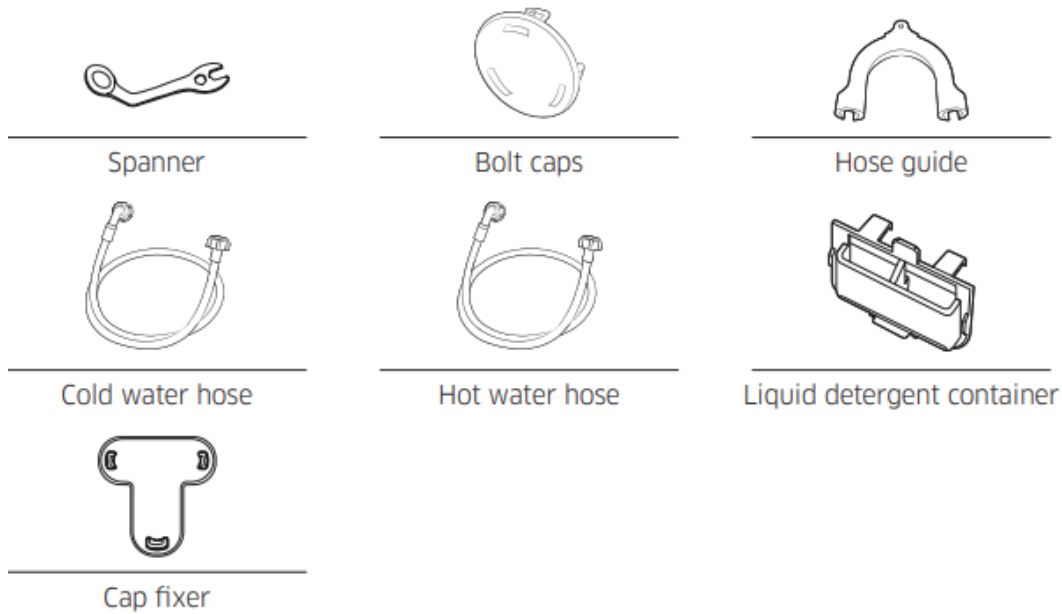

NOTE

- Bolt caps : The provided number (3 to 6) of bolt caps depends on the model.
- Hot water supply hose: Applicable models only.
- Liquid detergent container: Applicable models only

Installation requirements

Electrical supply and grounding

- AC 220-240 V / 50 Hz fuse or circuit breaker is required
- Use an individual branch circuit specific to the washing machine

To ensure proper grounding, the washing machine comes with a power cord featuring a three-prong grounding plug for use in a properly installed and grounded outlet. Check with a qualified electrician or serviceworker if you are not sure about the grounding.

Do not modify the provided plug. If it does not fit the outlet, call a qualified electrician to install a proper outlet.

WARNING

- Do NOT use an extension cord.
- Use only the power cord that comes with the washing machine.
- Do NOT connect the ground wire to plastic plumbing, gas lines, or hot water pipes.
- Improperly connected grounding conductors may cause electric shock.

Water supply

A proper water pressure for this washing machine is between 50 kPa and 800 kPa. Water pressure less than 50 kPa may cause the water valve not to close completely. Or, it may take longer to fill the drum, causing the washing machine to turn off. Water taps must be within 120 cm from the rear of the washing machine so that the provided inlet hoses reach the washing machine.

To reduce the risk of leaks:

- Make sure water taps are easily accessible.
- Turn off the taps when the washing machine is not in use.
- Check for any leaks at the water inlet hose fittings on a regular basis.

CAUTION: Before using the washing machine for the first time, check all connections at the water valve and taps for any leaks.

Drain

Samsung recommends a standpipe in height of 60~90 cm. The drain hose must be connected through the hose clip to the standpipe, and the standpipe must fully cover the drain hose.

Flooring

For best performance, the washing machine must be installed on a solid floor. Wood floors may need to be reinforced to minimize vibration and/or unbalanced loads. Carpeting and soft tile surfaces are not a good resistance to vibrations and may cause the washing machine to move slightly during the spin cycle.

CAUTION: Do NOT install the washing machine on a platform or a poorly supported structure.

Water temperature

Do not install the washing machine in areas where water may freeze as the washing machine always retains some water in its water valves, pumps, and/or hoses. Frozen water left in the connection parts may cause damage to belts, the pump, and other components of the washing machine.

Alcove or closet installation

Minimum clearance for stable operation:

| | | | |
|-------|-------|-------|--------|
| Sides | 25 mm | Rear | 50 mm |
| Top | 25 mm | Front | 550 mm |

If both the washing machine and a dryer are installed in the same location, the front of the alcove or closet must have at least a 550 mm unobstructed air opening. Your washing machine alone does not require a specific air opening.

Step-by-step installation

STEP 1: Select a location

Location requirements:

- Solid, level surface without carpeting or flooring that may obstruct ventilation
- Away from direct sunlight
- Adequate room for ventilation and wiring
- The ambient temperature is always higher than the freezing point (0 °C)
- Away from a heat source

STEP 2: Remove the shipping bolts

Unpack the product package and remove all shipping bolts.

1. Loosen all shipping bolts on the rear of the machine using the supplied spanner.

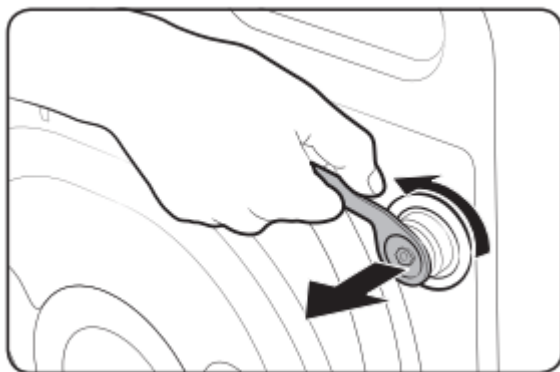

2. Fill the holes with the supplied plastic bolt caps.

Keep the shipping bolts for future use.

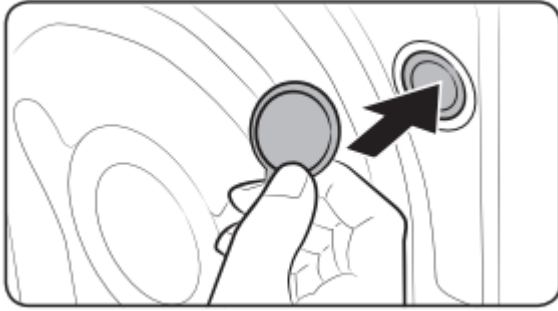

WARNING: Packaging materials can be dangerous to children. Dispose all packaging material (plastic bags, polystyrene, etc.) out of children's reach.

STEP 3: Adjust the levelling feet

1. Gently slide the washing machine into position. Excessive force may damage the levelling feet.
2. Level the washing machine by manually adjusting the levelling feet.

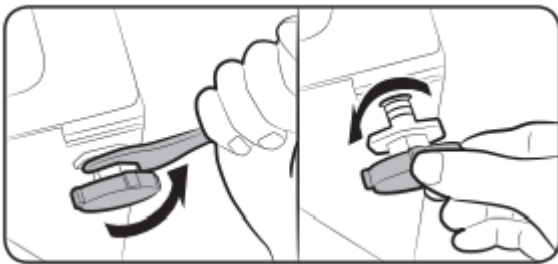

3. When levelling is complete, tighten the nuts using the spanner.

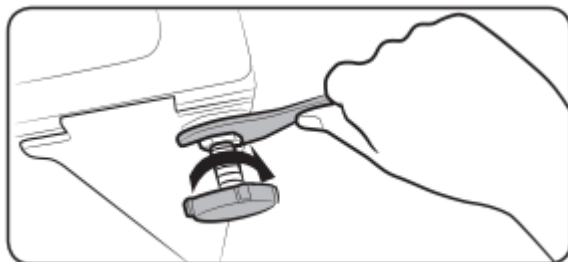

STEP 4: Connect the water hose

The provided hose adaptor may differ with the model. This step guides you through connecting the connector-type adaptor. If you are provided with the screw-type adaptor, go to 7.

Connect the water supply hose to the water tap.

1. Remove the **adaptor (A)** from the **water supply hose (B)**.

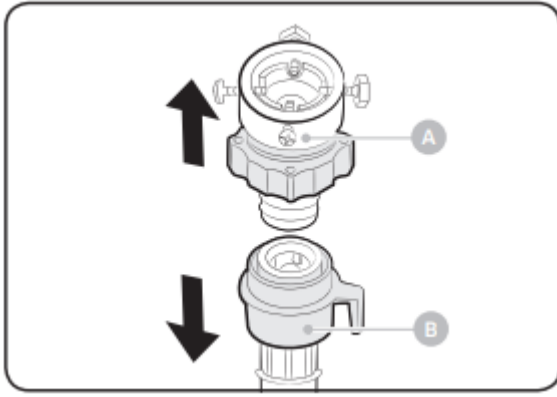

2. Use a Philips screwdriver to loosen four screws on the adaptor.

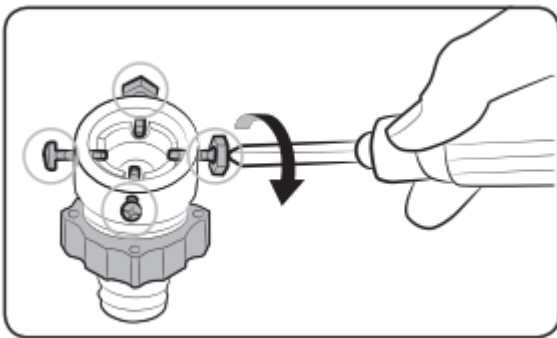

3. Hold the adaptor and turn **part (C)** in the arrow direction to loosen it by 5 mm (*).

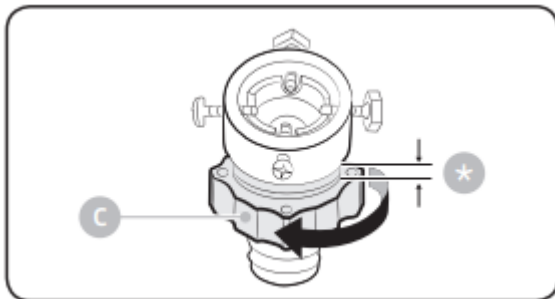

4. Insert the adaptor into the water tap, and tighten the screws while lifting up the adaptor.

5. Turn part (C) in the arrow direction to tighten it.

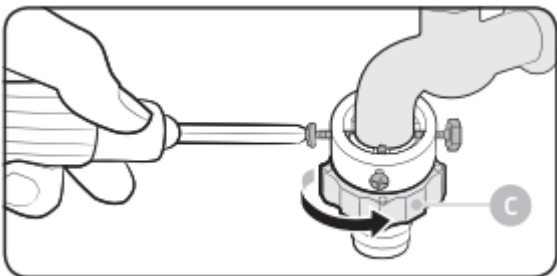

6. While holding down **part (E)**, connect the water supply hose to the adaptor. Then, release **part (E)**. The hose fits into the adaptor with a clicking sound.

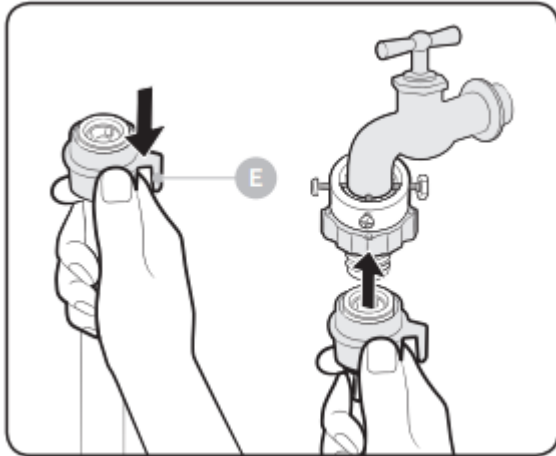

7. If you are using a screw type of water tap, use the provided screw-type adaptor to connect to the water tap as shown.

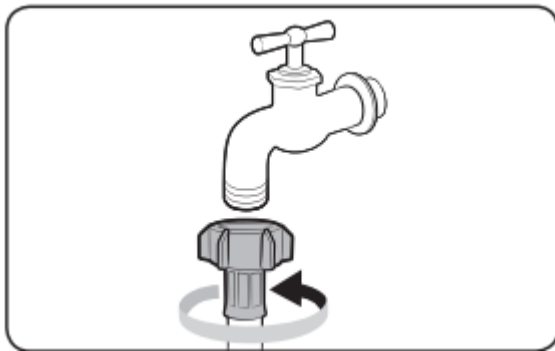

8. Connect the other end of the water supply hose to the inlet valve on the back of the washing machine. Turn the hose clockwise to tighten.

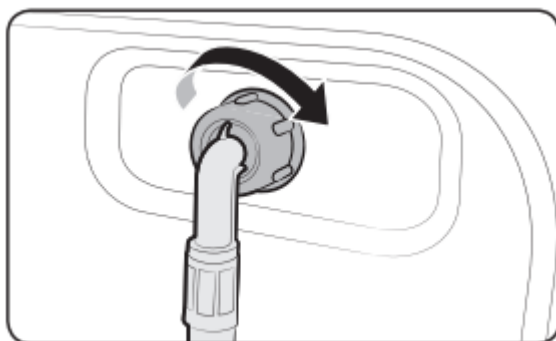

9. Open the water tap and check if there are any leaks around the connection areas. If there are water leaks, repeat the steps above.

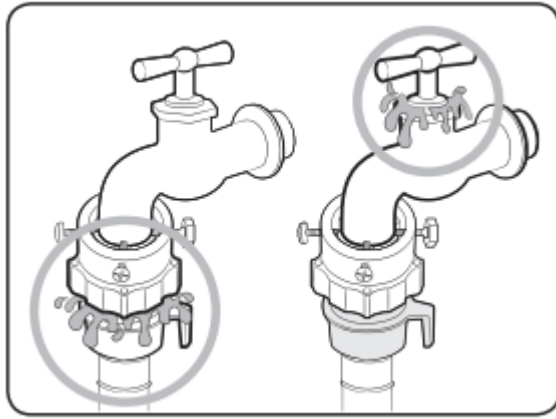

WARNING: Stop using the washing machine if there is a water leak, and contact a local Samsung service centre. Otherwise, this may cause electric shock.

CAUTION: Do not stretch the water supply hose by force. If the hose is too short, replace the hose with a longer, high-pressure hose.

NOTE:

- After connecting the water supply hose to the adaptor, check if it is connected properly by pulling the water supply hose downwards.
- Use a popular type of water taps. If the tap is square-shaped or too big, remove the spacer ring before inserting the tap into the adaptor.

For models with an additional hot water inlet:

1. Connect the red end of the hot water supply hose to the hot water inlet on the back of the machine.
2. Connect the other end of the hot water supply hose to the hot water tap.

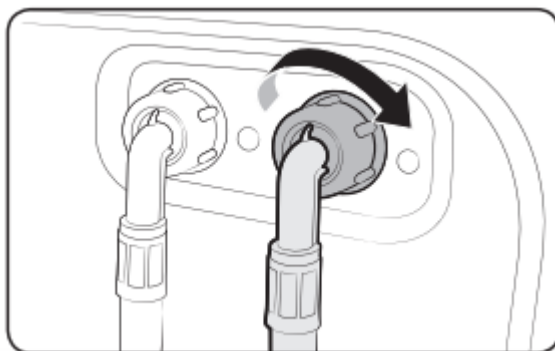

Aqua hose (applicable models only)

The aqua hose alerts users of a risk of water leaks. It senses the water flow and turns red on the centre **indicator (A)** in case of a leak.

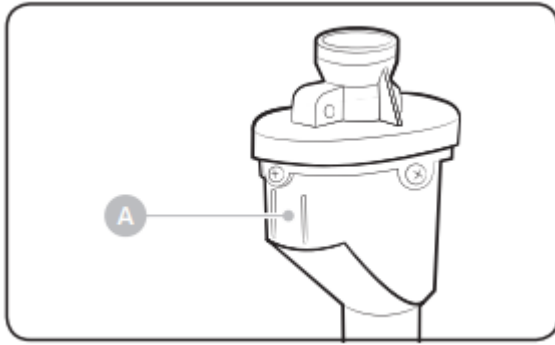

STEP 5: Position the drain hose

The drain hose can be positioned in three ways:

Over the edge of a wash basin

The drain hose must be placed at a height of between 60 cm and 90 cm (*) from the floor. To keep the spout of the drain hose bent, use the supplied **plastic hose guide (A)**. Secure the guide to the wall using a hook to ensure stable drainage.

In a sink drain pipe

The drain pipe must be above the sink siphon so that the end of the hose is at least 60 cm above the floor.

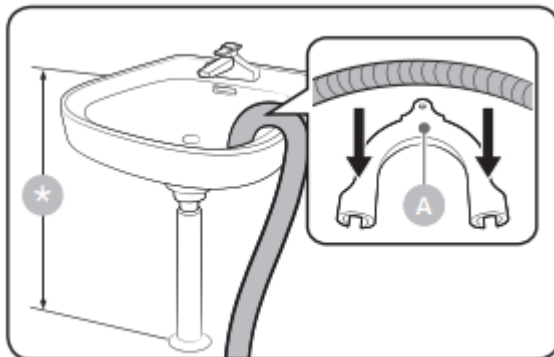

In a drain pipe

The drain pipe should be between 60 cm and 90 cm high (*). It is advisable to use a 65 cm high vertical pipe. Make sure the drain hose is connected to the stand pipe at a slant.

Drain standpipe requirements:

- Minimum diameter of 5 cm
- Minimum carry-away capacity of 60 litres per minute

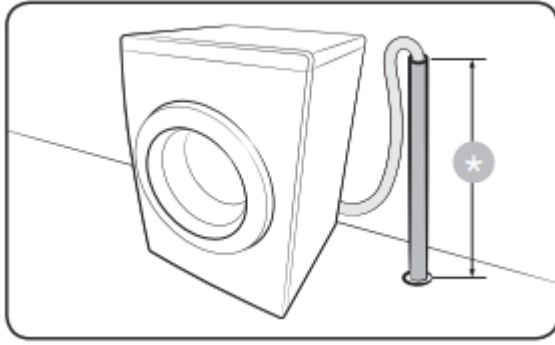

STEP 6: Turn on the washing machine

Plug the power cord into a wall socket featuring an AC 220-240 V / 50 Hz approved electrical outlet protected by a fuse or circuit breaker. Then, press the Power button to turn on the washing machine.

Before you start

Initial settings

Run Calibration (recommended)

Calibration ensures accurate weight detection by the washing machine. Make sure the drum is empty before running Calibration.

1. **Power off**, and then power on the washing machine.
2. Hold down **Temp.** and **Delay End** simultaneously for 3 seconds to enter Calibration mode. The “**CB**” message appears.
3. Press **Start/Pause** to run the Calibration cycle.
4. The drum will rotate clockwise and counter-clockwise for about 3 minutes.
5. When the cycle is complete, “**0**” appears on the display and the washing machine will turn off automatically.
6. The washing machine is now ready for use.

Laundry guidelines

STEP 1: Sort

Sort the laundry according to these criteria:

- Care Label: Sort the laundry into cottons, mixed fibres, synthetics, silks, wools, and rayon.
- Colour: Separate whites from colours.

- Size: Mixing different-sized items together in the drum improves the washing performance.
- Sensitivity: Wash delicate items separately using an Easy Iron option for pure, new woollen items, curtains, and silk items. Check the labels on the items.

NOTE: Make sure to check the care label on the clothing, and sort them accordingly before starting the wash.

STEP 2: Empty pockets

Empty all the pockets of your laundry items

- Metal objects such as coins, pins, and buckles on clothing may damage other laundry items as well as the drum.

Turn clothing with buttons and embroideries inside out

- If pants or jacket zippers are open while washing, the drum may be damaged. Zippers should be closed and fixed with a string.
- Clothing with long strings may become entangled with other clothes. Make sure to tie the strings before starting the wash.

STEP 3: Use a laundry net

- Brassieres (water washable) must be placed in a laundry net. Metal parts of the brassieres may break through and tear other laundry items.
- Small, light clothing such as socks, gloves, stockings, and handkerchiefs may become caught around the door. Place them inside a fine laundry net.
- Do not wash the laundry net by itself without other laundry. This may cause abnormal vibrations that could move the washing machine and result in injury

STEP 4 Prewash (if necessary)

Select the Prewash option for the selected course if the laundry is heavily soiled. Do not use the Prewash option when detergent is manually added into the drum.

STEP 5 Determine the load capacity

Do not overload the washing machine. Overloading may cause the washing machine to not wash properly. For the load capacity for the type of clothing, see page 35.

NOTE: When washing bedding or bedding covers, the wash time may be lengthened or the spin efficiency may be reduced. For bedding or bedding covers, the recommended maximum spin cycle speed is 800 rpm, and the load capacity is 2.0 kg or less.

CAUTION: If the laundry is unbalanced and the “**UB**” error code is displayed, redistribute the load. Unbalanced laundry may reduce the spinning performance.

STEP 6: Apply a proper detergent type

The type of detergent depends on the type of fabric (cotton, synthetic, delicate items, wool), colour, wash temperature, and degree of soiling. Always use “low suds” laundry detergent, which is designed for automatic washing machines.

NOTE

- Follow the detergent manufacturer’s recommendations based on the weight of the laundry, the degree of soiling, and the hardness of the water in your local area. If you are not sure about the water hardness, contact a local water authority.
- Do not use detergent that tends to be hardened or solidified. This detergent may remain after the rinse cycle, blocking the drain outlet.

CAUTION: When washing wool using the wool course, use only a neutral liquid detergent. If used with the Wool course, powder detergent may remain on the laundry and discolour the laundry

Detergent drawer guidelines

The washing machine provides a three-compartment dispenser: the left compartment for the main wash, the front-right for fabric softeners, and the rear-right for the preliminary wash.

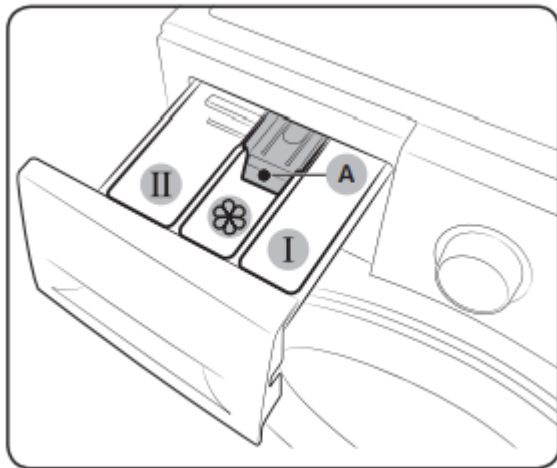

01 **I Prewash compartment:** Apply prewash detergent or starch.

02 **II Main-wash compartment:** Apply main-wash detergent, water softener, soaking detergent, bleach, and/or stain removers.

03  **Softener compartment:** Apply additives such as fabric softener. Do not exceed the **max line (A)**.

CAUTION

- Do not open the detergent drawer while the washing machine is operating.
- Do not use the following types of detergent:
 - Tablet or capsule types
 - Ball or net types
 - To prevent the compartment clogging, concentrated or highly-enriched agents (fabric softener or detergent) must be diluted with water before being applied.

To apply washing agents to the detergent drawer

1. Slide open the detergent drawer.
2. Apply laundry detergent to the : **main-wash compartment** as instructed or recommended by the manufacturer. To use liquid detergent, see page 30.

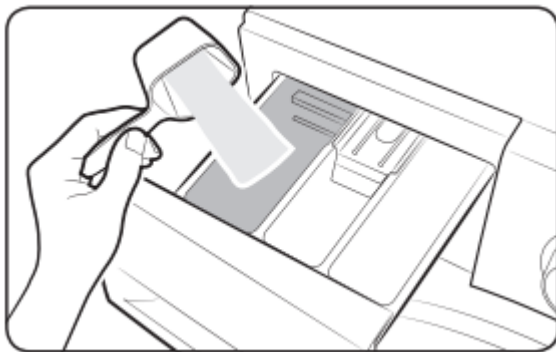

3. Apply fabric softener to the  **softener compartment**. Do not exceed the **max line (A)**

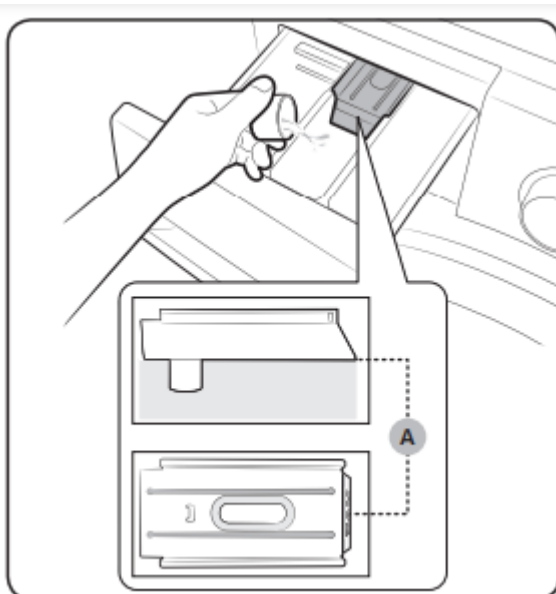

4. If you want to prewash, apply prewash detergent to the **I** **prewash compartment** as instructed or recommended by the manufacturer.

5. Close the detergent drawer.



CAUTION

- Do not apply powder detergent to the liquid container.
- Concentrated fabric softener must be diluted with water before applied.
- Do not apply main-wash detergent to the  **softener compartment**.

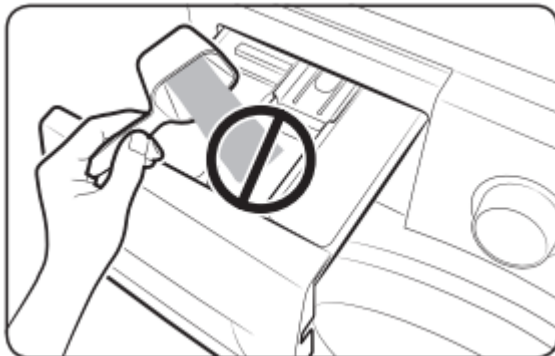

To use liquid detergent (applicable models only)

First insert the provided liquid container in the **II** **main-wash compartment**. Then, apply liquid detergent to the container below the marked **max line (A)**.

CAUTION



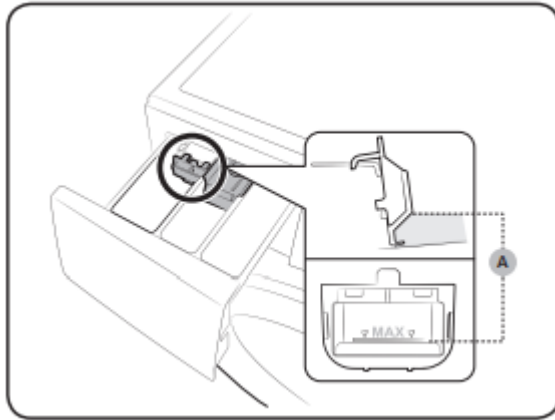



- Do not exceed the max line that is marked inside the container.
- Remove the liquid container if using powder detergent

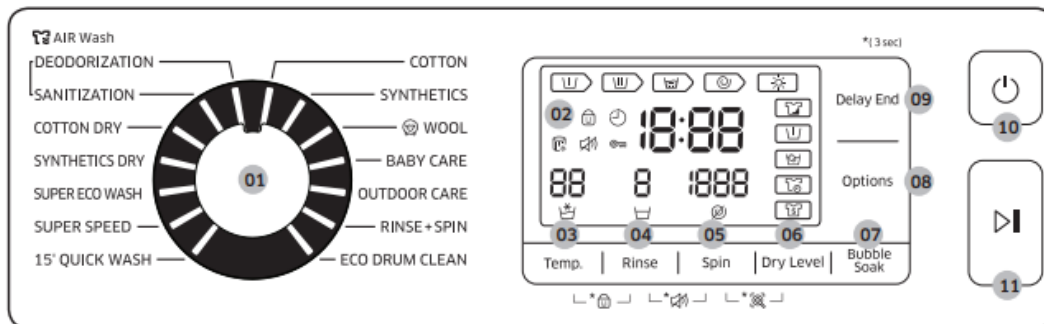

Operations

Control panel



| | |
|---------------------------|---|
| 01 Course Selector | Turn the dial to select a cycle |
| 02 Display | The display shows current cycle information and estimated time remaining, or an information code when a problem occurs. |
| 03 Temp. | Press to change the water temperature for the current cycle. |
| 04 Rinse | Press to change the rinse times for the current course. You can set the rinse times up to 5. |
| 05 Spin | Press to change the spinning speed for the current cycle. <ul style="list-style-type: none"> • Rinse Hold  : The final rinse process is suspended so that the laundry remains in the water. To unload the laundry, run a drain or spin process. • No Spin  : The drum does not spin after the final drain process. |
| 06 Dry Level | Press this button to select proper drying option. |
| 07 Bubble Soak | Press to activate/deactivate the Bubble Soak function. This function helps remove a wide variety of stubborn stains. <ul style="list-style-type: none"> • Bubble Soak helps remove a variety of stubborn stains. • With Bubble Soak selected, laundry is thoroughly soaked in water bubbles for effective washing. • Bubble Soak is available with and adds up to 30 minutes (or 20 minutes) to 3 cycles: Cotton, Synthetics, and Baby Care |
| 08 Options | Press to select an Option from Intensive  , Prewash  , and Intensive  + Prewash  . Press again to deselect. |
| 09 Delay End | Delay End lets you set the end time of the current cycle. Based on your settings, the start time of the cycle will be determined by the machine's internal logic. For example, this setting is useful for programming your machine to finish a wash at the time you normally return home from work. <ul style="list-style-type: none"> • Press to choose a preset unit of hours. |

| | |
|------------------------|--|
| 10 Power | Press to turn on/off the washing machine |
| 11 Start/ Pause | Press to start or stop an operation. |

Simple steps to start

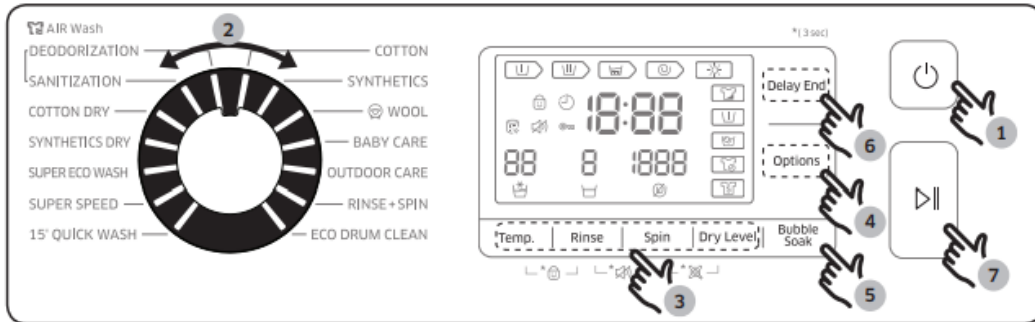

1. Press the **Power** button to turn on the washing machine.
2. Turn the **Course Selector** to select a course.
3. Change the course settings (Temp., Rinse, Spin and Dry Level) as necessary.
4. To add an option, press the **Options** button repeatedly until the corresponding option icon(s) turns on.
5. To select a preferred mode, press the **Bubble Soak** button repeatedly until the corresponding mode icon turns on.
6. To add a frequent option, press the corresponding button (**Delay End**).
7. Press the **Start/Pause** button.

To change the course during operation

1. Press the **Start/Pause** button to stop operation.
2. Select a different course.
3. Press the **Start/Pause** button again to start the new course.

Dry clothes only



You can dry your clothes directly or dry the washed clothes according to the following procedures.

1. Press **Power** button on the washing machine.
2. Use the Cycle Selector to select the appropriate drying cycle.
3. Press **Dry Level** button to select the appropriate drying mode.
4. Press **Start/Pause** button to start dry



Course overview

Standard courses

| Course | Description | Max load (kg) | |
|----------------|--|---------------|--------|
| | | WD90J6 | WD80J6 |
| COTTON | <ul style="list-style-type: none"> For cottons, bed linens, table linens, underwear, towels, or shirts. The washing time and the number of rinse cycles are automatically adjusted according to the load. | Max | Max |
| SYNTHETICS | <ul style="list-style-type: none"> For blouses or shirts that are made of polyester (diolen, trevira), polyamide (perlon, nylon), or the like. | 4 | 4 |
| WOOL | <ul style="list-style-type: none"> Specific for machine-washable wool for loads less than 2.0 kg. The wool course features gentle cradling and soaking to protect the wool fibres from shrinkage/distortion. A neutral detergent is recommended. | 2 | 2 |
| BABY CARE | <ul style="list-style-type: none"> Featuring a high-temperature wash and extra rinses to ensure that no powder detergent remains. | 4 | 4 |
| OUTDOOR CARE | <ul style="list-style-type: none"> For outdoor clothes, skiwear, and sportswear that are made of functional materials such as spandex, stretch, and micro-fibre. | 2 | 2 |
| RINSE + SPIN | <ul style="list-style-type: none"> Featuring an additional rinse after applying fabric softener to the laundry. | - | - |
| ECO DRUM CLEAN | <ul style="list-style-type: none"> Cleans the drum by removing dirt and bacteria from the drum. Perform once every 40 washes with no detergent or bleach applied. Make sure the drum is empty. Do not use any cleaning agents for cleaning the drum. | - | - |
| AIR Wash | <ul style="list-style-type: none"> This course is useful for removing bad odors. Turning the Cycle Selector cycles through the following operating modes.(DEODORIZATION > SANITIZATION) DEODORIZATION - Reduces bad smells from the laundry. SANITIZATION - Deodorize and sanitize the laundry by stronger AIR Wash action with higher temp. | - | - |
| COTTON DRY | <ul style="list-style-type: none"> Use to dry laundry such as cotton, underwear, and linen. | 6 | 5 |

| Course | Description | Max load (kg) | |
|----------------|---|---------------|--------|
| | | WD90J6 | WD80J6 |
| SYNTHETICS DRY | <ul style="list-style-type: none"> Use to dry heat-sensitive garments. This protects the fibers of the garment by drying it at low temperatures. | 3 | 3 |
| SUPER ECO WASH | <ul style="list-style-type: none"> Low-temperature Eco Bubble contributes to power saving. | 4 | 4 |
| SUPER SPEED | <ul style="list-style-type: none"> Press this button if you need to shorten the washing time, applicable for Intensive, Pre Wash, or Delay End cycles. The shortened time may differ depending on the Cycle/Load/Option. | 5 | 5 |
| 15' QUICK WASH | <ul style="list-style-type: none"> For lightly soiled garments in less than 2.0 kg that you want to wash quickly. | 2 | 2 |

Options

| Option | | Description |
|---|-------------|--|
|  | Intensive | <ul style="list-style-type: none"> For badly soiled laundry. The operation time for each cycle is longer than normal. |
|  | Pre Wash | <ul style="list-style-type: none"> This will add a preliminary washing cycle before the main wash cycle. |
|  | Bubble Soak | <ul style="list-style-type: none"> Bubble Soak helps remove a variety of stubborn stains. With Bubble Soak selected, laundry is thoroughly soaked in water bubbles for effective washing. Bubble Soak is available with and adds up to 30 minutes (or 20 minutes) to 3 cycles: Cotton, Synthetics, and Baby Care. |

Delay End

You can set the washing machine to finish our wash automatically at a later time, choosing a delay of between 1 to 19 hours (in 1 hour increments). The hour displayed indicates the time the wash will finish

1. Select a course. Then change the course settings if necessary.
2. Press the **Delay End** button repeatedly until a desired end time is set.
3. Press **Start/Pause** button.

The corresponding indicator turns on with the clock running.

4. To cancel the **Delay End**, restart the washing machine by pressing the **Power** button.

Real-life case

You want to finish a two-hour course 3 hours later from now. For this, you add the Delay End option to the current cycle with the 3-hour setting, and press **Start/Pause** at 2:00 p.m. Then, what happens? The washing machine starts operating at 3:00 p.m., and ends at 5:00 p.m. Provided below is the time line for this example.

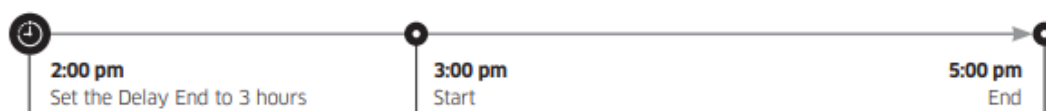

Settings

Child Lock

To prevent accidents involving children, the Child Lock function locks all buttons.

However, Child Lock does not activate until you press **Start/Pause**.

In the holding state, you can open the door or change settings by pressing corresponding buttons. However, once you press **Start/Pause** to start the washing machine, the Child Lock will be reactivated.

- Child Lock locks all buttons except for **Power**.
- To activate Child Lock, hold down **Temp.** and **Rinse** simultaneously for 3 seconds.
- To suspend or deactivate the Child Lock, hold down **Temp.** and **Rinse** simultaneously for 3 seconds once to suspend it, or hold down the buttons twice to deactivate it.

NOTE: To add detergent, put more laundry in the drum, or change the cycle settings whilst in the Child Lock state, you must first deactivate the Child Lock.

Sound On/Off

You can turn on or off the key. Your setting will remain effective after you restart the machine.

- To mute the sound, hold down the **Rinse** and **Spin** buttons simultaneously for 3 seconds.
- To unmute the sound, hold down again for 3 seconds.

Maintenance

Keep the washing machine clean to prevent deteriorated performance and to preserve its life cycle.

Eco Drum Clean

Perform this course regularly to clean the drum and to remove bacteria from it.

1. Press the **Power** button to turn on washing machine.
2. Turn the Course **Selector** to select **ECO DRUM CLEAN**.
3. Press the **Start/Pause** button.

NOTE: The water temperature for ECO DRUM CLEAN is set to 70 °C, which cannot be changed.

CAUTION: Do not use any cleaning agents for cleaning the drum. Chemical residue in the drum deteriorates the washing performance.

ECO DRUM CLEAN reminder

- The ECO DRUM CLEAN reminder appears on the main screen once every 40 washes. It is advisable to perform the ECO DRUM CLEAN regularly.
- When you first see this reminder, you can ignore the reminder for 6 consecutive times. From the 7th wash, the reminder does not appear. However, it appears again on the second 40th wash.

Smart Check

To enable this function, you must first download the **Samsung Smart Washer** app at the **Play Store** or the **Apple Store**, and install it on a mobile device featuring a camera operation.

The Smart Check function has been optimized for Galaxy & iPhone series (applicable models only).

1. Press and hold the **Spin** and **Dry Level** buttons simultaneously for 3 seconds to enter the Smart Check mode.
2. The washing machine starts the selfdiagnosis procedure and display an information code if a problem is detected.
3. Run the **Samsung Smart Washer** app on your mobile device, and tap **Smart Check**.
4. Put the mobile device close to the washing machine's display so that the mobile device and the washing machine face each other. Then, the information code will be recognized automatically by the app.
5. When the information code is recognized correctly, the app provides detailed information about the problem with applicable counteractions.



NOTE

- The function name, Smart Check, may differ depending on the language.
- If there is strong reflected light on the washing machine display, the app may fail to recognize the information code.
- If the app fails to recognize the Smart Check code consecutively, enter the information code manually onto the app screen.

Using dry course

All drying options except for the Time Dry option detect the weight of the laundry in order to display a more accurate drying time and dry the laundry more effectively.

Refer to the chart below to select the appropriate drying option according to the type and amount of laundry and the moisture you want to leave.

| Mode | Drying option | Usage | Load capacity(kg) | |
|---------------|--|---|--|--|
| | | | COTTON DRY | SYNTHETICS DRY |
| Auto Drying |  Cupboard | Use this option to dry laundry such as cotton, underwear, and linen. | 6 kg(WD90J6A****) 5 kg(WD80J6A****) | 3 kg |
| Manual Drying |  Time Dry | Use this option to dry the laundry for the specified period of time depending on the fibres, amount of laundry quantity and moisture. | 30 ~ 270 min (in 30 minutes increments) | 30 ~ 270 min (in 30 minutes increments) |

NOTE

- The drying result may differ depending on the selected washing cycle and the type/ amount of laundry.
- If both washing and drying cycles are selected, the spin speed is automatically set to enhance the drying efficiency.
- In case you want to dry laundry after a hand wash, turn the cycle selector to select the spin cycle, and then select a drying option for best performance.
- When drying is complete, dust from the dry surface of the clothes may remain on the diaphragm due to the ironing effect that prevents wrinkles. The dust will be washed away during the following wash. Alternatively, you can easily remove it with a damp towel or cloth.

CAUTION

- Do not use the drying function after applying a chlorine bleach agent to the laundry during a wash or drying cycle. Otherwise, the laundry may become discolored or the material may be damaged.
- Do not use the drying function for clothing with fur lining or made from acrylic material. This may result in the drying function being degraded.
- Do not touch the insides of the drum or the washing machine surface during or just after drying as it may be hot. This may result in burns.

AIR Wash

The AIR Wash function refreshes garments through Samsung's unique air-washing technology without the need for water.

Refer to the chart below for the usage and cycle time of each AIR Wash cycle.

| Cycle | Usage | Cycle time |
|----------------------|---|------------|
| DEODORIZATION | Use this cycle to remove bad odors from the laundry | 29min |
| SANITIZATION | Use this cycle to remove bad odors and bacteria from the laundry. | 59min |

NOTE

- The recommended maximum load capacity for the AIR Wash cycles is 1 kg or less (one or two items). If you overload the drum,, the deodorization or sanitization efficiency may be reduced.
- You can add a fragrance sheet to the laundry to add fragrance during the AIR Wash cycle.

CAUTION: Do not use any AIR Wash cycles for the following items:

- Heat-sensitive garments made from leather, mink, fur, silk, etc.
- Underwear trimmed with lace, doll cushions, and trims on dress suits may become loose.
- Clothes trimmed with buttons can cause them to break.
- Clothes full of starch may become deformed.
- Hard bedding.
- Electric blankets, furry or bulky blankets.
- Latex pillows.

Emergency drain

In case of a power failure, drain the water inside the drum before taking out the laundry

1. Power off and unplug the washing machine from the electrical outlet.
2. Gently press the top area of the filter cover (A) to open.

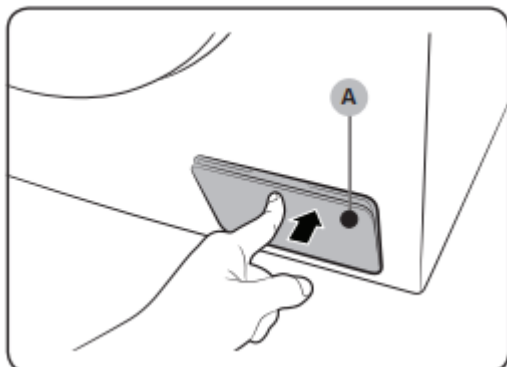

3. Put an empty, spacious container around the cover, and stretch the emergency drain tube to the container while holding the **tube cap (B)**.

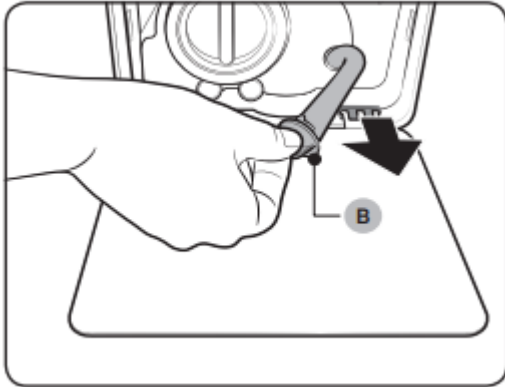

4. Open the tube cap and let water in the **Emergency drain tube (C)** flow into the container.

5. When done, close the tube cap, and reinsert the tube. Then, close the filter cover.

NOTE: Use a spacious container because the water in the drum may be more than expected.

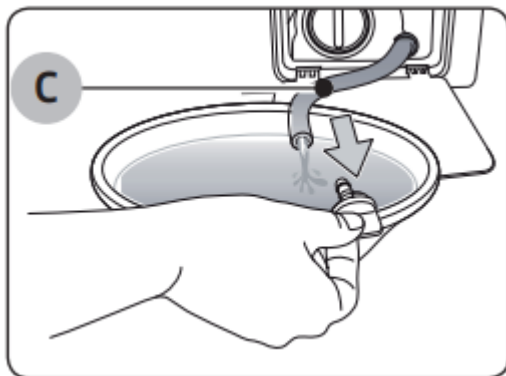

Cleaning

Surface of the washing machine

Use a soft cloth with a nonabrasive household detergent. Do not spray water onto the washing machine.

Mesh filter

Clean the mesh filter of the water supply hose once or twice a year.

1. Turn off the washing machine, and unplug the power cord.
2. Close the water tap.
3. Loosen and disconnect the water supply hose from the back of the washing machine. Cover the hose with a cloth to prevent water from gushing out.

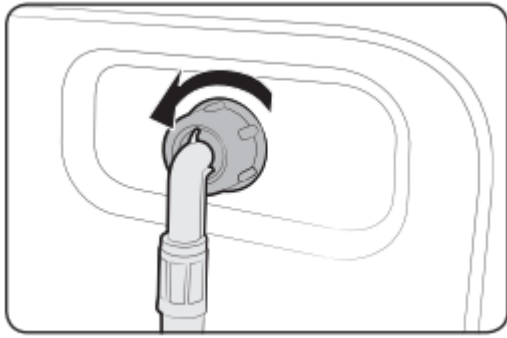

4. Use pliers to pull out the mesh filter from the inlet valve.
5. Submerge the mesh filter deeply in water so that the threaded connector is also submerged.
6. Dry the mesh filter completely in the shade.
7. Reinsert the mesh filter into the inlet valve, and reconnect the water hose to the inlet valve.
8. Open the water tap.

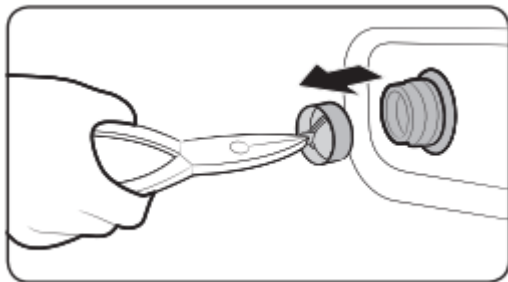

NOTE: If the mesh filter is clogged, an error code of “4C” appears on the screen.

Debris filter

It is advisable to clean the debris filter 5 or 6 times a year to prevent its clogging. A clogged debris filter may reduce the bubble effect.

1. Turn off the washing machine, and unplug the power cord.
2. Drain the remaining water inside the drum drum. See the “Emergency drain” section.
3. Gently press the top area of the filter cover to open.
4. Turn the pump filter (A) knob to the left, and drain off the remaining water.

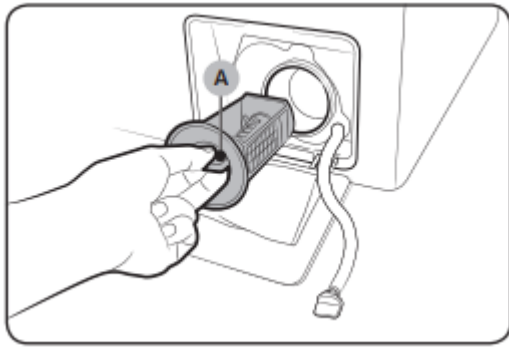

5. Clean the pump filter using soft brushes. Make sure the drain pump propeller inside the filter is unclogged.

6. Reinsert the pump filter, and turn the filter knob to the right.

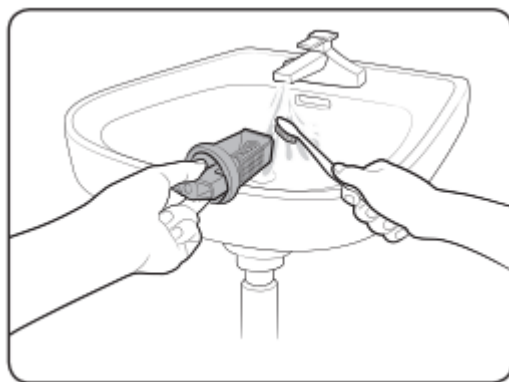

NOTE

- Some pump filters feature a safety knob that is designed to prevent accidents by children. To open the safety knob of the pump filter, push in and turn it anticlockwise. The spring mechanism of the safety knob helps open the filter.
- To close the safety knob of the pump filter, turn it clockwise. The spring makes a rattling sound, which is normal.

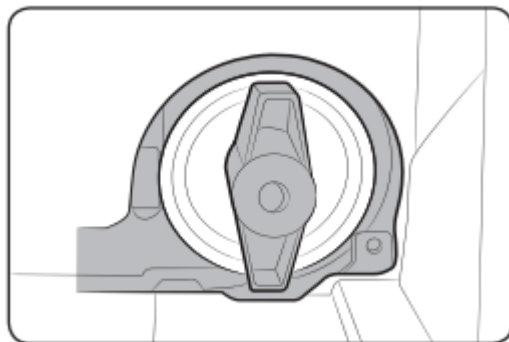

NOTE: If the debris filter is clogged, an error code of “5C” appears on the screen

CAUTION

- Make sure the filter cap is closed properly after cleaning the filter. Otherwise, this may cause a leak.
- Make sure the filter is inserted properly after cleaning it. Otherwise, this may cause an operational failure or a leak.

Detergent Drawer

1. While holding down the release lever (A) on the inner of the drawer, slide open the drawer.
2. Remove the release lever and the liquid detergent container from the drawer.

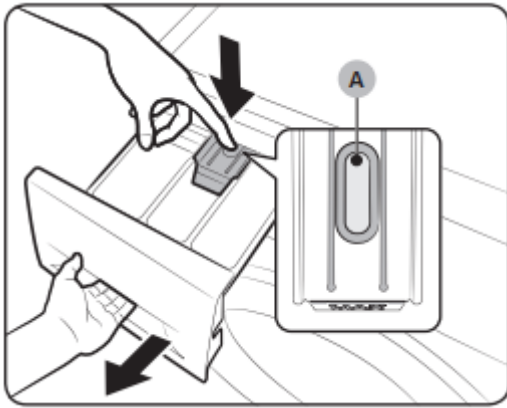

3. Clean the drawer components in flowing water using a soft brush.

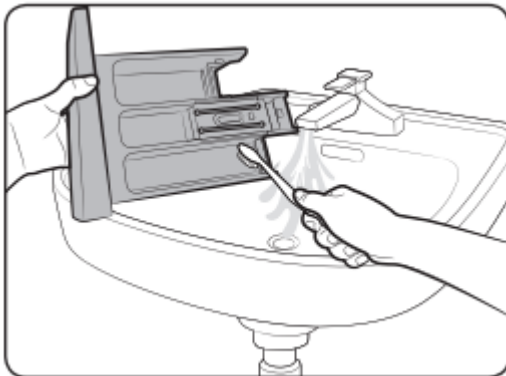

4. Clean the drawer recess using a soft brush.
5. Reinsert the release lever and the liquid detergent container to the drawer.
6. Slide the drawer inward to close it.

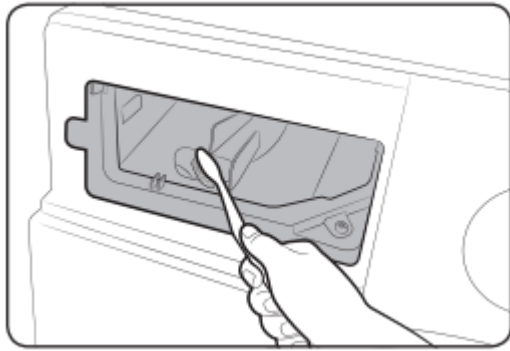

NOTE: To remove remaining detergent, perform the **RINSE+SPIN** course with the drum being empty.

Recovery from freezing

The washing machine may freeze when it drops below 0 °C.

1. Turn off the washing machine, and unplug the power cord.
2. Pour warm water over the water tap to loosen the water supply hose.
3. Disconnect the water supply hose, and soak it in warm water.
4. Pour warm water into the drum and leave it for about 10 minutes.
5. Reconnect the water supply hose to the water tap.

NOTE: If the washing machine still doesn't operate normally, repeat the above steps until it operates normally. Care against an extend

Care against an extended time of disuse

Avoid leaving the washing machine unused for an extended time.

If this is the case, drain the washing machine and unplug the power cord.

1. Turn the **Course Selector** to select a **RINSE+SPIN**.
2. Empty the drum, and press **Start/Pause** button.
3. When the course is complete, close the water tap and disconnect the water supply hose.
4. Turn off the washing machine, and unplug the power cord.
5. Open the door to let air circulate through the drum.

Troubleshooting

Checkpoints

If you encounter a problem with the washing machine, first check the table below and try the suggestions.

| Problem | Action |
|---|--|
| Does not start. | <ul style="list-style-type: none"> • Make sure the washing machine is plugged in. • Make sure the door is properly closed. • Make sure the water taps are open. • Make sure to press or tap Start/Pause to start the washing machine. • Make sure Child Lock is not activated. • Before the washing machine starts to fill, it will make a series of clicking noises to check the door lock and does a quick drain. • Check the fuse or reset the circuit breaker |
| Water supply is insufficient, or no water is supplied. | <ul style="list-style-type: none"> • Fully open the water tap. • Make sure the door is properly closed. • Make sure the water supply hose is not frozen. • Make sure the water supply hose is not kinked or clogged. • Make sure there is sufficient water pressure. |
| After a cycle, detergent remains in the detergent drawer. | <ul style="list-style-type: none"> • Make sure the washing machine is running with sufficient water pressure. • Make sure the detergent is added to the centre of the detergent drawer. • Make sure the rinse cap is inserted properly. • If using granular detergent, make sure the detergent selector is in the upper position. • Remove the rinse cap and clean the detergent drawer. |
| Excessive vibrations or makes noise. | <ul style="list-style-type: none"> • Make sure the washing machine is installed on a level, solid floor that is not slippery. If the floor is not level, use the levelling feet to adjust the height of the washing machine. • Make sure the shipping bolts are removed. • Make sure the washing machine is not contacting any other object. • Make sure the laundry load is balanced. |

| | |
|-----------------------------|--|
| | <ul style="list-style-type: none"> • The motor can cause noise during normal operation. • Overalls or metal-decorated clothes can cause noise while being washed. This is normal. • Metal objects such as coins can cause noise. After washing, remove these objects from the drum or filter case. |
| Does not drain and/or spin. | <ul style="list-style-type: none"> • Make sure the drain hose is straightened all the way to the drain system. If you encounter a drain restriction, call for service. • Make sure the debris filter is not clogged. • Close the door and press or tap Start/Pause. For your safety, the washing machine will not tumble or spin unless the door is closed. • Make sure the drain hose is not frozen or clogged. • Make sure the drain hose is connected to a drain system that is not clogged. • If the washing machine is not supplied with sufficient power, the washing machine temporarily will not drain or spin. As soon as the washing machine regains sufficient power, it will operate normally. |
| The door does not open. | <ul style="list-style-type: none"> • Press or tap Start/Pause to stop the washing machine. • It may take a few moments for the door lock mechanism to disengage. • The door will not open until 3 minutes after the washing machine has stopped or the power turned off. • Make sure all the water in the drum is drained. • The door may not open if water remains in the drum. Drain the drum and open the door manually. • Make sure the door lock light is off. The door lock light turns off after the washing machine has drained. |
| Excessive suds. | <ul style="list-style-type: none"> • Make sure the Auto Detergent and Auto Softener settings are properly configured. • Make sure you use the recommended types of detergent as appropriate. |

| | |
|---|---|
| | <ul style="list-style-type: none"> • Use high efficiency (HE) detergent to prevent oversudsing. • Reduce the detergent amount for soft water, small loads, or lightly soiled loads. • Non-HE detergent is not recommended. |
| Cannot apply additional detergent. | <ul style="list-style-type: none"> • Make sure the remaining amount of detergent and fabric softener is not over the limit. • Make sure the Auto Dispense function is activated, with both the Water Hardness and Concentration settings properly specified. |
| Stops | <ul style="list-style-type: none"> • Plug the power cord into a live electrical outlet. • Check the fuse or reset the circuit breaker. • Close the door and press or tap Start/Pause to start the washing machine. For your safety, the washing machine will not tumble or spin unless the door is closed. • Before the washing machine starts to fill, it will make a series of clicking noises to check the door lock and does a quick drain. • There may be a pause or soak period in the cycle. Wait briefly and the washing machine may start. • Make sure the mesh filter of the water supply hose at the water taps are not clogged. Periodically clean the mesh filter. • If the washing machine is not supplied with sufficient power, the washing machine temporarily will not drain or spin. As soon as the washing machine regains sufficient power, it will operate normally. |
| Fills with the wrong water temperature. | <ul style="list-style-type: none"> • Fully open both taps. • Make sure the temperature selection is correct. • Make sure the hoses are connected to the correct taps. Flush water lines. • Make sure the water heater is set to supply a minimum 120 °F (49 °C) hot water at the tap. Also, check the water heater capacity and recovery rate. |

| | |
|---|--|
| | <ul style="list-style-type: none"> • Disconnect the hoses and clean the mesh filter. The mesh filter may be clogged. • While the washing machine fills, the water temperature may change as the automatic temperature control feature checks incoming water temperature. This is normal. • While the washing machine fills, you may notice just hot and/or just cold water going through the dispenser when cold or warm temperatures are selected. This is a normal function of the automatic temperature control feature as the washing machine determines the water temperature. |
| Load is wet at the end of a cycle. | <ul style="list-style-type: none"> • Use the High or Extra High spin speed. • Use high efficiency (HE) detergent to reduce oversudsing. • Load is too small. Small loads (one or two items) may become unbalanced and not spin completely. • Make sure the drain hose is not kinked or clogged. |
| Leaks water | <ul style="list-style-type: none"> • Make sure the door is properly closed. • Make sure all hose connections are tight. • Make sure the end of the drain hose is correctly inserted and secured to the drain system. • Avoid overloading. • Use high efficiency (HE) detergent to prevent oversudsing |
| Has odours. | <ul style="list-style-type: none"> • Excessive suds collect in recesses and can cause foul odours. • Run cleansing cycles to sanitize periodically. • Clean the door seal (diaphragm). • Dry the washing machine interior after a cycle has finished. |
| No bubbles are seen (Bubbleshot models only). | <ul style="list-style-type: none"> • Overloading may screen bubbles. • Severely contaminated laundry may not generate bubbles. |
| Wi-Fi does not work (Wi-Fi models only). | <ul style="list-style-type: none"> • Make sure the Internet connection to your house is properly established. |

- Make sure the router turns on and operates normally.
- Make sure you have installed the latest version of the Smart Control App.

If a problem persists, contact a local Samsung service centre.

Information codes

If the washing machine fails to operate, you may see an information code on the screen. Check the table below and try the suggestions.

| Problem | Action |
|---------|--|
| 4C | <p>Water is not supplied.</p> <ul style="list-style-type: none"> • Make sure the water taps are open. • Make sure the water hoses are not clogged. • Make sure the water taps are not frozen. • Make sure the washing machine is operating with sufficient water pressure. • Make sure that the cold water tap and the hot water tap are properly connected. • Clean the mesh filter as it may be clogged. <p>NOTE: When the washer displays the “4C” code, the washer do draining for 3 minutes. During this time, the Power button is inoperative.</p> |
| 4C2 | <ul style="list-style-type: none"> • Make sure the cold water supply hose is firmly connected to the cold water tap. <p>If it is connected to the hot water tap, the laundry may be deformed with some cycles.</p> |
| 5C | <p>Water is not draining.</p> <ul style="list-style-type: none"> • Make sure the drain hose is not frozen or clogged. • Make sure the drain hose is positioned correctly, depending on the connection type. • Clean the debris filter as it may be clogged. • Make sure the drain hose is straightened all the way to the drain system. • If the information code remains, contact a customer service centre. |
| DC | <p>Operating the washer with the door open.</p> <ul style="list-style-type: none"> • Make sure the door is properly closed. • Make sure laundry is not caught in the door. |
| OC | <p>Water is overflowed.</p> <ul style="list-style-type: none"> • Restart after spinning. • If the information code remains on the display, contact a local Samsung service centre. |
| LC | <p>Check the drain hose.</p> |

| | |
|-------------------|--|
| <p>LC1</p> | <ul style="list-style-type: none"> • Make sure the end of the drain hose is placed on the floor. • Make sure the drain hose is not clogged. • If the information code remains, contact a customer service centre. <p>NOTE: When the washer displays the “LC/LC1” code, the washer do draining for 3 minutes. During this time, the Power button is inoperative.</p> |
| <p>UB</p> | <p>Spinning does not work.</p> <ul style="list-style-type: none"> • Make sure laundry is spread out evenly. • Make sure the washing machine is on a flat, stable surface. • Redistribute the load. If only one item of clothing needs washing, such as a bathrobe or pair of jeans, the final spin result might be unsatisfactory, and an “UB” check message will be shown in the display. |
| <p>3C</p> | <p>Check the motor for operation.</p> <ul style="list-style-type: none"> • Try restarting the cycle. • If the information code remains, contact a customer service centre. |
| <p>UC</p> | <p>The electronic control needs to be checked (Over Voltage Error).</p> <ul style="list-style-type: none"> • Check the PCB and wire harness. • Check if power is supplied properly • If the information code remains, contact a customer service centre. <p>Low voltage detected.</p> <ul style="list-style-type: none"> • Check if the power cord is plugged in. • If the information code remains, contact a customer service centre. |
| <p>HC</p> | <p>High temperature heating check.</p> <ul style="list-style-type: none"> • If the information code remains, contact a customer service centre. |
| <p>1C</p> | <p>The Water Level sensor is not working properly.</p> <ul style="list-style-type: none"> • Try power off and restarting the cycle. • Check Water Level Sensor wire harness. • If the information code remains, contact a customer service centre. |





















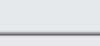
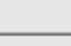



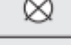

| | |
|-----------|--|
| | NOTE: When the washer displays the “1C” code, the washer do draining for 3 minutes. During this time, the Power button is inoperative. |
| AC | <p>Check communications between main and sub PBAs.</p> <ul style="list-style-type: none"> • Try power off and restarting the cycle. • If the information code remains, contact a customer service centre. |

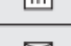
If any information code keeps appearing on the screen, contact a local Samsung service centre

Specifications

Fabric care chart

The following symbols provide garment care directions. The care labels include four symbols in this order: washing, bleaching, drying and ironing (and dry cleaning when necessary). The use of symbols ensures consistency among garment manufacturers of domestic and imported items. Follow the care label directions to maximize garment life and reduce laundry problems.

| | | | |
|---|-------------------------------|---|---|
|  | Resistant material |  | Do not iron |
|  | Delicate fabric |  | Can be dry cleaned using any solvent |
|  | Item can be washed at 95 °C |  | Dry Clean |
|  | Item can be washed at 60 °C |  | Dry clean with perchloride, lighter fuel, pure alcohol or R113 only |
|  | Item can be washed at 40 °C |  | Dry clean with aviation fuel, pure alcohol or R113 only |
|  | Item can be washed at 30 °C |  | Do not dry clean |
|  | Hand wash only |  | Dry flat |
|  | Dry clean only |  | Can be hung to dry |
|  | Can be bleached in cold water |  | Dry on clothes hanger |
|  | Do not bleach |  | Tumble dry, normal heat |
|  | Can be ironed at 200 °C max |  | Tumble dry, reduced heat |
|  | Can be ironed at 150 °C max |  | Do not tumble dry |
|  | Can be ironed at 100 °C max | | |

Protecting the environment

- This appliance is manufactured from recyclable materials. If you decide to dispose of this appliance, please observe local waste disposal regulations. Cut off the power cord so that the appliance cannot be connected to a power source. Remove the door so that animals and small children cannot get trapped inside the appliance.
- Do not exceed the detergent quantities recommended in the detergent manufacturer's instructions.
- Use stain removal products and bleaches before the wash cycle only when strictly necessary.
- Save water and electricity by only washing full loads (the exact amount depends upon the program used).

Specification sheet

“ * ” Asterisk(s) means variant model and can be varied (0-9) or (A-Z).

| Type | | Front loading washing machine | |
|------------------------|---------------------|-------------------------------|-------------------------|
| Model name | | WD90J6***** | WD80J6***** |
| Dimensions | | W600 x D650 x H850 (mm) | W600 x D600 x H850 (mm) |
| Water pressure | | 50 kPa ~ 800 kPa | |
| NET weight | | 70 kg | 71 kg |
| Wash and spin capacity | | 9.0 kg | 8.0 kg |
| Dry Capacity | | 6.0 kg | 5.0 kg |
| Power consumption | Washing | 220 V | 100 W |
| | | 240 V | 100 W |
| | Washing and heating | 220 V | 2000 W |
| | | 240 V | 2400 W |
| | Drying | 220 V | 1600 W |
| | | 240 V | 1600 W |
| | Spin | 220 ~ 240 V | 450 W |
| Pumping | | 30 W | |
| Spin revolutions | | 1400 rpm | |

NOTE: The design and specifications are subject to change without notice for quality improvement purposes.

According to Regulation (EU) No. 90/60/EC

“ * ” Asterisk(s) means variant model and can be varied (0-9) or (A-Z).

| Samsung | | |
|---|-------------|--------------------------|
| Model Name | WD90J6A**** | |
| Energy Efficiency Class | | |
| A (highest efficient) to G (lowest efficient) | A | |
| Energy Consumption | | |
| Washing, spinning, and drying | kWh | 6.12 |
| Washing and spinning only | kWh | 1.17 |
| Washing Performance Class | | |
| A (highest efficient) to G (lowest efficient) | A | |
| Water Extraction Efficiency Class | | |
| A (highest efficient) to G (lowest efficient) | A | |
| Residual moisture | % | 44 |
| Maximum Spin Speed | rpm | 1400 |
| Capacity | | |
| Washing | kg | 9.0 |
| Drying | kg | 6.0 |
| Water Consumption | | |
| Washing, spinning, and drying | ℓ | 99 |
| Washing and spinning only | ℓ | 54 |
| Program Duration | | |
| Washing, spinning, and drying | min | 665 |
| Washing and spinning only | min | 290 |
| Programs to which the information on the label and the Sheet relate | Wash | Cotton 60 °C + Intensive |
| | Dry | Cotton Dry + Spin |
| Estimatd annual consumption for a 4-person household, always using the dries (200 cycles) | | |
| Energy Consumption | kWh/yr | 1224 |
| Water Consumption | ℓ | 19800 |
| Estimatd annual consumption for a 4-person household, never using the drier (200 cycles) | | |
| Energy Consumption | kWh/yr | 234 |
| Water Consumption | ℓ | 10800 |

| Noise using standard 60 °C cotton washing cycle and 'dry cotton' drying cycle | | |
|---|----------------|----|
| Washing | dB (A) re 1 pW | 54 |
| Spinning | dB (A) re 1 pW | 73 |
| Drying | dB (A) re 1 pW | 59 |

The drying energy consumption data has been measured under the conditions specified in Standard EN50229.

- First drying should be performed with 6 kg load (the load consist: 2 sheets and 8 pillowcases and 23 towels) by selecting Cotton Dry + Spin;
- Second drying should be performed with 3 kg load (the load consist: 2 sheets and 6 pillowcases and 0 towels) by selecting Cotton Dry + Spin;

(1 or 2 towels can be added or removed for setting weight.)

According to Regulation (EU) No. 90/60/EC

“ * ” Asterisk(s) means variant model and can be varied (0-9) or (A-Z).

| Samsung | | |
|--|----------------|--------------------------|
| Model Name | WD80J6A**** | |
| Energy Efficiency Class | | |
| A (highest efficient) to G (lowest efficient) | A | |
| Energy Consumption | | |
| Washing, spinning, and drying | kWh | 5.44 |
| Washing and spinning only | kWh | 1.04 |
| Washing Performance Class | | |
| A (highest efficient) to G (lowest efficient) | A | |
| Water Extraction Efficiency Class | | |
| A (highest efficient) to G (lowest efficient) | A | |
| Residual moisture | % | 44 |
| Maximum Spin Speed | rpm | 1400 |
| Capacity | | |
| Washing | kg | 8.0 |
| Drying | kg | 5.0 |
| Water Consumption | | |
| Washing, spinning, and drying | ℓ | 88 |
| Washing and spinning only | ℓ | 48 |
| Program Duration | | |
| Washing, spinning, and drying | min | 640 |
| Washing and spinning only | min | 290 |
| Programs to which the information on the label and the Sheet relate | Wash | Cotton 60 °C + Intensive |
| | Dry | Cotton Dry + Spin |
| Estimated annual consumption for a 4-person household, always using the dries (200 cycles) | | |
| Energy Consumption | kWh/yr | 1088 |
| Water Consumption | ℓ | 17600 |
| Estimated annual consumption for a 4-person household, never using the drier (200 cycles) | | |
| Energy Consumption | kWh/yr | 208 |
| Water Consumption | ℓ | 9600 |
| Noise using standard 60 °C cotton washing cycle and 'dry cotton' drying cycle | | |
| Washing | dB (A) re 1 pW | 54 |
| Spinning | dB (A) re 1 pW | 73 |
| Drying | dB (A) re 1 pW | 59 |

The drying energy consumption data has been measured under the conditions specified in Standard EN50229.

- First drying should be performed with 5 kg load (the load consist: 2 sheets and 6 pillowcases and 18 towels) by selecting Cotton Dry + Spin;
- Second drying should be performed with 3 kg load (the load consist: 1 sheets and 6 pillowcases and 7 towels) by selecting Cotton Dry + Spin;

(1 or 2 towels can be added or removed for setting weight.)

Warning

This content is compiled from multiple sources and is provided for reference purposes only. It may not be complete or fully applicable to all situations. If you are unable to resolve your issue, please contact the product manufacturer or an authorized service provider for official support.

Document generated by [ManualsFile](#)

