

## Programming and Operation

### Quick reference: residential use

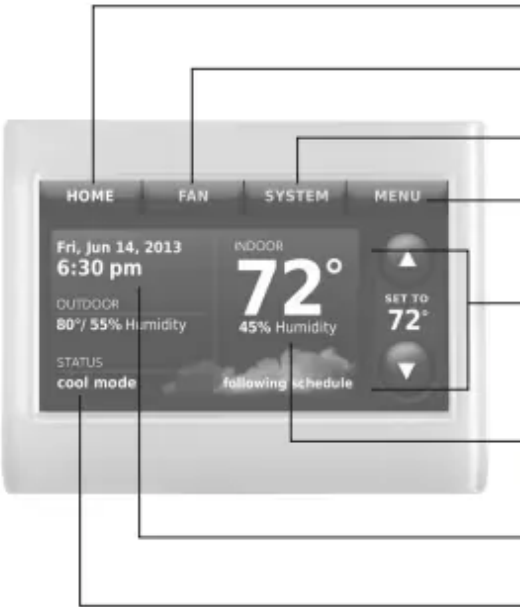

The diagram shows a residential thermostat interface with the following elements: a top navigation bar with 'HOME', 'FAN', 'SYSTEM', and 'MENU' buttons; a main display area showing 'Fri, Jun 14, 2013 6:30 pm', 'OUTDOOR 80° / 55% Humidity', 'STATUS cool mode', 'INDOOR 72° 45% Humidity', and 'following schedule'; and a right-side control panel with 'SET TO 72°' and up/down arrows.

- HOME.** Touch to display Home screen.
- FAN.** Select fan mode.
- SYSTEM.** Select system mode (Heat/Cool).
- MENU.** Touch to display options. Start here to set a program schedule.
- Current schedule.** Touch an arrow to change temperature setting and select a Temporary or Permanent Hold.
- Indoor conditions.** Shows indoor temperature and humidity.
- Current date and time.**
- Current status.** Shows system mode (heat/cool), outdoor temperature and humidity (with optional outdoor sensor).

### Quick reference: light commercial use

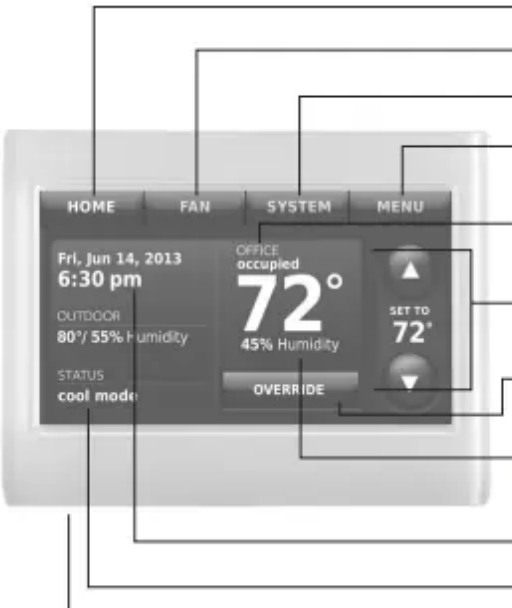

The diagram shows a light commercial thermostat interface with the following elements: a top navigation bar with 'HOME', 'FAN', 'SYSTEM', and 'MENU' buttons; a main display area showing 'Fri, Jun 14, 2013 6:30 pm', 'OUTDOOR 80° / 55% Humidity', 'STATUS cool mode', 'OFFICE occupied', '72° 45% Humidity', and 'OVERRIDE'; and a right-side control panel with 'SET TO 72°' and up/down arrows.

- HOME.** Touch to display Home screen.
- FAN.** Select fan mode.
- SYSTEM.** Select system mode (Heat/Cool).
- MENU.** Touch to display options. Start here to set a program schedule.
- Thermostat location.** Quickly identify which thermostat is in control of a specific area.
- Current schedule.** Touch an arrow to change temperature setting and set a temporary hold.
- Override.** Touch to temporarily override the program schedule.
- Indoor conditions.** Shows indoor temperature and humidity.
- Current date and time.**
- Current status.** Shows system mode (heat/cool), outdoor temperature and humidity (with optional outdoor sensor).
- USB port.** Use USB device to load holiday schedules and custom events.



## Setting the time/date

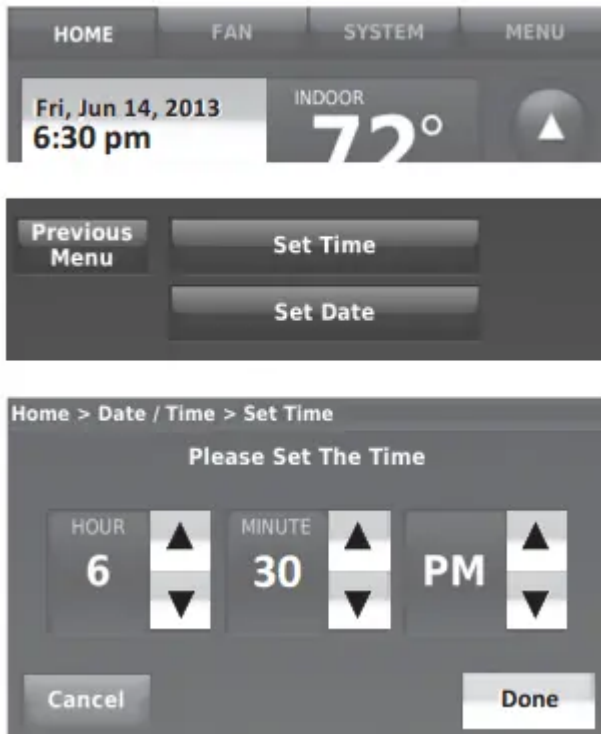

1. Touch the current time. The screen displays Set Time/Set Date.
2. Touch Set Time or Set Date.
3. Touch ▲ or ▼ until the proper time/ date is displayed.
4. Touch Done to save or Cancel to ignore changes.

NOTE: The thermostat will automatically switch to and from Daylight Saving Time.

NOTE: When used with the RedLINK Gateway, time/date is updated via the Internet. For some software versions of Prestige, installation without Gateway does not allow you to adjust time for 72 hours unless you remove the coin cell battery for a minute and then re-insert it.

## Setting the fan

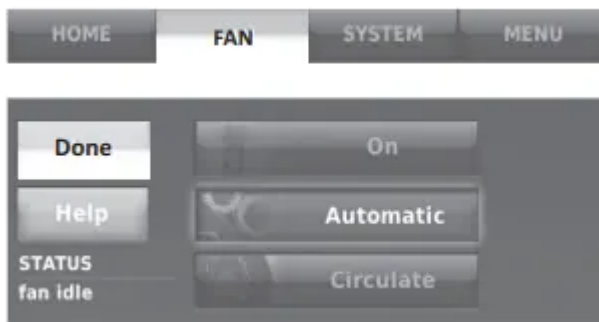

1. Touch FAN to display fan settings.

2. Touch On, Automatic, Circulate, or Follow Schedule.

3. Touch Done to save and exit.

On: Fan is always on.

Automatic: Fan runs only when the heating or cooling system is on.

Circulate: Fan runs randomly about 35% of the time (residential use only).

Follow Schedule: Fan controlled by program

## Setting system mode

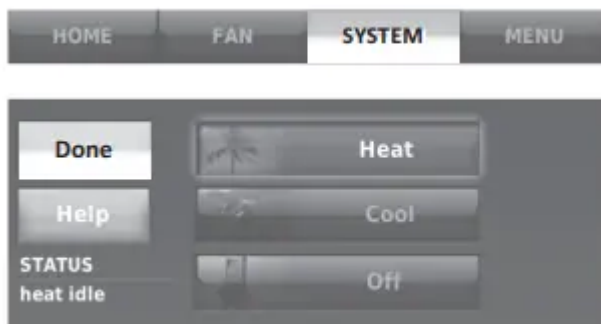

1. Touch SYSTEM to display system settings.

2. Touch desired option:

Heat: Thermostat controls only the heating system.

Cool: Thermostat controls only the cooling system.

Off: Heating/cooling systems are off.

Automatic: Thermostat selects heating or cooling as needed depending on the indoor temperature.

Emergency Heat (heat pumps with aux. heat): Controls auxiliary/ emergency heat.

Compressor is locked out.

3. Touch Done to save and exit.

## Adjusting program schedules

1. Touch MENU.

2. Select Create/Edit Schedule.

- Touch Guide Me to create a schedule by answering simple questions.
- Touch I'll do it myself to manually create a program schedule.
- Touch View/Edit to view the full schedule and make a quick adjustment.

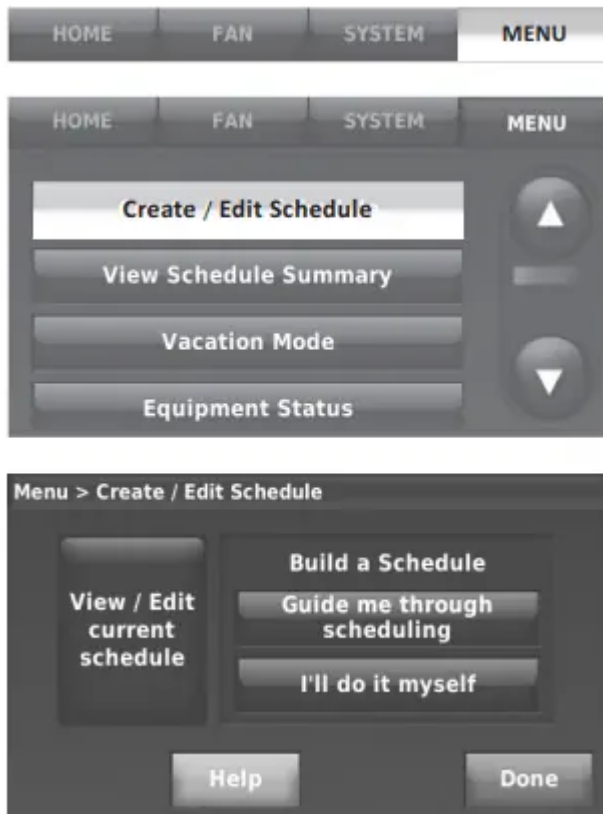

3. Select the days to schedule, touch Next.
4. Touch Wake to set your Wake time for selected day(s).
5. Touch ▲ or ▼ to set Heat and Cool temperatures for the Wake period, then touch Done.
6. Touch other time periods (Leave, Return, Sleep) to set time and temperatures for each.
7. Touch Done to save and exit.

NOTE: Touch Delete Period to eliminate any unwanted time period.

NOTE: Touch Fan Settings to customize fan settings for any time period.

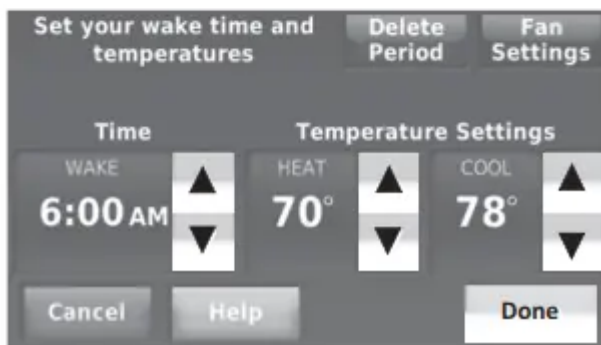
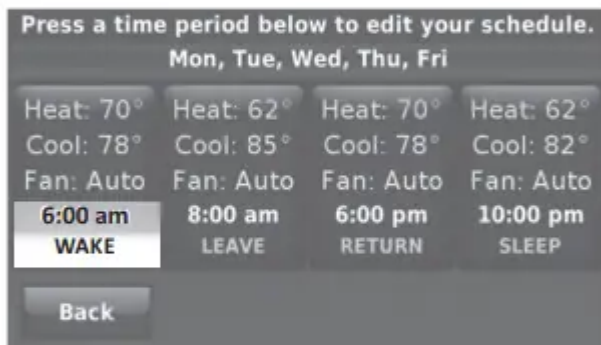
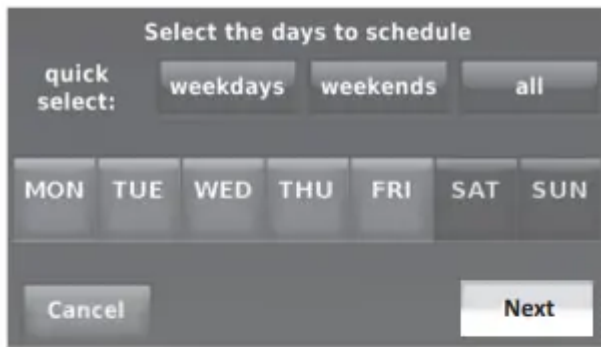

### Overriding schedules: residential use



1. Touch ▲ or ▼ to adjust the temperature (right side of screen) and the Hold Until time (left side). The schedule will resume when the Hold Until time expires.
2. Touch Switch to Permanent Hold to keep the same temperature until you change it or resume the program schedule.



3. Touch Cancel Hold at any time to resume the program schedule.

### Overriding schedules: commercial use



Touch ▲ or ▼ to adjust the temperature. It will be maintained until the hold time you set.

- To change the hold time, touch the Hold Until arrow buttons. This time can be adjusted up to the maximum time set by the installer.
- Touch Override to use a pre-set occupied temperature if a person uses the room during an unoccupied period. The new temperature will be maintained for 1 hour and can be adjusted up to the maximum time set by the installer.

The programmed schedule will resume when the override timer expires. Touch Cancel Hold at any time to resume the program schedule.

# Menu Options

## Viewing equipment status

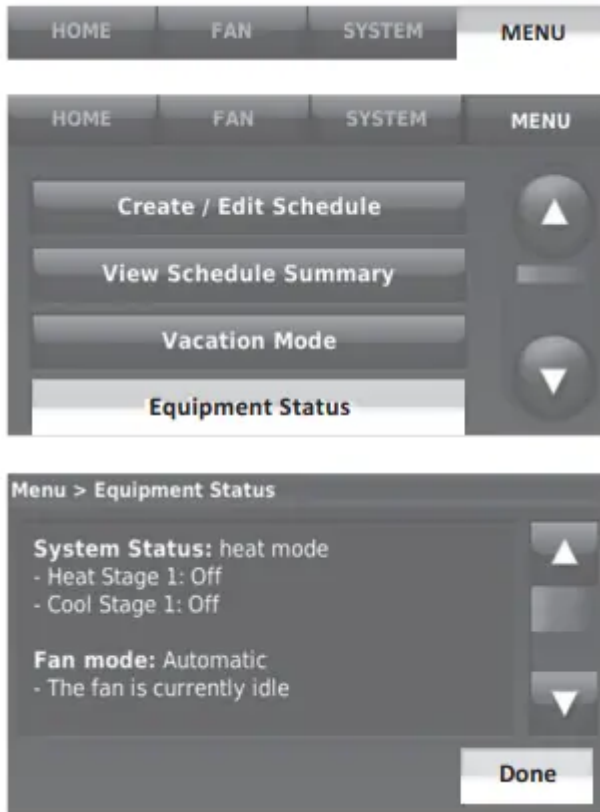

1. Touch MENU.
2. Select Equipment Status.
3. Touch ▲ or ▼ to view the status of all the equipment your thermostat is controlling. Depending on how your thermostat was installed, the Equipment Status screen can report data about the following systems:
  - Heating and cooling
  - Fan
  - Humidification
  - Dehumidification
  - Ventilation
  - Maintenance reminders
  - Thermostat information.

## Setting vacation hold: residential use

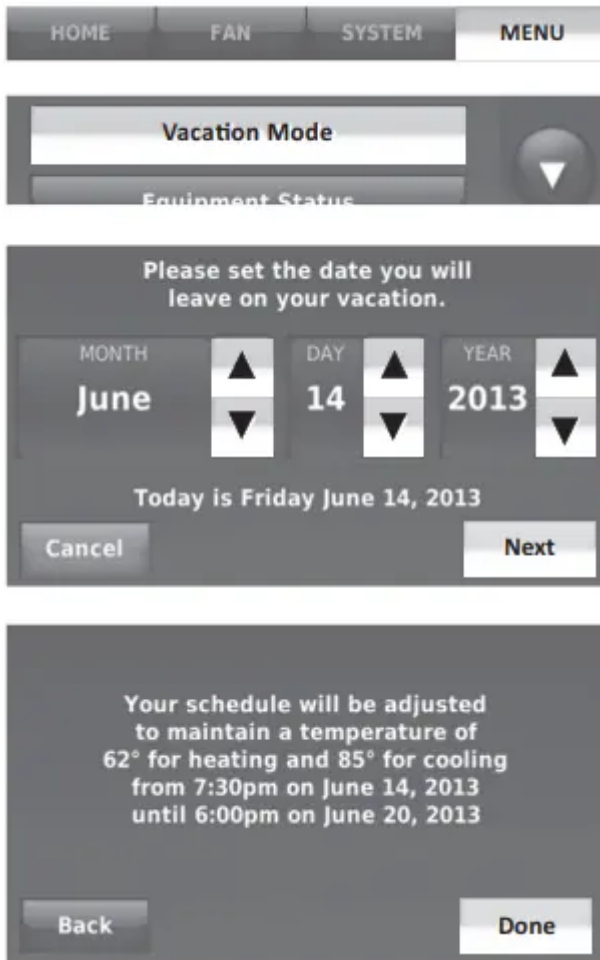

This feature helps you save energy while you are away, and restores comfortable settings just before you return home.

1. Touch MENU.
2. Select Vacation Mode.
3. Touch ▲ or ▼ to select the date you leave, then touch Next for further scheduling details, including times of day, temperature settings, return date, and return settings.
4. Review your selections on the last display, and touch Done to save your settings. Touch Back, then Cancel to ignore the changes.

## Setting holiday/event schedules: commercial use

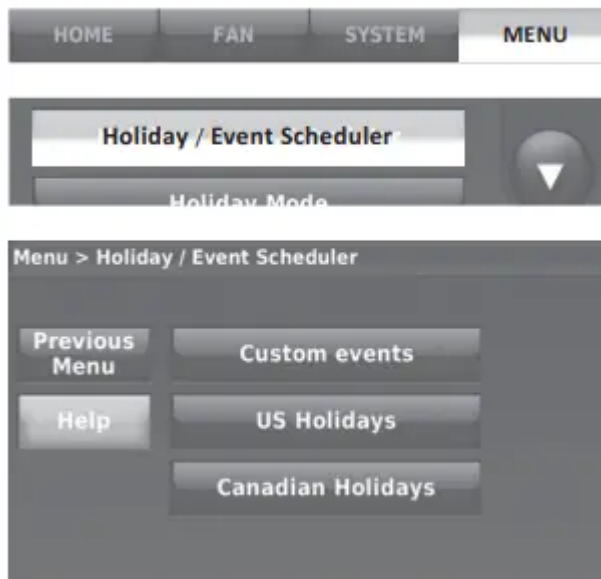

This feature helps you conserve energy when the workplace is unoccupied for special events and holidays.

1. Touch MENU.
2. Select Holiday/Event Scheduler.
3. Select the item you want to schedule.
  - Custom Events lets you set up other days for special schedules.
  - US and Canadian Holiday options let you select from a list of holidays commonly observed in each country.
4. Make selections as prompted on each screen. For more information, see next two pages.
5. Touch Done to save your settings.

## Setting custom events: commercial use

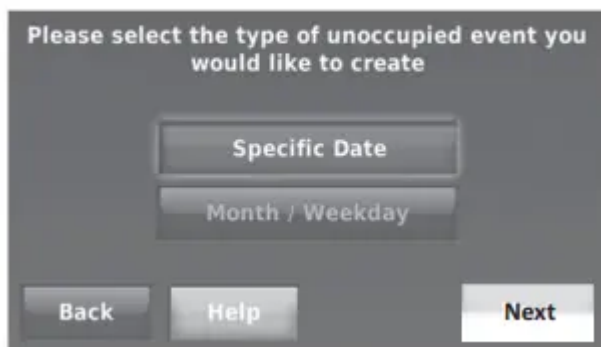
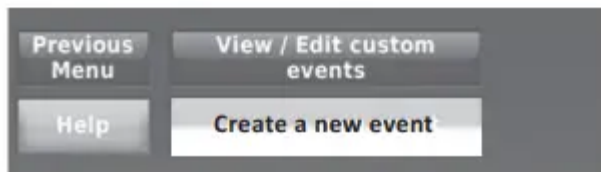
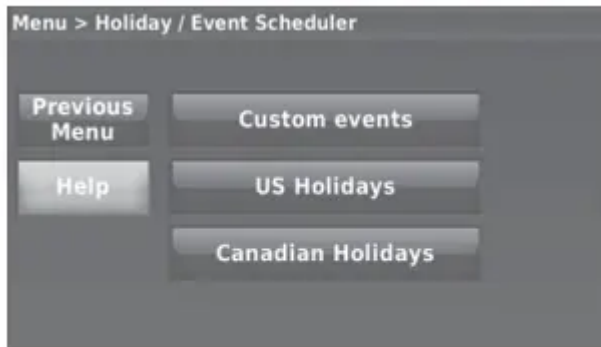

This feature lets you customize temperature settings to be maintained during a specific event. You can set up an event for a specific date or day in a month. The thermostat resumes normal scheduling after the event.

1. Select Custom events from the Holiday/Event Scheduler menu.
2. Select Create a new event.
3. Select Specific Date or Month/Weekday.
  - For Specific Date, you are prompted to select the start date, settings, end date, and frequency for the event.
  - For Month/Weekday, you are prompted to select the month, day of the week, week of the month, settings, length of event, and frequency of the event.

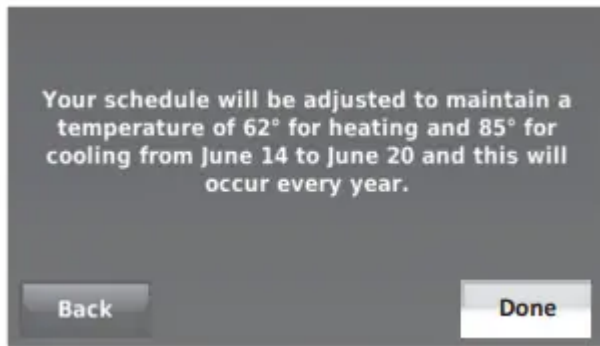

4. Review the settings and touch Done to save them. Touch Back, then Cancel to ignore the changes.

### Setting holiday schedule: commercial use

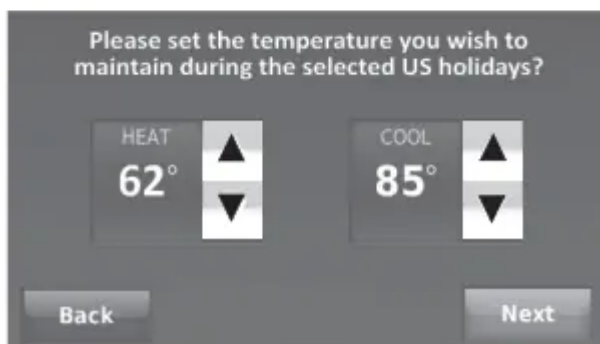
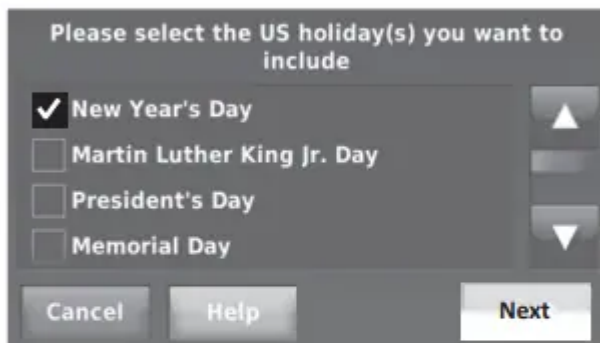
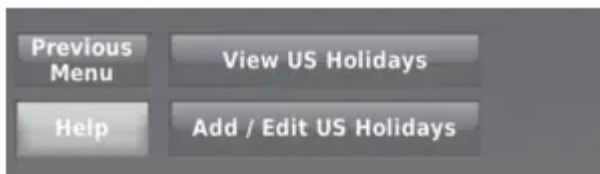

This feature lets you customize temperature settings to be maintained on specified national holidays. The thermostat resumes normal scheduling between selected holidays.

1. Select US Holidays or Canadian Holidays from the Holiday/Event Scheduler menu.
2. Select Add/Edit Holidays. A list of national holidays is displayed.
3. Touch the check box next to each holiday for which you want to maintain specific settings, (Touch ▲ or ▼ to scroll through the holiday list.) then touch Next. Set the

holiday schedule for Occupied or Unoccupied temperatures, depending whether the building will be in use.

4. Touch ▲ or ▼ to select the Heat and Cool temperatures.
5. Review the settings and touch Done to save them. Touch Back, then Cancel to ignore the changes.

### Setting holiday override: commercial use

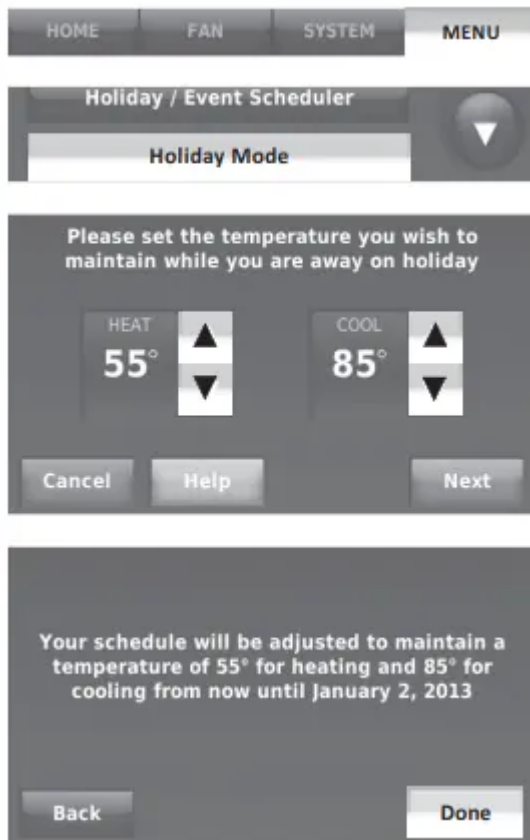

This feature lets you customize temperature settings to be maintained from now until a specified date. The thermostat resumes normal scheduling on the date you select.

1. Touch MENU.
2. Select Holiday Mode to display temperatures while you are away on holiday.
3. Touch ▲ or ▼ to select the Heat and Cool temperatures, then touch Next to select return date.
4. Review the settings and touch Done to save them. Touch Back, then Cancel to ignore the changes.

## Initiating occupancy mode: commercial use



This feature keeps temperature at an energy saving level until you touch Press to start occupancy. When you arrive, touch the button to maintain a comfortable temperature while the room is occupied. Touch the ▲ or ▼ buttons to set the temperature or the Hold Until time. The temperature is maintained until the time you set. Temperature returns to an energy-saving level after the timer expires, or the “Occupied” period ends.

## Remote setback (commercial use)

During Occupied program periods, an occupancy sensor directs the thermostat to go to REMOTE SETBACK settings when the room is empty. If someone is in the room, it uses the Occupied program period settings. The thermostat ignores the occupancy sensor during Unoccupied program periods.

If the thermostat is set up to be non-programmable, the sensor directs the thermostat to go to REMOTE SETBACK settings when the room is empty. If someone is in the room, then it follows the settings set by the user.

Depending on how your thermostat was installed, it may delay for up to 30 minutes before switching to REMOTE SETBACK settings. This delay allows the room to stay comfortable if the room is unoccupied for only a short time.

## Adjusting humidification settings



1. Touch MENU and select Humidification.
2. Select Auto.
3. Move the slider bar to select humidity level.
4. Touch More Settings if frost or condensation appears on the windows. Use a lower number to prevent frost or condensation. Use a higher number if indoor air is too dry. Window Protection limits the amount of humidity to prevent frost or condensation on windows. See notes below.
5. Touch Done to save your settings. Touch Cancel to ignore changes.

## Adjusting dehumidification settings: residential use



This feature can control a dehumidifier or use your air conditioner to reduce humidity.

1. Touch MENU and select Dehumidification.
2. Select Auto.
3. Move the slider bar to select humidity level.
4. Touch Done to save your settings. Touch Cancel to ignore changes.

### Adjusting dehumidification settings: commercial use



This feature can control a dehumidifier or use your air conditioner to reduce humidity.

1. Touch MENU and select Dehumidification.
2. Select Auto.
3. Move slider bar to select humidity level.
4. Touch Done to save your settings. Touch Cancel to ignore changes.

If your air conditioner is used to control humidity, the thermostat may use the following methods to maintain humidity:

- Cool from 1° to 5° F lower than your temperature setting.
- Run cooling for the minimum “on” time to reduce humidity.
- Run cooling and heating at the same time to reduce humidity without lowering the temperature.

## Adjusting ventilation settings

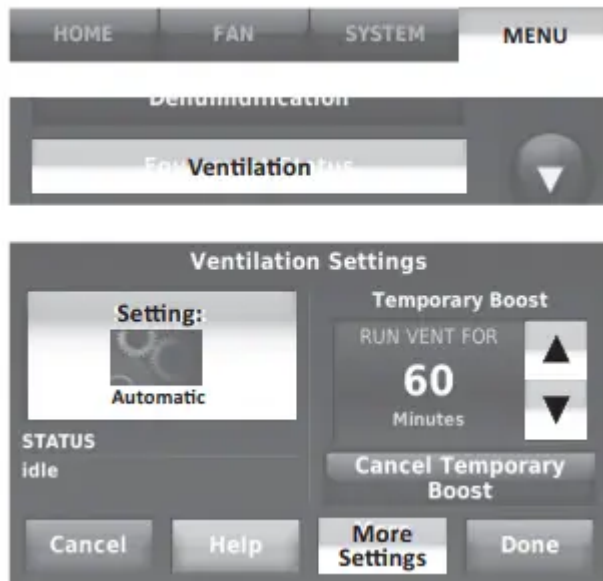

1. Touch MENU, and select Ventilation.
2. Touch Setting, then select:
  - Auto: Ventilation runs as programmed by the installer.
  - Off: Ventilation remains off unless turned on using the timer.
  - On: Ventilation is always on.
3. Touch ▲ or ▼ to run ventilation temporarily. To turn it off, set it to zero.
4. Touch More Settings to set maintenance reminders and lockouts. Select Yes to prevent ventilation from running during the Sleep or Unoccupied (commercial) program periods or when outdoor conditions exceed values set by the installer.

## Setting preferences

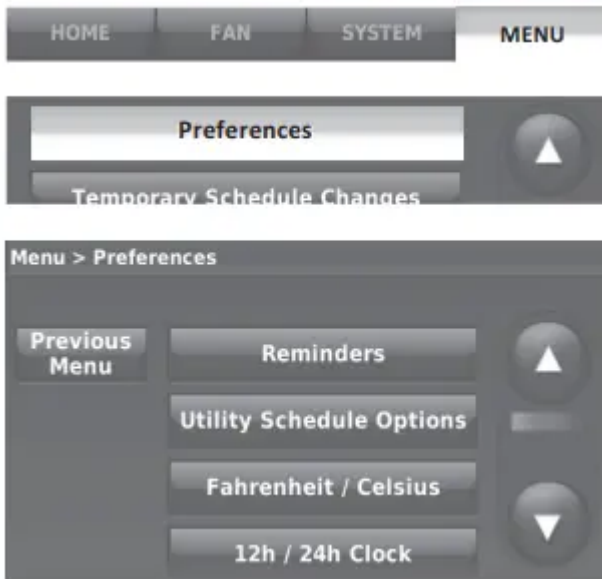

Preference menu options let you select how the thermostat displays information or responds to certain situations.

1. Touch MENU and select Preferences.
2. Select an option and follow prompts:
  - Reminders to change filters
  - Display heat/cool diagnostic alerts
  - Utility Schedule options
  - Fahrenheit/Celsius display
  - 12/24-hour clock display
  - Screen color and brightness
  - Language choice
  - Scheduling options
  - Adaptive Intelligent Recovery
  - Restore default schedule
  - Daylight saving time
3. Touch Done to save your settings. Touch Cancel to ignore changes.

## Cleaning the thermostat screen

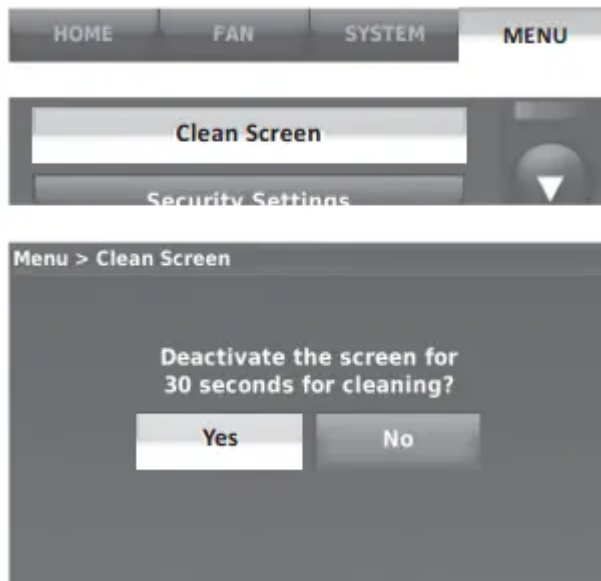

When you select the Clean Screen option, the screen is locked so you don't accidentally change settings while you clean.

1. Touch MENU.
2. Select Clean Screen. A prompt asks if you want to clean the screen for 30 seconds.
3. Touch Yes. A countdown timer displays elapsed time until the screen is reactivated.

## Adjusting security settings

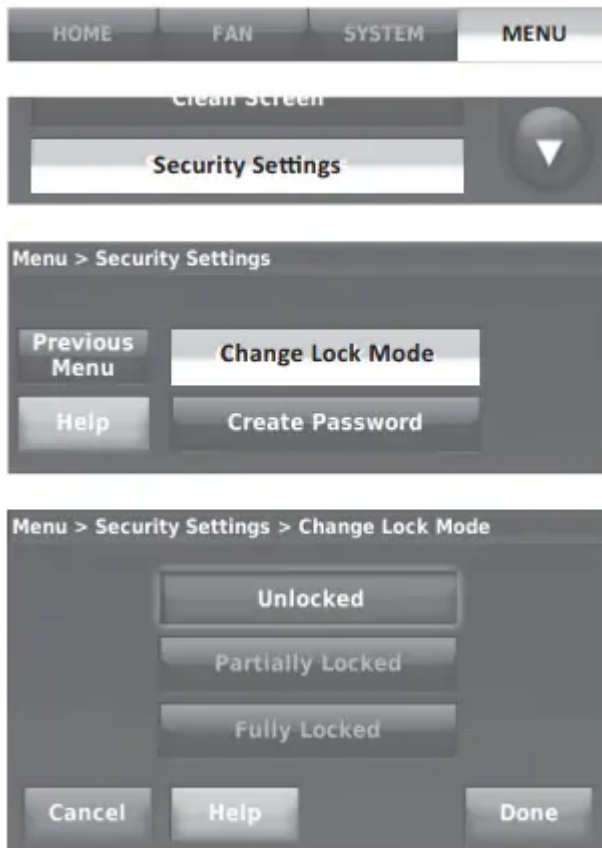

You can adjust security options to prevent unauthorized changes to system settings.

1. Touch MENU and select Security Settings.
2. Select Change Lock Mode.
3. Select an option and follow prompts:

Unlocked: Full access allowed.

Partially locked: Only temperature can be changed.

Fully locked: No access allowed.

NOTE: If you choose to use a password for additional security, write it here for reference:

--	--	--	--

## Viewing dealer information

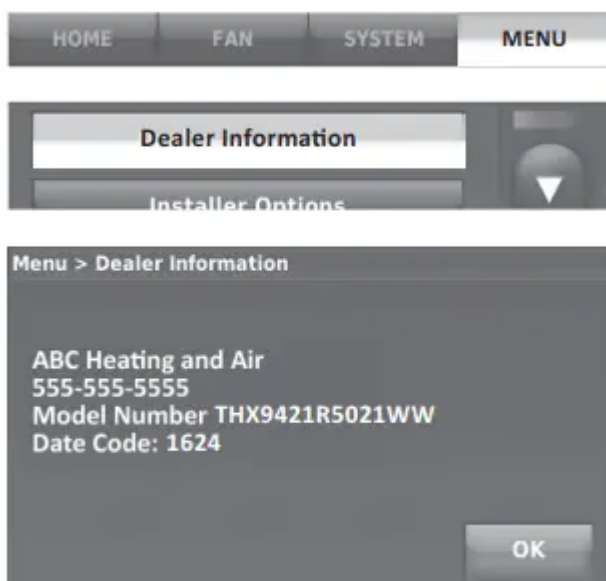

Check dealer information if you need to contact your installer for maintenance, repairs, or upgrades.

1. Touch MENU.
2. Select Dealer Information.
3. Touch Done to return to the menu.

## Troubleshooting

If you have difficulty with your thermostat, try these suggestions. Most problems can be corrected quickly and easily.

### Screen is blank

- Check circuit breaker and reset if necessary.
- Make sure power switch at heating and cooling system is on.
- Make sure furnace door is closed securely.

### Screen is difficult to read

- Change screen brightness using Preferences menu (see page 14).
- At 2 am each day, Prestige thermostats change screen colors for an hour, to prevent burn-in. Touch the screen at any time to restore pre set screen colors.

### Heating or cooling system does not respond

- Touch SYSTEM to set system to Heat. Make sure the temperature is set higher than the Inside temperature.

- Touch SYSTEM to set system to Cool. Make sure the temperature is set lower than the Inside temperature.
- Check circuit breaker and reset if necessary.
- Make sure power switch at heating & cooling system is on.
- Make sure furnace door is closed securely.
- If “Waiting For Equipment” is displayed, the compressor protection timer is on. Wait 5 minutes for the system to restart safely, without damaging the compressor.

**Warning**

This content is compiled from multiple sources and is provided for reference purposes only. It may not be complete or fully applicable to all situations. If you are unable to resolve your issue, please contact the product manufacturer or an authorized service provider for official support.